



# ATLAS G600 MINI PC

**WITH WINDOWS 11 PRO**

KAMPG600HA



# SAFETY & WARNINGS

Ensure to read all warnings and instructions in this user guide prior to first use. Retain this user guide for future reference.

- This PC contains small batteries for the CMOS on the motherboard. If the batteries require replacement, do not attempt to replace them yourself. Contact [help.Kogan.com](https://www.kogan.com/help) for assistance.
- The ideal working temperature of this PC is 10–35°C with a relative humidity of 30–80%.
- Do not repeatedly turn on and turn off the PC in a short period of time as this may cause damage to the internals.
- Do not allow food, water, or any other liquids to come into contact with the PC.
- Do not cover the fans on the PC as this may lead to lower performance and overheating.
- Do not expose the PC to strong lights or direct sunlight.
- Do not place the PC near strong magnetic fields.
- Do not use this PC in high altitudes (3000 metres above sea level and higher).
- Do not use this PC in highly humid or tropical areas.
- If there is a sudden power outage whilst the PC was in use, this may cause damage to the hard drive. When the power is reconnected, ensure to run a scan on the hard drive to check for any errors that may have occurred.
- When connecting the PC with a cable, do not forcibly pull on the cable to unplug it from the PC.
- Unplug and store the PC if it will not be used for an extended period.

# COMPONENTS LIST

- Mini PC
- Power adapter with USB-C cable
- User guide

## OVERVIEW

Front view



1 Power indicator

2 Power button

Top/side/back view

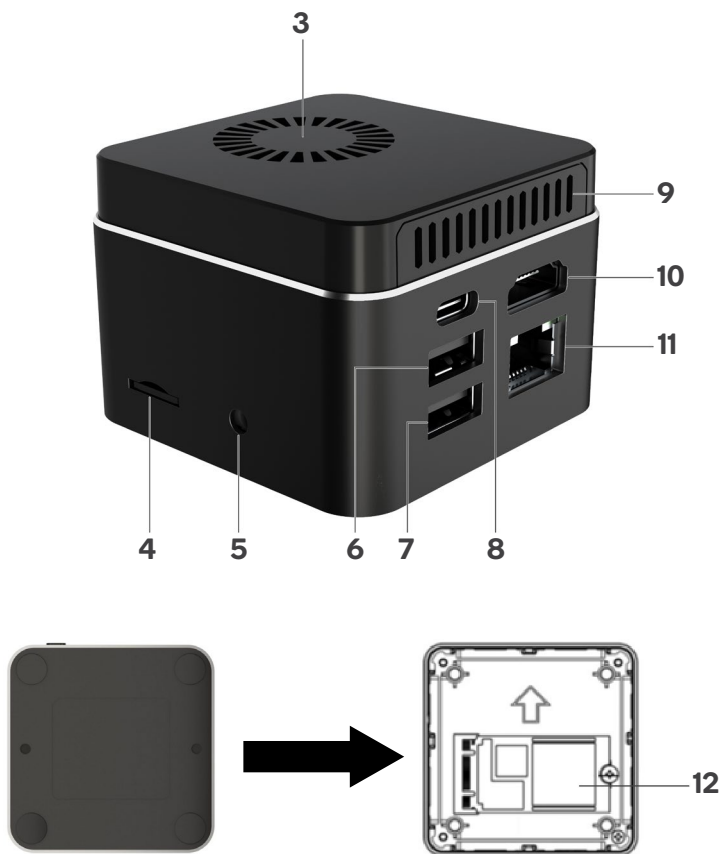

- |   |                   |    |                       |
|---|-------------------|----|-----------------------|
| 3 | Top fan           | 8  | USB-C port            |
| 4 | microSD card slot | 9  | Side fan              |
| 5 | 3.5mm audio jack  | 10 | HDMI port             |
| 6 | USB 3.0 port      | 11 | RJ-45 (Ethernet) port |
| 7 | USB 3.0 port      | 12 | SSD (underneath)      |

# OPERATION

1. Connect the PC to an external display (for example, TV, monitor, projector) with a HDMI cable (not supplied).
2. Connect the USB-C end of the power adapter into the USB-C port on the PC. Connect the power adapter into a power socket and switch on the socket.
3. Select the video output on the external display to the PC. Press the power button on the PC to start up the system. The power indicator will illuminate, and the PC will be ready for use.
4. Use the device by connecting it with a wired or wireless keyboard and mouse via USB port.

**Note:**

You may connect a wired or wireless keyboard and mouse using the USB 3.0 ports.

# SPECIFICATIONS

Dimensions (L x W x H)	62 x 62 x 43mm
Weight	155.7g
Power input	AC 110–240V, 50–60Hz
Power output	USB-C, 12V/2A
<b>System and performance</b>	
OS	Windows 11 Pro
CPU	Intel Gemini Lake N4020 4M Cache, up to 2.80GHz
Core	Dual core
Lithography	14nm
GPU	Intel UHD Graphics

Intel Burst Technology support	Yes
Memory type	LPDDR4
RAM	4GB
Wireless connectivity	Intel Wireless-AC 9461, 802.11 a/b/g/n/ac
Wi-Fi frequency supported	2.4G, 5G
Bluetooth	Version 5.1
Internal storage	eMMC, 64GB
SSD support	Yes, M.2 SSD up to 512GB
WHQL/CTS support	Yes
<b>Ports</b>	
USB	x2 USB 3.0, x1 USB-C
HDMI	x1 HDMI 1.4
microSD card reader	Yes
Ethernet port	Yes
3.5mm audio jack	Yes

### **Need more information?**

We hope that this user guide has given you the assistance needed for a simple set-up.

For the most up-to-date guide for your product, as well as any additional assistance you may require, head online to **help.kogan.com**

**kogan.com**