

ASSEMBLY INSTRUCTIONS

Counter & Bar Height Stool

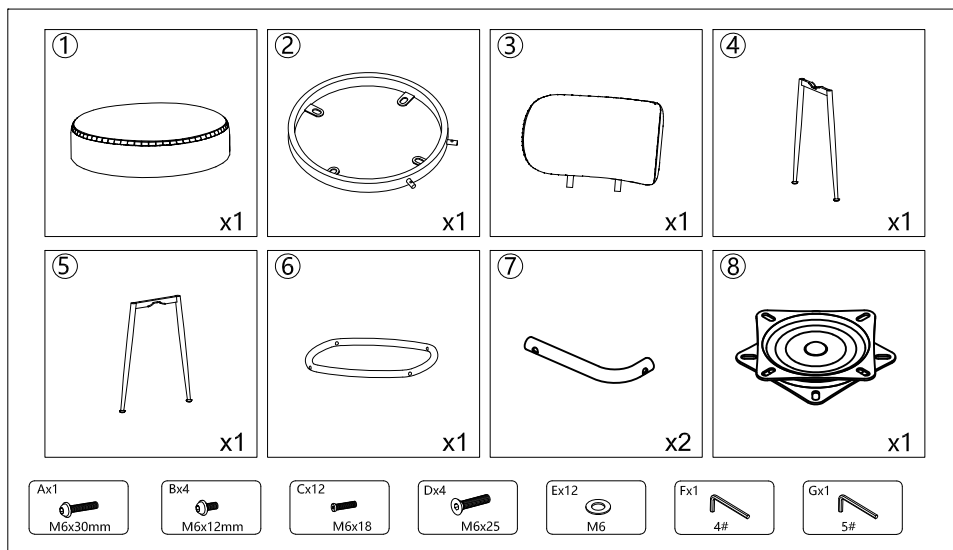
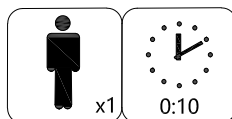
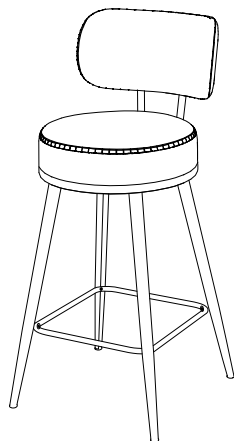

Please read through the instructions below to familiarize yourself with the parts and steps before assembly.

Note: Do NOT use power tools for assembly

1. Unpack and place seat (1), legs (4&5), footrest (6) and swivel plate (8) on a clean surface. Attach the leg part (4) to (5), using longest bolt (A), Allen wrench (G).
Note: Do not fully tighten yet.

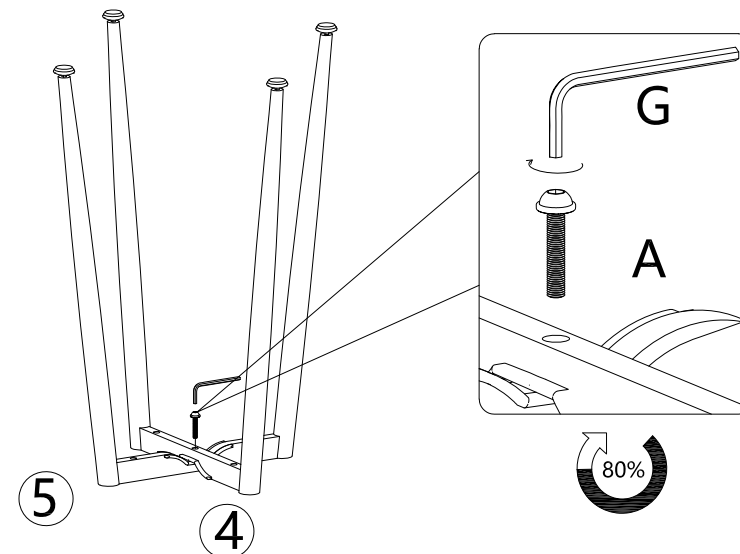

2. Attach footrest (6) to stool legs in step 1. Loosely attach the bolts (D) one by one and keep them loose. Do not fully tighten. After loosely attach the first bolt, move on to the diagonal bolt. After all 4 bolts are attached, use allen wrench (F) to tighten.
Note: Do NOT use power tools for assembly.

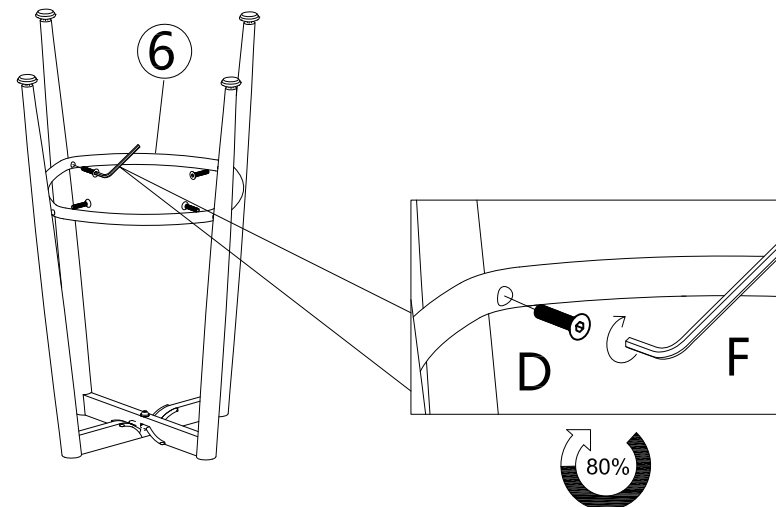

- 3** Fully tighten the longest bolt (A) in step 1 with allen wrench (G). Then attach swivel plate (8) to assembled legs in step 2, using bolts (C), flat washers (E) and allen wrench (F). **Fully tighten all the bolts.**

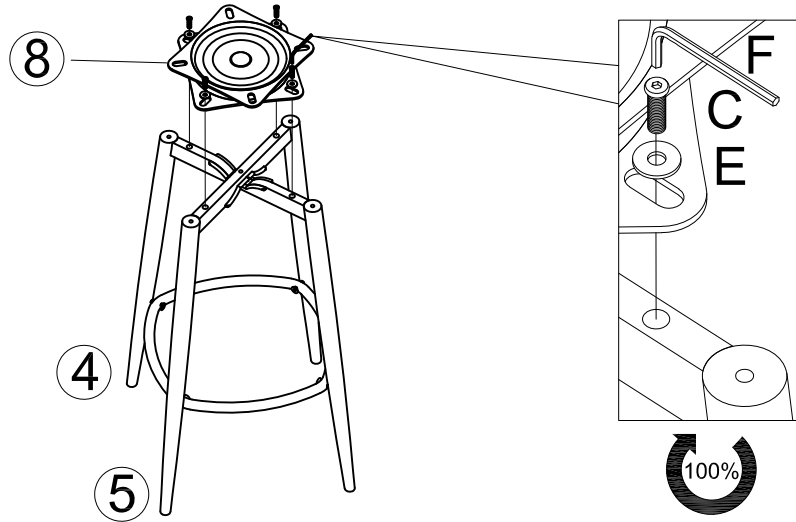

- 5** Turn assembled legs in step 3 upside down, and attach them to seat (1), using bolts (C), flat washers (E) and allen wrench (F). **Note: Tighten all bolts.**

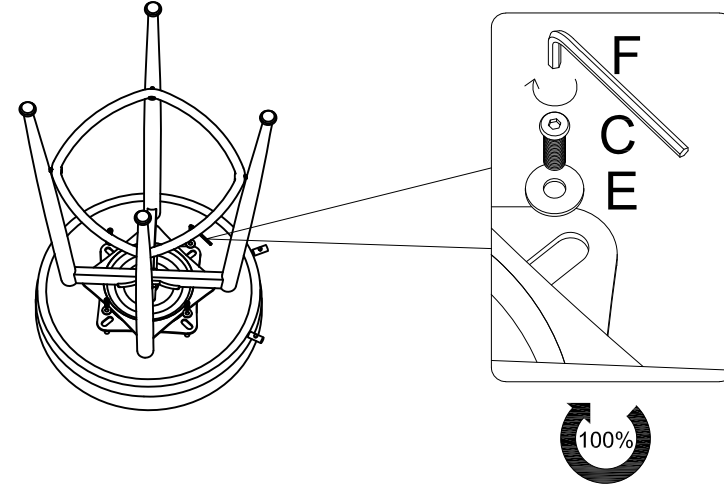

- 4** Attach the circle seat part (2) to seat part (1), using bolts (C), flat washers (E), allen wrench (F). **Fully tighten all the bolts.**

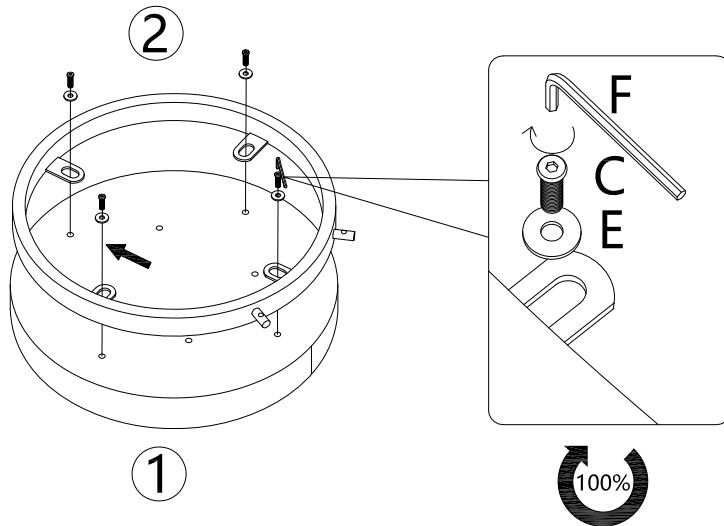

- 6** Attach parts (7) to backrest part (3), using bolts (B), allen wrench (G). **Note: Do not fully tighten yet.**

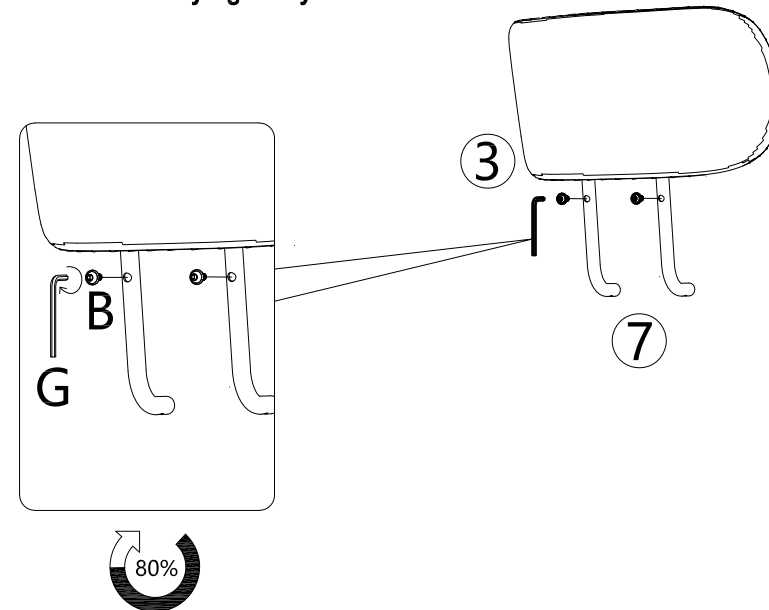

- 7** Attach the assembled backrest part in step 6 to seat part (1), using bolts (B), allen wrench (G). **Fully tighten all the bolts.**
- 9** Assembly complete. Enjoy.

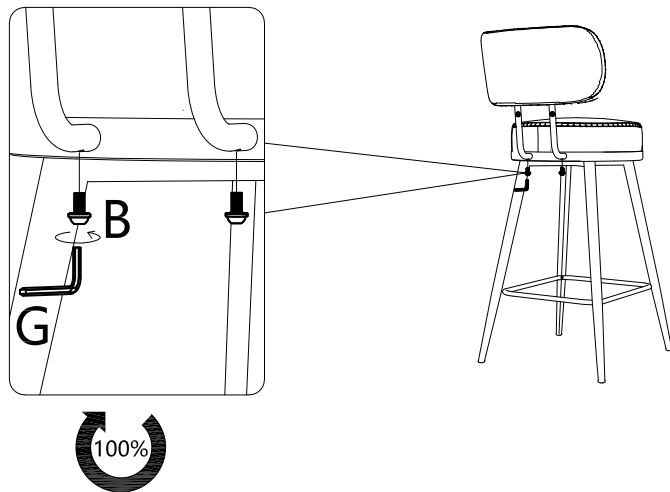

- 8** Turn assembled chair upright and place on a flat surface.
Note: Each leg has an adjustable foot leveler to help level your chair.

