

## A18 WIRELESS HEADSET

### USER MANUAL

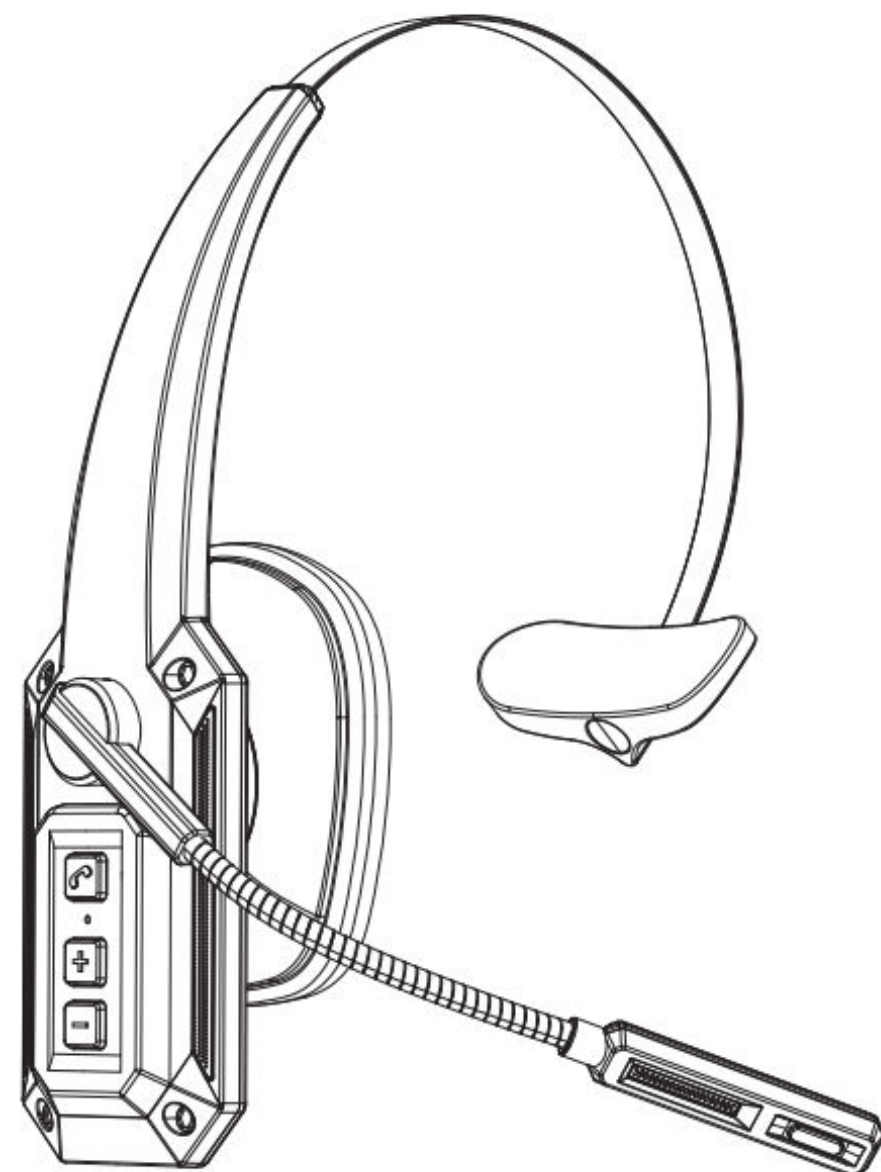

### Need any help?

If you have any issues with your order, please contact the email or website below to inquire about warranty coverage.

Customer Service: support@xxxxxx.cn  
Website: www.xxxxxx.cn

- 1 -

## WELCOME

Thank you for choosing A18 Wireless Headset. Please read the below instructions carefully before using. It will help you set up and operate this product properly and enjoy the advanced features.

No matter any questions, such as item broken or missing accessories when you received the package, please contact our customer service team, we will do our best to give you a satisfactory answer.

Customer Service:  
support@xxxxxx.cn  
Website: www.xxxxxx.cn

www.xxxx.cn

## PACKAGE LIST

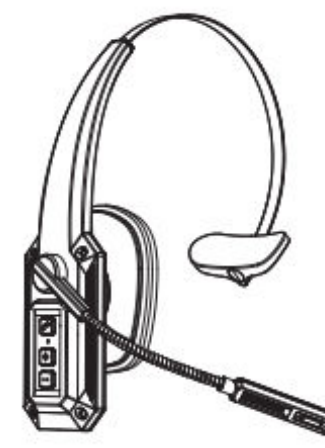

Headset \*1



Charging Cable \*1



User Manual \*1

- 2 -

## PRODUCT OVERVIEW

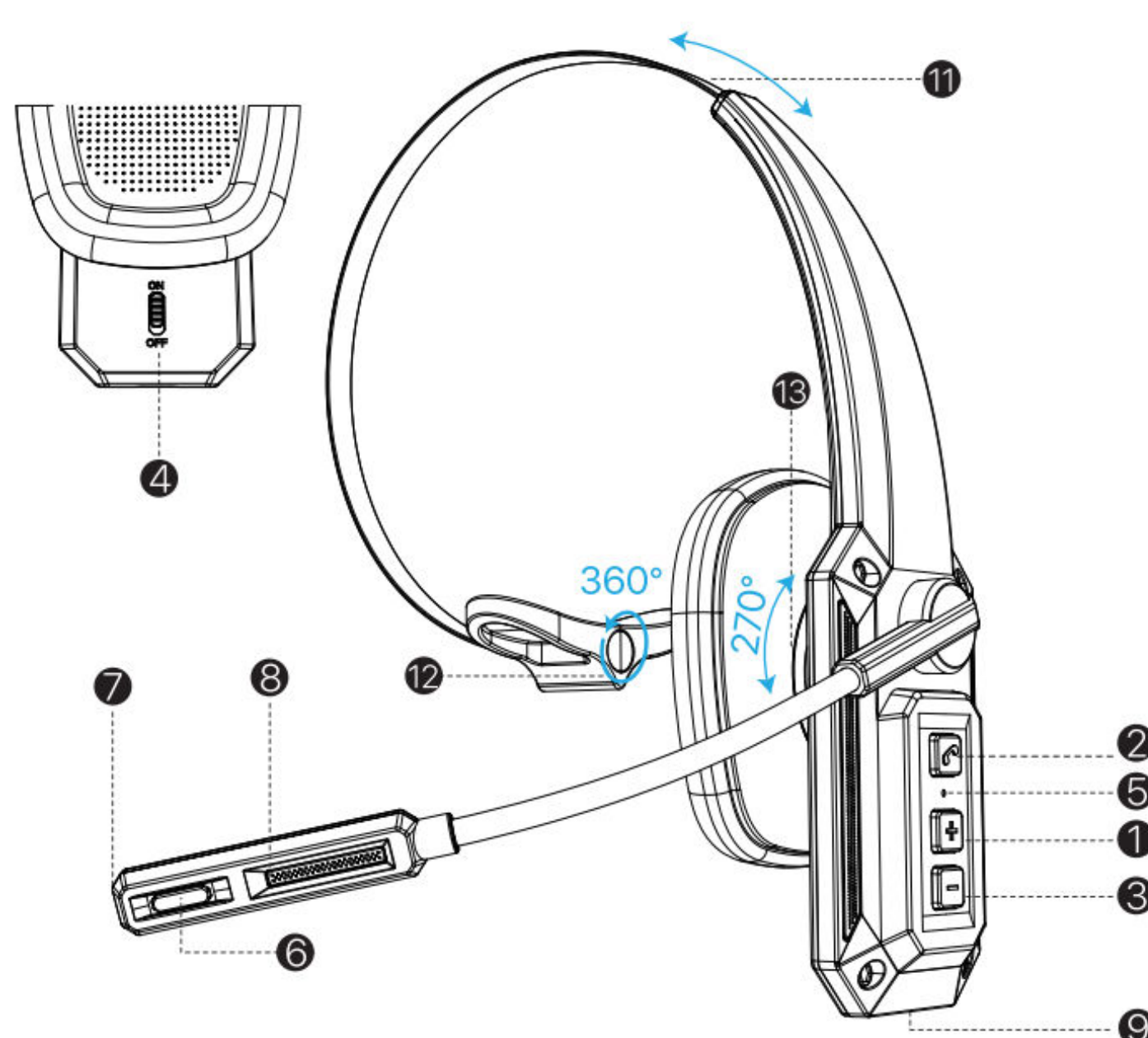

- 1 Multi-Function Button (MFB)
- 2 Volume +
- 3 Volume -
- 4 Power On/Off
- 5 LED Indicator
- 6 Mute Button
- 7 Main Microphone
- 8 Second Microphone
- 9 Changing Port
- 10 Soft Earpad
- 11 Retractable Headband
- 12 360°Rotable Pad
- 13 270°Rotable Mic

- 3 -

## How to Wear Your Headset

### Position Above the Ears

The earmuffs do not need to completely cover the earlobes but should cover the upper half of the ears, where there are many ear bones. Pressing on the ear bones can cause discomfort.

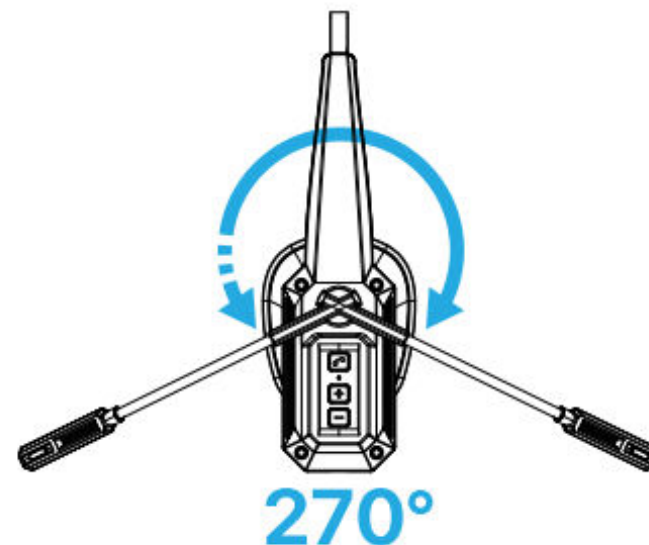

### Adjust for Comfort and Stability

Adjust the angle of the headset and the length of the headband slightly to ensure comfort and stability.

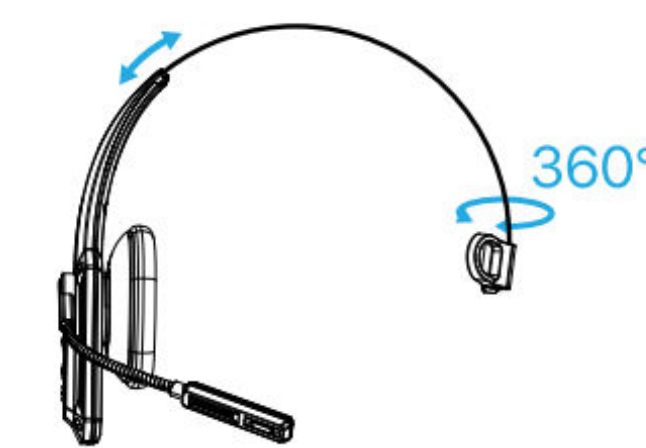

### Microphone Adjustment

The microphone can be adjusted up to 270° for easy switching between left and right ear wear.

- 4 -

## POWER ON / OFF

- Power On: Turn the power button to the ON position.
- Power Off: Turn the power button to the OFF position.
- Enable Pairing Mode: After powering on, hold the multi-function button for 3 seconds.
- Recover Default Settings: While charging, hold the multi-function button for about 3 seconds until the blue indicator flashes to reset to default settings.

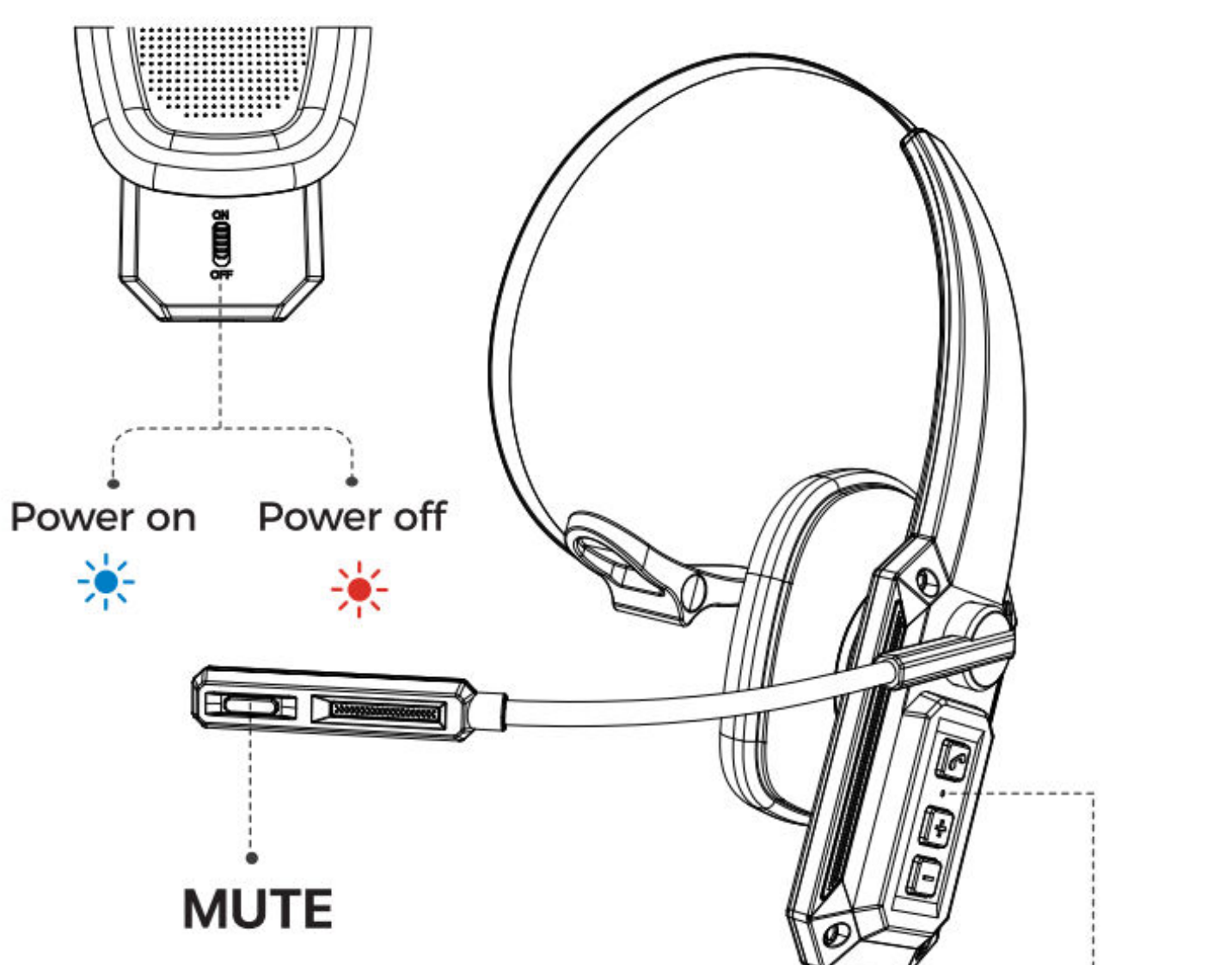

LED Indicator

- 5 -

## How to Connect

### Bluetooth Pairing and Connection (Phone)

- Enter Pairing Mode: With the headset powered on, press and hold the MFB (Multi-Function Button) for 3 seconds until the LED alternates between blue and red flashes.
- Connect to Device: Open the Bluetooth function on your device. Search for and connect to "A18" on your phone's Bluetooth list. The LED will change to a slow blue flash once connected.

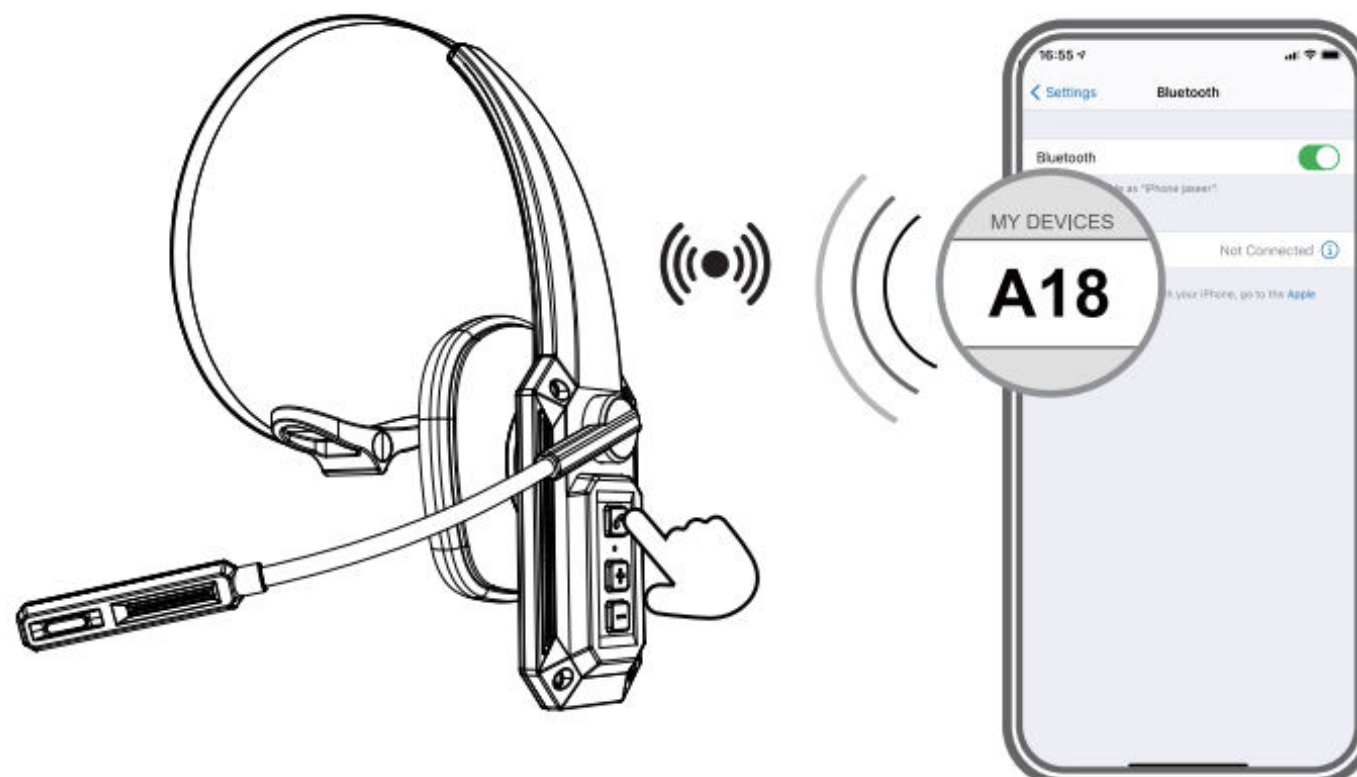

Press about 3s

### Tips:

- If the device cannot find the Bluetooth signal, turn off Bluetooth and restart the search.
- To clear the pairing record in the headset, while charging, press and hold the MFB for about 3 seconds until the blue indicator flashes.

- 6 -

## Dual-Device Pairing Setting

- Pair with First Phone: After successfully pairing with the first phone, turn off the Bluetooth headset to disconnect it.
- Pair with Second Phone: Turn the headset back on to enter pairing mode and pair it with a second phone.
- Reconnect First Phone: Once the second phone is successfully paired, find the pairing record in the Bluetooth settings of the first phone and reconnect the headset using this record.



Pair 2 device

## PC Connection Settings (PC Must Support Bluetooth)

### Pairing with a Computer via Bluetooth:

#### Enter Pairing Mode:

Turn on the headset. You will hear "Power On," followed by "Pairing" and the headset indicator will flash blue and red alternately.

#### Connect on PC:

- Go to Start > Settings > Bluetooth & other devices > Add Bluetooth or other device > Bluetooth.
- Click on the model number [A18] of your headset. A window will pop up indicating the Bluetooth connection is complete. You will also hear "Connected."

#### Troubleshooting:

- If your computer cannot find the Bluetooth device, turn off Bluetooth and restart the search.
- If your computer asks for a Bluetooth driver, contact your computer manufacturer.

- 7 -

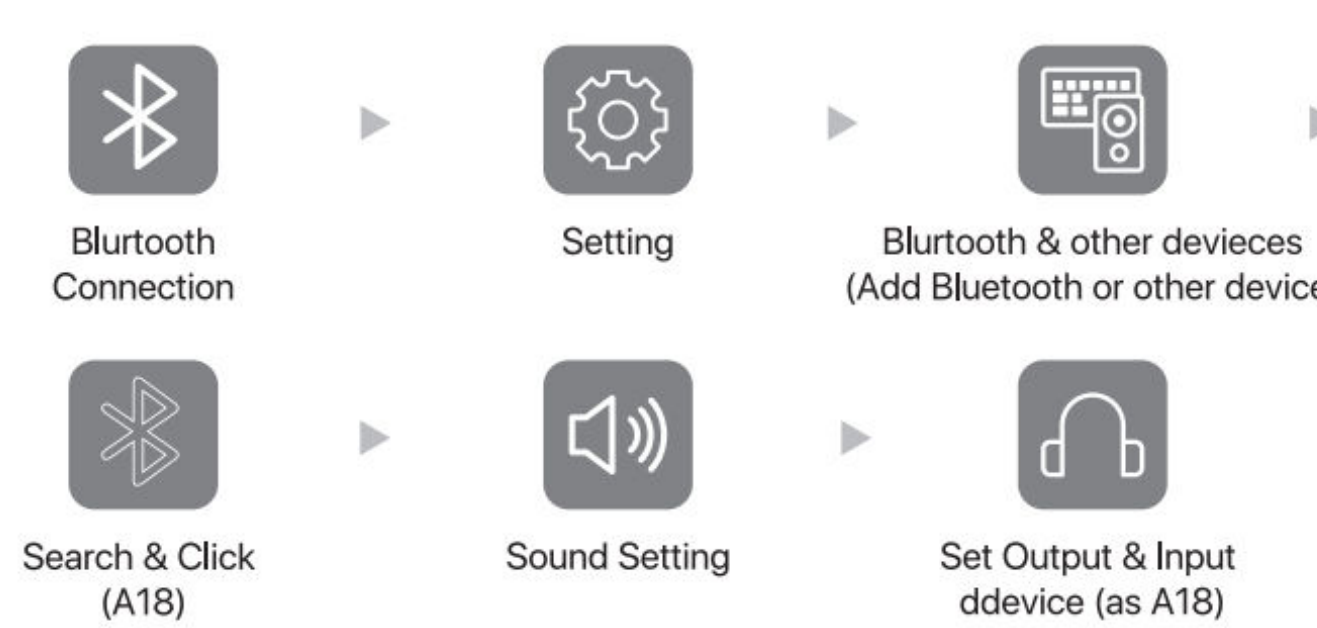

• Check the sound settings to ensure sound is played via the correct output and input:

- Right-click the Speakers icon at the bottom right, then click Open Sound settings.
- Select [A18] as your output device (Speaker).
- Select [A18] as your input device (Microphone).
- Make sure that [A19] is selected as both the output and input device. Then close Settings.

## Teams, Zoom & Other Meeting Apps Settings



- 8 -

## HEADSET OPERATION

Play / Pause / Anser / Hang up / Redail / Reject / Siri/Mute

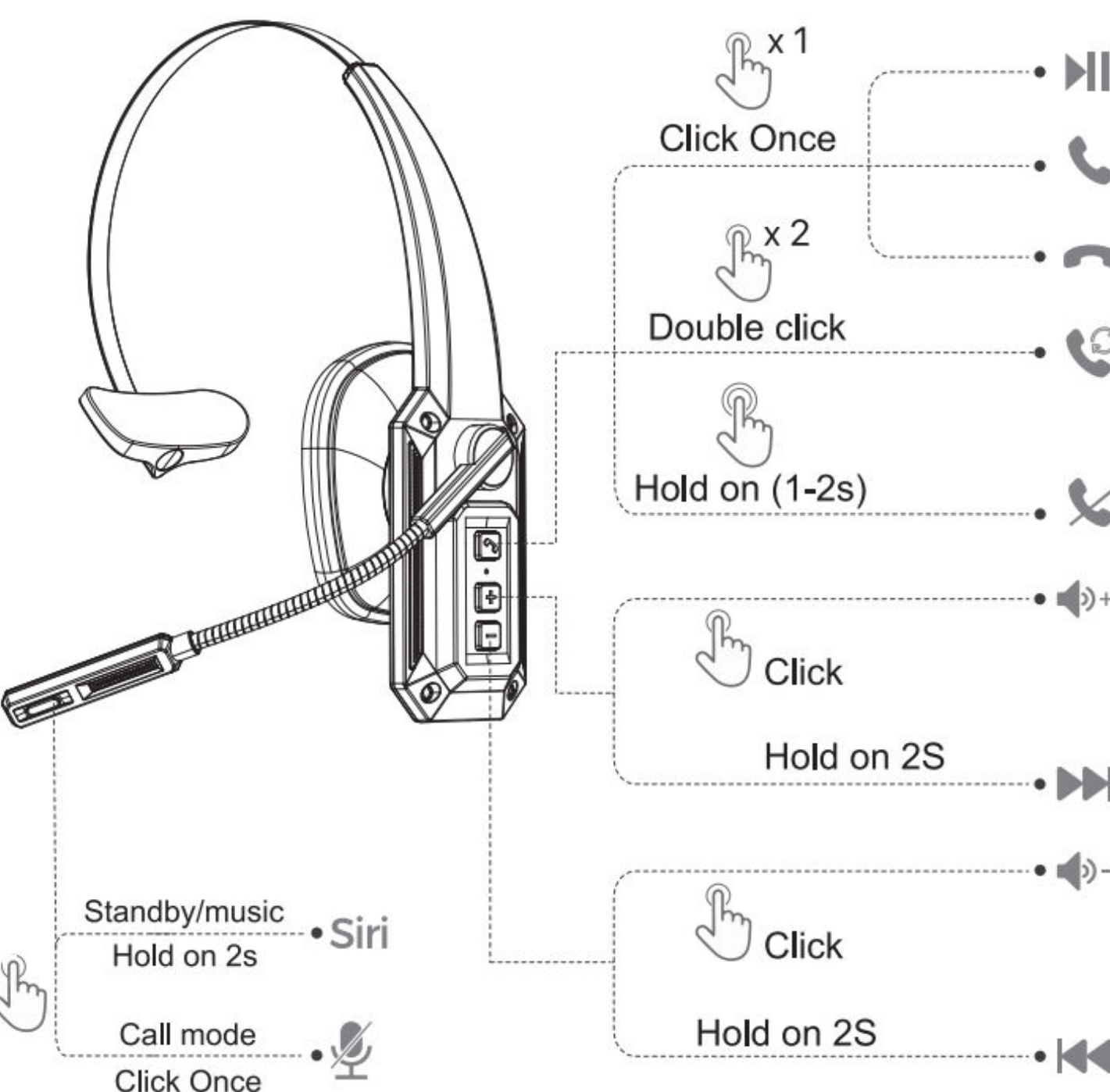

- 9 -

Function	Operation	LED Status	Voice Prompt	Instruction
First Power On	Slide the power button to ON	After the blue light stays on for 1 second, the red and blue lights flash alternately	"Power on", enter pairing state	The headset will enter the pairing state directly when it is turned on for the first time. If there is no connection operation after 5 minutes, it will automatically shut down.
Power On with Connection Record	Slide the power button to ON	After the blue light stays on for 1 second, the blue light flashes once every 8 s	"Powering on"	When turned on, the headset will automatically search for the last connected device. If not found within 10 seconds, it will enter pairing mode. If no connection is made within 5 minutes, the headset will shut down automatically.
Power Off	Slide the power button to OFF	The red indicator light flashes 3 times	"Power off"	
Pairing	Press and hold the multi-function button for 3 seconds	The red and blue lights flash alternately	Enter pairing state	If there is no pairing operation for 5 minutes, it will automatically shut down.
Headset Connected Successfully	The headset automatically connects successfully or the mobile phone connects successfully	After the connection is successful, the blue light flashes once every 8 s	"Connected"	Bluetooth is successfully connected to the communication device.

- 10 -

Function	Operation	LED Status	Voice Prompt	Instruction
Headset Disconnected Due to Distance from Phone	The headset and mobile phone are too far apart and disconnected	The blue light flashes once every 3 s	Left away reminder once	If it has not been connected, it will enter pairing mode after 10 minutes. If there is no operation, it will automatically shut down after 5 minutes.
Automatic Connection on Power On	The Bluetooth headset is powered off or turned off and restarted while online		Power on + "Connected"	When the headset is turned on, it will automatically connect to the last connected mobile phone.
Answer Incoming Call	When a call comes in, tap the multi-function button or answer the call with your mobile phone	When a call comes in, the blue light flashes once every 4 s; after answering the call, the blue light continues to gradually brighten and dim.		When you hear a ringtone from the unit, press the multi-function key once and the unit can answer the call.
Mute Call	Single-click the mute button		"MIC ON"	Click again to turn on the MIC, and there will be a prompt tone "MIC OFF".
Switch Call (Between Phone Earpiece and Headset Earpiece)	During a call, press and hold the multi-function button for 2 seconds	When switching to a mobile phone call, the red light will continue to gradually brighten and dim, and when switching to a Bluetooth call, the blue light will continue to gradually brighten and dim.	"Beep"	When you press and hold the multi-function key for 2 s, the Bluetooth call state is converted to the mobile phone call state. Repeat the operation to convert the mobile phone call state to the Bluetooth call state. (The mobile phone must support the switching function)

- 11 -

Function	Operation	LED Status	Voice Prompt	Instruction
End Call	Tap the multi-function button		"Di"	Touch the multi-function key to end the call.
Reject Incoming Call	When a call comes in, press and hold the multi-function button for about 2 s		Di Du	When there is an incoming call, press and hold the multi-function key to reject the incoming call.
Redial Last Number	Double-click the multi-function button		"Du"	In the online standby state, double-click the multi-function key and the phone will automatically dial the last dialed phone number.
Play/Pause	While playing music, tap the multi-function button to play/pause music	The blue light flashes once every 8 s		When playing music, tap the multi-function key to pause the music, and repeat the operation to return to the playing state.
Next Track	Press and hold the volume "+" button for 2 s for the next song			When playing music, long press "Volume +" for 2 s to play the next song.
Previous Track	Press and hold the volume "-" button for 2 s for the previous song			When playing music, long press "Volume -" for 2 s to play the previous song.

- 12 -

Function	Operation	LED Status	Voice Prompt	Instruction
Adjust Volume	Touch or continuously tap the volume + or volume - button			Each press increases the volume by one level. When the volume is adjusted to the maximum, there will be a "Beep" prompt sound, and when the volume is adjusted to the minimum, there will be a "du" prompt sound.
Voice Assistant	Press and hold the multi-function button for about 2S while online		"Du"	When online, long press the mute key for about 2S and then release it, and then say the name of the person corresponding to the number stored in the mobile phone address book to the headset according to the prompt of the mobile phone (the mobile phone must support voice dialing function).
Low Battery Alert	The battery voltage is lower than 3.3V	The red light flashes every 8 seconds	Remind every five minutes/ Battery Low	The headset is still in normal working condition.
Low Battery Shutdown	The battery voltage is lower than 3.0V	The red indicator light turns on for about 1 s and then turns off		The headset enters the shutdown state and the indicator light goes out.
Reject Third Party Call, Keep First Party Call	When the headset and the phone are in a call, a third party calls in, double-click the multi-function key		"Du"	When playing music, long press "Volume +" for 2 s to play the next song.
Answer Third Party Call and Hang Up Current Call	When the headset and the phone are in a call, a third party calls in, press the multi-function key once to hang up the current call and connect the third party			The third party's call will be answered and the previous call will be ended

- 13 -

Function	Operation	LED Status	Voice Prompt	Instruction
Hold First Call, Answer Third Party Call	When the headset and the phone are in a call, a third party calls in, long press the multi-function key until a "beep" sound to answer the call		"Du"	The third party's call will be answered and the previous call will be retained. Repeat the operation to retain the third party and answer the first party.
RF (DUT)	Enter pairing mode and press and hold the multi-function button and volume up button for three seconds	The red and blue lights are always on		Charging recovery
Charging	Charging voltage 5V current 200M	The red light is always on, and the blue light is always on after being fully charged		The blue light is always on when fully charged
Restore Factory Settings	Power off and charge 3s and then press and hold the multi-function button for 3 seconds	The blue light flashes 3 times and then the red light is always on		The headset deletes all connection records and restores factory settings

### NOTE:

If your headset is not detected by your phone or fails to establish a connection, follow these steps to restore the default settings:  
1. Recover default settings. Turn off the power button and charging the headset, then hold the Multi-function Button for about 3s till the blue indicator flashes to recover the default settings.  
2. Unplug the headset from its charger, power on the headset, and press "MFB" about 3s to pairing mode.  
3. Activate the Bluetooth feature on your phone and search for the "A19" device to begin the pairing process. With a "Connected" notification sound, the pairing is successful.

- 14 -

## CHARGE THE HEADSET

Output: DC 5V

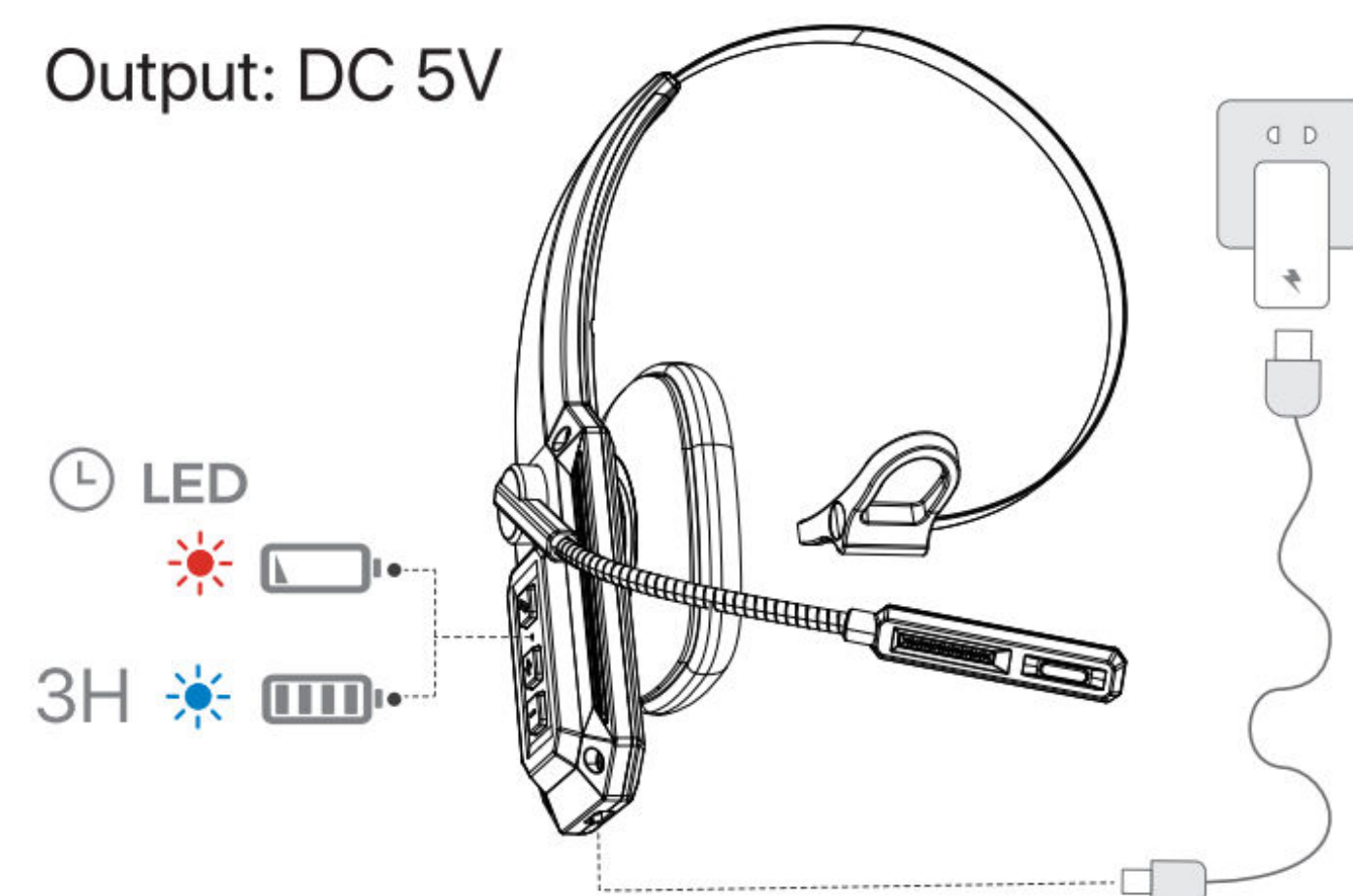

### NOTIFICATION

- Please fully charge the headset if it will be idle for a long time, and store it in a cool, dry place. Recharge it every 2 months.
- Please fully charge the headset before the first use.
- Please do not use the headset while charging.

- 15 -

## PRODUCT PARAMETERS

Model:	A18
Bluetooth Version:	V5.3
Operation Range:	49ft(15m)
Battery Capacity:	350mAh/3.7V
Charging Time:	3 hours
Voltage:	DC5V/1A
Headset Net Weight:	107g
Compatible devices:	PC,Laptop,Smartphone
Support System:	iOS/Android/Windows

EC REP C&E Connection E-Commerce (DE) GmbH  
Zum Linnegraben 20, 65933, Frankfurt am Main, Germany

CE RoHS  
Made in China

- 16 -



**FCC Warning:**

This equipment has been tested and found to comply with the limits for a Class B digital device, pursuant to part 15 of the FCC Rules. These limits are designed to provide reasonable protection against harmful interference in a residential installation. This equipment generates, uses and can radiate radio frequency energy and, if not installed and used in accordance with the instructions, may cause harmful interference to radio communications. However, there is no guarantee that interference will not occur in a particular installation. If this equipment does cause harmful interference to radio or television reception, which can be determined by turning the equipment off and on, the user is encouraged to try to correct the interference by one or more of the following measures:

- Reorient or relocate the receiving antenna.
- Increase the separation between the equipment and receiver.
- Connect the equipment into an outlet on a circuit different from that to which the receiver is connected.
- Consult the dealer or an experienced radio/TV technician for help.

**Caution:** Any changes or modifications to this device not explicitly approved by manufacturer could void your authority to operate this equipment.

This device complies with part 15 of the FCC Rules. Operation is subject to the following two conditions:

(1) This device may not cause harmful interference, and (2) this device must accept any interference received, including interference that may cause undesired operation.

This equipment complies with FCC radiation exposure limits set forth for an uncontrolled environment. This equipment should be installed and operated with minimum distance 0cm between the radiator and your body.