

# QUICK SETUP GUIDE:



**IMPORTANT:** It is recommended to BENCH TEST this unit by performing the Quick setup procedures below, adding a new user(s) and testing communications. In this manner, if there are any communication concerns experienced after the installation, troubleshooting efforts can be focused towards environmental variables.

1

## CAREFULLY UNPACK & CHECK THE CONNECTIONS

\*INSTALLED OPTIONS  
APPEAR ON BOX



**FOR TECH SUPPORT CALL:**  
(949) 208-3600  
[WWW.ELIKAACCESS.COM](http://WWW.ELIKAACCESS.COM)



**TOOLS**

SECURITY SCREW DRIVER



**ELIKA 460 MANUALS**

INSTALLATION INSTRUCTION MANUAL  
WEB APPLICATION MANUAL  
UNIT ACTIVATION CARD



**MISCELLANEOUS**

CALL BUTTON LABELS  
FUSE KIT  
TRANSFORMER



**IMPORTANT!**

**STANDARD GOOSENECK  
PEDESTAL INSTALLATION  
RECOMMENDED.**

IF ALTERNATE MOUNTING IS  
REQUIRED, ALLOW SPACE FOR  
ANTENNA.

**WITHOUT PROPER SPACING,  
SIGNAL MAY BE INTERRUPTED.**



**IMPORTANT!**

ELIKA 460 **REQUIRES  
ACTIVATION** BEFORE USE.

SEE THE ACTIVATION CARD  
**FOLLOW THE PROMPTED  
INSTRUCTIONS AT:**

[www.elikacloud.com](http://www.elikacloud.com)

2

## ROUTE THE POWER AND CONTROL WIRES

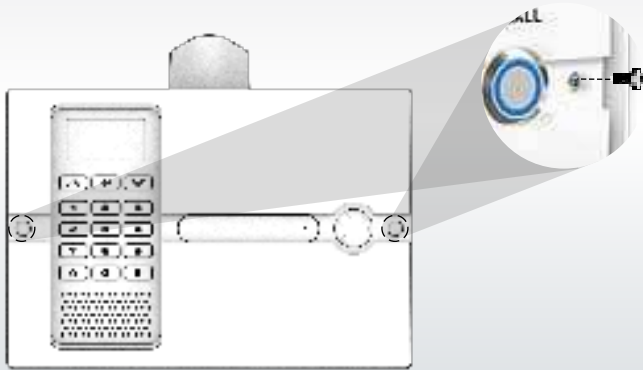

1. REMOVE THE SECURITY SCREWS

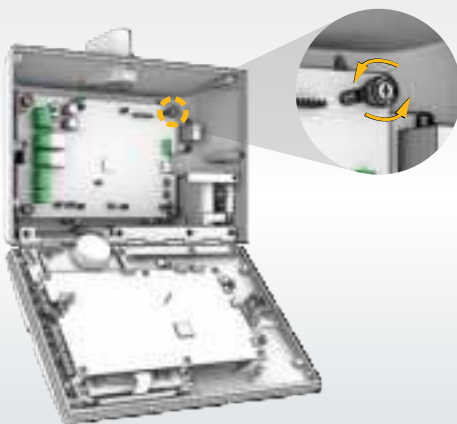

2. REMOVE THE MAIN BOARD

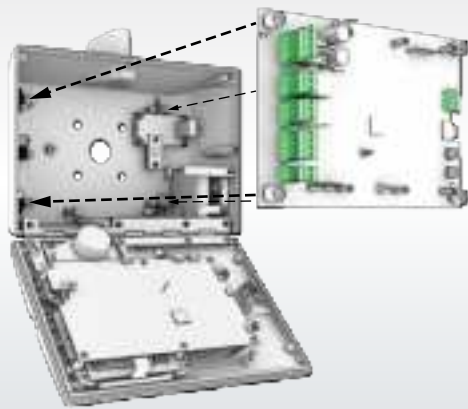

3. ROUTE THE WIRES  
RE-INSTALL THE MAIN BOARD



**WARNING**

**AUTOMATIC GATES CAN CAUSE  
SERIOUS INJURY OR DEATH!**

THE GATE PATH MUST BE  
CLEAR BEFORE OPERATING!

**SAFETY DEVICES SHOULD BE  
INSTALLED TO ENSURE  
PROPER USE.**

# QUICK SETUP GUIDE:



**IMPORTANT:** It is recommended to BENCH TEST this unit by performing the Quick setup procedures below, adding a new user(s) and testing communications. In this manner, if there are any communication concerns experienced after the installation, troubleshooting efforts can be focused towards environmental variables.

## 3 CONNECT YOUR ACCESSORIES

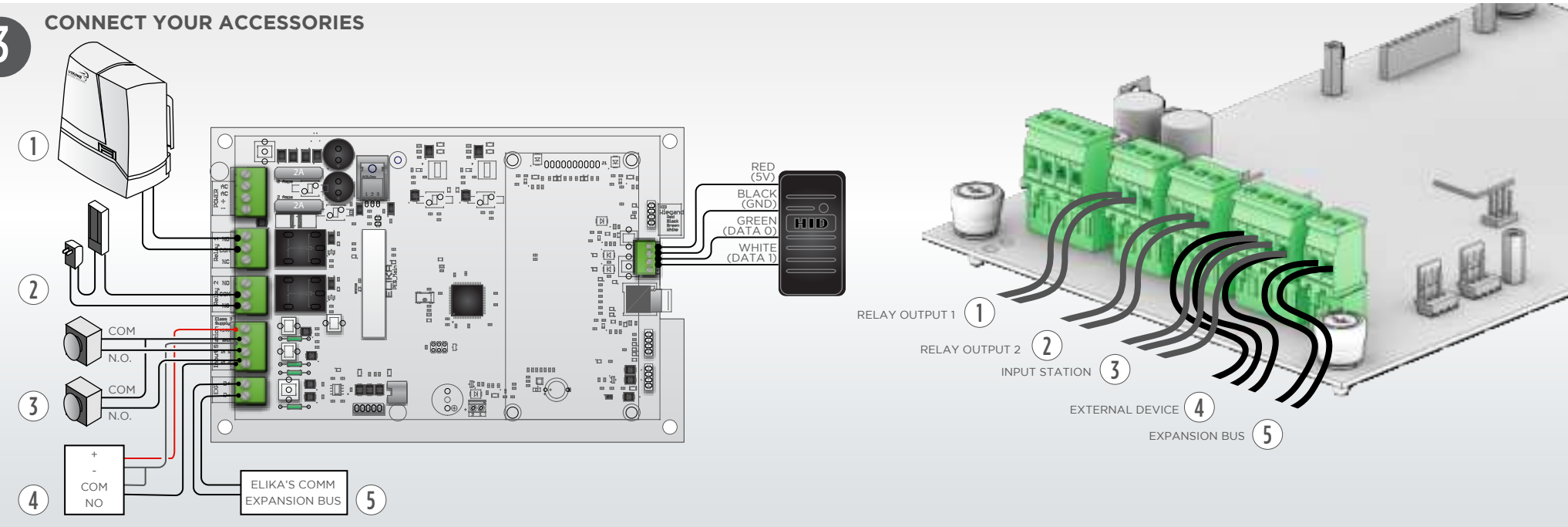

### IMPORTANT!

**ENSURE THAT ALL COMPONENTS ARE PROPERLY CONNECTED AND MOUNTED TO THE UNIT.**

FOR ADDITIONAL INFORMATION REGARDING INSTALLATION REFER TO THE MANUAL.



### STOP!

**CONFIRM THAT THE UNIT HAS THE PROPER POWER BEFORE TRYING TO OPERATE.**

FOR ADDITIONAL INFORMATION ON POWER OPTIONS REFER TO THE INSTALLATION MANUAL.

## 4 CONNECT YOUR POWER SUPPLY

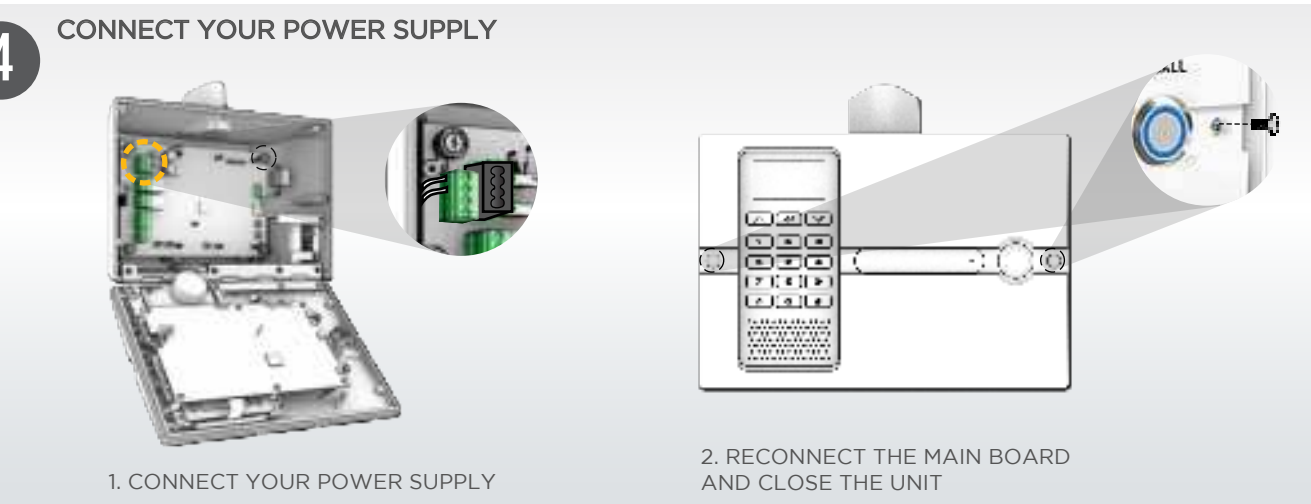

## 5 APPLICATION SETUP

1. REGISTER DEVICE AT:  
[www.elikacloud.com](http://www.elikacloud.com)
  - a. FOLLOW ONLINE PROMPT
2. INPUT CODES:
  - a. SERIAL NUMBER
  - b. REGISTRATION CODE
  - c. FOLLOW ONLINE PROMPT
  - d. ACTIVATE AND PICK PLAN

**FOR MORE INFORMATION REFER TO THE MANUAL**

