

Rowenta®

EN

KO



www.rowenta.com

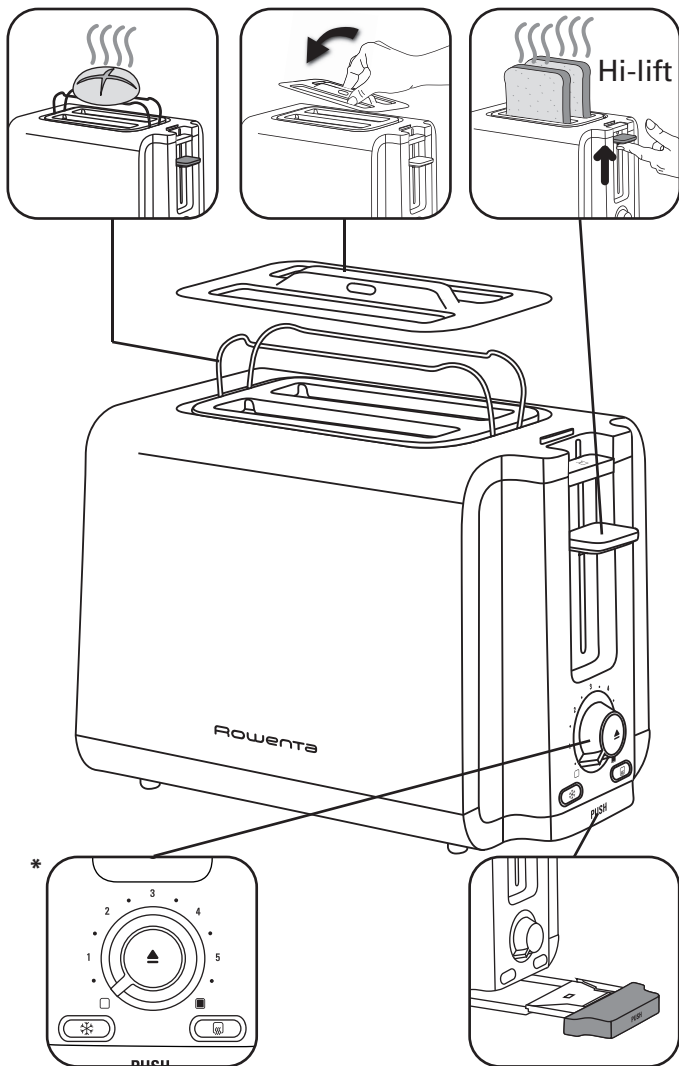

* depending on model • 모델에 따라 다름

English

SAFELY INSTRUCTIONS

IMPORTANT SAFEGUARDS:

- This appliance is not intended to be operate using an external timer or separate remote, control system.
- ! • **For your safety, this appliance conforms, with applicable standards and regulations (Directives on low voltage, electromagnetic compatibility, materials in contact with foodstuffs, environment, etc.).**
- ! • **In accordance with the CSC notice of 2/12/04, this product features a mechanical design allowing the bread ejection mechanism to be detached from the power cut-off element.**
- Check that the electricity supply voltage corresponds to the voltage indicated on the appliance (ac current only).
- Given the many standards in effect, if this toaster is used in a country other than the country where it was purchased, have it checked by an approved service centre (see enclosed after sales service information).
- Check that the electricity installation is sufficient to supply the power required by this appliance.
- Always plug the toaster into an earthed socket.
- Use extension leads which are in good condition, with an earthed connection, and with a minimum rating of 10A.
- ! • **This appliance is intended to be used in household only. It is not intended to be used in following applications, and the guarantee will not apply for:**
 - staff kitchen areas in shops, offices and other working environments;
 - farm houses;
 - by clients in hotels, motels and other residential type environments;
 - bed and breakfast type environments.

TO PREVENT ANY ACCIDENTS

When using electrical appliances, basic safety precautions should always be followed:

DO:

- Carefully read and follow all the instructions for use.

- Close supervision is necessary when the toaster is used by or near children or certain disabled persons who are not familiar with these instructions and should only use this toaster under surveillance of a responsible adult.
- The toaster must always be used in the upright position, never on its side or tilted forwards or backwards.
- ! • **Before each use make sure that the crumb tray is fitted correctly.**
- Regularly remove crumbs from the crumb tray.
- The bread control lever must be in the "Up" position before plugging in or unplugging the appliance.
- Unplug the appliance if it shows any working abnormalities.
- Unplug from the power socket when not in use during and before cleaning. Allow to cool down before cleaning or storing.
- To unplug remove the plug from the wall socket (when the toasting cycle is finished).
- If the bread jams in the slots after toasting and the elements do not switch off, unplug the plug immediately and wait for the appliance to cool before attempting to remove the bread.
- Bread can burn; Therefore do not use this appliance near any flammable materials such as curtains, under shelving or under wall cupboards.
- Use on a flat, stable heat-resistant work surface, away from any contact with water and never use underneath a built in kitchen alcove.

DO NOT:

- Do not let the toaster operate unattended, particularly when toasting for the first time or when settings have been changed.
- Do not store the cord or the plug between the slots in the appliance.
- Do not unplug the appliance by pulling on the cord.
- Do not move or carry the appliance during use.
- ! • **This appliance is not intended for use by persons (including children) with reduced physical, sensory or mental capabilities, or lack of experience and knowledge, unless they have been given supervision or**

instruction concerning use of the appliance by a person responsible for their safety.



• **Children must be supervised to ensure that they do not play with the appliance.**

- Do not leave the appliance within the reach of children.
- Do not use outdoors. Avoid humid environments.
- Do not use the appliance for any other use other than that for which it was designed.
- Do not touch the metal parts or hot surfaces of the appliance when it is working.
- Oversized foods, metal foil packages, or utensils (spoon, knife, etc.) must not be inserted into a toaster as they may cause an electric shock or fire.
- Do not use accessory attachments that are not recommended by the manufacturer as this may be dangerous.
- To protect yourself against and electrical shock do not immerse the cord, plugs, or appliance in water or other liquids.



• **Do not place any sugar coated type of bread in the toaster or anything that may melt or drop into the toaster, do not toast small pieces of bread or croutons as this may cause damage to the toaster or a risk a fire.**



• **Do not try to toast very thick slices of bread that could become stuck in the toasting slots.**

- Do not use this appliance if:
 - it has a damaged cord,
 - the appliance has been dropped and has visible damage or does not operate properly.In any of these instances, the appliance must be sent to your local approved after-sales service centre to avoid any risk of danger. Refer to the guarantee enclosed.
- If the supply cord is damaged, it must be replaced by the manufacturer, its service agent or similarly qualified persons in order to avoid a hazard.
- Do not let the cord hang over the edge of the worktop or come into contact with hot surfaces.
- Do not place on or near a gas burner, electric ring/hob, or near a heated oven.
- Do not cover this appliance while in use.
- **Bread can burn, therefore the appliance must not be used near or below curtains and other combustible materials such as curtains, drapes or wood (shelving, cupboards...) it should be attended when in use.**



• Do not put paper towels, cardboard or plastic in, on or under the toaster.

• **If flames were to arise from parts of the toaster, never attempt to extinguish them with water. Unplug the appliance and smother the flames with a damp cloth.**

- Do not attempt to dislodge food once the toasting cycle is engaged.
- Do not use this appliance as a source of heating or drying.
- Do not use the toaster for cooking, grilling or defrosting frozen food other than bread products.
- Do not use the appliance to toast bread and warm croissants (or similar products) at the same time (depending on model).
- The metal frame can become very hot. Do not touch it! Use an oven glove or tongs (depending on model).
- Do not use any abrasive cleaning agents (no soda-based scouring products, no scouring pads...), no metallic utensils, metal scouring pads etc.
- For appliances with a metallic finish: Do not use any cleaning products designed for metals: use a soft cloth with a window or glass cleaner.

SAVE THESE INSTRUCTIONS



Environment protection first !

- ① Your appliance contains valuable materials which can be recovered or recycled.
- ➔ Leave it at a local civic waste collection point.

If you have any product problems or queries please contact our Helpline:

0845 602 1454 - UK

(01) 677 4003 - ROI

or consult our website: www.tefal.co.uk

한국어

안전상 주의사항

• 본 제품은 외부 타이머 또는 개별 리모콘으로 작동하도록 고안된 제품이 아닙니다.

 • 사용자의 안전을 위해서 본 가전제품은 적용 기준 및 규정을 준수합니다. (저전압, 전자석 호환성, 음식물 접촉물, 환경 등)

 • CSC고시 (2004. 2. 12)에 의거, 본 제품은 빵 방출 장치가 전력 차단 구성요소로 부터 분리 될 수 있습니다.

• 사용전압이 제품에 표기된 전압과 일치하는지 확인하십시오. (전원 기준에 따라 달라질 수 있음)

• 나라에 따라 해당기준이 다르므로 제품을 구입 한 나라가 아닌 곳에서 사용할 때에는 공인된 서비스 센터에 확인을 받으십시오. (A/S 정보는 동봉한 설명서를 참조하시기 바랍니다.)

• 본 제품을 사용하기 위한 전력이 충분히 공급 될 수 있는지 전기사설을 확인하십시오.

• 전원을 연결할 때에는 반드시 전지된 소켓에 하셔야합니다.

• 전원 연결장치를 사용하실 때에는 반드시 최소 10A의 접지된 것이어야 합니다.

 • 본 제품은 가정용으로 제조되었습니다. 다음과 같은 장소에서 사용 되었을 경우는, 품질 보증 혜택을 받으실 수 없습니다.

- 가게, 사무실 및 다른 영업적인 환경

- 농장 시설

- 음식점 및 레스토랑 (아침 및 저녁식사 형태 제공)

- 호텔, 모텔 및 기타 숙박시설 내에서 고객 접대용

사고를 예방하기 위해

전기제품을 사용할 때에는 다음의 기본적인 안전상 주의사항을 준수해 주십시오.

준수사항

• 사용설명서를 주의깊게 읽어주십시오.

• 토스터는 항상 똑바로 세워서 사용해 주십시오.

 • 제품 사용 전 빵부스러기받이를 비워주십시오.

• 정기적으로 빵 부스러기받이를 비워주십시오.

• 빵 올림, 내림 손잡이는 전원을 연결하거나 전원코드를 콘센트에서 빼기 전에 반드시 위로 향해있도록 하십시오.

• 제품을 사용한 후, 또는 세척 전에 반드시 전원 코드를 빼 주십시오. 세척이나 보관 전에는 제품을 완전히 식혀주십시오.

• 빵이 투입구에 걸려 나오지 않거나 열선이 꺼지지 않을경우, 즉시 전원코드를 빼고 제품이 완전히 식을 때까지 기다린 후에 빵을 꺼내십시오.

• 토스트 시간이 끝난 후에는 코드를 전원장치에서 빼 주십시오.

• 토스터는 안정되고 열에 강한 바닥위에 두고 사용하시고, 물이 튀지 않도록 주의하십시오. 화재의 위험이 있으므로 제품을 커튼이나 선반 밑과 같이 가연성이 있는 물체 옆에 두지 마십시오.

주의: 다음의 사항을 주의하여 주십시오.

• 전원코드와 전원 플러그를 제품의 빵 투입구에 넣지 마십시오.

• 전원코드를 잡아당겨 콘센트에서 빼지 마십시오. 전원플러그를 잡고 빼주십시오.

• 사용 중일 때에는 제품을 운반하지 마십시오.

- 본 제품은 감각기관 또는 지적능력이 부족한 사람(아동포함) 또는 경험과 지식이 부족한 사람이 사용해서는 안됩니다. 단 보호자의 감독 또는 지도하에서 사용할 경우는 예외입니다. 어린이나 장애우가 사용 중일 때에는 반드시 주의 깊게 지켜봐 주십시오.

- 어린이가 제품을 가지고 장난치지 않도록 주의 깊게 지켜봐 주십시오.

- 제품이 작동 중일 때, 특히 처음 사용하시거나 제품의 설정을 변경하였을 경우에는 제품을 방치하지 마십시오.
- 빵을 굽는 이외의 용도로 사용하지 마십시오.
- 너무 두꺼운 빵, 금속 호일 등을 토스터에 넣지 마십시오. 전기쇼크 및 화재의 위험이 있습니다.
- 본 제품에 포함되지 않은 다른 제품용 부속품을 사용하지 마십시오.

- 전기 쇼크를 방지하기 위해서 코드, 플러그 또는 토스터를 물 또는 기타 액체에 담그지 마십시오.

- 설탕이 입혀진 빵은 설탕이 녹아내릴 수 있으므로 토스트하지 마십시오. 매우 작은 조각의 빵이나 샐러드 장식용의 작은 빵은 제품의 기능을 손상시키거나 화재를 유발할 수 있으므로 토스트하지 마십시오.

- 너무 두꺼운 빵은 제품에 걸려 문제가 발생할 수 있습니다.

- 다음과 같은 경우에는 제출을 사용하지 마시고, 당사 서비스센터(1588-1588)에 의뢰하십시오.
 - 전원코드가 손상된 경우
 - 제품을 떨어뜨렸거나 손상되었거나 작동상에 문제가 있는 경우
- 전원코드가 손상되었을 경우 위험상황을 방지하기 위해 자사 서비스센터에 의뢰하여 주십시오.
- 제품의 전원코드를 늘어뜨려 놓거나, 제품의 뜨거운 부분에 닿지 않도록 주의하십시오.
- 실외에서 사용을 하지마시고, 습기찬 환경을 피해주십시오.

- 제품을 가스, 전기버너, 가열된 오븐 등 전열기 옆에 두지 마십시오.

- 먼지방지 뚜껑을 닫은 상태에서 제품을 동작시키지 마십시오.

- 화재의 위험이 있으므로, 벽이나 선반아래 혹은 블라인드나 커튼과 같은 가연성이 있는 물체 근처에는 제품을 작동시키지 마십시오.

- 종이나 플라스틱을 토스터 안이나 위, 아래에 두지 마십시오.

- 토스터에서 불이 날 경우 절대로 물로 끄려고 하지 마십시오. 젖은 헝겊으로 불꽃을 약하게 하십시오.

- 토스트 중일 때에는 빵을 꺼내지 마십시오.

- 본 제품을 전열기로 사용하지 마십시오.

- 냉동 식품의 가열, 그릴, 해동을 위해 제품을 사용하지 마십시오.

- 토스트 기능과 크로와상 데우기 기능을 동시에 사용하지 마십시오. (모델에 따라 다름)

- 제품의 금속 부분이 매우 뜨거울 수 있습니다. 손으로 만지지 말고, 집게나 장갑을 이용하십시오.

- 세척시에는 연마제, 철 수세미, 금속성 기구 등을 사용하지 마십시오.

본 사용설명서를 잘 보관하십시오.

환경보호



- ① 본 제품은 재활용이 가능한 부품들을 포함하고 있습니다.

- ➡ 환경 보호를 위해 분리 수거해 주십시오.

만약 제품에 이상이 있거나 문의가 있으시면 대우 일렉서비스 센터(1588-1588)로 연락하십시오.

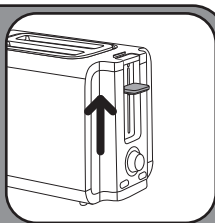
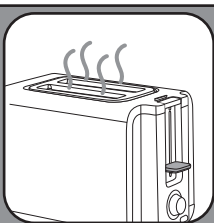
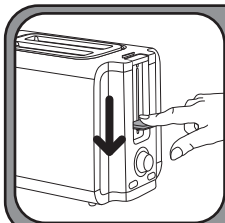
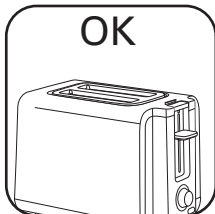
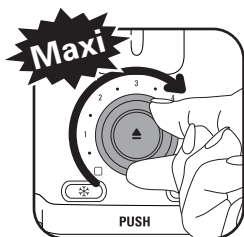
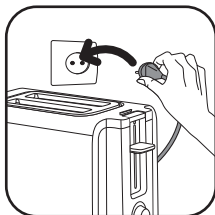
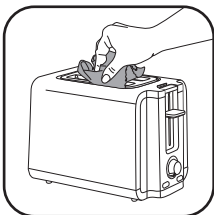
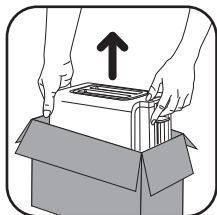
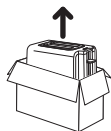

x3

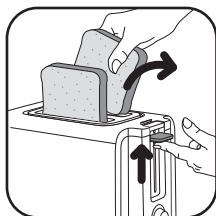
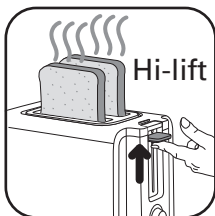
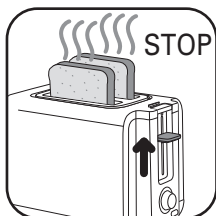
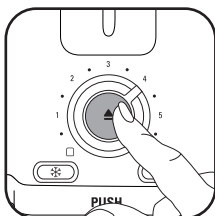
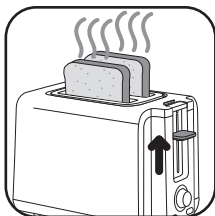
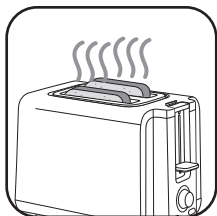
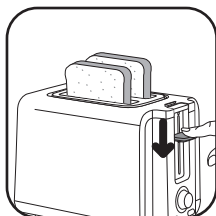
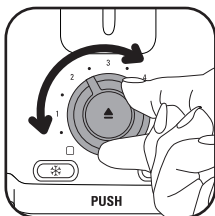
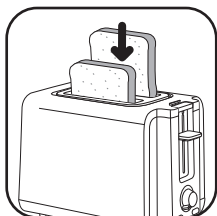

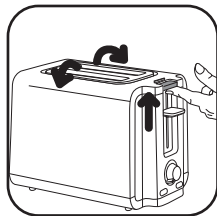
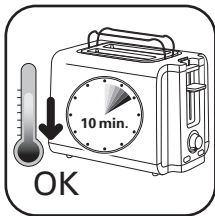
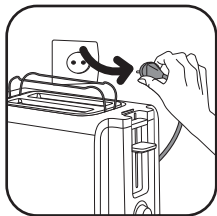
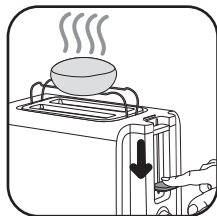
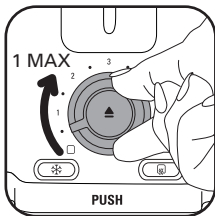
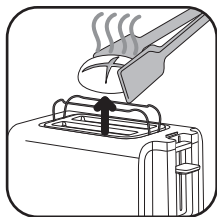
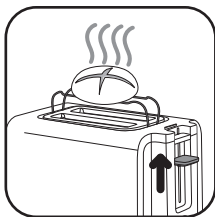
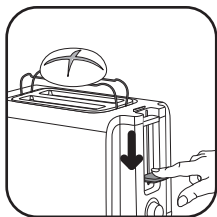
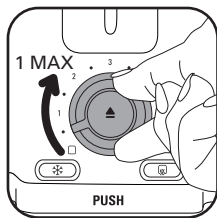
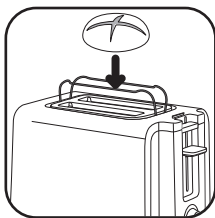
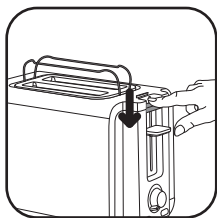

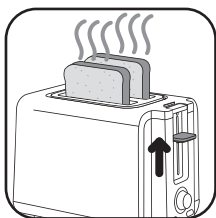
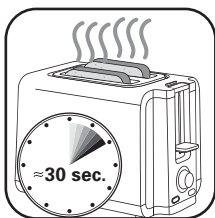
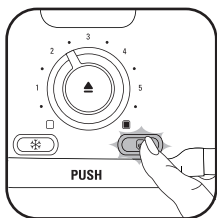
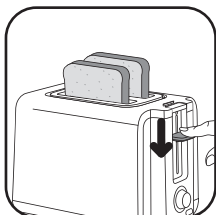
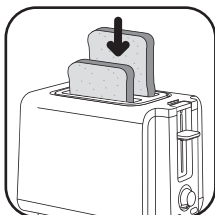
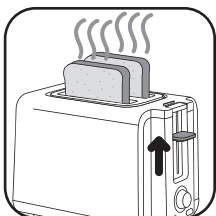
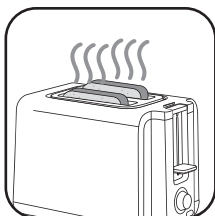
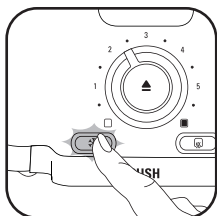
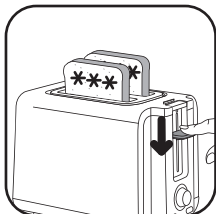
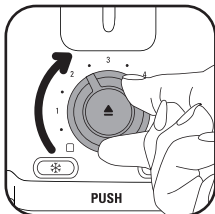
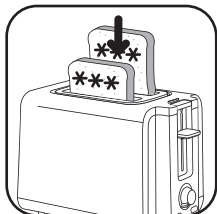

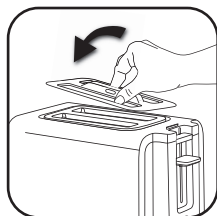
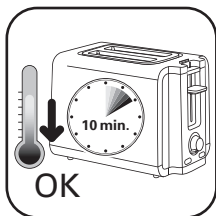
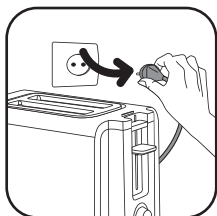

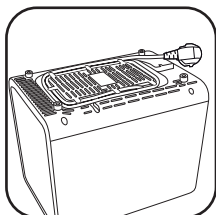
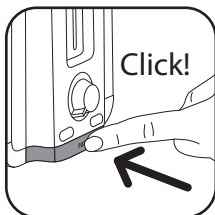
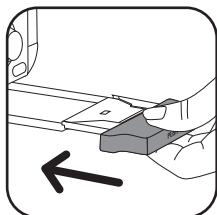
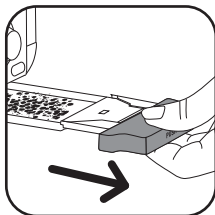
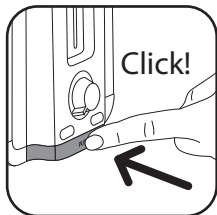
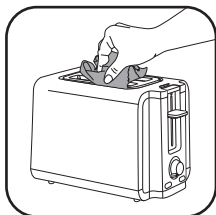
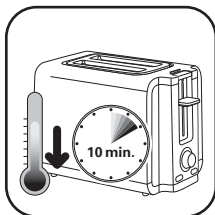
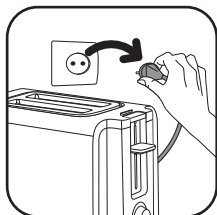
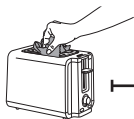



www.rowenta.com