

Installation Instructions

for use by heating contractor



Bypass Cartridge (with integrated check valve)

Part Number: 7828756 Bypass cartridge
7828757 Flow check valve

For use with: Vitodens 100-W, WB1B CombiPlus, B1HA and B1KA

Safety and Installation Requirements

Please ensure that these instructions are read and understood before starting any service work. Failure to comply with these instructions may cause product/property damage, severe personal injury and/or loss of life.

Working on the equipment

The installation, adjustment, service and maintenance of this product must be performed by a licensed professional heating contractor who is qualified and experienced in the installation, service, and maintenance of hot water boilers. There are no user serviceable parts on the boiler, burner or control.

Ensure that main power to the equipment being serviced is off.

Ensure that the main fuel supply valve to the boiler is closed.

Take precautions to avoid accidental activation of power or fuel during service work.

Do not perform service work on any component part without ensuring safe operation of the heating system. When replacing parts, use original Viessmann or Viessmann approved replacement parts.



Refer to the Installation and Service Instructions applicable to this boiler.

Removing the Front Panel

Vitodens 100-W B1HA and B1KA

1. Loosen retaining screws (do not remove completely).
2. Remove front panel.

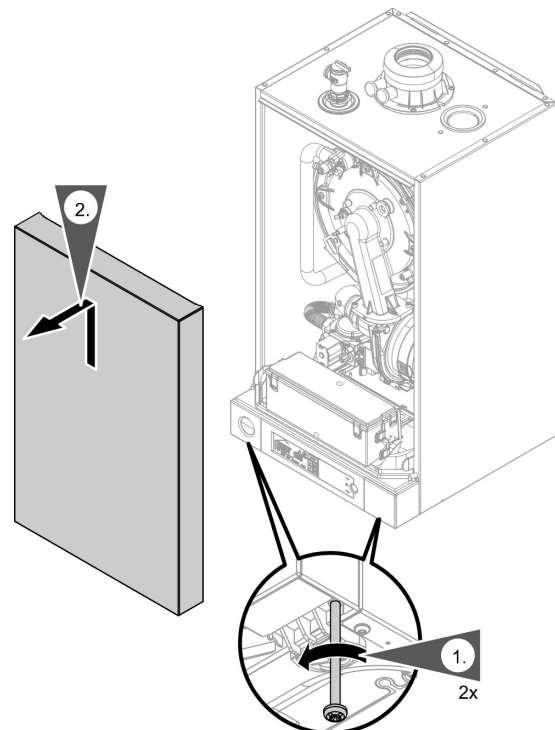

Replacing the Bypass Cartridge (WB1B CombiPlus)

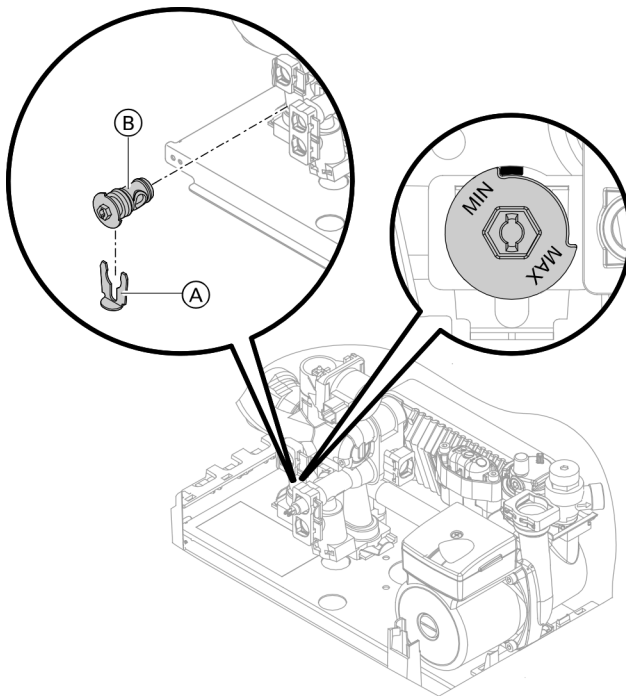

1. Isolate or drain water from the heat exchanger to the CombiPlus.

IMPORTANT

Residual water may leak out during disassembly.

2. Remove CombiPlus cover.
3. Use needle nose pliers to remove clip (A). Then remove the bypass cartridge (B).
4. Install the new bypass cartridge (B) and reinstall clip (A).
5. Set bypass cartridge (B) to "MIN".
6. Reassemble the CombiPlus cover and boiler.
7. Fill boiler with water, purge air and test for levels.



For more details refer to the Installation and Service Instructions applicable to this boiler.



WARNING

Gas leaks can lead to explosions.
Check the gas pipe seals to ensure that there are no leaks.

Replacing the Bypass Cartridge and Check Valve (B1HA and B1KA)

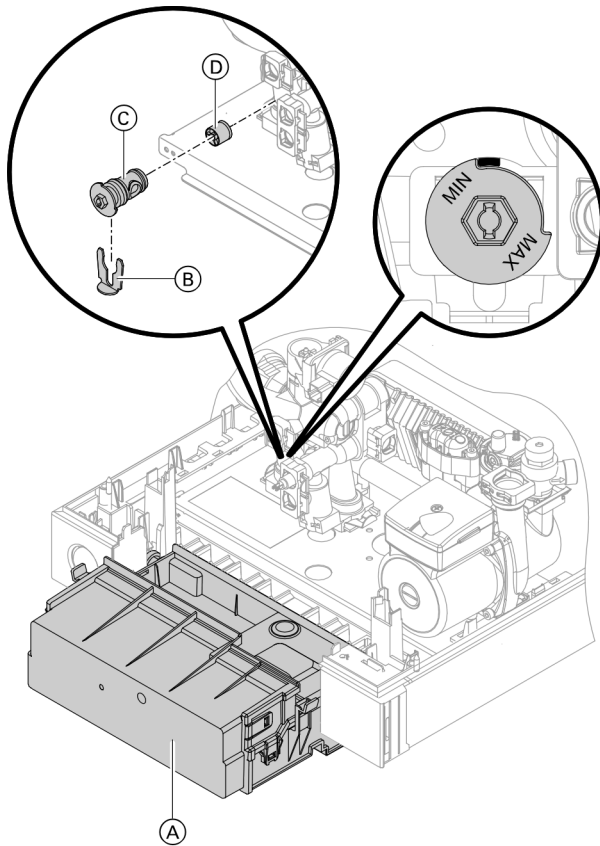

1. Isolate or drain the water from the heat exchanger.

IMPORTANT

Residual water may leak out during disassembly.

2. Press the retaining tabs and fold down the control (A).
3. Use needle nose pliers to remove clip (B). Remove bypass cartridge (C) and flow check valve (D).
4. Inspect flow check valve (D) for contamination and functionality. Replace if necessary.
5. Install new bypass cartridge (C) with flow check valve (D) and reinstall clip (B).
6. Set bypass cartridge (C) to 'MIN'.
7. Reassemble boiler.
8. Fill boiler with water, purge air and test for leaks.



For more details refer to the Installation and Service Instructions applicable to this boiler.



WARNING

Gas leaks can lead to explosions.
Check the gas pipe seals to ensure that there are no leaks.

Reinstalling the Front Panel

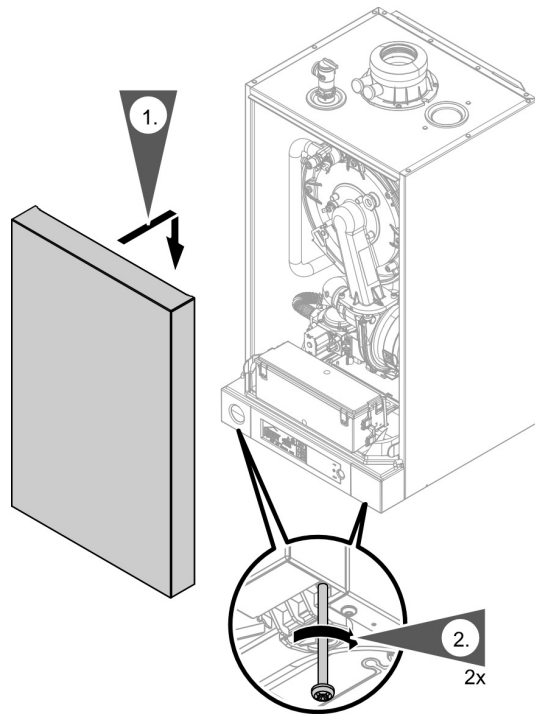

Vitodens 100-W B1HA and B1KA

1. Install the front panel.
2. Tighten the screws at the bottom of the boiler.