



SUB SUB Master L&R L&R  
Frequency Volume Volume Treble Bass

Short Press: Pause/Play  
Long Press: Power on/Off

Product Parameter

Product Model :XY-S220H  
BT Version :5.0  
Audio Input :AUX + BT +USB Flash /  
USB Sound Card  
Channel :2.1  
Chip :TDA7498E  
Adaptive power supply :DC 12~36 V  
Output Power : 160W\*2+220W  
(PMPO)

STEPS FOR USAGE

STEP1:Connect the speakers and power to the amplifier board first, then power up.

STEP2:Turn on the Bluetooth function of the mobile phone, then find the playback device named "XinYi" in the Bluetooth list of the mobile phone and connect it. As shown on the right

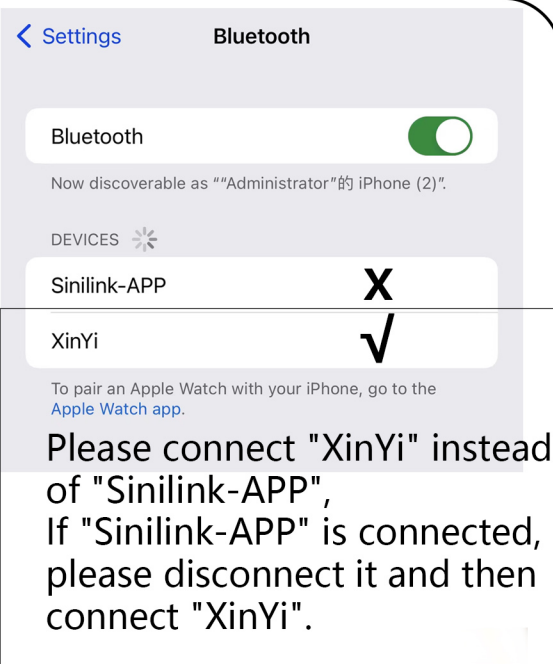

Please connect "XinYi" instead of "Sinilink-APP",  
If "Sinilink-APP" is connected,  
please disconnect it and then  
connect "XinYi".

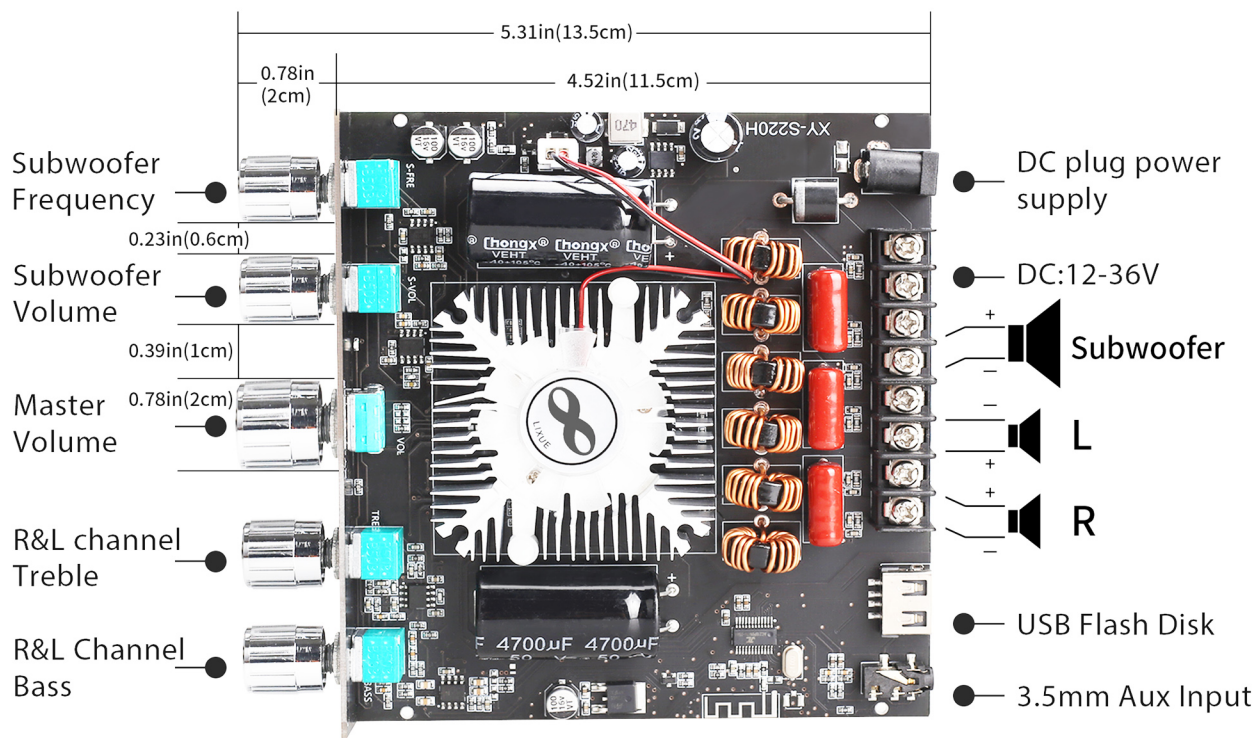

## APP INSTRUCTIONS

Step 1: Download "sinilink" APP through Google Play or Apple APP Store

Step 2: Use your email to register your personal account.

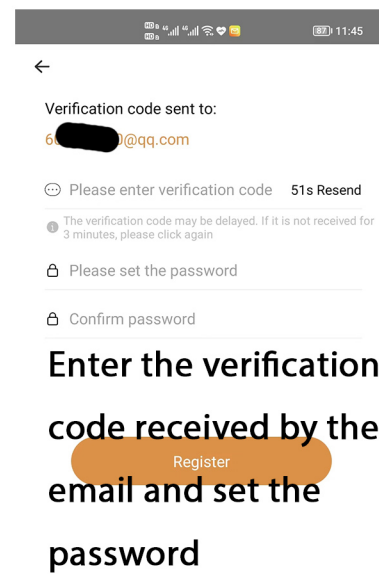
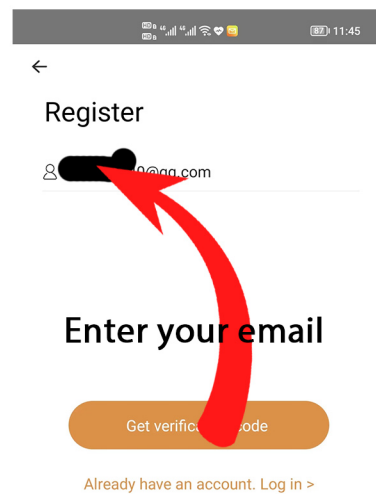
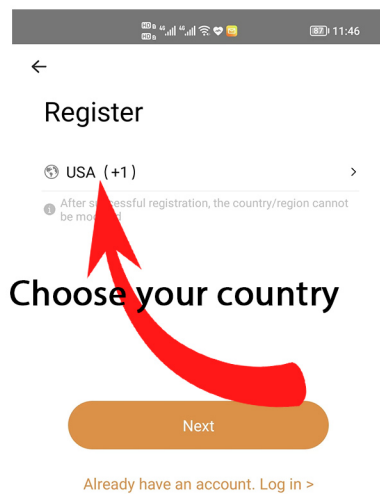
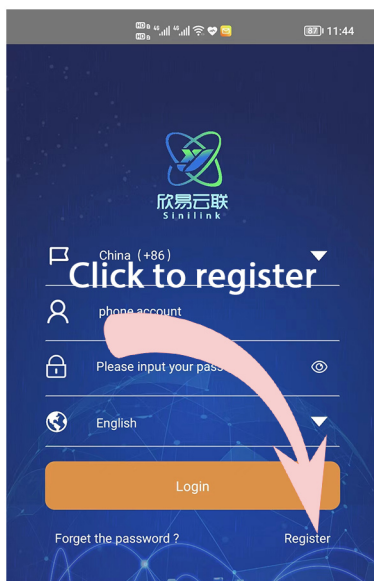

## Step 3: Add a Bluetooth Device

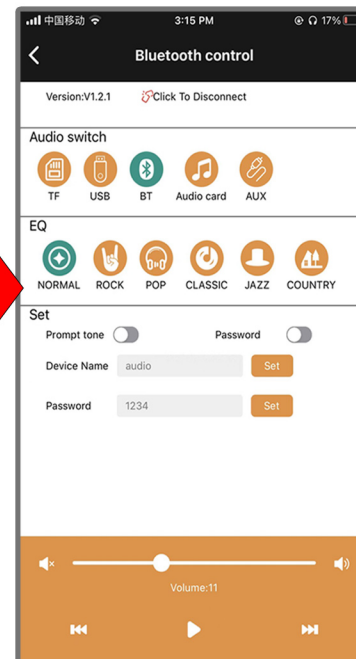
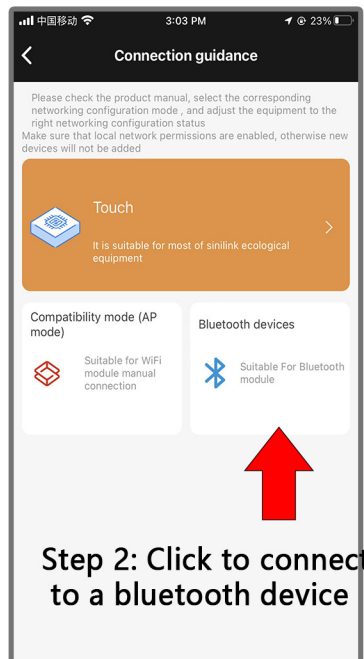

## NOTE:

1. When using the APP, please turn on all the permissions required by the APP in the mobile phone settings, otherwise some mobile phones will have compatibility problems, resulting in the failure of Bluetooth connection.
2. After starting the APP, you need to create an account with your email address. It is not recommended to use a mobile phone number, because you may not receive a verification code when you register with a mobile phone number.
3. If you encounter technical problems or fail to download the APP, please contact our technical team: [andre@uwaykey.com](mailto:andre@uwaykey.com), we will assist you to solve the problem.

When using the APP, please turn on the location information of the mobile phone.

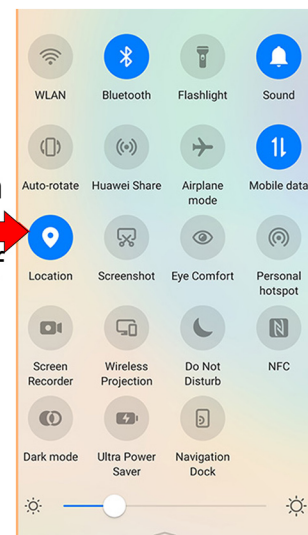

## 1. Audio input mode switch

### 1) AUDIO INPUT MODE SWITCH

**POWER-ON FOR THE FIRST TIME:** When the product is powered on without any external audio device, the default is Bluetooth mode; if an external playback device is mounted, such as inserting an AUX or USB Flash disk, the power-on default is AUX or USB Flash disk mode; during playback, follow The principle of rear plug-in device priority. For example, when AUX is inserted during Bluetooth playback, it will be switched to AUX playback immediately; if a USB Flash disk is inserted, it will be switched to USB Flash disk playback immediately; the audio mode can also be switched by APP, which is very convenient.

**2) PLAY MODE MEMORY:** when the power is turned off in the Bluetooth play mode, the next time the power is turned on, it will still enter the Bluetooth play mode; when the power is cut off in the AUX play mode, the next power on will already enter the AUX mode, if the AUX does not exist, it will automatically enter the Bluetooth play mode.

**Audio switching:** You can use hardware switching, that is, the plug-in device will play first; you can also use APP switching.

When using the USB sound card function, just use the USB data cable to connect to the computer, no need to install any driver, most computer systems will switch the USB sound card by default, if it cannot be automatically switched, you can manually select the switch

## 2. How to choose a power supply?

The power supply range of this product is 12V-36VDC, and it is compatible with standard 5.5-2.1/2.5 power adapter plugs. It is recommended to use a 24V/36V standard power adapter with a current output of more than 10A.

1) The power of the power supply must be greater than the sum of the power of the speakers.

2) The power supply voltage is recommended cannot be higher than 36V, if higher than 38V, the circuit board will be burned.

3) For 4  $\Omega$  speakers, it is recommended to use 36V10A power supply; for 8 ohm speakers, it is recommended to use 36V8A power supply

4) When using 24V and below power supply, the volume must not be turned on to the maximum, and the sound will be distorted when the volume is turned on to the maximum.

Notice:

The output power in the above power output comparison table is the instantaneous peak power (PMPO).

Based on the frequency of 1khz, and according to the regular sine wave calculation,

$RMS \approx PMPO * 0.707$ . The waveform of the sound is irregular, and at the same time, the output power is also affected by many other factors, such as the level of the input signal, the actual heat dissipation effect of the chip, etc., so the calculation method also has certain limitations. The results can only be used as a reference and cannot be completely relied on the algorithm.



### 3. How to choose speakers?

Left and right channel speakers

The left and right channels can continuously output 160W\*2 power, and 20W~200W speakers can be driven. It is recommended to use 4-8Ω full-range speakers.

Subwoofer

The subwoofer channel can continuously output 220W of power, and the speakers of 30-300W can be driven. It is recommended to use a 3-8Ω woofer, and the frequency of 20Hz-200Hz is the best.

If the continuous output power of the speaker is lower than that of the power amplifier, the power supply voltage can be appropriately reduced, or the volume can be reduced to avoid distortion caused by the output power of the power amplifier being greater than the power of the speaker. If multiple speakers are used in parallel, the impedance of the speakers connected to the left and right channels must be more than 4 ohms, and the impedance of speakers connected to the subwoofer must be controlled to more than 3 ohms. If the impedance is too small, the power amplifier will easily enter the overcurrent protection. state.

It is not recommended to use 2 ohm speakers. The impedance is too low and the current is too large. The power amplifier is easy to enter the overcurrent protection state. If it must be used, be sure to turn down the volume and reduce the output power.

### 4. About the Bluetooth signal

This product uses a PCB antenna, in the case of no blocking, the visual distance of the connection can be to 49 feet. If you can't find Bluetooth during use, or can't connect to Bluetooth, it is considered a signal problem.

- 1)** Be sure to stay away from the router when using it.
- 2)** Avoid using it on the metal table, the metal table will affect the PCB antenna signal
- 3)** If the power amplifier board is placed in a metal box, the metal will shield the Bluetooth signal, and an external antenna must be connected at this time.

### PAY ATTENTION:

If you use a USB flash memory disk , the capacity of the USB flash memory disk is less than or equal to 32GB, and the format of the USB flash memory disk is FAT32.

If you encounter technical problems that cannot be solved, please send your questions to our technical team: [andre@uwaykey.com](mailto:andre@uwaykey.com), we will do our best to solve the problem for you.