

YEEDI C12 Floor Cleaning Robot



YEEDI C12 Floor Cleaning Robot Instruction Manual

[Home](#) » [yeedi](#) » YEEDI C12 Floor Cleaning Robot Instruction Manual 

Contents

- 1 YEEDI C12 Floor Cleaning Robot
- 2 Important Safety Instructions
- 3 FCC
- 4 PACKAGE CONTENTS
- 5 PRODUCT DIAGRAM
- 6 QUICK START
- 7 CONNECT ROBOT WITH APP
- 8 TECHNICAL SPECIFICATIONS
- 9 CONTACT
- 10 Documents / Resources
 - 10.1 References

YEEDI

YEEDI C12 Floor Cleaning Robot



Important Safety Instructions

IMPORTANT SAFETY INSTRUCTIONS READ ALL INSTRUCTIONS BEFORE USING THIS APPLIANCE. When using an electrical appliance, basic precautions should always be followed, including the following:

WARNING: Read all safety warnings and instructions. Failure to follow the warnings and instructions may result in electric shock, fire or serious injury.



1. Do not allow to be used as a toy. Close attention is necessary when used by or near children.
2. Clear the area to be cleaned. Remove power cords and small objects from the floor that could entangle the Appliance. Tuck rug fringe under the rug base, and lift items such as curtains and tablecloths off the floor.
3. If there is a drop off in the cleaning area due to a step or stairs, you should operate the Appliance to ensure that it can detect the step without falling over the edge. It may become necessary to place a physical barrier at the edge to keep the unit from falling. Make sure the physical barrier is not a trip hazard.
4. Only use as described in this manual. Only use attachments recommended or sold by the manufacturer.
5. Please make sure your power supply voltage matches the power voltage marked on the Docking Station.
6. Do not handle plug or appliance with wet hands.
7. Non-rechargeable batteries are prohibited.
8. Do not use without dust bin and/or filters in place.
9. Do not operate the vacuum in an area where there are lit candles or fragile objects on the floor to be cleaned.
10. Do not use and store in extremely hot or cold environments (below -5°C / 23°F or above 40°C / 104°F). Please charge the robot in temperature above 0°C / 32°F and below 40°C / 104°F .
11. Keep hair, loose clothing, fingers, and all parts of body away from any openings and moving parts.
12. Do not operate the Appliance in a room where an infant or child is sleeping.

13. For INDOOR use ONLY. Do not use the Appliance in outdoor, commercial or industrial environments. Do not use Appliance on wet surfaces or surfaces with standing water.
14. Do not allow the Appliance to pick up large objects like stones, large pieces of paper or any item that may clog the Appliance.
15. Do not use Appliance to pick up flammable or combustible materials such as gasoline, printer or copier toner, or use in areas where they may be present.
16. Do not use Appliance to pick up anything that is burning or smoking, such as cigarettes, matches, hot ashes, or anything that could cause a fire.
17. Do not put any object into openings. Do not use with any opening blocked; keep free of dust, lint, hair, and anything that may reduce air flow.
18. Take care not to damage the power cord. Do not pull on or carry the Appliance or Docking Station by the power cord, use the power cord as a handle, close a door on the power cord, or pull power cord around sharp edges or corners. Do not run Appliance over the power cord. Keep power cord away from hot surfaces. Do not unplug by pulling on cord. To unplug, grasp the plug, not the cord.
19. If the power cord is damaged, it must be replaced by the manufacturer or its service agent in order to avoid a hazard.
20. Do not use the Docking Station if it is damaged.
21. Do not use with a damaged power cord or plug. Do not use the Appliance or Docking Station if it is not working properly, has been dropped, damaged, left outdoors, or come in contact with water. It must be repaired by the manufacturer or its service agent in order to avoid a hazard.
22. Turn OFF the power switch before cleaning or maintaining the Appliance. Turn off all controls before unplugging. Always turn off this appliance before connecting or disconnecting motorized nozzle.
23. The plug must be removed from the receptacle before cleaning or maintaining the Docking Station.
24. Remove the Appliance from the Docking Station, and turn OFF the power switch to the Appliance before removing the battery for disposal of the Appliance.
25. The battery must be removed and discarded according to local laws and regulations before disposal of the Appliance.
26. Please dispose of used batteries according to local laws and regulations.
27. Do not incinerate the Appliance even if it is severely damaged. The batteries can explode in a fire.
28. When not using the Docking Station for a long period, please unplug it.
29. The Appliance must be used by the directions in this Instruction Manual. ECOVACS ROBOTICS cannot be held liable or responsible for any damages or injuries caused by improper use.
30. Prevent unintentional starting. Ensure the switch is in the off position before connecting to the battery pack, picking up or carrying the appliance.
31. When battery pack is not in use, keep it away from other metal objects, like paper clips, coins, keys, nails, screws or other small metal objects, that can make a connection from one terminal to another. Shorting the battery terminals together may cause burns or a fire.
32. Under abusive conditions, liquid may be ejected from the battery; avoid contact. If contact accidentally occurs, flush with water. If liquid contacts the eyes, additionally seek medical help. Liquid ejected from the battery may cause irritation or burns.
33. Do not use a battery pack or appliance that is damaged or modified. Damaged or modified batteries may exhibit unpredictable behaviour resulting in fire, explosion or risk of injury.
34. Do not expose a battery pack or appliance to fire or excessive temperature. Exposure to fire or temperature

- above 130°C may cause an explosion. The temperature of 130°C can be replaced by the temperature of 265°F.
35. Follow all charging instructions and do not charge the battery pack or appliance outside of the temperature range specified in the instructions. Charging improperly or at temperatures outside of the specified range may damage the battery and increase the risk of fire.
 36. Have servicing performed by a qualified repair person using only identical replacement parts. This will ensure that the safety of the product is maintained.
 37. Do not modify or attempt to repair the appliance or the battery pack (as applicable) except as indicated in the instructions for use and care.
 38. Place the cords from other appliances out of the area to be cleaned.
 39. Do not operate the vacuum in a room that has lit candles on furniture that the vacuum may accidentally hit or bump into.
 40. Do not allow children to sit on the vacuum.
 41. Use only as described in this manual. Use only the manufacturer's recommended attachments.
 42. Recharge only with the charger specified by the manufacturer. A charger that is suitable for one type of battery pack may create a risk of fire when used with another battery pack.
 43. Use appliances only with specifically designated battery packs. Use of any other battery packs may create a risk of injury and fire.
 44. The robot contains batteries that are only replaceable by skilled persons. To replace the robot's battery, please contact Customer Service.
 45. If the robot will not be used for a long time, fully charge the robot power OFF for storage and unplug the Docking Station.
 46. To Reduce The Risk Of Electric Shock – Do not use on wet surfaces. Do not be exposed to rain. Store indoors.
 47. To Reduce The Risk Of Injury From Moving Parts – Unplug Before Servicing.
 48. Risk Of Injury. Brush May Start Unexpectedly. Unplug Before Cleaning or Servicing.
 49. To reduce the risk of injury, the user must read the instruction manual.
 50. To Reduce The Risk Of Electric Shock – Do not use outdoors or on wet surfaces.

SAVE THESE INSTRUCTIONS For Household use only

To reduce the risk of electric shock, this docking station has a polarized plug (one blade is wider than the other). This plug will fit in a polarised outlet only one way. If the plug does not fit fully in the outlet, reverse the plug. If it still does not fit, contact a qualified electrician to install the proper outlet. Do not change the plug in any way.

	Direct current
	Alternating current

This Device Complies with DHHS Radiation Rules, 21CFR Chapter 1, Subchapter J.

Device Update

- Typically, some devices are updated bi-monthly, but not always so specific.
- Some devices, especially those that went on sale more than three years ago, will only be updated if a critical vulnerability is found and fixed.
- To disable the Wi-Fi module on the robot, power the robot ON. Place the robot on the Docking Station, making

sure the Charging Contacts on the robot and the Docking Station Pins make a connection. Then, double-tap the



button.

- To enable the Wi-Fi module on the robot, power the robot OFF and then back ON. And unplug the Station and plug it in again.

FCC

Federal Communications Commission (FCC) Interference Statement

This equipment has been tested and found to comply with the limits for a Class B digital device, under Part 15 of the FCC Rules. These limits are designed to provide reasonable protection against harmful interference in a residential installation. This equipment generates, uses and can radiate radio frequency energy and, if not installed and used in accordance with the instructions, may cause harmful interference to radio communications. However, there is no guarantee that interference will not occur in a particular installation. If this equipment does cause harmful interference to radio or television reception, which can be determined by turning the equipment off and on, the user is encouraged to try to correct the interference by one of the following measures:

- Reorient or relocate the receiving antenna.
- Increase the separation between the equipment and the receiver.
- Connect the equipment to an outlet on a circuit different from that to which the receiver is connected.
- Consult the dealer or an experienced radio/TV technician for help.

This device complies with Part 15 of the FCC Rules / Industry Canada licence-exempt RSS standard(s).

Operation is subject to the following two conditions:

1. This device may not cause harmful interference, and
2. this device must accept any interference received, including interference that may cause undesired operation.

Caution: Any changes or modifications not expressly approved by the party responsible for compliance could void the user's authority to operate this equipment.

MPE Requirements

To satisfy FCC / IC RF exposure requirements, a separation distance of 20 cm or more should be maintained between the antenna of this device and persons during device operation. To ensure compliance, operations at closer than this distance is not recommended.

PACKAGE CONTENTS

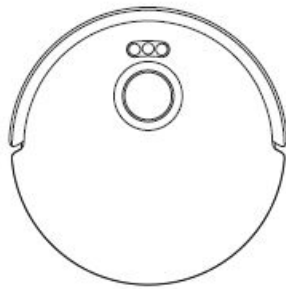

Robot

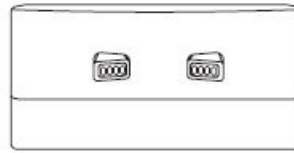

Docking Station

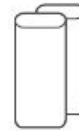

Plugs

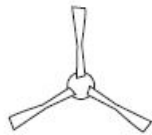

Side Brush



Instruction Manual

Water Tank and Mopping Pad Module



Reservoir
(pre-installed)



Mopping Pad Plate



Washable
Mopping Pad

Note: Figures and illustrations are for reference only and may differ from actual product appearance. Product design and specifications are subject to changes without notice.

PRODUCT DIAGRAM

Robot

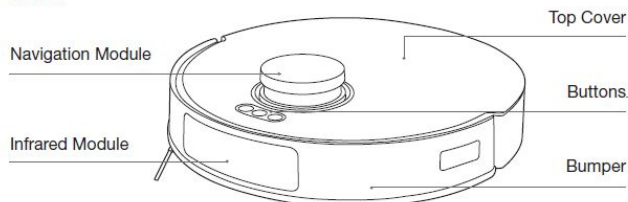

Buttons

- Short Press: Return to charge
- Short Press: Start/Pause/Continue Long Press: Power on/off
- Short Press: Start/End Spot Clean Long Press: Child Lock

RESET Button

Connect APP: Short press RESET button and follow voice prompts to connect to the App.
Restore to default settings: Press and hold RESET Button for 5 s. After you hear the voice prompt, the startup music will be played and the robot will be restored to default settings.

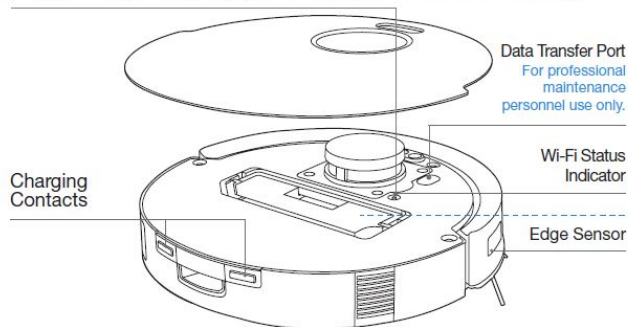

Bottom View

Anti-drop Sensor

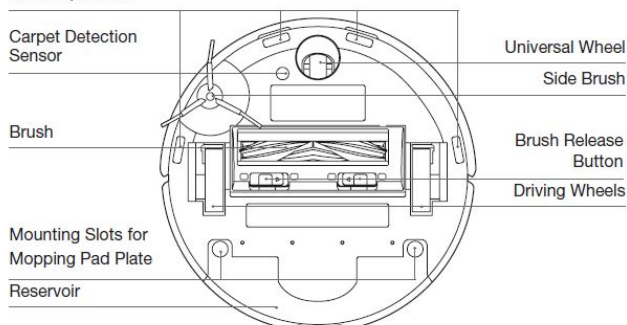

Mopping Pad Module

Mopping Pad Plate

Washable Mopping Pad

Note: Figures and illustrations are for reference only and may differ from actual product appearance. Product design and specifications are subject to changes without notice.

Dust Bin

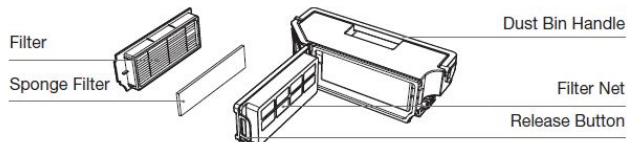

Docking Station

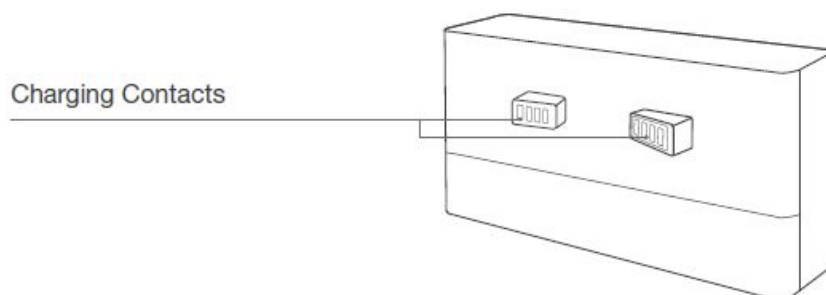

Plug Installation Holes

Cable Trunking

Power Plug

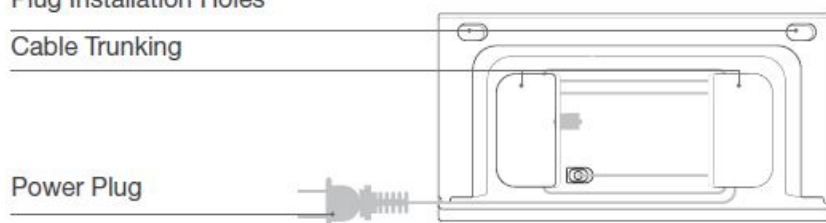

SENSORS

Name	Functional Description
Navigation Module	By utilizing the principle of triangulation, which involves emitting and receiving laser beams reflected by surrounding objects, precise distance measurement information between the robot and nearby objects can be calculated through algorithms. When the robot moves within a certain environment, the positions of surrounding objects are determined to create a spatial map of the robot's surroundings. The measurement range is 0.8 m.
Infrared Module	Use line laser to scan objects and capture images with a monocular camera, then generate the three-dimensional coordinates of the object through image algorithms, thus identifying the spatial size of the object. The measurement range is approx. 0.35 m.
Anti-drop Sensor	With infrared distance measurement, the infrared sensor can detect the distance between the bottom of ROBOT and the ground. ROBOT will not move forward when there are stairs in front or the identified distance exceeds the preset threshold, realizing the Anti-drop. The trigger distance is approx. 60 mm.
Carpet Detection Sensor	The ultrasound probe can emit ultrasonic waves with a frequency of 300KHZ. The energy of the ultrasonic waves is absorbed by the carpet. If the reflected energy is below the threshold, the robot recognizes the presence of the carpet. According to YEEDI lab tests, currently, over 50 types of carpets available on the market can be identified.
Edge Sensor	With infrared distance measurement, ROBOT can detect the distance between itself and objects on its right side. When there is a wall or obstacle on the right side, ROBOT will perform edge cleaning to avoid missing spots or collisions.
Anti-collision Sensor	When the transmitted signal is blocked by an obstacle, the signal receiver will not be able to receive the signal. With this principle, the robot will avoid obstacles when colliding with them.

NOTES BEFORE CLEANING

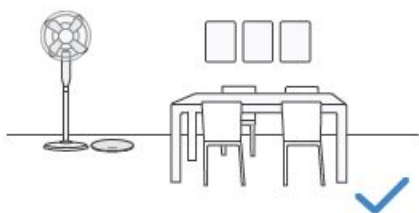

- Tidy up the area to be cleaned by putting furniture, such as chairs, in their proper place.



- During the first use, make sure each room door is open to help ROBOT fully explore your house.

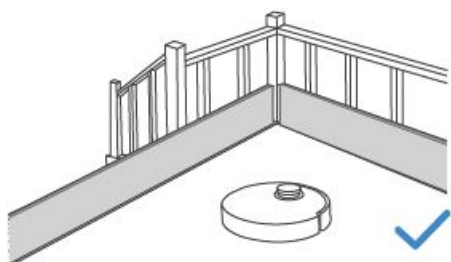

- It may be necessary to place a physical barrier at the edge of a drop to

stop the unit from falling over the edge.



- Put away objects including cables, clothes slippers, etc. on the floor to improve the cleaning efficiency.



- Before using the product on a rug with tasselled edges, please fold the rug edges under.



- Please do not stand in narrow spaces, such as hallways, and make sure not to block sensors.

QUICK START

Please remove all protective materials before use.

1. Installation

- The sound of Clicking indicates proper installation.

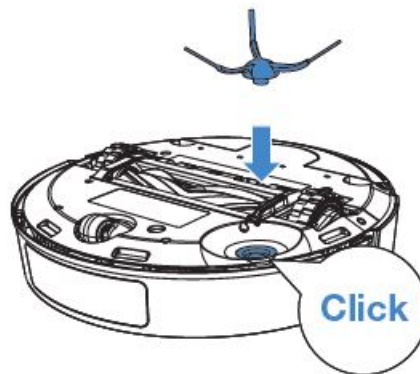

2. Place the Docking Station

- Keep the area around the Docking Station clear of objects, especially objects with reflective surfaces.
- **Note:** It is recommended to place the Docking Station on a hard floor to experience complete robot functions.

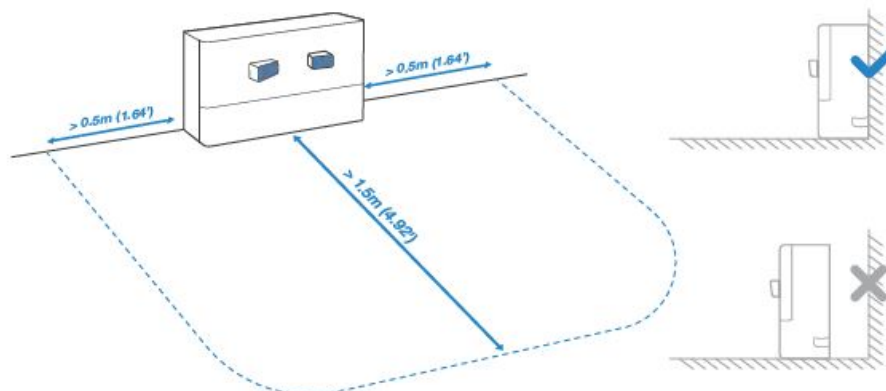

3. Install Plugs (for homes with baseboards)

- Remove the protective sticker and insert the sticky end into the installation holes.

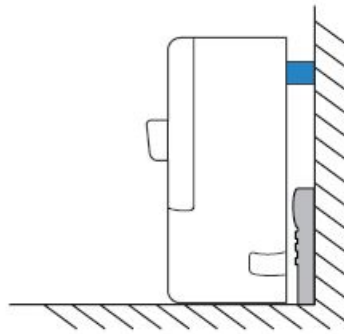
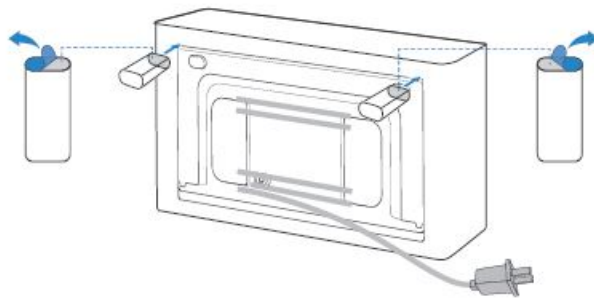

DOWNLOAD THE YEEDI APP

To enjoy all available features, it is recommended to control your robot via the YEEDI App.

1. Scan the QR Code under the Top Cover to download the App.

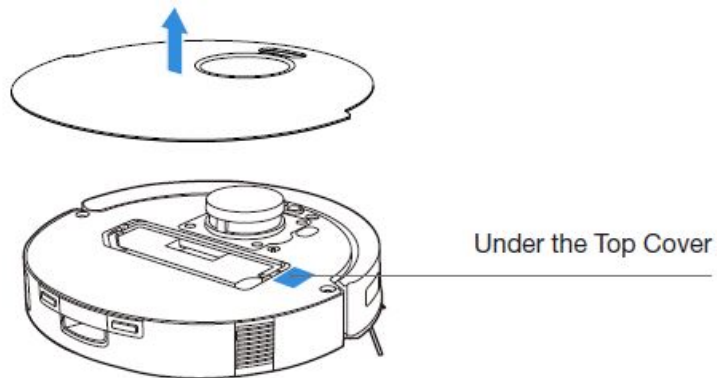

2. Search YEEDI to download the App.



POWER ON ROBOT

- Press and hold  for 3 seconds to power on ROBOT.

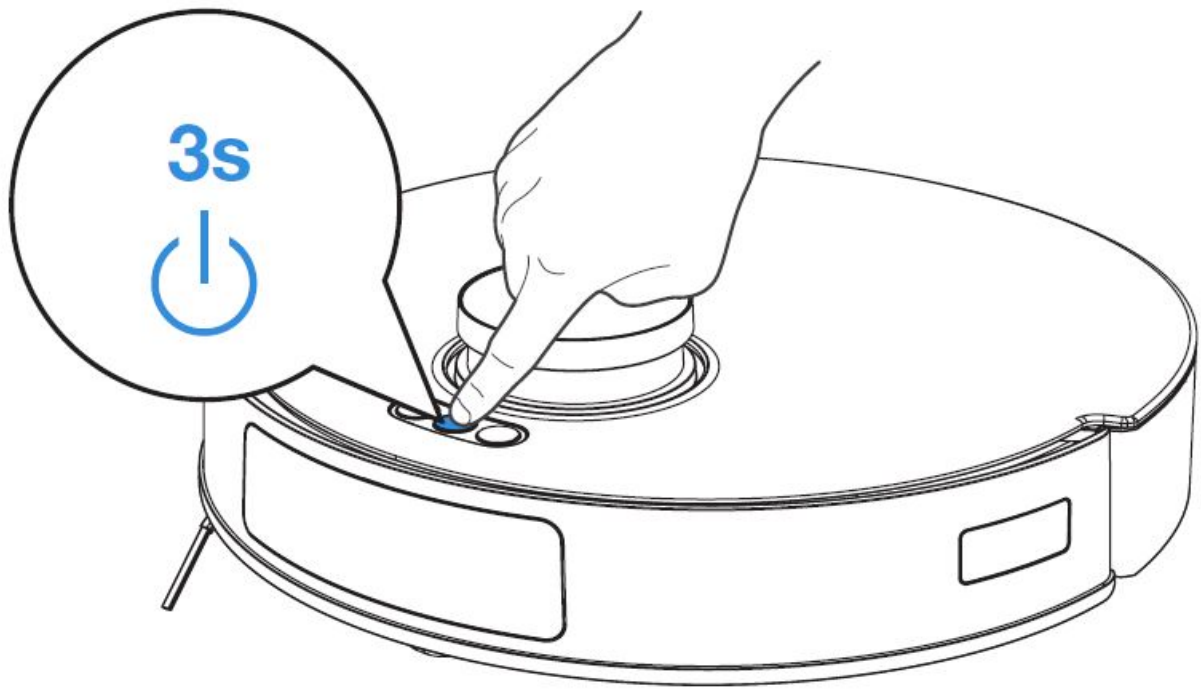

CONNECT ROBOT WITH APP

Wi-Fi Network Requirements:

- You are using a 2.4 GHz or 2.4/5 GHz mixed network.
- Your router supports 802.11b/g/n and IPv4 protocol.
- Do not use a VPN (Virtual Private Network) or Proxy Server.
- Do not use a hidden network.
- WPA and WPA2 using TKIP, PSK, AES/CCMP encryption.
- WEP EAP (Enterprise Authentication Protocol) is not supported.
- Use Wi-Fi channels 1-11 in North America and channels 1-13 outside North America (refer to local regulatory agency).
- If you are using a network extender/repeater, the network name (SSID) and password are the same as your primary network.
- Please enable the WPA2 on your router.

Wi-Fi Indicator

	Flashing slowly	Connecting the App
	Flashing quickly	Disconnected to Wi-Fi
	On	Connected to Wi-Fi

- Please be aware that the realization of intelligent functions such as remote startup, voice interaction, 2D/3D map display and control settings, and personalized cleaning (depending on different products) requires users to download and use the YEEDI App, which is constantly updated.
- You need to agree to our Privacy Policy and User Agreement before we can process some of your basic and

necessary information and enable you to operate the product.

- If you do not agree with our Privacy Policy and User Agreement, some of the aforementioned intelligent functions cannot be realized through the YEEDI App, but you can still use the basic functions of this product for manual operation.

CHARGE ROBOT

- Short press  to recall ROBOT to enter the Docking Station to charge.

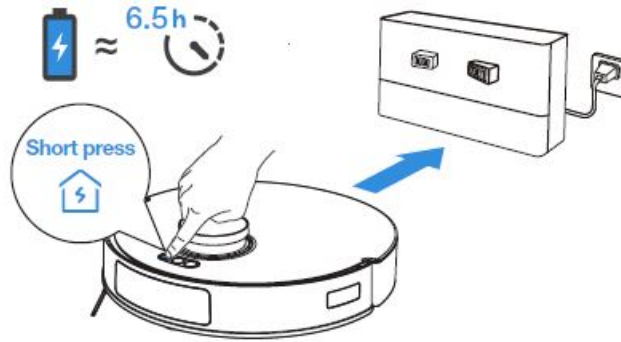

OPERATE ROBOT

Remove the Mopping Pad Plate before mapping. When creating a map for the first time, please follow ROBOT to help eliminate some minor issues. For example, ROBOT may get stuck under the furniture.

Please refer to the following solutions:

1. Raise your low-sitting furniture if possible;
2. Cover the bottom of the furniture;
3. Set up Virtual Boundary via the App.

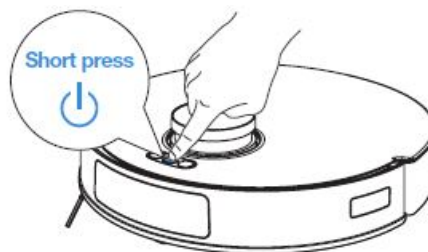

Before first vacuuming, please make sure ROBOT is in the Charging Station and fully charged. Short press  to start cleaning and mapping.



Note:

- Do not frequently remove washable mopping pads.
- Do not use a rag or any other object to scratch the Mopping Pad Plate.
- When the YEEDI App prompts that the mops need to be replaced, please replace them in time. Explore more accessories at the YEEDI App or <https://www.yeedi.com>.

TECHNICAL SPECIFICATIONS

Model	DKX56		
Rated Input	20 V  1 A	Charging Time	6.5 h
Docking Station	CH2405		
Rated Input	100-240 V ~ 50-60 Hz 0.5 A		
Rated Output	20 V  1 A		
ROBOT Dimensions (L*W*H m)	353*351*96		
Docking Station Dimensions (L*W*H mm)	218*73*111		

Note: Technical and design specifications may be changed for continuous product improvement. Explore more accessories at <https://www.yeedi.com>.

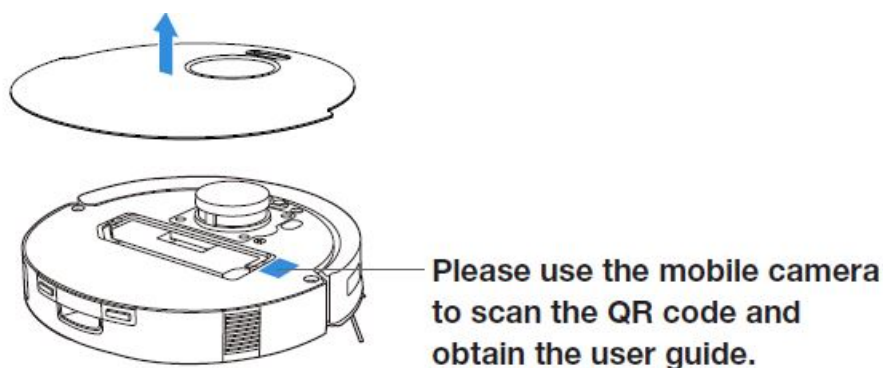

CONTACT

- Ecovacs Home Service Robotics Co., Ltd.
- No.518 Songwei Road, Wusongjiang Industry Park,
- Guoxiang Street, Wuzhong District, Suzhou, Jiangsu, China.

Documents / Resources

	YEEDI C12 Floor Cleaning Robot [pdf] Instruction Manual C12, C12 Floor Cleaning Robot, Floor Cleaning Robot, Cleaning Robot, Robot
---	---

References

- [User Manual](#)

This website is an independent publication and is neither affiliated with nor endorsed by any of the trademark owners. The "Bluetooth®" word mark and logos are registered trademarks owned by Bluetooth SIG, Inc. The "Wi-Fi®" word mark and logos are registered trademarks owned by the Wi-Fi Alliance. Any use of these marks on this website does not imply any affiliation with or endorsement.