



User Manual

WS-2394



Thank you for purchasing the Sami wearable WS-2394 4G GPS SMARTWATCH. Read the instructions carefully to obtain optimum results and preserve it for future reference

1. Getting started

1. Check that the device is the correct model and all accessories are in the box.
2. Prepare a 4G LTE Nano SIM card, can ask for your dealer if have any questions. Necessary to activate data flow, GPRS and caller ID functions. **Please DESACTIVE THE SIM PIN before inserting into the watch.**

2. Insert a SIM card.

1. Please turn off the watch before inserting the SIM Card. **The type of card is Nano size.**
2. Take the SIM tray out.
3. Put the SIM card in the holder and make sure that the card's angle corner fixes the holder. Then gently insert the holder back into device.
4. Please turn off the device before inserting the SIM card. After the SIM card is installed, turn on the device and wait for the signal and data icons to appear in the status bar, indicating that the signal is recognized. If you do not see a signal after installing the SIM card, please turn off the device, check that the SIM card is properly placed, and then turn the device back on.

(If your model does not have a SIM tray, just insert the SIM card into the slot and make sure that the SIM card is in the direction which is shown on the screen protector of device.)

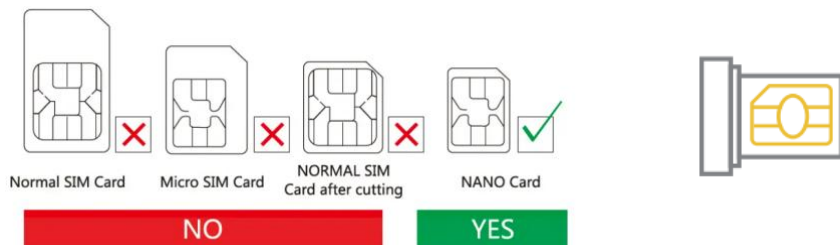

3.Switch on and off

Switch on:

If the device is off the power, long press the power button for 3~5 seconds to turn on.

Switch off:

- 1: Enter the settings of device, choose the shut down option.
- 2: When the device is crashed, you can use remote shut down on the PC or Mobile client.
- 3: When there is not a SIM card, long press the power button to turn the device.

4.Charging the device

1. When you receive the low battery notification from device or the phone app, please charge the device in time.
2. When battery is under 15%, device will turn into the power saving mode and functions are restricted except the incoming call answer.
3. During charging, the device will turn into restricted mode and please do not use.

Charging

Connect the metal contacts on the charging port to those on the back of the device, then put them on a flat surface. Connect the charging cradle to a power supply, the device's screen will light up and display the process of charging.

CAUTION: The metal contacts and charging port is magnetic. Please keep it away from other metal in avoid of accidental short circuit.

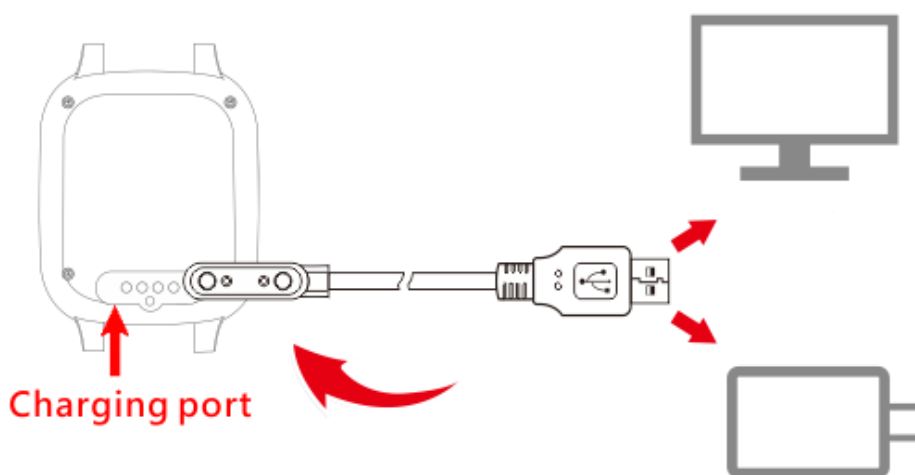

- The charging dock is not water resistant. Wipe the port, metal contacts, and the device dry during charging.
- Long press the power button over 20s to active the battery when the device is fully charged after not used for long time.

5.Product diagram

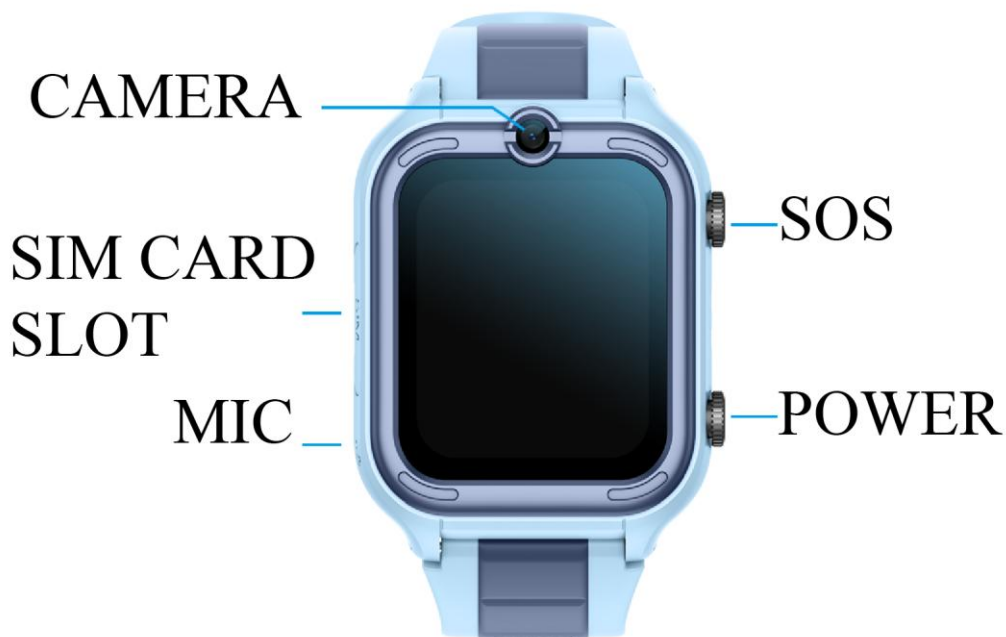

6.APP USING

6.1 Get the app

Scan the QR code below to download the APP or tap the device information on the watch menu and find the download QR code to scan and download.



6.2 Register and login in.

Please follow the steps in the APP to register and login in.

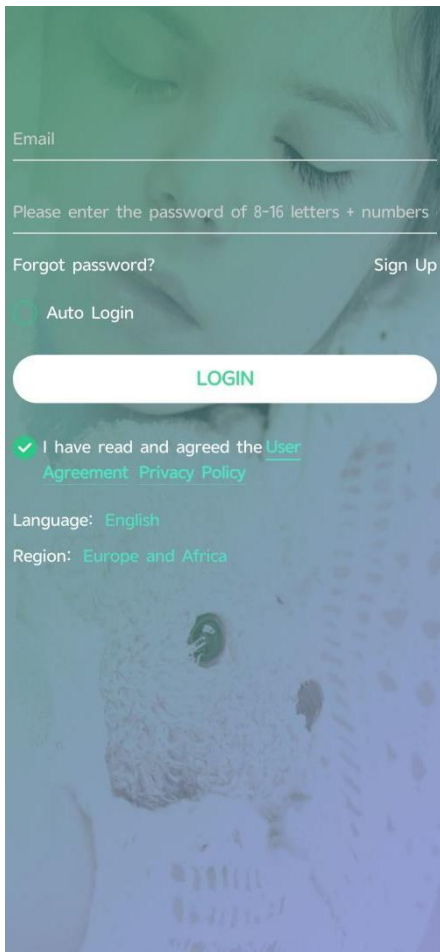

Email

Please enter the password of 8-16 letters + numbers

Forgot password? Sign Up

☐ Auto Login

LOGIN

✓ I have read and agreed the [User Agreement](#) [Privacy Policy](#)

Language: [English](#)

Region: [Europe and Africa](#)

< Register

Please Input Your Email

Please Enter Verification Code **MHE72Z** 

Please enter the password of 8-16 letters + numbers 

CONFIRM REGISTRATION

✓ I have read and agreed the [User Agreement](#) [Privacy Policy](#)

Language: [English](#)

Region: [Europe and Africa](#)

6.3 Bind with the device.

Login in the APP and find the correct device. The correct device type is SMART WATCH. Enter the registration code to bind with device.

About the registration code:

- (1) Scan the QR code on the back of device or manually enter the 15 numbers length code
- (2) Enter the device information page and find the registration code, scan or manual input.

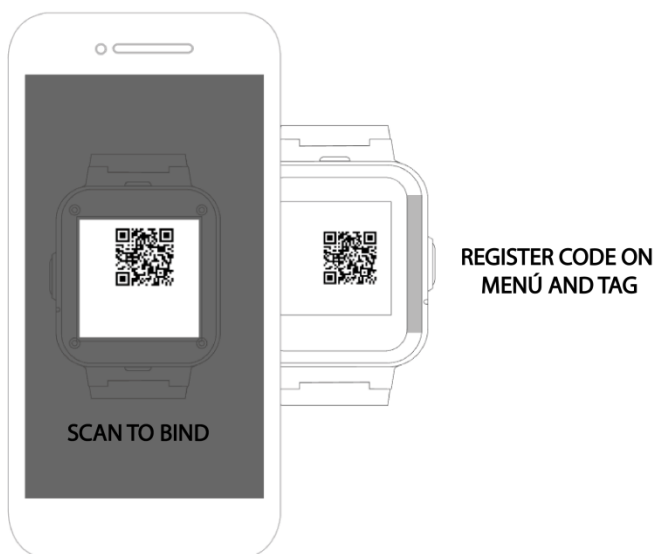

6.4 Account bind and management

- Upon initial binding with the device, the associated account is automatically designated as the admin.

- For guest accounts seeking to bind with and manage the device, admin approval is required.
- Admins can review and approve guest requests by receiving notifications on the pairing page of the phone app.
- **If you are going to stop using the watch or give it to someone., please UNBIND from the APP so the other user can bind it again.**

7.Functions

Location: GPS+LBS +WIFI 3 tracking method. The device uses the 3 different ways depending on the environment. If many high buildings, It will use GPS, when around buildings LBS and if in any room WIFI.

Route playback: playbacks the route travelled by the watch wearer on the map.

Safety area: Set fence(safety area) in the device(Max 3 fences),And notify you in APP when watch wearer reach or out of the appointed area.

Contact: Setting up maximum 15 members of your friends or relative in APP.

Dial pad: Dial pad is supported. You can turn on or off this function in switch settings of APP.

SOS: 3 emergency contacts can be set. Press the SOS BUTTON (The button on some models is the power button) for 3 more seconds and it will make an emergency call to the appointed contacts in turns. If there is no one answering, it will continue to dial twice in turns and stop.

Message notification: Notify you when the device turns on or off the SOS function in SMS.(The fees of SMS are calculated according to your local carrier)

Alarms: Set 3 alarm clocks.

Camera: Take a photo.And you can upload it to the phone APP.

Gallery: Save the photos, and you can delete in it or upload photos to the APP.

Microchat: Real time chat between the device and the APP. APP can text or send 15s voice message to the device. And device can read one unread message each time and only send voice message.

Video call: Make a video call with the bind account on Mobile or another device.

Do not disturb: Set 4 periods in one time. Block all calls and keep silent mode in this appointed period.

Setting: Change UI(Some model is not adapted), Volume(Medium, Ringtone, Alarms, Power on and off), Brightness, Date and time, Volte, Power off, About device(Model, Version, IMEI)

What is in Device Information:

1. Registration code: Scan it to register device.
2. Official account: Scan it to follow us to get more information.
3. APP download: Download the Setracker APP

Quick math: Game for kids.

Stopwatch: For time measuring

Calculator: For usual math calculating

Members: Show the account of family members who is bind with the device.

Watch faces: Long press on the idle screen to switch different style of watch faces(some models may not support)

Love heart: You can set this in the APP. And the Love heart can be only shown on the interface of watch.

Remote shut down: Remote shutting down order to the watch when it is power on.

Remote restart: Send a remote restarting message to the watch. And restart the device.

8.Problems fixing

If the device cannot connect to the server in your first time of using, and in the APP shows the device is off line. Please check the following conditions:

1. Your SIM card is 4G and network is normal or not.
2. Data flow is activated and the service is normal or not.
3. The Ip and port, or the IMEI is correct or not. The IMEI code on the device shall be same as the factory code. You can get the code by send message **pw,123456,ts#** to the watch.(The watch has a SIM card. And the message is texted in **ENGLISH**).
4. If there is still not working, please ask the seller for more details and help.

If you cannot register account, generally there are 2 problems :

1. The code of device does not exist or it has registered before, you can ask for your seller for help.
2. Account has registered before. Under this condition, you just create another account is OK.

Dial and incoming call answer function does not work:

1. Check your SIM card(4G Nano SIM card with activated data flow, GPRS, and caller ID functions)
2. If you switch on the whitelist or reject unknown numbers, please add the phone numbers you need in the phone book or whitelist.
3. Check the IPN of your phone numbers fixes the device or not.

Charging failure:

1. If you cannot switch on the device, please long press the power button for 3-5 seconds or the device is in extreme low battery, please charge the device.
2. Check if there are oxidation, corrosion, rusting, or damaged on the charging dock and cable. Keep the connecting pin dry and clean.
3. Check the direction of magnetic 2 pin cable is the same as the charging dock. Make sure the two parts are fully connected.
4. If the battery is in extreme low status, the screen will not light up at the beginning of charging. Wait 1 hour continuous charging, you can start the device normally.

Working time of device is short:

1. Overtime using(We advise a balance using of device according to your personal health)
2. The watch does not get a full charge.
3. The signal is poor and causes a high consumption of battery capacity

Positioning accurate is not good:

1. Check if the device has a normal data flow.
2. It is normal for LBS positioning has a localization deviation(LBS depends on the distribution density of bases)
3. Device's mode of positioning is default off for the first time of using and it will not update the location information.

Why device automatically switches on or off

1. Installing SIM card for the first time or change different cards
2. Unbind the device or after a network reset
3. You set the autostart or shut down on the phone app.

The quality of calling is poor:

1. The signal of compunction is poor
2. The device is too close to the phone during calling.

9.Safety warnings

Please read this chapter carefully and before using device.

- 1.When the device encounters faults or performances a factory reset, if you do not back up your files in advance, you cannot be able to take a recovery of your previous data.
- 2.It is normal for the device to get a bit heat during long time using or too many programs working.
- 3.If you install a screen protector or surface of your hand is wet or dirty, the screen may response slowly or not work. If the screen is broken, please contact with your local
- 4.This device may contain small parts that may be a choking hazard to children under 3 years. Keep small parts away from children.

Please follow these notes in avoid of damage of body and device:

- 1.It is not allowed for children or pets to put any parts of the device and accessories in mouth.
- 2.It is not allowed to poke any body parts with device.
- 3.Do not expose device in extreme hot or cold environment. The working temperatures of device is $-5^{\circ}\text{C}\sim 40^{\circ}\text{C}$.
- 4.Keep device away from any microwave equipment.
- 6.Do not use device fiercely(strike, scratch or drop the device)
- 7.It is not allowed to use device during thunderstorm or lighting outdoor.
- 8.Keep the surface of device dry and clean.
- 9.It is not allowed for wearer to use device during any vehicles' operating.
- 10.It is not allowed to use the device during charging.



WARNING

- 1.In avoid of hearing damage or loss, please do not overtime use device at high dB levels.
- 2.In avoid of visual damage or loss, please adjust the brightness of screen to a suitable range.
- 3.The device has a built-in speaker. Do not put magnetic objects or magnetic-avoiding objects close to the device to avoid damage.
- 4.If the device is part or whole broken, do not touch or remove the broken part, stop using it immediately and contact your seller.
- 5.Consumer must choose and use a power adapter which obtains the legal standard certificates and meets the parameters below:
Input: AC 100-240V~, 50/60Hz, 0.3A
Output: 5V  1A



WARNING

Please follow these notes in avoid of damage of body and device:

- 1.Do not disassemble, hit, crush, or burn the battery. In case of deformation, stop using the battery immediately.
- 2.Do not short circuit the battery to avoid overheating, burns, or other personal injuries.
- 3.Do not place the battery in the high-temperature environments. Overheating may cause explosion.
- 4.If any part of device is broken or the device is overheating, stop using immediately.

Declaration of Conformity

Hereby we,

| | |
|-----------------------|---------------------------------------|
| Name of manufacturer: | <u>SANTOSHI SL</u> |
| Address: | <u>CALLE FELIPE ASENJO N.56</u> |
| Zip code & City: | <u>28947 - FUENLABRADA (MADRID)</u> |
| Country: | <u>SPAIN</u> |

declare that this DoC is issued under our sole responsibility and that this product:

| | |
|----------------------|----------------------|
| Product description: | <u>Smart Watch</u> |
| Type designation(s): | <u>WS-2391</u> |
| Trademark: | <u>SAMI WEARABLE</u> |

is in conformity with the relevant Union harmonization legislation:

DIRECTIVE EMC 2014/30/EU

DIRECTIVE LVD 2014/35/EU

Standard CE (RED): DIRECTIVE 2014/53/EU

Standard RoHS: 2011/65/EU: (RoHS) Restriction of Hazardous Substance.

with reference to the following standards applied:

EN 301 489-1 V2.2.3 (2019-11), EN 301 489-52 V1.1.2 (2020-12),
EN 55032:2015+AC:2016+A1:2020+A11:2020, EN 55035:2017+A11:2020
EN50360:2017, EN62209-1:2016, EN 62209 2:2010/A1:2019, EN50566:2017, EN 50663:2017
EN 62368-1:2014+A11:2017, IEC 62133-2:2017
EN 62209-1:2016, EN 62209-2:2010/A1:2019, EN 50566:2017
EN 301 511 V12.5.1 (2017-03) **LTE** EN 301 908-1 V13.1.1 (2019-11), EN 301 908-13 V13.1.1 (2019-11) **WCDMA** EN 301
908-1 V13.1.1 (2019-11), EN 301 908-2 V13.1.1 (2020-06)



Signature

Full name: VISHAL MIRPURI

Position: ADMINISTRATOR

Date: 14/11/2024

Contact support: info@sami.es