

PSMRS04 - PSMRS05

Metal Microphone Isolation Shield

Vocal Booth and Studio Recording Acoustic Panel

PYLE
PyleUSA.com

USER GUIDE



PSMRS04

Three Panels Metal Isolation Shield



PSMRS05

Five Panels Metal Microphone Isolation Shield

PACKAGE CONTENTS

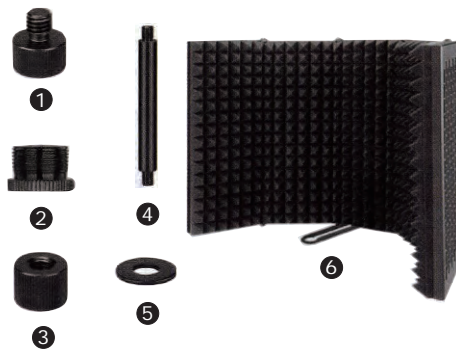

- | | |
|-------------|-----------------------|
| 1 Screws X1 | 2 Adapter X1 |
| 3 Nut X 2 | 4 Connecting rod X1 |
| 5 Washer X1 | 6 Isolation Shield X1 |

HOW TO INSTALL

USAGE 1

Use on the desktop

- Step 1:** Take out the isolation shield and all accessories on the desk.
- Step 2:** Install adapter on connecting rod (and then Install the microphone on the adapter).
- Step 3:** Pass the connecting rod through the crossbar of the isolation shield (the connecting rod can move forward and backward to adjust the position)
- Step 4:** Combine connecting rod and washer with nut.
- Step 5:** Use it on the desk (**Note:** microphone and shock mount are not included).

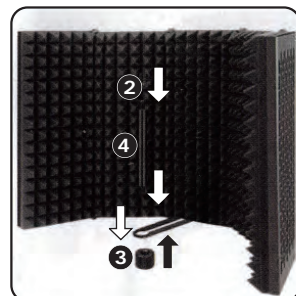

Questions? Issues?

We are here to help!

Phone: (1) 718-535-1800

Email: support@pyleusa.com

USAGE 2

Use with floor stand (5/8 interface)

Step 1: Take out the isolation shield and all accessories on the desk.

Step 2: Take out the floor stand.

(Note: The floor stand, microphone, shock mount and pop filter is not included in the product and the customer needs to prepare it himself).

Step 3: Combine the nut, connecting rod and adapter (the connecting rod can move forward and backward to adjust the position).

Step 4: Install washer, screws and nut on the crossbar of the isolation shield

Step 5: Fix the Isolation Shield on the floor stand (as the picture shows)

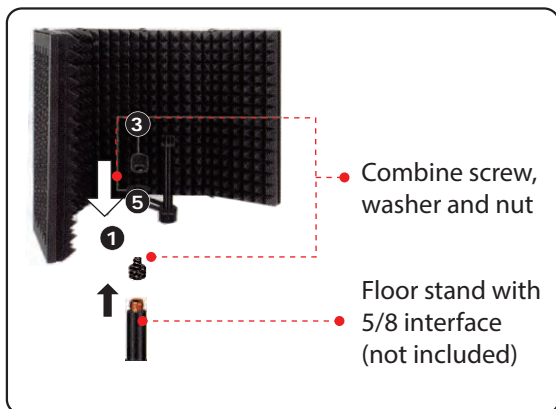

USAGE 3

Use with floor stand (3/8 interface)

Step 1: Take out the isolation shield and all accessories on the desk.

Step 2: Take out the floor stand.

(Note: The floor stand, microphone, shock mount and pop filter is not included in the product and the customer needs to prepare it himself).

Step 3: Combine the nut, washer, connecting rod and adapter (the connecting rod can move forward and backward to adjust the position).

Step 4: Fix the sound enclosure to the floor stand with nuts and washers.

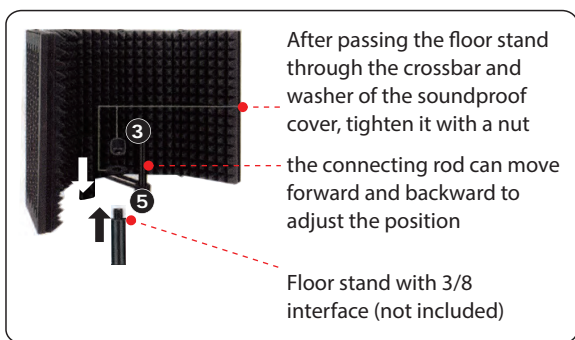

California Prop 65 Warning

⚠ WARNING:

This product contains Nickel carbonate which is known to the state of California to cause cancer birth defects and other reproductive harm. Do not ingest.

For more info go to: www.P65warnings.ca.gov