

Measuring for your new blinds is easier than you might think! All you have to do is follow our simple tips, double-check everything you do, and set aside some time to do it. Happy measuring!

Recess fitting

Measure the full width and height of the recess [the size of the hole if you like] and we will make the appropriate deductions to ensure a perfect fit. Please note that our Fly Screen Roller Blinds are only suitable for recess fitting, and for windows that open outwards.

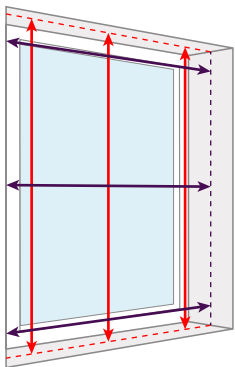

- **Measure in 3 places** for both the width and the drop, **use the smallest measurement**

- **Don't make any deductions**, we'll deduct a small amount from the width and drop to ensure your blind fits perfectly.

- **Use a metal tape measure**, cloth ones can stretch and give you inaccurate measurements

Top-Tip:

Check that your recess is deep enough to fit the blind into, also bearing in mind any obstructions such as handles.

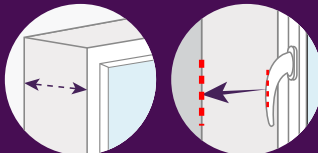

Blind Depth
50mm