

Mini Single Color LED Controller (2.4GHz)

Model No.: MLR2

Features

- 4096 levels smooth dimming, Min brightness 0.1%, dimming range 0.1%-100%
- One controller can be paired with 12 remote (Control distance 30m)
- Auto-forwarding: Automatically forward the remote control signal to another master box, making the remote control distance infinite
- Support do not disturb mode setting, Suitable for areas with frequent power outages to save electricity
- Supports "Tuya Smart" app control (2.4GHz gateway is needed)
- Support Alexa, Google Assistant, Yandex Alice (2.4GHz gateway is needed)



Parameters

Name: Mini Single Color LED Controller (2.4GHz)

Model No.: MLR2

Input Voltage: DC12-24V

Output Current: Max 6A

Output Power: 72-144W

Output Type: Constant Voltage

Control Signal: 2.4GHz RF

Control Distance: 30m

IP Rate: IP20

Working Temp.: -10~40°C

Dimming level: 4096 levels

Dimming Range: 0.1%-100%

Dimming Curve: Logarithmic

EMC Standard (EMC): ETSI EN 301 489-1 V2.2.3
ETSI EN 301 489-3 V2.1.1

Safety Standard (LVD): EN 61347-1:2015+A1:2021
EN 61347-2-11:2001+A1:2019

Radio Equipment (RED): ETSI EN 300 440 V2.2.1

Certification: CE, EMC, LVD, RED

Warranty: 5 Years

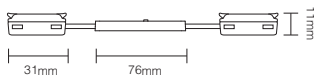
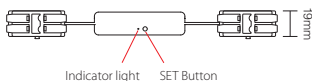

Connection Diagram

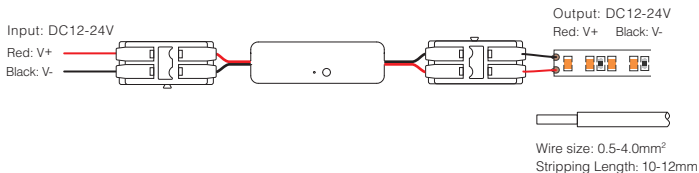

Application Diagram

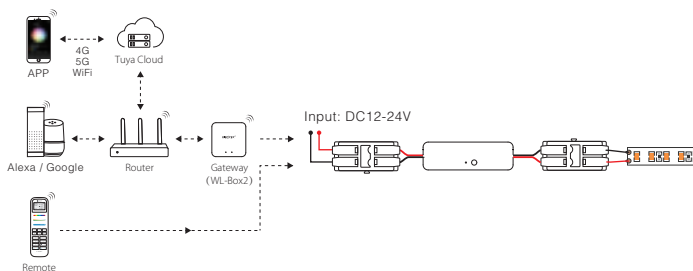

Compatible with remote control (need to be purchased separately)

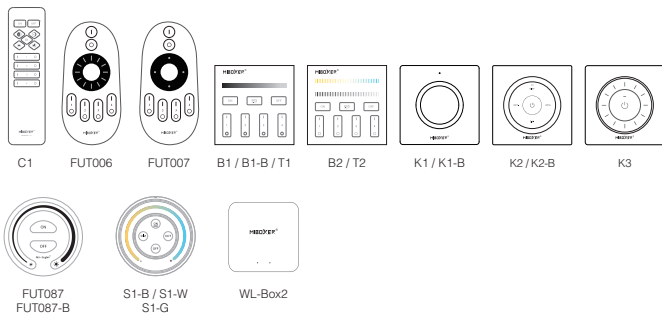

Remote Control Instructions

1). Linking Code Instructions

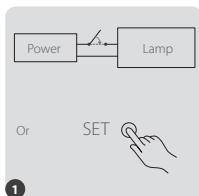

Power off, then power on again after 10 seconds or the "SET" button once or turn on the light through the PUSH switch.

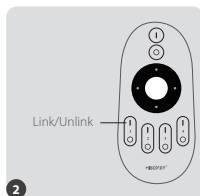

Short press the "I" button 3 times within 3 seconds.



The light flashes slowly 3 times, indicating successful Linking.



If the light does not flash slowly, the code binding failed, please perform the above steps again.
(Note: Already coded lamps cannot be coded again).

2). Unlinking Code Instructions

Method 1:

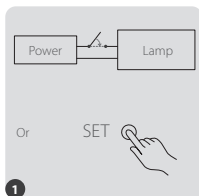

Power off, then power on again after 10 seconds or the "SET" button once or turn on the light through the PUSH switch.

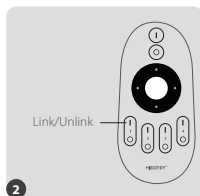

Short press the "I" button 5 times within 3 seconds.



The lamp flashes 10 times quickly, indicating successful unlinking



If the light does not flash quickly, unlinking failed, please perform the above steps again.
(Note: For lamps that are not coded, no unlinking is required).

Method 2:

Press and hold the "SET" button for 5 seconds, the light flashes 10 times, and the code is cleared successfully.

3). Auto-forwarding & Auto-synchronization

Remote control signal auto-forwarding

The remote control signal received by the host will be forwarded to another host within 30m, making the control distance infinite.

Dynamic mode auto-synchronization

In the same dynamic mode, the lamps will be automatically synchronized so that the dynamic effects are always consistent.



4). Turn Do Not Disturb mode on and off (ON by default)

Turn on "Do Not Disturb" (applicable to areas with frequent power outages to save energy)

Turn on Do Not Disturb mode:

Short press the "OFF" button 3 times within 3 seconds, and then short press the "ON" button 3 times. The light flashes 4 times to indicate success.

Turn off Do Not Disturb mode:

Short press the "ON" button 3 times within 3 seconds, and then short press the "OFF" button 3 times. The light flashes 4 times slowly to indicate successful shutdown.

Note: When the lamp is powered on again after a power outage, its status (lights on or off) will remain the same as before the power outage.

Note: When the lamp is powered on again after a power outage, its status will be on by default.

Notice

1. When installing the device, please turn off the power to ensure safety.
2. Please check if the input voltage is consistent with the device.
3. Non-professional users cannot disassemble the device directly, otherwise the device may be damaged.
4. Do not use the device near large metal areas or areas with strong electromagnetic waves, otherwise the remote control distance will be seriously affected.



Made in China