

# User Manual

Ergonomic Dual Mode Rechargeable  
Wireless Keyboard Mouse Combo

# Product Function

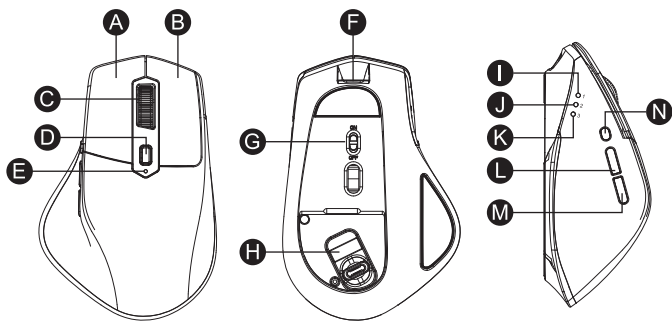

**A** Left Button

**B** Right Button

**C** Scroll Wheel Button

**D** DPI Button

**E** Low Voltage Indicator / Charging Indicator

**F** Type-C Charging Port

**G** Power Switch

**H** USB Receiver

**I** 2.4G Indicator

**J** BT1 Indicator

**K** BT2 Indicator

**L** Forward Button

**M** Backward Button

**N** Mode Switch Button

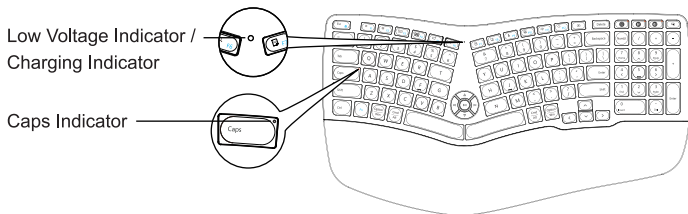

Type-C Charging Port

Power Switch

OFF ON



2.4GHz  
Channel

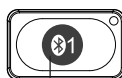

Bluetooth  
Channel 1

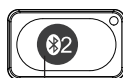

Bluetooth  
Channel 2

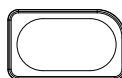

## 2.4GHz Connection Steps

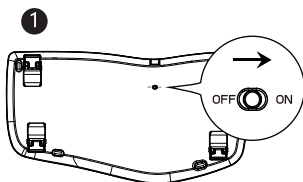

1. Switch the power switch to ON.

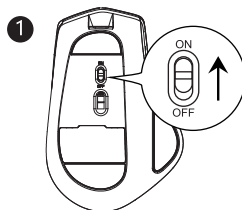

1. Switch the power switch to ON.

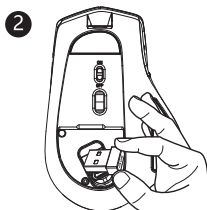

2. Take out the USB receiver.

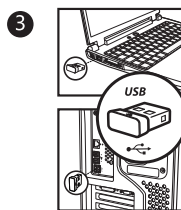

3. Plug the USB receiver into the USB port of the computer.

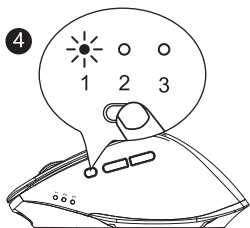

4. Press the mode switch button on the left side of the mouse until the USB indicator is on, the mouse enters 2.4G mode.

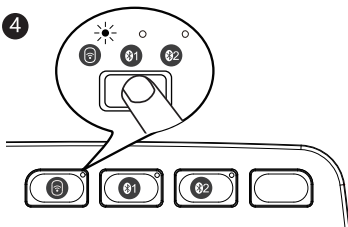

4. Press the key , switch to 2.4G channel, the white indicator flashes slowly, the keyboard enters 2.4G mode.

## Mouse Bluetooth Connection Steps

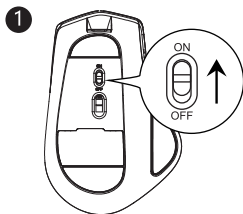

1. Switch the power switch to ON.

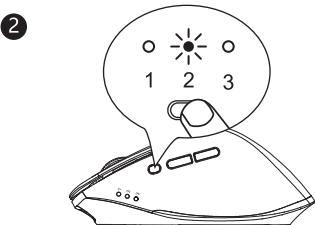

2. Press the mode switch button on the left side of the mouse until the 2 / 3 indicator is on, the mouse enters Bluetooth mode.

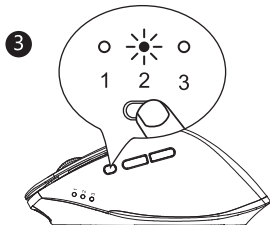

3. Long press the mode switch button on the left side of the mouse for 3~5 seconds until the 2 / 3 indicator flashes quickly, then the mouse enters Bluetooth pairing mode.

## Windows 10 System (Mouse)

- 4 Open the “Setting” and find “Bluetooth Device” on the computer.

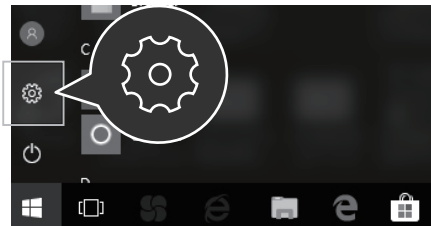

- 5 Choose “Add / Delete Bluetooth Devices”.

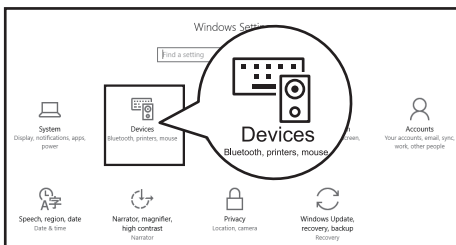

- 6 Bluetooth search and click to pair the “ProtoArc EKM01”.

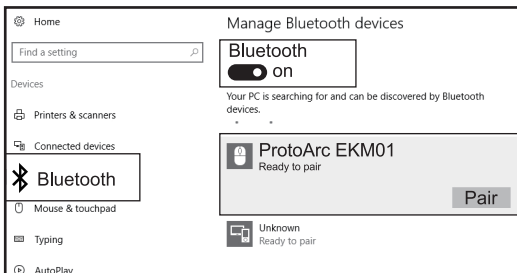

- 7 Successfully paired when it shows “ProtoArc EKM01 Connected”.

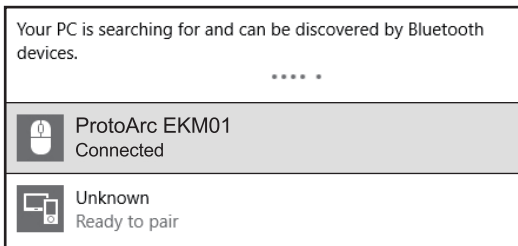

## Mac OS System (Mouse)

Complete Mouse Bluetooth Mode Installation Steps 1, 2 and 3 before pairing.

- 4 Find “System Preferences” on Mac.



- 5 Turn on “Bluetooth” in System Preferences.



- 6 Your computer will automatically search for “ProtoArc EKM01” and then click “pair”.

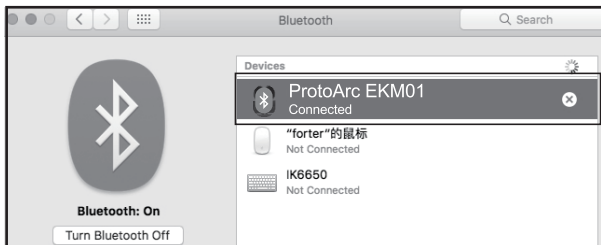

## iOS System (Mouse)

Only iPad OS 13 / iOS 13 and above systems support mouse function.

Complete Mouse Bluetooth Mode Installation Steps 1, 2 and 3 before pairing.

- 4 Open “Settings” and find “Accessibility”.

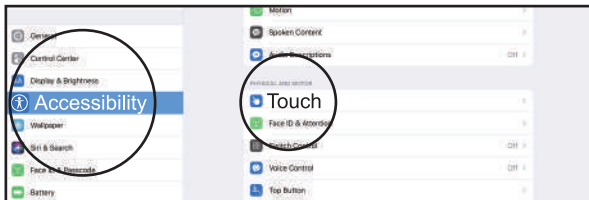

- 5 Click “Touch”.



- 6 Turn on “Assistive Touch”.

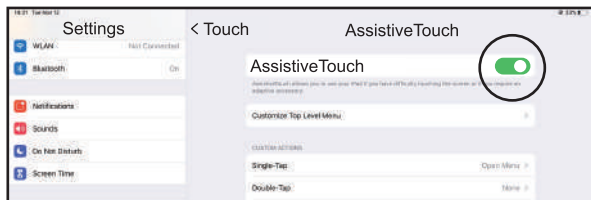

- 7 Open “Settings” and turn on Bluetooth function.



- 8 Bluetooth search and click to pair the “ProtoArc EKM01”.

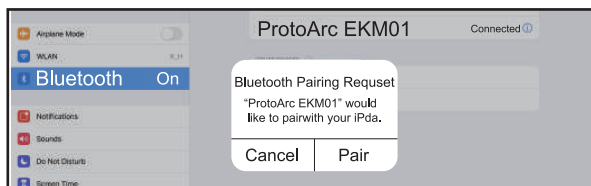

- 9 Successfully paired when it shows “ProtoArc EKM01 Connected”.

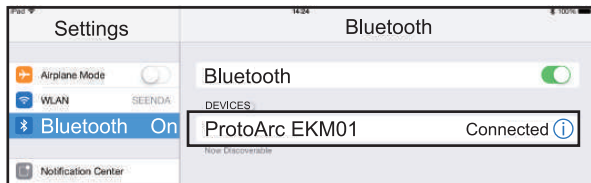



## Android System (Mouse)

Complete Mouse Bluetooth Mode Installation Steps 1, 2 and 3 before pairing.

- 4 Open "Settings" and turn on Bluetooth function.

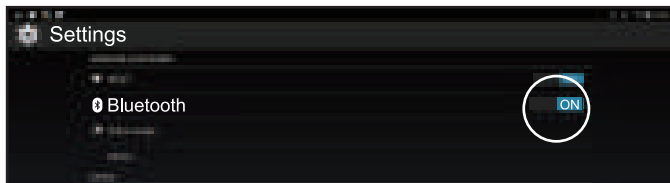

- 5 Bluetooth search and click to pair the "ProtoArc EKM01".

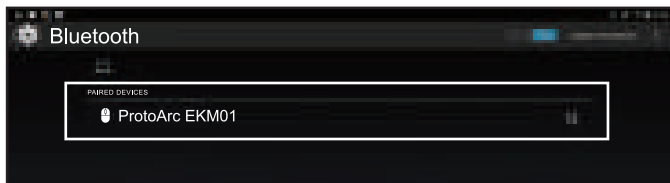

- 6 Successfully paired when it shows "ProtoArc EKM01 Connected".

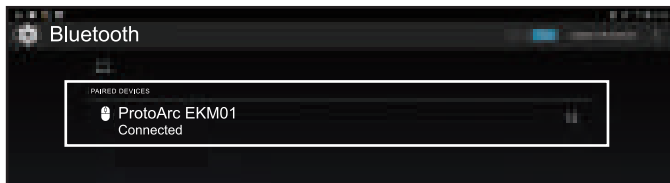

# Keyboard Bluetooth Connection Steps

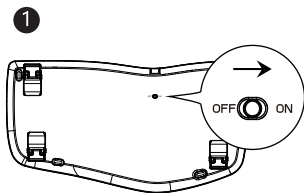

1. Switch the power switch to ON.

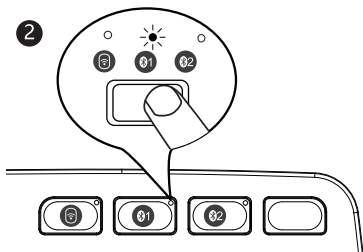

2. Press the channel key to choose bluetooth channel 01 / 02, the white indicator flashes, the keyboard enters bluetooth mode.

3. Long press the channel key for 3~5 seconds, the white indicator flashes quickly, the keyboard enters bluetooth pairing mode.

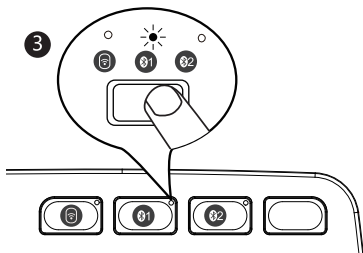

## Windows 10 System (Keyboard)

4 Open "Settings" and Click Bluetooth Devices.

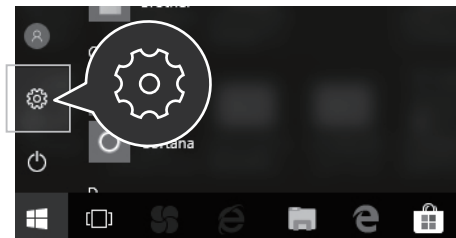

5 Choose “Add / Delete Bluetooth Devices”.

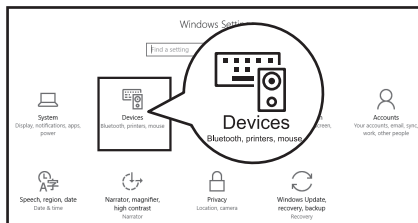

6 Bluetooth search and click to pair the “ProtoArc EKM01”.

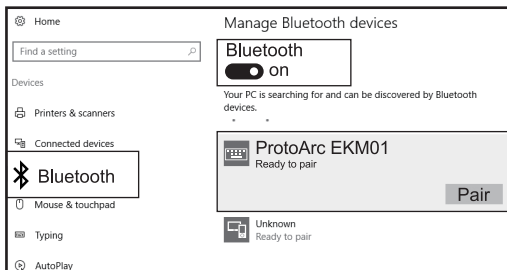

7 Successfully paired when it shows “ProtoArc EKM01 Connected”.

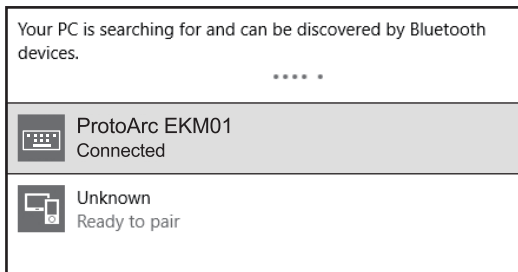

## Mac OS System (Keyboard)

Complete Keyboard Bluetooth Mode Installation Steps 1, 2 and 3 before pairing.

- 4 Find “System Preferences” on Mac.



- 5 Turn on “Bluetooth” in System Preferences.



- 6 Bluetooth search and click to pair the “ProtoArc EKM01”.



## iOS System (Keyboard)

Complete Keyboard Bluetooth Mode Installation Steps 1, 2 and 3 before pairing.

- 4 Open "Settings" and turn on Bluetooth.

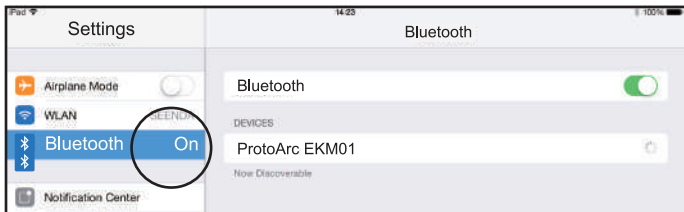

- 5 Bluetooth search and click to pair the "ProtoArc EKM01".

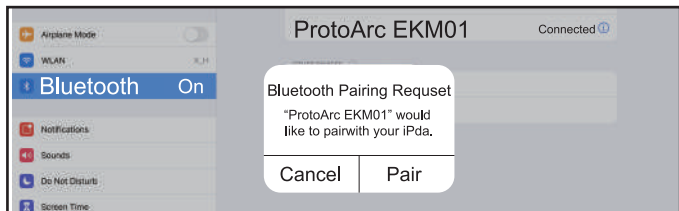

- 6 Successfully paired when it shows "ProtoArc EKM01 Connected".

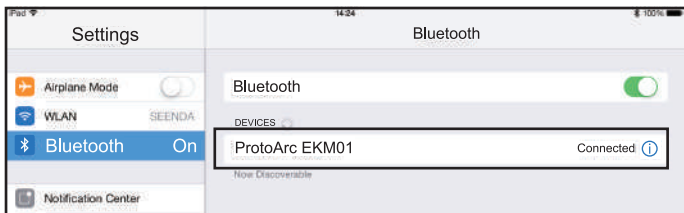

## Android System (Keyboard)

Complete Keyboard Bluetooth Mode Installation Steps 1, 2 and 3 before pairing.

- 4 Open “Settings” and turn on Bluetooth.

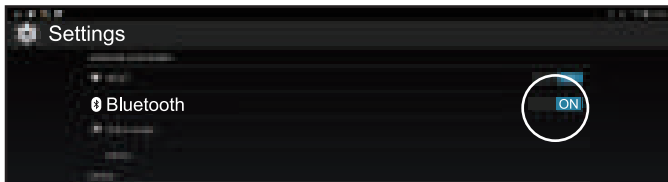

- 5 Bluetooth search and click to pair the “ProtoArc EKM01”.

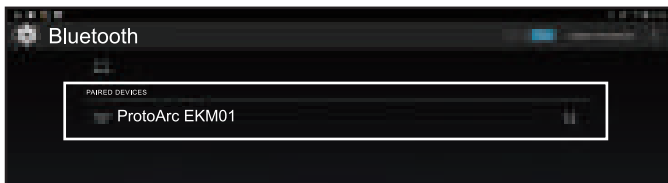

- 6 Successfully paired when it shows “ProtoArc EKM01 Connected”.

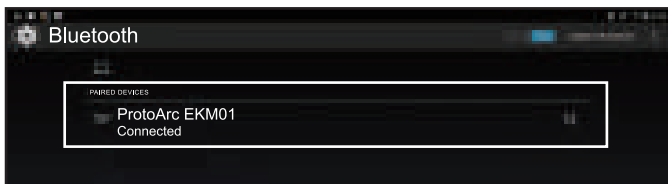

## How to Switch the Mouse Mode

After USB / Bluetooth 1 / Bluetooth 2 devices connected, short press the mode switch button on the left side of the mouse to easily switch between devices.

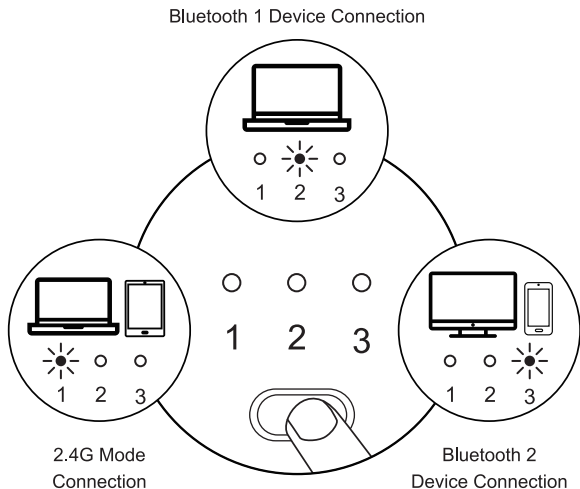

## Mouse Charging

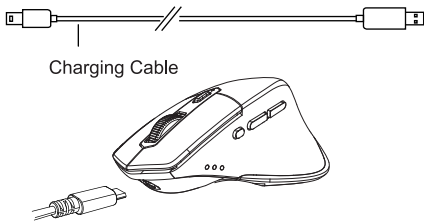

## How to Switch the Keyboard Mode

After ① | ② connected, short press the keyboard channel key to easily switch between devices.

### Bluetooth 1 Device Connection

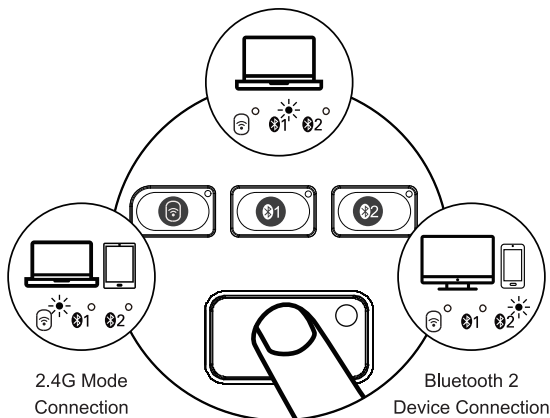

## Keyboard Charging

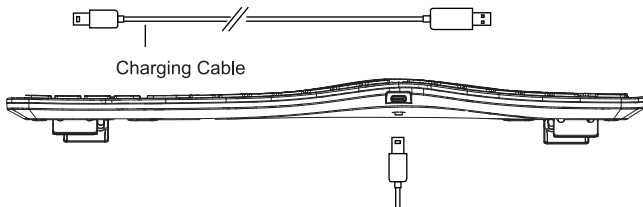

When the battery is too low, the low voltage indicator of the keyboard mouse will flash until the keyboard mouse turns off, please recharge the keyboard mouse in time to make sure the keyboard mouse can work properly. When the battery of the keyboard is too low, delay or slow response will happen while typing.



## Multimedia Function Button

Buttons	Win system	Android system	iOS system	MAC OS system
	Decrease brightness	Decrease brightness	Decrease brightness	Decrease brightness
	Increase brightness	Increase brightness	Increase brightness	Increase brightness
	Window switching	Window switching	/	Multi-window preview
	Multi-window preview	/	App switching	App switching
	Show desktop	/	/	Show desktop
	Search	Search	Search	Search
	Select all	Select all	Select all	Select all
	Copy	Copy	Copy	Copy
	Cut	Cut	Cut	Cut
	Paste	Paste	Paste	Paste
	Mute	Mute	Mute	Mute
	Home	Home	Home	/
	Screenshot	Screenshot	Screenshot	Screenshot
	Lock	/	Lock	Lock
	Volume up	Volume up	Volume up	Volume up
	Volume down	Volume down	Volume down	Volume down
	Previous	Previous	Previous	Previous
	Play&Stop	Play&Stop	Play&Stop	Play&Stop
	Next	Next	Next	Next
	FN+ESC (FN lock) button to turn on or turn off the FN function			

**Please NOTE:** The FN function is a cyclic mode (F1-F12 and multimedia functions are cyclically used)

# Product Parameters

## Keyboard

Compatible Operating Systems	2.4G compatible systems: Windows OS Bluetooth compatible systems: Windows 8, Windows 10 or above, Mac OS X 10.12 or above, Android 4.3 or above.
Battery Capacity	300mAh
Sleep Time	Enter into the sleep mode after no operation of 30 minutes
Battery Life	1000 times charge and discharge
Key Life	3 Millions Strokes
Standby Time	200 Hours
Wake Up Way	Press any key
Operating Distance	Within 8 meters
Working Current	≤3mA
Keyboard Dimension	423.8 x 231.4 x 27.7mm

## Mouse

Compatible Operating Systems	2.4G compatible systems: Windows OS Bluetooth compatible systems: Windows 8, Windows 10 or above, Mac OS X 10.12 or above, Android 4.3 or above.
Working Voltage	3.7V
Working Current	≤3.5mA
DPI	800-1300-2000
Sleep Time	30 mins
Working Time	140 hours
Charging Time	2-3 hours
Battery Capacity	500mAh
Wake Up Way	Press any button
Operating Distance	Within 8 meters
Standby Time	100 Days
Mouse Dimension	124.6 x 83.6 x 50.4mm

## Kind Note

1. When the keyboard mouse is not connected properly, please turn off the power switch, restart the Bluetooth of the device and connect again, or delete extra Bluetooth device names in the Bluetooth list, and connect again.
2. Please press the channel button to switch between the devices that already connected successfully, wait for 3 seconds, it will work properly.
3. The keyboard mouse has memory function, when the keyboard mouse is connected properly at one channel, turn off the keyboard mouse and turn on again, the keyboard mouse will be in the default channel, and the indicator of this channel is on.

## Sleep Mode

1. When the keyboard mouse is not used for over 30 minutes, the keyboard mouse will automatically enter into the sleep mode, the indicator light will be off.
2. When you want to use the keyboard mouse again, please press any key, the keyboard mouse will wake up within 3 seconds, and the indicator light will be on again.

## Package List

- ▶ 1 x Wireless Bluetooth Keyboard
- ▶ 1 x Wireless Bluetooth Mouse
- ▶ 1 x USB Receiver
- ▶ 1 x Type-C Charging Cable
- ▶ 1 x User Manual