

# EAGLE 3.0



OPERATION MANUAL  
DSA-EGE

# HELMETS SAVE LIVES!

Always wear a properly fitted helmet that complies with CPSC or CE safety standards when you ride your E-Scooter.

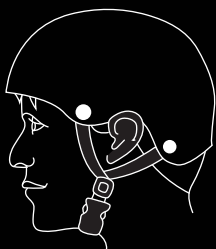

## **Correct Fit:**

Make sure your helmet covers your forehead.

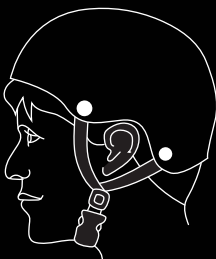

## **Incorrect Fit:**

Forehead is exposed and vulnerable to serious injury.

## **WARNING**

As with all mechanical devices, the Hover-1 Eagle 3.0 is subject to wear and high stresses. Different materials and components may react to wear or fatigue in different ways. If the design life of a component has been exceeded, it may suddenly fail, possibly causing injuries to the rider. Any form of crack, scratch, or change of coloring in highly stressed areas indicate that the life of the component has been reached and it should be replaced. Do not ride in an abusive manner.

## **CAUTION**

In this manual, the CAUTION sign indicates a hazardous situation which, if not avoided, can cause minor or moderate injury.

## **WARNING**

In this manual, the WARNING sign indicates a hazardous situation which, if not avoided, can cause serious injury or death.

## **WARNING**

Great care should be taken with the Hover-1 Eagle 3.0 when folding and unfolding it. Moving and folding parts can cut skin or pinch if mishandled.

**DO NOT RIDE YOUR HOVER-1 EAGLE 3.0 WITHOUT THE STEERING COLUMN, FOLDING HINGE, AND HANDLEBARS SECURELY LOCKED IN PLACE.**

# **WARNING**

## **PLEASE READ THE OPERATION MANUAL THOROUGHLY.**

**Failure to follow the basic instructions and safety precautions listed in the operation manual can lead to damage to your Eagle 3.0, property damage, serious bodily injury, and even death.**

Thank you for purchasing the Hover-1 Eagle 3.0. Please read all instructions carefully before using it and retain this manual for future reference.

- To avoid collisions, falls, and loss of control, please learn how to ride the Eagle 3.0 safely.
- You can learn how to ride the Eagle 3.0 by reading the operation manual and watching videos.
- All users are responsible for any consequences caused by violating warning contents or proper operations. Hover-1 can not be held liable.

## **ATTENTION**

1. Use only the supplied charger from Hover-1 with this E-Scooter.
2. The operating temperature range of the charger is 32°F - 104°F (0°C - 40°C).
3. The operating temperature range of the Eagle 3.0 is 32°F - 104°F (0°C - 40°C).
4. Do not ride on icy or slippery surfaces.
5. Read the operation manual and warning labels before riding.
6. Store the Eagle 3.0 in a dry, ventilated environment.
7. When transporting the Eagle 3.0, avoid violent crashes or impact.

## **LOW TEMPERATURE WARNING**

Low temperatures will affect the lubrication of moving parts inside the Eagle 3.0, increasing internal resistance. Additionally, the discharge capacity and capacity of the battery will be significantly decreased.

Use caution when riding the Eagle 3.0 in cold temperatures (below 40°F/4°C). Doing so may increase the risk of mechanical failures of the E-Scooter, which may lead to damage to your device, property damage, serious bodily injury, and even death.

## **SAFETY INSTRUCTIONS**

- Keep the E-Scooter away from heat sources, direct sunlight, humidity, water, and any other liquids.
- Do not operate the E-Scooter if it has been exposed to water, moisture, or any other liquids to prevent electric shock, explosion, and/or injury to yourself and damage to the E-Scooter.
- Do not use the E-Scooter if it has been dropped or damaged in any way.
- Repairs to electrical equipment should only be performed by the manufacturer. Improper repairs void the warranty and may place the user at serious risk.
- Do not puncture or harm the exterior surface of the E-Scooter in any way.
- Keep the device free from dust, lint, etc.
- Do not use this E-Scooter for anything other than its intended use or purpose. Doing so may damage the E-Scooter or lead to property damage, injury, or death.
- This product is not a toy. Keep out of reach of children.
- Do not expose the batteries to excessive heat such as direct sunlight or an open flame.
- Do not allow hands, feet, hair, body parts, clothing, or similar articles to come in contact with moving parts, wheels, or the drivetrain while the Eagle 3.0 is running.

- Do not operate or allow others to operate the Eagle 3.0 until the user understands all instructions, warnings, and safety features described in this manual.
- Check with your doctor if you have a medical condition that could affect your ability to use the Eagle 3.0.
- Persons with head, back, neck ailments, or prior surgeries to those areas of the body are not recommended to use the Eagle 3.0.
- Do not operate if you are pregnant or have a heart condition.
- Persons with any mental or physical conditions that may make them susceptible to injury or impair their physical or mental capabilities to recognize, understand, and perform all of the safety instructions and assume the hazards inherent in operation should not use the Eagle 3.0.

## SERIAL NUMBER

Please keep your serial number on file for warranty claims as well as proof of purchase.

## WARNING

Prolonged exposure to UV rays, rain, and the elements may damage the enclosure materials. Store indoors when not in use.

# INTRODUCTION

The Eagle 3.0 is a personal transporter. Our production processes are developed with strict testing for each Eagle 3.0 E-Scooter. Operating the Eagle 3.0 without following the contents of this manual may lead to damage to your Eagle 3.0 E-Scooter or bodily injury.

## PACKAGE CONTENTS

- Hover-1 Eagle 3.0 Electric Folding Scooter
- Charger

Your Eagle 3.0's serial number is stamped on the bottom of the E-Scooter platform. Record the serial number in the designated area of the "WARRANTY" section of this manual in case your Eagle 3.0 is lost or stolen.

# SAFETY PRECAUTIONS

- The first rule of safe riding is to use common sense.
- Different localities and countries have different laws about riding electric transportation devices on public roads. You should check with local officials to ensure you are complying with local traffic law requirements.
- Hover-1 is not liable for tickets or violations given to riders who do not follow local laws and regulations.
- For your safety, always wear a helmet that meets CPSC or CE safety standards. In the event of an accident, a helmet can protect you from serious injury and in some cases, even death.

- Obey all local traffic laws. Obey red and green lights, one-way streets, stop signs, pedestrian crosswalks, etc.
- Ride with traffic, not against it.
- Ride defensively; expect the unexpected.
- Give pedestrians the right-of-way.
- Do not ride too close to pedestrians and alert them if you intend to pass them from behind.
- Slow down at all street intersections and look to the left and right before crossing.
- Your Eagle 3.0 electric folding scooter is not equipped with reflectors. It is not recommended that you ride in conditions of low visibility.
- If you are riding your E-Scooter in low-visibility conditions, ensure your LED headlight is turned on, and that you are wearing bright, reflective clothing.



## WARNING

When you ride in low-visibility conditions such as fog, dusk, or night, you might be difficult to see, which could lead to a collision. To increase your level of safety, be sure to wear bright, reflective clothing when riding in low-visibility conditions.

- Do not ride above your skill level. Ensure you have had enough practice with all functions and features of your Eagle 3.0.
- Do not ride too fast – with increased speed comes increased risk. If you are moving at a higher speed, small bumps can create strong impacts, leading to a higher risk of injury.
- Do not ride with pets.
- Before stepping on your Eagle 3.0, make sure it is placed flat on level ground.



- Do not try to open or modify your Eagle 3.0 E-Scooter. Doing so voids the manufacturer warranty and may cause your Eagle 3.0 to fail, resulting in injury or death.
- Do not use the Eagle 3.0 in a manner that would put people or property in danger.
- If you are riding near other riders, be sure to maintain a safe distance between each other to prevent collisions.
- Be sure to keep your feet on the Eagle 3.0 at all times. Moving your feet off your Eagle 3.0 while driving is dangerous and may cause the Eagle 3.0 to stop suddenly or veer sideways.
- Do not operate the Eagle 3.0 while under the influence of drugs or alcohol.
- Do not operate the Eagle 3.0 when you are restless or sleepy.
- Use your best judgment to keep yourself out of dangerous situations with your Eagle 3.0.
- Do not ride your Eagle 3.0 off of curbs, ramps, or attempt to operate in a skate park, empty pool, or in any way similar to a skateboard. Misuse of your Eagle 3.0 voids the manufacturer warranty and may lead to injury or damage.
- Do not abuse your Eagle 3.0. Doing so can damage your unit and cause failure to the operating system, which may lead to injury. Physical abuse, including dropping your Eagle 3.0, voids the manufacturer warranty.
- Do not operate in or near puddles of water, mud, sand, stones, gravel, debris, or near rough and rugged terrain.
- The Eagle 3.0 can be used on paved surfaces that are flat and even. If you encounter uneven pavement, lift your Eagle 3.0 over and past the obstruction.
- Do not ride in inclement weather: snow, rain, hail, sleet, on icy roads, or in extreme heat or cold.
- Bend your knees when riding on bumpy pavement to absorb the shock and vibrations. This will help you keep your balance.
- If you are unsure if you can safely ride on a specific terrain, step off and carry your Eagle 3.0. Always be on the side of caution.



## WARNING

Proper use of your brake is vital to ensure safe, efficient stopping. To avoid misuse and potential injury, do not apply sudden or excessive force to your brakes. Apply your brakes gradually and give yourself enough room to come to a complete stop safely.

- Do not attempt to ride over bumps or objects greater than ½ inch, even when prepared and bending your knees.
- Pay attention. Look where you are riding and be conscious of the road conditions, people, property, and objects around you.
- Do not operate the Eagle 3.0 in crowded areas.
- Operate your Eagle 3.0 with extreme caution when indoors, especially around people, property, and narrow spaces.
- Do not operate the Eagle 3.0 while talking, texting, or looking at your phone.
- Do not ride your Eagle 3.0 where it is not permitted.
- Do not ride your Eagle 3.0 near motor vehicles or on public roads.
- Do not travel up or down steep hills.
- The Eagle 3.0 is intended for use by a single individual, DO NOT attempt to operate the Eagle 3.0 with two or more people.
- Do not carry anything while riding the Eagle 3.0.
- Individuals with lack of balance should not attempt to operate the Eagle 3.0.
- Young children and the elderly should not operate the Eagle 3.0.
- At higher speeds, always take longer stopping distances into consideration.
- Do not attempt to jump on or off your Eagle 3.0.
- Do not attempt any stunts or tricks with your Eagle 3.0.
- Do not ride the Eagle 3.0 in dark or poorly lit areas.

- Do not ride the Eagle 3.0 near or over potholes, cracks, or uneven pavement or surfaces.
- Do not operate your Eagle 3.0 off-road.
- Do not turn sharply, especially at high speeds.
- Do not exceed the maximum weight limit of 264 lbs (120 kg).
- Avoid driving the Eagle 3.0 in unsafe places, including areas with flammable gas, steam, liquid, dust, or fiber that could cause fire and explosion accidents.
- Do not operate near swimming pools or other bodies of water.
- Maintain a safe braking distance during wet conditions.

## **WARNING**

There may be additional risk of injury if you use your E-Scooter incorrectly. This includes, but is not limited to:

- Jumping your E-Scooter
- Riding over debris or obstacles
- Performing stunts
- Riding off-road
- Riding fast
- Racing other riders
- Riding in an unusual manner

The aforementioned examples add stress to each part of your E-Scooter and can lead to long term damage of the device. Damage to your E-Scooter can lead to an accident or increase your risk of injury. To decrease your risk of injury, use your E-Scooter correctly.

## **WARNING**

To reduce the risk of injury, adult supervision is required. Never use in roadways, near motor vehicles, on or near steep inclines or steps, swimming pools, or other bodies of water. Always wear shoes, and never allow more than one rider at a time.

## **CARE & MAINTENANCE**

- To avoid damage to the Eagle 3.0's internal circuitry, do not expose it to liquid, moisture, or humidity.
- Do not use abrasive cleaning solvents to clean the Eagle 3.0.
- Do not expose the Eagle 3.0 to extremely high or low temperatures, as this will shorten the life of the device, destroy the battery, and/or distort certain plastic parts.
- Do not dispose of the Eagle 3.0 in fire as it may explode or combust.
- Do not let the Eagle 3.0 come into contact with sharp objects, as this will cause scratches and damage.
- Do not let the Eagle 3.0 fall from high places, as doing so may damage the internal circuitry.
- Do not attempt to disassemble the Eagle 3.0.
- Use only the charger provided by Hover-1.
- Use only the manufacturer's authorized replacement parts.

## **WARNING**

Avoid using water or other liquids for cleaning. If water or other liquids enter the Eagle 3.0, it will cause permanent damage to the internal components.

## **WARNING**

Users who disassemble the Eagle 3.0 without permission from Hover-1 will void the warranty.

# BATTERY CARE / MAINTENANCE

## BATTERY SPECIFICATIONS

Battery Type: Rechargeable lithium-ion battery

Charge Time: Up to 5 hours

Battery Voltage: 36V

Battery Capacity: 4Ah

Working Temperature: 32°F - 104°F

Charging Temperature: 32°F - 104°F

Storage Time: 1 year

Storage Temperature: 32°F - 104°F

Storage Humidity: 5% - 95%

## BATTERY MAINTENANCE

- The lithium-ion battery is built into the E-Scooter. Do not disassemble the E-Scooter to remove the battery or attempt to separate it from the E-Scooter.
- When charging the E-Scooter, only use the enclosed 1-pin charging cable provided by Hover-1. Use of any other charger or cable may lead to damage to the E-Scooter, overheating, and risk of fire. Use of any other charger or cable voids the manufacturer warranty.
- Do not connect or attach the E-Scooter or the battery to a power supply plug or directly to a car's cigarette lighter.
- Do not place the E-Scooter near a fire or leave it out in direct sunlight. Heating the E-Scooter can break or ignite the battery inside the device.
- Do not continue charging the battery if it does not recharge within the specified charging time. Doing so may cause the battery to become hot, rupture, or ignite.
- To preserve natural resources, please recycle or dispose of batteries properly. This product contains lithium-ion batteries. Local, state, or federal laws may prohibit disposal of lithium-ion batteries in ordinary trash. Consult your local waste authority for information regarding available recycling and/or disposal options.



## WARNING

Failure to follow the safety precautions listed below could lead to serious bodily injury or death.

- Do not attempt to modify, change, or replace your battery.
- Do not use your device if the battery begins to emit odor, overheats, or begins to leak.
- Do not touch any leaking materials or breathe fumes emitted.
- Do not allow children or animals to touch the battery.
- The battery contains dangerous substances. Do not open the battery or insert anything into the battery.
- Do not attempt to charge the device if the battery has discharge or emits any substances. In that case, immediately distance yourself from the battery in case of fire or explosion.



## **WARNING**

SEEK IMMEDIATE MEDICAL ASSISTANCE IF  
YOU ARE EXPOSED TO ANY SUBSTANCE  
THAT IS EMITTED FROM THE BATTERY.

# SPECIFICATIONS

Model:	DSA-EGE
Net Weight:	20.88 lbs (9.47 kg)
Max Supported Weight:	220 lbs (100 kg)
Min Supported Weight:	44 lbs (20 kg)
Max Speed:	Up to 15 mph (25 km/h)
Max Range:	Up to 7 miles (11.2 km)
Battery Type:	Lithium-ion
Motor Power:	300W brushless motor
Battery Voltage:	36V
Battery Capacity:	4.0Ah
Power Requirement:	AC 100V-240V, 50 Hz/60 Hz
Folding Size:	38.5 in. x 15.7 in. x 16.5 in. (97.8 cm x 40 cm x 42 cm)
Open Size:	38.5 in. x 15.7 in. x 44.7 in. (97.8 cm x 40 cm x 113.5 cm)
Tire Type:	Non-pneumatic solid tires
Tire Size:	6.5" front & rear
Brake Type:	Electronic & mechanical brake
UL Certification:	UL2272 certified

# PARTS LIST

**A.** Eagle 3.0 E-Scooter

**B.** Handlebars

**C.** Charger

**D.** Hex Key

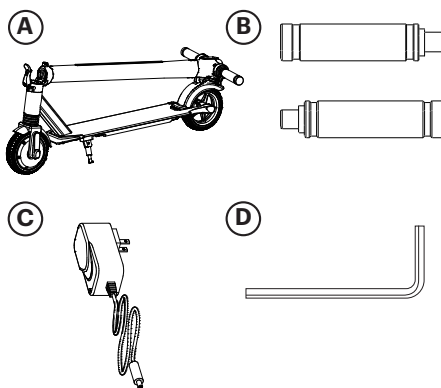

# HOVER-1 EAGLE 3.0 DIAGRAM

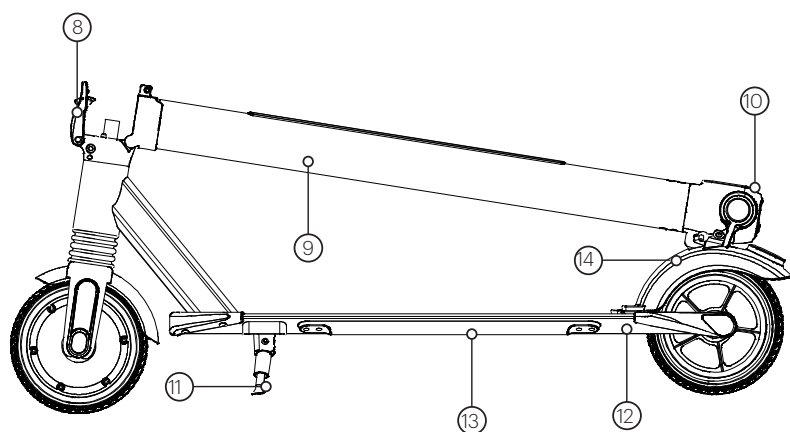
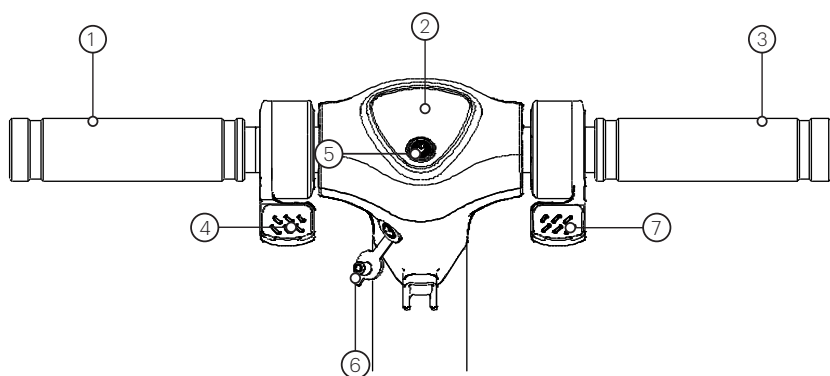

## FEATURES/PARTS

- |                          |                                |
|--------------------------|--------------------------------|
| 1. Handlebars (L)        | 8. Folding Hinge               |
| 2. LCD Display           | 9. Steering Column             |
| 3. Handlebars (R)        | 10. LED Headlight              |
| 4. Electronic Brake      | 11. Kickstand                  |
| 5. Power/Function Button | 12. Foot Deck                  |
| 6. Charging Port         | 13. Foot Deck LED              |
| 7. Throttle              | 14. Mechanical Rear Foot Brake |



# HOVER-1 EAGLE 3.0 DIAGRAM

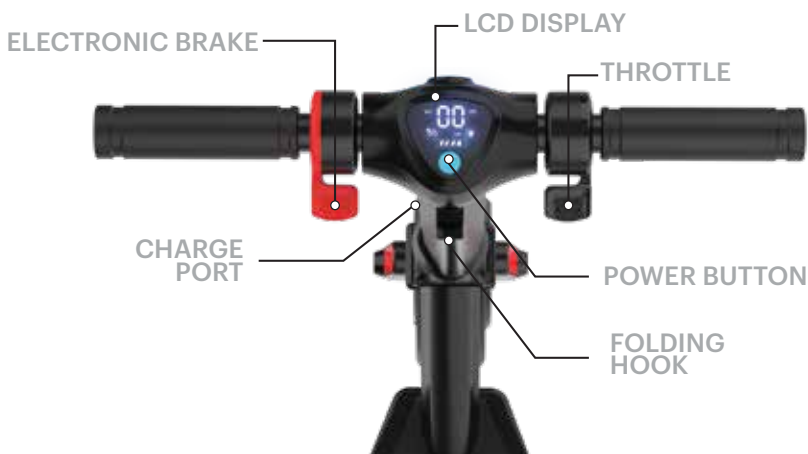

## LCD DISPLAY

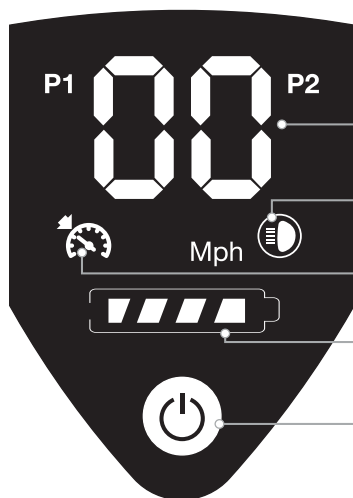

### SPEEDOMETER

Displays your current speed in mph.

Displays the current speed mode when toggled. While the E-Scooter is on, press the power button once to switch between high and low speed mode:

- P1 - Low speed mode (max speed 9 mph)
- P2 - High speed mode (max speed 15 mph)

### HEADLIGHT ICON

Indicates the headlight is activated.

### CRUISE CONTROL ICON

Indicates cruise control is activated.

### BATTERY INDICATOR

Displays your current battery life.

### POWER/ FUNCTION BUTTON

Press and hold 3 seconds to power the E-Scooter on or off. When the powered on, quickly press the power button twice to turn the headlight and deck lights on/off.

# CHARGING YOUR EAGLE 3.0

- Ensure that the charging port is clean and dry.
- Make sure that there is no dust, debris or dirt inside the port.
- Plug the charger into a grounded wall outlet.
- Connect the cable with the power supply (100V-240V; 50 Hz/60 Hz).
- Align and connect the 1-pin charging cable into the charging port of the Eagle 3.0 (DO NOT FORCE OR BEND THE CHARGING CABLE AS IT MAY CAUSE THE PRONGS TO BEND OR BREAK).
- The charging indicator light on the charger itself should change to red, indicating that your device is now being charged.
- When the red indicator light on your charger changes to green, then your device is fully charged.
- After fully charging your Eagle 3.0, unplug the charger from your device and from the power outlet.

## ⚠ CAUTION

Only use the included charging cable and charger to charge your Eagle 3.0. Using any other charger may damage your Eagle 3.0.

# PREPARING YOUR E-SCOOTER

PLEASE READ THE FOLLOWING INSTRUCTIONS CAREFULLY

## ATTACHING THE HANDLEBARS

Attach the handlebars by placing them into the appropriate sockets and twisting them counter-clockwise.



**NOTE:** If the handlebars do not attach flush to the frame, you may need to shift the location of your throttle and brake assembly. Loosen the throttle and brake assembly with the included hex key and make sure they are NOT touching or blocking your handlebars, then tighten them.

# PINCH POINTS

Some parts of your Eagle 3.0 can injure you if mishandled. Moving and folding parts can cut skin. Clamps and pivoting parts such as brake levers can pinch. When folding and unfolding your Eagle 3.0, please watch for pinch points where possible injury may be sustained. Do not leave your hand in these areas during the folding or unfolding process.



## FOLDING & UNFOLDING

To fold your Eagle 3.0, push the folding hinge release button and pull the folding hinge down. Push the steering column down to the rear foot brake. Align the folding hook (located near the charging port) with the opening in the rear foot brake to lock the Eagle 3.0 in a folded position.

To unfold your Eagle 3.0, push the foot brake down to unlock the folding hook. Raise the steering column until it is pointing straight up. Pull the folding hinge up and press it against the steering column to ensure it is securely locked.



RELEASE THE FOLDING HINGE  
TO FOLD THE STEERING  
COLUMN

## SPEED MODES

While the E-Scooter is on, press the power button once to switch between high and low speed mode:

P1 - Low speed mode (max speed 9 mph)

P2 - High speed mode (max speed 15 mph)

## KICK TO START

For safety reasons, the Eagle 3.0 will not accelerate unless it is already moving at least 1.8 mph (3 km/h). You must first kick off the ground and then press the throttle in order to ride the E-Scooter.

## CRUISE CONTROL

To activate cruise control, quickly press the throttle down two times while riding above 3 mph. You will hear a beep and the cruise control indicator will light up on the LCD display indicating that it is activated. Press the throttle down once or squeeze the brake handle to cancel cruise control.

# BEFORE RIDING

Before each use, the E-Scooter operator shall perform the pre-operation checks as specified below:

- The area that the unit is to be operated in is safe and suitable for safe operation.
- The braking system is functioning properly.
- All safety labels are in place and understood by the operator.
- Any and all axle guards, chain guards, or other covers and guards supplied by the manufacturer are in place and in serviceable condition.
- The tires are in good condition and have sufficient tread remaining.

## WARNING

Any E-Scooter that does not work properly can cause you to lose control and fall. Do not ride an E-Scooter with a part that is damaged. Replace the damaged part before riding.

It is important that you fully understand all the functions of your Eagle 3.0 E-Scooter. If these functions are not used correctly, you will not have full control of your Eagle 3.0. Before you ride, learn the functions of the various mechanisms on your Eagle 3.0.

Practice using the Eagle 3.0 at slower speeds in a flat, open area before taking it out into public areas.

### PRE-RIDE CHECKLIST

Ensure that your Eagle 3.0 is in proper working order each time you ride. If a part of the Eagle 3.0 does not function correctly, please contact our Customer Support Center.

- Ensure the battery is fully charged before riding your E-Scooter.
- Please wear all appropriate safety and protective gear before operating your E-Scooter.
- Make sure to wear comfortable clothes and flat, closed-toe shoes when operating your E-Scooter.

# RIDING YOUR EAGLE 3.0 E-SCOOTER

**FAILURE TO FOLLOW ANY OF THE FOLLOWING SAFETY PRECAUTIONS MAY LEAD TO DAMAGE TO YOUR DEVICE, DAMAGE TO PROPERTY, VOID YOUR MANUFACTURER WARRANTY, AND MAY CAUSE SERIOUS BODILY INJURY OR DEATH.**

## OPERATING YOUR DEVICE

Make sure the device is fully charged before the first use. Before turning on your Eagle 3.0 E-Scooter, ride it like a normal kick scooter to get comfortable with the device before using it with the motor.

When you are comfortable riding the E-Scooter, power it on. For the motor to activate, you must first push off the ground with your foot to get the E-Scooter moving, then press the throttle down with your thumb.

To slow down, disengage the throttle and squeeze the brake handle to engage the disc brake. The brake is pressure-sensitive, so a tighter squeeze will result in more stopping power. Do not attempt to stop suddenly as this may lead to injury or damage to your brake discs.

Use the handlebars to turn the Eagle 3.0 in the desired direction.

The Eagle 3.0 can be operated manually if you do not wish to use the motor.

As you get comfortable on the E-Scooter, you will notice it becomes easier to maneuver. Remember at higher speeds, it is necessary to shift your weight when making turns to maintain your stability.

Prepare to brace yourself if you encounter bumps or uneven surfaces. If necessary, dismount your Eagle 3.0 and carry it to a safe operating surface.



## WARNING

Do not turn sharply or at high speeds. Do not turn or ride quickly along slopes, as it may cause injury.

## **SPEED AND WEIGHT LIMITATIONS**

Speed and weight limits are set for your own safety. Please abide by the limits listed here in the manual.

- Maximum Speed: 15 mph
- Maximum Supported Weight: 220 lbs
- Minimum Supported Weight: 44 lbs



### **WARNING**

Riding the Eagle 3.0 while exceeding the weight limit may increase the possibility of injury or product damage.

## **OPERATING RANGE**

The Eagle 3.0 can travel up to 7 miles on a fully charged battery under ideal riding conditions. The following are some of the major factors that will affect the operating range of your device:

- Terrain: Operating range is highest when riding on a smooth, flat surface. Riding uphill and/or on rough terrain will reduce the operating range significantly.
- Weight: A lighter user will have a higher operating range than a heavier user.
- Ambient Temperature: Please ride and store the E-Scooter in recommended temperatures. This will increase operating range, battery life, and overall performance of your device.
- Speed and Riding Style: Maintaining a moderate and consistent speed while riding produces maximum operating range. Traveling at high speeds for extended periods of time, frequent starts and stops, and idling will decrease operating range.



### **WARNING**

Proper use of your brake is vital to ensure safe, efficient stopping. To avoid misuse and potential injury, do not apply sudden or excessive force to your brake. Apply the brake gradually and give yourself enough room to come to a complete stop safely.

# SAFETY ALERTS

If a system error occurs or an improper operation is performed while riding your Eagle 3.0, the device will alert the user in a variety of ways.

The following are common occurrences that will produce safety alerts. These notices should not be ignored and appropriate action should be taken to correct any improper operation, failure, or errors.

- Prohibited riding surfaces (uneven, too steep, unsafe, etc.)
- Battery voltage is too low.
- The E-Scooter is still charging.
- The E-Scooter is overheating, or the motor temperature is too high.
- When the battery is about to run out of power, the battery icon will flash.
- If any or both tires are blocked, the device will stop after 10 seconds.
- When the battery level has depleted below protection mode, the motor will power off after 15 seconds.
- If a high discharge current is produced during use (such as riding up a steep slope for a long period of time), the motor will shut off after 15 seconds.



# FCC STATEMENT

NOTE: This equipment has been tested and found to comply with the limits for a Class B digital device, pursuant to Part 15 of the FCC Rules. These limits are designed to provide reasonable protection against harmful interference in a residential installation. This equipment generates, uses, and can radiate radio frequency energy and, if not installed and used in accordance with the instructions, may cause harmful interference to radio communications. However, there is no guarantee that interference will not occur in a particular installation. If this equipment does cause harmful interference to radio or television reception, which can be determined by turning the equipment off and on, the user is encouraged to try to correct the interference by one or more of the following measures:

- Reorient or relocate the receiving antenna.
- Increase the separation between the equipment and receiver.
- Connect the equipment into an outlet on a circuit different from that to which the receiver is connected.
- Consult the dealer or an experienced radio/TV technician for help.

Changes or modifications not expressly approved by the party responsible for compliance could void the user's authority to operate the equipment.

This device complies with Part 15 of the FCC Rules. Operation is subject to the following two conditions:

(1) This device may not cause harmful interference, and (2) this device must accept any interference received, including interference that may cause undesired operation.

# WARRANTY

For warranty information, please visit us at [www.hover-1.com](http://www.hover-1.com)

Manufacturer: DGL Group, Ltd.  
2045 Lincoln Highway, Edison, NJ 08817

Error codes	Error E1- motor hall failure, the motor needs to be replaced
	Error E2 - accelerator failure, the accelerator needs to be replaced
	Error code E3 - motor blocking fault, release the accelerator
	Error E4/MOS - mainboard MOS tube failure, the mainboard needs to be replaced
	Error E6 - controller / instrument communication failure, the controller needs to be replaced
	Error E7 - battery over-voltage protection, the battery needs to be replaced
	Error E8 - controller error, the controller needs to be replaced
	Error E9 - brake failure, the brake needs to be replaced

Affix Serial Number Label Here:



@Hover1Rideables



@RideHover1



@RideHover1



[www.Hover-1.com](http://www.Hover-1.com)