



Item # 704 114  
Model #153-002-LC

## USE AND CARE GUIDE

---

### MILL VALLEY FULLY WOVEN LOUNGE CHAIR

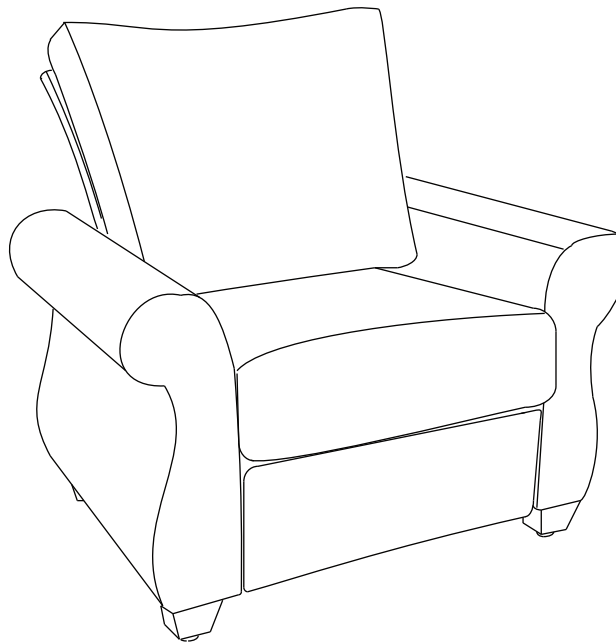

Questions, problems, missing parts? Before returning to the store,  
call Hampton Bay Customer Service  
8.00 a.m. - 7.00 p.m. EST, Monday - Friday,  
9.00 a.m. - 6.00 p.m. EST, Saturday

**1-855-HD-HAMPTON**

**HAMPTONBAY.COM**

---

#### **THANK YOU**

*We appreciate the trust and confidence you have placed in Hampton Bay through the purchase of this lounge chair. We strive to continually create quality products designed to enhance your home. Visit us online to see our full line of products available for your home improvement needs.*

*Thank you for choosing Hampton Bay!*

## Table of Contents

Table of Contents.....	2	Pre-Assembly .....	3
Safety Information.....	2	Planning Assembly .....	3
Warranty.....	2	Hardware Included.....	3
Two Year Frame, Weave & Fabric Limited Warranty .....	2	Package Contents .....	4
What Is Covered .....	2	Assembly .....	5
What Is Not Covered .....	2		
Care Instructions .....	2		

## Safety Information



**DANGER:** Please keep children out of the assembly area during assembly.



**WARNING:** Do not stand on the chairs. Do not sit on the armrests.



**CAUTION:** Use the chairs on flat ground only.

## Warranty

### TWO YEAR FRAME, WEAVE AND FABRIC LIMITED WARRANTY

#### WHAT IS COVERED

We warrant the frame, weave and fabric to be free of manufacturing defects to the original purchaser for two years.

#### WHAT IS NOT COVERED

It remains the customer's responsibility for freight and packaging charges to and from our service center. This warranty does not cover commercial use, hardware, acts of nature, fire, freezing and abusive use. In addition, purchased parts are not covered under this warranty. We reserve the right to make substitutions with similar merchandise, if the model in question is no longer in production.

## Care Instructions

Before using, wipe with a clean, dry cloth. Do not use bleach or solvents. Treat the frame with one-step liquid wax for maximum protection against UV light and salty, damp air. When not in use, store the furniture in a cool, dry place. If your set includes cushions or mesh fabric, they may be cleaned by hand with a mild solution of soap and water. Rinse the cushions thoroughly and allow to drip dry. Do not machine wash or tumble dry, as the cushions may shrink. Do not use bleach or solvents on fabrics.

You may contact our customer service department with any questions by phone at 1-855-HD-HAMPTON or visit [www.hamptonbay.com](http://www.hamptonbay.com).

# Pre-Assembly

## PLANNING ASSEMBLY

It will take two persons about 15 minutes to complete the assembly process.

## HARDWARE INCLUDED

**NOTE:** Hardware not shown to actual size.

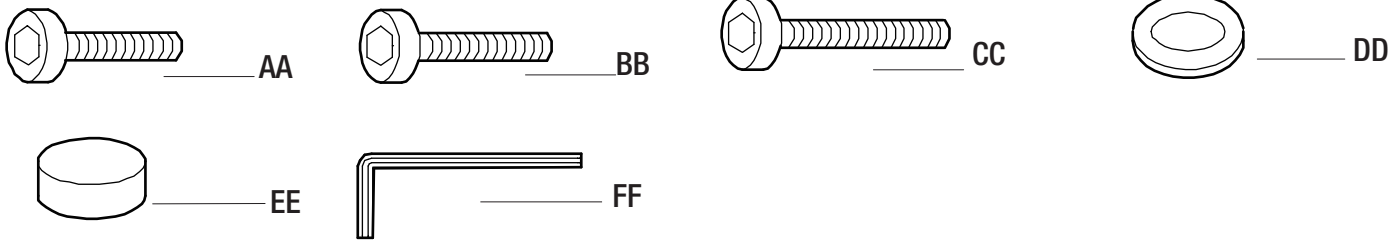

Part	Description	Quantity
AA	Bolt (M6x20)	2
BB	Bolt (M6x45)	6
CC	Bolt (M6x55)	2
DD	Washer	10
EE	Bolt Cap	10
FF	Hex wrench	1

# Pre-Assembly (continued)

## PACKAGE CONTENTS

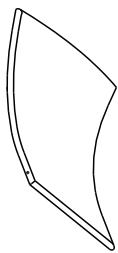

A

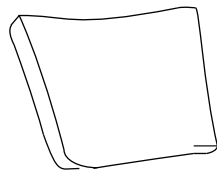

E



B

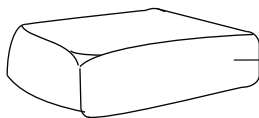

F



C

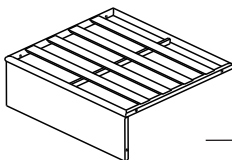

D

Part	Description	Quantity
A	Back panel	1
B	Left armrest	1
C	Right armrest	1
D	Seat panel	1
E	Back cushion	1
F	Seat cushion	1

# Assembly

## 1 Attaching armrests to the back panel

- Place the back panel (A) upside down on a flat, smooth surface.
- Attach the armrests (B) and (C) to the middle of the back panel (A) with washers (DD) and bolts (AA) using hex wrench (FF). (Fig. 1.1)
- Attach the armrests (B) and (C) to the bottom of the back panel (A) with washers (DD) and bolts (CC) using hex wrench (FF). (Fig. 1.2)



**IMPORTANT:** Do not fully tighten bolts (AA) or (CC) until the end of Step 2.

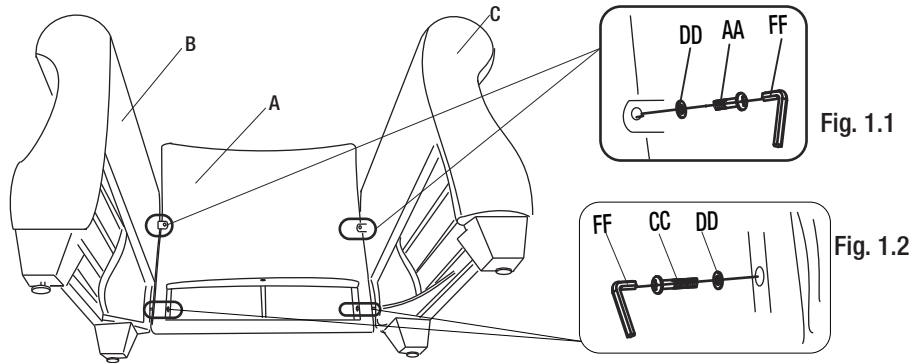

## 2 Attaching armrests to the seat panel

- Plug the seat panel (D) in the back panel (A) (Fig. 2.0).
- Attach armrests (B) and (C) to the seat panel (D) with washers (DD) and bolts (BB) using hex wrench (FF). Do not fully tighten bolts (BB) until the end of step 2. (Fig. 2.1)
- Attach armrests (B) and (C) to the seat panel (D) with washers (DD) and bolts (BB) using hex wrench (FF). (Fig. 2.2 & 2.3 )
- Fully tighten all the bolts (AA, BB and CC) and cover all bolts with bolt caps (EE).

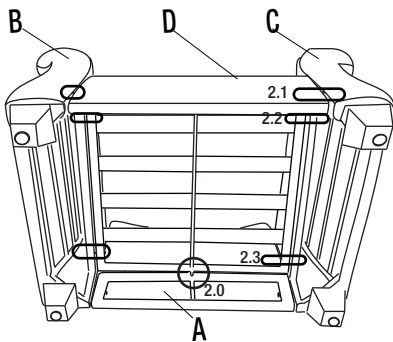

Fig .2.0

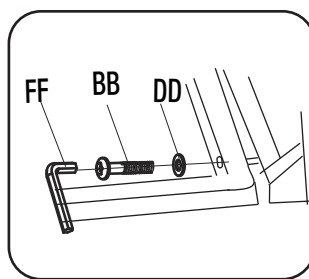
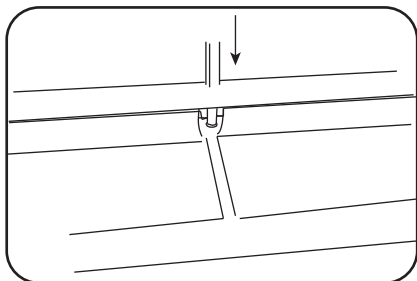
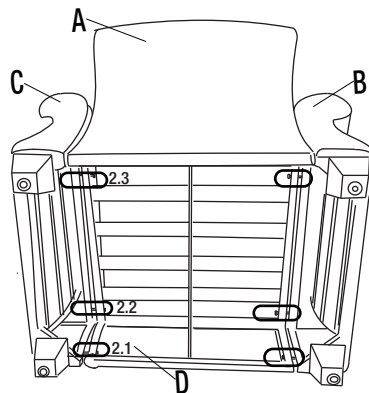

Fig .2.1

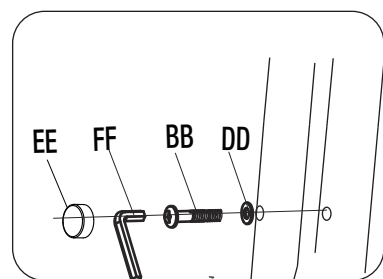

Fig. 2.2 and 2.3

## 3 Placing cushions

Turn the lounge chair upright.

Place the cushions (E) and (F) on the chair.

Level the chair with foot glides at the bottom of the chair.

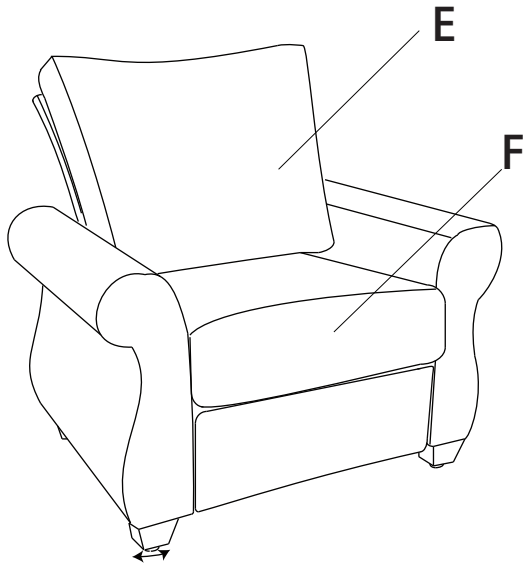



Questions, problems, missing parts? Before returning to the store,  
call Hampton Bay Customer Service  
8.00 a.m. - 7.00 p.m. EST, Monday - Friday,  
9.00 a.m. - 6.00 p.m. EST, Saturday

**1-855-HD-HAMPTON**

**HAMPTONBAY.COM**

Retain this manual for future use.