

# USER MANUAL

## TAIL LIGHTS



**Model.: WJ20-0006**

Chevy Silverado 1500/2500 1999-2002

Chevy Silverado 1500/2500 2003-2006

Chevy Silverado 3500 2001-2006

Chevy Silverado Classic Body Style 2007 (NOT FIT other models)

GMC Sierra 1500/2500 1999-2002

GMC Sierra 3500 2001-2002

# REQUIRED TOOLS

Socket



Ratchet



Flathead  
Screwdriver

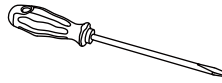

Phillips  
Screwdriver

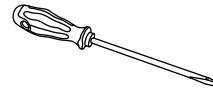

Panel  
Remover

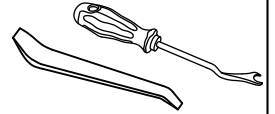

## Installation Instructions

1



2. Open the tail gate and locate the two screw and remove them.



3. Remove the taillight by pulling straight out



4. Remove all sockets from the taillight housing



5



6. Remove the bulbs from the black sockets except the reverse bulb.

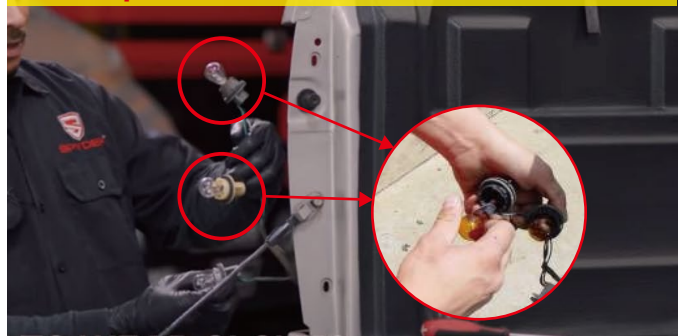

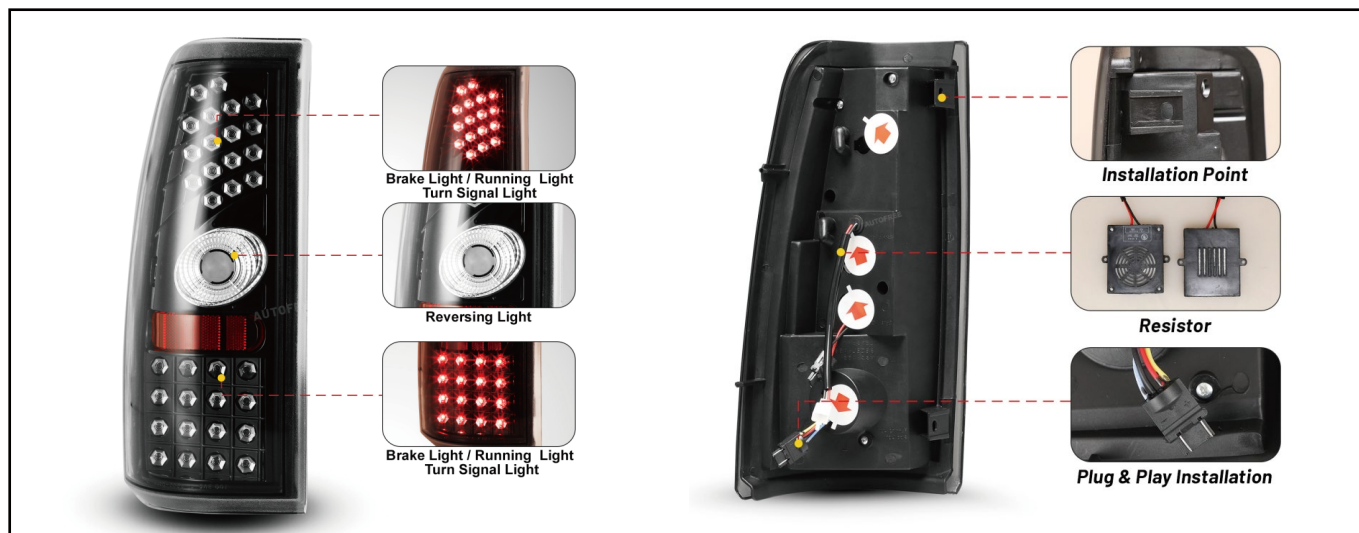

**7. Place the resistor in a safe location in the housing.**



**8. Connect the pigtails to the stock sockets. Make sure the wires match: Black to Black.**



**9. Connect the resistor to the taillight housing.**



**10. Place the taillight into the truck housing, secure with screws.**



**11**



**12. Repeat the steps 2~11 for the other side.**

