

# Manual book

## Packing List

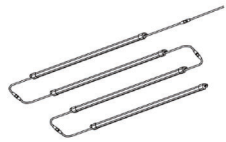

4 \* Led light bar pack

or



6 \* Led light bar pack



1\*Power cable and WIFI CONTROLLER



1 \* Double-sided tape



Cable tie

## Installation:



1. Cut appropriate length of double-sided adhesive tape to paste on backside of the Led grow strip

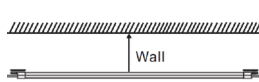

2. Remove the other side paper of the double-sided tape, Paste the strip light on a wall or shelf

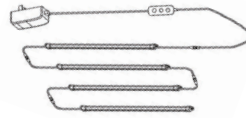

3. Connect 4pcs led strip with power cord and connect to home electricity system.



or

3. Connect 6pcs led strip with power cord and connect to home electricity system.



Scan the code to download the "Smart Life" APP, and operate the device in the APP after configuring the network according to the network configuration instructions.

## APP Instruction

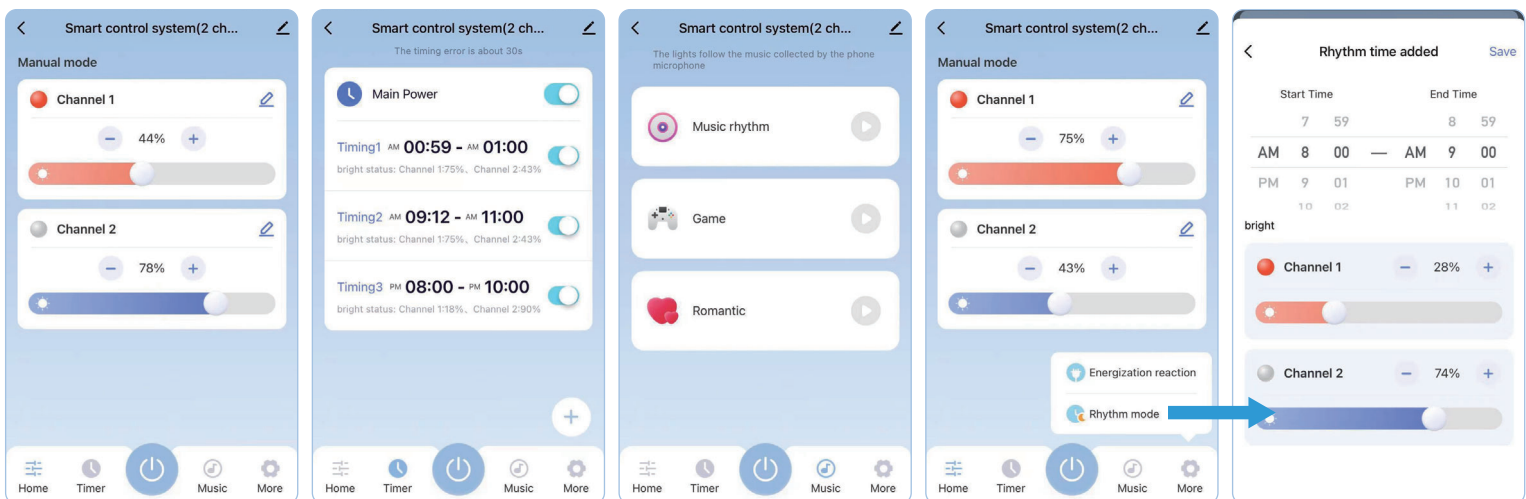

### Manual Mode

### Timing Mode

### Music Mode

### Rhythm Mode

- 1: The spectrum can be manually adjusted arbitrarily (that is, the brightness value of each channel)
- 2: You can set up to 24 sets of time-period spectrum modes, which can be executed cyclically every day after opening.
- 3: You can customize up to 5 rhythm modes (same as the timing mode setting), which can be called when needed after saving
- 4: The name and slider color of each channel can be freely set (set according to the light color of each channel)
- 5: If you need to control multiple devices at the same time, please configure all devices on the network and then group them to control multiple devices (a WIFI router can theoretically connect up to 240 devices, and it is recommended to have a maximum of 15 devices for better effect)
- 6: One device only allows one mobile phone to be connected to the network. If you need to share with multiple mobile phones, please share it with another mobile phone in the APP.

## Attention

1. Non-waterproof, Indoor used only!
2. It is recommended to use the grow light in a well ventilated place.
3. Please don't use the grow light over 18 hours continuously, otherwise its lifespan will be affected.
4. Extremely bright, do not look at directly the light when it is working.

## Warranty

1 year warranty is our promise. If your product has any problem, you can contact us by email . We will give you best solution according to your exact problem.

## **FCC Statement**

This device complies with part 15 of the FCC Rules. Operation is subject to the following two conditions:

Any Changes or modifications not expressly approved by the party responsible for compliance could void the user's authority to operate the equipment.

Note: This equipment has been tested and found to comply with the limits for a Class B digital device, pursuant to part 15 of the FCC Rules. These limits are designed to provide reasonable protection against harmful interference in a residential installation. This equipment generates uses and can radiate radio frequency energy and, if not installed and used in accordance with the instructions, may cause harmful interference to radio communications. However, there is no guarantee that interference will not occur in a particular installation. If this equipment does cause harmful interference to radio or television reception, which can be determined by turning the equipment off and on, the user is encouraged to try to correct the interference by one or more of the following measures:

(1) This device may not cause harmful interference, and (2) this device must accept any interference received, including interference that may cause undesired operation.

- Reorient or relocate the receiving antenna.
- Increase the separation between the equipment and receiver.
- Connect the equipment into an outlet on a circuit different from that to which the receiver is connected.
- Consult the dealer or an experienced radio/TV technician for help.

This equipment complies with FCC radiation exposure limits set forth for an uncontrolled environment.

This equipment should be installed and operated with minimum distance 20cm between the radiator & your body.