



**IDEXX**

SNAP® Test Quick Reference Guide

# Table of contents

SNAP test kits at a glance.....3

SNAP Pro\* Analyser .....4

SNAP\* Heartworm RT Test .....5

SNAP\* FIV/FelV Combo Plus Test .....6

SNAP\* cPL Test.....7

SNAP\* fPL Test.....8

SNAP\* Parvo Test.....9

SNAP\* Giardia Test .....10

SNAP\* Feline proBNP Test .....11

SNAP\* Lepto Test .....12

SNAP\* Foal IgG Test .....13

## Key



Supported species.



Read time in minutes.



Store at room temperature or in refrigerator.



Store in refrigerator.

**ALL components MUST be at room temperature before the test is run.**

# SNAP\* test kits at a glance

Test name†	Supported sample types				Storage* Refrigerated = 2°C–8°C Room temperature = 2°C–25°C	Sample size	Drops of solution	Read time (minutes)
	Faecal	Anticoagulated whole blood	Plasma	Serum				
SNAP® Heartworm RT Test		●	●	●	Room temperature until expiration	3 drops	4	8
SNAP® FIV/FeLV Combo Test		●	●	●	Refrigerated until expiration	3 drops	4	10
SNAP® cPL Test				●		3 drops	4	10
SNAP® fPL Test				●		3 drops	4	10
SNAP® Parvo Test	●				Room temperature until expiration	Coat entire swab tip with a thin layer of faecal material.	5	8
SNAP® <i>Giardia</i> Test	●				Refrigerated until expiration	Coat entire swab tip with a thin layer of faecal material.	5	8
SNAP® Feline proBNP Test			●	●		3 drops	5	10
SNAP® Lepto Test				●		3 drops	4	10
SNAP® Foal IgG Test		●	●	●		1 drop	Entire bottle, or until well is full	7

\*Refer to package insert for complete storage requirements.

†Before beginning any test, refer to the package insert for complete instructions.

# SNAP Pro\* Analyser

**IMPORTANT:** Prepare the SNAP test, but do not activate the test.\*

When prompted by the SNAP Pro, gently slide the SNAP test into the port at the bottom of the analyser (well end first) until it clicks into position.



When analysis is complete, results are shown on the results screen and are saved on the analyser automatically. The color of the status light indicates the results of the run:



**Solid green**

All results are negative.



**Flashing blue**

At least one result is positive.



**Flashing yellow**

Visual confirmation needed.  
(See operator's guide for more information).

## Interpreting SNAP Pro icons

Icon	Description
	Wireless (Wi-Fi) signal status (5 gray bars = best signal; 5 red bars = no signal)
	Lost Wi-Fi communication
	Connected and communicating with the IDEXX VetLab® Station via a wired connection (red icon indicates the analyser is off-line)
	Lost Ethernet connection
	Battery charging

Icon	Description
	Software upgrade is available (SmartService® Solutions customers only)
	Warning notification (grey icon indicates the warning has been viewed and is unresolved)
	Error notification (grey icon indicates the error has been viewed and is unresolved)
	Lost communication with IDEXX VetLab Station

For more information or to order this product, visit [idexx.com.au/prohelp](https://idexx.com.au/prohelp).

\*Before beginning any test, refer to the package insert for complete instructions.

# SNAP® Heartworm RT Test

Screen annually for heartworm.



## Test procedure\*

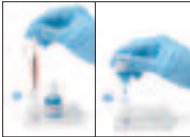

1. Using the provided pipette, dispense **3 drops of sample** and **4 drops of conjugate** to the sample tube.



2. Gently **invert 3–5 times** to mix.



3. Pour the entire contents of the sample tube into the sample well of a SNAP Heartworm RT device.

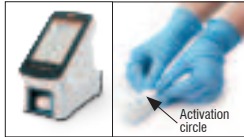

4. Use the SNAP Pro® Analyser to automatically activate the SNAP test and interpret the result.  
**OR**  
When colour **first** appears in the activation circle, press firmly to activate. You will hear a distinct “snap.”



5. Read the result at **8 minutes**.

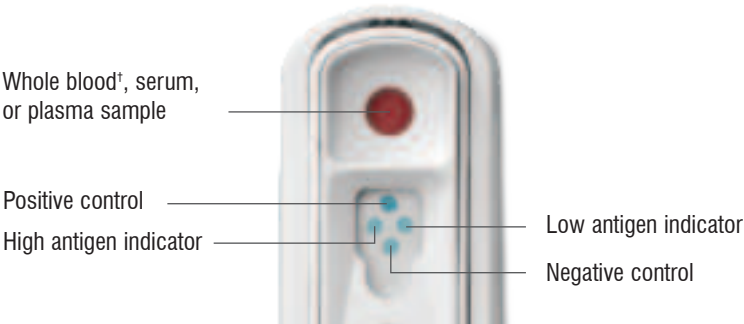

\*Before beginning any test, refer to the package insert for complete instructions.  
†Anticoagulated whole blood (e.g., EDTA, heparin)

# SNAP® FIV/FeLV Combo Plus Test

Test all new-to-household, at-risk, and symptomatic cats for feline immunodeficiency virus (FIV) and feline leukaemia virus (FeLV).



## Test procedure\*



1. Using the provided pipette, dispense **3 drops of sample** and **4 drops of conjugate** to the sample tube.



2. Gently **invert 3–5 times** to mix.



3. Pour the entire contents of the sample tube into the sample well of a SNAP FIV/FeLV Combo device.

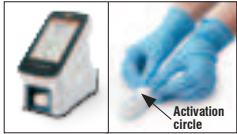

4. Use the SNAP Pro® Analyser to automatically activate the SNAP test and interpret the result.  
**OR**  
When colour **first** appears in the activation circle, press firmly to activate. You will hear a distinct “snap.”

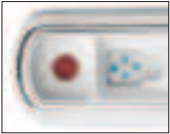

5. Read the result at **10 minutes**.

Whole blood†, serum,  
or plasma sample

Positive control

FIV Ab

FeLV Ag

Negative control

\*Before beginning any test, refer to the package insert for complete instructions.  
†Anticoagulated whole blood (e.g., EDTA, heparin)

# SNAP\* cPL Test

Test dogs that present with vomiting, anorexia, and/or abdominal pain.



## Test procedure\*



1. Using the provided pipette, dispense **3 drops of sample** and **4 drops of conjugate** to the sample tube.



2. Gently **invert 3–5 times** to mix.



3. Pour the entire contents of the sample tube into the sample well of a SNAP cPL device.

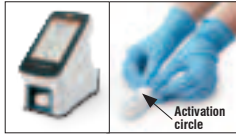

4. Use the SNAP Pro\* Analyser to automatically activate the SNAP test and interpret the result.

### OR

When colour **first** appears in the activation circle, press firmly to activate. You will hear a distinct “snap.”



5. Read the result at **10 minutes**.

Serum sample

Reference

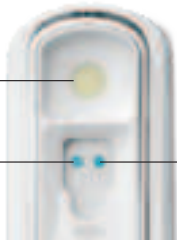

### Abnormal

Sample spot is the same colour or darker than reference spot.

Pancreas-specific lipase



### Normal

Sample spot is lighter than reference spot.

\*Before beginning any test, refer to the package insert for complete instructions.

# SNAP\* fPL Test

Test cats that present with lethargy, decreased appetite, dehydration, weight loss, vomiting, and/or diarrhoea.



## Test procedure\*

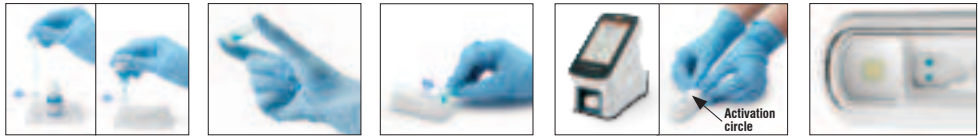

1. Using the provided pipette, dispense **3 drops of sample** and **4 drops of conjugate** to the sample tube.
2. Gently **invert 3–5 times** to mix.
3. Pour the entire contents of the sample tube into the sample well of a SNAP iPL device.
4. Use the SNAP Pro\* Analyser to automatically activate the SNAP test and interpret the result.  
**OR**  
When colour **first** appears in the activation circle, press firmly to activate. You will hear a distinct “snap.”
5. Read the result at **10 minutes**.

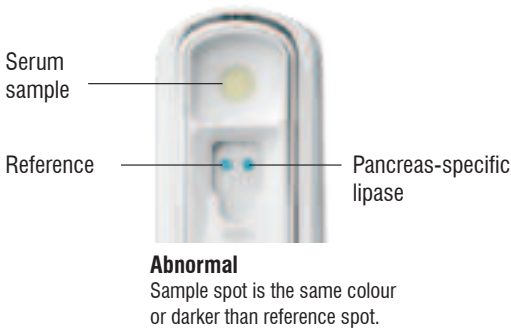

\*Before beginning any test, refer to the package insert for complete instructions.



# SNAP<sup>®</sup> Parvo Test

Test dogs that present with sudden onset of lethargy, vomiting, fever, and diarrhoea.



Can be stored at room temperature.\*

## Test procedure<sup>†</sup>

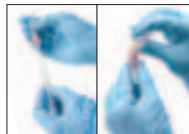

1. Swab sample<sup>‡</sup> and place swab tip into tube. Bend bulb to break seal and release conjugate.



2. Squeeze and release bulb **3 times** to mix sample and conjugate.



3. Squeeze bulb to dispense **5 drops** into the sample well of a SNAP Parvo device.

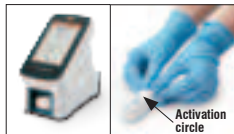

4. Use the SNAP Pro<sup>®</sup> Analyser to automatically activate the SNAP test and interpret the result.

### OR

When colour **first** appears in the activation circle, press firmly to activate. You will hear a distinct “snap.”



5. Read the result at **8 minutes**.

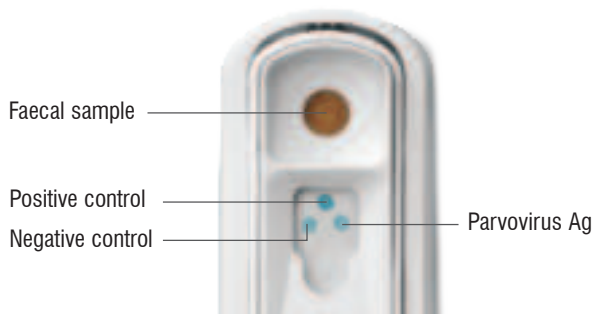

\*Refer to package insert for complete storage requirements.

<sup>†</sup>Before beginning any test, refer to the package insert for complete instructions.

<sup>‡</sup>The collection swab is not intended to be used rectally.

# SNAP\* Giardia Test

Test dogs and cats that present with diarrhoea.



## Test procedure\*

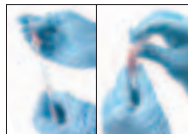

1. Swab sample† and place swab tip into tube. Bend bulb to break seal and release conjugate.



2. Squeeze and release bulb **3 times** to mix sample and conjugate.



3. Squeeze bulb to dispense **5 drops** into the sample well of a SNAP *Giardia* device.

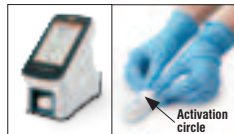

4. Use the SNAP Pro\* Analyser to automatically activate the SNAP test and interpret the result.

### OR

When colour **first** appears in the activation circle, press firmly to activate. You will hear a distinct "snap."



5. Read the result at **8 minutes**.

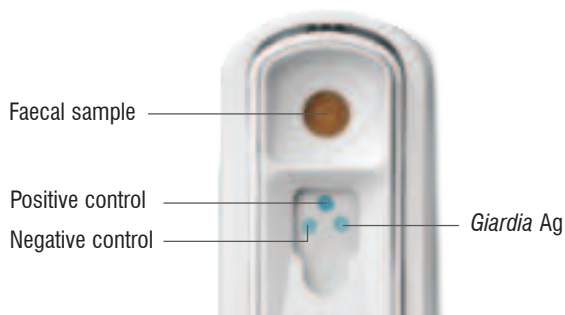

\*Before beginning any test, refer to the package insert for complete instructions.

†The collection swab is not intended to be used rectally.

# SNAP<sup>®</sup> Feline proBNP Test

Test cats at risk for cardiac disease (murmur, arrhythmia, respiratory signs, prior to anaesthesia, breed, history, age).

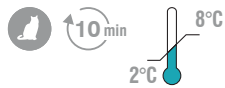

## Test procedure\*

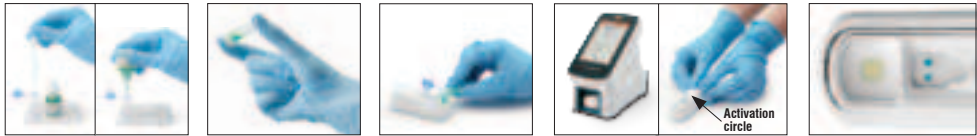

1. Using the provided pipette, dispense **3 drops of sample** and **5 drops of green conjugate** to the sample tube.
2. Gently **invert 3–5 times** to mix.
3. Pour the entire contents of the sample tube into the sample well of a SNAP Feline proBNP device.
4. Use the SNAP Pro<sup>®</sup> Analyser to automatically activate the SNAP test and interpret the result.  
**OR**  
When colour **first** appears in the activation circle, press firmly to activate. You will hear a distinct “snap.”
5. Read the result at **10 minutes**.

Serum or EDTA  
plasma sample

Reference

NT-proBNP

### Abnormal

Sample spot is the same colour or darker than reference spot.

### Normal

Sample spot is lighter than reference spot.

\*Before beginning any test, refer to the package insert for complete instructions.

# SNAP<sup>®</sup> Lepto Test

Test dogs when leptospirosis is suspected.



## Test procedure\*



1. Using the provided pipette, dispense **3 drops of sample** and **4 drops of conjugate** to the sample tube.



2. Gently **invert 3–5 times** to mix.



3. Pour the entire contents of the sample tube into the sample well of a SNAP Lepto device.

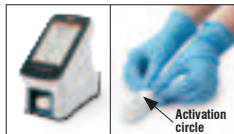

4. Use the SNAP Pro<sup>®</sup> Analyser to automatically activate the SNAP test and interpret the result.

### OR

When colour **first** appears in the activation circle, press firmly to activate. You will hear a distinct “snap.”



5. Read the result at **10 minutes**.

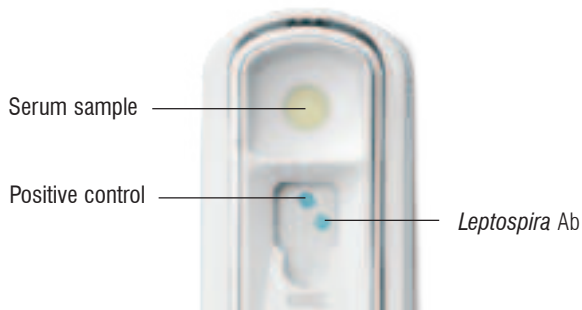

\*Before beginning any test, refer to the package insert for complete instructions.

# SNAP\* Foal IgG Test

Test foals for immunoglobulin G (IgG) levels.



## Test procedure\*

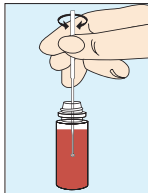

1. Dilute sample.<sup>†</sup>  
Mix thoroughly and dispose of the first **5–10 drops** from the bottle.

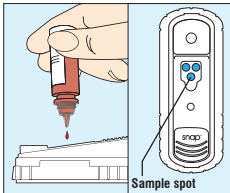

2. Apply **1 drop** of sample over sample spot.

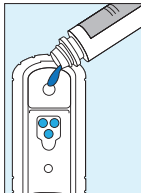

3. Pour the entire bottle of conjugate into the sample well.

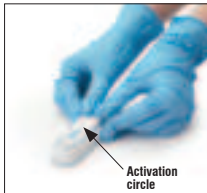

4. When colour **first** appears in the activation circle, press firmly to activate. You will hear a distinct "snap."



5. Read the result at **7 minutes**.

Whole blood<sup>†</sup>,  
serum, or  
plasma sample

400 mg/dL  
calibrator spot

Sample spot

800 mg/dL  
calibrator spot

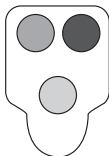
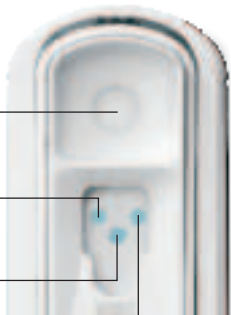

### ≤400 mg/dL IgG

Colour intensity of sample spot is lighter than or equal to the 400 mg/dL calibrator spot.

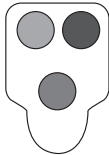

### 400–800 mg/dL IgG

Colour intensity of sample spot is darker than the 400 mg/dL calibrator spot but lighter than or equal to the 800 mg/dL calibrator spot.

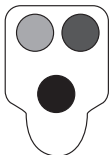

### >800 mg/dL IgG

Colour intensity of sample spot is darker than the 800 mg/dL spot.

\*Before beginning any test, refer to the package insert for complete instructions.

<sup>†</sup>Anticoagulated whole blood (e.g., EDTA, heparin), serum, or plasma sample.

For more information on any of our tests please visit  
[idexx.com.au](https://idexx.com.au)

Have questions?

Contact IDEXX Customer and Technical Support  
at **1300 44 33 99**.

