

Ice Maker

Instruction Manual

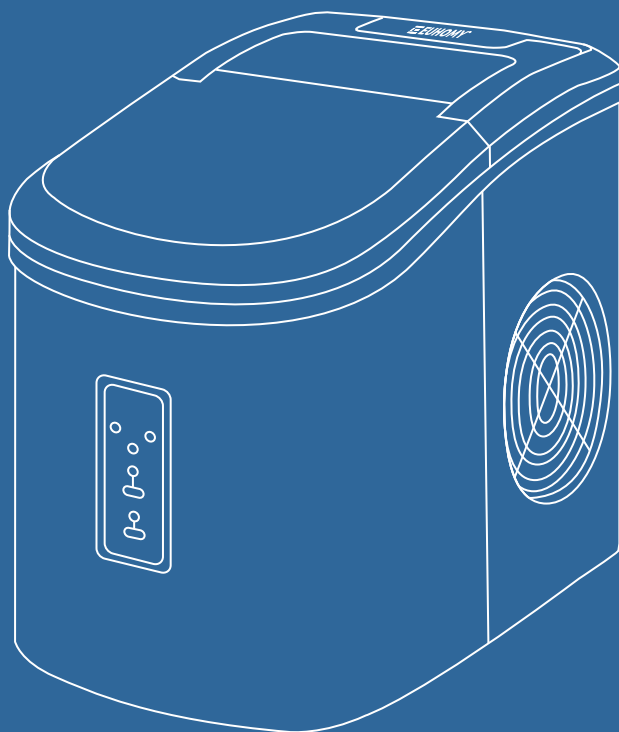

Model:IM-01

Email:euhomey@hotmail.com

Facebook:[@Euhomey](https://www.facebook.com/Euhomey)

Congratulations on your new Euhomey product. To ensure proper operation, please read this Instruction Manual carefully before using this product. Keep this manual in a safe place for future reference.

Congratulations

Dear Customer, So lucky to meet you guys !!!
Thanks for making a purchase on Euhomy!

We hope to provide you with sincere service. If there is anything missing or wrong with your order, If you have any question about using our Ice Maker. PLEASE reach out to us.
Email-(euhomey@hotmail.com) or Facebook-([@Euhomy](#)).

Euhomy team will answer your doubts online for 24 hours. Your satisfaction is our ultimate goal. We'd appreciate if you could share your experience with other shoppers on Amazon. We'd love to make it right for you! If you just want to see the problem description, you can directly see the tenth page, Or contact us directly. Email:euhomey@hotmail.com

Our Mission: To be the most trusted appliance brand, Create compact and practical appliance to better your life.

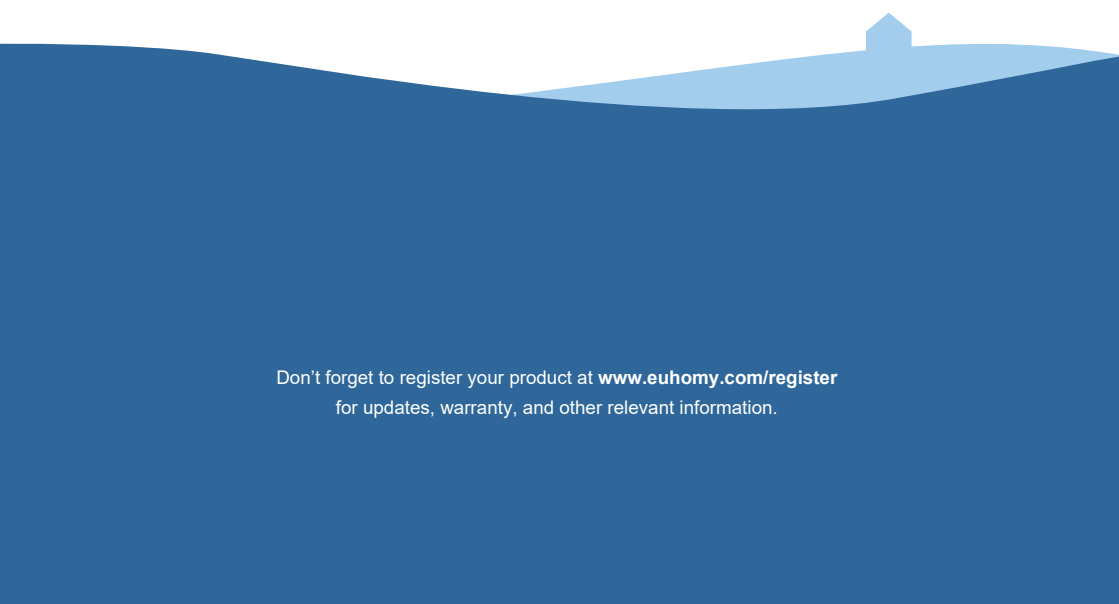

Don't forget to register your product at www.euhomy.com/register
for updates, warranty, and other relevant information.

I Q&A

1.How often do I need to clean my ice maker?

Depending on your usage habits, if you use it frequently, it is recommended that you clean it at least once a week. Failure to clean the machine will cause scale accumulation, which will eventually block the pump and cause the product to fail to work.

2.How should I clean the machine?

It is recommended to use lemon water or weak acid vinegar for cleaning. Drain immediately after cleaning, and then clean it with pure water.

It is recommended to drain water at least once every three days. Draining can not only ensure that the hardness of the water is not too high, but also ensure that impurities can be discharged well, and it is not easy to produce scale in the water tank.

3.Why is my ice cube cloudy?

It means that your water quality is turbid. It is recommended to use drinking water and distilled water. If your water quality problem is serious, it is recommended that you install a water filter kit.

4.Can I put milk and juice into the water tank to make ice cubes?

It is recommended that you do not do that. Our research has found that the high concentration of milk and beverages can easily block the pump and reduce the life of the pump. At the same time, the protein in milk is prone to calcification, which chemically reacts with the PU water pipe inside the machine, which easily breaks it, making the product unable to continue working.

5.Why does my ice cube melt easily?

Because the ice maker is not a refrigerator, it does not have a heat preservation function. The high ambient temperature in summer will accelerate the melting of ice cubes. You can close the lid of the machine to keep the internal temperature. Some customers also put electric fans on the side of the machine to blow away the hot air around, thus solving the problem, you can try. However, if you are not using ice cubes for a long time, we recommend removing them from the ice basket and storing them in the refrigerator.

6.Why is my ice cube so thick and what should I do?

It may be that your ice making time is set too long, or it may be that the temperature of your environment is low. You can try to adjust the size of the ice cubes.

7.Why does the ice cube I made have a plastic smell?

The ice cube itself has no taste. If you feel there is a plastic smell, try to clean the inside of the machine with lemon water, then run a few cycles, and finally rinse with distilled water.

8.Why is there noise in the operation of my machine?

There is a faint sound when the machine is running. Closing the lid can reduce the noise. If the water pump makes noise during use, it is recommended to turn off the machine first, and then turn on the machine after cleaning the filter in the water tank to observe whether the noise disappears.

9.Why is water leaking from my machine?

It may be that the PUA tube inside the machine fell off during transportation. You can remove the back cover of the machine and connect it by yourself. If you don't know how to operate, please contact the Euhomy team. We will give you a professional video to help you solve the problem.

10.Why is there water flowing but not making ice?

If you make sure that the ambient temperature is not abnormal, then the refrigerant of the machine has leaked. Please provide a video or picture and send it to us, and the Euhomy team will help you.

Contents

Safety precautions	2-4
Operation & Installation	5-7
Maintenance & Tips	8
Warranty	9
Troubleshooting-euhomy@hotmail.com	10

| Safety Precautions

SAVE THESE INSTRUCTIONS / For Household Use Only



When using electrical appliances, basic safety precautions should always be followed:

- Do not use this appliance near water.
- Clean only with a damp cloth.
- Do not block any ventilation openings. Install in accordance with the manufacturer's instructions.
- Do not install near any heat sources such as radiators, heat registers, stoves, or other apparatus (including amplifiers) that produce heat.
- Do not defeat the safety purpose of the polarized or grounding-type plug. A polarized plug has two blades with one wider than the other. A grounding type plug has two blades and a third grounding prong. The wide blade or the third prong are provided for your safety. If the provided plug does not fit into your outlet, consult an electrician for replacement of the obsolete outlet.
- Protect the power cord from being walked on or pinched particularly at plugs, convenience receptacles, and the point where they exit from the appliance.
- Do not attempt to modify or extend the power cord of this appliance.
- Unplug this appliance during lightning storms or when it will not be used for long periods of time.
- Unplug this appliance before cleaning it.
- Make sure that the available AC power matches the voltage requirements of this appliance.
- Do not handle the plug with wet hands. This could result in an electric shock.
- Unplug the power cord by holding the plug, never by pulling the cord.
- Do not turn the appliance on or off by plugging or unplugging the power cord.
- Turn off the appliance before unplugging it.
- Refer all servicing to qualified service personnel. Servicing is required when the appliance has been damaged in any way, such as the power-supply cord or plug is damaged, liquid has been spilled or objects have fallen into the appliance, the appliance has been exposed to rain or moisture, does not operate normally, or has been dropped.
- To reduce the risk of fire or electric shock, do not expose this appliance to rain, moisture, dripping, or splashing, and no objects filled with liquids should be placed on top of it.
- This appliance is not intended for use by persons (including children) with reduced physical, sensory or mental capabilities, or lack of experience and knowledge, unless they have been given supervision or instruction concerning the use of the appliance by a person responsible for their safety.
- Do not use your ice maker outdoors. Place the ice maker away from direct sunlight and make sure that there is at least four inches of space between the back of your unit and wall. Keep a minimum distance of four inches on each side of your unit free.
- Do not use liquids other than water to make ice-cubes.
- Do not clean your ice maker with flammable fluids. The fumes can create a fire hazard or explosion.
- Do not tip over.

| Safety Precautions

Note:

- Fill with potable water only. Only use drinking water.
Do not touch the evaporator when the ice maker is making ice, it may burn your skin.
This appliance must be earthed.

Risk Of Fire or Explosion- Flammable Refrigerant Used

- Do Not Use Mechanical Devices To Defrost Ice Maker. Do Not Puncture Refrigerant Tubing.
- To Be Repaired Only By Trained Service Personnel. Do Not Puncture Refrigerant Tubing.
- Consult Repair Manual/Owner's Guide Before Attempting To Install or Service This Product.
All Safety Precautions Must be Followed.
- Dispose Of Property In Accordance With Federal Or Local Regulations.
- Follow Handling Instructions Carefully.
- The ice maker should be installed in accordance with the safety standard for Refrigeration Systems, ASHRAE15. The ice maker shall not be installed in corridors or hallways of public buildings.
- If the unit is with problem need to be maintained, that replacing with like components and that servicing shall be done by factory authorized service personnel, so as to minimize the risk of possible ignition due to incorrect parts or improper service.

This appliance must be plugged into at least a 15 A, 110 - 115 V, 60 Hz GROUNDED OUTLET. This appliance must be grounded. It is equipped with a 3-wire cord grounding plug. The plug must be plugged into an outlet that is properly installed and grounded.

Electric Shock Hazard

Failure to follow these instructions can result in electric shock, fire, or death.

- Keep ventilation openings in the ice maker clear of obstruction.
- Do not damage the refrigerant tubing when handling, moving, or using the ice maker.
- Never allow children to play with or operate the ice maker.
- Unplug the ice maker before carrying out user maintenance on it.

| Safety Precautions

- If a component part is damaged, it must be replaced by the manufacturer, its service agent, or similar qualified persons in order to avoid a hazard.
- Follow local regulations regarding disposal of the ice maker due to flammable refrigerant and gas. All refrigeration products contain refrigerants, which under the guidelines of federal law must be removed before disposal. It is the consumer's responsibility to comply with federal and local regulations when disposing of this product.
- This ice maker is intended to be used in household and similar environments.
- We do not recommend the use of an extension cord with this appliance. If you must use an extension cord, use one with a minimum of 14 AWG wiring and rated at no less than 1875 Watts.
- Avoid the use of an extension cord because it may overheat and cause a risk of fire. However, if it is necessary to use an extension cord:
Use only 3-wire extension cords with 3-blade grounding plug.
- The marked rating of an extension cord must be equal to or greater than the rating of this appliance.
- It should be positioned such that it does not drape over the counter or tabletop where it can be pulled on by children.

I Operation & Installation

ASSEMBLY AND PARTS

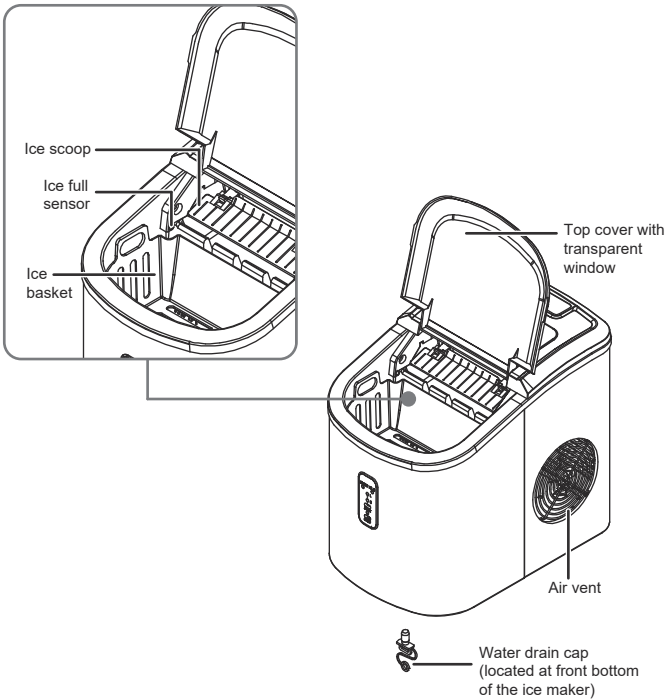
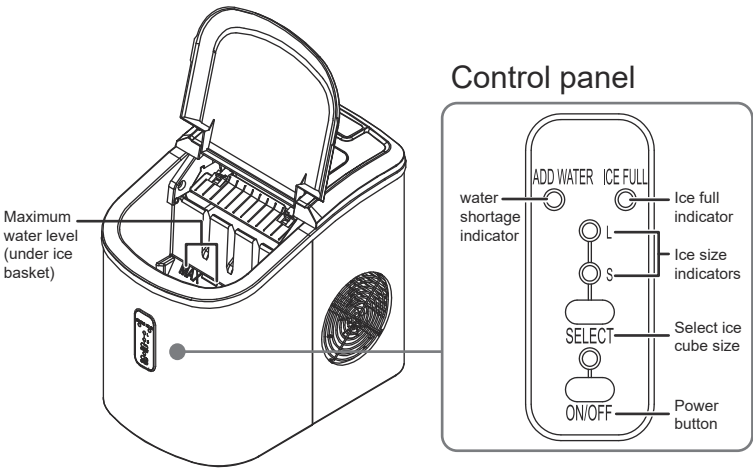

I Operation & Installation

BEFORE FIRST USE

- This portable ice maker uses a fully-automatic control system, with an advanced microcomputer for easy and convenient ice making. Making ice is simple and fast. Just add water, plug into an outlet, and press the ON/OFF button. You can select one of the two ice cube sizes with the touch of a button.
- When first turning on the unit or during ice-making cycles, the compressor will stay idle for 3 minutes, while energizing.
- There are warning indicators that alert you to fill water when the reservoir is empty, and to remove ice when the storage basket is full. The icemaker also has built-in safeguards that can limit accidental damage, automatically shutting down the system when necessary.

Note:

- The incline angle of the ice maker cabinet should not exceed 45° during transportation or use. Do not turn the icemaker upside down. Inverting the ice maker could cause the compressor or refrigerating system to operate incorrectly. When the ice maker is moved or transported, please allow time for the fluids in the compressor to settle. Before using the ice maker for the first time, please wait 2 hours after the unit has been leveled and positioned in its proper place.
- Please ensure the ice maker is level and on a stable table or platform to avoid malfunction.
- The machine must be placed on a dry and level surface with sufficient ventilation, far from heat sources such as ovens, heaters and corrosive gases. Leave an 8" (20 cm) clearance on all sides of the ice maker for proper ventilation.
- Do not fill the water reservoir with hot water. This may damage the ice maker. It is best to fill the water reservoir with water of room temperature or lower. Please ensure the ice maker is level and on a stable table or platform to avoid malfunction.

PREPARING YOUR ICE MAKER

- Remove the exterior and interior packaging.
- Make sure that the ice basket and ice scoop are inside. If any parts are missing, please contact customer service.
- Remove the tape holding the ice scoop and ice basket.
- Clean the tank and ice basket with diluted detergent, warm water, and a soft cloth.
- Allow one hour for the refrigerant fluid to settle, then plug the ice maker in to a grounded wall outlet.

USE YOUR ICE MAKER

Prior to using your ice maker each time, wipe out the interior with a clean, damp cloth.

- Making Ice Ensure that the drain plug underneath the front of the unit is closed and the water tube screen is in place.
- Plug the ice maker into the wall outlet and the green power indicator light.
- Open the cover and remove the ice basket.

Fill the water reservoir. NOTE: do not fill above the max water level mark at the back of the

- water reservoir.

Replace the ice basket and close the cover.

- Press the ON/OFF button and the green POWER LED will light signifying that the unit is on. To
- change between either the small or large ice size, press the SELECT button until the desired ice size is indicated.

I Operation & Installation



If the room temperature is below 60° F (15.6° C), select the SMALL ice cube size to prevent the ice cubes from sticking together. Press and hold the SELECT button for five seconds to run 8 continuous cycles, even when the ICE FULL indicator is on.

- The ice making cycle will last approximately 8-13 minutes depending on the ice size that is selected. The ice making cycle starts with water being pumped into the Water Tray situated below the Evaporator Fingers. Over the next 8-13 minutes ice forms on the Evaporator Fingers. Once this has completed, the Ice Tray will tilt backwards and the remaining water in the Ice Tray is drained back into the Water Reservoir. The ice cubes are then dropped from the Evaporator Fingers and pushed forward into the Ice Basket by the Ice Shovel. The Ice Tray will automatically move back into position under the Evaporator Fingers and start the next cycle.
- The ICE FULL LED light will light up when the ice basket is full and the Ice Maker will stop the ice making cycle automatically. Gently remove the ice from the Ice Basket with the Ice Scoop. Once the Ice Basket has been emptied and the Cover closed, the Ice Maker will restart its ice making function automatically.
- The ADD WATER LED light will light up when there is no more water in the Water Reservoir, and the ice making cycle will stop automatically. Press the Power Button once (the Power Button will flash every 5 seconds), remove the ice basket, and add water to the Water Reservoir.



Do not fill above the MAX water level mark at the back of the Water Reservoir. Replace the ice basket, and close the Cover. Wait 3 minutes then press the Power Button to restart the ice making function.

- When you have finished making ice, transfer the ice to a freezer. The ice will last in the Ice Maker for up to a 18 hour period, depending on the ambient temperature. Stop the ice making cycle by pressing the Power Button. Unplug the unit from the wall outlet. Open the Cover and allow the Ice Maker to reach room temperature and follow the directions in the Care and Cleaning section.
- Direct sunlight or reflected sunlight may cause the infrared sensor to malfunction. If the unit does not stop making ice cubes even when full, move the ice maker to a darker location. You must change the water in the tank at least every 24 hours to ensure a reasonable hygiene level and avoid bad smelling ice.

| Maintenance & Tips

MAINTENANCE

- Your ice maker is designed for year-round use with only minimal cleaning and maintenance. When you first receive it, wipe the outside with a mild detergent and warm water, then wipe dry with a dry cloth. Do this periodically to keep your ice maker looking new.

Note:

- To prevent damage to the finish, do not use:
Gasoline, benzine, thinner, or other similar solvents.
Abrasive cleaners.

TIPS & SUGGESTIONS

- Stop the ice-making cycle by pressing the POWER button. the green LED light will go out, indicating the ice maker is off. Unplug the Ice Maker from the wall outlet and allow the unit to warm up to room temperature.
- If the Water Tray is not in the vertical position behind the Evaporator Fingers, gently push the Water Tray back so that all water drains into the Water Reservoir.
- Open the Drain Plug to drain out excess water.
- Remove the Ice Basket.
- Remove the Water Tube Screen and rinse under running water.
- Clean the Ice Maker interior with a soft cloth dampened in warm water and vinegar. Rinse with a clean, damp cloth.
- Replace the Drain Plug and the Water Tube Screen. Wash the Ice Basket and Ice Scoop in warm soapy water. Rinse and dry.
- Clean the exterior of the Ice Maker with a soft, damp cloth. Use a mild dishwashing soap if necessary.
- Do not clean the Evaporator Fingers.
- Locate your ice maker in the coolest area of the room, away from heat producing appliances or heating ducts and out of the direct sunlight.
- Make sure that the appliance is sufficiently ventilated, with adequate air circulation behind it.

| Warranty

Euhomy offers a limited 1-year warranty ("warranty period") on all of our products purchased new and unused from Euhomy company, with an original proof of purchase and where a defect has arisen, wholly or substantially, as a result of faulty manufacture, parts or workmanship during the warranty period. The warranty does not apply where damage is caused by other factors, including without limitation:

- (a) normal wear and tear;
- (b) abuse, mishandling, accident, or failure to follow operating instructions;
- (c) exposure to liquid or infiltration of foreign particles;
- (d) servicing or modifications of the product other than by Euhomy;
- (e) commercial or non-household use.

The Euhomy warranty covers all costs related to restoring the proven defective product through repair or replacement of any defective part and necessary labor so that it conforms to its original specifications. A replacement product may be provided instead of repairing a defective product. Euhomy's exclusive obligation under this warranty is limited to such repair or replacement. A receipt indicating the purchase date is required for any claim, so please keep all receipts in a safe place. Although greatly appreciated, the product registration is not required to activate any warranty and product registration does not eliminate the need for the original proof of purchase. The warranty becomes void if attempts at repair are made by non-authorized third parties and/or if spare parts, other than those provided by Euhomy, are used.

You may also arrange for service after the warranty expires at an additional cost. These are our general terms for warranty service, but we always urge our customers to reach out to us with any issue, regardless of warranty terms. If you have an issue with a Euhomy product, please contact us (euhomy@hotmail.com), and we will do our best to resolve it for you.

Troubleshooting-euhomy@hotmail.com

PROBLEM	POSSIBLE CAUSES	SOLUTION
ADD WATER indicator light turns on.	<ul style="list-style-type: none"> Low water level or lack of water. 	<ul style="list-style-type: none"> Add water and the ice maker will operate automatically
There is no indication on the control panel	<ul style="list-style-type: none"> Plug disconnected. 	<ul style="list-style-type: none"> Check that the plug is plugged into the electrical outlet.
The ice cubes stick together	<ul style="list-style-type: none"> The water temperature is too cold. 	<ul style="list-style-type: none"> Replace the water with warmer water.
	<ul style="list-style-type: none"> The ice making cycle is too long. 	<ul style="list-style-type: none"> Stop the ice maker, wait for the ice to melt, then restart the ice maker after selecting SMALL sized ice cubes.
ICE FULL and ADD WATER indicators light up simultaneously.	<ul style="list-style-type: none"> Electrical power surge. Air in the lines or the lines are blocked. The water tank cannot detect water level. 	<ul style="list-style-type: none"> Turn off ice maker, unplug from electrical outlet, refill water if required replace the plug, then restart the unit. Inspect relative parts. Remove the drain cap on the back of the unit and drain out a small amount of water. Replace cap and restart ice maker. Check if ice is blocking the ice pusher. Turn off the ice maker, let the ice melt, then restart.
The ICE FULL indicator light is on.	<ul style="list-style-type: none"> The ice basket is full. 	<ul style="list-style-type: none"> Remove ice from the ice storage basket to make more.
The unit does not operate.	<ul style="list-style-type: none"> Power is not being supplied to the unit. The ambient temperature or the water temperature is too high. 	<ul style="list-style-type: none"> Plug the unit into a standard 110/120 V/60 Hz, power source. Please run the ice maker in temperatures below 32°C (90°F) and/or pour colder water into the water reservoir.
Ice blockage. No ice is being made.	<ul style="list-style-type: none"> Making ice takes too much time 	<ul style="list-style-type: none"> Turn off the machine. Start the machine after the ice block melts. Or change the size selector to small ice cubes.
The ice-making cycle seems normal but no ice is produced.	<ul style="list-style-type: none"> There is refrigerant leakage. A pipe in the cooling system is blocked. 	<ul style="list-style-type: none"> Consult a qualified technician or call customer service
	<ul style="list-style-type: none"> The room temperature or water temperature is too high. 	<ul style="list-style-type: none"> The room temperature should be 50°F-105°F (10°-40.6° C), water temperature should be 40°F - 90°F (4.44° C - 32.2° C).
The ice maker won't stop making ice	<ul style="list-style-type: none"> Direct or reflected sunlight can cause the sensor to malfunction. 	<ul style="list-style-type: none"> Move the ice maker to a darker location.

Thank you for selecting our quality appliance. Please be sure to read this user manual carefully before using. Any question, please contact the professional service for help.

Model:IM-01

Email:euhomey@hotmail.com

Facebook:Euhomy



👍 Like us



Euhomy



Scan me