

Klipsch Jamo
ENERGY < MIRAGE >

(Works Only with Subwoofers with a WA Port)

WA-2 Wireless Subwoofer Kit

Owner's Manual

IMPORTANT SAFETY INSTRUCTIONS!

1. READ these instructions.
2. KEEP these instructions.
3. HEED all warnings.
4. FOLLOW all instructions.
5. DO NOT use this apparatus near water.
6. CLEAN ONLY with dry cloth.
7. DO NOT block any ventilation openings. Install in accordance with the manufacturer's instructions.
8. DO NOT install near any heat sources such as radiators, heat registers, stoves, or other apparatus (including amplifiers) that produce heat.
9. DO NOT defeat the safety purpose of the polarized or grounding type plug. A polarized plug has two blades with one wider than the other. A grounding type plug has two blades and a third grounding prong. The wider blade or the third prong are provided for your safety. If the provided plug does not fit into your outlet, consult an electrician for replacement of the obsolete outlet.
10. PROTECT the power cord from being walked on or pinched, particularly at plugs, convenience receptacles, and the point where they exit from the apparatus.
11. ONLY USE attachments/accessories specified by the manufacturer.
12. USE only with a cart, stand, tripod, bracket, or table specified by the manufacturer, or sold with the apparatus. When a cart is used, use caution when moving the cart/apparatus combination to avoid injury from tip-over. 
13. UNPLUG this apparatus during lightning storms or when unused for long periods of time.
14. REFER all servicing to qualified service personnel. Servicing is required when the apparatus has been damaged in any way, such as power-supply cord or plug is damaged, liquid has been spilled or objects have fallen into the apparatus, the apparatus has been exposed to rain or moisture, does not operate normally, or has been dropped.
15. DO NOT expose this apparatus to dripping or splashing and ensure that no objects filled with liquids, such as vases, are placed on the apparatus.
16. To completely disconnect this apparatus from the AC Mains, disconnect the power supply cord plug from the AC receptacle.
17. The mains plug of the power supply cord shall remain readily operable.





The exclamation point, within an equilateral triangle, is intended to alert the user to the presence of important operating and maintenance (servicing) instructions in the literature accompanying the product.



The lightning flash with arrowhead symbol within an equilateral triangle, is intended to alert the user to the presence of uninsulated "dangerous voltage" within the product's enclosure that may be of sufficient magnitude to constitute a risk of electrical shock to persons.

WARNING: To reduce the risk of fire or electrical shock, do not expose this apparatus to rain or moisture.

WARNING: No naked flame sources – such as candles – should be placed on the product.

	CAUTION RISK OF ELECTRIC SHOCK. DO NOT OPEN.	
<hr/> <p>WARNING: Do Not Open! Risk of Electrical Shock. Voltages in this equipment are hazardous to life. No user-serviceable parts inside. Refer all servicing to qualified service personnel.</p>		

WARNING: This product is intended to be operated **ONLY** from the AC Voltages listed on the back panel or included power supply of the product. Operation from other voltages other than those indicated may cause irreversible damage to the product and void the products warranty. The use of AC Plug Adapters is cautioned because it can allow the product to be plugged into voltages in which the product was not designed to operate. If the product is equipped with a detachable power cord, use only the type provided with your product or by your local distributor and/or retailer. If you are unsure of the correct operational voltage, please contact your local distributor and/or retailer.

CAUTION: Place the equipment near a main power supply outlet and make sure that you can easily access the power breaker switch.

THANK YOU

Thank you for your purchase of the KLIPSCH® Group WA-2 Wireless Subwoofer Kit. The WA-2 will only operate with select KLIPSCH®, ENERGY®, MIRAGE® and JAMO® brand subwoofers that have a “WA Port” input on the back of the amplifier panel (refer to your subwoofer owner’s manual). The WA-2 is a 2.4 GHz product designed to wirelessly transmit a signal up to a 50 foot (15m) radius.*

PACKING LIST

1. Transmitter
2. Receiver
3. Power supply
4. Audio cable
5. Hook and loop strips
6. This Owner’s Manual

PRODUCT REGISTRATION

Register your product online at **www.klipsch.com/register**

- KLIPSCH will keep you up-to-date on new products and promotions.
- Your personal information will never be resold.
- This registration information is not used for warranty purposes.
Please retain your receipt for warranty claims.

*subject to RF interference (see “Troubleshooting”)

SETUP

1. Decide where the subwoofer will go (refer to your subwoofer owner's manual).
2. Most receivers (and pre-amps) have a line level subwoofer output labeled Subwoofer Pre Out, Sub Out, SW Out, etc. If you have this connection, use one of the two male jacks on one end of the supplied audio cable to plug into that output, then use the corresponding (same color) jack on the opposite end of the cable and plug into the WA-2 transmitter input "B" (labeled "Left/LFE"). In absence of a subwoofer output use both male jacks on one end of the cable and connect the left and right channel pre-amp outputs from your receiver (if provided) (not tape outs) to "B" (labeled "Left/LFE") and "D" (labeled "Right") inputs on the WA-2 transmitter.
3. Connect the cable from the WA-2 receiver to the "WA Port" on the back of the subwoofer. **Carefully match the four pins of the cable to the corresponding 4 holes on the WA Port and gently push in until connected. Improper pin alignment can result in damage to the connector.**

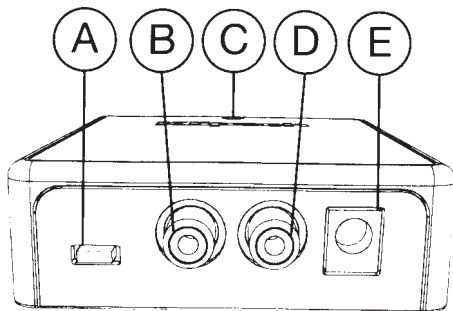

TRANSMITTER REAR

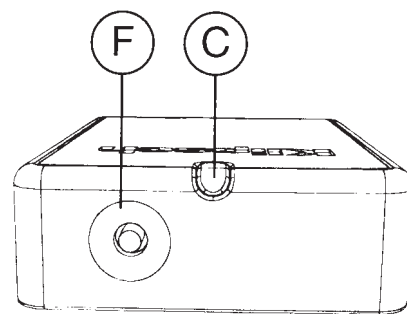

TRANSMITTER FRONT

RECEIVER FRONT

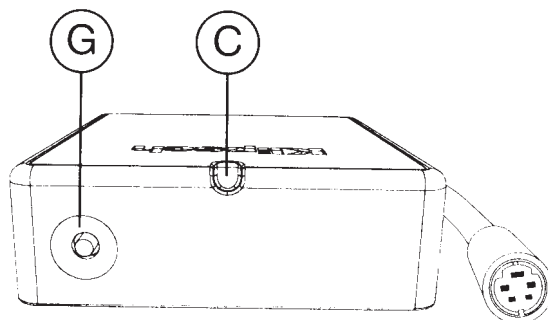

4. Plug supplied power supply cable into “E” on the WA-2 transmitter and plug other end into an AC wall outlet.
5. Check to make sure Gain Switch “A” is in middle position (0dB). This position best matches the output voltage of most receivers and processors.
6. Turn receiver/pre-amplifier on.
7. Turn subwoofer to “On” or “Auto On” position.
8. The WA-2 transmitter and receiver should be automatically “paired” with their **red** LED’s (“C”) on solid, and the subwoofer should now be operational.
9. Some subwoofers have two screws on back that will attach to keyholes (“H”) on the back of the receiver box. For subwoofers that do not (JAMO SUB 800, ENERGY ESW-M6 & ESW-M8, MIRAGE MM-6 & MM-8), you can use the supplied hook and loop strips to attach the WA-2 receiver to the back of subwoofer. Attach the receiver to these subwoofers on the back at the top left-hand corner of the subwoofer (“I”). It is recommended that you clean the area on the subwoofer and transmitter with rubbing alcohol before attaching the strips.

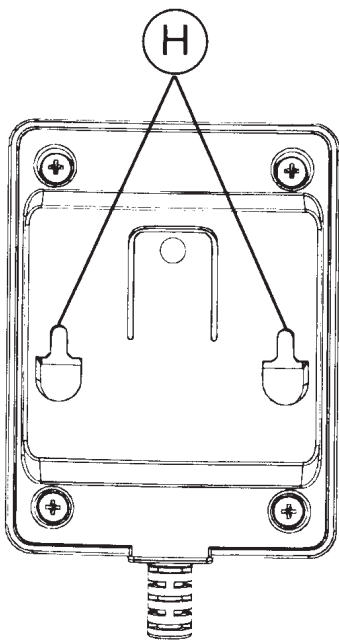

BACK OF RECEIVER BOX

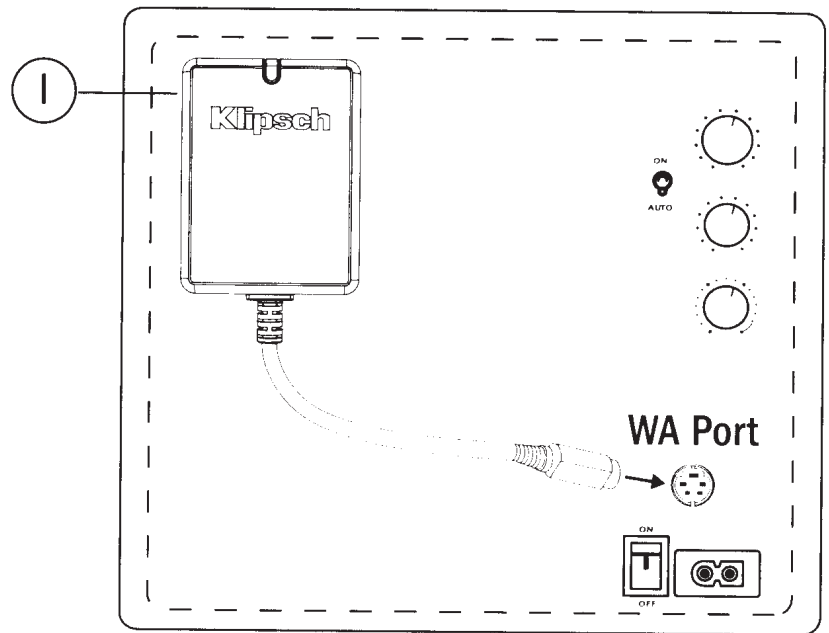

BACK OF SUBWOOFER

TRANSMITTER CONNECTIONS

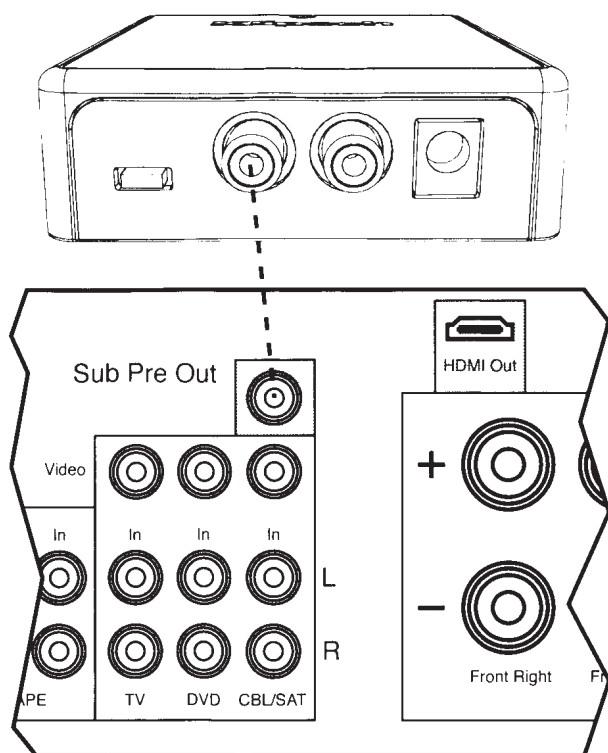

A/V RECEIVER

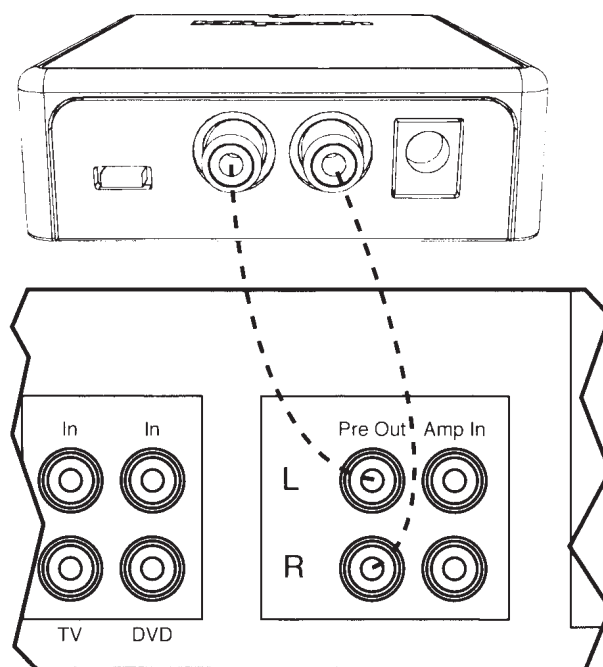

STEREO RECEIVER

TROUBLESHOOTING

- If the subwoofer does not operate and the red LED's ("**C**") are flashing on the WA-2 transmitter and receiver, a simple "pairing" is needed. Push and hold in button "**F**" on the transmitter while pushing and holding button "**G**" on the receiver and keep pushed until both LED's stop flashing and glow solid (approximately five seconds).
- Since the WA-2 is a wireless device, it may encounter RF interference from other wireless devices in the same area. If there is difficulty "pairing" the transmitter and receiver, or their signal connection fades, you may need to move them closer together and/or farther away from other

wireless products. If other wireless devices in the area have a manual channel selection option, you can also select a different channel for their operation to help eliminate interference with the WA-2.

- If you do not get a signal, or get a low level audio signal from the subwoofer, make sure the subwoofer out level control on your surround receiver is set correctly (usually at the halfway point sometimes labeled “0dB”). If your subwoofer out level on your surround receiver is correct, and you have adjusted the subwoofer volume level and the signal is still too low, move the gain control “**A**” to the right (+12dB) to increase the signal to the subwoofer. If the signal is too high, move the gain control to the left (-12dB) to reduce signal strength.

WARRANTY – U.S. AND CANADA

KLIPSCH warrants to the original retail purchaser that this product is to be free from defective materials and workmanship for a period of two (2) years from the date of purchase, if it is properly used and maintained. If this product proves defective in either material or workmanship, KLIPSCH, at its option, will (a) repair the product, or (b) replace the product, at no charge for parts or labor. If the product model is no longer available and cannot be repaired effectively or replaced with an identical model, KLIPSCH at its sole option may replace the unit with a current model of equal or greater value. In some cases, modification to the mounting surface may be required where a new model is substituted. KLIPSCH assumes no responsibility or liability for such modification. To obtain a repair or replacement under the terms of this warranty, please return to dealer first, if possible, and they will direct you accordingly for repairs or replacement. You will be required to submit a copy of the original receipt.

Limitations:

- This limited warranty does not cover failure of the product resulting from improper installation, misuse, abuse, accident, neglect, mishandling, or wear from ordinary use or environmental deterioration.
- This limited warranty does not cover cosmetic damage, including paint damage, or consequential damage to other components or premises which may result for any reason from the failure of the product.
- This limited warranty is null and void for products not used in accordance with KLIPSCH's instructions.
- This limited warranty is null and void for products with altered or missing serial numbers and for products not purchased from an authorized dealer.
- This limited warranty terminates if you sell or otherwise transfer this product to another party.

THIS WARRANTY GIVES YOU SPECIFIC LEGAL RIGHTS, AND YOU MAY ALSO HAVE OTHER RIGHTS WHICH VARY FROM STATE TO STATE, JURISDICTION TO JURISDICTION OR COUNTRY TO COUNTRY. KLIPSCH'S RESPONSIBILITY FOR MALFUNCTIONS AND DEFECTS IN HARDWARE IS LIMITED TO REPLACEMENT OR REPAIR AS SET FORTH IN THIS WARRANTY STATEMENT. FOR CANADIAN CUSTOMERS, KLIPSCH DISCLAIMS ALL OTHER WARRANTIES AND CONDITIONS, EXPRESS OR IMPLIED, STATUTORY OR OTHERWISE, FOR THE PRODUCT. FOR U.S. CUSTOMERS, ALL EXPRESS AND IMPLIED WARRANTIES FOR THE PRODUCT, INCLUDING BUT NOT LIMITED TO ANY IMPLIED WARRANTIES OF MERCHANTABILITY AND FITNESS FOR A PARTICULAR PURPOSE ARE LIMITED IN TIME TO THE TERM OF THIS WARRANTY. SOME STATES, JURISDICTIONS OR COUNTRIES DO NOT ALLOW THE EXCLUSION OF CERTAIN IMPLIED WARRANTIES OR CONDITIONS, OR LIMITATIONS ON HOW LONG AN IMPLIED WARRANTY OR CONDITIONS LASTS, SO THIS LIMITATION MAY NOT APPLY

TO YOU. KLIPSCH DOES NOT ACCEPT LIABILITY FOR SPECIAL, INDIRECT, CONSEQUENTIAL OR INCIDENTAL DAMAGES, INCLUDING WITHOUT LIMITATION, ANY LIABILITY FOR THIRD PARTY CLAIMS AGAINST YOU FOR DAMAGES OR FOR PRODUCTS NOT BEING AVAILABLE FOR USE. THE MAXIMUM LIABILITY FOR WHICH KLIPSCH MAY BE RESPONSIBLE WILL BE NO MORE THAN THE AMOUNT YOU PAID FOR THE PRODUCT THAT IS THE SUBJECT OF THE CLAIM. SOME STATES, JURISDICTIONS OR COUNTRIES DO NOT ALLOW THE EXCLUSION OR LIMITATION OF SPECIAL, INDIRECT, INCIDENTAL OR CONSEQUENTIAL DAMAGES, SO THE ABOVE LIMITATION OR EXCLUSION MAY NOT APPLY TO YOU.

WARRANTY OUTSIDE THE U.S. AND CANADA

The Warranty on this product if it is sold to a consumer outside of the United States and Canada shall comply with applicable law. To obtain any applicable warranty service, please contact the dealer from which you purchased this product, or the distributor that supplied this product.

FCC AND CANADA EMC COMPLIANCE INFORMATION

NOTE: This equipment has been tested and found to comply with the limits for a Class B digital device, pursuant to part 15 of the FCC Rules. These limits are designed to provide reasonable protection against harmful interference in a residential installation. This equipment generates, uses and can radiate radio frequency energy and, if not in-stalled and used in accordance with the instructions, may cause harmful interference to radio communications. However, there is no guarantee that interference will not occur in a particular installation. If this equipment does cause harmful interference to radio or television reception, which can be determined by turning the equipment off and on, the user is encouraged to try to correct the interference by one or more of the following measures:

- Reorient or relocate the receiving antenna.
- Increase the separation between the equipment and receiver.
- Connect the equipment into an outlet on a circuit different from that to which the receiver is connected.
- Consult the dealer or an experienced radio/TV technician for help.

Approved under the verification provision of FCC Part 15 as a Class B Digital Device.

Caution: Changes or modifications not expressly approved by the manufacturer could void the user's authority to operate this device.

This Class B digital apparatus complies with Canadian ICES-003.

Cet appareil numérique de la classe B est conforme à la norme NMB-003 du Canada.

WIRELESS TRANSMITTER COMPLIANCE INFORMATION

The term "IC:" before the radio certification number only signifies that Industry Canada technical specifications were met.

This equipment complies with FCC and IC radiation exposure limits set forth for an uncontrolled environment. This equipment should be installed and operated with minimum distance 20cm between the radiator and your body. This transmitter must not be co-located or operating in conjunction with any other antenna or transmitter.

Le terme «IC:» avant le numéro de certification radio signifie seulement que les spécifications techniques d'Industrie Canada ont été respectées.

Cet appareil est conforme à FCC et IC l'exposition aux rayonnements limites fixées pour un environnement non contrôlé. Cet appareil doit être installé et utilisé avec une distance minimale de 20 cm entre le radiateur et votre corps. Cet transmetteur ne doit pas être co-situé ou opérant en liaison avec toute autre antenne ou transmetteur.

This device has been designed to operate with the antennas listed below, and having a maximum gain of [x] dB. Antennas not included in this list or having a gain greater than [x] dB are strictly prohibited for use with this device. The required antenna impedance is 50 ohms.

Operation is subject to the following two conditions: (1) this device may not cause interference, and (2) this device must accept any interference, including interference that may cause undesired operation of the device.

To reduce potential radio interference to other users, the antenna type and its gain should be so chosen that the equivalent isotropically radiated power (e.i.r.p.) is not more than that permitted for successful communication..

EU COMPLIANCE INFORMATION:

Eligible to bear the CE mark, Conforms to European Union Low Voltage Directive 2006/95/EC; Conforms to European Union EMC Directive 2004/108/EC.

WEEE NOTICE

Note: This mark applies only to countries within the European Union (EU) and Norway.



This appliance is labeled in accordance with European Directive 2002/96/EC concerning waste electrical and electronic equipment (WEEE). This label indicates that this product should not be disposed of with household waste. It should be deposited at an appropriate facility to enable recovery and recycling.

Klipsch, Jamo, Energy and Mirage are registered trademarks of Klipsch Group, Inc. and its subsidiaries.



3502 Woodview Trace
Indianapolis, IN 46268
1-800-KLIPSCH • klipsch.com

© 2011 Klipsch Speakers