

TAURUS[®]

Assembly and Operating Instructions

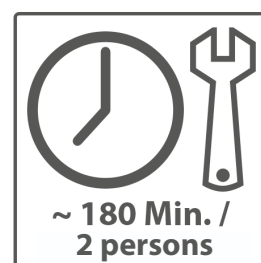
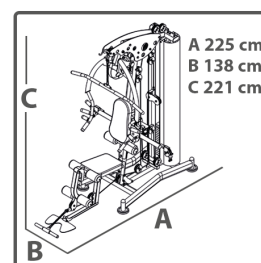
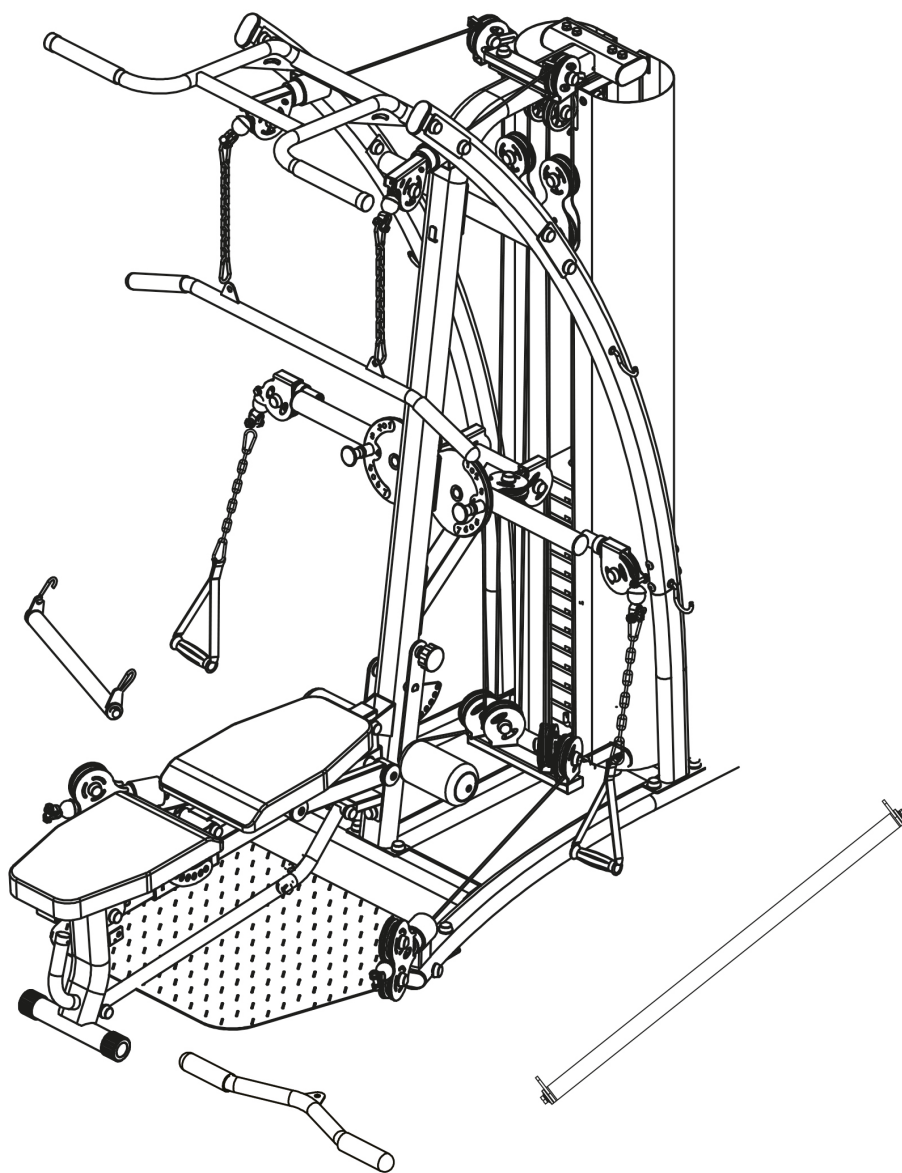

TFWS5.01.01

TF-WS5

Weight station WS5

Dear Customer,

Thank you for deciding for a high-quality training equipment of the brand Taurus, the brand that makes athlete's hearts beat faster. Taurus offers a wide range of home fitness equipment like elliptical cross trainers, ergometers, treadmills and rowing machines. Taurus equipment is the optimal equipment for all those who want to train at home independent of goals and fitness level. For further information please visit www.sport-tiedje.com or www.taurus-fitness.de.



SAFETY NOTICE

Please read all of the instructions carefully before assembly and first use. These instructions are intended to ensure speedy assembly and explain safe usage. Make sure that all people exercising with the equipment (in particular children and persons with limited physical, sensory, mental or motor capabilities) are informed about these instructions and its content in advance. In case of doubt, a responsible person must supervise the use of the equipment.

This equipment has been manufactured according to the latest safety knowledge. As far as possible, potential safety hazards which could cause injury have been eliminated. Make sure to follow the instructions carefully and that all parts are securely in place. If required, read through the instructions again to correct any mistakes.

Please pay close attention to the safety and maintenance instructions given here. The contract partner cannot be held liable for damage to health, accidents or damage to the equipment when it is not used in accordance with these instructions.

The equipment is only suitable for use at home. The equipment is not suitable for semi-professional (e. g., hospitals, clubs, hotels, schools, etc.) and commercial or professional use (e. g., health clubs).

Retain these instructions in a safe place for future reference, maintenance or when ordering replacement parts.

INHALTSVERZEICHNIS

1	GENERAL INFORMATION	5
1.1	Technical Data	5
1.2	Personal safety	6
1.3	Set-up place	7
2	ASSEMBLY INSTRUCTIONS, MAINTENANCE AND CARE	8
2.1	General instructions	8
2.2	Faults and Troubleshooting	9
2.3	Maintenance and service calendar	9
3	ASSEMBLY	10
4	WARRANTY INFORMATION	40
5	DISPOSAL	42
6	ORDERING ACCESSORIES	42
7	ORDERING SPARE PARTS	43
7.1	Service hotline	43
7.2	Serial number and model name	43
7.3	Parts list	44
7.4	Exploded drawing	47

1.1 Technical data

Weight and dimensions:

Item weight (gross, incl. packaging): 139 kg

Item weight (net, without packaging): 134 kg

Weight stack in kg: 90 kg

Packed dimensions boxes (length x width x height):

No. 1 ca. 189 cm x 57 cm x 27 cm

No. 2 ca. 128 cm x 102 cm x 22 cm

Set-up dimensions (length x width x height): approx. 225,1 cm x 138 cm x 211,5 cm

1.2 Personal safety

- + Before you start using the equipment, you should consult your physician that this type of exercise is suitable for you from a health perspective. Particularly affected are persons who: have a hereditary disposition to high blood pressure or heart disease, are over the age of 45, smoke, have high cholesterol values, are overweight and/or have not exercised regularly in the past year.
- + Please note that working out excessively can seriously damage your health.
- + The equipment may only be used for its intended purpose; this means for strength training for adults.
- + Any other usage is prohibited and potentially dangerous. The contract partner cannot be held liable for damage resulting from improper use.
- + The equipment may not be used by several persons at the same time.
- + Children should not be allowed unsupervised access to the equipment.
- + Before starting your training, make yourself familiar with all of the equipment's functions and setting options. Have an expert explain the correct usage of the product to you.
- + Make sure that nobody is in the range of motion of the equipment while exercising.
- + Keep your hands, feet and other body parts, hair, clothing, jewelry and other objects well clear of moving parts.
- + During use, wear suitable sports clothing rather than loose or baggy clothing. When selecting sports shoes, think about the suitability of the sole – preferably this should be made of rubber or other non-slip materials. Shoes with heels, leather soles, studs or spikes are not suitable. Never work out in bare feet.
- + It is also important to take note of the information given in the workout instructions for creating a workout plan.
- + At the first signs of weakness, nausea, dizziness, pain, difficulty in breathing or other abnormal symptoms, stop your workout immediately and, if necessary, consult your physician.
- + Before each training session, check all cables for any possible damage. Immediately replace defective cables and do not use the equipment until it has been repaired. Also pay attention to any material fatigue.
- + Never let go of the handlebars or grips as long as there is resistance in order to avoid crushing and similar injuries.
- + Make sure that the cables are always in the wheel guide. If the cables are stuck while you are training, stop training immediately and check the cable run.
- + If you adjust the seat, make sure that it fully locks in its new position, because otherwise it may slide and lead to injuries.

1.3 Set-up place

- + The equipment should only be used indoors, in a sufficiently heated and dry area (ambient temperature between 10°C and 35°C). The equipment should not be used outdoors or in rooms with high humidity (over 70%) like swimming pools. The equipment should only be stored in surroundings with an ambient temperature between 5°C and 45°C.
- + The training room should be well ventilated during training and not be exposed to any draughts.
- + Choose a location in which to place the equipment such that there is enough free space/ clearance to the front, the rear and to the sides of the equipment (at least 1.50 m). Furthermore, the equipment should not be set up in main entrances or on escape routes.
- + No objects of any type should be inserted into the openings of the equipment.
- + The equipment should be placed on a level and solid surface, any unevenness in the floor should be leveled out.
- + A floor protective mat / equipment underlay can help to protect high-quality floor coverings (parquet, laminate, cork, carpets) from dents and sweat and can help to level out slight unevenness.

2.1 General instructions

- + Please check if all parts and tools belonging to the equipment are included in the delivery and if there is any transport damage. If there are any complaints, please contact your contract partner directly.
- + Some of the nuts and bolts to be used in assembly are already pre-mounted in order to make set-up as easy as possible.
- + The equipment must be assembled by adults. In case of doubt, ask for assistance from another person with technical skills.
- + Keep children away from the equipment during assembly, because small parts are included in the delivery and may be swallowed.
- + Make sure that you have enough space (at least 1.50 m) in every direction during assembly.
- + Do not leave any tools and packaging materials like plastic sheeting laying around to avoid danger of suffocation for children.
- + Assemble the equipment on an underlay mat or on the cardboard packaging in order to avoid damage to the equipment and to the floor (scratches).
- + Before starting assembly, all individual parts should be placed on the floor next to each other.
- + Read the assembly instructions carefully and assemble the equipment according to the illustrations. Proceed carefully and cautiously.
- + First loosen all parts and check for their correct fitting. Then tighten the screws using a tool.
- + Modifications to the design or improper repairs may pose a hazard to the user and should not be carried out. The product warranty may be void as a result.
- + Only authorized service technicians are permitted to carry out all servicing and/or repairs – it excludes maintenance and care.
- + Damaged or worn components may impair your safety and the lifespan of the equipment. You should therefore immediately replace damaged or worn components. Please contact your contract partner in such a case. The equipment should no longer be used until it has been repaired. When needed, only use original Taurus spare parts.
- + Check the tightness of all screw connections once a month.
- + In order to be able to guarantee the constructively defined safety level of this equipment, we recommend having the equipment regularly maintained (at least once a year) by specialists (service technicians of your contract partner).
- + The equipment may be cleaned of dust, dirt and sweat using a damp cloth. The use of solvents should be strictly avoided. Also, make sure that no liquids (e. g. sweat) get into the openings of the equipment.

2.2 Faults and Troubleshooting

The equipment runs through regular quality controls during production. Nevertheless, errors or malfunctions on the equipment may occur. Individual parts are often the cause of faults and replacement is usually sufficient. Please use the following overview to see the most common errors and how to repair them. If the equipment still does not work properly, please contact your contract partner.

Problem	Cause	Solution
Scraping noises	Cable or pulleys not running smoothly or are damaged	Perform a visual check of the route of the cable or of the pulley or of the pulley guide
Weight is suspended in the air	Cable is too tightly stretched	Readjust cable tension
Cable is not taut	Cable is too slack	Readjust cable tension
Squeaking & cracking noises	Screws are either too loose or too tight	Check that screws are correctly tightened or lubricate

2.3 Maintenance and service calendar

The multi-gym needs to be cleaned after every training session with a moist towel (no solvent!) in order to avoid damage caused by sweat.

The following routine work must be done in the specified time intervals:

Part	Weekly	Weekly	2x annually	Annually
Pulling ropes and rollers	C / I			
Bolts		I		
Pulleys and cable guide	I			
Legends: C = cleaning; I = inspect				

3 ASSEMBLY

In order to make the assembly of the equipment easier, we recommend that you do not initially fully tighten the screws and bolts. However, you should make sure that all screws and bolts are firmly tightened after assembly.

Assembly kit

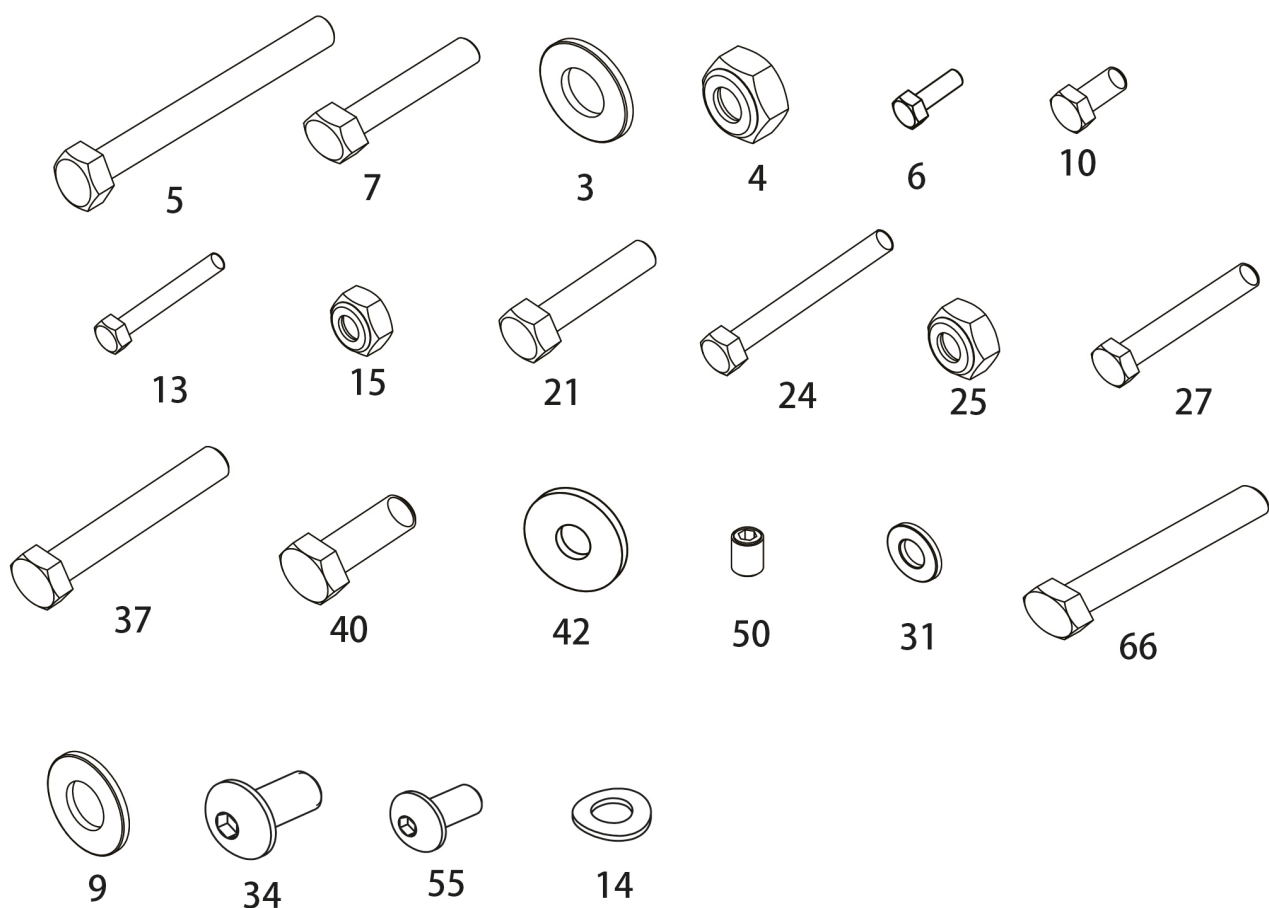

Accessories:

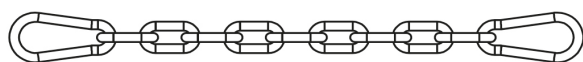
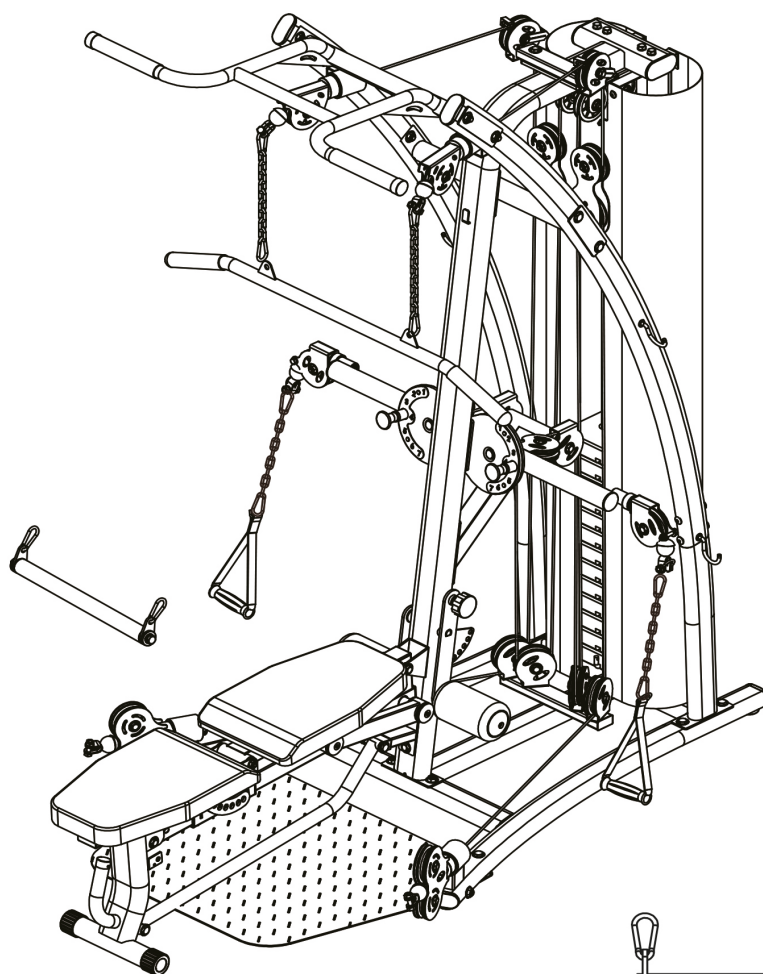

chain-70 4pcs



ship barshort-72 1pcs

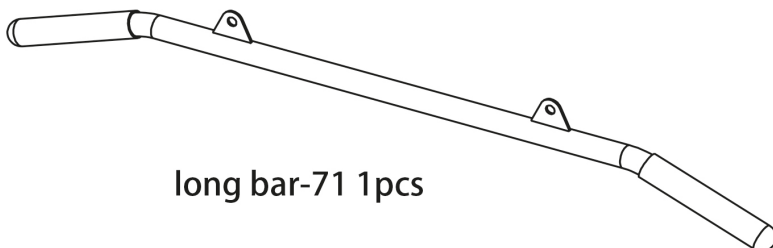

long bar-71 1pcs

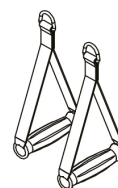

belt-73 2pcs



ship bar long-74 1PCS

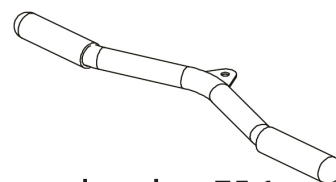

short bar-75 1p

Step 1: Exploded drawing

No.	Description	Specification	Qty.
1	ground tube		1
2	footplate		1
3	flat washer	Φ12	6
4	lock nut	M12	2
5	hexagon bolt	M12x100	2
7	hexagon bolt	M12x55	2

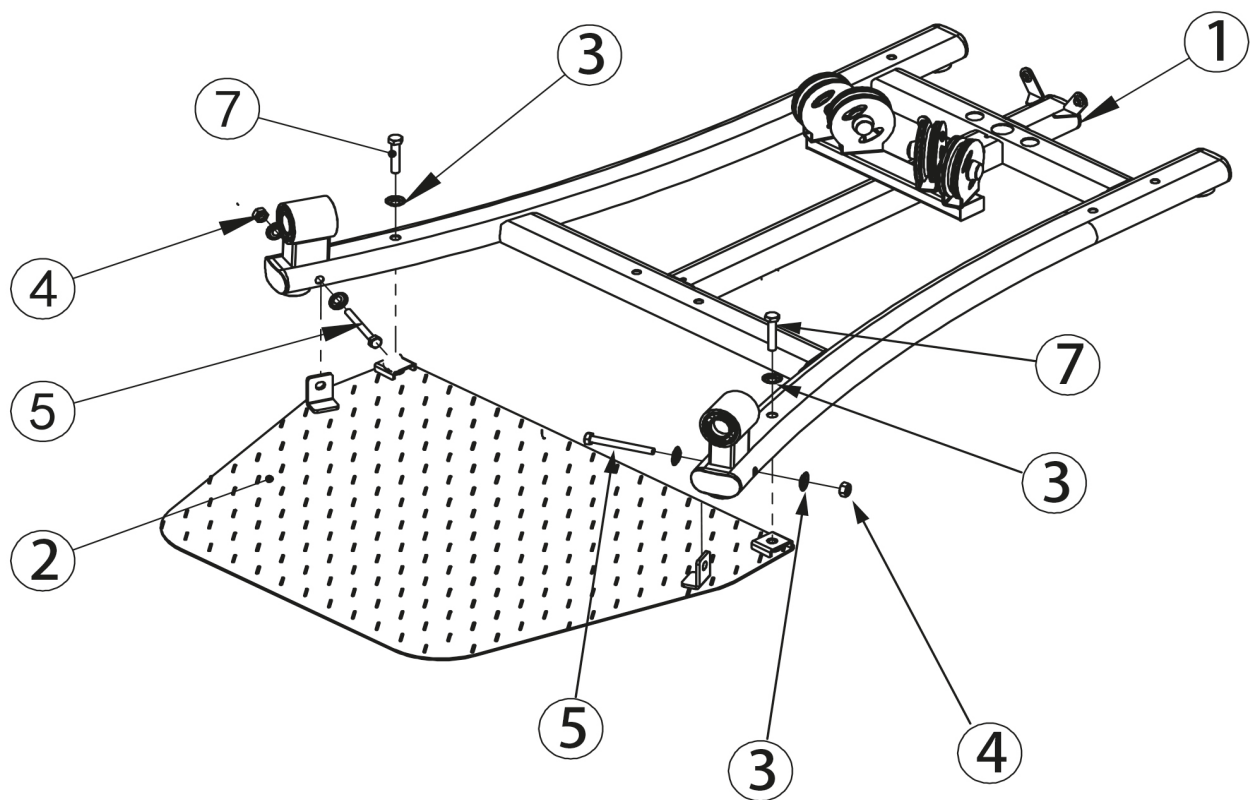

Step 1: Assembly

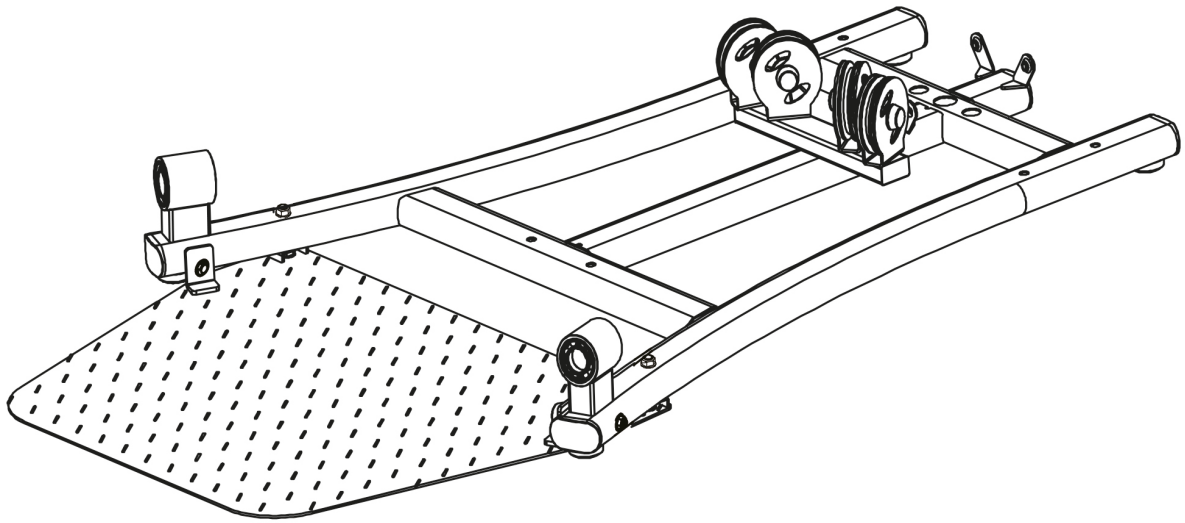

Assemble the footplate (2) to the ground tube (1), using two hexagon bolts (7), two hexagon bolts (5), six flat washers (3) and two lock nuts (4).

Step 2: Exploded drawing

No.	Description	Specification	Qty.
8	guide rod		2
9	flat washer	Φ10	2
10	hexagon bolt	M10x20	2
11	weight stack		19
12	pulley frame		1
13	hexagon bolt	M8x40	2
14	arc-shaped washer	Φ8	4
15	lock nut	M8	2
16	rubber cushion	Φ60x Φ26x42	2
17	weight stack pin		1
18	selector rod		1
19	magnetic pin	Φ10x100	1

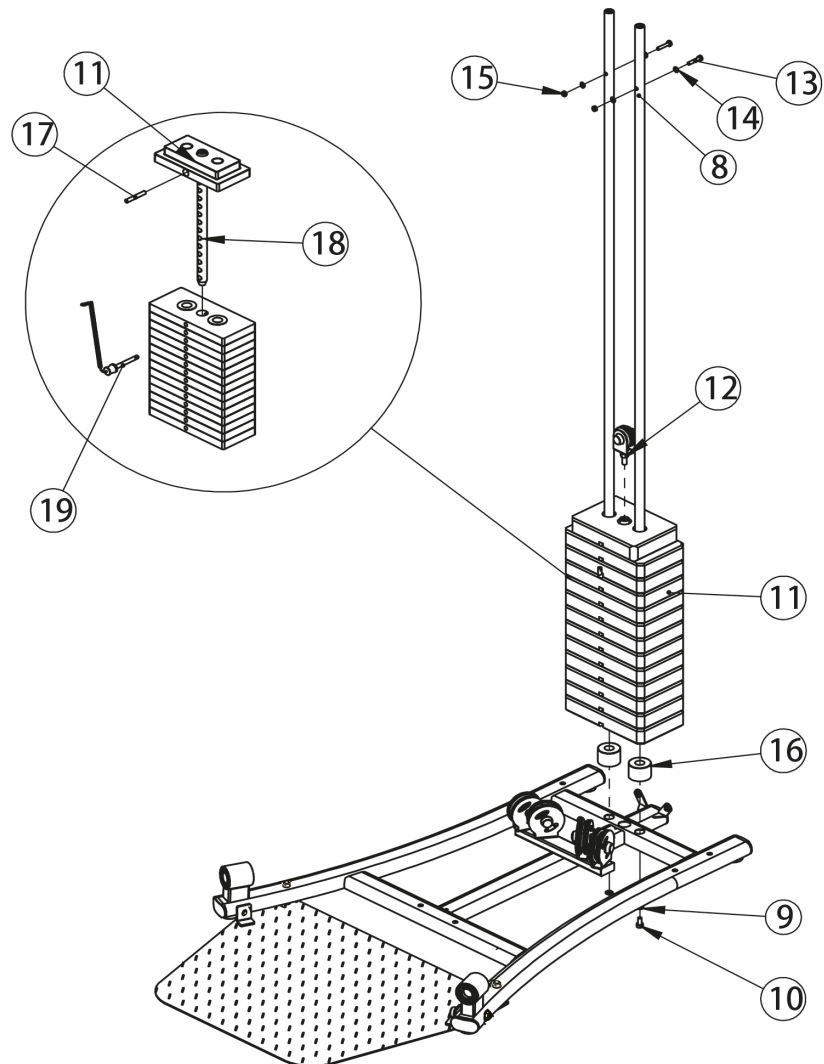

Step 2: Assembly

1	
2	
3	
4	
5	
6	
7	
8	
9	
10	
11	
12	
13	
14	
15	
16	
17	
18	
19	

9KG	20LB
13.5KG	30LB
18KG	40LB
22.5KG	50LB
27KG	60LB
31.5KG	69LB
36KG	79LB
40.5KG	89LB
45KG	99LB
49.5KG	109LB
54KG	119LB
58.5KG	129LB
63KG	139LB
67.5KG	149LB
72KG	159LB
76.5KG	169LB
81KG	179LB
85.5KG	188LB
90KG	198LB

Note:

Each of the plates has a tare weight of 4.5 kg.

Weight map

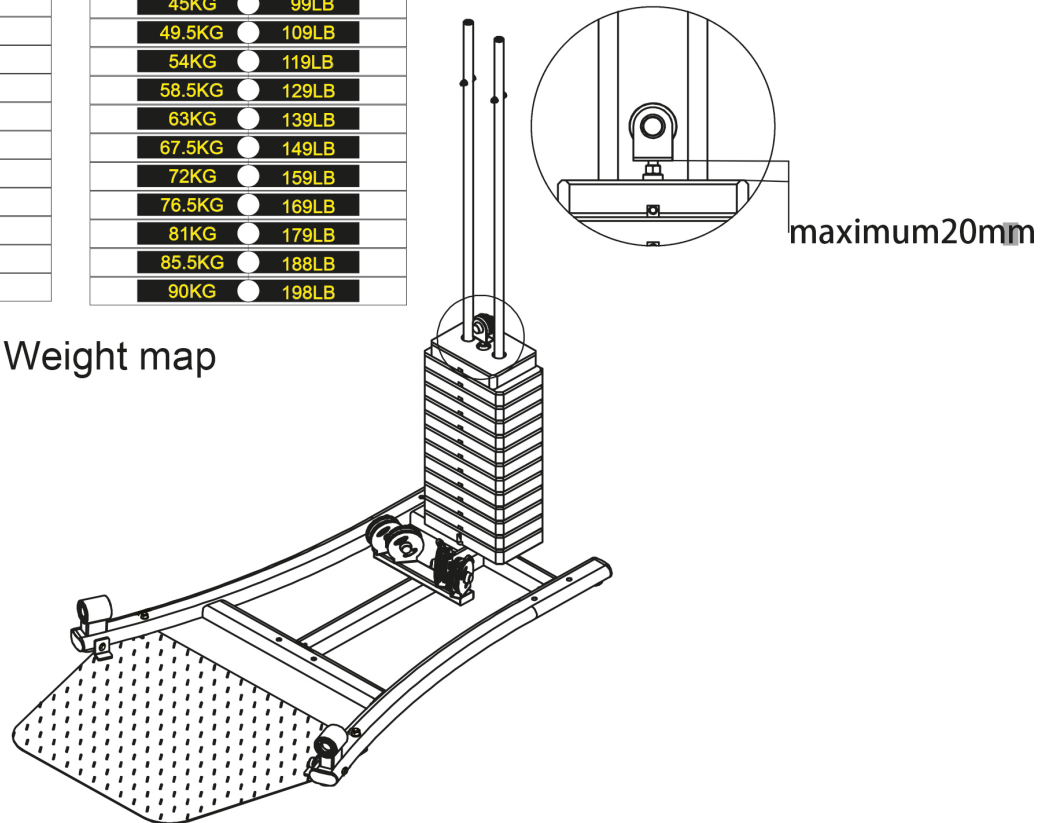

Assemble the two guide rods (8) and the two rubber cushions (16) to the ground tube (1) with two hexagon bolts (10) and two flat washers (9).

Put the plates of the weight stack (11) on the guide rods (8) one by one. Put the stack pin into the top plate plate of the weight stack (11). Stick the selector rod (18) into the weight stack (11).

Assemble the pulley frame (12) to the selector rod (18). Fix two hexagon bolts (13), four arc-shaped washers (14) and two lock nuts (15) to the two guide rods (8).

Step 3: Exploded drawing

No.	Description	Specification	Qty.
3	flat washer	Φ12	4
4	lock nut	M12	2
9	flat washer	Φ10	10
20	upper frame		1
21	hexagon bolt	M12x45	2
23	shield support frame		1
24	hexagon bolt	M10x70	4
25	lock nut	M10	4
26	upper pulley frame		1
27	hexagon bolt	M10x60	2

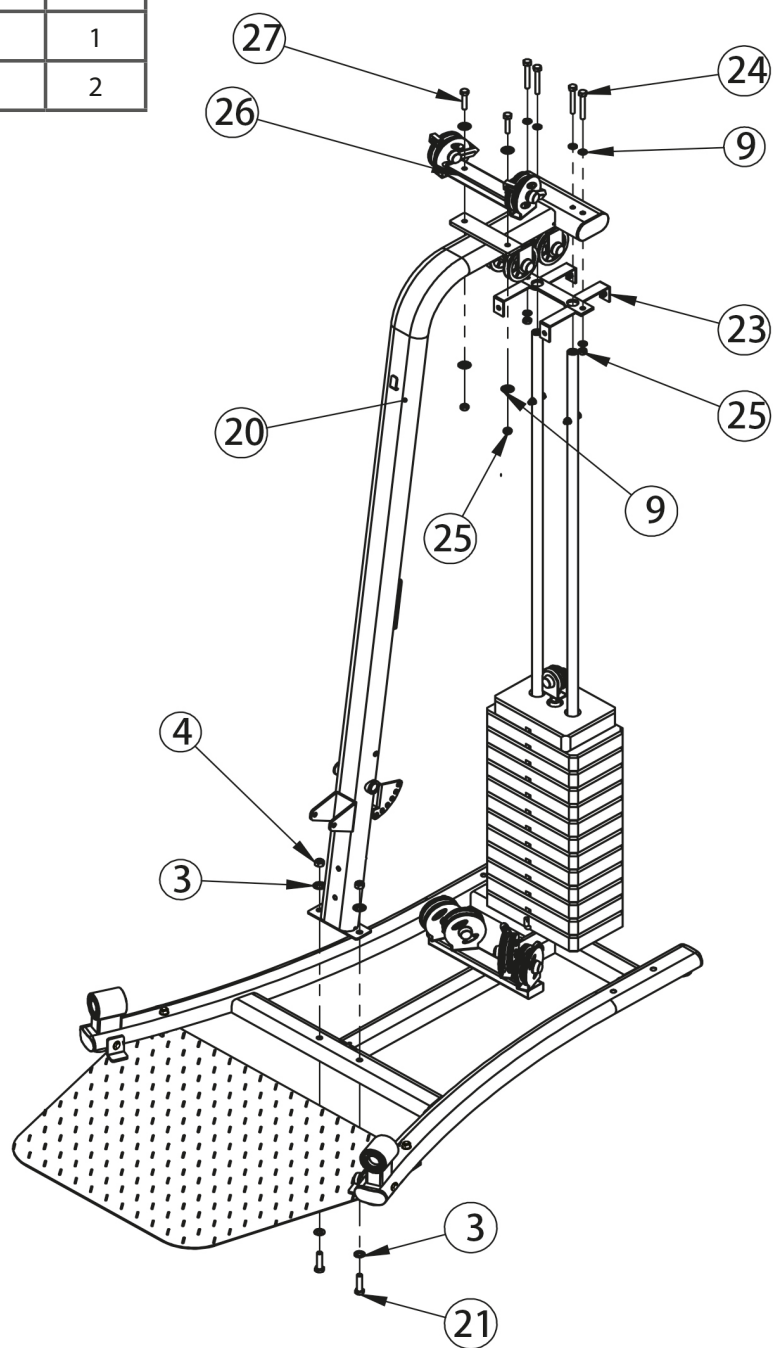

Step 3: Assembly

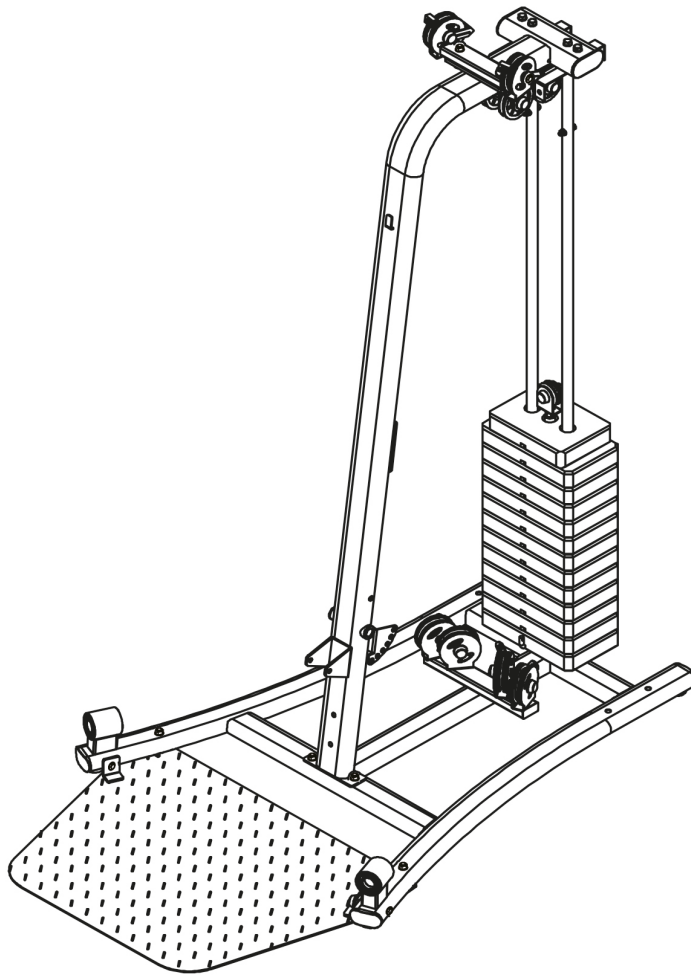

Assemble the upper pulley frame (16) to the upper frame (20), using two hexagon bolts (27), four flat washers (9) and two lock nuts (25).

Assemble the shield support frame (23) to the upper frame (20), using two hexagon bolts (24) and four flat washers (9).

Assemble the guide rods (8) to the upper frame (20), using two hexagon bolts (24) and two flat washers (9).

Assemble the upper frame (20) to the ground tube (1), using two hexagon bolts (21), two flat washers (3) and two lock nuts (4).

Step 4: Exploded drawing

No.	Description	Specification	Qty.
3	flat washer	Φ12	8
4	lock nut	M12	4
9	flat washer	Φ10	8
15	lock nut	M8	4
21	hexagon bolt	M12x45	4
29	big bending tube left		1
30	big bending tube right		1
31	decorative washer	Φ8	4
32	hook		4
33	connection tube		2
34	button head socket screw	M10x20	8

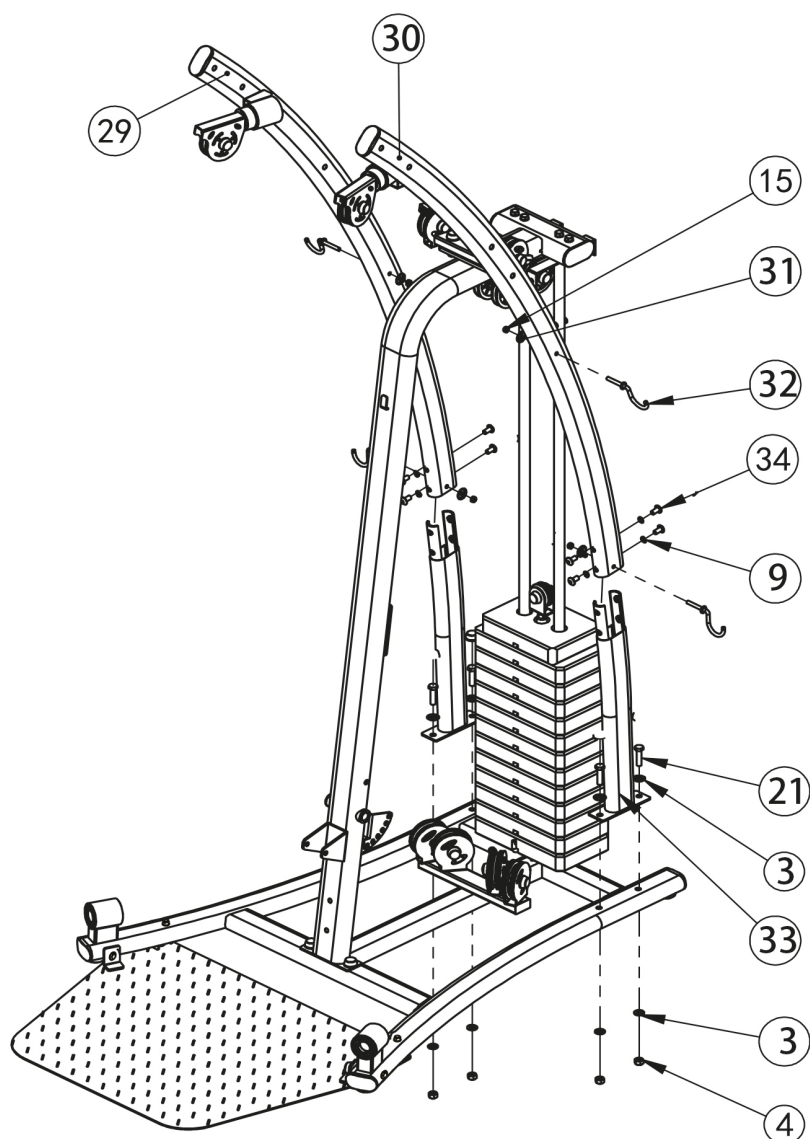

Step 4: Assembly

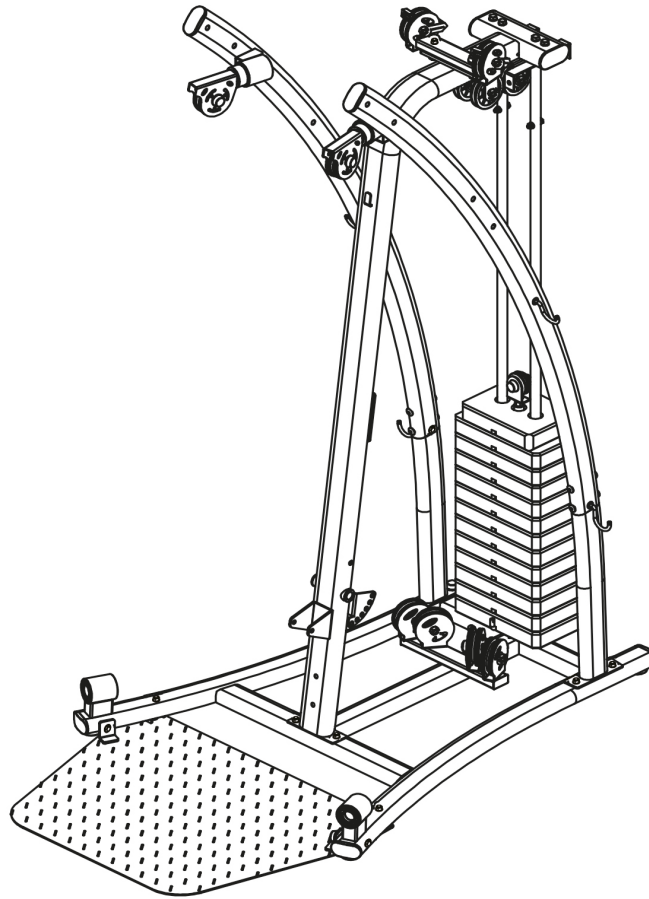

Assemble the right big bending tube (30) to the connection tube (33), using four button head socket screws (34) and four flat washers (9).

Assemble the two hooks (32) to the right big bending tube (30), using two lock nuts (15) and two flat washers (31).

Assemble the connection tube (33) to the ground tube (1), using two hexagon bolts (21), four washers (3) and two lock nuts (4).

Repeat these steps on the other side.

Step 5: Exploded drawing

No.	Description	Specification	Qty.
3	flat washer	Φ12	18
4	lock nut	M12	8
36	chip up bar		1
37	hexagon bolt	M12x65	8
38	reinforcing plate	t4.0x50x160	4
39	connection frame		1
40	hexagon bolt	M12x30	2

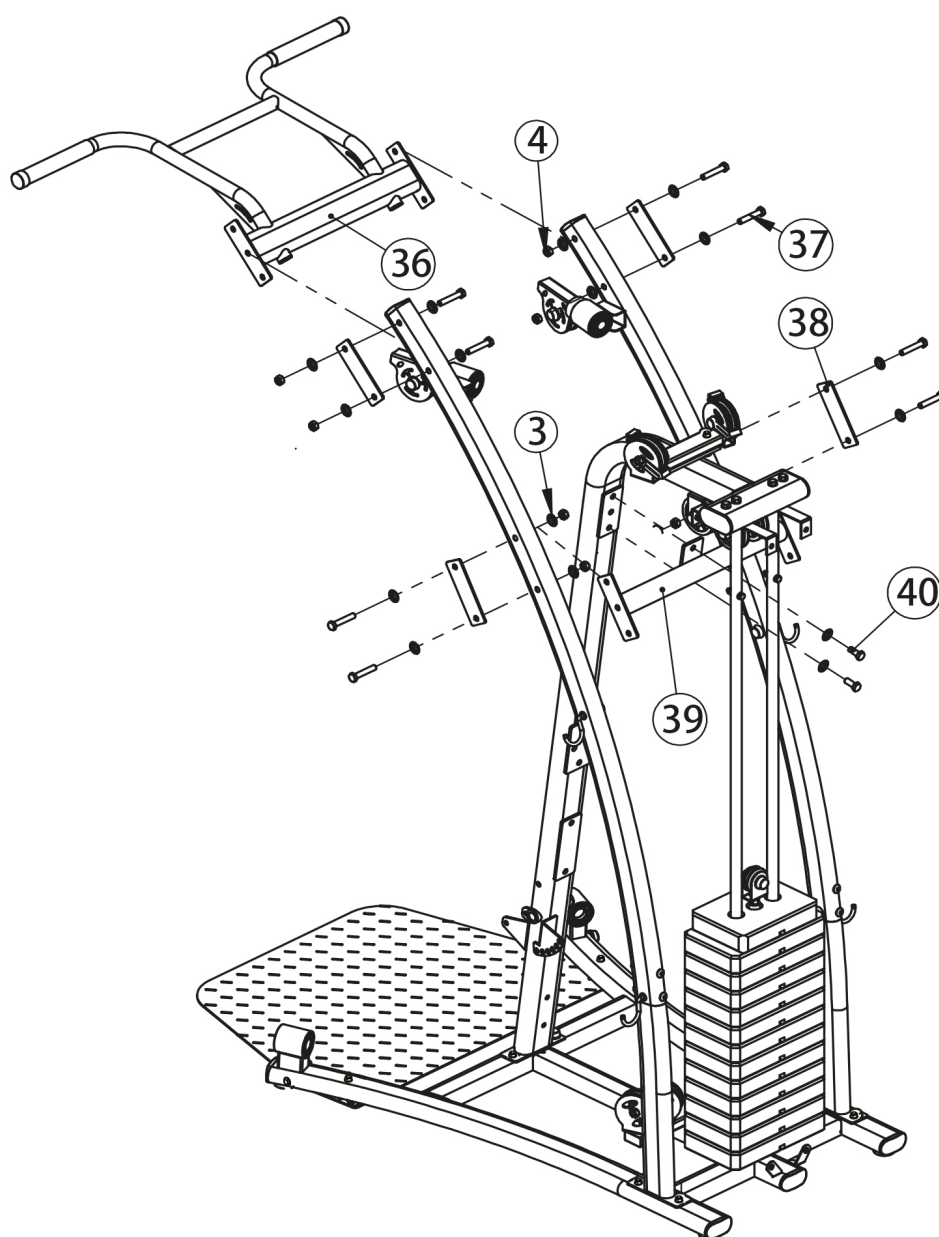

Step 5: Assembly

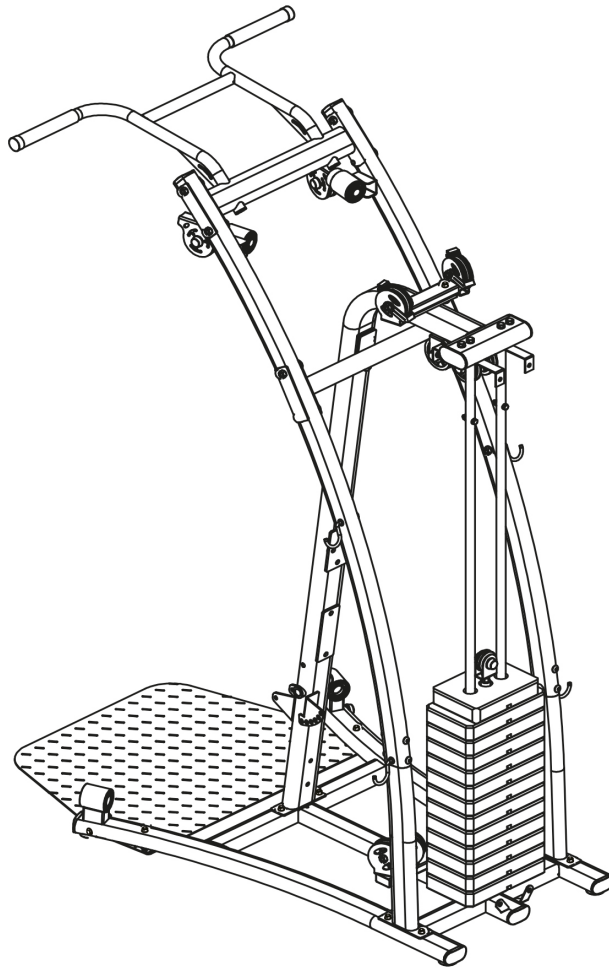

Assemble the connection frame (39) to the upper frame (20), using two hexagon bolts (40) and two flat washers (3).

Assemble the connection frame (39) to the left and the right big bending tube (30), using four hexagon bolts (37), eight flat washers (3), two reinforcing plates (38) and four lock nuts (4).

Assemble the chin up bar (36) to the left and the right big bending tube (30), using four hexagon bolts (37), eight flat washers (3), two reinforcing plates (38) and four lock nuts (4).

Step 6: Exploded drawing

No.	Description	Specification	Qty.
3	flat washer	Φ12	6
34	button head socket screw	M10x20	2
40	hexagon bolt	M12x30	6
41	butterfly arm left		1
42	big flat washer	Φ10	2
43	butterfly arm right		1
44	pulley support frame		1
45	butterfly arm plate		1

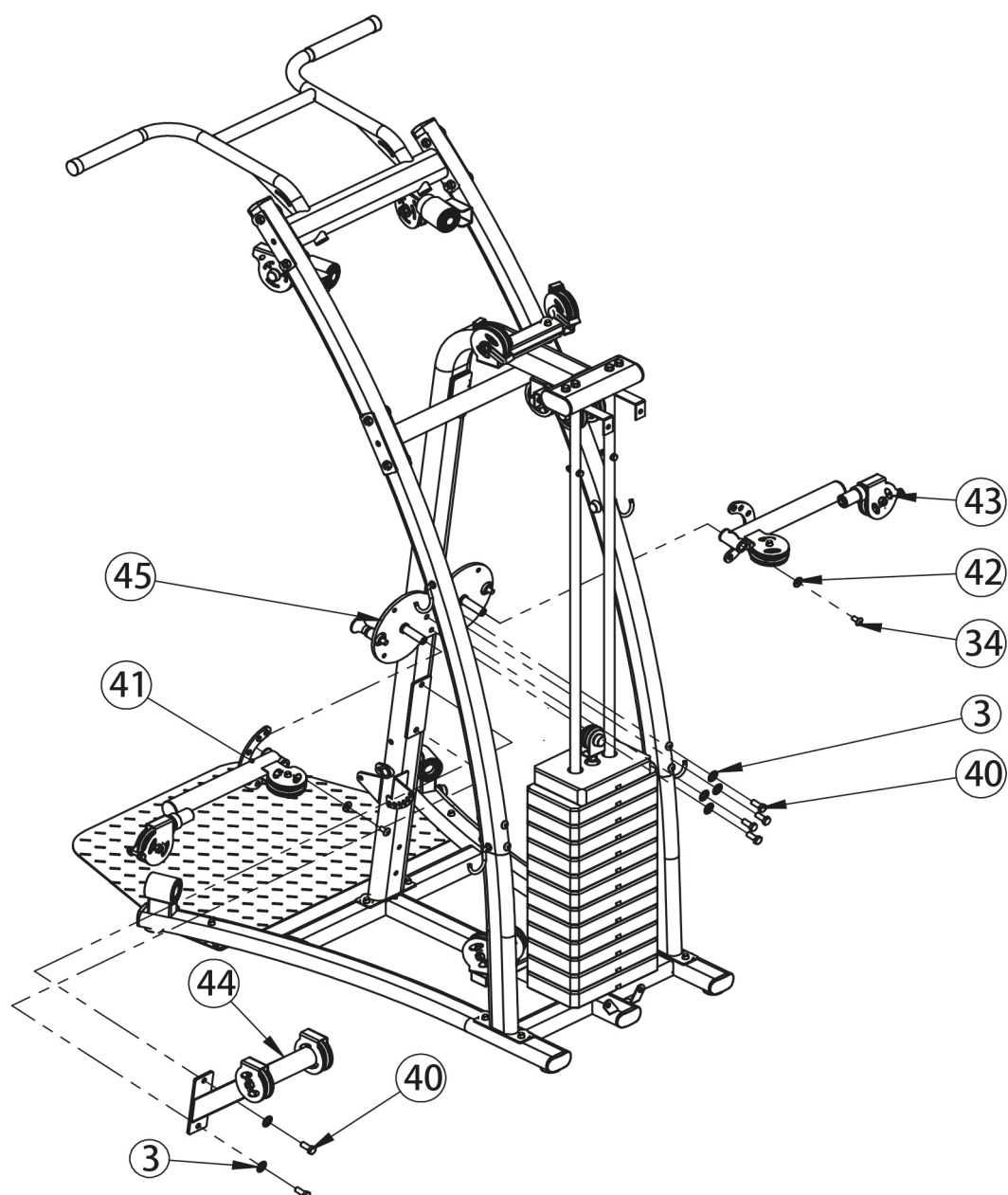

Step 6: Assembly

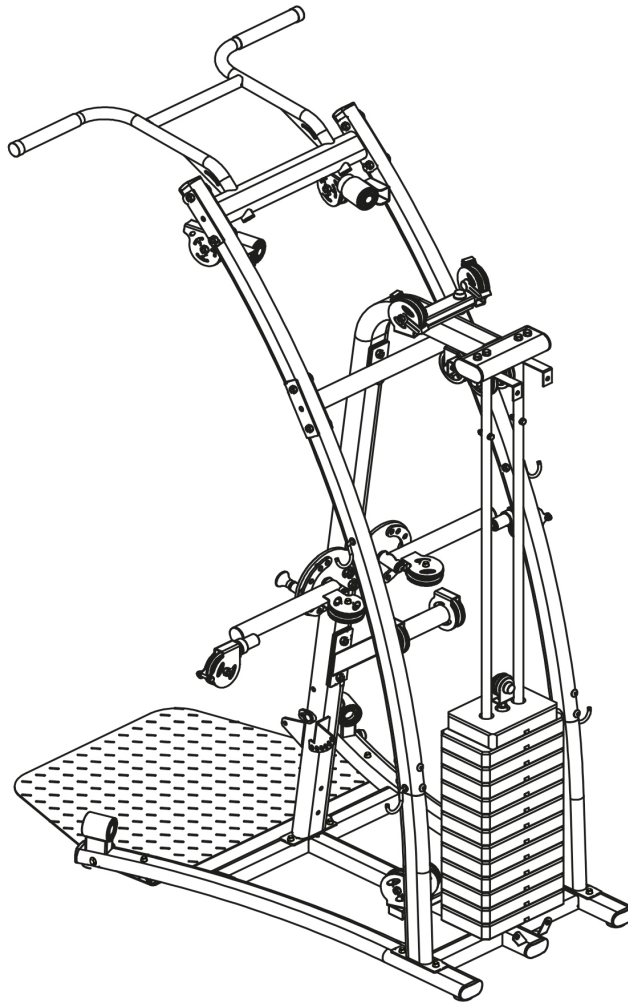

Assemble the butterfly arm plate (45) to the upper frame (20), using four hexagon bolts (40) and four washers (3).

Assemble the pulley support frame (44) to the upper frame (20), using two hexagon bolts (40) and two flat washers (3).

Assemble the left and the right butterfly arm (41/43) to the butterfly arm plate (45), using two button head socket screws (34) and two big flat washers (42).

Step 7: Exploded drawing

No.	Description	Specification	Qty.
34	button head socket screw	M10x20	1
42	big flat washer	Φ10	1
46	pulley frame		2
47	leg press frame		1
48	leg press frame small		1
49	stop collar		2
50	socket set screw	M8x10	4

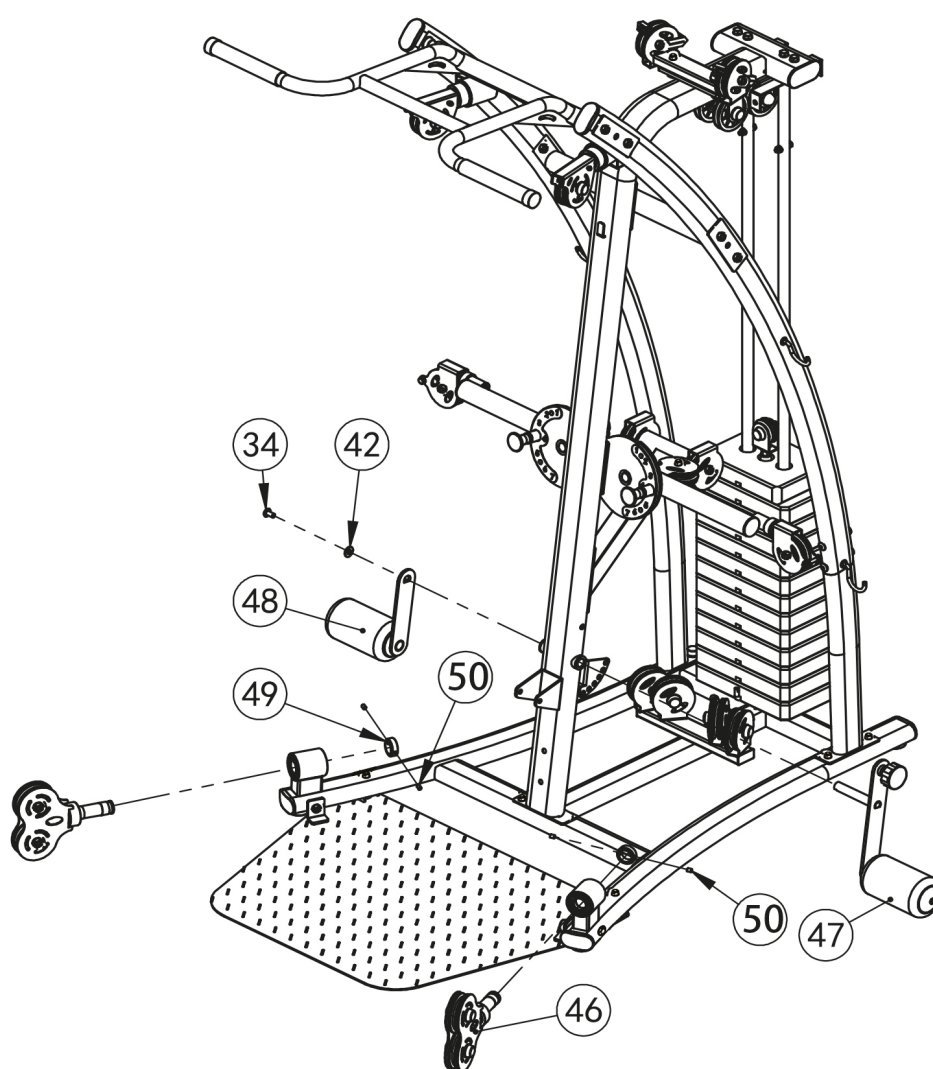

Step 7: Assembly

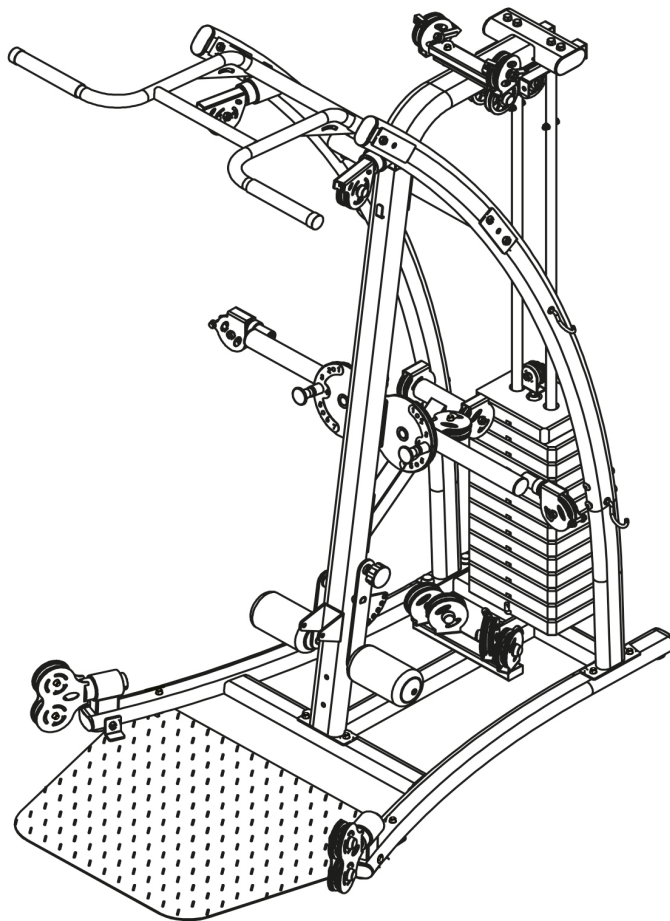

Assemble the two pulley frames (46) with the two stop collars (49) to the ground tube (1), using four button head socket screws (50).

Assemble the leg press frame (47) and the small leg press frame (48) to the upper frame (20), using one button head socket screw (34) and one big flat washer (42).

Step 8: Exploded drawing

No.	Description	Specification	Qty.
51	wire		1
52	double pulley frame		2

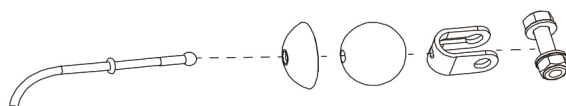
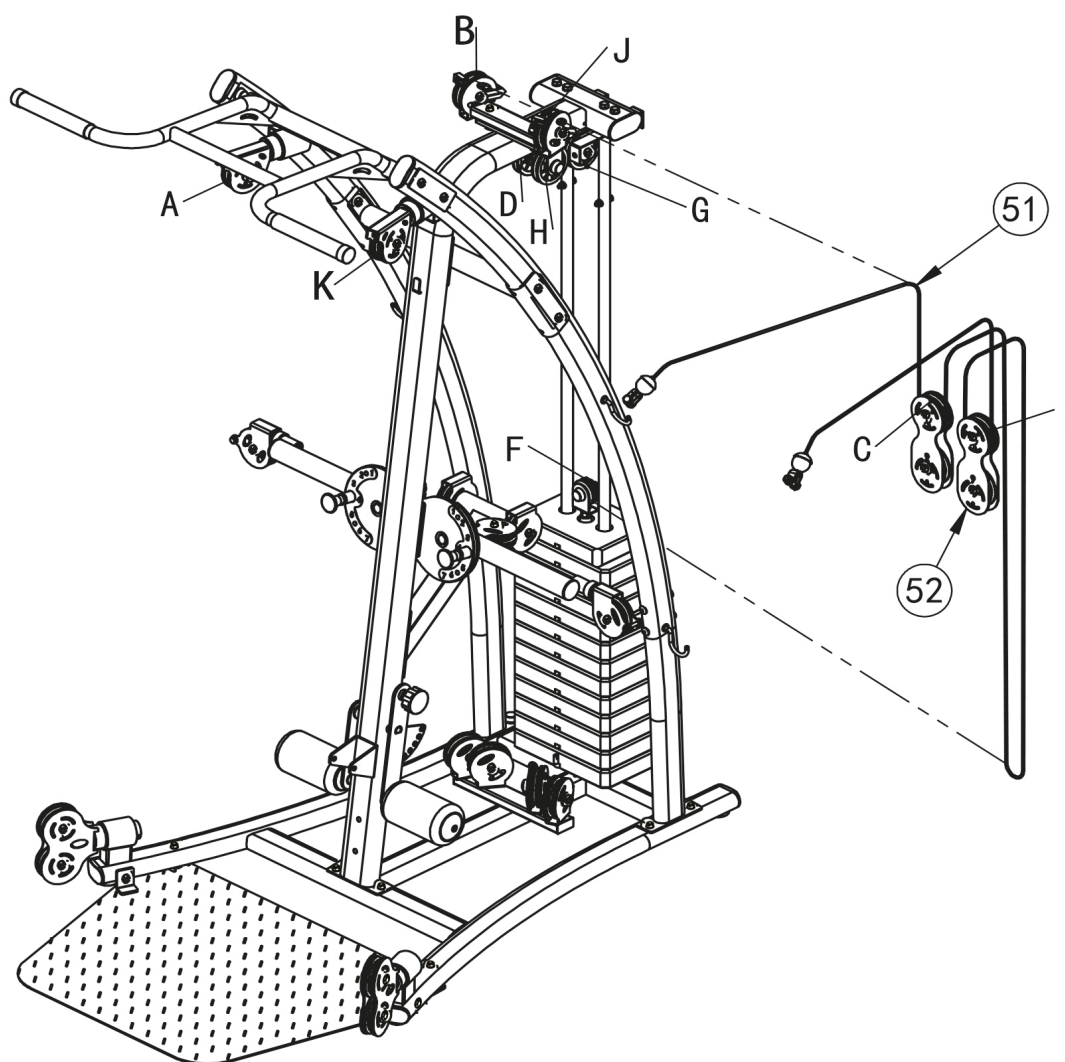

wire Installation diagram

Step 8: Assembly

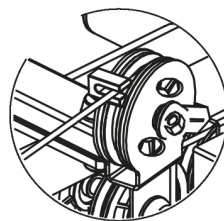
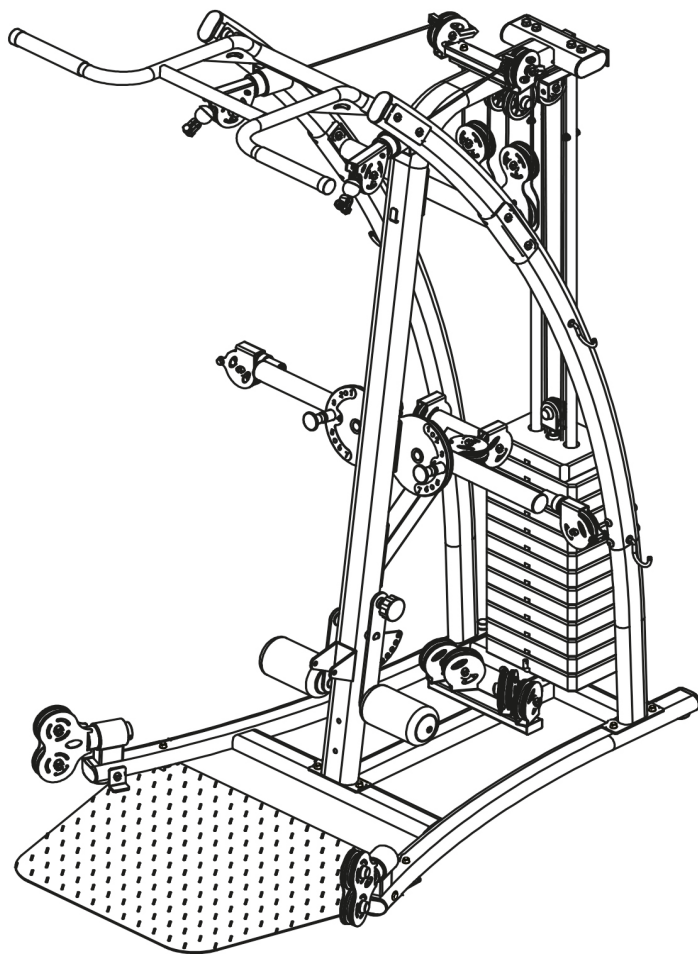

B、 J assembly drawing

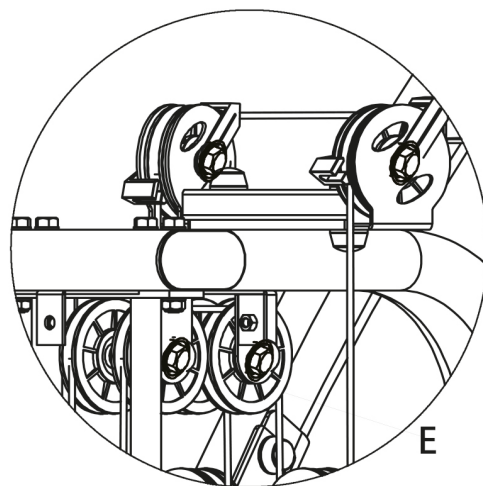

B、 J assembly drawing

Devide the cable (51) and guide one of its ends starting from point A though the following points: B, C, D, E, F, G, H, I, J, K and the double pulley frame (52). When you are finished fix the ball head back to the wire.

Step 9: Exploded drawing

No.	Description	Specification	Qty.
53	wire		2

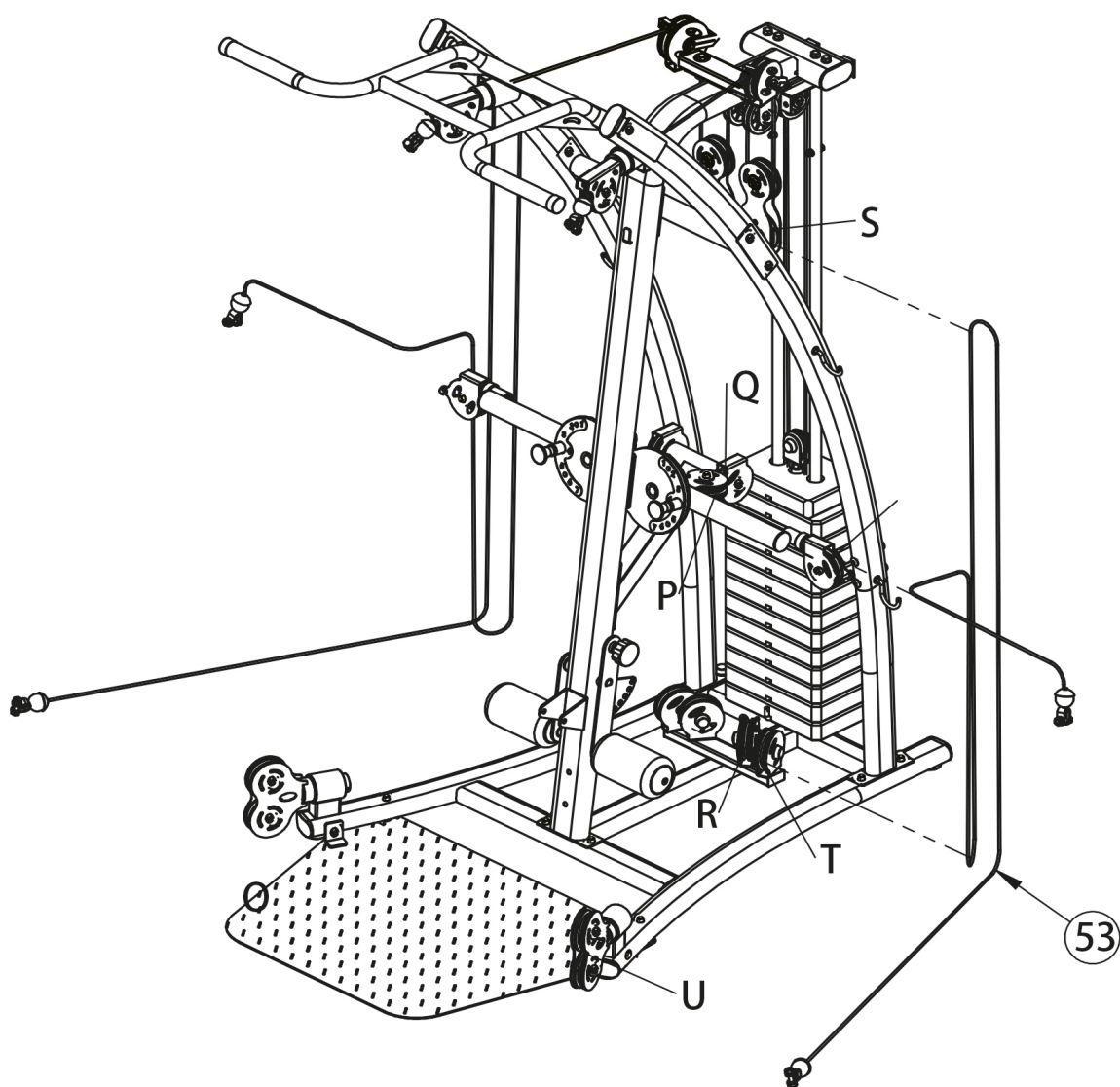

Step 9: Assembly

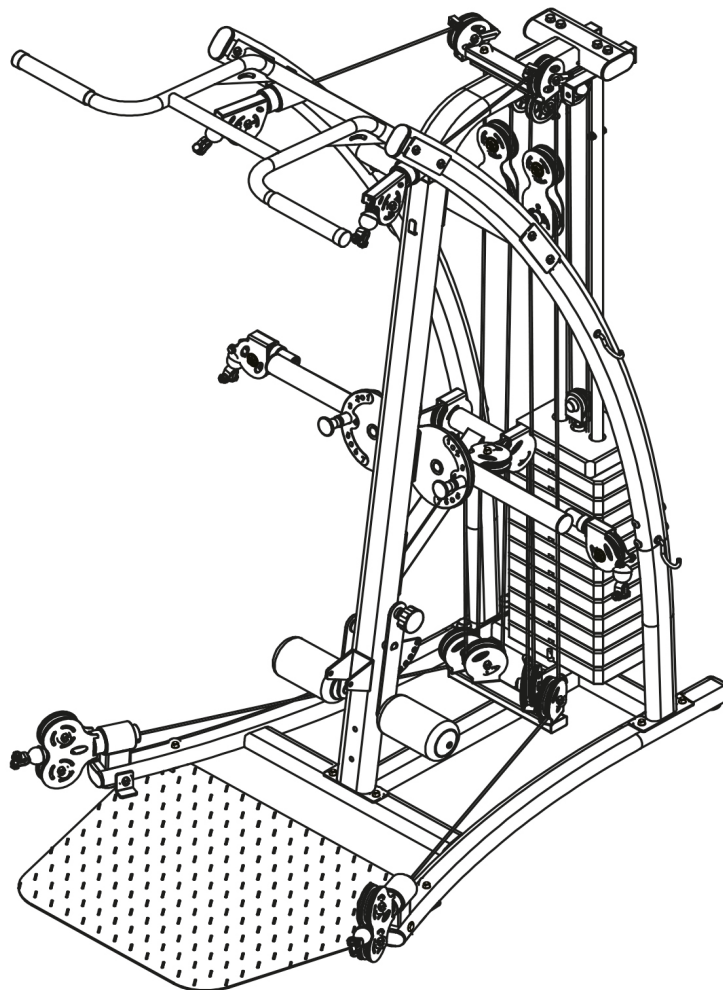

Devide the cable (53) and guide one of its ends starting from point A though the following points: B, C, D, E, F, G, H, I, J and K. When you are finished fix the ball head back to the wire.

Step 10: Exploded drawing

No.	Description	Specification	Qty.
9	flat washer	Φ10	4
24	hexagon bolt	M10x70	2
25	lock nut	M10	2
35	connection part		1
54	shield right		1
55	button head socket screw	M8x16	8
31	flat washer	Φ8	8
57	shield left		1

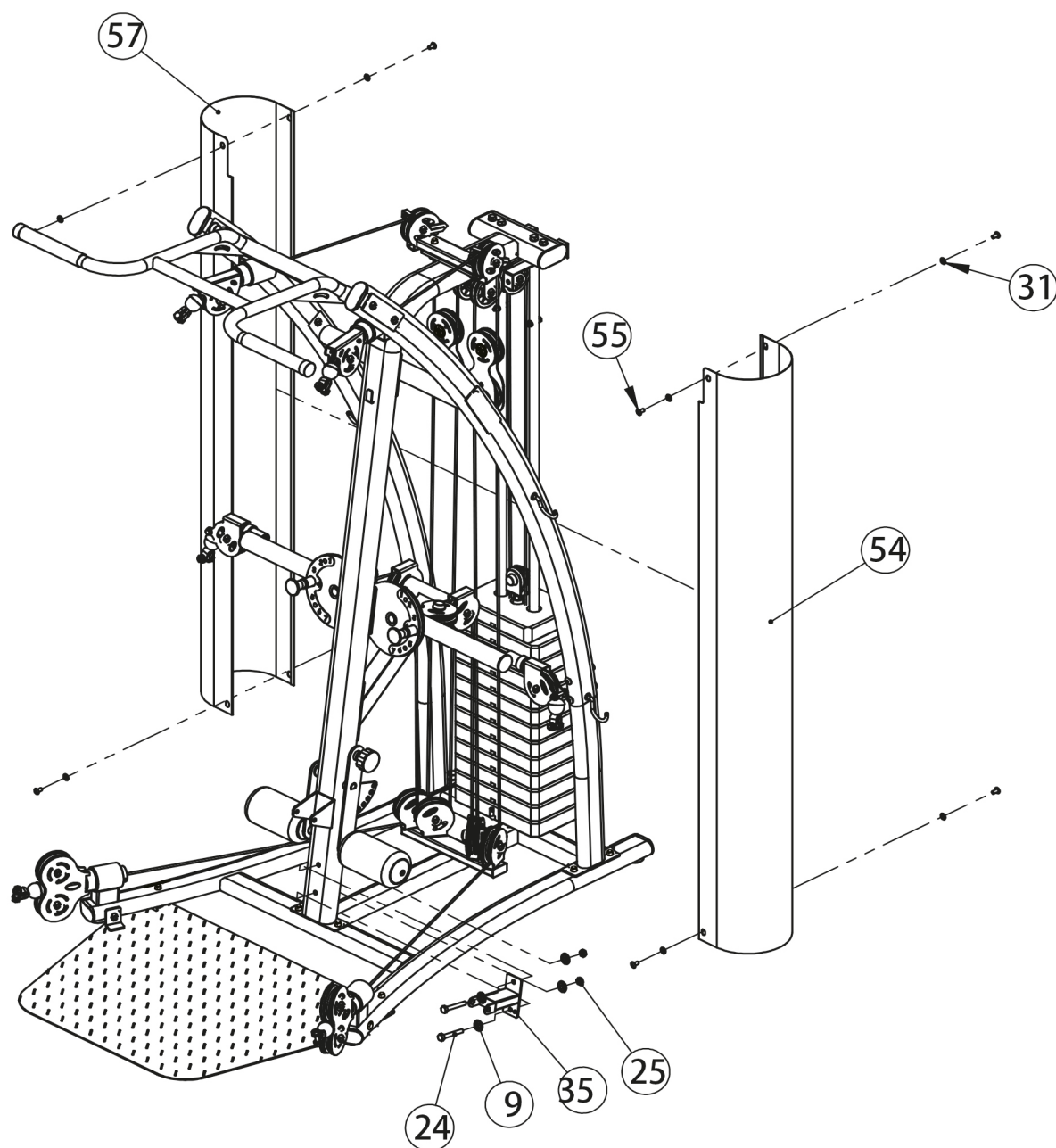

Step 10: Assembly

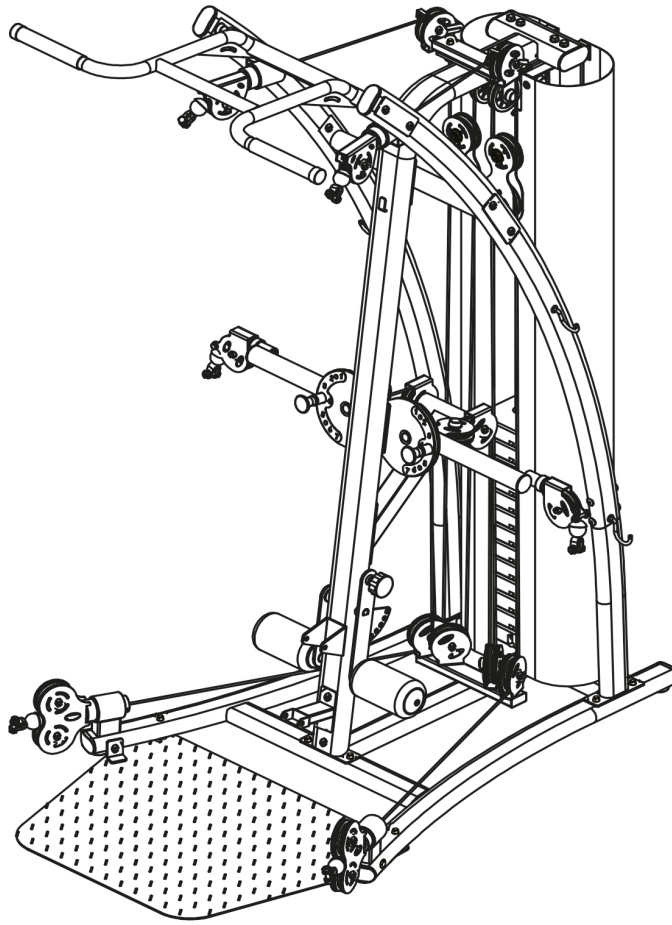

Assemble the connection part (35) to the upper frame (20), using two hexagon bolts (24), four flat washers (9) and two lock nuts (25).

Assemble the two shields (54/57) to the shield support frame (23), using eight head socket screws (55) and eight flat washers (31).

Step 11: Exploded drawing

No.	Description	Specification	Qty.
6	hexagon bolt	M8x20	8
9	flat washer	Φ10	4
22	back cushion		1
25	lock nut	M10	4
28	seat cushion	Φ10	1
31	flat washer	Φ8	8
58	seat cushion tube		1
59	support tube		1
60	seat cushion adjustment tube	Φ12x128	1
61	live shaft		2
62	back cushion tube		1

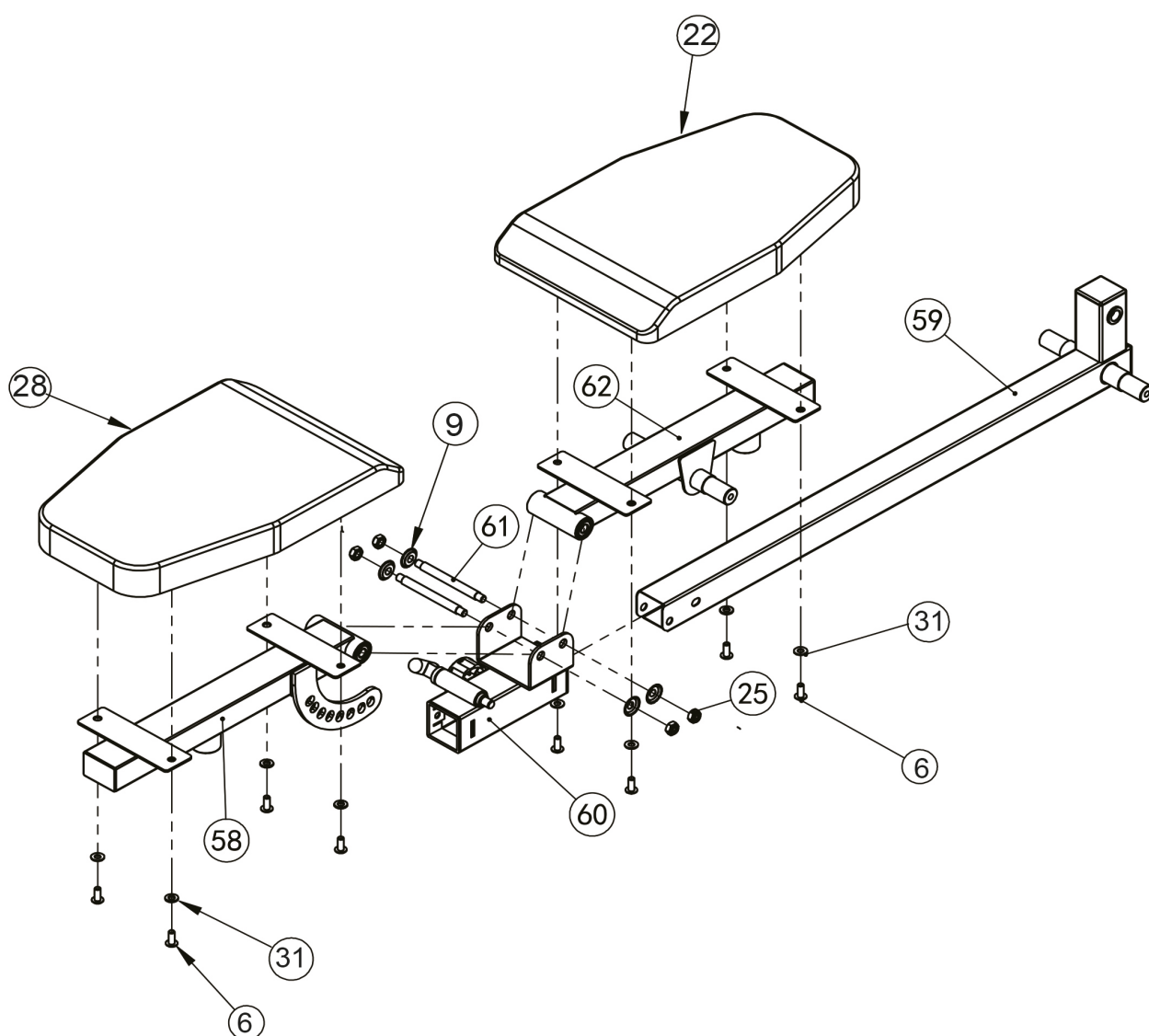

Step 11: Assembly

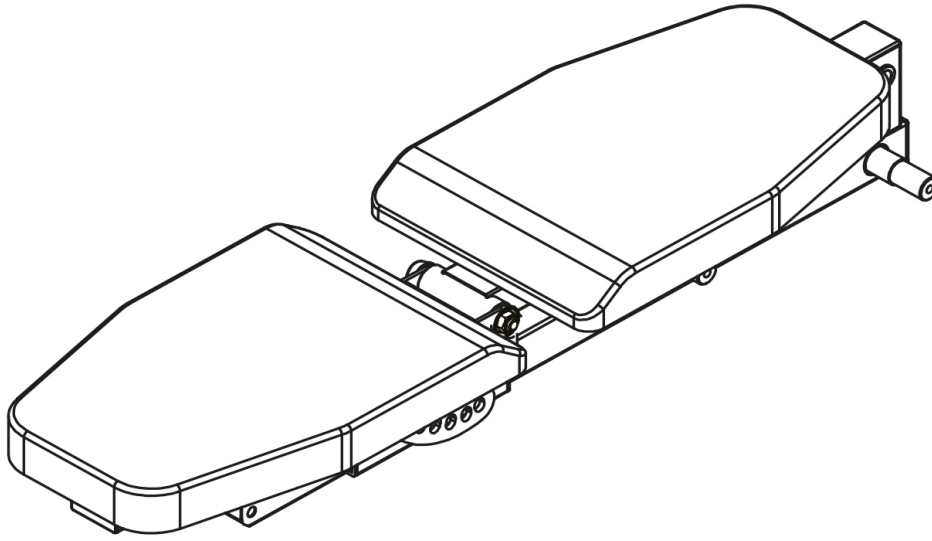

Put the support tube (59) into the seat cushion adjustment tube (60).

Assemble the seat cushion tube (58) and the back cushion tube (62) to the seat cushion adjustment tube (60), using two live shafts (61), four flat washers (9) and four lock nuts (25).

Assemble the back cushion (22) and the seat cushion (28) to the seat cushion tube (58) and the back cushion tube (62), using eight hexagon bolts (6) and eight flat washers (31).

NOTE:

Please make sure that the parts are showing in the correct direction while assembling them. See drawings.

Step 12: Exploded drawing

No.	Description	Specification	Qty.
34	button head socket screw	M10x20	4
63	back cushion support tube		2
64	end cap-50		4

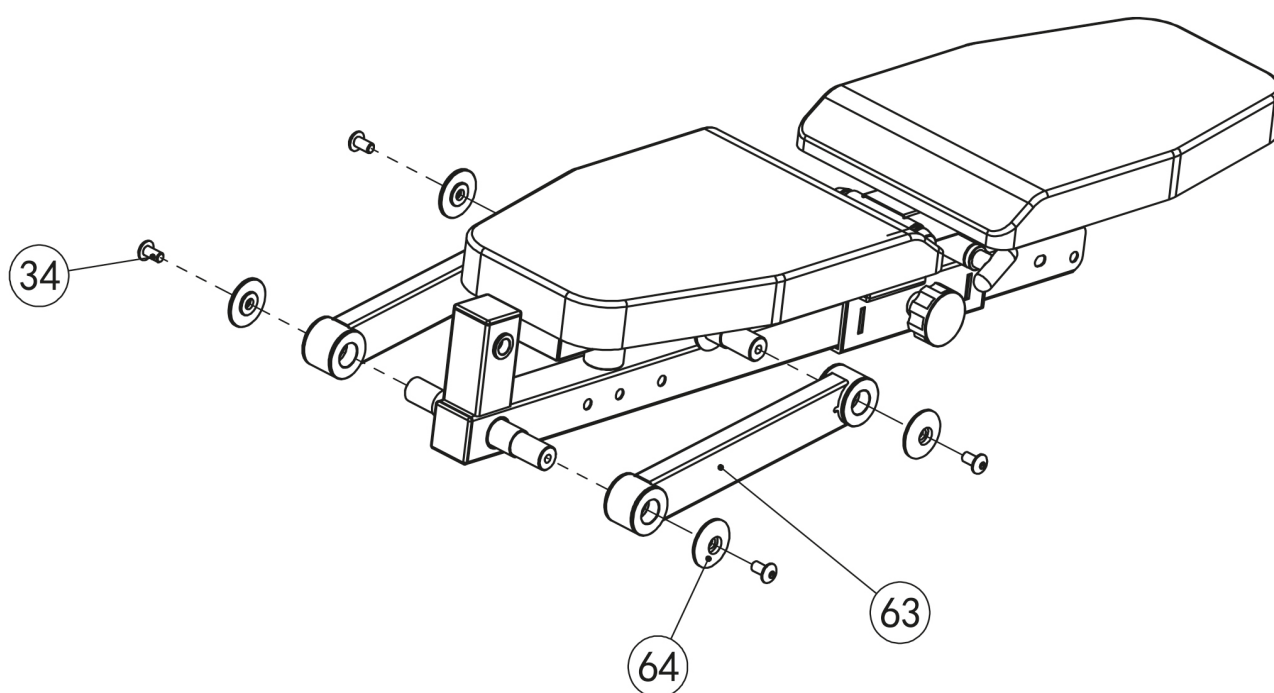

Step 12: Assembly

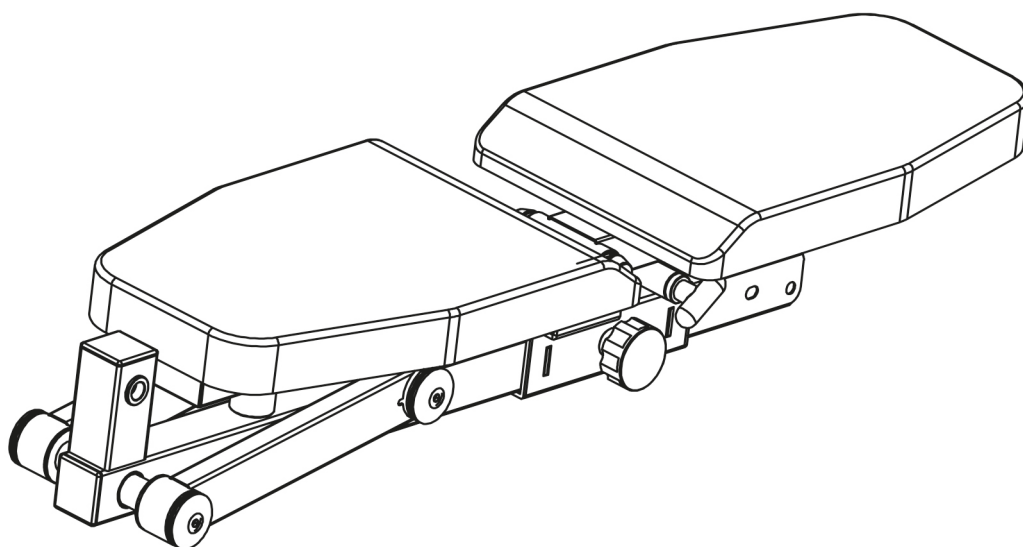

Assemble the two back cushion support tubes (63) to the support tube (59), using four end caps (64) and four button head socket screws (34).

NOTE:

Please check if the parts are showing in the correct direction when you are done assembling them. Apply some silicone on the support tube where the seat is sliding back and forth.

Step 13: Exploded drawing

No.	Description	Specification	Qty.
3	flat washer	Φ12	2
4	lock nut	M12	1
9	flat washer	Φ10	2
24	hexagon bolt	M10x70	1
25	lock nut	M10	1
65	connection rod		1
66	hexagon bolt	M12x75	1
67	shaft	Φ15.9x76.5	1
68	front support frame		1

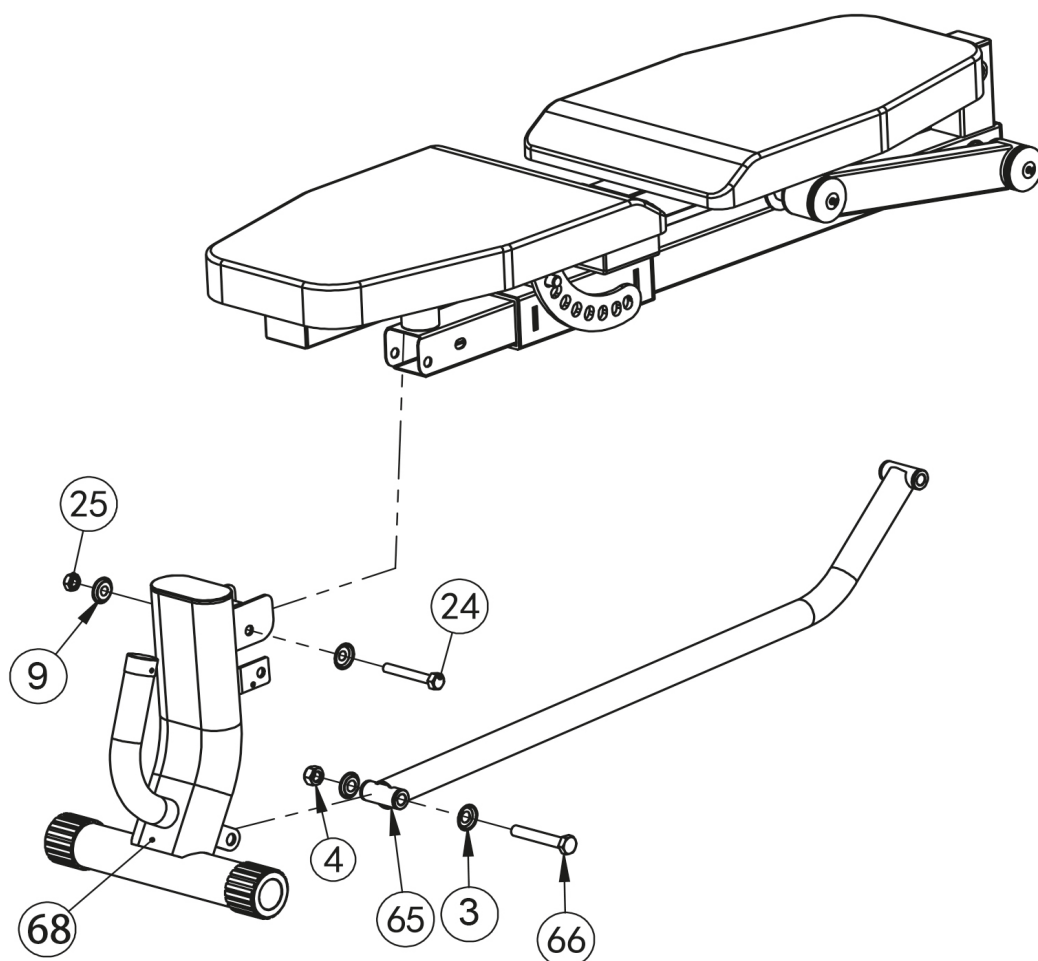

Step 13: Assembly

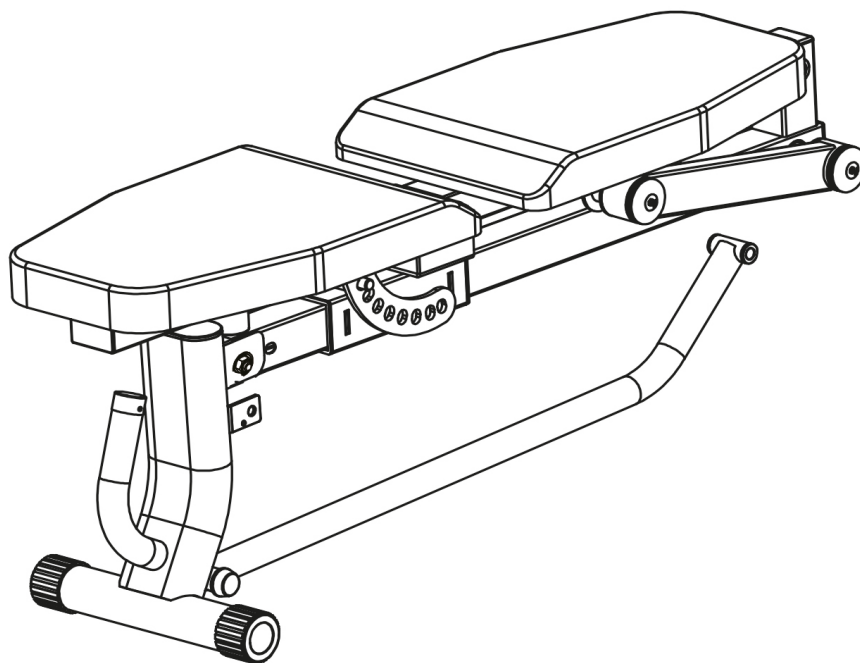

Assemble the front support frame (68) to the support tube (59), using a hexagon bolt (24), two flat washers (9) and one lock nut (25).

Assemble the connection rod (65) to the front support frame (68), using one hexagon bolt (66), two flat washers (3) and one lock nut (25).

Step 14: Exploded drawing

No.	Description	Specification	Qty.
3	flat washer	Φ12	2
4	lock nut	M12	1
9	flat washer		2
10	hexagon bolt	M10x20	2
66	hexagon bolt	M12x75	1
67	shaft	Φ15.9x76.5	1

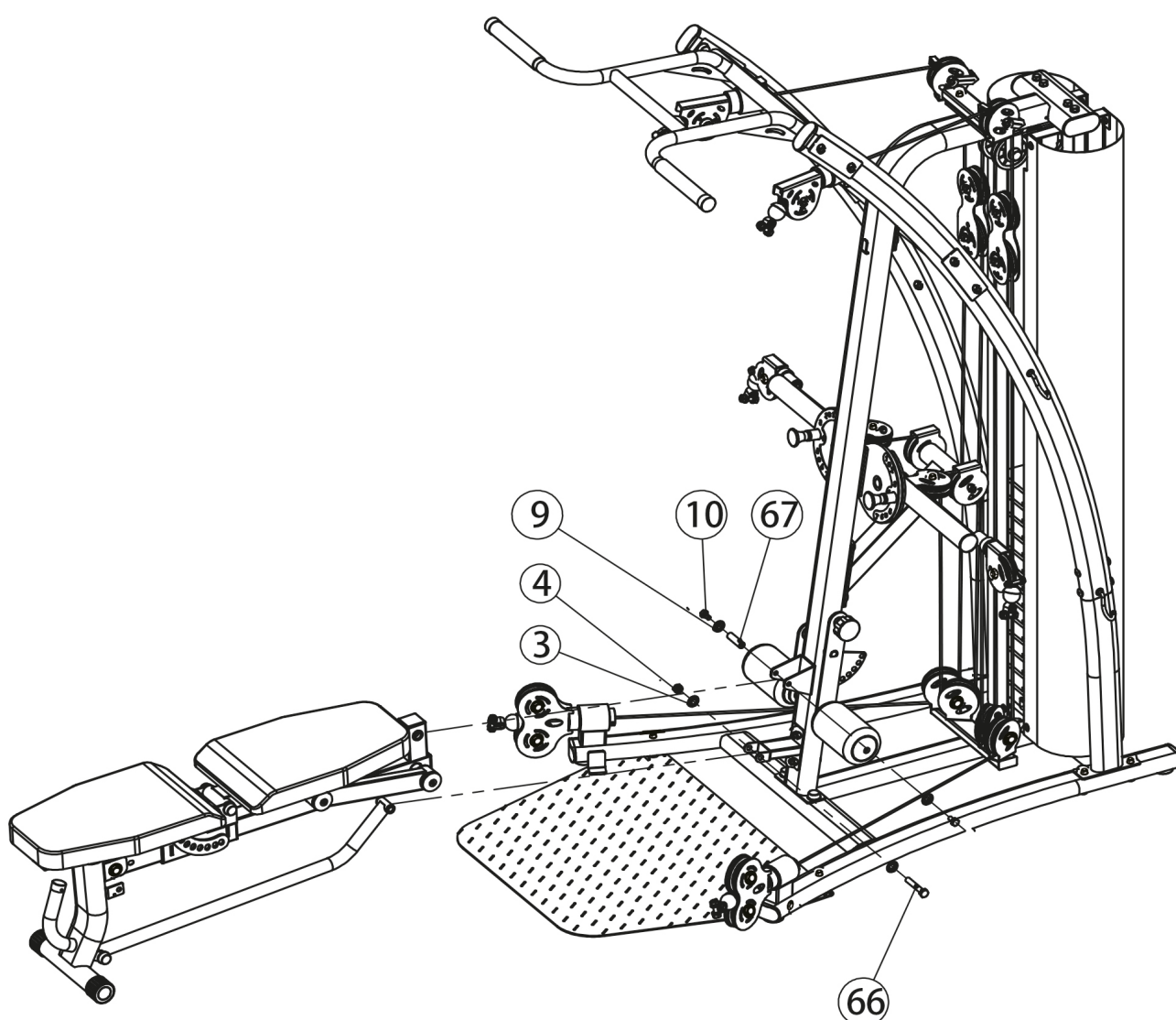

Step 14: Assembly

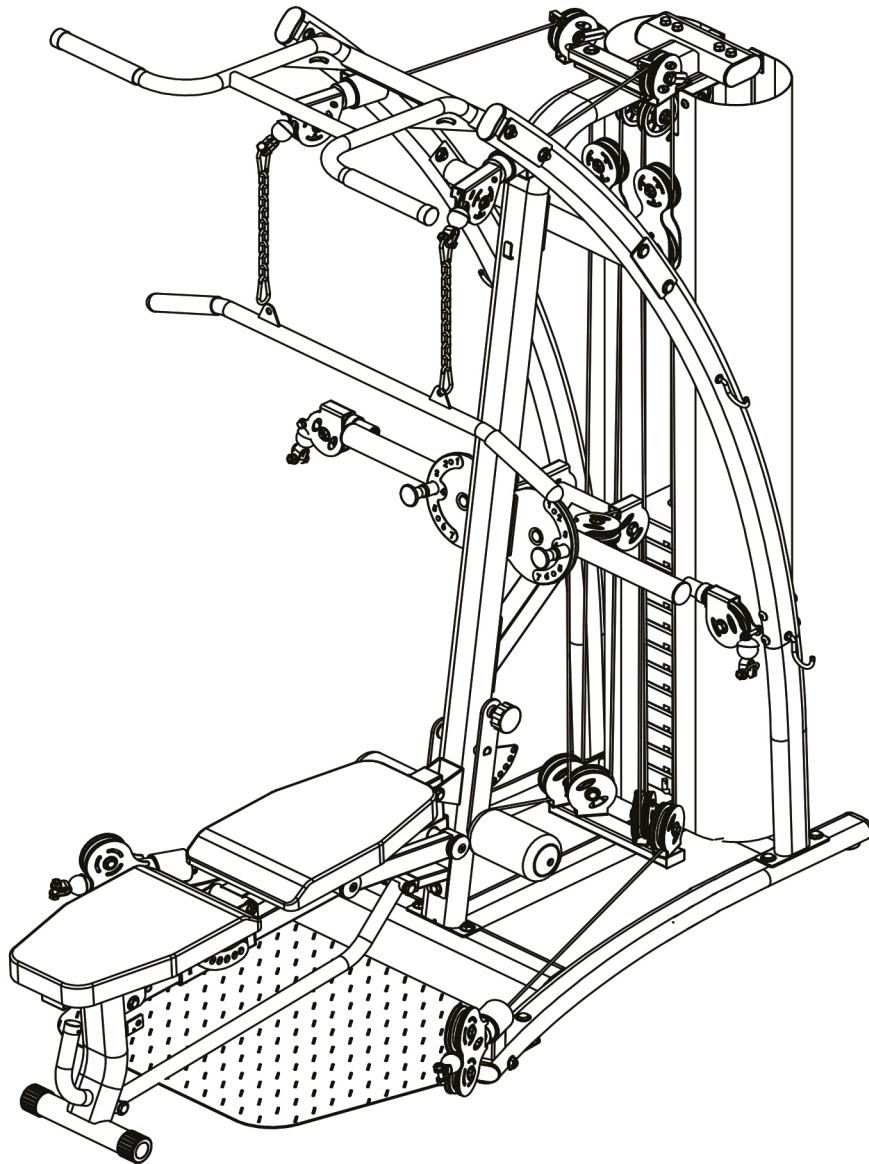

Assemble the support tube (59) to the upper frame (20), using two hexagon bolts (10), one shaft (67) and two flat washers (3) and assemble the connection rod (65) to the connection part (35), using one hexagon bolt (66), two flat washers (3) and one lock nut (4).

Taurus fitness equipment is subject to strict quality controls. However, if a fitness equipment purchased from us does not work perfectly, we take it very seriously and ask you to contact our customer service as indicated. We are happy to help you by phone via our service hotline.

Error descriptions

Your fitness equipment is developed for long-term, high-quality training. However, should a problem arise, please first read the operating instructions. For further assistance, please contact your contract partner or call our service hotline. To ensure your problem is solved as quickly as possible, please describe the defect as exactly as possible.

In addition to the statutory warranty, we provide a warranty for every fitness equipment purchased from us according to the following provisions.

Your statutory rights are not affected.

Warranty

The warrantee is the first/original buyer and/or any person who received a newly purchased product as a gift from the original buyer.

Warranty periods

The following warranty periods begin on delivery of the fitness equipment.

Model	Use	Full warranty
WS5	Home use	24 months

Repair costs

According to our choice, there will either be a repair, a replacement of individual damaged parts or a complete replacement. Spare parts, that have to be mounted while assembling the equipment, have to be replaced by the warrantee personally and are not a part of repair. After the expiration of the warranty period for repair costs, a pure parts warranty applies, which does not include the repair, installation and delivery costs.

The terms of use are defined as follows:

- Home use: solely for private use in private households up to 3 hours per day
- Semi-professional use: up to 6 hours per day (e. g. rehabilitation centers, hotels, clubs, company gyms)
- Professional use: more than 6 hours per day (e. g. commercial gyms)

Warranty service

Within the warranty period, equipment which develops faults as a result of material or manufacturing defects, will be repaired or replaced at our discretion. Ownership of equipment or parts of equipment which have been replaced is transferred to us. The warranty period is not extended nor does a new warranty period begin following repair or replacement under the warranty.

Warranty conditions

For the warranty to be valid, the following steps must be taken:

Please contact our customer service by email or phone. If the product under warranty has to be sent in for repair, the seller bears costs. After expiry of the warranty, the buyer bears the costs of transport and insurance. If the fault is covered by our warranty, you will receive a new or repaired equipment in return.

Warranty claims are invalid in case of damage resulting from:

- misuse or improper handling
- environmental influences (moisture, heat, electrical surge, dust, etc.)
- failure to follow the current safety measures for the equipment
- failure to follow the operating instructions
- use of force (e. g. hitting, kicking, falling)
- interventions which were not carried out by one of our authorized service centers
- unauthorized repair attempts

Proof of purchase and serial number

Please make sure that you are able to provide the appropriate receipt when claiming on your warranty. So that we can clearly identify the model of your equipment, and for the purposes of our quality control, you will need to give the serial number of your equipment, when contacting the service team. Where possible please have your serial number and your customer number ready when you call our service hotline. It will help us to deal with your request swiftly. If you have trouble finding the serial number on your fitness equipment, our service team is at your disposal to offer further information.

Service outside the warranty period

We are also happy to issue an individual cost estimate if there is a problem with your fitness equipment after the warranty has expired, or in cases which do not fall under the terms of the warranty, e. g. normal wear and tear. Please contact our customer service team to find a quick and cost-effective solution to your problem. In such a case you will be responsible for the delivery costs.

Communication

Many problems can be solved just by speaking to us as your contract partner. We know how important it is to you as a user of the fitness equipment to have problems solved quickly and simply, so you can enjoy working out with minimal interruption. For that reason, we also want to resolve your queries quickly and in a straightforward manner. Thus, please always keep your customer number and the serial number of the faulty equipment handy.

5 DISPOSAL

At the end of its operational life, this equipment cannot be disposed of in normal household waste. Instead, it must be disposed of via an electricals recycling centre. Further information can be obtained from your local authority's recycling service.

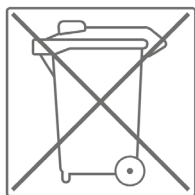

The materials can be recycled as per their symbols. Through the reuse, recycling of materials or other forms of recovery of old equipment, you make an important contribution to the protection of the environment.















6 ORDERING ACCESSORIES

	Floor mat set ArtNr. TF-FMS-B
	Silicone spray ArtNr. ST-1003

7.1 Service hotline

So that we can give you the best possible service, please have your **model name, part number, serial number, exploded drawing and parts list** ready.

SERVICE HOTLINE

DE	DK	FR
 +49 4621 4210-0  +49 4621 4210-699  service@sport-tiedje.de Mo. - Fr. 8:00 - 18:00 Sa. 9:00 - 18:00	 80 90 16 50  +49 4621 4210-945  info@t-fitness.dk Ma. - Fr. 8:00 - 18:00 Lø. 9:00 - 18:00	 +33 (0) 172 770033  +49 4621 4210-933  service-france@sport-tiedje.fr Lun. - Ven. 8:00 - 18:00 Sam. 9:00 - 18:00
NL	UK	INT
 +31 172 619961  info@fitshop.nl Ma. - Do. 9:00 - 17:00 Vr. 9:00 - 21:00 Za. 10:00 - 17:00	 +44 141 876 3972  orders@powerhousefitness.co.uk Mon. - Fri. 9:00 - 17:00	 +49 4621 4210-0  service-int@sport-tiedje.de Mon - Fri 8:00 - 18:00 Sat 9:00 - 18:00

7.2 Serial number and model name

Before assembling your equipment, find the serial number on the white sticker and enter it in the appropriate space.

Serial number:

Brand / category:

Model name:

7.3 Parts list

No.	Description	Specification	Qty.
1	ground tube		1
2	footplate		1
3	flat washer	Φ12	46
4	lock nut	M12	12
5	hexagon bolt	M12x100	2
6	hexagon bolt	M8x20	8
7	hexagon bolt	M12x55	2
8	guide rod		2
9	flat washer	Φ10	32
10	hexagon bolt	M10x20	4
11	weight stack		19
12	pulley frame		1
13	hexagon bolt	M8x40	2
14	arc-shaped washer	Φ8	4
15	lock nut	M8	6
16	rubber cushion	Φ60xΦ26x42	2
17	weight stack pin		1
18	selector rod		1
19	magnetic pin	Φ10x100	2
20	upper frame		1
21	hexagon bolt	M12x45	6
22	back cushion		1
23	shield support frame		1
24	hexagon bolt	M10x70	7
25	lock nut	M10	11
26	upper pulley frame		1
27	hexagon bolt	M10x45	2
28	set cushion	1	1
29	big bending tube left		1
30	big bending tube right		1
31	flat washer	Φ8	12
32	hook		4

No.	Description	Specification	Qty.
33	connection tube		2
34	button head socket screw	M10x20	15
35	connection part		1
36	chip up bar		1
37	hexagon bolt	M12x65	8
38	reinforcing plate	t4.0x50x160	4
39	connection frame		1
40	hexagon bolt	M12x30	8
41	butterfly arm left		1
42	big flat washer	Φ10	3
43	butterfly arm right		1
44	pulley support frame		1
45	butterfly arm plate		1
46	pulley frame		2
47	leg press frame		1
48	leg press frame small		1
49	stop collar		2
50	socket set screw	M8x10	4
51	wire		1
52	double pulley frame		2
53	wire		2
54	shield right		1
55	button head socket screw	M8x16	8
57	shield left		1
58	seat cushion tube		1
59	support tube		1
60	seat cushion adjustment tube		1
61	axis of rotation	Φ12x128	2
62	back cushion tube		1
63	back cushion support tube		2
64	end cap-50		4
65	connection rod		1
66	hexagon bolt	M12x75	2
66	hexagon bolt	M12x75	2

No.	Description	Specification	Qty.
67	shaft	Φ15.9x76.5	1
68	front support frame		1
70	chain		4
71	long bar		1
72	ship bar short		1
73	belt		2
74	ship bar long		1
75	triceps rope		1

7.4 Exploded drawing

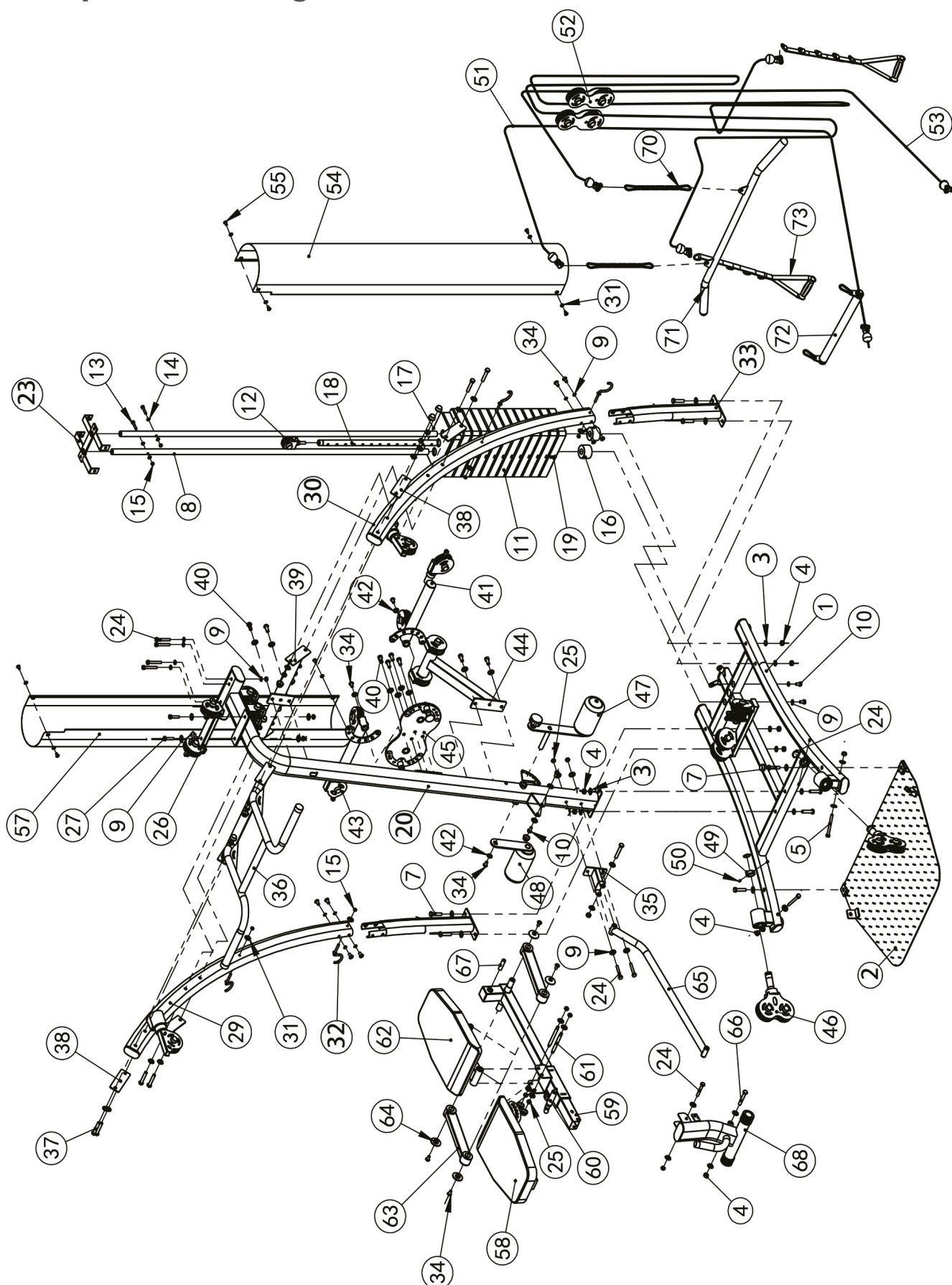















CONTACT

Company head office

Sport-Tiedje GmbH
Flensburger Str. 55
24837 Schleswig
Germany

Hotline for Technical Information

DE	DK	FR
 +49 4621 4210-0  +49 4621 4210-698  technik@sport-tiedje.de	 80 90 16 50  +49 4621 4210-945  info@t-fitness.dk	 +33 (0) 172 770033  +49 4621 4210-933  service-france@sport-tiedje.fr
NL	UK	INT
 +31 172 619961  info@fitshop.nl	 +44 141 876 3986  support@powerhousefitness.co.uk	 +49 4621 4210-0  service-int@sport-tiedje.de

www.sport-tiedje.com
www.taurus-fitness.de

DISCLAIMER



©2011 TAURUS® is a registered brand of the company Sport-Tiedje GmbH. All rights reserved. Any use of this trademark without the explicit written permission of Sport-Tiedje is prohibited.

Product and instructions are subject to change. Technical data can be changed without advance notice.

Please find a detailed overview including address and opening hours for all specialist fitness stores of the Sport-Tiedje Group in Germany and abroad on the following website.

www.sport-tiedje.com/en/stores

Notes

Notes

Notes

TAURUS®

(Weight station WS5)