

NX713

SmartAccess Link Wide 7-inch VGA Digital
Terrestrial TV/DVD/SD
AV Navigation

NX613

SmartAccess Link Wide 7-inch VGA Digital
Terrestrial TV/DVD/SD
AV Navigation

Thank you for purchasing a Clarion product. •Please read this installation manual carefully before installing and wiring the product, and work safely and correctly. •Please keep this manual together with the instruction manual in a safe place.

<Request to customers> Installation and wiring of this unit requires specialized skills and experience. We recommend that you have the installation done at the store where you purchased the unit.

<Request to dealers> After installation is complete, please give this "Installation Instructions" to the customer.

Clarion Co., Ltd.

Clarion Homepage <http://www.clarion.com> For inquiries, please contact the customer service center toll-free at **0120-112-140**

Purchase date

Year Month Day

Purchase store name

TEL.

(9:30-12:00, 13:00-17:00 except Saturdays, Sundays, holidays, and national holidays)

For safe and proper use

•Please read this "Installation Manual" carefully before installation and install the product correctly. •After reading the manual, be sure to keep it in a place where you can easily see it at any time (such as the glove box).

Regarding pictorial symbols: This "Installation Manual" uses various pictorial symbols to ensure that you use the product safely and correctly, and to prevent injury to yourself or others, and damage to property. The symbols and their meanings are as follows.

Please read the main text after fully understanding the contents.

caveat

This symbol indicates that ignoring this symbol and handling the product improperly may result in death or serious injury.

Note

This symbol indicates that ignoring this symbol and handling the product improperly may result in injury to persons or physical damage.

Examples of pictorial symbols

| | |
|--|--|
| | ⚠ The symbol indicates that there is a warning or caution. The specific caution is depicted in the image (in the left image, watch out for pinched fingers). |
| | ⊘ The symbol indicates that an action is prohibited. The specific prohibition is illustrated in the image (in the left image, disassembly is prohibited). |
| | ❗ Symbols indicate things that require or instruct you to do something. |

Before you start work

caveat

•Check the battery voltage of the vehicle you are installing it on...
This unit is designed for use with DC12V vehicles only. Do not use it in 24V vehicles such as large trucks or diesel vehicles designed for cold climates. Doing so may result in fire or breakdown.

•Disconnect the negative battery cable while performing wiring work... Otherwise, it may cause a short circuit and result in electric shock or injury.

When connecting the power terminal of this unit directly to a battery, use a power cord with a capacity equal to or greater than the specified capacity. Using a cord with a capacity smaller than the specified capacity may exceed the current capacity, resulting in a fire or electric shock.

•When replacing a fuse, always use a fuse of the specified capacity... Using a fuse with a capacity larger than the specified capacity may cause a fire.

❗

⚠

❗

❗

About installation location

caveat

Do not install this unit in the following locations:
- Places that obstruct forward visibility - Places that obstruct driving operations such as steering, shift lever, and brake pedal - Places that pose a danger to passengers
It may interfere with driving operations or become detached, resulting in traffic accidents or injuries.

When installing in a vehicle equipped with an airbag, do not install in a position that may affect the operation of the system.
If the airbag does not operate properly, it may cause an accident or injury in the event of an accident.

Note

Do not place in locations subject to rain, water, humidity, or dust.
If water, moisture or dust gets into the unit, it may cause smoke or fire.

Do not install in places with a lot of vibration or where it cannot be secured securely.
The unit may come off and cause an accident or injury.

•Do not install the antenna in a location that is exposed to direct sunlight or hot air from a heater, or in a location that blocks the ventilation holes or heat dissipation section of the unit. Heat may build up inside the unit, which may result in a fire. •When installing a film antenna, attach it to the specified installation location.
If you place it in a position that obstructs your view, it will interfere with safe driving.

Installation precautions

caveat

If you are drilling holes in the vehicle to install the product, check the position of pipes, tanks, electrical wiring, etc., and take care not to interfere with or come into contact with these. Damage to pipes, etc. may result in a fire or accident.

Note

• Always use the included parts as specified...
Using parts other than those specified may damage internal parts or cause them to come loose, resulting in accidents or malfunctions.

When drilling holes in the vehicle body to route cables, use insulating grommets.
Contact between the opening and the cords may cause them to wear out and short out, which may result in an accident or fire.

• Never use bolts or nuts attached to important safety parts of the vehicle (steering, seat rails, brake system, gasoline tank, etc.)... using these may result in inability to brake, breakdowns, or fires.

When installing using the screws on the vehicle, be sure to tighten them securely so they do not come loose.
The screws may come loose and cause accidents or breakdowns.

Wiring precautions

caveat

• When wiring connection cables, avoid high heat areas.
The insulation of the cords may melt and cause a short circuit, which may lead to an accident or fire. Be particularly careful with the wiring in the engine compartment.

• Keep cables together so they don't get in the way of driving...
If it gets wrapped around the steering wheel, shift lever, brake pedal, etc., it can cause an accident.

• Never cut the power cord cover to power other devices...
This may exceed the current capacity of the power cord and cause a fire or electric shock.

When using bolts and nuts on the vehicle body to ground the steering wheel, seat rail, etc.
Do not use screws that are attached to important safety parts such as brakes or steering wheels.
Doing so may cause accidents or breakdowns.

When wiring connection cords in a vehicle equipped with an airbag, do not wire them in a position that will affect the operation of the system. If the airbag does not operate normally, it could cause an accident or injury in the event of an accident.

❗

⚠

⊘

⊘

⊘

⊘

Note

• Make a proper connection...
Incorrect connection may result in an accident or fire.

After completing wiring, secure the cords with clamps or insulating tape.
If the cords come into contact with the vehicle body, they may become frayed and short out, causing an accident or fire.

Do not pinch cables in moving parts such as the body, screws, or seat rails.
A broken wire or short circuit may cause an accident, electric shock, or fire.

❗

❗

⚠

After installation is complete

After installation is complete, operate the unit and check the connections and operation by following the instruction manual included with the product.

To check the unit after installation

ご使用には利用開始日を登録する必要があります
「利用開始」を選択すると利用開始日を登録します。
店舗での取り付け確認時は、「取り付け確認」を選択してください。

利用開始

取り付け確認

Touch "Installation Check" on the screen that appears after starting up the unit. The screen will switch to the navigation screen. * If no operation is performed for 3 minutes, the screen will remain on the navigation screen. will switch to.

* To start using the service, please touch the Don't do that.

Product configuration

| | | | | | |
|-------------------|--------------------------------|---------------------------------|-------------------------------|--------------------------------|-----------------------------|
| 1 Main unit | 1 2 TV antenna (ZCP-131) | 1 2 TV | 8 Accessory bag..... | 1 9 Warranty card..... | 1 0 Instruction manual..... |
| (2.5m) | 1 4 Power cord | 1 5 Hands-free microphone | 1 6 Extension USB cable | 1 7 SD memory card (4GB) | 1 |
| | | | | | |

*1. For details on the TV antenna product configuration, please refer to the TV antenna installation manual included with the product. Two antennas (L) and two antennas (R).

8 Accessory bag Contents list

| | | | | | |
|--------------------------|------------------------------------|---|---|------------------------|---|
| 1. Wiring connector..... | 3 2. Mounting screw (M5 x 8) | 8 3. Mounting screw (M5 x 8 flathead) | 8 4. Double-sided tape for fixing GPS antenna | 1 5. Cord holder | 6 |
| | | | | | |

1

2

3

4

5

How to install

Installation precautions

1. Install the unit within 40° of the horizontal surface.

2. With the exception of some vehicle models, the product can be installed using the vehicle's mounting brackets.

3. Depending on the vehicle model and year, installation may not be possible unless a special installation kit is used. Please consult your dealer.

4. This unit is equipped with a fan motor to prevent the temperature inside the unit from rising. If the exhaust port of the fan motor is blocked by a cord or mounting bracket, it may cause a breakdown or a fire, so please be careful with the wiring, etc.

5. When opening and closing the panel of this unit, it may come into contact with the center panel of some vehicle models. If this occurs, modify the center panel before installing the unit so that it does not come into contact with the panel.

6. When installing, be careful not to press too hard against the panel surface of the unit as this may cause a malfunction.

Within 40°

< Rear of the unit >

Fan motor exhaust port

MAX.8mm

MAX.8mm

Case

Case

Damage

Note

• Be sure to use the included screws according to the shape of the screw holes on the mounting bracket. Using screws other than those specified may cause an accident or malfunction.

Mounting holes: This unit

has mounting holes for Nissan vehicles, Toyota vehicles, and our vehicle-specific kits. If you are using our mounting kit (sold separately), use one of the holes marked with * to install, although this may vary slightly depending on the vehicle model.

For Nissan vehicles

Install using 3 to 4 of the • points shown in the left illustration.

< Mounting bracket example >

For Toyota/Daihatsu vehicles (panel width 200mm size)

Use the four points shown in the diagram on the left to install the unit. <Example of mounting bracket>

For Toyota/Daihatsu (other than the above types), Suzuki, and Subaru vehicles

Install using the four points shown in the diagram on the left.

< Mounting bracket example >

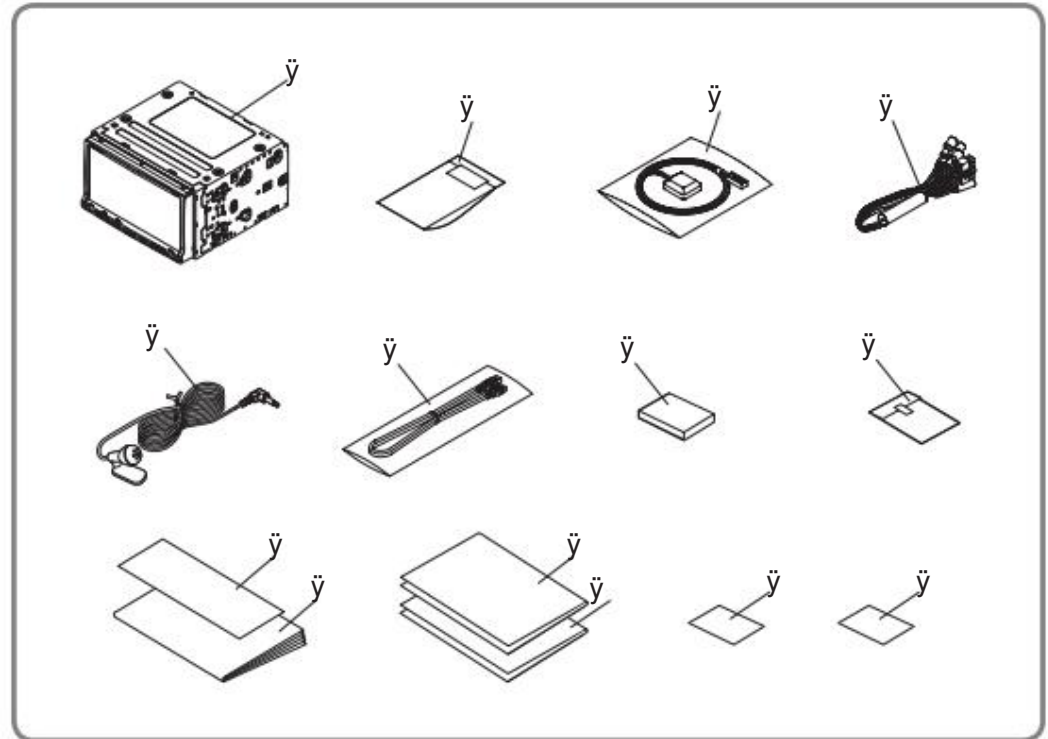

Installation example

Here are installation examples for Honda and Toyota vehicles. For details, please refer to the instruction manual included with the dedicated installation kit (sold separately) for each vehicle model.

Installation example for Honda vehicles

This is an example using a separately sold mounting kit (2DIN space mounting kit for Honda vehicles).

Installation example for Toyota vehicles

This is an example using a separately sold mounting kit (200mm face panel for Toyota vehicles).

Mounting bracket (side) (included in the mounting kit sold separately)

Finisher (included in the mounting kit sold separately)

Sponge tape (included in the mounting kit sold separately)

Flat head screws (M5 x 6) x 2 (included in the mounting kit sold separately)

After installing the mounting bracket, tighten it together with the bracket on the vehicle side to install it.

