

# INSTRUCTION MANUAL



## PANINI MAKER



MODEL 300000IBR

PLEASE READ THIS MANUAL CAREFULLY PRIOR TO OPERATING  
YOUR PRODUCT AND RETAIN IT FOR FUTURE REFERENCE

---

# IMPORTANT SAFETY INFORMATION

1. READ ALL INSTRUCTIONS.
2. The voltage and frequency requirements for this product are AC 120 V, 60 Hz. Only for household use.
3.  **WARNING!** Surfaces are liable to become hot during use.
4. Do not touch hot surfaces. Use the handles and knob.
5. To protect against the risk of electric shock, do not immerse the cord, plug or cooking unit in water or any other liquid.
6. Close supervision is essential when the appliance is being used by or near children.
7. Unplug the appliance when not in use and prior to cleaning. Always unplug the appliance by pulling the plug from the socket. Do not pull on the cord. Allow the appliance to cool down prior to attaching or removing parts and prior to cleaning.
8. If the supply cord is damaged, it must be replaced by the manufacturer, their service agent or similarly qualified persons to avoid hazards.

- 
9. Do not operate the appliance if it is malfunctioning or has been damaged in any manner. To avoid the risk of electric shock, never attempt to repair the appliance yourself. Take it to an authorized repairer. Incorrect reassembly may introduce the risk of electric shock.
  10. The use of attachments is not recommended by the manufacturer and may result in fire, electrical shock or other injuries.
  11. Do not use outdoors or for commercial purposes.
  12. Do not allow the power cord to hang over the edge of the table or counter or touch hot surfaces.
  13. Do not place the appliance on or near a hot gas or electric burner or a hot oven.
  14. Do not operate the appliance by means of an external timer or separate remote-control system.
  15. Extreme caution must be exercised when moving the appliance.
  16. The appliance is suitable for use by children aged 8 years and above and persons with reduced physical, sensory or mental capabilities or lack of

---

experience and knowledge only if supervised or instructed on the use of the appliance and its related safety hazards. Children must not play with the appliance. Cleaning and user maintenance must not be undertaken by children unless they are 8 years or above and supervised.

17. Keep the appliance and its cord out of reach of children under the age of 8.
18. Operate the appliance in a well-ventilated area. Prior to operation, ensure there is at least 10 cm of clear space on all sides of the appliance to allow for adequate air circulation.
19. Do not allow the appliance to touch curtains, wall coverings, clothing, dishtowels or other flammable materials when in operation.
20. Do not attempt to remove food residue or otherwise clean the appliance when it is in operation.
21. This appliance is intended for household or similar use such as:
  - in staff kitchen areas in shops, offices and other work environments;
  - by clients in hotels, motels, B&Bs and other residential-type environments.



CONTENTS

IMPORTANT SAFETY INFORMATION .....1-3

TECHNICAL SPECIFICATIONS ..... 4

PRODUCT OVERVIEW ..... 4

PRIOR TO FIRST USE ..... 5

OPERATING INSTRUCTIONS ..... 5

CLEANING AND MAINTENANCE ..... 6

STORAGE ..... 6

TECHNICAL SPECIFICATIONS

Model No.	300000IBR
Power Supply	120V 60Hz
Power Consumption	1500W
Dimensions	L315*W276*H112mm

Specifications and design are subject to change without notice.

PRODUCT OVERVIEW

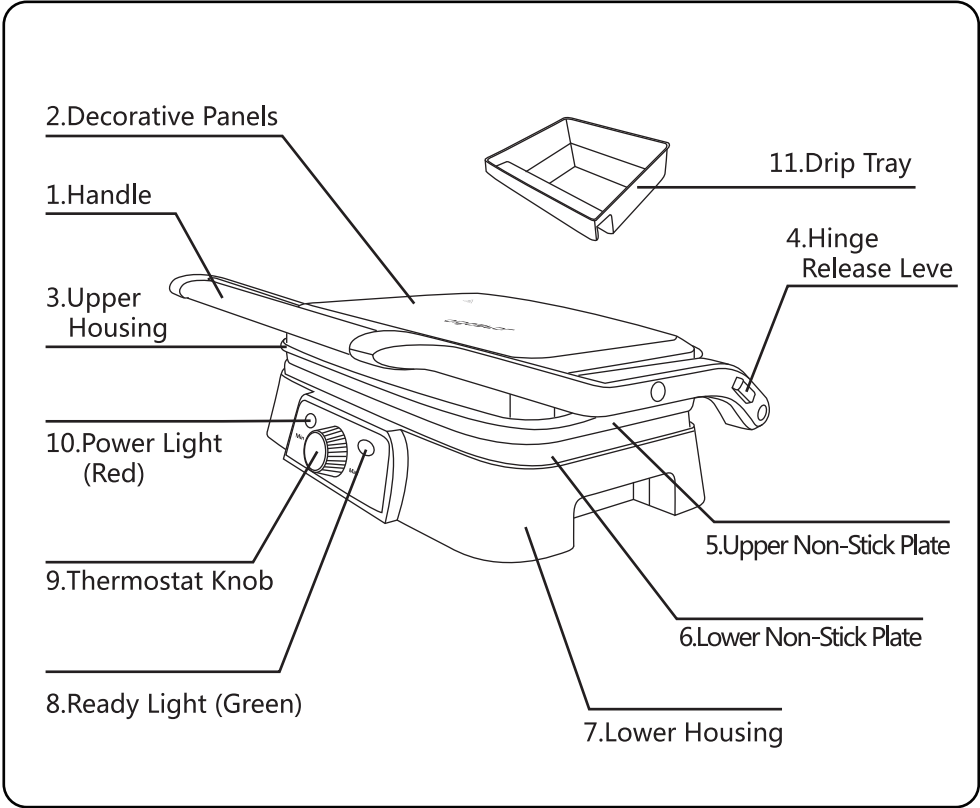

## PRIOR TO FIRST USE

1. Remove all packaging.
2. Wipe the cooking plates with a sponge or damp cloth and warm water.
3. Do not immerse the unit in water or rinse the cooking surfaces under running water.
4. Dry the appliance with a cloth or paper towel. For best results, lightly coat the cooking plates with a little cooking oil or cooking spray.
5. Notice: When your appliance is heated for the first time it may emit a small amount of smoke or a slight odor. This is normal and poses no safety concerns.

## OPERATING INSTRUCTIONS

### AS A PRESS GRILL

1. First, set the temperature control to MAX. You can adjust it later according to your preferences.
2. Close the appliance and plug it into the socket. You will notice that the power and ready light will go on indicating that the appliance has begun heating.
3. It will take approximately 2-3 minutes for the appliance to reach the appropriate temperature at which point the ready light will go off.
4. Once the ready light is off, open the appliance and place the panini or other food items on the lower cooking plate.
5. Close the appliance. The ready light will go on again.
6. Cook for about 3 to 8 minutes until the ready light goes off or until the panini etc. turns golden brown, adjusting the temperature controls to suit your tastes.
7. When the food is heated/cooked to

the desired degree, use the handle to open the lid. Remove the food items with the help of a plastic spatula. Never use metal tongs or a knife as these can damage the non-stick coating of the cooking plates.

8. Once you are finished, unplug the appliance and leave the unit open to cool.

### AS AN OPEN GRILL

1. The appliance's upper and lower cooking plates can line up to create a large, double-size cooking surface. Using the appliance as an open grill is a versatile cooking option.
2. Place the appliance on a clean, flat surface.
3. With your left hand on the handle, use your right hand to slide the hinge release lever toward you. Push the handle back until the cover rests flat on the counter. The unit will stay in this position until you lift the handle and cover to return it to the closed position.

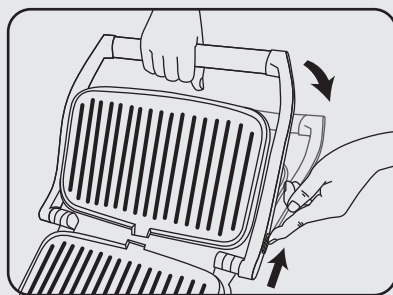

4. You can use the open grill option to cook burgers, steak, poultry (we do not recommend cooking bone-in chicken using this method as it does not cook evenly on an open grill), fish and vegetables.

---

## CLEANING AND MAINTENANCE

1. Always unplug the appliance and allow it to cool prior to cleaning. The unit is easier to clean when slightly warm. There is no need to disassemble the appliance to clean it. Never immerse the appliance in water. The appliance is NOT dishwasher-safe.
2. Wipe the cooking plates with a soft cloth to remove food residue. For baked-on food residue, squeeze some warm water mixed with detergent over the residue then clean the affected area with a non-abrasive plastic scouring pad or place wet paper towel over the area to loosen the food residue.
3. Do not use abrasive cleaning products as these can scratch and damage the cooking plates' non-stick coating.
4. Do not use metal utensils to remove your food items as these can damage the cooking plates' non-stick surface.
5. Wipe the outside of the appliance with a damp cloth only. Do not clean the outside with an abrasive scouring pad or steel wool as this will damage the finish.
6. Remove and empty the drip tray after each use and wash the tray in warm, soapy water. Avoid using scouring pads or harsh detergents as these may damage the surface of the tray. Rinse and dry the tray thoroughly with a clean, soft cloth and replace.

## STORAGE

- Always unplug the appliance prior to storage.
- Always ensure the appliance is cool and dry prior to storage.

WARRANTY: 2 YEARS



AIGOSTAR INC  
489 Yorbita Rd, City of Industry, CA 91744 (UNIT A)

---

**HTTP: //WWW. AIGOSTARUSA. COM**  
MADE IN P. R. C