

WELCOME TO FLOOR WHEEL DRIVE.

SmartClean
robo vac **V2**



USER MANUAL

Table of Contents

1.	Introduction
2.	SmartClean robo vac V2
2.1	Accessories
2.2	Remote Control
2.3	Charging Dock
3.	Using the SmartClean robo vac V2
3.1	Basic Operation Functions
3.2	Cleaning Modes
3.3	Cleaning Cycles
3.4	Downloading the Tzumi App
3.5	Tzumi Smart Phone App Setup
3.6	Google Assistant & Amazon Alexa Instructions
4.	SmartClean robovac V2 Care
4.1	Emptying the dust bin
4.2	Cleaning the filter
4.3	Cleaning the side brushes
4.4	Cleaning the Anti-Drop sensors and Charging Contacts
4.5	Cleaning the Anti-Collision Sensor
4.6	Cleaning the main Brush
5.	User Cautions
5.1	Batter Care and Charging
5.2	Troubleshooting
5.3	Frequently Asked Questions
5.4	Specifications
6.	Important Safety information





SMART CLEAN DOES THE WORK FOR YOU

This intelligent vacuum travels through living spaces, bedrooms, kitchens, and more to deliver a cleaning experience that's hassle-free and stays out of your way. It can easily navigate from hardwood floors to rugs and carpet with gripping rubber wheels. Its slim frame quietly utilizes a super-efficient, 3-stage cleaning system that has four modes and can be operated via remote or the tsumi Smart Home app, compatible with Alexa and Google Assistant. Program it to clean when you want, and when the job is done (or the battery is running low), **SMART CLEAN V2** returns to its dock for automatic charging.

Get ready to sit back, relax & **SmartClean** do the work.



2. Smart Clean V2 Diagrams

Main Unit

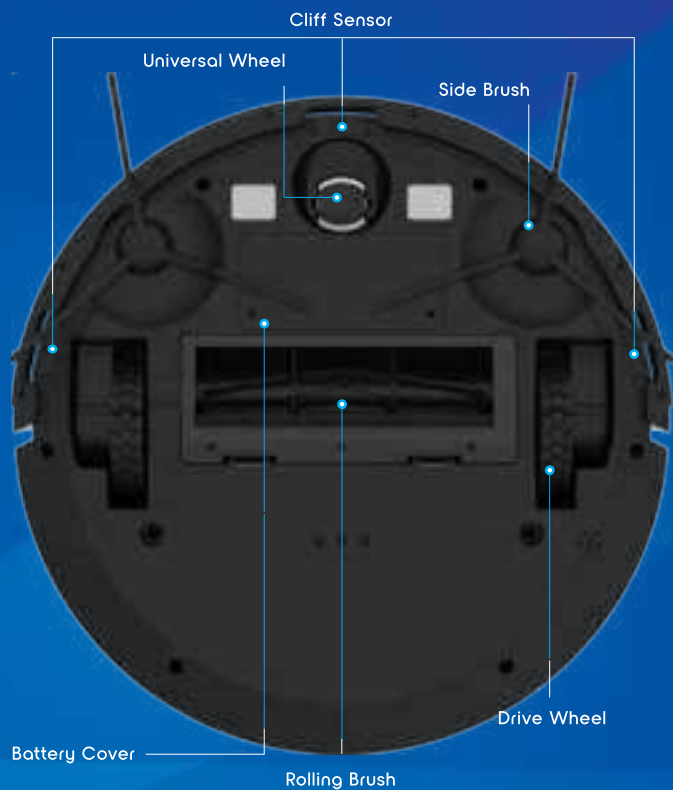

Return to Dock/Pause
Short Press for return/Pause

On/Off/Pause

- Short tap for On/Pause
- Long tap 3-second for On/Off

Indicator

- Blue: Normal
- Red: Abnormal or low battery
- Flashing Blue: Charging



Its slim frame quietly utilizes a super-efficient, 3-stage cleaning system that has four modes and can be operated via remote or the tzumi Smart Home app, compatible with Alexa and Google Assistant. Program it to clean when you want, and when the job is done (or the battery is running low), **SMART CLEAN V2** returns to its dock for automatic charging.



2.1 Fully Loaded



Remote Control 2.2

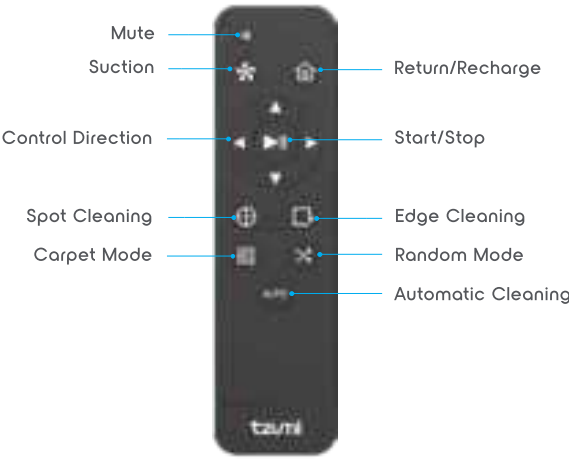

Charging Dock 2.3

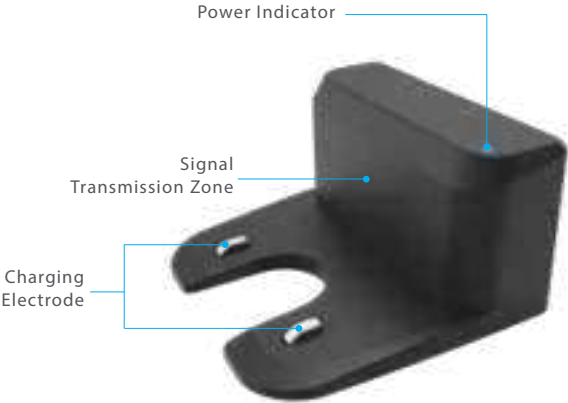

3 Let's Get Started

- 1 Plug in the Charging Dock into the wall and tie up any excess wire so it will not interfere with the vacuum.

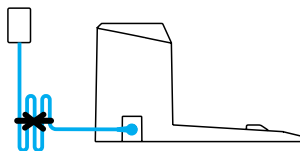

Note: Failure to tie up remaining wire might cause vac to accidentally pull it while charging or cleaning.

- 2 Place charging dock on a hard level surface and against a wall.

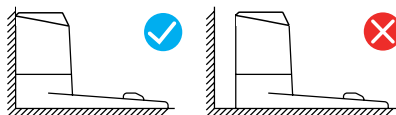

- 3 Check to make sure the area around charging dock is open and uncluttered. I'd say leave about 3 feet on both sides and 6 feet in front of it free.

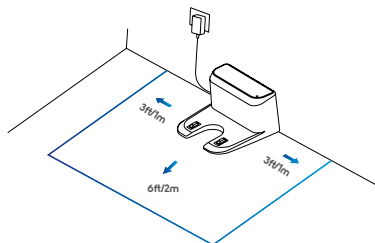

- 4 Now it's time to install side brushes. Press them into their designated slots until you hear a click.

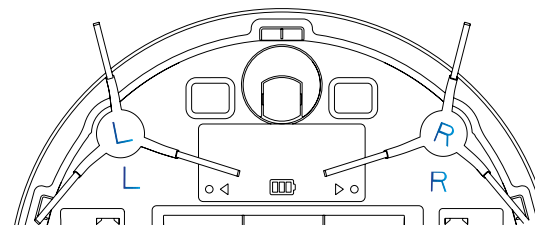

- 5 Powering up!

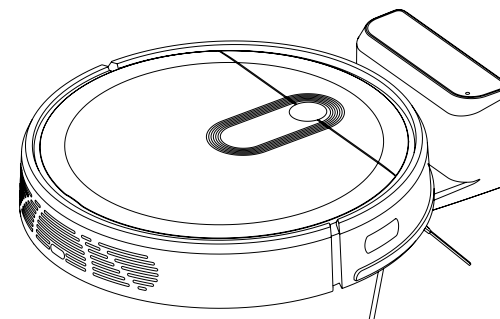



- Place unit on the Charging Dock, making sure it's properly aligned and connected by the metal contact points underneath.
- You will know it is powering up when the button illuminates. Now your **V2** is ready to clean!



3.1 Basic Operating Functions





To Start

To start a cleaning cycle, press the  button or the  button on the remote

To Pause

To pause a cleaning cycle, press the  button or the  button on the remote and again to resume.

To Dock

To send back to my Charging Dock, press the  button on the vacuum or the  button on the remote.

To Turn Off

To turn the vacuum OFF, press and hold the  button until you'll hear 'Powering Off'.

Your Clean 3.2

1

Auto Clean

This setting is where I use smart path navigation, an internal gyro guides me with precision for optimal cleaning. At various points through out the cleaning cycle, the **V2** will touch up around the edges of the room and furniture for even more efficiency and improve navigation.

2

Carpet Mode

On certain thick or dark rugs, the **V2** may loose its way around, if this is the case, use the Carpet or Random Mode which will disable any 'smarts' and will clean the room randomly.

3

Spot Clean

Place on the desired area and press the "spot clean" option on the remote. The Unit will spiral 5 feet in diameter, always circling back to the original spot.

4

Edge Clean

This mode goes around the edges of the room making sure all edges are clean.

5

Manual Clean

If you want control, just press the directional arrow buttons on the remote and operate manually.



Suction Boost

By default, suction power is set to 1000 Pa, but it can be easily increased up to 2000 Pa if you need more power to clean certain areas. Increase suction by pressing the "suction power" button on the remote.

Auto Dock & Recharge

Whenever the battery gets low or the cleaning cycle is complete, your **V2** will automatically dock to recharge. If the cleaning cycle wasn't complete before the battery got low, it will automatically go and complete the job once the battery is charged.

Note: If the Charging Dock is inaccessible, it won't be able to charge.

! Notes Before Cleaning

Before using the **SmartClean robo vac V2**, pick up objects like clothing, loose papers, pull cords for blinds or curtains, power cords and any fragile objects.

If the room to be cleaned contains a balcony, a physical barrier should be used to prevent access to the balcony and ensure safe operation.

3.3 1 Start a Cleaning Cycle

- Press the **"Power"** button to start a cleaning cycle (or press the **"Auto"** button on remote control).

If the battery gets low before finishing the cleaning cycle, the **SmartClean robo vac V2** will return to the Charging Dock to recharge.

If the Charging Dock is inaccessible, the **SmartClean robo vac V2** will not be able to recharge, please place the **SmartClean robo vac V2** manually on the Charging Dock to recharge.

Note: Please refer to section 3.2 for more cleaning modes.

2 Pause Cleaning Cycle

- To pause the **SmartClean robo vac V2** during cleaning cycle, press the **"Power"** button on the **SmartClean robo vac V2** or press the **"Pause"** button on the remote control.
- To resume the cleaning cycle, press the same button again.
- To send **SmartClean robo vac V2** back to the Charging Dock, press the **"Home"** button on the **V2** or the remote control.

3 Power Off

To turn the vacuum **OFF**, press and hold the **"Power"** button until you hear **'Powering OFF'**.

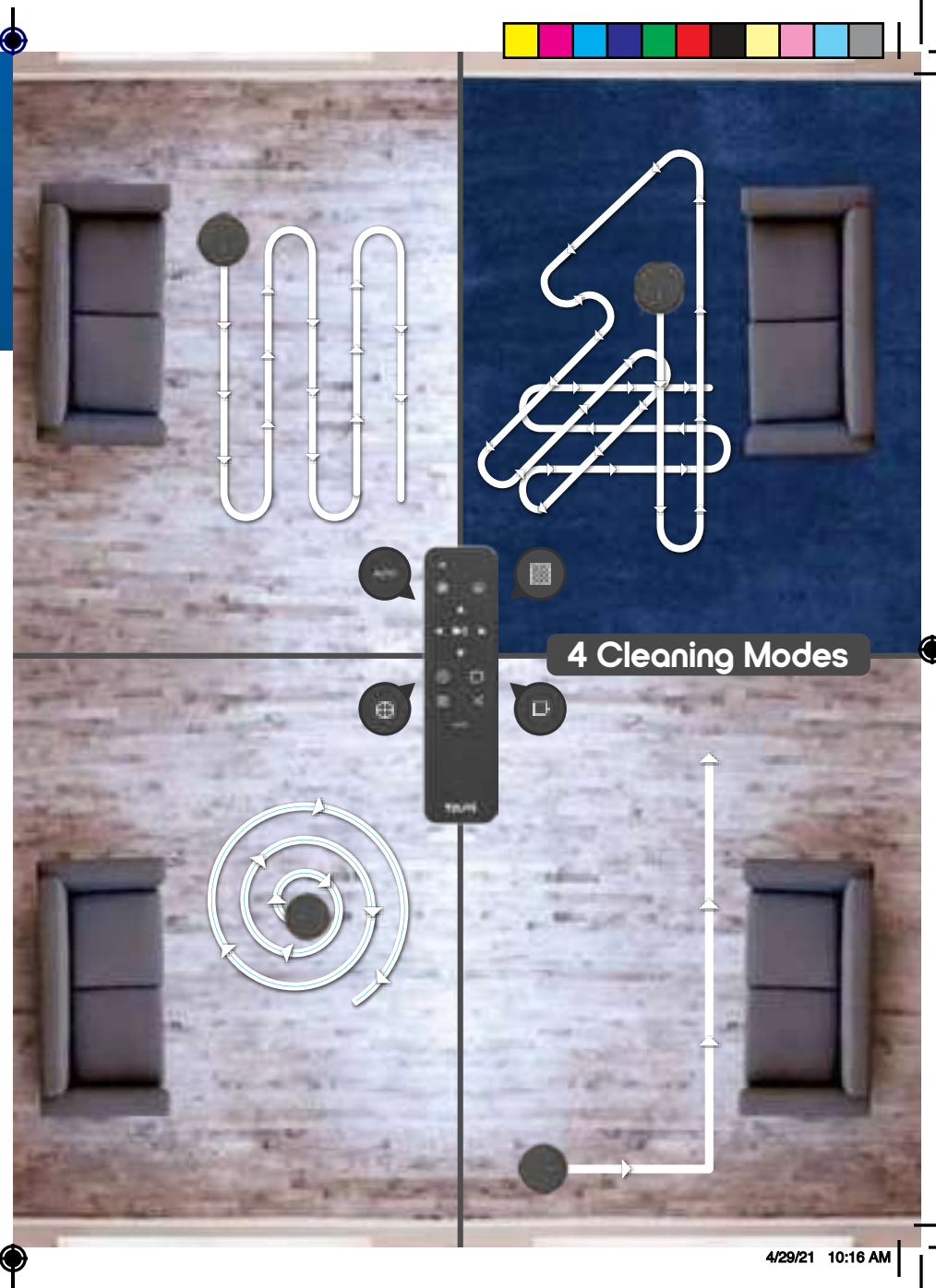

3.4 In the Tzumi Smart Home App, you can select any cleaning mode, set the time, schedule a cleaning, view my system status, receive notifications as well as access additional features.

Control and customize your clean, from your phone with the Tzumi Smart Home App



Scan the code to download the latest version of "Tzumi Smart Home" or search "Tzumi Smart Home" in the App store.



3.5 Tzumi Smart Home App Instructions

Before you use me with the app, make sure that:

- Your smartphone or tablet is connected to a WiFi network.
- Your device is running iOS8.0 (or newer) or Android 4.4 (or newer).
- The 2.4GHz band wireless signal is enabled on your wireless router.
- The vacuum WiFi has been reset and is ready for connection.
- Your V2 is attached to Charging Dock and has enough power.

WiFi Set-Up

- 1 Download the **Tzumi Smart Home** from the App Store (iOS devices) or Google Play (Android devices).
- 2 Open the app and create a user account.
- 3 Tap the "+" icon in the top right corner and add the "Smart Clean RoboVac" to your account.

Adding the vacuum to the APP

E-Z Mode

Press both "Power/Home" buttons for 5 seconds until you hear '**WiFi resetted, ready for EZ Mode Connection**'. For visual confirmation of E-Z mode, lift the vacuum cover and verify the WiFi LED is blinking fast. Follow the steps on the APP to finish the setup.

AP Mode

In certain routers, the EZ Mode does not work, in that case use the AP Mode to connect the vacuum to your account.

Press both buttons for 5 seconds, you'll hear '**WiFi resetted, ready for AP Mode Connection**'. For visual confirmation of AP mode, lift the vacuum cover and verify the WiFi LED is blinking slowly. Follow the APP instructions to finish the setup. If you hear '**WiFi resetted, ready for EZ Mode Connection**', reset again to get the '**WiFi resetted, ready for AP Mode Connection**' prompt.

3.6 You can also use Google Assistant or Amazon Alexa to operate with voice commands

Google Assistant & Amazon Alexa Instructions

Before you use the app, make sure that:

- Your **V2** is attached to my Charging Dock and have enough power.
- Your **V2** is active in the Tzumi Smart Home App.
- The Google Home app or amazon Alexa is installed on your smart device and you have an active account.
- You have a device with Google Assistant (i.e. Google Home, Google Home Mini) or an Alexa enabled device, (i.e Amazon Echo, Echo Dot, Echo show.

Operate me with the Google Assistant

- 1 Open the Google Home app on your smart device.
- 2 Press the “+” icon and set up a device, choose the ‘**Works with Google**’ option.
- 3 Search for the ‘**Tzumi Smart**’ service and link it to your account.

I’m now ready to be operated with voice commands

Try these:

- “Ok Google, set Smart Vac to auto mode” - It will start an automatic cleaning cycle
- “Ok Google, set Smart Vac to edge mode” - It will start an edge cleaning cycle
- “Ok Google, ask Smart Vac to stop cleaning” - It will stop my cleaning cycle
- “Ok Google, ask Smart Vac to go home” - It will go back to my Charging Dock

Operate me with Amazon Alexa

- 1 Open the Amazon Alexa app on your smart device and select “**Skills**” from the options menu.
- 2 Once on the “**Skills**” page, search for “**Tzumi Smart**” and tap ‘enable’
- 3 Use your Tzumi Smart Home app credentials to log in to give Alexa access to control my functions.

I’m now ready to be operated with voice commands

- “Alexa, ask Smart Vac to start cleaning” - It will start an automatic cleaning cycle
- “Alexa, ask Smart Vac to stop cleaning” - It will stop my cleaning cycle
- “Alexa, ask Smart Vac to go home” - It will go back to my Charging Dock

Pleas note: Due to software changes some of the instructions or commands may change and no longer work. To see an up to date list, go to the Tzumi Smart Home app, tap on 'More Services'. You can check instructions and a full list of available commands.



Taking Care Of Me

To keep me running at peak performance, perform the following care procedures. If you notice I’m picking up less debris from the floor, then empty the dust bin, clean the filter and main brush.



SmartClean robo vac V2 Care 4.

To keep the SmartClean robo vac V2 running at peak performance, perform the following care procedures. If you notice the SmartClean robo vac V2 picks up less debris from the floor, then empty the dust bin, clean the filter and the Main Brush.

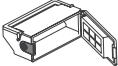
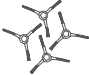
Robot Part	Care Frequency	Replacement Frequency
 HEPA Filter	Once a week (twice a week in homes with pets)	Every 2 months
 Main Brush	Once every 3 months (once every 2 months in homes with pets)	Every 6 months
 Dust Bin	After each use	Never
 Side Brushes	Once a month	Every 3 months
Driving Wheels Anti-drop Sensors Charging Contacts Anti-Collision Sensors	Once a month	Never

4.1 Emptying the SmartClean robo vac V2 Dust Bin

- 1 Lift the top lid on the vacuum.
- 2 Pick up the dustbin handle and pull to remove the dustbin.
- 3 Open the dustbin door to empty it.

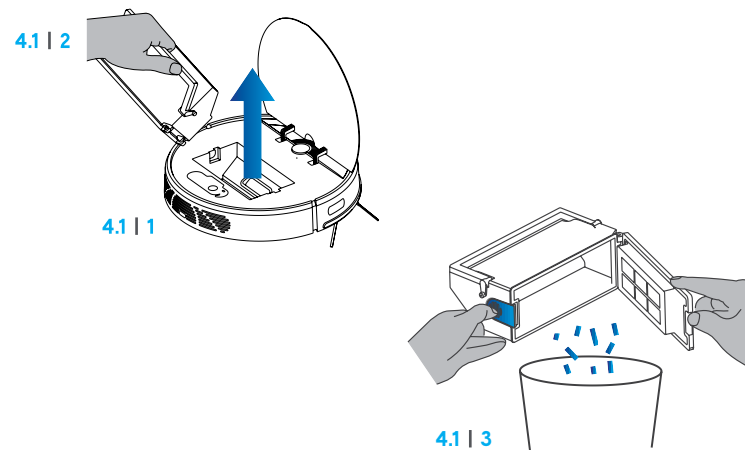

4.2 Cleaning the SmartClean robo vac V2 Filter

- 1 Remove filter by grasping the white tab.
- 2 Shake off debris by tapping the filter against your trash container.

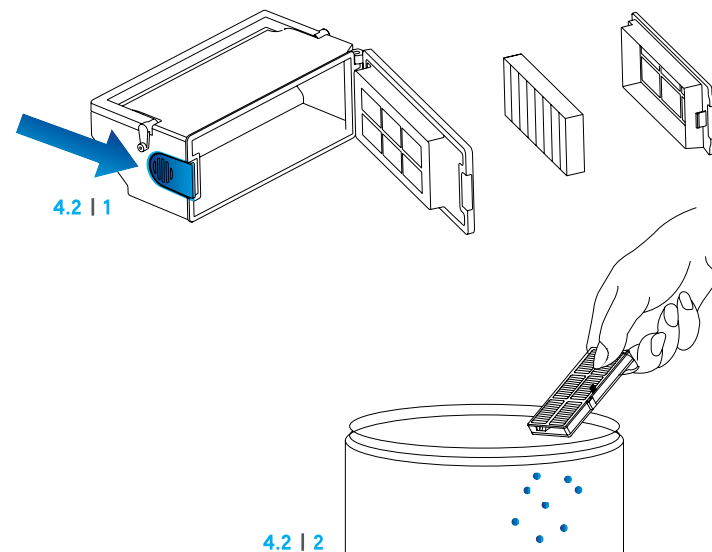

4.3 Cleaning the SmartClean robo vac V2's Side Brushes

- 1 Remove the Brushes.
- 2 Clean the Brushes and the Brushes stand, reinstall the Brushes.

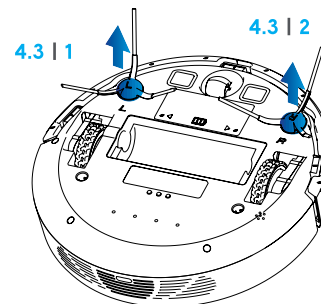

4.4 Cleaning the SmartClean robo vac V2 Anti-Drop Sensors and Charging Contacts

- 1 Wipe the Smart Clean Robo Vac's Anti-Drop sensors, charging contacts and dock contacts with a clean, dry cloth.

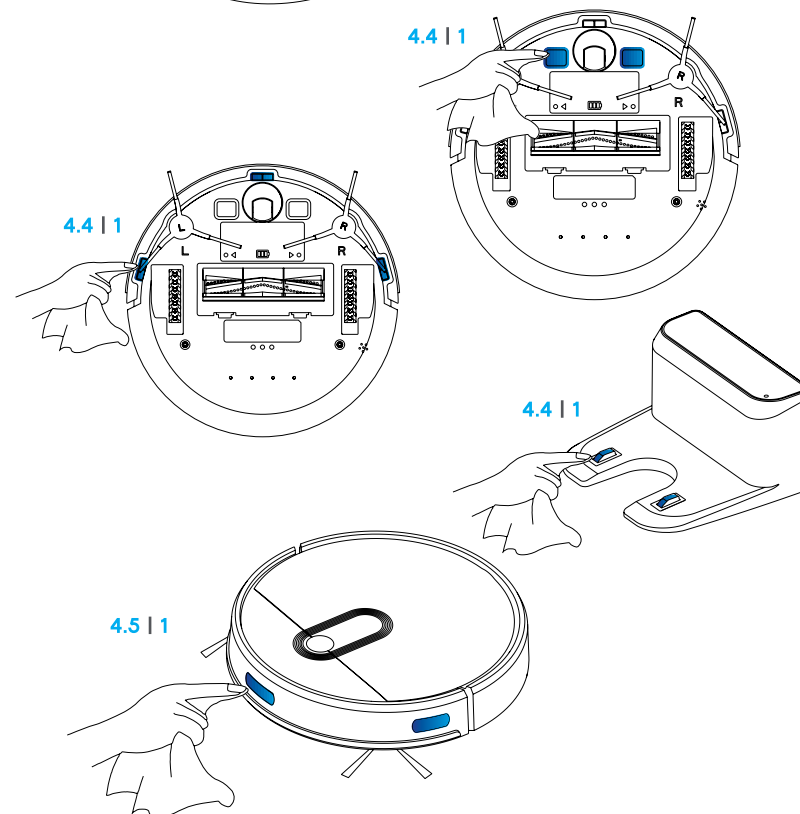

4.5 Cleaning the Vac Floor Anti-Collision Sensor

- 1 Use a clean, dry microfiber or soft cotton cloth to wipe any debris accumulated in the round sensor opening on the right side of the bottom surface. Do not spray cleaning solution directly into the sensor opening.

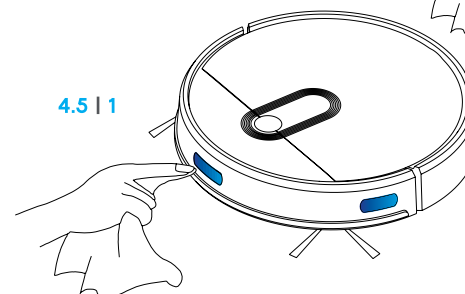

4.6 Cleaning the SmartClean robo vac V2 Main Brush

- 1 Pull on the release tabs to unlock the Brush guard as shown.
- 2 Lift the Main Brush to remove.
- 3 Clean the Main Brush with the provided cleaning tool or a vacuum cleaner.
- 4 Reinstall the Main Brush by inserting the fixed protruding end first and then click into place.
- 5 Press down to snap the Main Brush cover into place.

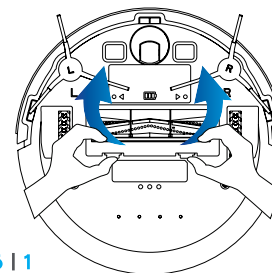

4.6 | 1

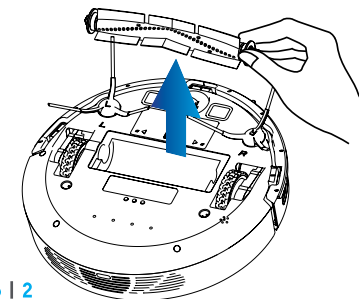

4.6 | 2

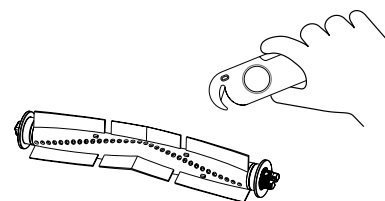

4.6 | 3

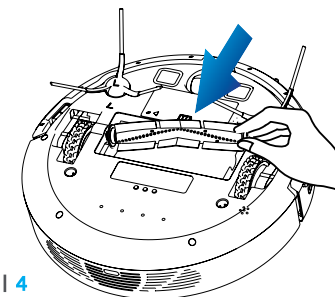

4.6 | 4

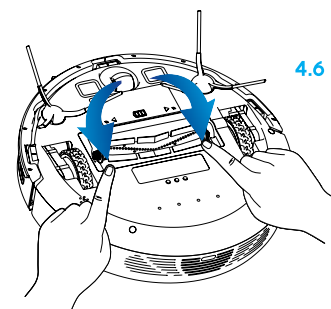

4.6 | 5

5 User Cautions

The Smart Clean Robo Vac is for indoor use only. Do not use the SmartClean robo vac V2 outdoor, commercial or industrial environments.

- Before using the **SmartClean robo vac V2**, pick up objects like clothing, loose papers, pull cords for blinds or curtains, power cords and any fragile objects.
- The **SmartClean robo vac V2** is not a toy. Do not sit or stand on the **SmartClean robo vac V2**. Small children and pets should be supervised when the **SmartClean robo vac V2** is operating.
- Store and operate the **SmartClean robo vac V2** in room temperature environments only.
- Do not use the **SmartClean robo vac V2** to pick up anything that is burning or smoking.
- Do not use the **SmartClean robo vac V2** to pick up spills, bleach, paint, chemicals or anything wet.
- If the room to be cleaned contains a balcony, a physical barrier should be used to prevent access to the balcony and ensure safe operation.
- Do not place anything on top of the **SmartClean robo vac V2**.
- Be aware that the **SmartClean robo vac V2** moves on its own. Be careful when walking in the area that the Smart Clean Robo Vac is operating in to avoid stepping on it.
- Do not operate the **SmartClean robo vac V2** in areas with exposed electrical outlets in the floor.

Battery Care & Charging 5.1

This device complies with Part 15 of the FCC rules. Operation is subject to the following two conditions:

- 1** This device may not cause harmful interference.
- 2** This device must accept any inference received, including interference that may cause undesired operation.

- Charge using a standard outlet only. This product may not be used with any type of power converter. The use of power converter will immediately void the warranty.
- Do not use a Charging Dock with a damaged cord or plug. If the cord or plug is damaged, it must be serviced by the manufacturer or a qualified service provider.
- Charge indoors only.
- The Charging Dock may be protected with a surge protector in the event of severe electrical storms.
- Never handle or touch the Charging Dock or cables with wet hands.
- Always remove the **SmartClean robo vac V2** from the Charging Dock before cleaning or maintaining it.
- The **SmartClean robo vac V2** contains Li-Ion rechargeable batteries, be sure to never open, pierce or damage the batteries.
- Do not wet the battery compartment.
- If the batteries are leaking, stop the **SmartClean robo vac V2** use immediately and contact customer service.

5.2 Troubleshooting

The **SmartClean robo vac V2** will tell you if something is wrong with a two-tone distress sound followed by a message. The indicator “**Power/Home**” button will also blink or be solid red. Please refer to the chart below to troubleshoot and resolve the **SmartClean robo vac V2** problem. If the problem is not resolved, please contact our customer service department for further assistance.

Rebooting Instructions

For some errors, rebooting the **SmartClean robo Vac V2** may resolve the problem. To reboot the **SmartClean robo Vac V2**, press and old the “**Power**” button on the vacuum until you hear ‘**Powering OFF**’, wait 10 seconds, press and hold the “**Power**” button again to restart.

My indicator is Solid Red

Error Message	What to do
· Driving wheels are stuck.	Clean the driving wheel and press the power button to restart the Vac.
· Side Brushes are stuck	Clean the side brushes and press the power button to restart the Vac.
· Suction is not working well, please check	Remove and empty the bin clean the filter, then, briskly tap the bin to loosen any remaining trapped debris.
· Main Brush is Stuck	Remove and clean the main brush and caps.

My indicator is flashing red

Error Message	What to do
· The vacuum is stuck	Restart cleaning Vac in a new location Move the vacuum to a safe area before starting
· Wheels are Stuck	If the SmartClean robo vac V2 is stuck free it and start in a new location. Clean SmartClean robo vac V2 's side wheels out of hair and debris. Push the wheels in and out, and check that they both turn freely.
· Front bumper is stuck	Ensure there are no obstacles in front of the SmartClean robo vac V2 . Check the bumper for any stuck items or debris.



Note: We strive to upgrade and improve the APP experience, hence, some of the visuals, features and instructions may change over time. Please reach out to us if you have any questions or need assistance.

5.3 Frequently asked questions

Problems

Solutions

My SmartClean robo vac V2 cannot be activated.

- Make sure the vacuum is Powered **ON**.
- Make sure the battery is fully charged
- Replace the batteries (**2 AAA**) in the remote control.
- Make sure the remote control is within range (**16 ft/5 m**) of SmartClean robo vac V2.
- If you still have trouble, turn off the main power switch and then turn it back on.

What if the remote control does not work?

- Replace the batteries in the remote control.
 - Make sure SmartClean robo vac V2 is turned on and fully charged.
- Note:** Limited workable range distance is 5m/16,5ft.

My Smart Clean RobVac V2 stopped working suddenly.

- Check if the SmartClean robo vac V2 is trapped or stuck on obstacle.
- Check if the battery level is too low.
- If you still have trouble, turn off the main power switch, wait for 10 seconds, and then turn it back on.

The Suction power is weak on my Smart Clean robo vac V2.

- Check if any obstructions are blocking the suction inlet.
- Empty the Dust Bin
- Clean the filters with a vacuum cleaner or a cleaning brush.
- Clean the filters with a vacuum cleaner or a cleaning brush.

The Main Brush does not rotate.

- Clean the Main Brush.
- Check if the Main Brush and main brush cover have been installed properly.

5.4

SPECIFICATIONS

Dimenisons

12.6" x 12.6" x 3"
(320 x 320 x 76mm)

Weight

4.8lb (2.2kg)

Input

19 V  0.6A

Battery

2600mAh rechargeable lithium battery

Rated Voltage

14.4W

Rated Power

42W

Charging Time

300 min.

Dust bin capacity

15.22 oz. (450ml)

Running Time

Up to 150 min

Docking station

Dimenisons

6.22" x 5.79" x 3.3"
(158 x 147 x 84mm)

Power Input/Output

19V/0.6A

6. Important Safety Information

The **SmartClean robo vac V2** should not be used by children and persons with reduced physical, sensory or mental capabilities. Children should not play with the **SmartClean robo vac V2**. Cleaning and user maintenance shall only be done by adults.

The **SmartClean robo vac V2** must be used in accordance with the directions in this Instruction Manual. Tzumi Electronics cannot be held liable or responsible for any damages or injuries caused by improper use.

To reduce the risk of injury or damage, keep these safety precautions in mind when setting up, using and maintaining your SmartClean robo vac V2:

- Read all safety and operating instructions before operating your SmartClean robo vac V2.
- Retain the safety and operating instructions for future reference.
- Heed all warnings on your SmartClean robo vac V2, battery, charging Dock and in the owner's manual.
- Follow all operating and use instructions.



The symbol on the product or its packaging indicates:

Do not dispose of electrical appliances as unsorted municipal waste, use separate collection facilities. Contact your local authority for information regarding the collection systems available.





For more details on
the ionVac family of products
or to view more home and phone
innovations visit tzumi.com

If you have any questions
or need support setting up
or using your RoboVac V2,
email us at support@tzumi.com
or call 1-855-GO-TZUMI

tzumi®
live awesome.