

# VISSANI™

Model 30SSC19PRT 1009255804  
30BLC19PRT 1009255777  
30WHC19PRT 1009255835

## INSTALLATION GUIDE

### UNDER CABINET RANGE HOOD

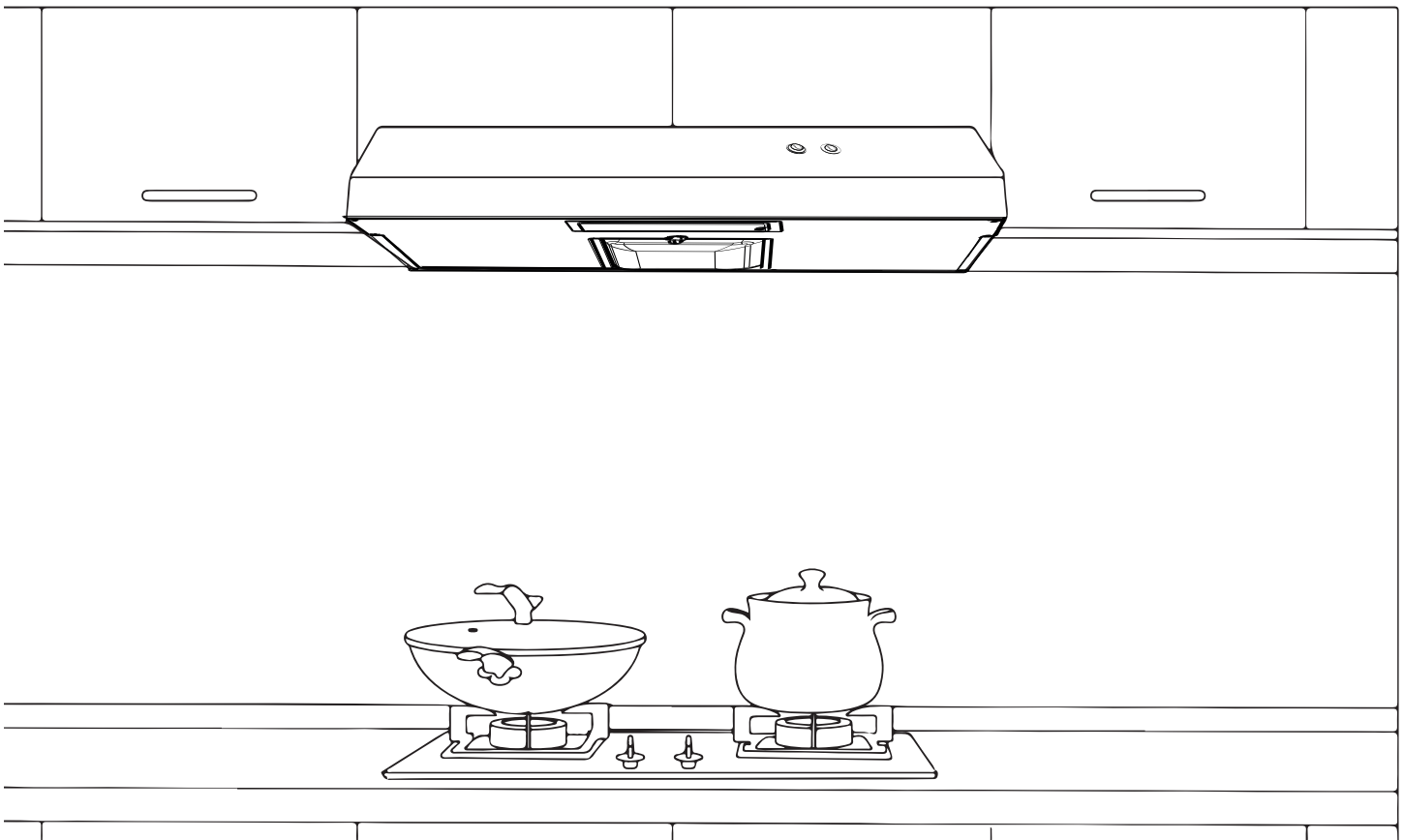

Questions, problems, missing parts? Before returning to the store,  
call Vissani Customer Service  
8 a.m. - 7 p.m., EST, Monday - Friday, 9 a.m. - 6 p.m., EST, Saturday  
**1-855-847-7264**

**HOMEDEPOT.COM**

#### THANK YOU

*We appreciate the trust and confidence you have placed in Vissani through the purchase of this range hood. We strive to continually create quality products designed to enhance your home. Visit us online to see our full line of products available for your home improvement needs. Thank you for choosing Vissani!*

## Pre-Installation

### TOOLS/MATERIALS REQUIRED (NOT SUPPLIED)

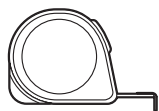

Measuring tape



Level

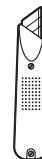

Utility knife

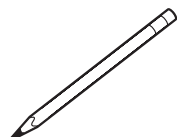

Pencil

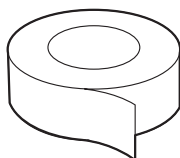

Certified duct tape



Adjustable wrench

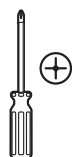

Phillips screwdriver



Flathead screwdriver



Needle nose pliers

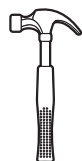

Hammer

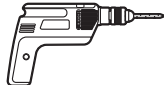

Electric drill



Safety goggles



Safety gloves

# Pre-Installation (continued)

## PACKAGE CONTENTS

Carefully check the range hood for damage and for missing parts prior to installation. If there is any damage or if you are missing parts, do not proceed with the installation. Report damage and missing parts immediately. Do not dispose of packaging before you are satisfied with your new range hood.

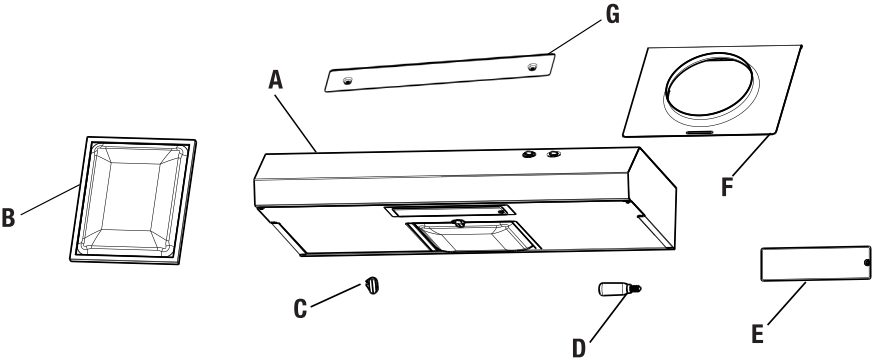

Part	Description	Quantity
A	Range hood	1
B	Filter	1
C	Plastic retainer clip	2
D	Light bulb	1

Part	Description	Quantity
E	Plastic lens cover	2
F	Round adapter (located inside the hood)	1
G	Recirculating vent cover	1

## HARDWARE INCLUDED



NOTE: Parts not shown in actual size.

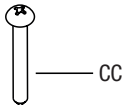
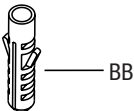
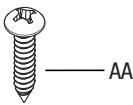

Part	Description	Quantity
AA	Upper mounting screws (4.5 mm x 13 mm)	4
BB	Wall anchor (8 mm x 40 mm)	4

Part	Description	Quantity
CC	Rear mounting screws (5 mm x 45 mm)	4

## PRODUCT DIMENSIONS

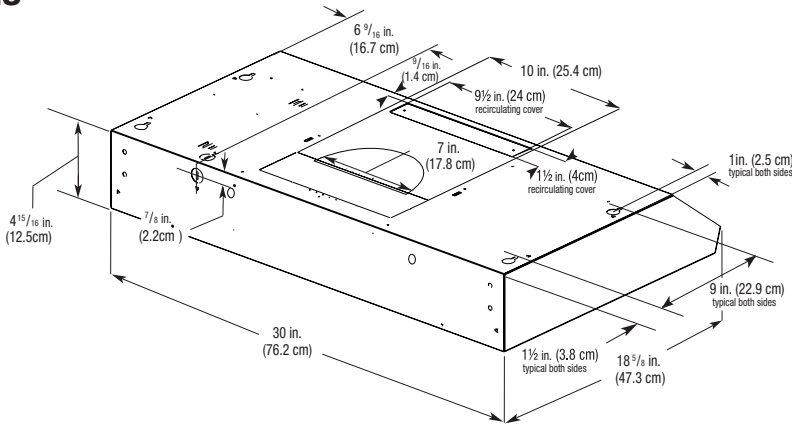

## Pre-Installation (continued)

### PLANNING INSTALLATION

#### Number of people required: 1

- Before installation, measure all distances to ensure the proper position of the range hood (A).
- The minimum distance (1) from the cooking surface to the range hood is 24 in. (609 mm). If your range specifies a different distance, use the greater distance of the two. For best performance, this distance (1) should not exceed 30 in. (762 mm).
- Dimension (2) should be a maximum of 762 mm (30 in.) The range hood should be approximately the same size as the cook top.
- If the bottom of the cabinet (3) above the location where the range hood is to be installed is recessed, attach appropriately sized wood filler strips (4) on each side using wood screws.
- Screws are provided to secure the range hood to most types of cabinets, but consult a qualified installer to verify that the supplied screws are suitable for your cabinets.
- Put a thick, protective covering over your counter, cooktop, or range to protect it from damage and dirt during installation. Remove any hazardous objects around the area.



**WARNING:** Always wear safety goggles and gloves during installation.

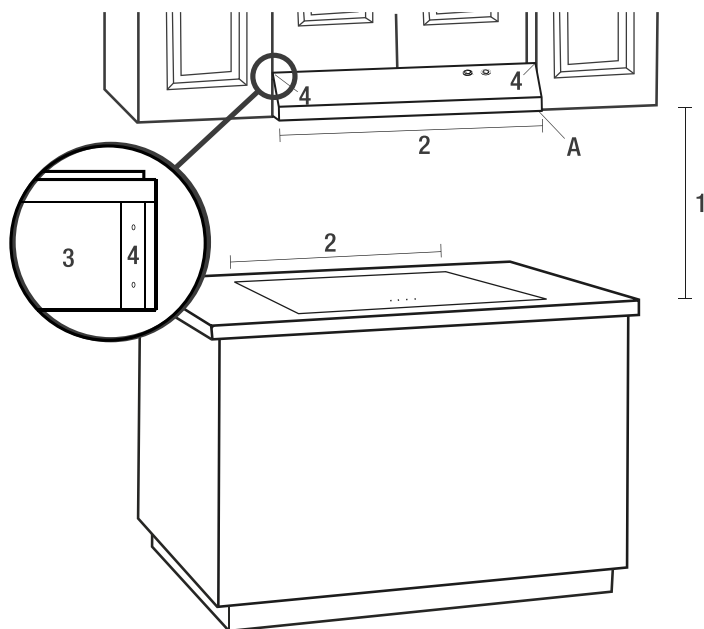

### VENTING OPTIONS

- Determine if your existing venting system is top venting, and ensure that the openings in the cabinet or wall for the damper and for power access are in appropriate locations and are of appropriate sizes. Use the round adapter, the opening should be A.
- If this is a new installation, choose the venting method that suits your needs. Cut out openings for the damper and for power access in the cabinet bottom or back wall, depending on the direction of venting chosen.

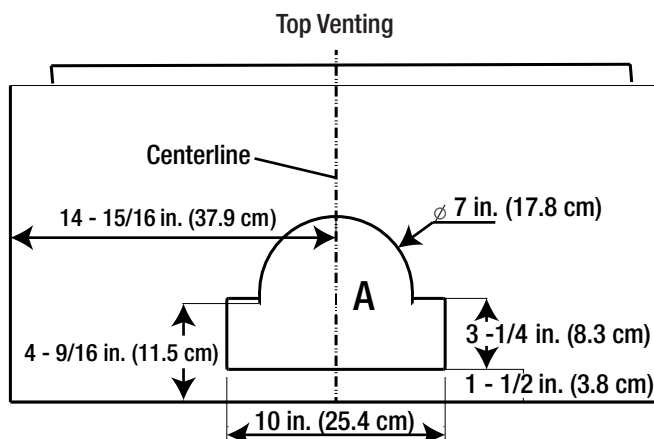

## Pre-Installation (continued)

### GUIDELINES FOR INSTALLING DUCTWORK:

- Your venting system must vent to the outdoors either horizontally through the back wall (13) or vertically through the roof (14) (refer to Fig 5/ Fig 6/ Fig 7).
- Use round metal ductwork with a uniform diameter of 7 in. (177 mm). The total duct run in the venting system should not be more than 35 ft (10.7 m).
- Calculate the total effective length of the ductwork by adding the equivalent lengths in the table shown (Fig 9). For each fitting used add the length of the equivalent straight duct used in the system.
- Fasten all connections between pieces of duct with sheet metal screws and tape all joints with certified duct tape.
- If you must turn the path of the ductwork using elbows, keep the number of elbows to a minimum for effective performance and use no more than three 90° elbows. Ensure that there is a minimum of 18 in. (458 mm) of straight vent between each elbow. Elbow as far away from the range hood's exhaust opening as possible.
- Cap the exterior of the duct with a wall cap (15) or roof cap (16). Never use 4 in. (102 mm) laundry-type wall caps. Use caulking to seal exterior wall or roof opening around the cap.
- The venting system must have a damper.
- For this option, convert filter (see Charcoal / Grease Filter in the Care and Cleaning section).

Horizontal Wall Venting

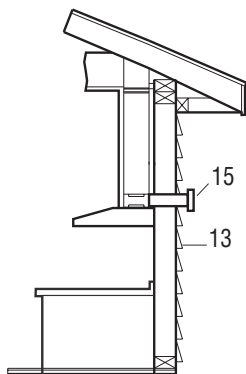

Fig. 5

Horizontal Wall Venting

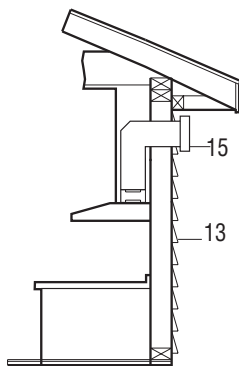

Fig. 6

Vertical roof Venting

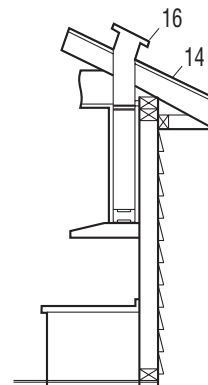

Fig. 7

- For interior venting system (air does not exhaust to outdoors) (Fig 8):
- In interior vented installations, air is recirculated through a charcoal filter (included) and exhausted through the top of the range hood (17). See the installation section for more details.

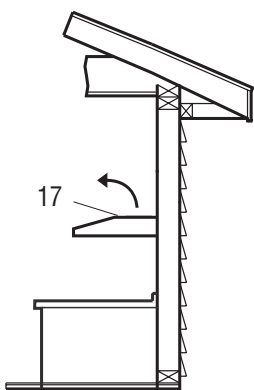

Fig. 8

Equivalent Length Chart

Type of duct	Length added
45° Elbow	3 ft (0.91 m)
90° Elbow	5 ft (1.52 m)
90° Flat elbow	12 ft (3.66 m)
9 ft (2.74 m) Straight duct	9 ft (2.74 m)
Wall cap	0 ft (0 m)

Fig. 9

## Pre-Installation (continued)

### WIRING CONNECTION REQUIREMENTS

Installation work and electrical wiring must be done by a qualified person(s) in accordance with all applicable codes and standards, including fire-rated construction.

#### OBSERVE ALL GOVERNING CODES AND ORDINANCES AND WARNINGS

- Electrical grounding is required for this range hood. Check with a qualified electrician if you are not sure whether the range hood is properly grounded.
- Failure to follow electrical requirements may result in a fire.
- A fuse in the neutral or grounding circuit could result in electrical shock.
- If hot/cold water pipe is interrupted by plastic/nonmetallic gaskets or other materials, DO NOT use for grounding.
- DO NOT GROUND TO A GAS PIPE.



**IMPORTANT:** It's the customer's responsibility to contact a qualified electrical installer and assure that the electrical installation is adequate and complies with the National Electrical Code, or CSA standards, as well as all local codes and ordinances.

- Save installation instructions for electrical inspector's use.
- If codes permit and a separate ground wire is used, it is recommended that a qualified electrician determine if the ground path is adequate.
- DO NOT use an extension cord or adapter plug with this appliance.
- The range hood must be connected with copper wire only.
- The range hood should be connected directly to the junction (or circuit breaker) box through flexible, armoured or nonmetallic sheathed copper cable. Allow some slack in the cable so the appliance can be moved if it is necessary.
- A UL listed or CSA approved conduit connector must be provided at each end of the power supply cable (at the range hood and at the junction box).
- When making the electrical connection, cut a 1-1/4 in. (3.2 cm) hole in the wall. A hole cut through wood must be sanded until smooth. A hole through metal must have a grommet.
- When cutting or drilling into the wall or ceiling, do not damage electrical wiring and other hidden utilities.
- Wire size must conform to all local codes and ordinances. The latest edition requirements of the National Electrical Code ANSI/ NFPA 70, or the latest edition CSA Standards C22.1-94, Canadian Electrical Code Part 1 and C22.2 No. 0-M91.



**DANGER:** Risk of electrical shock. This range hood must be properly grounded.



**DANGER:** Turn off the power circuit breaker or the power switch on the junction box before installing or servicing this unit. Touching circuitry inside the range hood while it is energized will result in death or serious injury.



**DANGER:** All electrical wiring must be properly installed, insulated, and grounded. Improper insulation and grounding will result in deadly electrical shock.



**NOTE:** Temporarily wire the range hood to test it for proper operation. If the range hood does not operate correctly, do not proceed with the installation.

- Disconnect power.
- Run 3 wires - black, white, and green - according to the National Electrical Code and local codes and ordinances, in 1/2 in. conduit from the service panel to the junction box.



**WARNING:** Electrically ground the blower. Use copper wire. Connect ground wire to green ground screw in terminal box. Failure to do so can result in death, fire or electrical shock.

- Use UL listed wire connectors and connect white wires together.
- Use UL listed wire connectors and connect black wires together.
- Connect green (or bare) ground wire from power supply to green ground screw in terminal box and securely tighten.
- Close and secure the junction box cover with the screw previously removed.
- Turn the power on, and ensure that the lights and the fan are operating correctly.
- Once you have tested the electrical connection, disconnect the power supply cable and wires from the electrical source before proceeding with the rest of the installation.

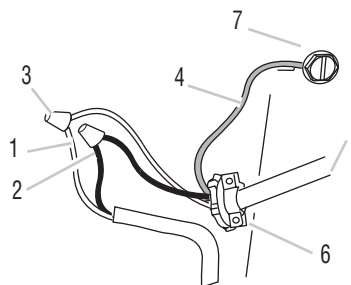

1. White wires.
2. Black wires.
3. UL listed wire connector.
4. Green (or bare) ground wire.
5. Home power supply cable.
6. UL listed or CSA approved 1/2 in. strain relief.
7. Green ground screw.

# Installation

## 1 Preparing the range hood

- Remove the filter from the fume hood (A) by removing the screw from the retaining clip.
- Remove the four screws from the cover on the range hood (A).
- Slightly push the cover towards the rear of the hood (A) to release the tabs at the front.

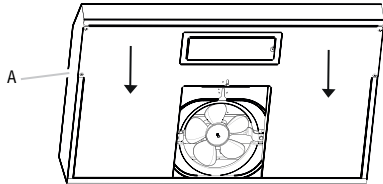

## 2 Removing the range hood cover

- Pull the top of the cover slightly outwards.

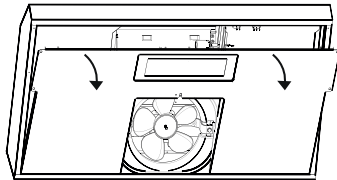

- Release the tab in the lower slot on the left side of the hood.

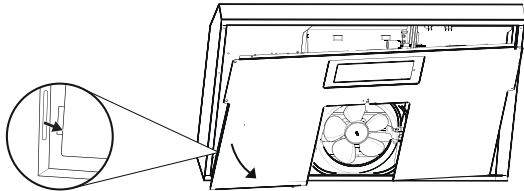

- Finally, detach the remaining tab on the right side to release the cover.

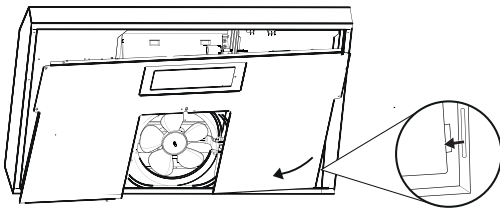

**NOTE:** Once the cover is removed, you'll see a plastic bubble pack that includes the light bulb and screws for installation. Keep them aside while you're following the next steps in order to avoid damages.

## 3 Marking the wiring hole location

- Determine and clearly mark a vertical centerline on the wall and cabinet bottom.

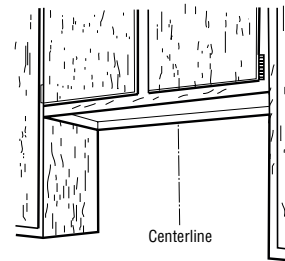

## 4 Wiring through the top

- Mark a line distance from the right of the centerline on the underside of the cabinet. Mark the point on this line that is 2 in. (5 cm) from back wall. Drill a 1-1/4 in. (3.2 cm) diameter hole through the cabinet at this point.

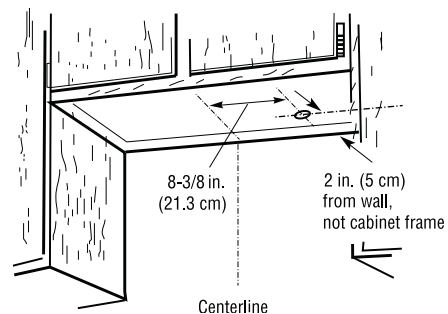

## 5 Wiring through wall

- Mark a line distance from the right of the centerline on the underside of the wall. Mark the point on this line that is 7/8 in. (2.2 cm) from the underside of the cabinet. Drill a 1-1/4 in. (3.2 cm) diameter hole through the rear wall at this point.

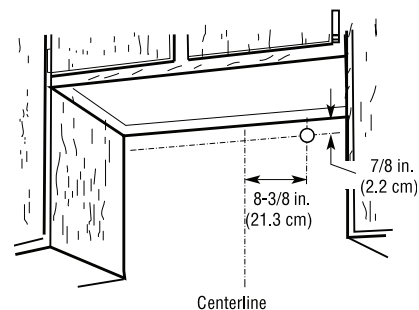

## Installation (continued)

### 6 Preparing exhaust venting



**WARNING:** Fuel (gas) burning ranges must be vented outdoors using, at minimum, metal ductwork and range hoods of sufficient capacity. Follow your fuel burning equipment manufacturer's guidelines, as well as, all applicable safety standards published by the National Fire Protection Association (NFPA), and the American Society for Heating, Refrigeration and Air Conditioning Engineers (ASHRAE), and your local code authorities.

Choose venting exhaust discharge from the options listed:

#### Style 1 - Recirculating Hood version

For this installation, go to "Install Range Hood (recirculating version)".

#### Style 2 - Cut Openings for 7 in. (17.8 cm) Round Vent to Round Vent Transition

##### Roof Venting

To make a circular vent opening on the underside of the cabinet top:

- Mark a centerline on the underside of the top of cabinet.
- Mark a line 5 in. (12.7 cm) from the back wall on the underside of the top of cabinet.
- Use a compass or a circle template to draw a circle with a diameter of 7-1/2 in. (19 cm). Use saber or keyhole saw to cut the circular vent opening.
- Repeat steps 1-3 for the underside of the top of the cabinet.

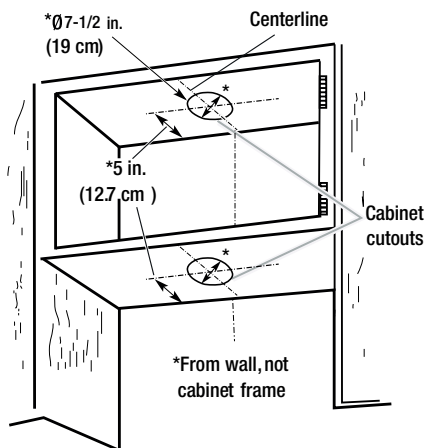

### 7 Installing vent system

- Install vent through the vent opening in upper cabinet or wall. Complete venting system according to the selected venting method. See "Venting Requirements" section.
- Use caulk to seal exterior wall or roof opening around the cap.

### 8 Preparing the location (cabinet mounting)



**NOTE:** Before making cutouts, make sure there is proper clearance within the ceiling or wall.

- Select a flat surface for assembling the range hood. Place covering over that surface.
- Lift the range hood and set it upside down onto covered surface.
- If cabinet has recessed bottom, add wood filler strips on each side. Install screws to attach filler strips in locations shown.
- Mark the location of the four keyhole mounting slots on the cabinet bottom.

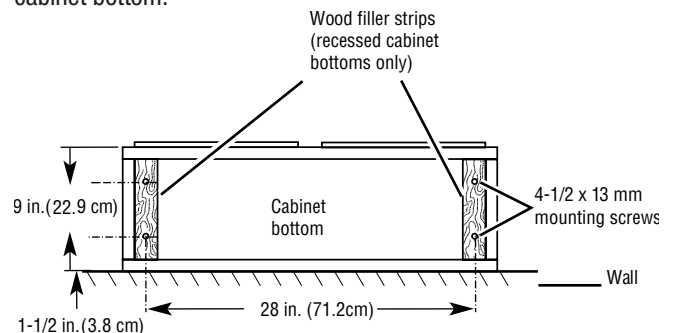

**NOTE:** Make the drill holes on the thin area of the slot.

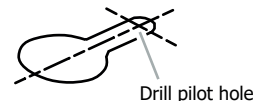

- Use 1/8 in. (3 mm) drill bit and drill four pilot holes as shown.
- If a vent damper is installed with a wall cap with damper, check that they do not interfere with each other. Remove the vent connector damper flap if they interfere.
- Install the four 4.5 mm x 13 mm mounting screws in pilot holes. Leave about 1/4 in. (6.4 mm) space between screw heads and cabinet to slide range hood into place.

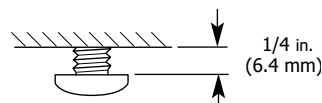



## Installation (continued)

### 9 Preparing the location (wall mounting)

- Determine the distance from the cooking surface to mounting holes.
- Taking as base the horizontal line and the center line of the wall, mark the location of the four keyhole mounting slots, as shown

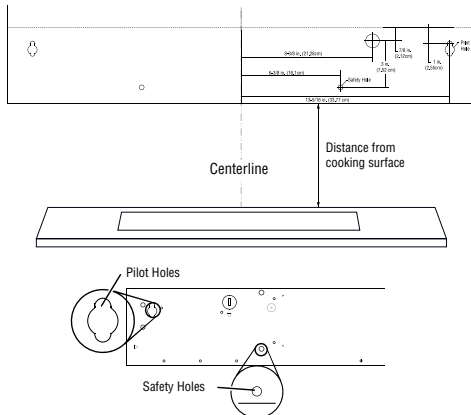

**NOTE:** Make the drill holes on the thin area of the slot.

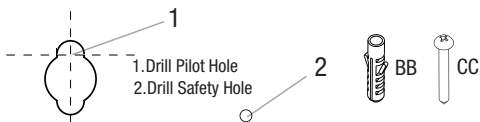

- Use a 3/10 in. (8 mm) drill bit and drill two pilot holes (1) and two safety holes (2).
- Remove the mounting template.
- Insert four wall anchors (BB) in those holes.
- Install the two of the 5 x 45 mm upper mounting screws (CC) in pilot holes. Leave about 1/4 in. (6.4 mm) space between screw heads and wall to slide range hood into place.

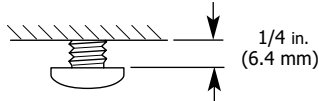

**NOTE:** Leave the safety holes without screws.



**NOTE:** If the wall is wood, do not use anchors (use 3mm drill).

### 10 Installing power supply cable

- For direct wire installations, run the home power supply cable according to the National Electric Code or CSA standards and local codes and ordinances. There must be enough wiring from the fused disconnect (or circuit breaker) box to make the connection in the hood electrical terminal box.



**NOTE:** Do not reconnect power until the installation is complete.

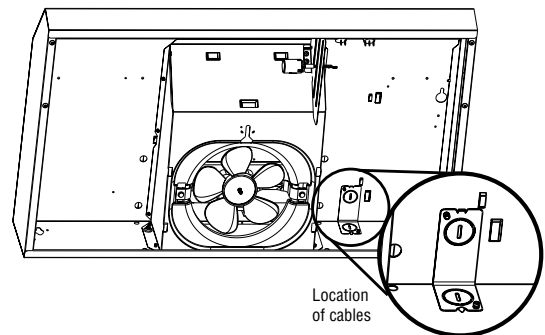

- Remove the power supply knockout (1) from the top or rear of the vent hood (depending on the incoming location of your home power supply cable) and install a UL listed or CSA approved 1/2 in. strain relief (not included).

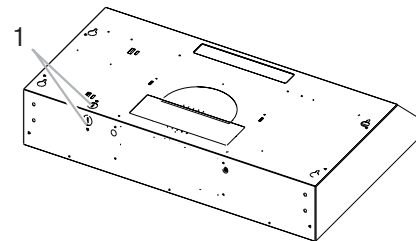

- Lift the hood into final position (see Installation section steps 11 or 12 depending the kind of installation you need). Feed enough electrical wire through the 1/2 in. UL listed or CSA approved strain relief to make connections in the terminal box. Tighten the strain relief screws.
- Connect ventwork to hood. Seal joints with vent clamps or duct tape to make secure and airtight.
- Check that back draft dampers work properly.

## Installation (continued)

### 11 Installing via cabinet mounting

- Lift the range hood (A) up under cabinet.
- Position the range hood (A) so that the large end of the keyhole slots (1) are over the mounting screws (AA).

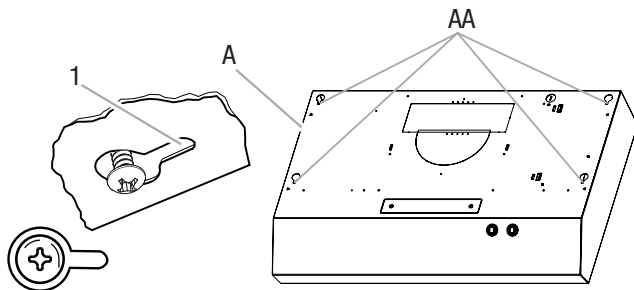

- Then push the hood toward the wall so that the upper mounting screws (AA) are in the neck of the slots (1).

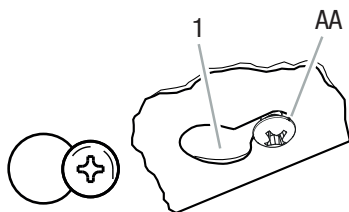

- Tighten the mounting screws, making sure they are in the narrow neck of slots.

### 12 Installing via wall mounting

- Lift the range hood (A) up under cabinet.
- Position the range hood (A) so that the large end of the keyhole slots (1) are over the mounting screws (CC).

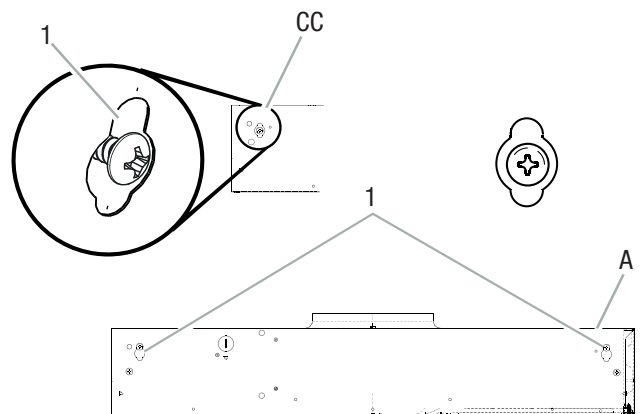

- Then push the hood down so that the upper mounting screws (CC) are in the neck of the slots (1).

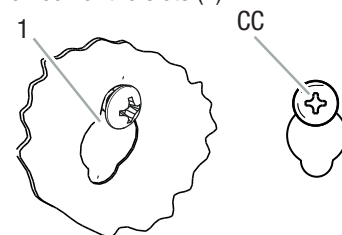

- Tighten mounting screws (CC).
- Insert the two remaining upper mounting screws (CC) into the security slots (2) to secure the hood.

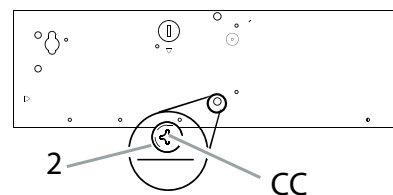

- Replace the hood cover starting from the bottom.
- Install the 4 screws securing the cover to the hood.
- Finally, put the grease filter in place, the retaining clip and the screw that secures the grease filter.

## Installation (continued)

### Bulb installation

- Before putting into place the range hood cover, install the light bulb.
- Screw a LED lamp 9 W max or incandescent bulb 40 W max into the socket.

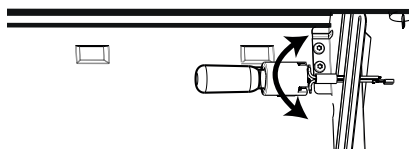

### Reinstalling range hood cover

- Insert the tab on the right side of the cover into the slot in the hood.

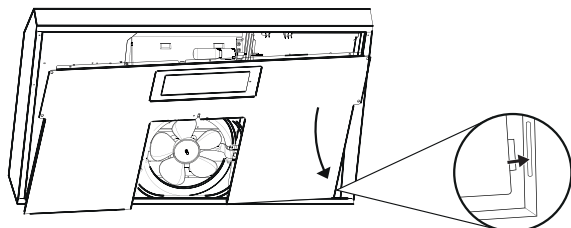

- Insert the tab on the left side into the slot in the hood.

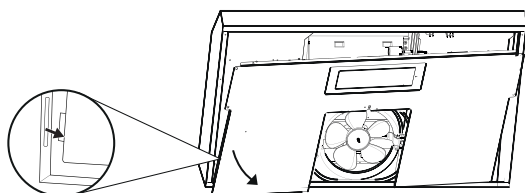

- Verify that the back of the cover assembles and fits inside the hood.

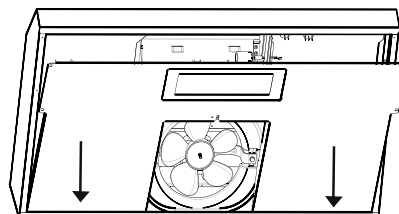

- Finally push inward and slide the cover toward the front to secure it against the hood.

