

KICKASS



RECHARGEABLE LITHIUM VACUUM SEALER

OWNER'S MANUAL

KAVSGEN2-USB

V1.1

SAFETY NOTES

- Use the vacuum sealer in dry, cool areas. Avoid exposing it to heat or excessive moisture.
- Do not leave the vacuum sealer unattended while it is operating.
- Always turn off and unplug the device when not in use.
- Never attempt to modify or alter the vacuum sealer in any way.
- Do not try to disassemble or repair the device yourself, unless directed by KickAss. If a part is damaged or not working, please contact KickAss support.
- Misuse of this product may cause injury or damage. Follow all instructions carefully.
- Keep the vacuum sealer out of reach of children. The device is not a toy.
- Keep pets away from the vacuum sealer at all times.
- Do not use chemicals or harsh cleaners on the device.
- If any part of the vacuum sealer or accessory comes into contact with liquid, dry it immediately with a soft cloth or paper towel.
- Unlock the lid after each use to avoid putting pressure on the sealing gasket and foam.
- Do not touch the sealing strip right after use - it becomes hot during operation.
- Avoid pressing the buttons while the lid is open, especially after switching the device on.
- Only use compatible vacuum bags (up to 30cm wide).
- Do not vacuum seal foods with high amount of liquid, as this can make the hose and machine difficult to clean.

TABLE OF CONTENTS

SAFETY NOTES ----- 2

PRODUCT SPECIFICATIONS ----- 4

INCLUDED COMPONENTS ----- 5

PRODUCT FEATURES ----- 6

PRODUCT OVERVIEW ----- 7

CHARGING THE UNIT ----- 8

USING THE RECHARGEABLE LITHIUM VACUUM SEALER ----- 9

 USING THE AUTOMATIC VACUUM-AND-SEAL FUNCTION ----- 10

 USING THE MANUAL VACUUM FUNCTION ----- 11

 USING THE AUTOMATIC SEALING FUNCTION ----- 12

 USING THE EXTERNAL VACUUM PIPE ----- 13

TROUBLESHOOTING ----- 14

CLEANING INSTRUCTIONS ----- 15

WARRANTY & SUPPORT INFORMATION ----- 15

PRODUCT SPECIFICATIONS

PRODUCT DIMENSIONS	376 mm x 78 mm X 58 mm (LWH)
WEIGHT	0.95 kg
APPROXIMATE SEALING TIME	30 seconds
VACUUM PRESSURE	60kPa
NOISE LEVEL	< 75dB
MAXIMUM SEALING WIDTH	≤ 30cm
SEALING LINE THICKNESS	3mm
USB-C INPUT	5V/2A 10W
BATTERY CAPACITY	1500 mAh
APPROXIMATE CHARGING TIME	2 hours
CERTIFICATIONS	AS/NZS CISPR 14.1 AS/NZS 60335.2 IEC 62133

INCLUDED COMPONENTS



VACUUM SEALER



CARRY BAG



**CHARGING
CABLE**



3 X CUTTING BLADES



**EXTERNAL
VACUUM
PIPE**



6 X REUSABLE VACUUM BAGS

PRODUCT FEATURES

- Cordless and rechargeable for convenient use anywhere.
- Compact and lightweight – easy to carry, store, and operate.
- Can vacuum and seal up to 42 times on a single battery charge.
- Offers three modes: Manual Vacuum, Automatic Vacuum-and-Seal, and Seal-only.
- Use the vacuum sealer anytime you need to keep food fresh, whether you're at home, on a trip, or even outdoors.
- Seals food quickly and easily in under 30 seconds.
- Lock-and-release buttons make it simple and safe to operate.
- Comes with a water-resistant carry bag, external vacuum pipe, USB-C cable, bag cutter, and vacuum bags.
- Battery charge level is shown via a 3-light LED indicator.
- LED indicators light up during operation to clearly show when the device is active, providing added safety and peace of mind.

PRODUCT OVERVIEW

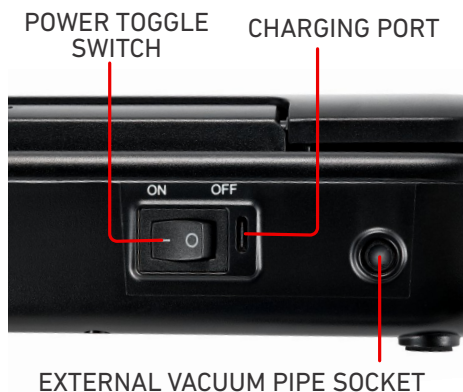

CHARGING THE UNIT

- Plug the included USB-C cable into the charging port of the vacuum sealer.
- Connect the other end to a suitable power source with a USB-C output.

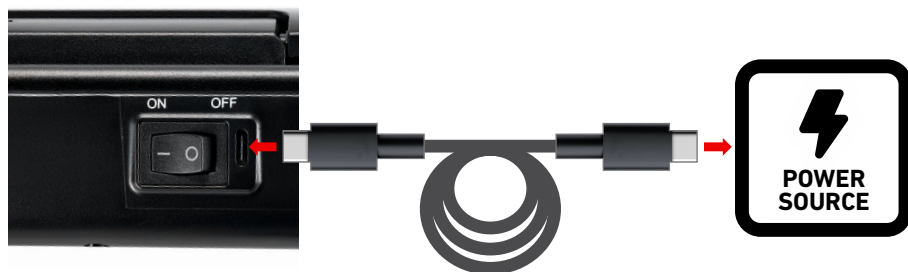

- Once connected, the LED indicator lights will show the battery level:
 - ● **One blinking light:** Battery is low and charging has started
 - ● **One solid + one blinking:** Battery is over 30% and still charging
 - ● **Two solid + one blinking:** Battery is over 60% and still charging
 - ● **All three solid:** Fully charged
- When charging is complete, unplug the cable and store in a clean, dry place.

USING THE RECHARGEABLE LITHIUM VACUUM SEALER

IMPORTANT NOTES:

- Remove all packaging, the protective bag, and any support materials before using the device for the first time.
- Make sure to fully charge the device before using it for the first time.
- After each sealing process, allow the device to cool down for about 20 seconds before using again.
- When using any vacuum function, make sure the bag is securely placed under the caging tabs of the vacuum chamber, with no wrinkles, without blocking the air suction holes.
- Avoid pressing any buttons while the device is still operating, this will interrupt the current process.
- During the vacuum sealing process, small amounts of liquid, crumbs, or food particles may be inadvertently pulled into the vacuum channel. Always clean and empty the vacuum chamber after each use using a soft cloth or paper towel.

USING THE AUTOMATIC VACUUM-AND-SEAL FUNCTION (VAC SEAL BUTTON):



- Fill the bag, leaving space between the contents and the bag opening.
- Open the lid and place the bag opening into the vacuum chamber. When inserting:
 - Make sure the caging tabs are properly installed.
 - Make sure the bag is under the caging tabs.
 - Avoid wrinkles.
 - Do not block the air suction holes.



- Close the lid and press down both sides firmly until it is fully locked and unyielding.
- Turn on the power using the toggle switch.
- Press the VAC SEAL button to start the automatic vacuum and sealing process.
- The indicator light will turn on.
- Wait for the light to turn off. This means sealing is complete.
- Turn off the power using the toggle switch.
- Unlock the lid by pressing both LOCK RELEASE buttons, then remove your sealed bag.

USING THE MANUAL VACUUM FUNCTION (MANUAL VAC BUTTON):



- Fill the bag, leaving space between the contents and the bag opening.
- Open the lid and place the bag opening into the vacuum chamber. When inserting:
 - Make sure the caging tabs are properly installed.
 - Make sure the bag is under the caging tabs.
 - Avoid wrinkles.
 - Do not block the air suction holes.



- Close the lid and press down both sides firmly until it is fully locked and unyielding.
- Turn on the power using the toggle switch.
- Press and hold the MANUAL VAC button to start vacuuming.
- Release the MANUAL VAC button once the desired vacuum level is reached.



- Press the SEAL button. The indicator light will turn on and the device will begin sealing.
- Wait for the light to turn off, this will indicate that the sealing process is complete.
- Turn off the power using the toggle switch.
- Unlock the lid by pressing both LOCK RELEASE buttons, then remove your sealed bag.

USING THE AUTOMATIC SEALING FUNCTION (SEAL BUTTON):

- Place the opening of the bag directly on the sealing strip, making sure the bag lies flat and wrinkle-free.
- Close the lid and press down both sides firmly until it is fully locked and unyielding.
- Turn on the power using the toggle switch, then press the SEAL button. The indicator light will turn on and the sealing process will begin.
- Wait for the light to turn off, indicating the seal is complete.
- Turn off the power using the toggle switch.
- Press both lock release buttons to open the lid and remove the sealed bag.



USING THE EXTERNAL VACUUM PIPE

- Connect the pointed nozzle end of the External Vacuum Pipe to the port on the back of the sealer.
- Connect the other end to the valve of the bag, jar or cannister you wish to vacuum seal.
- Press the MANUAL VAC button to initiate the vacuum sealing process, and hold it until the desired pressure is obtained.



TROUBLESHOOTING

<p>Vacuum sealer does not turn on.</p>	<ul style="list-style-type: none"> • Ensure the device has power or is being charged via a working power outlet. • Check if the USB cable or charging port is damaged. • Do not operate the device if it appears defective. Please contact KickAss Products.
<p>The vacuum pump runs, but the bag is not being vacuumed or sealed.</p>	<ul style="list-style-type: none"> • Make sure the open end of the bag is properly placed under the caging tabs of the vacuum chamber, with no wrinkles, and does not block the air suction holes. • Inspect the sealing foam of the vacuum chamber. Remove foreign elements sticking on the surface and clean if dirty. • Check for crumbs or food residue near the sealing area or sealing strip. Clean if needed. • Make sure the lid is properly locked on both sides before sealing. • Ensure the other side of the bag is fully sealed and there are no holes before starting.
<p>The device stopped the vacuum process before all the air was removed.</p>	<ul style="list-style-type: none"> • The device has a safety feature for the Automatic-Vacuum-and- Seal Function that pauses the operation if it runs continuously for 2 minutes. This may happen with larger bags or canisters. To resume the operation, simply press the VAC SEAL button again. • The buttons may have been pressed accidentally while the device was operating. • The device's battery has been depleted.

<p>Air returns into the bag after sealing.</p>	<ul style="list-style-type: none"> • Check the sealed edge for wrinkles, which can cause air leaks. Flatten the bag opening before sealing. • Wipe off moisture, crumbs, or food residue near the opening. Reseal the bag if needed. • For juicy or wet foods, partially freeze them before vacuum sealing.
<p>Bag does not seal properly.</p>	<ul style="list-style-type: none"> • Remove any wrinkles, moisture, or stuck food particles from the bag opening. • Wait at least 20 seconds between each seal to let the sealing strip cool down. Overheating can melt the bag. • Let the lid remain open between uses to help the device cool properly. • Check the condition of the vacuum bag. If there are molten parts on the sealing, replace the bag with a new one.

CLEANING INSTRUCTIONS

- Always turn off the device and unplug from any power source before cleaning.
- Allow the device to cool down completely before starting to clean.
- Never immerse the device in water or any other liquid.
- Use a soft, damp cloth or sponge to gently wipe the surface and vacuum chamber.
- Avoid using brushes or abrasive materials that may scratch the device.
- During vacuuming, small amounts of liquid, crumbs, or food particles may enter the vacuum chamber. Wipe the vacuum channel clean with a soft cloth or paper towel after each use to keep the device in good condition.
- Fully charge the device after each use, before storing.
- If storing for an extended period, charge the device every 3 months to maintain battery life.

WARRANTY & SUPPORT INFORMATION

Need help? For product support or to make a warranty claim, reach out to the KickAss Customer Service team on: warranty@kickassproducts.com.au

Alternatively, visit our Customer Support Portal at:
<https://supportportal.kickassproducts.com.au/>



KickAss is a registered trademark of
KickAss Products Pty Ltd.

Designed & imported by
KickAss Products Pty Ltd
39 Iris Place, Acacia Ridge, QLD 4110
Australia

Made in China

