

Note

- The external device connections shown may differ slightly from illustrations in a manual.
- In PC mode, there may be noise associated with the resolution, vertical pattern, contrast or brightness. If noise is present, change the PC output to another resolution, change the refresh rate to another rate or adjust the brightness and contrast on the [Picture] menu until the picture is

clear. Depending upon the graphics card, some resolution settings may not allow the image to be positioned on the screen properly.

- When connecting to a wired LAN, use a CAT 7 cable with high-speed Internet transmission.
- The TV may be capable of operating without a set-top-box from a multichannel video programming distributor (MVPD).

Specifications

Product specifications may be changed without prior notice due to upgrade of product functions.

Estimated yearly energy consumption indicated on the FTC label is measured in accordance with the Test Procedures for Television Sets (USA only).

The actual energy consumption depends on the usage environment (The content watched, TV settings, etc.).

- For information of the power supply and power consumption, refer to the label attached to the product.
 - The typical power consumption is measured in accordance with IEC 62087 or each country's energy regulations.
 - On some models, the label is inside the external device connection terminal cover.
 - Depending upon the model or country, the typical power consumption may not be on label.

(Depending upon country)

(Only QNED80AQA, QNED85AQA)

Broadcasting Specifications	
Television system	ATSC, ATSC3.0 (Only USA), NTSC-M, 64 & 256 QAM
Channel coverage (Band)	VHF 2-13, UHF 14-69, DTV 2-69, CATV 1-135, CADTV 1-135
External antenna impedance	75 Ω

(Except for QNED80AQA, QNED85AQA)

Broadcasting Specifications	
Television system	ATSC, NTSC-M, 64 & 256 QAM
Channel coverage (Band)	VHF 2-13, UHF 14-69, DTV 2-69, CATV 1-135, CADTV 1-135
External antenna impedance	75 Ω

- Certain 8K input/decoding standards may not be supported. An additional device may be necessary to support certain 8K standards. Upscaled and enhanced 8K images will vary depending upon the source content (Depending upon model).

Environment Condition	
Operating Temperature	0 °C to 40 °C (32 °F to 104 °F)
Operating Humidity	Less than 80 %
Storage Temperature	-20 °C to 60 °C (-4 °F to 140 °F)
Storage Humidity	Less than 85 %

Troubleshooting

Cannot control the TV with the remote control.	<ul style="list-style-type: none">Check if anything such as tape has been placed over the receiver.Check if there is any obstacle between the product and the remote control.Replace the batteries with new fresh ones.
No image display and no sound is produced.	<ul style="list-style-type: none">Check if the product is turned on.Check if the power cord is connected to a wall outlet.Check if there is a problem in the wall outlet by connecting other products.
The TV turns off suddenly.	<ul style="list-style-type: none">Check the power control settings. The power supply may be interrupted.Check if the auto-off function is activated in the settings menu.If there is no signal while the TV is on, the TV will turn off automatically after 15 minutes of inactivity.
Abnormal Display	<ul style="list-style-type: none">If the TV feels cold to the touch, there may be a small flicker when it is turned on. This is normal; there is nothing wrong with TV. Some minute dot defects may be visible on the screen, appearing as tiny red, green, or blue spots. However, they have no adverse effect on the TV's performance. Avoid touching the LCD screen or holding your finger(s) against it for long periods of time. Doing so may produce some temporary distortion effects on the screen.This panel is an advanced product that contains millions of pixels. In a very few cases, you could see fine dots on the screen while you're viewing the TV. Those dots are deactivated pixels and do not affect the performance and reliability of the TV.Displaying a still image for a prolonged period of time may cause an image sticking. Avoid displaying a fixed image on the TV screen for a extended length of time.
Generated Sound	<ul style="list-style-type: none">Cracking noise A cracking noise that occurs when watching or turning off the TV is generated by plastic thermal contraction due to temperature and humidity. This noise is common for products where thermal deformation is required.Electrical circuit humming/panel buzzing A low level noise is generated from a high-speed switching circuit, which supplies a large amount of current to operate a product. It varies depending upon the product. This generated sound does not affect the performance and reliability of the product.

- When cleaning the product, be careful not to allow any liquid or foreign objects to enter the gap between the upper, left or right side of the panel and the guide panel, (Depending upon model).

- Make sure to wring any excess water or cleaner from the cloth.
- Do not spray water or cleaner directly onto the TV screen.
- Make sure to spray just enough of water or cleaner onto a dry cloth to wipe the screen.

Regulatory

FCC NOTICE

This equipment has been tested and found to comply with the limits for a Class B digital device, pursuant to Part 15 of the FCC Rules. These limits are designed to provide reasonable protection against harmful interference in a residential installation. This equipment generates, uses, and can radiate radio frequency energy and, if not installed and used in accordance with the instructions, may cause harmful interference to radio communications. However, there is no guarantee that interference will not occur in a particular installation. If this equipment does cause harmful interference to radio or television reception, which can be determined by turning the equipment off and on, the user is encouraged to try to correct the interference by one or more of the following measures:

- Reorient or relocate the receiving antenna.
- Increase the separation between the equipment and the receiver.
- Connect the equipment to an outlet on a circuit different from that to which the receiver is connected.
- Consult the dealer or an experienced radio/TV technician for help.

This device complies with part 15 of the FCC Rules. Operation is subject to the following two conditions: (1) this device may not cause harmful interference and (2) this device must accept any interference received, including interference that may cause undesired operation. Any changes or modifications in construction of this device which are not expressly approved by the party responsible for compliance could void the user's authority to operate the equipment. and For indoor use only, use outdoors or in other modes not covered by this manual may violate the FCC regulation and violate the user authority to use the product.

FCC Radio Frequency Interference Requirements (for UNII devices)

High power radars are allocated as primary users of the 5.25 to 5.35 GHz and 5.65 to 5.85 GHz bands. These radar stations can cause interference with and/or damage this device. This device cannot be co-located with any other transmitter.

FCC RF Radiation Exposure Statement

(For having wireless function (WLAN, Bluetooth,...))

This equipment complies with FCC radiation exposure limits set forth for an uncontrolled environment. This transmitter must not be co-located or operating in conjunction with any other antenna or transmitter. This equipment should be installed and operated with minimum distance 20 cm (7.8 inches) between the antenna and your body. Users must follow the specific operating instructions for satisfying RF exposure compliance.

NOTE THE MANUFACTURER IS NOT RESPONSIBLE FOR ANY RADIO OR TV INTERFERENCE CAUSED BY UNAUTHORIZED MODIFICATIONS TO THIS EQUIPMENT. SUCH MODIFICATIONS COULD VOID THE USER'S AUTHORITY TO OPERATE THE EQUIPMENT.

NOTE TO CABLE/TV INSTALLER

This reminder is provided to call the CATV system installer's attention to Article 820-40 of the National Electric Code (U.S.A.). The code provides guidelines for proper grounding and, in particular, specifies that the cable ground shall be connected to the grounding system of the building, as close to the point of the cable entry as practical.

WARNING! (STABILITY HAZARD)

A television set may fall, causing serious personal injury or death. Many injuries, particularly to children, can be avoided by taking simple precautions such as:

- ALWAYS use cabinets or stands or mounting methods recommended by the manufacturer of the television set.
- ALWAYS use furniture that can safely support the television set.
- ALWAYS ensure the television set is not overhanging the edge of the supporting furniture.
- ALWAYS educate children about the dangers of climbing on furniture to reach the television set or its controls.
- ALWAYS route cords and cables connected to your television so they cannot be tripped over, pulled or grabbed.
- NEVER place a television set in an unstable location.
- NEVER place the television set on tall furniture (for example, cupboards or bookcases) without anchoring both the furniture and the television set to a suitable support.
- NEVER place the television set on cloth or other materials that may be located between the television set and supporting furniture.
- NEVER place items that might tempt children to climb, such as toys and remote controls, on the top of the television or furniture on which the television is placed.

If the existing television set is going to be retained and relocated, the same considerations as above should be applied.

Symbols

	Refers to alternating current (AC).		Refers to stand-by.
	Refers to direct current (DC).		Refers to "ON" (power).
	Refers to class II equipment.		Refers to dangerous voltage.

Using Magic Remote Control

- Power** Turns the TV on or off.
- Accesses the [Guide].**
 - [Dash]** Inserts a — between numbers such as 2-1 and 2-2.
- LIST** **Accesses the saved channel list.**
- QUICK ACCESS** **Accesses the [Edit Quick Access].**
 - [Edit Quick Access]** is a feature that allows you to enter a specified app or Live TV directly by pressing and holding the number buttons.
- Volume buttons** Adjusts the volume level.
- Home** Accesses the Home menu.
- Home** Launches the last used apps.
- Wheel (OK)** Press the center of button to select a menu. You can change channels by using button.
- Wheel (OK)** **Accesses the [Magic Explorer].** You can run the [Magic Explorer] feature when the pointer color is changed to purple. If watching a channel, press and hold down the pointer onto the video. When using [TV Guide], [Settings], [Sports Alert], or [Art Gallery], press and hold down on the text.
- Up/Down/Left/Right** Press the up, down, left or right button to scroll the menu. If you press buttons while the pointer is in use, the pointer will disappear from the screen and Magic Remote will operate like a general remote control. To display the pointer on the screen again, shake Magic Remote to the left and right.
- Back** Returns to the previous level.
- Back** Clears on-screen displays and returns to last input viewing.

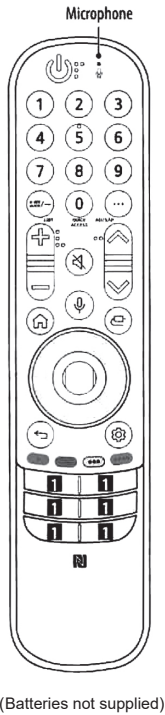

(Batteries not supplied)

- Number buttons** Enters numbers.
- Accesses the [Quick Help].**
- More actions** Displays more remote control functions.
- AD/SAP** SAP (Secondary Audio Program) feature can also be enabled by pressing the button.
- Channel buttons** Scrolls through the saved channels.
- Mute** Mutes all sounds.
- Mute** Accesses the [Accessibility] menu.
- Voice recognition** Network connection is required to use the voice recognition function. Check for recommended content. (Some recommended services may not be available in some countries.)
- Voice recognition** Speak while pressing and holding the button to use the voice recognition feature.
- Input** Changes the input source.
- Input** Accesses the [Home Dashboard].
- Q. Settings** Accesses the Quick Settings.
- Q. Settings** Displays the [All Settings] menu.
- These access special functions in some menus.
- Red button** Runs the record function.
- Streaming Service buttons** Connects to the Video Streaming Service.

The remote control vary depend of model: The buttons on the remote control may have a different name or location than the remote control shows in this manual.

Note

****To use the button, press and hold for more than 1 second.**

The descriptions in this manual are based on the buttons on the remote control. Please read this manual carefully and use the TV correctly. This remote uses infrared light. When in use, it should be pointed in the direction of the TV's remote sensor. (Some buttons and services may not be provided depending upon models or regions.)

How to register the Magic Remote Control

To use the Magic Remote, first pair it with your TV.

- Put batteries into the Magic Remote and turn the TV on.
- Point the Magic Remote at your TV and press the **Wheel (OK)** on the remote control.

- If the TV fails to register the Magic Remote, try again after turning the TV off and back on.

How to deregister the Magic Remote Control

Press the (**Back**) and (**Home**) buttons at the same time, for five seconds, to unpair the Magic Remote with your TV.

- Press and hold the (**Home**) and (**Q. Settings**) buttons for more than 5 seconds to disconnect and re-register the Magic Remote at the same time.



- It is recommended that an Access Point (AP) be located more than 0.2 m (0.65 ft) away from the TV. If the AP is installed closer than 0.2 m (0.65 ft), the Magic remote control may not perform as expected due to frequency interference.

Using Always Ready

(Depending upon model)

You can operate the TV and connect to Bluetooth with direct voice recognition while the power is off.

- → [General] → [Always Ready], setting [Enable the function] to on.
- Pressing the button while watching TV switches the screen to [Always Ready] that is turned on, and pressing the button once more turns the screen to [Always Ready] that is turned off.
- Press the (**Home**) button or the (**Back**) button to watch TV when the screen is in [Always Ready] that is turned on.

- Press the **Wheel (OK)** button to display the wallpaper when the screen is in [Always Ready] that is turned off, and press the button to watch TV.

Note

- Using Always Ready may increase energy consumption.
- For models with motion sensors, such as G2, if you set screen on with the motion sensor, the TV will turn on by recognising the motion.
- For more information about the feature, refer to the → → [User Guide] → [Troubleshooting] → [Learn More About Always Ready].

Connecting Smart Devices using NFC Tagging

NFC is technology that uses Near Field Communication (13.56 MHz), allowing you to conveniently send and receive information without separate settings. By bringing a smart device near the NFC-enabled remote control, you can install the LG ThinQ app and connect the device to the TV.

- Turn on NFC in the smart device's settings. To use NFC with Android devices, set the NFC option to enable 'read/write tags' in the smart device's settings. The NFC settings may vary depending upon the device.
- Bring the smart device near the (NFC) on the remote control. The required distance for NFC tagging is about 1 cm (0.39 inches).
- Follow the instructions to install the LG ThinQ app on your smart device.
- Retagging the smart device to the remote control allows you to conveniently access various features on the connected TV through the LG ThinQ app.

Note

- This feature is available for NFC-enabled smart devices only.
- This feature is only available if the remote control has an NFC logo.

Specifications

Specifications (MR22GN, MR22GA)		
	Frequency range	Output Power (Max.)
Bluetooth	2,400 to 2,483.5 MHz	7 dBm
NFC	13.56 MHz	-
* Only MR22GN		

Licenses



804106809A



PRINTED IN MEXICO / SC:14-09-2022
OBPN: "MFL71846432203 REV02"
SHNMDL: 75QNED80AQA_B / TAB / Elbrd:J.E.



55QNED85AQA 65QNED85AQA 65QNED90UQA
55QNED85UQA 65QNED85UQA 65QNED99UQA

804006809I

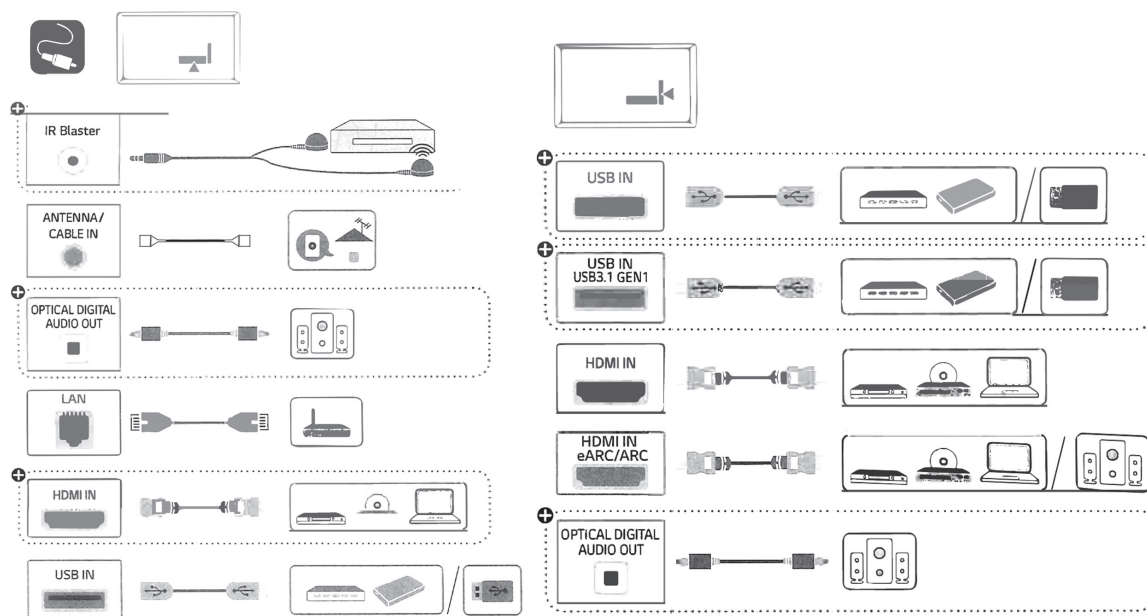
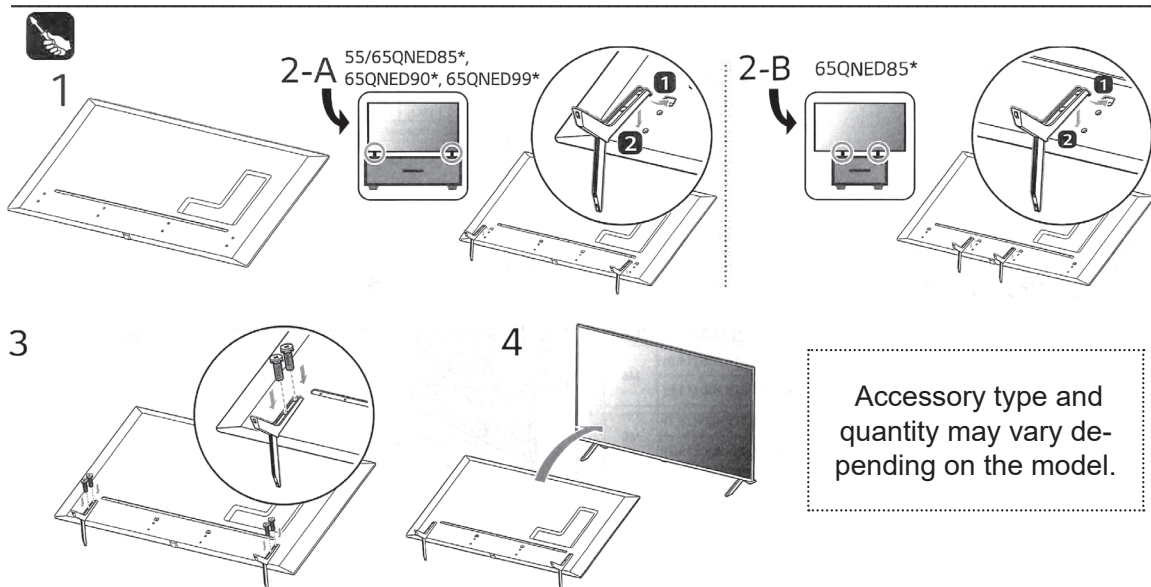
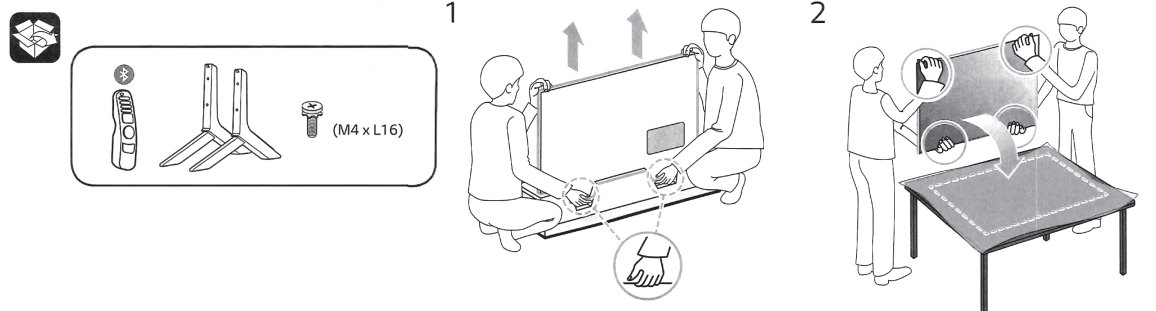

The cables mentioned in this guide is not supplied with your unit.



(Batteries not supplied)



The remote control vary depend of model: The buttons on the remote control may have a different name or location than the remote control shows in this manual.

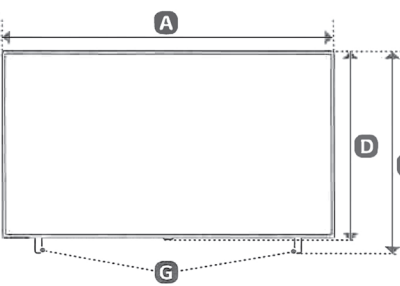

A, B, C, D, E : mm (inches)
F, G : kg (lbs)

MODELS	A		B		C		D		E		F		F - G		Power consumption
55QNED85AQA 55QNED85UQA	1,233 (48.5)	1 233 (48.5)	779 (30.6)	779 (30.6)	257 (10.1)	257 (10.1)	716 (28.1)	716 (28.1)	45.5 (1.7)	45,5 (1,7)	20.2 (44.5)	20,2 (44,5)	19.8 (43.6)	19,8 (43,6)	195 W
65QNED85AQA 65QNED85UQA	1,452 (57.1)	1 452 (57,1)	904 (35.5)	904 (35,5)	295 (11.6)	295 (11,6)	839 (33)	839 (33)	44.9 (1.7)	44,9 (1,7)	30.6 (67.4)	30,6 (67,4)	30.2 (66.5)	30,2 (66,5)	250 W
65QNED90UQA	1,444 (56.8)	1 444 (56,8)	898 (35.3)	898 (35,3)	295 (11.6)	295 (11,6)	834 (32.8)	834 (32,8)	29.5 (1.1)	29,5 (1,1)	26.8 (59.0)	26,8 (59,0)	26.4 (58.2)	26,4 (58,2)	290 W
65QNED99UQA	1,444 (56.8)	1 444 (56,8)	898 (35.3)	898 (35,3)	295 (11.6)	295 (11,6)	834 (32.8)	834 (32,8)	29.5 (1.1)	29,5 (1,1)	28.8 (63.4)	28,8 (63,4)	28.4 (62.6)	28,4 (62,6)	410 W
Power requirement										AC 120 V- 50/60 Hz					

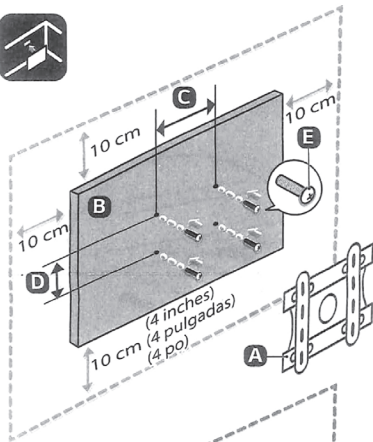

C, D : mm (inches)

A	B	C x D (mm)	E
OLW480B MSW240	55QNED85*	300 (11.8) x 300 (11.8)	M6
		300 (11,8) x 300 (11,8)	
LSW440B	65QNED85*	400 (15.7) x 400 (15.7)	M6
	65QNED90*	400 (15,7) x 400 (15,7)	
	65QNED99*	400 (15,7) x 400 (15,7)	

C : mm (inches)

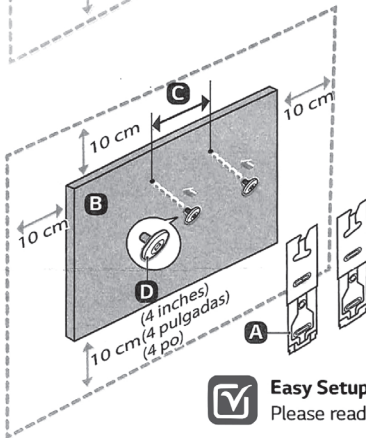

A	B	C (mm)	D
WB21LMB	55QNED85*	300 (11.8)	M6
		300 (11,8)	
WB21LMC	65QNED85*	400 (15.7)	M6
	65QNED90* 65QNED99*	400 (15,7)	



Easy Setup Guide

Please read this manual carefully before operating your set and retain it for future reference.

8040068091



PRINTED IN MEXICO / SC:02-21-2023 1P / Elbrd:M.C
OBPN: *MFL718785042203REV02* / SHNMDL: 65QNED85AQA_B