

Setup Instructions

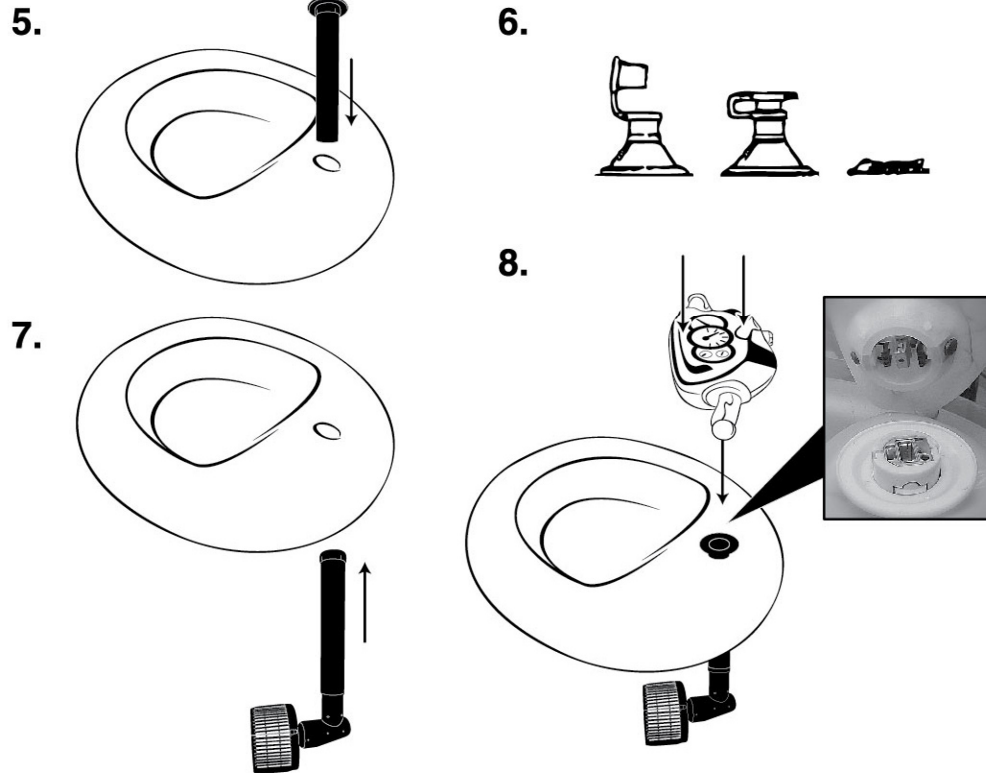

5. When the Aqua Blast Bumper Boat™ is partially inflated, fully insert the pipe cover from the top. Finish inflating the air chambers.

6. **NOTE:** Fill inflatable with air until the inflatable is firm and solid. If any seam begins to strain, immediately stop inflation and release air to reduce the pressure until all signs of stress on the inflatable are gone. **DO NOT** use the item if there is straining at the seams. Use of an over inflated item can result in serious injury, paralysis or death.

7. Insert the propeller unit into the pipe cover from underneath the Aqua Blast Bumper Boat™. You will hear the unit click into place when it is properly inserted.

8. Attach the controller unit to the top of the propeller pipe by aligning the connectors and pressing the unit down until it clicks twice.

NOTE: If you do not hear 2 clicks, the controller unit is not properly attached to the propeller pipe.

For easier assembly, push at the positions shown.

Use Instructions

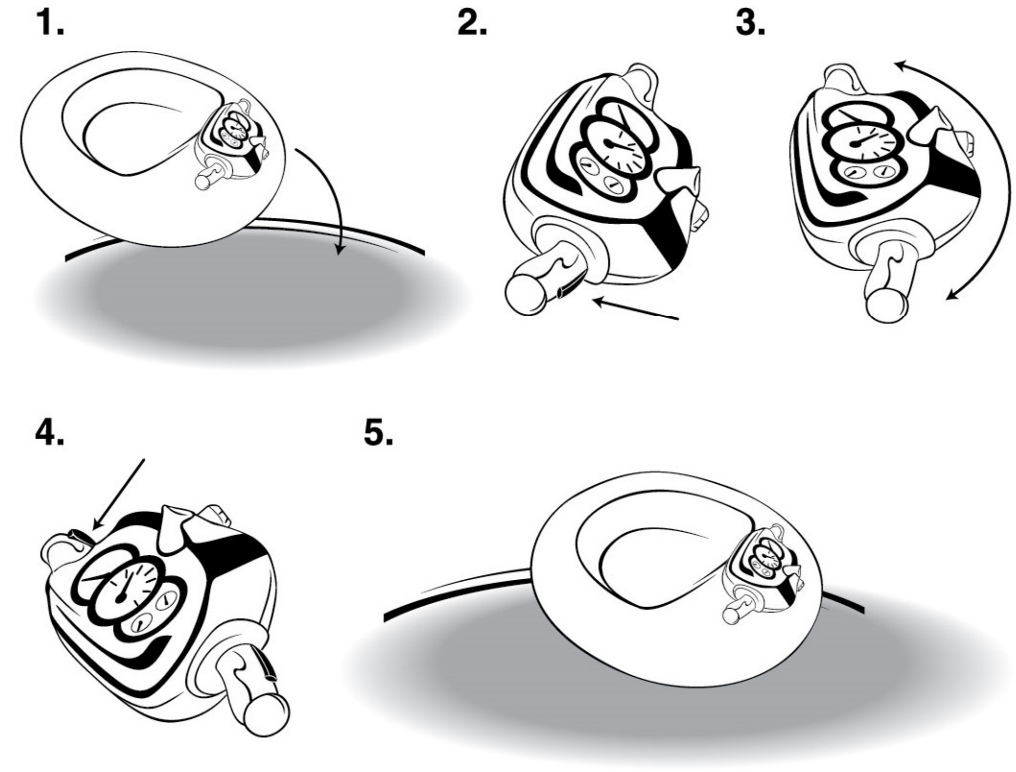

HOW TO PLAY

1. Place the assembled Aqua Blast Bumper Boat™ into the swimming pool.

2. Press and hold the right handle's trigger to start the propeller; release it to stop.

3. Turn the controller unit for steering control.

4. To shoot the water blaster, hold down the trigger on the left handle.

5. **IMPORTANT:** To prevent overheating, the Aqua Blast Bumper Boat™ may automatically shut down for cooling after long continuous play. The cooling process may take up to 1.5 hours.

WARNING!

1. This is a toy and not a life saving flotation device. It should not be used as such.

2. Attention! Aqua Blast Bumper Boat™ should be used in water level no higher than the neck of a standing child and under adult supervision.

3. There should be a minimum of 6 ft (183 cm) between the product and the swimming pool wall to prevent the possibility of the child falling off and hitting his head on the edge of the pool's wall.

Safety Information

WARNING!

To avoid the risk of serious injury or death:

- Intended for only children aged 5-10.
- Adult supervision required.
- Adult assembly required.
- Do not hang on, stand on or tackle this product.
- Do not use a high-pressure air pump to inflate.
- Do not use electric air pump if water or moisture is present. This may result in electric shock.
- Use product in swimming pool only.
- Never drive this product over other swimmers.
- This product is intended to be used as a toy and not as a personal flotation device.
- Do not allow anyone over 100 lb (45 kg) to use this product.
- Read all instructions before using this product.
- All safety warnings and instructions should be followed when the product is in use.
- Correctly follow all instructions and safety requirements shown in this manual; otherwise injury or death, especially for children, could result.
- All inflatables are temperature sensitive, therefore never unfold or inflate in temperatures below 50°F (10°C).
- Once inflated, make sure that the product does not come in contact with stones, gravel or other sharp objects, which could puncture the inflatable.
- There should be a minimum of 6 ft (183 cm) between the product and the swimming pool wall to prevent the possibility of the child falling off and hitting their head on the edge of the pool's wall.
- To prevent premature material fatigue, refrain from exposing the product to unnecessary sunlight. Over exposure to sunlight may cause leakage.
- Stop using Aqua Blast Bumper Boat™ if there is any damage to the propeller safety cage.
- Once assembled according to the instructions provided, confirm that this battery-operated toy is fully functional before placing in the water.

- This is not a lifesaving device. Do not leave a child unattended while the device is in use.
- Do not shoot water blaster cannon directly at person's eyes or face.
- Fill with clean, cold tap water only. (Other liquids may be harmful to people and the water blaster.)
- Do not insert anything inside nozzle.
- Do not attempt to alter the nozzle. (This may damage the product and will not function properly.)
- Do not allow sand or dirt to get inside the tank or nozzle. (Salt water and sand are harmful to the water blaster.)
- Only to be used in water in which the child is within its depth and under supervision.
- Not suitable for children under 36 months due to small part. Choking hazard.
- Keep away from fire.

While every attempt is made to embody the highest degree of protection in all equipment, we cannot guarantee freedom from injury. The user assumes all risk of injury resulting from use. All merchandise is sold on this condition, which no representative of the company can waive or change.

REPAIR PATCH INSTRUCTIONS

For your convenience, a repair patch has been included to repair holes in the inflatable section.

Do not use the patch for holes or rips on the seam.

In the event of an accidental puncture, cut out a suitably sized patch, making sure you round the corners of your repair patch to avoid peeling. Make sure the area to be patched is clean and dry. Press patch firmly over the puncture. Do not inflate for 20 minutes.

The repair patch should be applied by an adult.

Safety Information

Battery Care Instruction:

Important! Only adults should replace batteries.

- Non-rechargeable batteries are not to be recharged.
- Rechargeable batteries are only to be charged under adult supervision.
- Rechargeable batteries are to be removed from the toy before being charged.
- Different types of batteries or new and used batteries are not to be mixed.
- Batteries are to be inserted with the correct polarity.
- Exhausted batteries are to be removed from the toy.
- The supply terminals are not to be short-circuited.
- Alkaline batteries are recommended.
- Do not mix old and new batteries.
- Do not mix alkaline, standard (carbon-zinc), or rechargeable batteries.
- Please keep this information for future reference.
- Remove batteries from the product before extended storage.
- This toy is to be operated in water only when fully assembled in accordance with the instructions.

BANZAI IS USED UNDER LICENSE BY FOCUS BRAND LTD.
CONTENTS AND SPECIFICATIONS MAY VARY FROM THOSE ILLUSTRATED.

Banzai®

34179
TANG RONG ROAD,
CHANGPING, DONGGUAN, CHINA
ALL RIGHTS RESERVED
MADE IN CHINA
www.toysinquiry.com



BEFORE RETURNING TO STORE

PLEASE VISIT
THE CUSTOMER SERVICE WEBSITE
BELOW FOR IMMEDIATE ASSISTANCE
REGARDING QUESTIONS OR
PROBLEMS WITH THIS PRODUCT.

www.toysinquiry.com