

# Installation Instructions

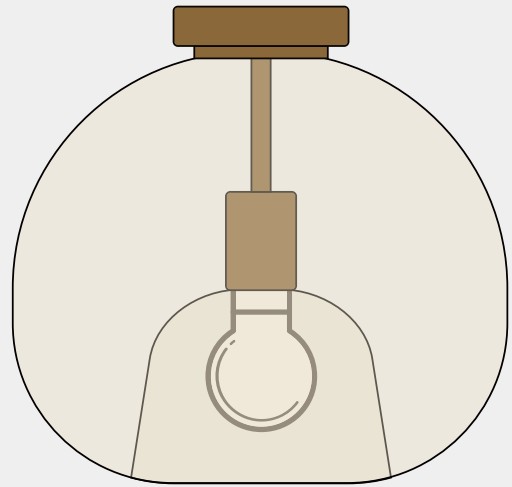

## Vintage Bubble Glass Flush Mount Ceiling Light

CL0153

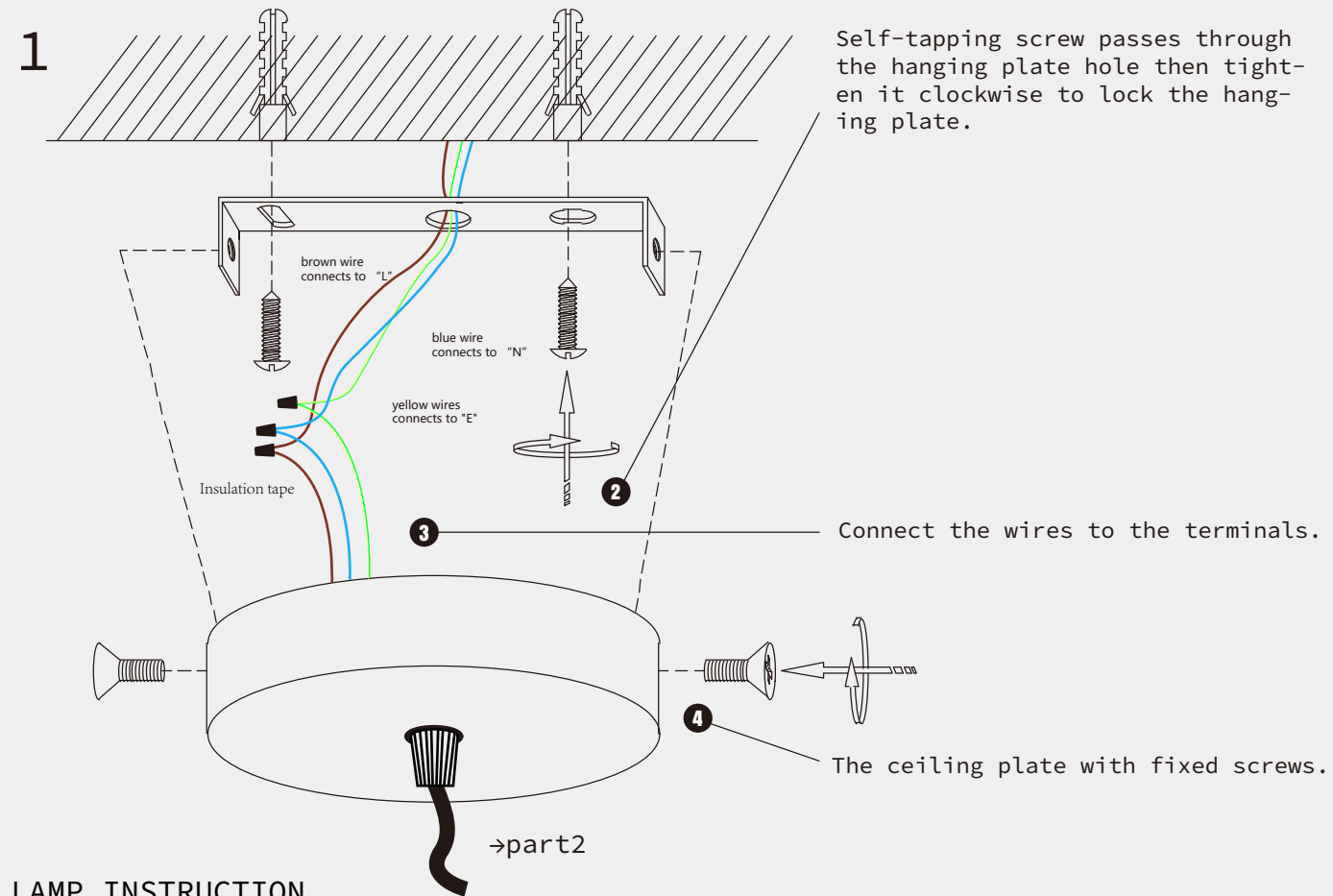

## THE LAMP INSTRUCTION



|   |   |
|---|---|
| Maintenance   | Precautions   |
| 1.Voltage: 220-240V                                   | Keep the lighting away from acidic chemical solvents to avoid damage.       |
| 2.Please wear gloves when install.                    |   |
| 3.Don't install it on the moist ceiling.              | Tip   |
| 4.Turn off the power before cleaning out.             | Please follow the instructions then install the parts in the correct order. |
| 5.Please wash with the sanitizer without corrosivity. |   |

2 Install lampshades from top to bottom.

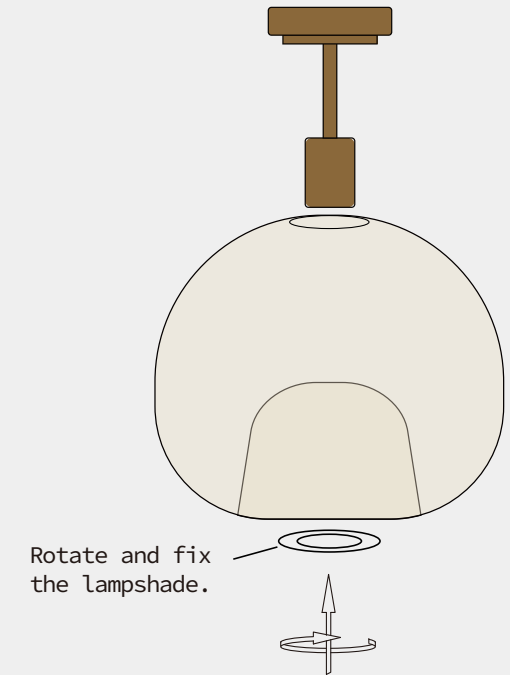

Rotate and fix  
the lampshade.

3 Turn on the power. ON

