



18V LITHIUM ION

USB POWER SOURCE

INSTRUCTION MANUAL

SPECIFICATIONS

Input: 18V DC
Output: 5V DC 2A (Type - A)
5V DC 2A (Type - C)
Compatible Batteries: All PXC Batteries

ozito.com.au

1. Charging Light
2. On Button
3. Output Type-C
4. Output Type-A

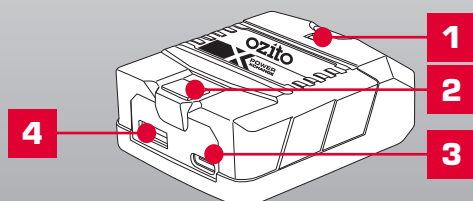

3 YEAR
REPLACEMENT WARRANTY

PXCG-USBC

DESCRIPTION OF SYMBOLS

V	Volts		Regulatory Compliance Mark (RCM)
A	Amps	Ah	Amp hour
	Indoor use only		Warning
	Read Instruction Manual		Do not dispose of in rubbish

CARING FOR THE ENVIRONMENT



Power tools that are no longer usable should not be disposed of with household waste but in an environmentally friendly way. Please recycle where facilities exist. Check with your local council authority for recycling advice.



Recycling packaging reduces the need for landfill and raw materials. Reuse of recycled material decreases pollution in the environment. Please recycle packaging where facilities exist. Check with your local council authority for recycling advice.



USB POWER STATION SAFETY WARNINGS

THIS MANUAL CONTAINS IMPORTANT SAFETY AND OPERATING INSTRUCTIONS FOR YOUR BATTERY CHARGER. BEFORE USING THE CHARGER READ ALL INSTRUCTIONS AND CAUTIONARY MARKINGS ON THE CHARGER AND BATTERY PACK. DO NOT LOSE THESE SAFETY INSTRUCTIONS.

1. Before using the charger read all instructions and cautionary markings on the charger, battery pack and the product using the battery pack.
2. Do not place any object on top of the charger or place the charger on a soft surface that may result in excessive internal heat. Place the charger in a position away from any heat source.
3. Do not operate the charger if it has received a sharp blow, been dropped or otherwise damaged in any way.
4. Do not disassemble charger.
5. Never attempt to connect 2 chargers together.
6. DO NOT store or use the tool and battery pack in locations where the temperature may reach or exceed 40°C (such as inside sheds or metal buildings in summer).
7. Keep the battery charger, batteries and the cordless tool out of children's reach.
8. Do not incinerate the battery pack even if it is seriously damaged or is completely worn out. The battery can explode in a fire.
9. Never attempt to open the battery pack for any reason. If the plastic housing of the battery pack breaks or cracks, immediately discontinue use and do not recharge.
10. Only use USB charging cables in good working condition
11. Never attempt to modify the charger in any way
12. Refer to the charging instructions and rating of your electronic appliance before using with this device.
13. Do not cover or place any object on top of the charger, place the charger away from heat sources.
14. Do not use the cordless tool or the battery charger near vapours and inflammable liquids.
15. Use power tools only with specifically designated battery packs. Use of any other battery packs may create a risk of injury and fire.
16. When battery pack is not in use, keep it away from other metal objects, like paper clips, coins, keys, nails, screws or other small metal objects, that can make a connection from one terminal to another. Shorting the battery terminals together may cause burns or a fire.
17. Under abusive conditions, liquid may be ejected from the battery; avoid contact. If contact accidentally occurs, flush with water. If liquid contacts eyes, additionally seek medical help. Liquid ejected from the battery may cause irritation or burns.
18. Do not use a battery pack or tool that is damaged or modified. Damaged or modified batteries may exhibit unpredictable behaviour resulting in fire, explosion or risk of injury.
19. Do not expose a battery pack or tool to fire or excessive temperature. Exposure to fire or temperature above 130°C may cause explosion.
20. Follow all charging instructions and do not charge the battery pack or tool outside the temperature range specified in the instructions. Charging improperly or at temperatures outside the specified range may damage the battery and increase the risk of fire.
21. Never service damaged battery packs. Service of battery packs should only be performed by the manufacturer or authorized service provider.



ELECTRICAL SAFETY



WARNING! When using mains-powered tools, basic safety precautions, including the following, should always be followed to reduce risk of fire, electric shock, personal injury and material damage.
Read the whole manual carefully and make sure you know how to switch the tool off in an emergency, before operating the tool. Save these instructions and other documents supplied with this tool for future reference.

This appliance is not intended for use by persons (including children) with reduced physical, sensory or mental capabilities, or lack of experience and knowledge, unless they have been given supervision or instruction concerning use of the appliance by a person responsible for their safety.
Children should be supervised to ensure that they do not play with the appliance.

This appliance is compatible and only to be used with all batteries & chargers from the Ozito PXC range. Refer to the PXC battery and charger manuals for information regarding charging, use and storage.

CHARGING CAPACITY

Suggested Charging Capacity by Battery Power	
Output	Suitable power to charge
2 Amp	Tablet computer, mobile phone, camera, devices requiring more power.

Note: PXCG-USBC is suitable to charge USB compatible devices such as a mobile phone, tablet or camera via the USB ports. Two devices can be charged simultaneously.

1. CHARGING A DEVICE

Connecting USB Power Station to battery pack

- 1 With the battery sitting on a flat surface, align the raised ribs on the battery with the recess in the usb power station and slide onto the battery ensuring a firm connection.

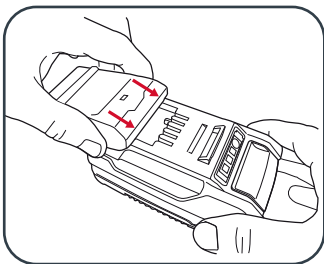

Connecting to Power Station

- 1 Connect the device to be charged via USB cord to the USB Power Station outlet.

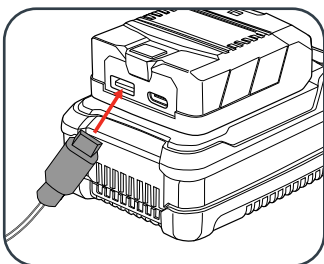

- 2 Push the On button to turn on

- 3 The LED will illuminate red showing power is being supplied to the USB Power Station.

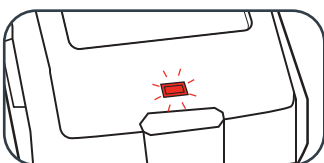

Note: If no device is connected or device requires charging current less than 65mA (TYPE-C port) or 85mA (TYPE-A port), the USB Power Station will turn off in 1 MINUTE. The red LED light will no longer be illuminated.

- 4 To remove, disconnect USB cord and press the battery release tab and slide the USB Power Station from its position.

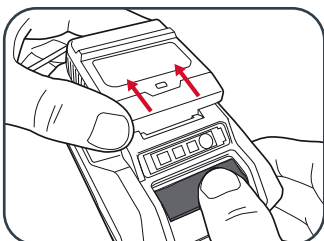

Note: For best results ensure the battery is fully charged.

2. MAINTENANCE

- Disconnect the charger from power source before cleaning.
- Keep the charger in a dry place out of reach of children.
- If the enclosure of the charger requires cleaning, do not use solvents. Use a dry, soft cloth only to wipe down the surface. Never let any liquid get inside the charger; never immerse any part of the charger.
- There are no other parts inside the charger which require maintenance. Do not take the charger apart. If the charger is damaged, contact your supplier or the manufacturer.

WARRANTY

IN ORDER TO MAKE A CLAIM UNDER THIS WARRANTY YOU MUST RETURN THE PRODUCT TO YOUR NEAREST BUNNINGS WAREHOUSE WITH YOUR BUNNINGS REGISTER RECEIPT. PRIOR TO RETURNING YOUR PRODUCT FOR WARRANTY PLEASE TELEPHONE OUR CUSTOMER SERVICE HELPLINE:

Australia 1800 069 486

New Zealand 0508 069 486

TO ENSURE A SPEEDY RESPONSE PLEASE HAVE THE MODEL NUMBER AND DATE OF PURCHASE AVAILABLE. A CUSTOMER SERVICE REPRESENTATIVE WILL TAKE YOUR CALL AND ANSWER ANY QUESTIONS YOU MAY HAVE RELATING TO THE WARRANTY POLICY OR PROCEDURE.

The benefits provided under this warranty are in addition to other rights and remedies which are available to you at law.

Our goods come with guarantees that cannot be excluded at law. You are entitled to a replacement or refund for a major failure and for compensation for any other reasonably foreseeable loss or damage. You are also entitled to have the goods repaired or replaced if the goods fail to be of acceptable quality and the failure does not amount to a major failure.

Generally you will be responsible for all costs associated with a claim under this warranty, however, where you have suffered any additional direct loss as a result of a defective product you may be able to claim such expenses by contacting our customer service helpline above.

36 MONTH REPLACEMENT WARRANTY

Your product is guaranteed for a period of **36 months from the original date of purchase** and is intended for DIY (Do It Yourself) use only. If a product is defective it will be replaced in accordance with the terms of this warranty. Warranty excludes consumable parts.

WARNING

The following actions will result in the warranty being void.

- If the tool has been operated on a supply voltage other than that specified on the tool.
- If the tool shows signs of damage or defects caused by or resulting from abuse, accidents or alterations.
- Failure to perform maintenance as set out within the instruction manual.
- If the tool is disassembled or tampered with in any way.

ONLINE MANUAL

Scan this QR Code with your mobile device to take you to the online manual.

