

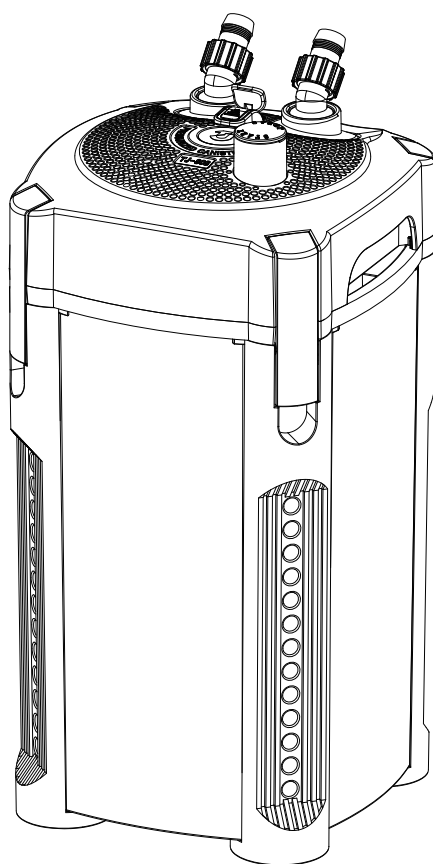

AQ150 USER MANUAL

AQQA External Filter



For the safe and proper operation of the filter, please read this user manual carefully.

1. Warning

1. Never pull the power cord with wet hands.
2. Ensure the power supply voltage and frequency align with those specified on the product label.
3. Cut off the power immediately at the first sign of abnormality. Disconnect all power before performing any maintenance.
4. Refrain from placing aquariums and filters near household electronics like computers and TVs.
5. Regularly unplug the power cord to remove accumulated dust and grime for safety.
6. Avoid pinning or binding the power cord and altering or replacing switches. If the power cord is damaged, dispose of the product.
7. To keep the plug and socket dry, position the socket between 1.3 to 1.5 meters above the ground and safeguard the power cord. (A "U" shape placement is recommended).
8. Do not use extension cords to minimize the risk of electric shock from water overflow or leakage.
9. Keep the filter away from flammable materials like gasoline.
10. Exercise caution to prevent children from interfering with the filter.

2. Attention

1. The filter must be installed at least 10 cm above the water level.
2. This product is equipped with a protection device to prevent motor overheating. The motor will stop running if it overheats due to empty running or debris blocking the water blades. The motor will resume operation once debris is removed and overheating is resolved. Please check for the following causes of overheating: reduced flow, kinked hoses, blocked water blades, etc.
3. Before use, double-check that the connecting hoses are correctly attached, and observe the operation for a while to ensure it runs smoothly.
4. This filter is designed exclusively for indoor ornamental fish tanks and should not be used for other purposes.
5. Do not lay the filter body on its side. Overly compact placement of filter media may decrease water flow.
6. Use the shortest and highest-quality hoses to minimize water resistance.
7. Regularly clean all components and replace filter media and other consumables to extend the motor's lifespan.
8. Be vigilant as small fish may be sucked into the filter.
9. Do not use the product when frozen, as it may damage it.
10. Avoid running the product without water for extended periods, as it can cause permanent damage.

3. Product Specifications

Model	Volt/Freq	Power	Max flow	Product size	Applicable tank size	Cord length
AQ150-1200L	US Standard: AC100-120V/50-60Hz	18W	1200L/H (317GPH)	7.1"x7.1"x11.2" (18x18x29CM)	16"-31.5"	6.2ft
					40-80cm	1.9m
AQ150-1800L	UK/AU Standard: AC 220-240V/50Hz	25W	800L/H (475GPH)	7.1"x7.1"x16" (18x18x40CM)	20"-39.5"	6.2ft
					50-100cm	1.9m
AQ150-2200L		35W	2200L/H (581GPH)	8.5"x8.5"x18.5" (21x21x47cm)	28"-55"	6.2ft
					70-140cm	1.9m

4. Spare Parts

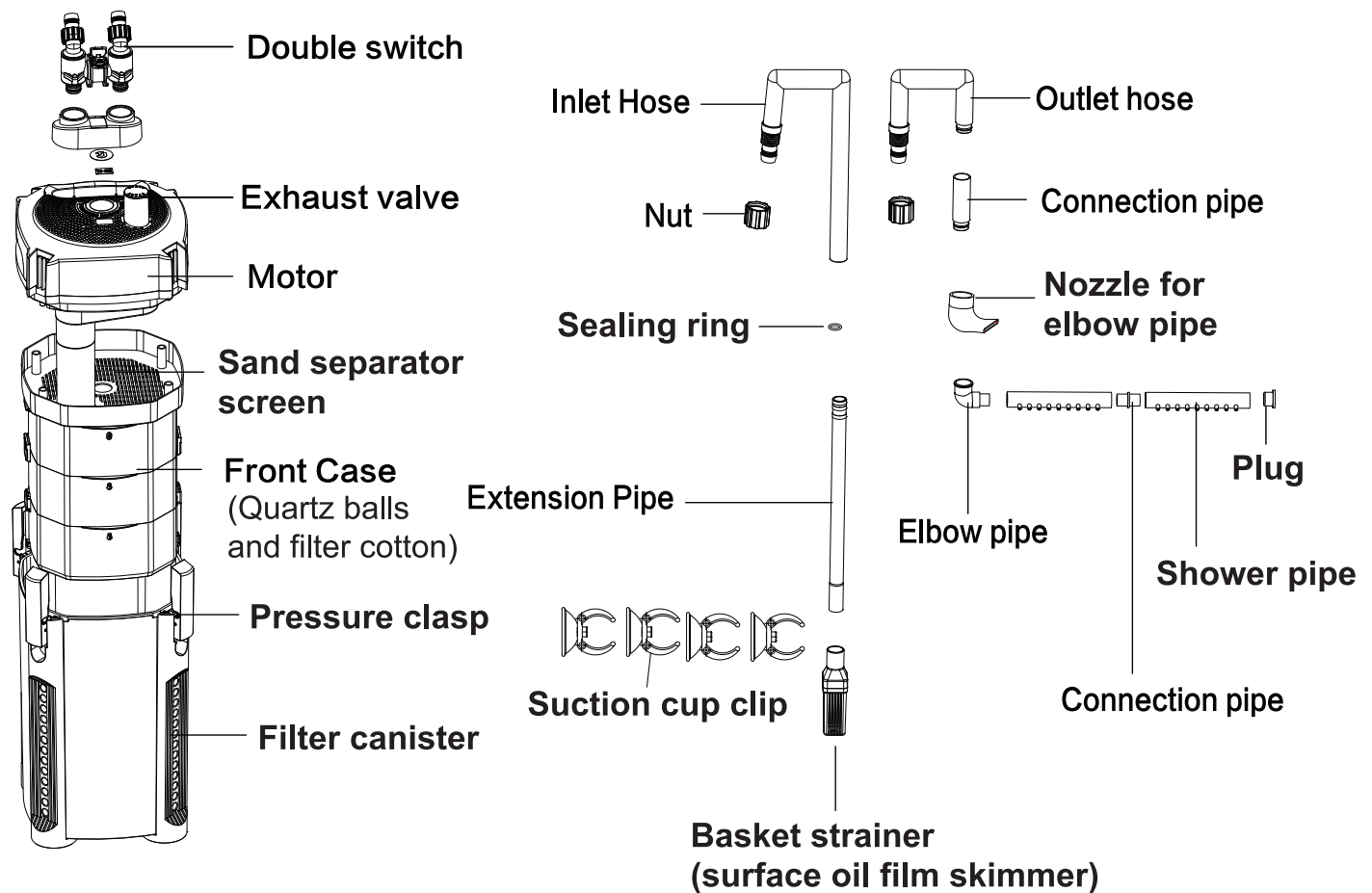

AQ150-1200L:1*Quartz balls and filter cotton
 AQ150-1800L:3*Quartz balls and filter cotton
 AQ150-2200L:3*Quartz balls and filter cotton

5. Installation Method

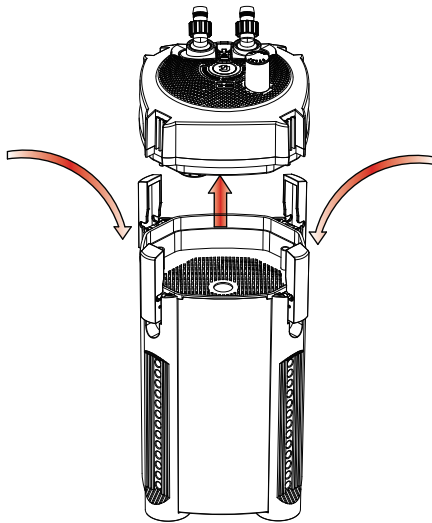

1. Release the safety latch by pulling it up from the bottom.
2. Unlock all the pressure clasps.
3. Hold the handles on both sides and lift them, ensuring to press down on the filter tank body during removal.

-
1. Remove the filter media separation screen, filter screen, and filter media from the filter canister for cleaning.
 2. Clean all the filter media thoroughly.

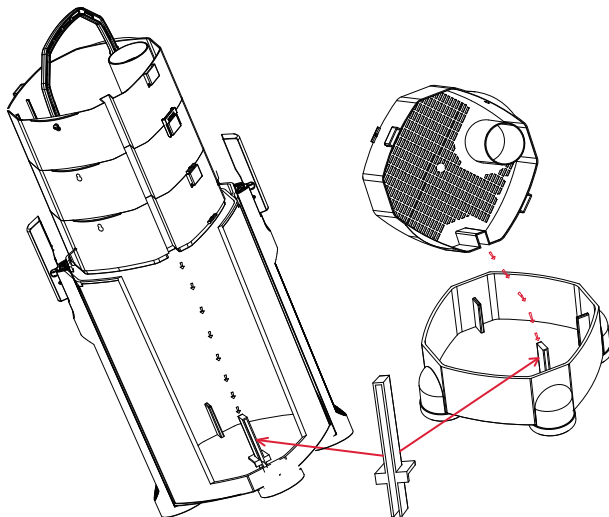
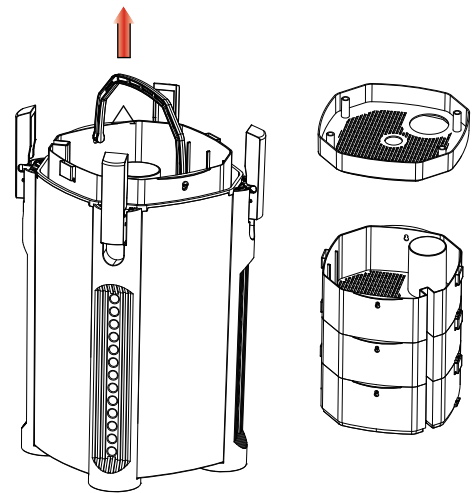

1. Insert the filter basket into the filter canister.
2. Make sure the red wire channel is correctly aligned with the corresponding clips on the canister's base.

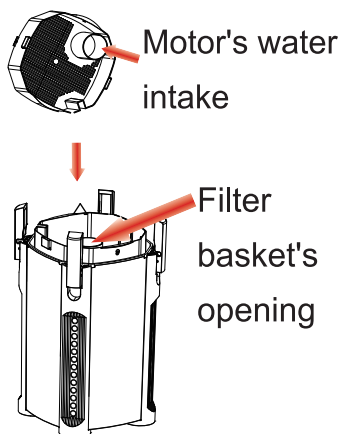

Installation of the Top Motor

Mount the motor into the filter canister, ensuring the motor's water intake aligns properly with the filter basket's opening. Next, firmly press down on the motor and lock it in place with the pressure clasps. (as illustrated in the diagram)

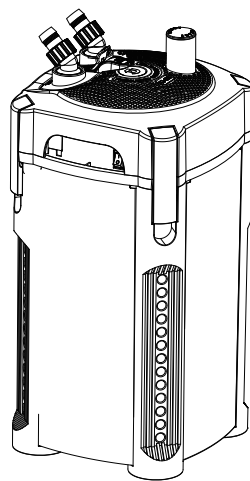
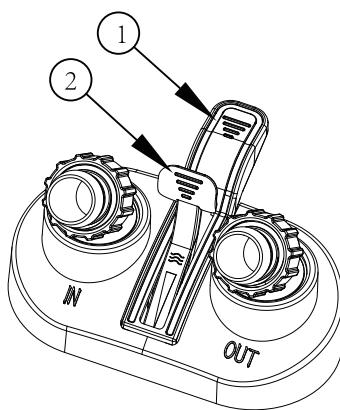
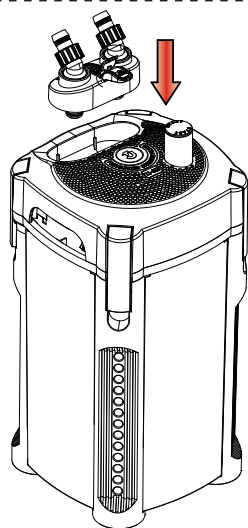
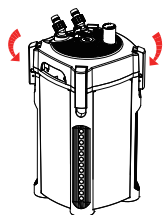

Install the Switch

Position the switch lever to the lowest water outlet setting (minimum water flow). Insert the switch into the two corresponding holes on the motor, and firmly press down on the lever to lock the switch in place on the motor's top. After that, adjust the water flow to the maximum. Note: ① indicates the switch lever, and ② indicates the water flow control valve.

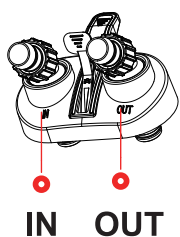
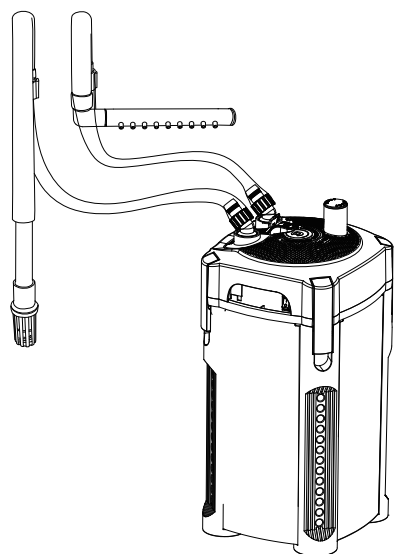

1. Attach the other end of the IN hose to the water intake elbow, extension pipe, basket strainer (surface oil film skimmer), and any additional fittings required.

2. Attach the other end of the OUT hose to the outlet elbow and the shower pipe.

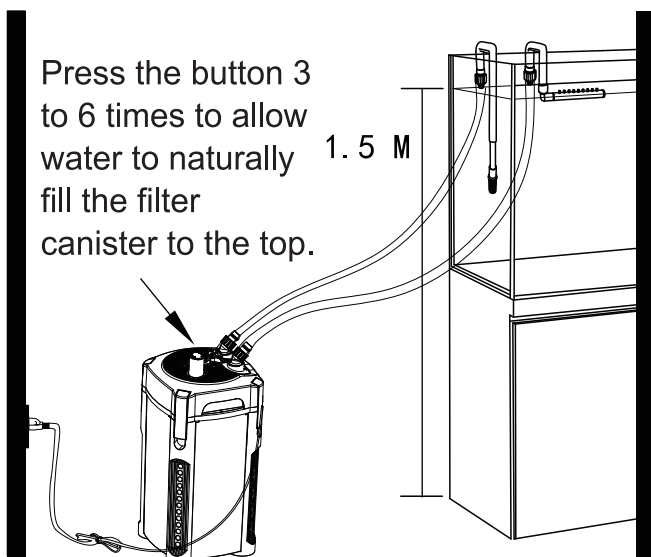

1. After the filter canister is filled with water, it will automatically release any trapped air, enabling it to operate efficiently.
2. Check all connection points for any signs of leakage.
3. In the event of leaks, switch off the power supply and tighten the affected connections to resolve the issue.

Filter Media Selection (Some need to be purchased separately)

1. White Filter Sponge: Effectively traps fine particulates.
 - Suggested replacement: Monthly.
2. Filter Sponge: Fosters nitrifying bacteria, decomposes waste, and filters debris.
 - Suggested replacement: Every six months.
3. Ceramic Rings: Improves water circulation, boost filtration performance, and remove larger particles.
4. Bio Balls: Promotes nitrifying bacteria growth, biological and physical breakdown, and filtration.
5. Activated Carbon: Eliminates odors and clarifies water.
 - Suggested replacement: Monthly.

6. Troubleshooting

Problem	Reason	Solution
The motor fails to fit onto the filter canister	a. The sand separator screen is positioned incorrectly	Position the sand separator screen correctly
	b. Sand separator screens are positioned incorrectly between each other	Correctly align the sand separator screens
	c. The arrangement of filter media is either too dense or excessive	Remove excess filter media
Motor is leaking	a. The pressure clasp is not secured correctly	Tighten the pressure clasp
	b. Debris is present on the sealing ring	Clear any debris from the sealing ring
	c. The sealing ring is damaged	Replace the damaged sealing ring

Problem	Reason	Solution
Impeller is not working	a. The power is not plugged in	Plug in the power
	b. The shaft has snapped	Replace the shaft
	c. The shaft or impeller is obstructed by debris	Remove foreign objects
Decreased Water Flow	a. Debris is obstructing the switch	Remove foreign objects
	b. The hose is bent	Straighten the hose
	c. The filter media has debris	Clean the filter media to remove debris
	d. The basket strainer is clogged	Remove the blockage from the basket strainer
Air buildup in the filter canister	a. Incorrect positioning of the device above the water level	Adjust the device so that the motor is more than 3.9 inches (10 cm) below the water surface, maintaining a suitable distance
	b. Filter media is debris-laden	Clean the filter media
	c. Air intrusion in the water inlet hose	Inspect the water inlet hose for sealing issues
Post-automatic suction, the water flow is impeded	a. The water inlet hose is improperly installed	Properly reinstall the water inlet hose
	b. The device is too close to the water surface	Position the motor more than 10 cm below the water level, adjusting the distance if necessary, maintaining a suitable distance
	c. Water is retained within the bucket, hoses, or other components	Remove the retained water

Problem	Reason	Solution
Noise generation during operation	a. Air in the hoses	Gently sway the body from side to side to release the trapped air
	b. Air trapped within the canister	While the filter is powered on, move it left and right to expel the air
	c. Motor is above the water surface	Ensure the motor is positioned more than 10 cm below the water surface
	d. Air is retained in the filter body	Cycle the power supply on and off 4-5 times, and sway the filter body
	e. Debris on the rotor	Remove the debris
	f. Shaft is snapped	Replace the shaft

7. AQQA LIMITED MANUFACTURER'S WARRANTY

We offer the end user of this product a manufacturer warranty of 2 years from the date of sale if this product was purchased from an AQQA®-authorised specialist dealer

Retain receipt for any future warranty claim. Conditions apply. Products are guaranteed by AQQA® Aquatic Supplies to the original purchaser against defective material and workmanship under normal use for a period up to 2 years from the date of the original purchase through an Authorized Dealer. Refer to the User Manual included with your product for specific warranty details.

Products have no warranty if:

1. The product has been serviced, modified or tampered with by anyone other than AQQA® Aquatic Supplies.
2. The product has been abused or damaged (including broken or cracked bulbs), and/or.
3. The product has been transported without proper packaging.
4. The product was purchased from an Unauthorized Reseller.

WARRANTY LIABILITY DISCLAIMER

In no event will AQQA® be liable for any consequential or incidental damages, including but not limited to, lost aquatic life, personal injury, property damage, equipment damage, lost profits, lost wages, lost savings, lost income, etc., arising out of the use of any AQQA® products.

1.0. Terms and Conditions of Warranty.

- 1.1. AQQA® warrants to the purchaser, for 2 years from date of original purchase through an Authorized AQQA® Reseller, free to repair or replace parts where fault is found due to defective materials or faulty workmanship and where goods do not operate in accordance with the instructions.

- 1.2. All claims for repair or replacement must be made at place of purchase.
- 1.3. Only the direct purchaser is entitled to warranty claims against us and these are not transferable without our consent.
- 1.4. The original and dated Proof of Purchase (receipt) must be supplied with all goods claims. Please also provide this Guarantee where possible.
- 1.5. Wear parts (e.g.: seals, suction devices, axes, pump wheels, light sources, pH electrodes, filter media, such as filter cartridges, as well as UVC burners), glass damage and the opening of the product, as well as structural changes or the use of non-AQQA® original parts are excluded from the guarantee.
- 1.6. All goods subject to claim under Guarantee should be prepared for transportation in the original packaging or other comparable packaging which offers the same degree of protection and AQQA® must incur no costs from the shipment.
- 1.7. Where claims on inspection reveal goods are in normal working order, AQQA® will request reimbursement of all reasonable costs incurred.
- 1.8. Warranty claims do not exist in the case of only insignificant deviations from the agreed or customary condition or usability, e.g. insignificant deviations in colour, dimensions and/or quality or performance characteristics of the products.
- 1.9. Our warranty obligation extends only to the delivery of newly manufactured products. Unless otherwise agreed, used products are sold as seen, excluding any warranty.

8. DISPOSAL

Do not dispose of this product as unsorted municipal waste. Collection of such waste separately for special treatment is necessary. This product has to be disposed of at an authorized place for the recycling of electrical and electronic appliances rather than being disposed of together with the domestic waste. Collecting and recycling waste is a way of saving natural resources. So, please consult with your local seller to make sure the product is disposed of in an environmentally friendly way.



9. CONTACT INFORMATION

Company Name: Shenzhen Aiku Pet Technology Co., Ltd
Add: Room 501, No.20, Lane 1, Lishipai, Dafapu Community
Bantian Street, Longgang District, Shenzhen Guangdong. 518000
Email: service@aqqapet.com
Website: <http://www.aqqapet.com>



@AQQA Aquarium



Company: E-CrossStu GmbH
Address: Mainzer Landstr.69, 60329
Frankfurt am Main
Email: E-crossStu@web.de
Nr.202504727907



Company Name: YH Consulting Limited
Address: C/O YH Consulting Limited Office
147 Centurion House, London Road
Staines-upon-Thames, Surrey, TW18 4AX
Email: H2YHUK@gmail.com
Tel: +44 07514-677868
No.202504725766



MADE IN CHINA