

## ENGLISH

<b>Introduction</b>	4
<b>Care and maintenance</b>	4
<b>Warning</b>	4
Hearing protection	4
Safety	4
<b>Technical specifications</b>	5
Audio	5
Connectivity	5
Microphone	5
Battery	5
<b>Product content</b>	6
<b>General overview</b>	6
<b>First time use</b>	6
<b>Switching on and off the device</b>	6
<b>Bluetooth® pairing</b>	6
<b>ESmart Connect app</b>	7
Setting up your account	7
Pairing the earphones	9
Manual pairing (altenative method)	12
<b>Customising the product with ESmart Connect App</b>	14
Equalizer	14
Have you lost your device? (Find my earbuds)	18
Custom control	19
Proximity sensor	20
Renaming the device	21
<b>Default settings</b>	23
Play/Pause	23
Volume +/Volume -	23
Skipping to the next/previous track	23
Call control	23
Answering/Ending a call	23
Using the Voice Assistant feature	23
<b>Charging the battery</b>	23
Earphones	23
Charging case	23
<b>Restoring default settings</b>	23
<b>FAQ / Troubleshooting</b>	24
I can't link the earphones to the ESmart Connect app.	24
<b>Warranty</b>	24



ENERGY♥SYSTEM



**senshi eco.**

Manual de usuario / User manual  
Manual de l'utilisateur / Manual do usuário

## Introduction

---

Thank you for trusting our company and buying the new *Senshi Eco Earphones*. We hope you enjoy the product.

## Care and maintenance

---

- Do not expose your *Senshi Eco Earphones* to impacts, dust, humidity or high temperatures.
- Use neither corrosive nor abrasive cleaning products.
- Do not disassemble the device. All repair works should be carried out exclusively by qualified staff of Energy Sistem Technology, S.A.
- Make sure your *Senshi Eco Earphones* are off when you are not using them. Do not store them with an empty battery for long periods of time.
- You can clean the earbuds' external surface and charging connectors with a clean cloth and hand sanitiser. Do not use these products to clean the ear tips or the internal mesh of the earphones. Avoid getting the charging ports and connectors wet.

**Note:** After every workout session, we recommend thoroughly drying the earphones before putting them back in the case.

## Warning

---

### Hearing protection

Listening to loud music can cause irreversible hearing loss. To avoid hearing damage, we recommend the following guidelines:

- Do not listen to loud music for long periods of time.
- Turn the volume down on the source device before using the earphones, then gradually increase the volume to a safe volume level.

### Safety

For safety reasons and to avoid possible accidents, we recommend the following safety measures:

- Do not use the earphones while driving or carrying out any other activity that requires special attention.
- Keep the product, packaging and accessories out of the reach of children and pets to avoid accidents and choking hazard.

## Technical specifications

---

### Audio

- Frequency response: 20 Hz ~ 20 kHz
- Driver diameter: 10 mm
- Earbud design
- Type: dynamic

### Connectivity

- Bluetooth® 5.3 (class 2) wireless technology.
- Frequency band: 2.4 GHz
- Maximum output power: < 20.00 dBm
- Compatible Bluetooth profiles: HSP / HFP / A2DP / AVRCP
- Compatible with SBC codecs
- Up to 20 m distance range
- True Wireless function with auto-pairing
- Hands-free function
- Voice assistant compatible with Google/Siri

### Microphone

- Type: built-in microphone
- Sensitivity: -42 dB ± 3 dB (@1 kHz)
- Frequency range: 100 Hz ~ 10 kHz

### Battery

#### Earbud:

- Capacity: 30 mAh / 3.7 V
- Type: lithium-polymer battery
- Battery life at medium volume: 5 hours
- Charging time: 1.5 hours
- Charging method: charging case
- This value is approximate. The battery life depends on the selected volume and type of music.

#### Charging case:

- Capacity: 400 mAh / 3.7 V
- Type: lithium-polymer battery
- Extra battery life: 20 hours
- Charging time (cable): 1.5 hours
- Charging time (charging pad): 4 hours
- Charging method: USB Type-C and Qi compatible wireless charging

#### Other features:

- Proximity sensor to control music playback
- ESmart Connect App compatible

## Product content

---

- Senshi Eco Earphones
- Wireless charging case
- USB Type-C cable
- Quick guide

## General overview

---

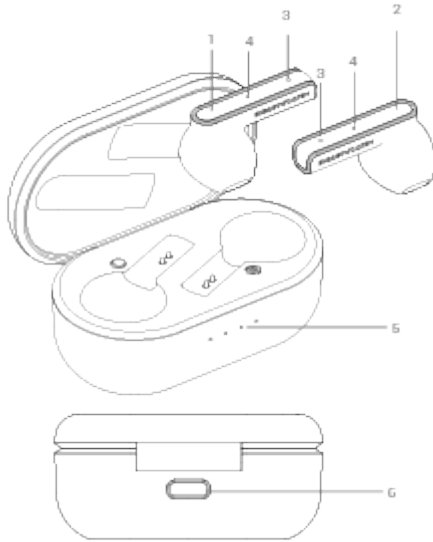

1. Left multifunction button
2. Right multifunction button
3. Microphone
4. Status LED
5. Charging indicator (charging case)
6. USB Type-C charging port

## First time use

---

When using your earphones for the first time, remove the blue sticker from the charging pins on each earphone. Place them back in the case to start charging.

## Switching on and off the device

---

To switch on your *Senshi Eco Earphones*, simply take them out of the charging case or tap and hold the *Left and Right multifunction buttons (1 and 2)* for 10 seconds. You will hear a confirmation sound. Both earbuds sync automatically.

To switch off your *Senshi Eco Earphones*, put them back in the charging case or tap and hold the *Left and Right multifunction buttons (1 and 2)* for 10 seconds.

## Bluetooth® pairing

---

Switch on your *Senshi Eco Earphon*. Both earbuds sync automatically. Select *Senshi Eco Earphon* from the list of Bluetooth devices on your smartphone or Bluetooth music player and press "connect". Both earbuds will pair with it immediately and without codes. You will hear a confirmation sound when the devices are paired.

If you previously paired the earbuds with a device, there is no need to repeat the pairing process. Just enable Bluetooth

mode on your music player and switch on your *Senshi Eco Earphon*. They will sync with it automatically.

## ESmart Connect app

---

Before getting started you will need to download the *ESmart Connect* app to your Android device from Google Play, or from the App Store for iOS. This will let you set up and manage your *Senshi Eco Earphon*.

**NOTE:** If the app does not appear in your Play Store, you will have to download it directly using this link [here](#) .



ESmart Connect  
Energy Sistem



### Setting up your account

- 1) After installing and opening the app, tap to accept the "User Agreement and Privacy Policy".
- 2) Go to the next page, tap on Sign Up, and enter your phone number or email to register and get the verification code.
- 3) Enter the verification code and set the password to register and log in.

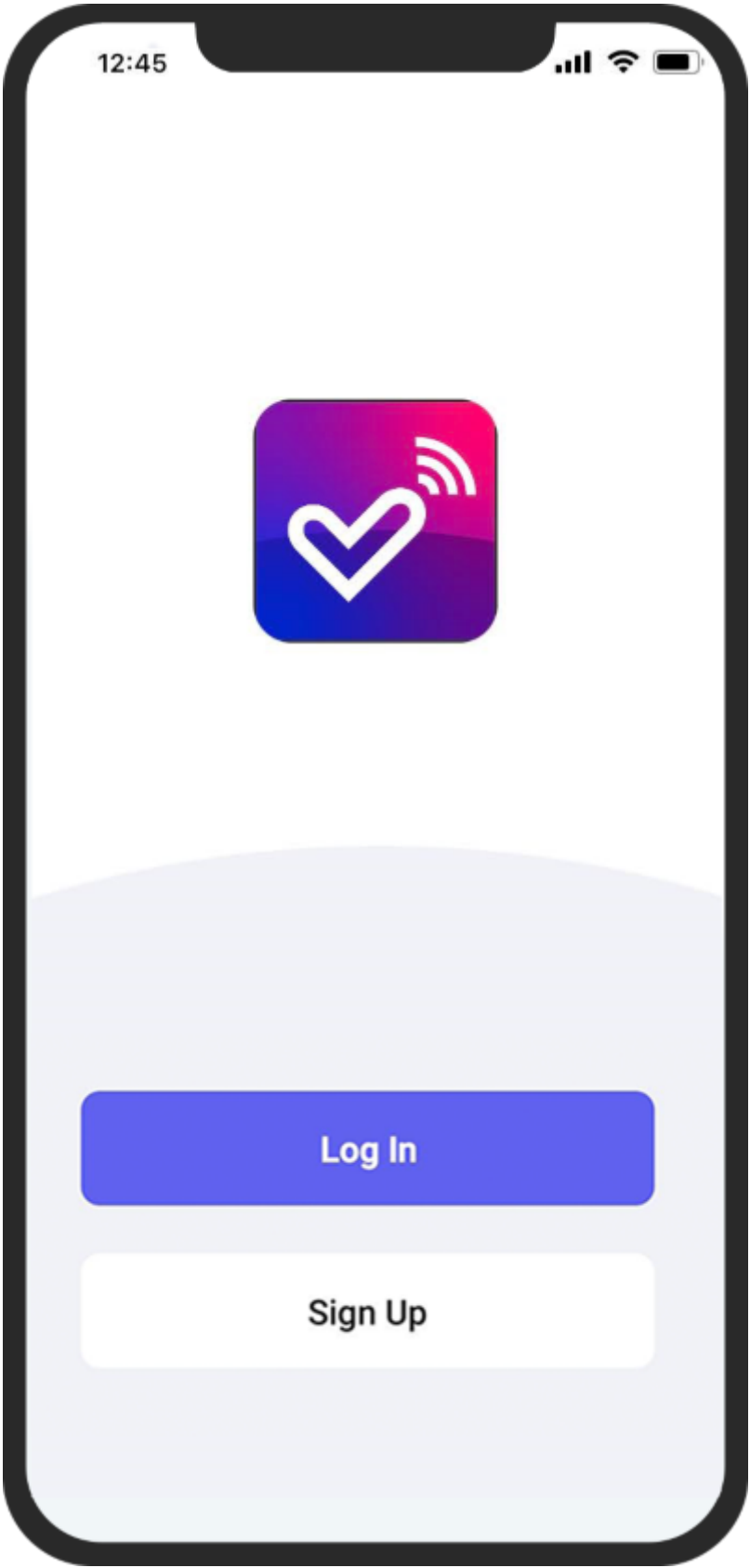

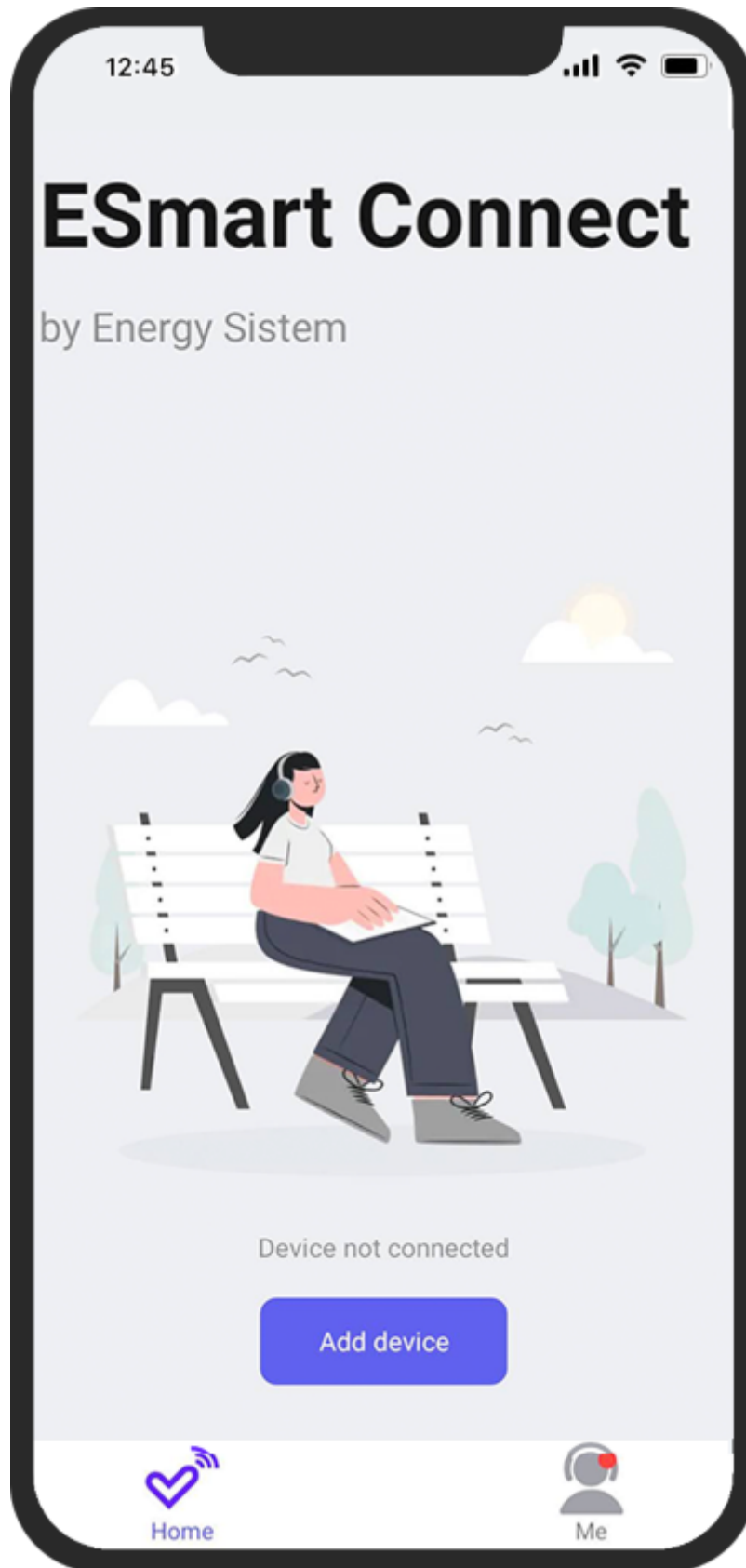

In the user profile, you can change your profile picture, nick and time zone (the app automatically selects your device's time zone).

You can also manage your configured devices, receive app notifications, see the FAQs, and make comments or suggestions for our customer service team.

#### Pairing the earphones

**Important:** Before pairing or connecting the headset to the application, you need to have your phone's GPS enabled.

**Note:** \*For operating system security reasons, the earphones must be connected manually via Bluetooth® connection in the phone's Bluetooth functions menu when using iOS devices. If this is not the case, the earphones will not be able to connect to the app.

Almost all Android devices support "one-click configuration", and will connect to the earphones directly via Bluetooth® connection using ESmart Connect. Otherwise you will need to pair the earphones to your device manually via Settings > Bluetooth.

On the app home screen, tap the "Add device" button to start the automatic search. When your Earphones Style 4 are shown, tap the Add button to download the menu for the model (Earphones Style 4). Tap on the *Done* button when the model interface has finished downloading.

The product interface will appear, showing a pop-up window to pair the earphones with the phone.

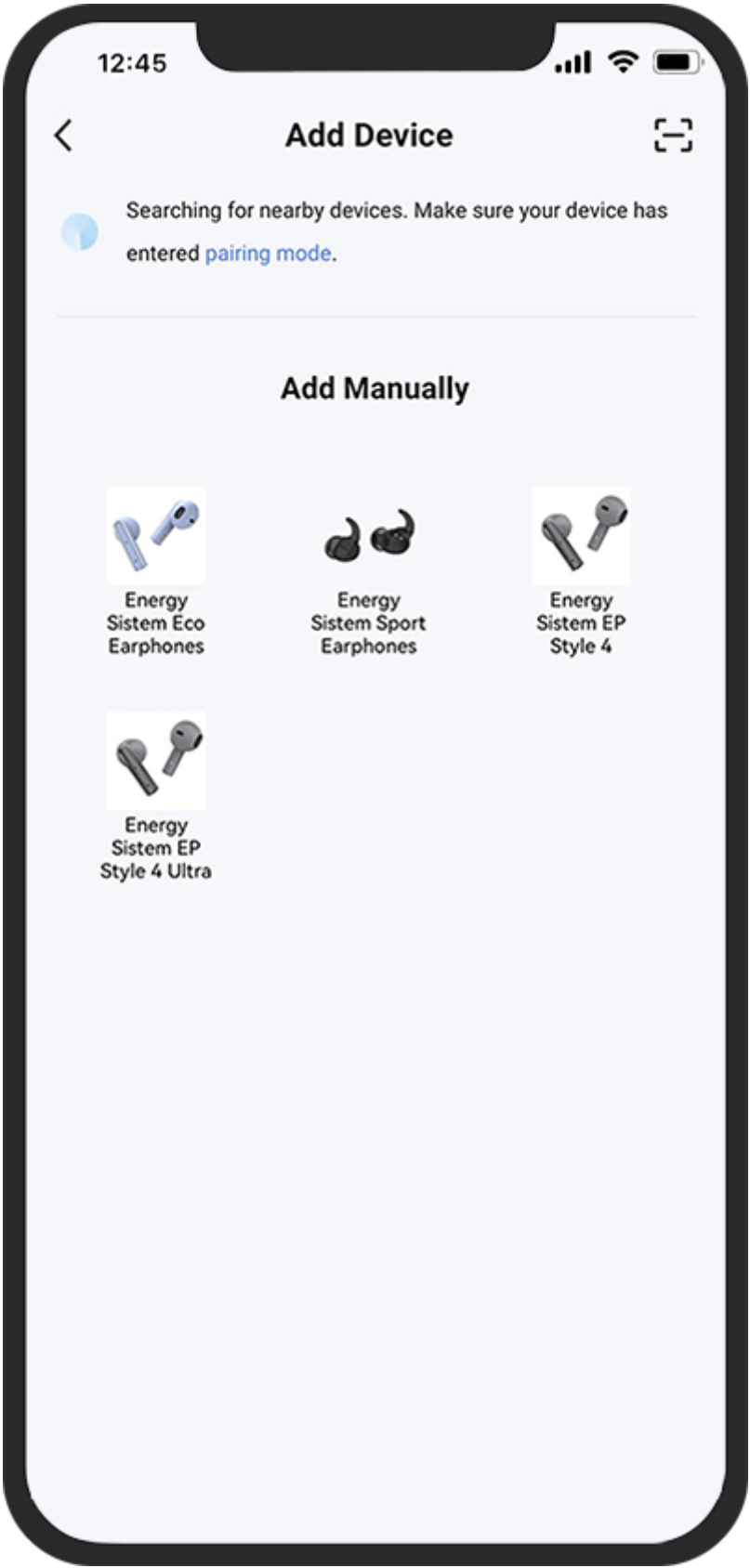

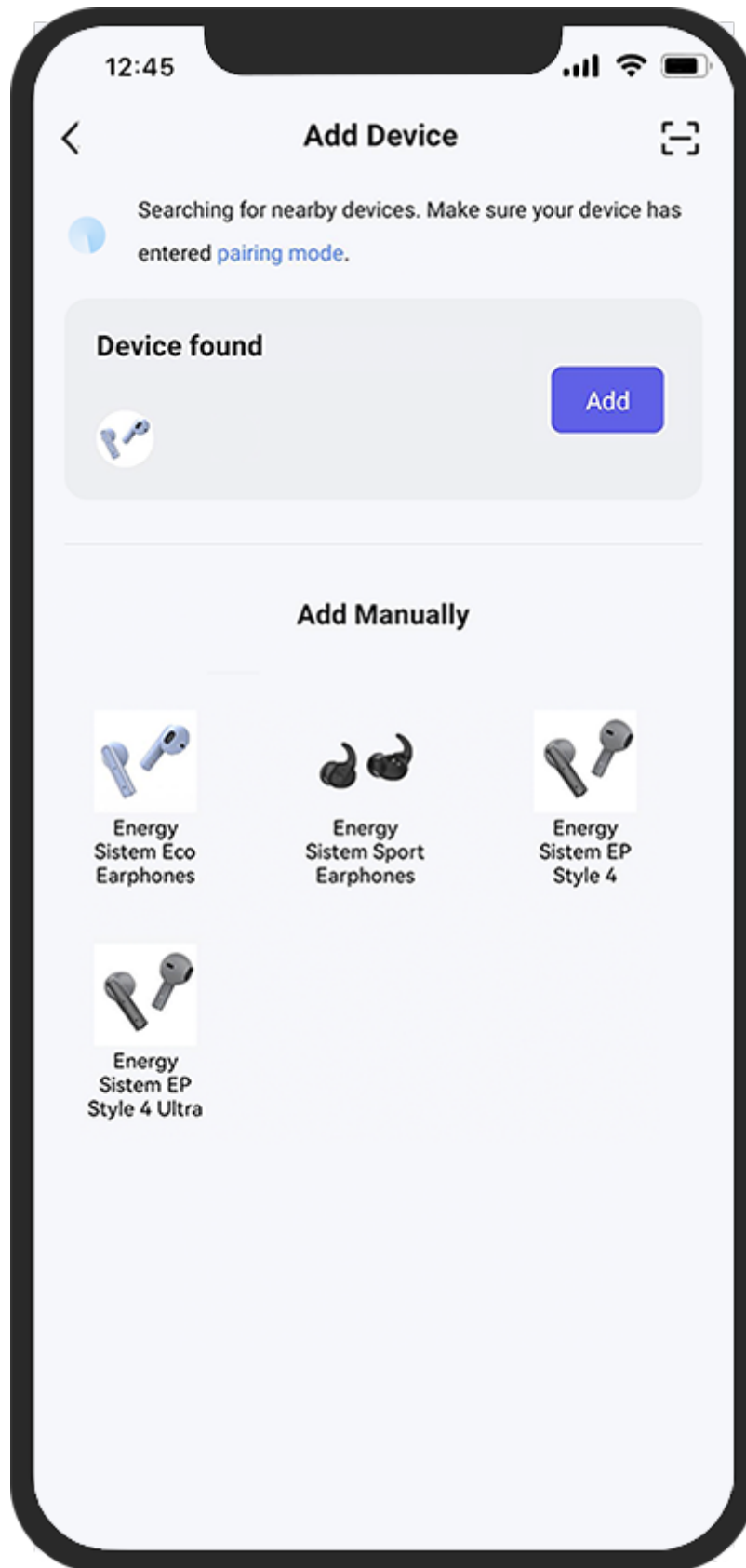

#### Manual pairing (alternative method)

There is an alternative method for manually pairing your earphones. To do so, select "Add" and follow the app's instructions for manual pairing.

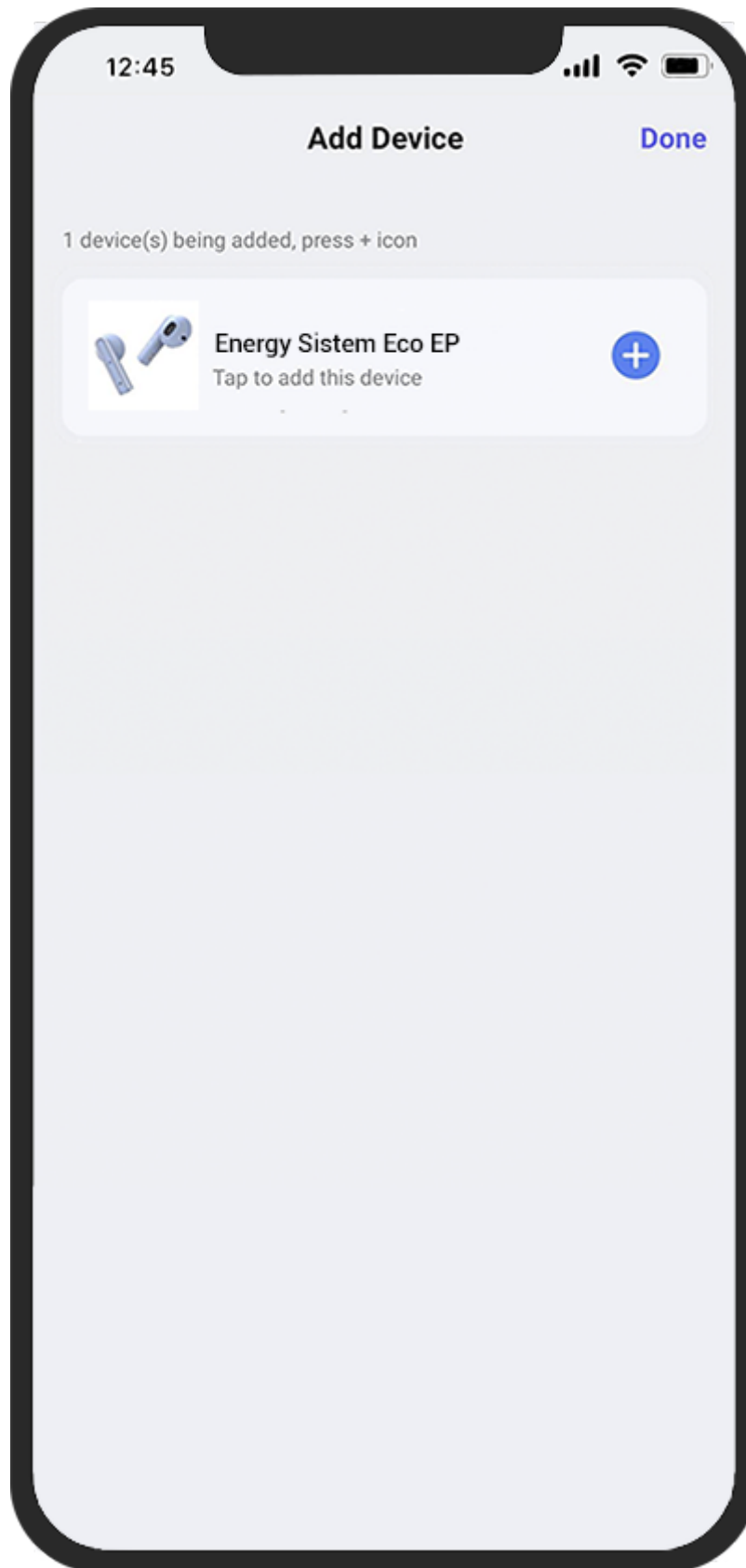

Finally, both automatic and manual pairing add your earphones to the application.

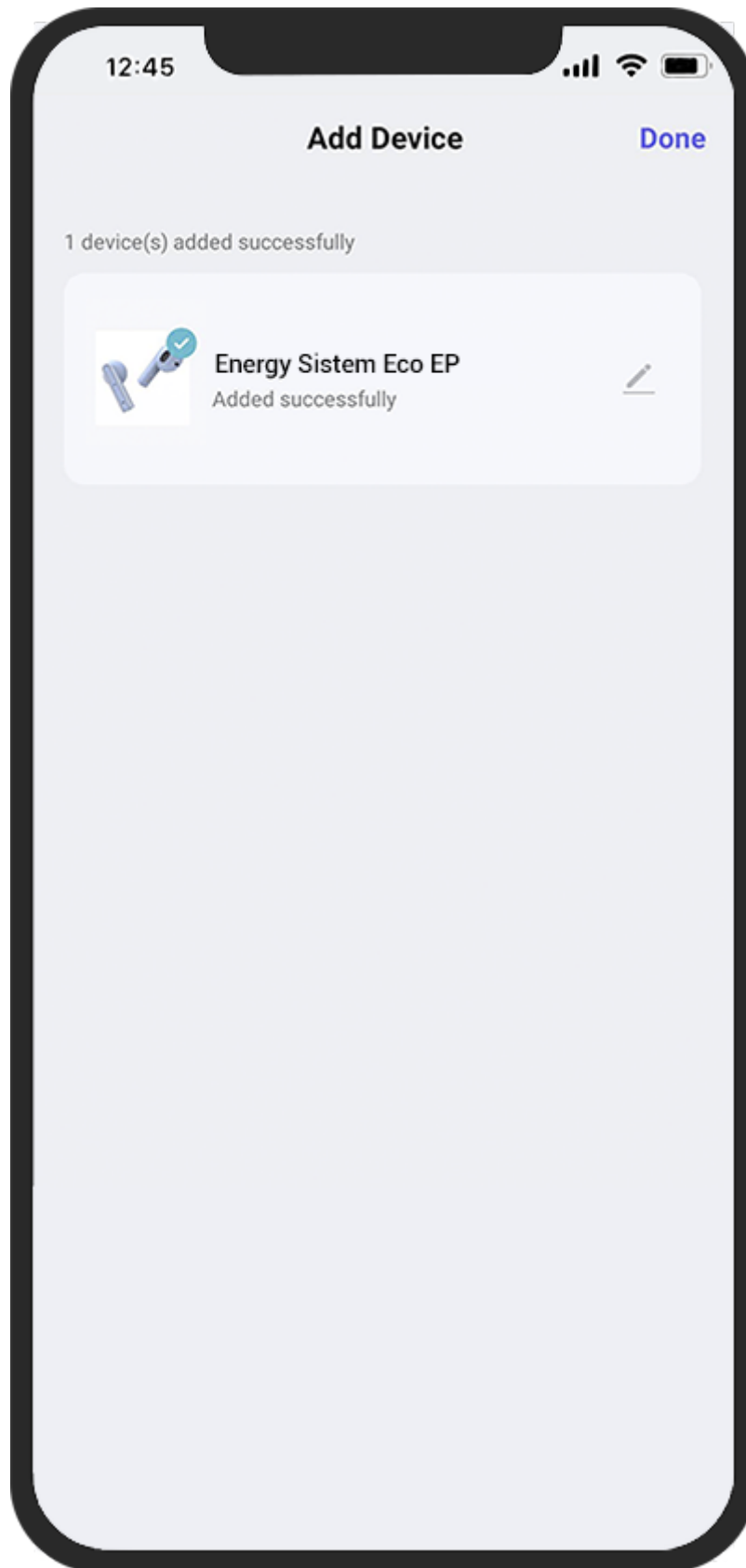

## Customising the product with ESmart Connect App

---

### Equalizer

The equalizer can be enabled or disabled from the home screen.

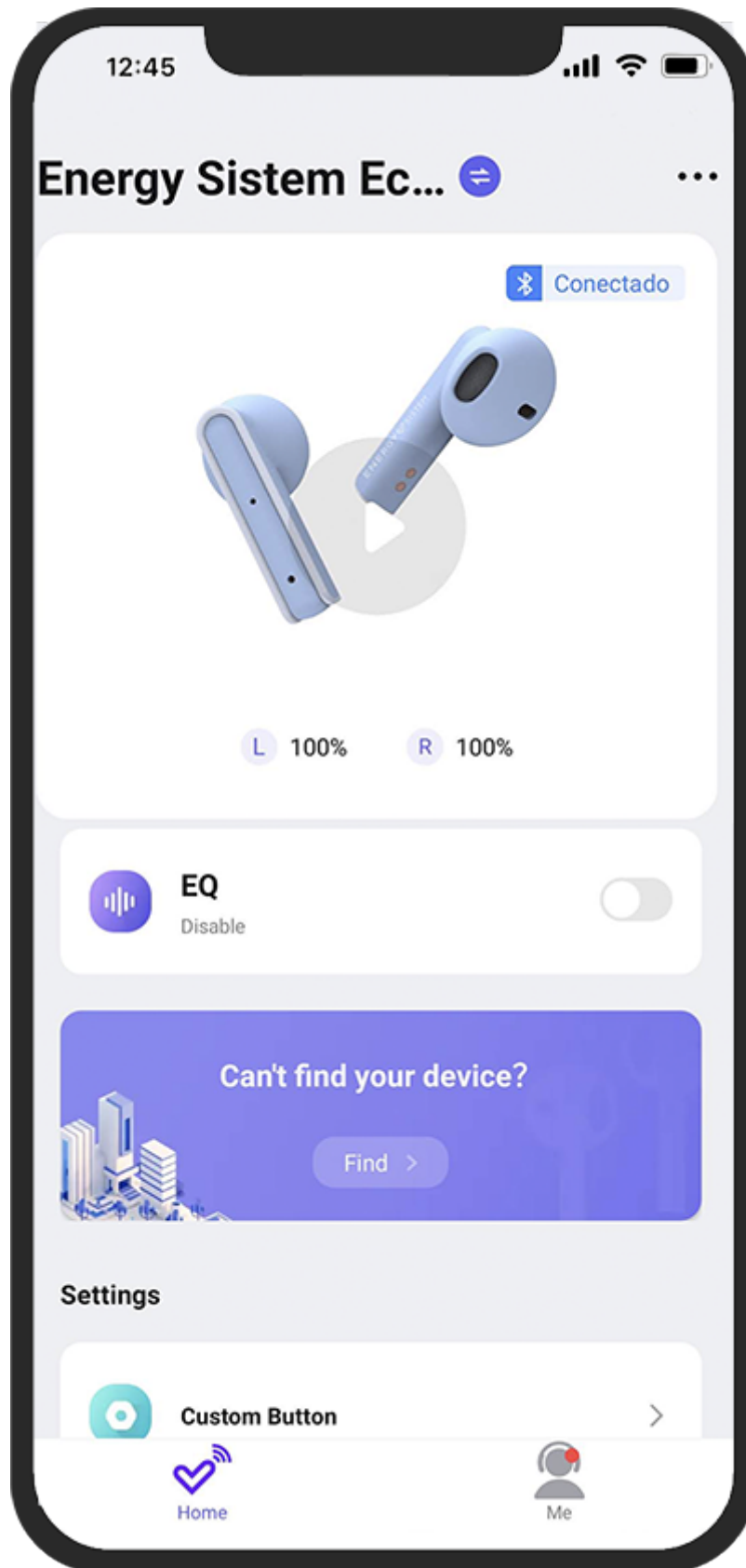

Enter the equalizer to select one of the 5 preset modes we have prepared exclusively for your device.

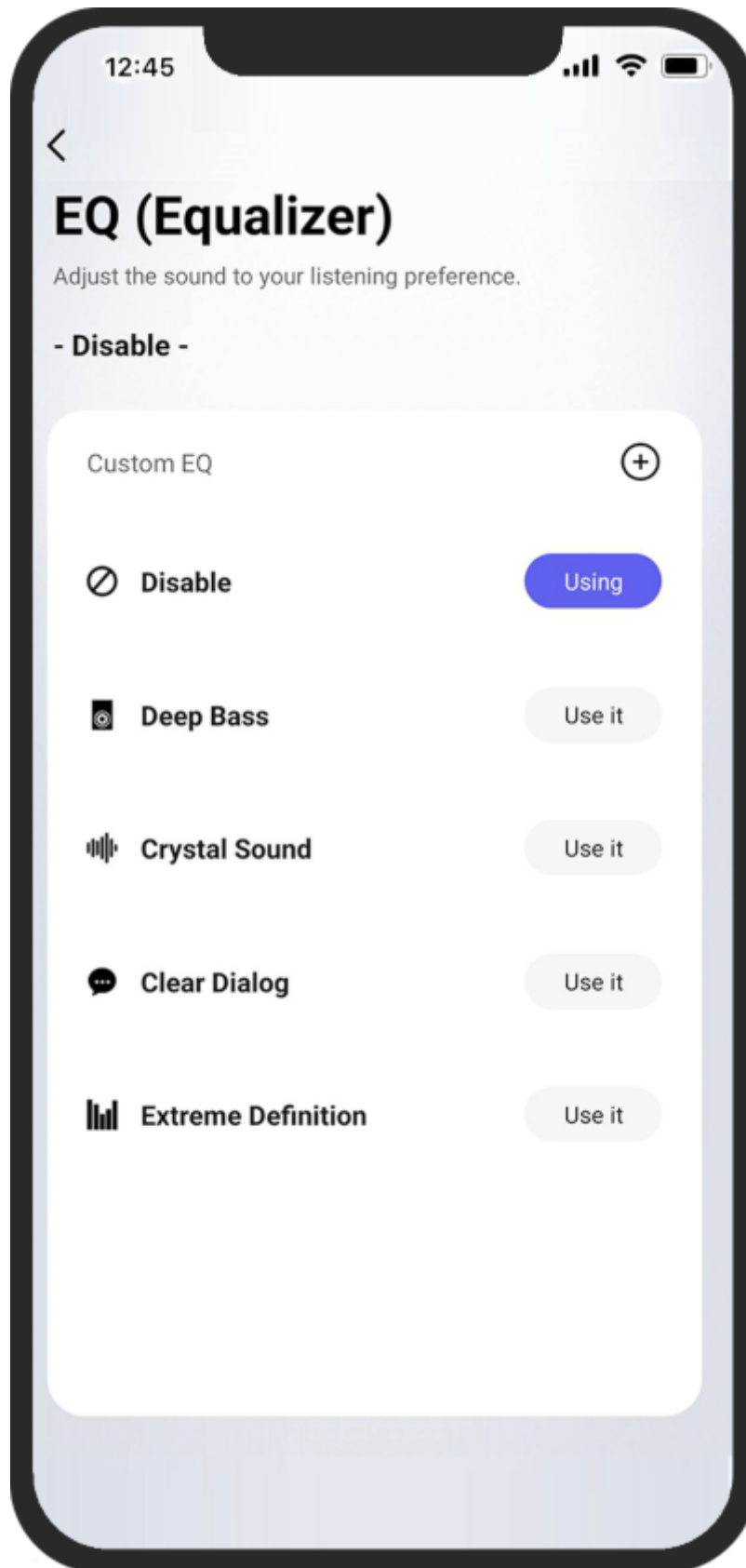

Tapping "+" will take you to a 10-octave band equalizer where you can adjust equalization per band, configuring it to your liking within a range of 24 dB.

Be sure to then tap Save and create a new preset in the list with your chosen name.

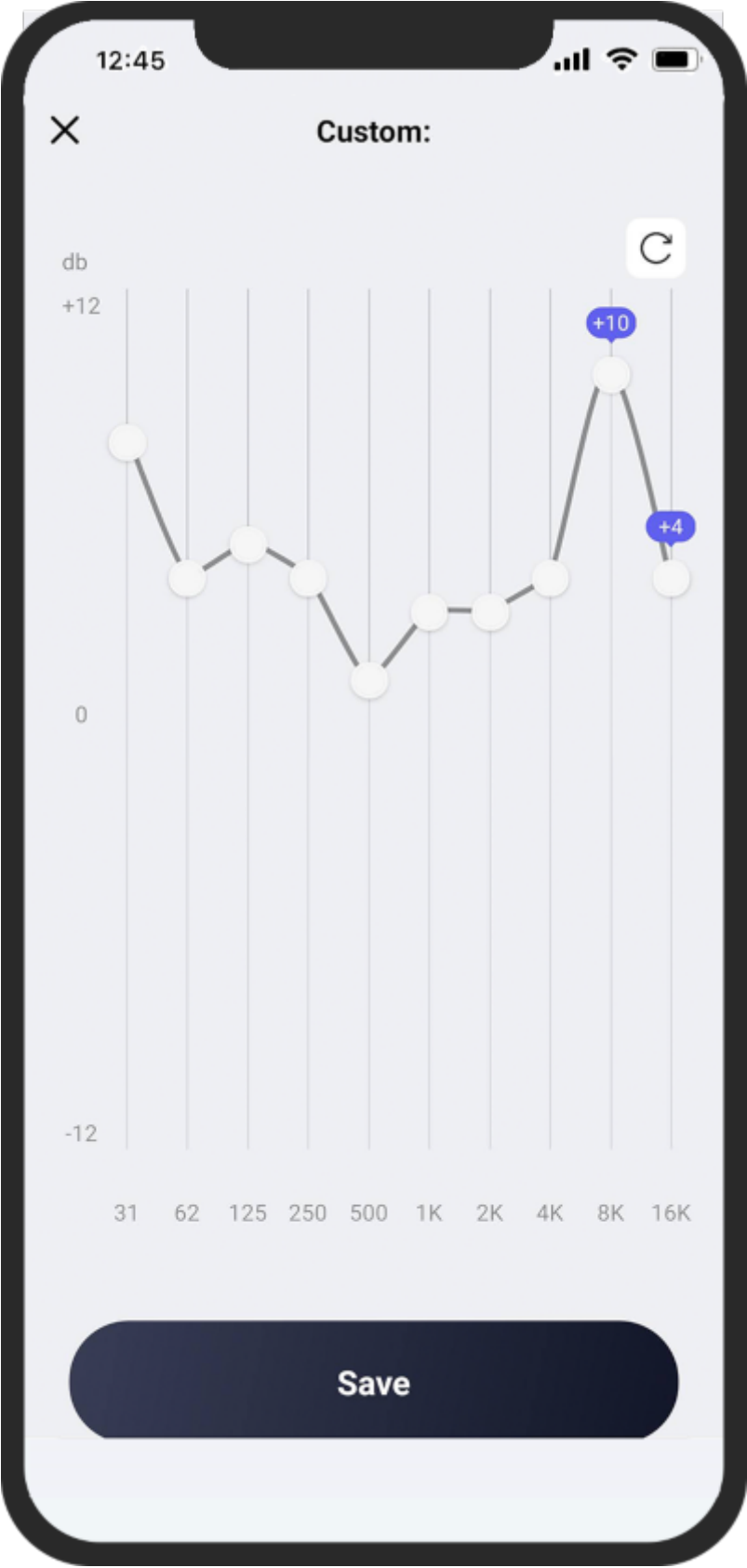

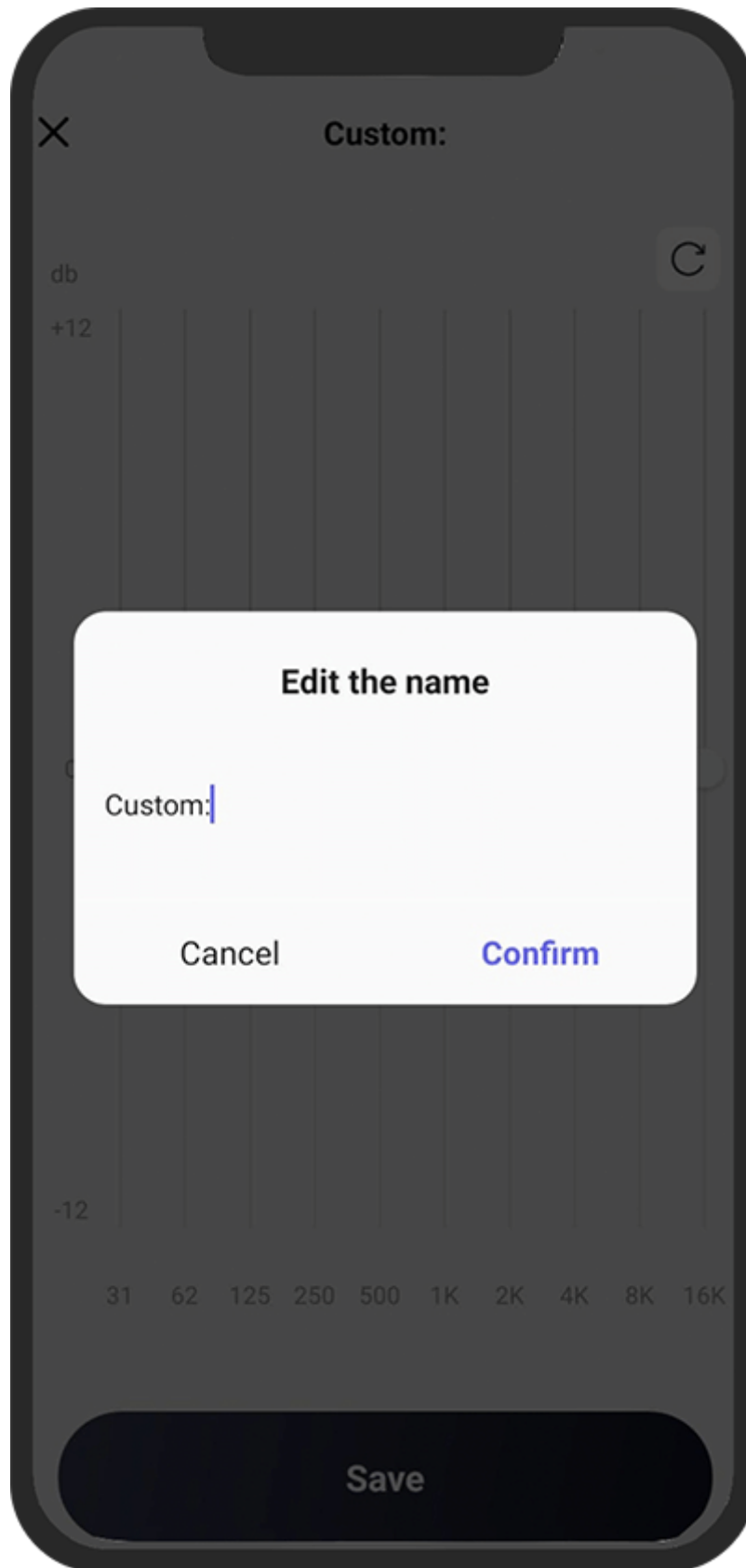

Have you lost your device? (Find my earbuds)

Go to the "Can't find your device?" section to see where your earphones were last connected to your mobile device.

If you cannot find your earphones and they are paired via Bluetooth® connection, tap the "Click to play" button to have them beep at full volume.

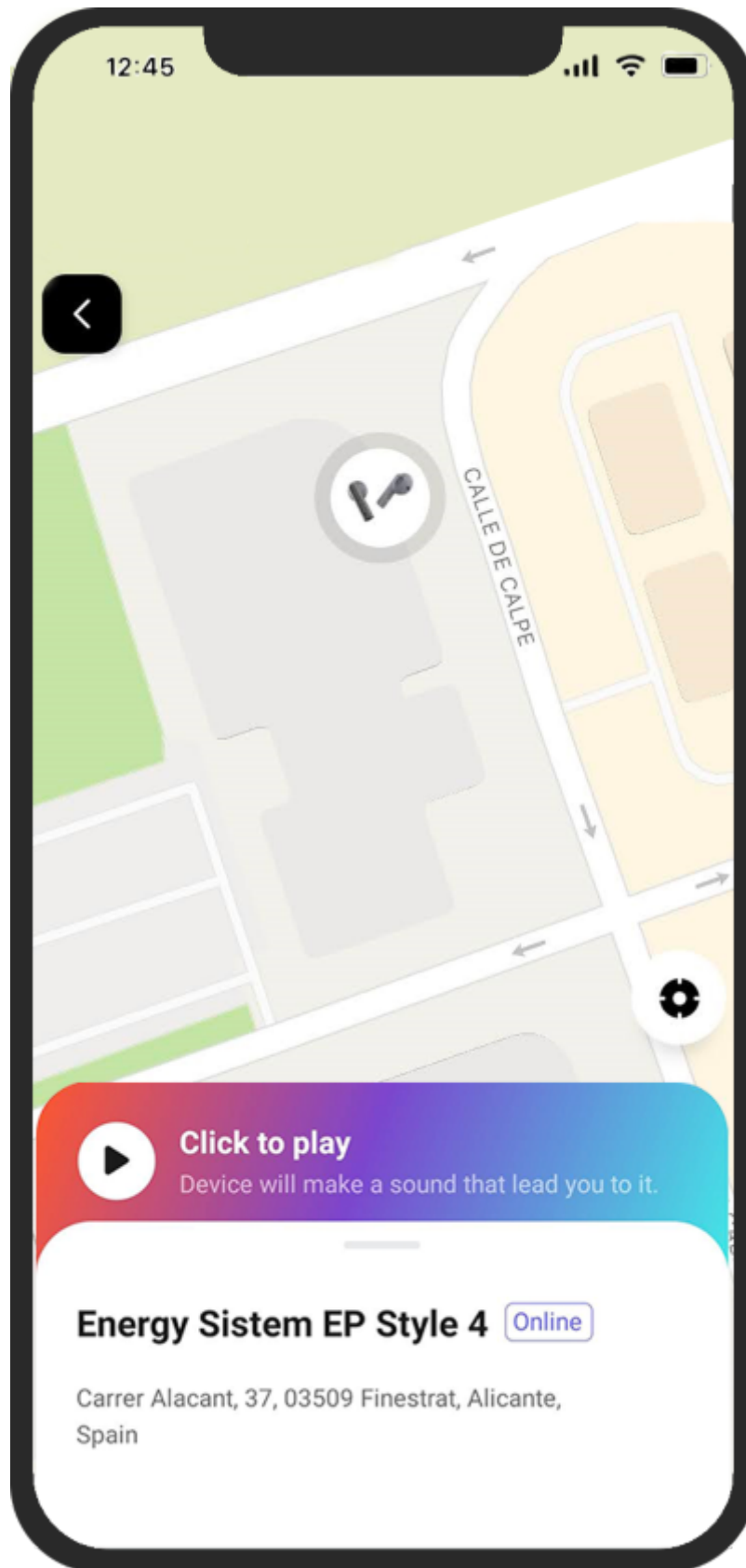

### Custom control

The ESmart Connect app lets you customise the functions of your earphones' touch controls. First enter the Custom Control section in the main menu.

Here you can choose the function you want the device to perform when holding down the touch buttons or tapping them 1, 2 or 3 times. You can also choose a range of functions for the left or right earbud.

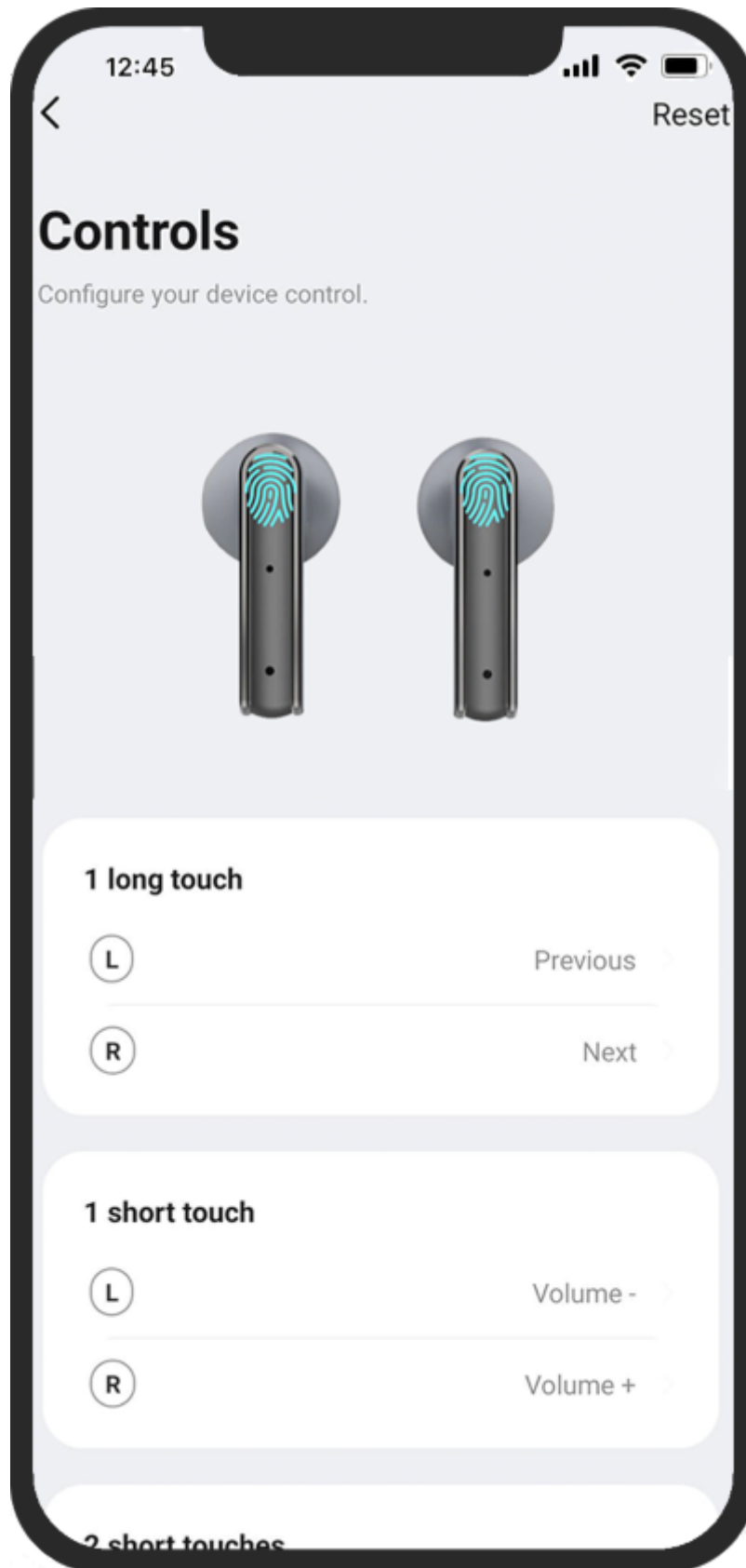

#### Proximity sensor

Senshi Eco Earphon have a built-in proximity sensor or Play/Pause sensor that pauses the music when you remove the earbud, and resumes it when you put it back in.

This function can be enabled and disabled using the switch in the app's main menu.

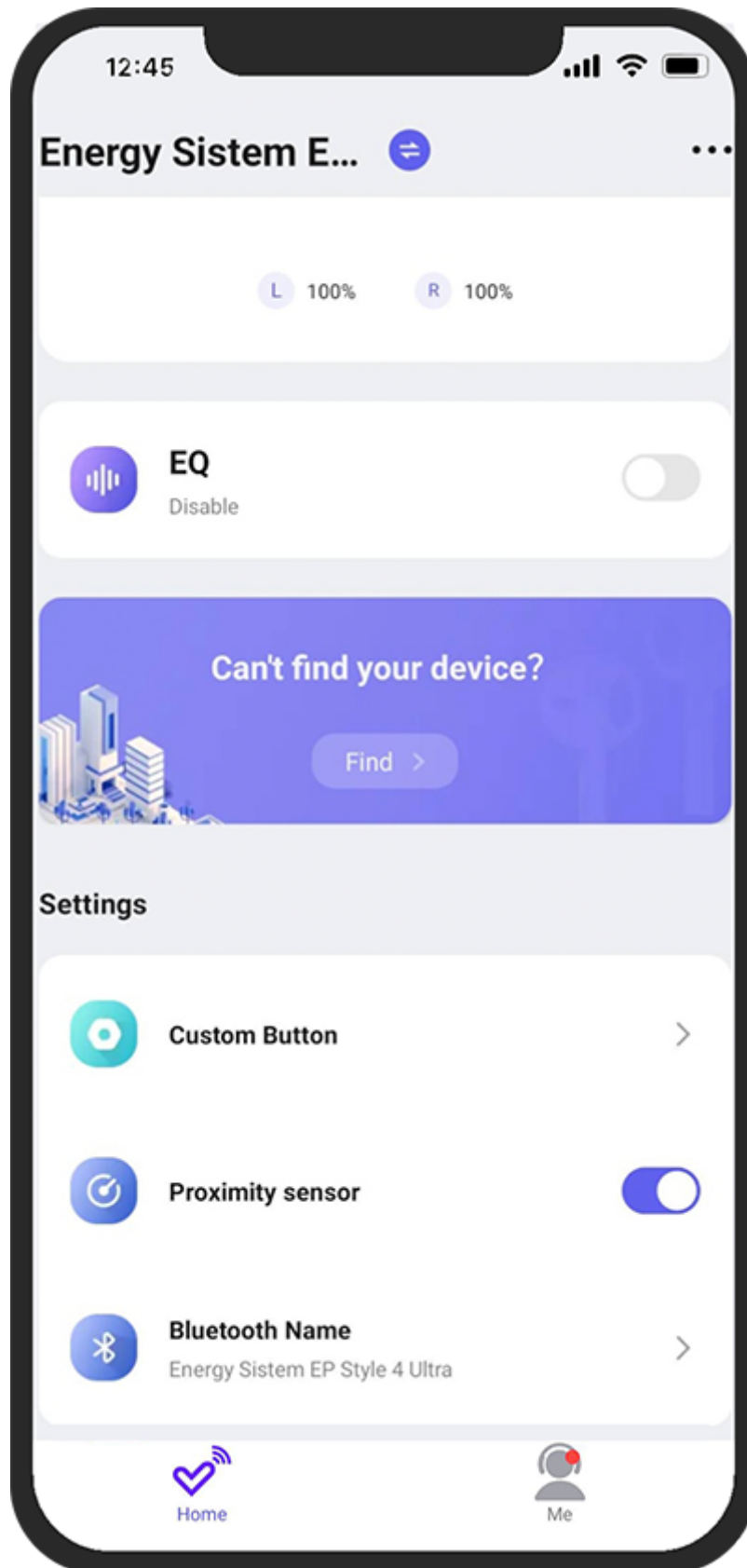

### Renaming the device

You can change your device's Bluetooth name in the "Bluetooth Name" section in the main menu. Bluetooth name is limited to 28 characters.

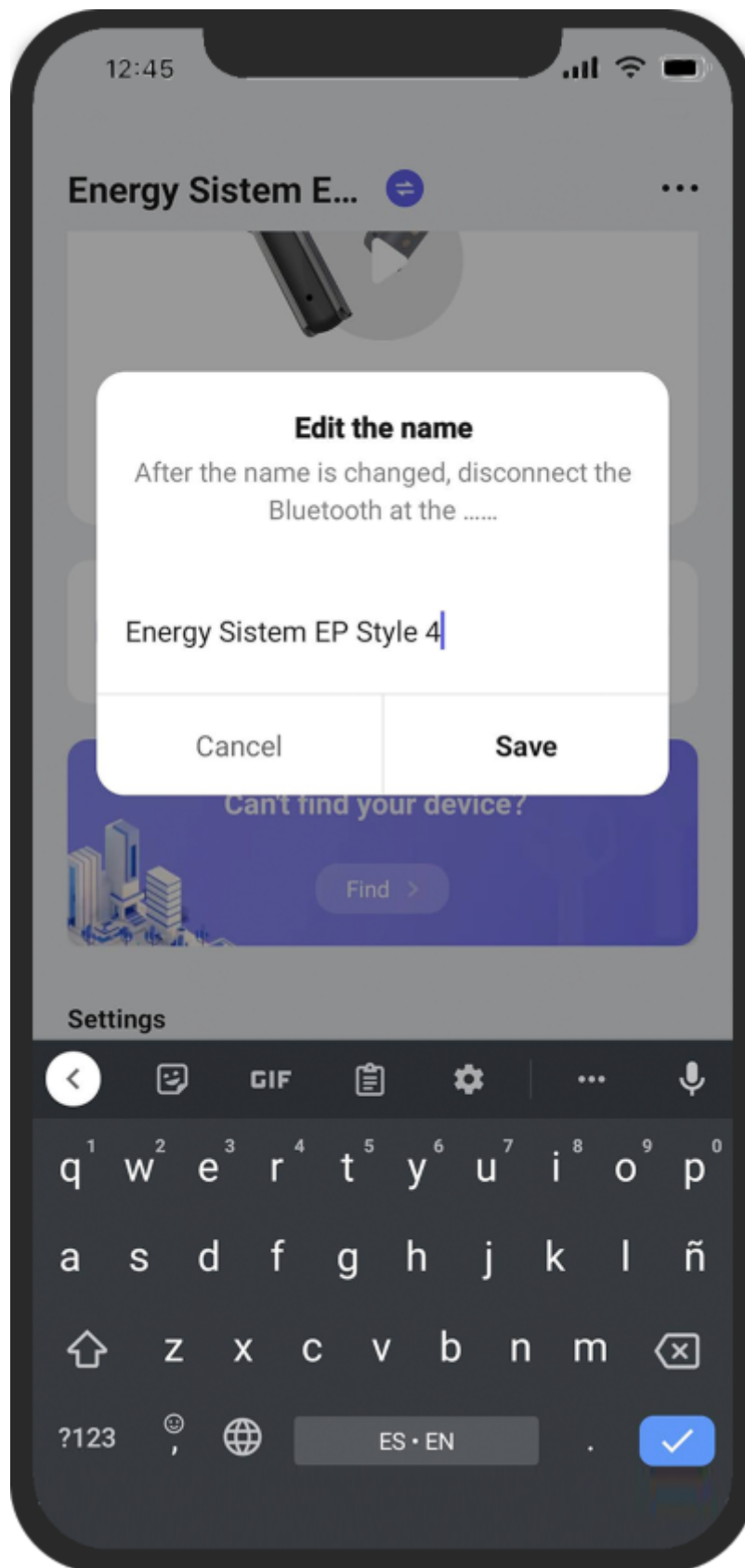

**NOTE** All changes made to the earphones via the app are saved in their Bluetooth chip, meaning your device will keep its configuration should you later connect it to another device that does not support the ESmart Connect app.

## Default settings

---

The settings below can be adjusted via the ESmart Connect App.

### Play/Pause

Tap the *Left multifunction button (1)* twice in a row to resume playback or pause the music.

### Volume +/Volume -

Tap the *Right or Left multifunction button (2 or 1)* to turn the volume up or down.

### Skipping to the next/previous track

Tap and hold the *Right or Left multifunction button (2 or 1)* for 2 seconds to skip to the next or previous track during music playback.

### Call control

You can control calls from the earphones themselves once your *Earphones True Wireless Style 4 Ultra* are paired with your smartphone.

#### Answering/Ending a call

To answer a call or hang up, tap the *Left (1) or Right (2) multifunction button* twice.

Tap and hold for 2 seconds to decline the incoming call.

### Using the Voice Assistant feature

You can interact with your smartphone's voice assistant using your *Senshi Eco Earphon*. To do so, tap the *Left multifunction button (1)* three times in a row. You can give the voice command after hearing the confirmation sound.

**Important note** All these functions can be changed via the ESmart Connect app.

## Charging the battery

---

### Earphones

When the battery level of the *Senshi Eco Earphon* is below 2%, you will hear a low battery warning sound. To charge the earphones' battery, put the earbuds back in the charging case. The *Charging indicator (charging case) (5)* flashes white and switches off once the charging process is complete.

### Charging case

When the battery level of the charging case is below 10%, the *Charging indicator (charging case) (5)* starts flashing. Plug the USB Type-C end of the provided cable into the *USB Type-C charging port (6)*, and the other end into a 5 V USB charging device. The *Charging indicator (charging case) (5)* lights up white as the battery charges. Once the charging process is complete, all LEDs will light up white.

**Caution:** Do not charge your headphones with fast charging adapters or dedicated laptop charging adapters, Because their output voltage exceeds 5V and the device may become unusable.

**Important:** We recommend not leaving neither your *Senshi Eco Earphon* nor your charging case unused for long periods of time with an empty battery. We recommend charging the battery at least once a month.

**Caution:** Do not charge your headphones with dedicated laptop charging adapters, Because its output voltage exceeds 5V and the device may become unusable.

## Restoring default settings

---

Follow the steps below to restore the earphones to default and reset their configuration:

- 1- Open the charging case lid or remove the earphones from the case, making sure they are not connected to the smartphone or any other Bluetooth device.
- 2- Tap the touch button in the earbuds 10 times in a row, both at the same time.
- 3- You can reconnect them to your Bluetooth device and use them as normally.

## FAQ / Troubleshooting

---

I can't link the earphones to the ESmart Connect app.

Press 5 times in a row on the touch button of the right or left earphone. You will hear a "beep". Close and reopen the app.

## Warranty

---

Find the full warranty terms and conditions at:

<https://www.energysistem.com/terms-warranty>

