







## Aroma Omni

---

**RECHARGEABLE ULTRASONIC DIFFUSER**  
DIFFUSEUR ULTRASONIQUE RECHARGEABLE

---



*Infuse your air with the vitality  
and well-being of nature*



# **TABLE OF CONTENTS**

BENEFITS OF DIFFUSING	1
PRODUCT FEATURES	2
SPECIFICATIONS	3
DIAGRAM OF PARTS	5
DIFFUSING INSTRUCTIONS	6
CHARGING INSTRUCTIONS	9
CARE AND MAINTENANCE	11
CAUTIONS	14
FCC & IC STATEMENTS	18
FAQS	20

## **BENEFITS OF DIFFUSING**

Diffusing is an easy, heat-free way to enjoy Saje's 100% natural diffuser blends.

This ultrasonic technology, combined with water and essential oils, produces negative ions and aromas that elevate your well-being.

When used with your favourite Saje diffuser blend, the ultrasonic diffuser's refreshing mist brings nature's goodness into your space, supporting balance and harmony.

Transform your surroundings with revitalizing air that's reminiscent of fresh mist off a waterfall. Add the Saje diffuser blend of your choice and enjoy fresh, inviting aromas anytime.

## **PRODUCT FEATURES**

- Uses an ultrasonic, heat-free system to disperse essential oil molecules into the air.
- Gently humidifies your space.
- Whisper-quiet operation and auto shut-off.
- Rechargeable, cordless functionality with a charging pad, a USB adaptor, and charging cable.
- Operates with adjustable LED light on or off.

## SPECIFICATIONS

PRODUCT NAME	Aroma Omni
INPUT VOLTAGE	USB DC 5V2A
OUTPUT VOLTAGE	5V
RATING POWER	10W
WATER TANK CAPACITY	4.1 fl. oz.   120 ml
MISTING DURATION	approx. 6 hrs continuous   approx. 12 hrs intermittent
MIST OUTPUT	approx. 0.507 fl. oz. (15 ml) per hour on continuous; approx. 0.20 fl. oz. (6 ml) per hour on intermittent
POWER BUTTON SETTINGS	continuous/intermittent/off
LIGHT BUTTON SETTINGS	light on/dim/off
CHARGING LIGHT INDICATOR	when plugged in: <ul style="list-style-type: none"><li>• red light: charging</li><li>• green light: fully charged</li></ul> unplug unit when fully charged



BATTERY CHARGE TIME	4-5 hours
COVERAGE AREA	up to approx. 500 sq ft
DIMENSIONS	(d) 4" x (h) 8.9" or (d) 102 mm x (h) 227 mm
NET WEIGHT	approx. 33.7 oz.   954 g
MAIN MATERIALS	ceramic and BPA-free plastic

## DIAGRAM OF PARTS

- A. MIST OUTLET
- B. CERAMIC COVER
- C. WATER TANK COVER
- D. WATER TANK
- E. MAXIMUM WATER LEVEL LINE
- F. CERAMIC DISC
- G. SECONDARY USB PORT
- H. POWER BUTTON
- I. LIGHT ON/OFF BUTTON
- J. CHARGING LIGHT INDICATOR
- K. AIR INLET & LED LIGHT
- L. CHARGING PIN
- M. USB CHARGING PAD
- N. MAIN USB PORT
- O. POWER ADAPTOR
- P. CHARGING CABLE

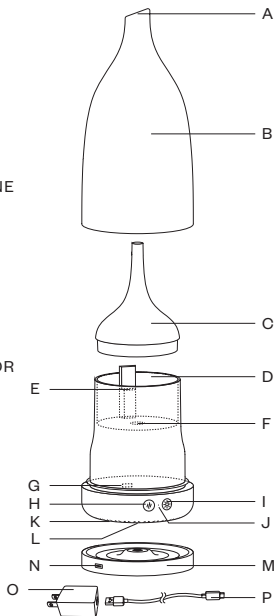

## DIFFUSING INSTRUCTIONS

1. Remove the ceramic lid from the unit to expose water tank and then remove the water tank cover.
2. Fill water tank with room temperature tap water to no higher than max. water level line (4.1 fl. oz. | 120 ml) by bringing water to the unit. If the water exceeds max. water level, the unit will not mist.
3. Add 10-15 drops (depending on preference) of your favourite Saje diffuser blend to the water. Tilting the unit can cause water to run into the diffuser's ventilation system and out the bottom — to ensure correct usage, always bring water to your ultrasonic diffuser and not the other way around.

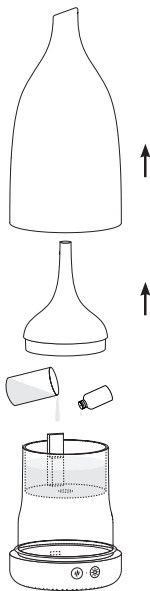

4. Place the cover back on the water tank before placing the ceramic lid on top of the unit.
5. Press and hold the power button for unit to turn on: once to mist continuously, twice for intermittent, and a third time to turn the unit off.
6. The light feature can be activated without the misting feature on. Press on the light button: once to turn on the light to high intensity, twice to change the light to medium intensity, and a third time to turn the light off.

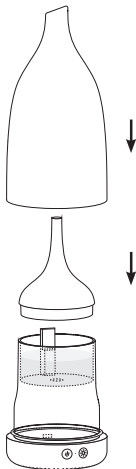

#### **BUTTON INDICATORS:**



*Press the Power button:*

**ONCE:** Continuous mist

**TWICE:** Intermittent mist

**THREE TIMES:** Unit off



*Press the Light button:*

**ONCE:** High intensity

**TWICE:** Medium intensity

**THREE TIMES:** Light off

7. Unit will shut off automatically after 6 hours (continuous setting) and 12 hours (intermittent setting), or when the diffuser is out of battery. Note that the water level remaining in the tank after shut-off will vary. For next use, fill the water tank to the max. water level line with a new water supply.
8. A filled unit should never be moved. Always wait until water reaches minimum levels to change diffuser's location; this will deter water from entering the ventilation system.
9. Use only Saje diffuser blends; using other oils may result in malfunction. For more information, see FAQs.

**PLEASE NOTE: RUN TIMES AND AMOUNT OF WATER LEFT IN THE TANK AFTER AUTO SHUT-OFF WILL VARY DUE TO CLIMATE, ENVIRONMENT, AND OTHER FACTORS. FOR OPTIMAL OPERATION, ENSURE MIST IS UNOBSTRUCTED BY OVERHANGING OBJECTS.**

**THE UNIT WILL REQUIRE CHARGING AFTER THE 6-10 HOUR RUNTIME.**

## CHARGING INSTRUCTIONS

1. Plug the USB cord into the charging pad and then connect it to the power adaptor. After, connect the power adaptor to an electrical outlet. Place the diffuser on the charging pad until fully charged, indicated when the light turns green.

**Caution: Only use the provided adaptor. Do not use a fast charge adaptor as this can result in damage to the unit and overheating.**

2. If the light indicator is red when the power button is pushed, the battery does not have any charge remaining. If the light is

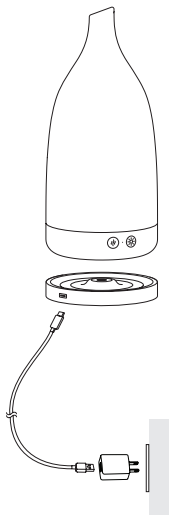

green when on charge, the charge is complete. To fully charge battery, the unit must be plugged in for approx. 4-5 hours while not in use.

**PLEASE NOTE: THIS UNIT CAN ALSO BE CHARGED DIRECTLY ON THE BASE OF THE UNIT INSTEAD OF THE CHARGING PAD, DEPENDING ON YOUR PREFERENCE.**

## CARE AND MAINTENANCE

- If the unit is knocked over while in operation, water could leak into the internal mechanism of the unit. If this occurs, unplug from power, empty water, and let unit dry out in well-ventilated area for at least three days.
- Turn off unit and unplug from the power adaptor prior to cleaning.
- When carrying the unit, always carry from the base and not from the lid.
- Remove cover and empty water from the water tank, carefully avoiding the air outlet.
- If required, use a clean, soft, damp cloth to wipe down exterior of unit.
- If oils are spilled on the diffuser's surface, clean immediately to prevent surface damage.
- Frequency of cleaning is dependent upon usage and types of diffuser blends used (i.e. how thick the



essential oils are in the diffuser blend).

- To clean inside water tank, pour a few drops of rubbing alcohol, Saje Diffuser Care Cleaner, or Saje Multi-Surface Cleaner into tank and wipe with a clean, soft cloth. Do not use vinegar or dish soap.
- White film build up on the inside of the unit is likely due to hard water. If this occurs, filtered or distilled water is recommended to prolong the life of the unit.
- To clean the disc, pour a few drops of rubbing alcohol onto a clean cotton swab and wipe the disc. The disc can be accessed by inserting the swab in the hole at the center/bottom of the water tank. Repeat this process with a new cotton swab until the cotton swab comes out clean.
- The ceramic disc should be kept clean of mineral deposits and other debris for optimal misting. Never use any sharp objects to clean the ceramic disc as this will damage the disc permanently.
- For optimum results, clean the water tank before changing diffuser blends.

- If required, wipe the charging pad only with a dry cloth.
- Unplug the charging base from the wall outlet when not in use for extended periods.
- Do not disassemble or attempt to repair unit. In the event of a problem, please contact 1-877-ASK-SAJE.

## CAUTIONS

- Do not leave battery on charge/plugged in for over 24 hours.
- Only use the power adaptor supplied with the device. Never operate the device if the power adaptor is damaged.
- Do not attempt to use the device if any part is damaged or broken.
- To reduce the risk of electric shock, do not attempt to service the device in any way other than as described in the “Care & Maintenance” section of this manual. Do not plug the unit into the wall socket with wet hands. In case of smoke, unusual aromas, noises, or other malfunctions, unplug the unit immediately and discontinue use.
- Make sure both the charging port and USB connector are dry and free of foreign matter in the USB connector port.
- Do not place unit directly below or beside electrical

outlets or other electrical devices that are susceptible to water damage.

- Do not place the unit on carpet or fabric surfaces that may obstruct the fan on the bottom of the unit, causing overheating.
- When moving the device, hold securely by the base. Always place the unit on a stable, level surface. Do not tilt, move, or attempt to empty or refill unit while in use.
- Do not touch the highly sensitive ceramic disc with bare fingers when the ultrasonic diffuser is in use or plugged in. To prevent clogging or damaging the ceramic disc when operating, use clean tap water at room temperature.
- Do not fill water tank directly from tap as water could spill into the internal mechanism and cause damage. Fill only to the water level line and do not overfill or immerse the unit in water.
- Do not pour water or other liquid into the air outlet. Ensure that no essential oils or water leak into the air

outlets on either side of the water tank. After each use, remove any liquid left in the water tank.

- Always turn off and unplug the device during maintenance or when not in use. Ensure that the power adaptor is not covered or blocked when plugged in; it must be able to dissipate the heat properly.
- Use only Sage diffuser blends in device. Other oils may contain fragrances, base oils, or synthetics that could result in malfunction. Some single note essential oils are also too thick or heavy for use in the ultrasonic diffuser. See FAQs for more information.
- Always keep unit out of reach of small children and pets.
- Do not place any metallic object on the charging pad to avoid damaging the disk.
- To prevent electrical shock or damage, do not spill water on the charging base. If a spill occurs:
  - With dry hands, immediately unplug the charging base from the wall outlet.
  - Allow the charging base to thoroughly dry before using it again.

- Always handle the charging base with dry hands. Do not place the charging base in wet or damp environments.
- When the charging pad is connected to power, do not touch the metallic part to avoid risk of electrocution.
- Do not use the charging base if there are any signs of corrosion or physical damage. Inspect the charging base regularly and discontinue use if any issues are found.
- Use only the specified charging adaptor provided with the product.
- Do not attempt to disassemble or modify the charging base.

## **FCC & IC STATEMENTS**

This device complies with Part 15 of the FCC rules. Operation is subject to the following two conditions:

1. This device may not cause harmful interference, and
2. This device must accept any interference received, including interference that may cause undesired operation.

This equipment has been tested and found to comply with the limits for a Class B digital device, pursuant to Part 15 of the FCC Rules. These limits are designed to provide reasonable protection against harmful interference in a residential installation. This equipment generates, uses, and can radiate radio frequency energy and, if not installed and used in accordance with the instructions, may cause harmful interference to radio communications. However, there is no guarantee that interference will not occur in a particular installation. If this equipment does cause harmful interference to radio or television reception, which can be determined by turning the equipment off and on, the

user is encouraged to try to correct the interference by one or more of the following measures:

- Reorient or relocate the receiving antenna.
- Increase the separation between the equipment and receiver.
- Connect the equipment into an outlet on a circuit different from that to which the receiver is connected.
- Consult the dealer or an experienced radio/TV technician for help.

Changes or modifications not expressly approved by Saje Natural Wellness Canada could void the user's authority to operate this equipment.

This device complies with Part 18 of the FCC Rules and ICES 001 (B). Although this product is tested and complies with FCC, it may interfere with other devices. If this product is found to interfere with another device, separate the other device and this product. Conduct only the user maintenance found in this instruction manual. Other maintenance and servicing may cause harmful interference and can void the required FCC compliance.



## FAQS

### **Q: WHAT IF MY UNIT DOES NOT TURN ON?**

- a. The battery may not be sufficiently charged. See operating instructions.
- b. The power adaptor may not be properly plugged in when charging. Ensure that the power adaptor is properly plugged into the DC power jack and the electrical source.

### **Q: WHAT IF MY UNIT DOES NOT MIST OR THERE IS ALMOST NO MIST?**

- a. There may not be enough water in the water tank. Ensure that the water tank is filled to the maximum water level line.
- b. The water level may be too high (higher than the maximum water level line). Turn off unit, pour out excess water, and try again.
- c. The ceramic disc may require cleaning. Please see “Care & Maintenance” instructions.

**Q: WHAT TYPE OF WATER SHOULD GO INTO MY ULTRASONIC DIFFUSER?**

To prevent clogging or damage to the unit or disc, it's recommended to use clean tap water at room temperature.

**Q: WHAT CAN I PUT IN MY ULTRASONIC DIFFUSER?**

We recommend using 100% natural Saje diffuser blends, as they have been carefully blended for safe and easy use in your ultrasonic diffuser. Other blends and oils may contain fragrances, base oils, or synthetics that have a thick and heavy consistency and could result in your unit's malfunction.

All Saje 100% Pure Single Note Essential Oils may be diffused, except the following:

- Ylang Ylang
- Patchouli
- Sandalwood
- Jasmine
- Rose

**Q: WHAT IF MY UNIT DOES NOT CHARGE?**

- a. Move the unit slightly on the base to be sure that the charging pin is properly connected to the charging pad.
- b. Make sure that the charging pad is correctly connected with the charging cable and the power adaptor.
- c. Only use the provided charging cable and power adaptor.
- d. Make sure that there is no foreign object on the charging pad, wipe it with a dry clean cloth if needed.
- e. Try charging it directly by connecting the USB cable to the unit USB port.

