



CT240 Telephone Controller

Installation Instructions and User Manual

1. Introduction

The CT240 telephone controller is designed to remotely control your home's thermostat. It is possible to command a temperature decrease (Unoccupied) during a prolonged absence or a temperature increase (Comfort) before you return home.

Depending on your thermostat's operating characteristics, it either connects to the Aube output (for most Aube models) or to the auxiliary output.

When the auxiliary output is not used to control a thermostat, it can be used to simultaneously control a load such as a water heater, lighting, etc.

Figure 1: Product Overview

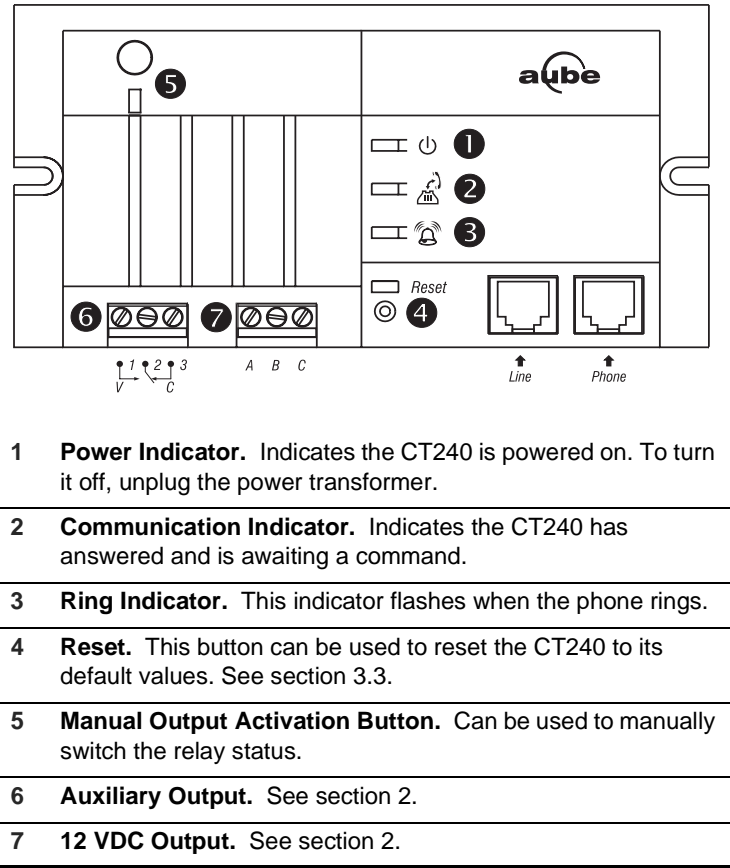

2. Installation

Any device connected to a telephone line must conform to the country's standards. The CT240 telephone controller meets:

- FCC68 standards for installation on the North American network.
- FDTBR21 standards for installation on the European network.

2.1 Included Parts

- One CT240 telephone controller
- One power transformer 120 V (North America) or 250 V (Europe)
- One 5 m (16 foot) telephone cable

NOTE: If you are using an answering machine, position the answering machine switch to ON before installing the CT240. Make sure that your answering machine answers after a minimum of 4 rings.

Figure 2: Answering Machine Switch

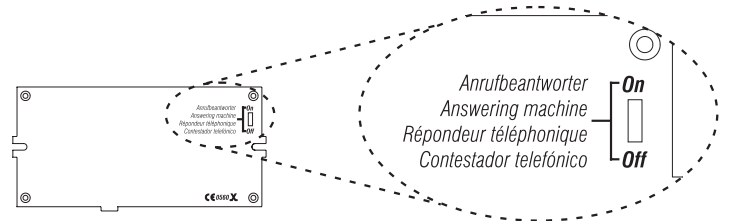
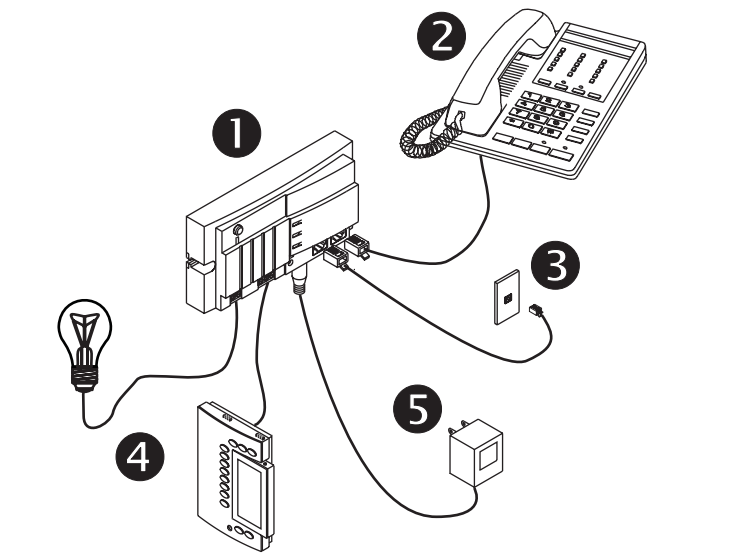

Figure 3: Typical Installation



- 1 Mount the CT240 near a telephone outlet.

NOTE: If you plan to connect a load having more that 30 volts on the auxiliary output, the CT240 must be installed inside a certified electrical box.

- 2 OPTIONAL. Connect your phone (or answering machine) to the PHONE connector of the CT240.
- 3 Connect one end of the telephone cable to the LINE connector of the CT240 and the other end to the telephone outlet in your home.
- 4 Connect the thermostat and load. Both outputs work simultaneously.

NOTE: Refer to your thermostat's electrical specifications (telephone interface) for the connection requirements.

- If your thermostat requires a 12 VDC signal to switch to Vacation setpoint, use the ABC output (FIGURE 4):
 - A and C terminals:
 - 0 VDC in Comfort mode
 - 12 VDC in Vacation mode

NOTE: 50 mA max. for parallel connection of Aube thermostats.

- If your thermostat requires a dry contact to switch to the Vacation setpoint, use the 123 output (FIGURE 5):
 - Load = terminals 2 and 3 (NC) (open = Vacation)
 - Thermostat = terminals 1 and 2 (NO) (closed = Vacation)

- 5 When all connections have been made, connect the power transformer to the 9 V outlet of the CT240 and the other end to the wall electrical outlet. The power indicator light is ON when the circuit is powered.

Figure 4: 12 VDC Signal to thermostat

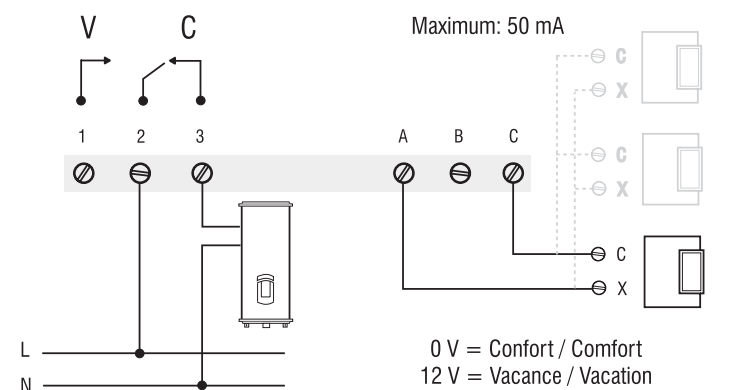
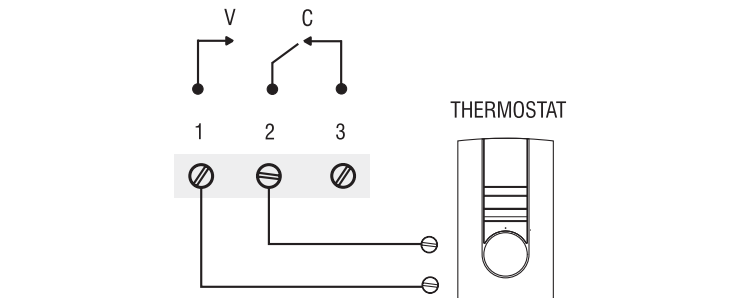

Figure 5: Dry contact to thermostat



3. Operation

NOTE: The CT240 will automatically hang up if no key is pressed during the 30 seconds following the CT240 answering a call.

Default values:

- Access code = 1234
- Number of rings = 4

3.1 With or Without an Answering Machine

1 BEGIN A SESSION (without answering machine)

Dial your phone number	
Wait for the number of rings...	
CT240 answers	⌋ Beep • Beep • Beep ⌋

1 BEGIN A SESSION (with an answering machine)

Dial your phone number	
Let it ring once and hang up	
Wait 10 seconds...	
Dial your phone number again within the next 30 seconds	
CT240 answers (1st ring)	⌋ Beep • Beep • Beep ⌋

2 ENTER YOUR ACCESS CODE

Enter your 4-digit access code (default: 1234)	⌋ Beep • Beep ⌋	Accepted
	⌋ Beeeep ⌋	Error

3 OUTPUT STATUS/MODIFY STATUS

Press 1 for output status	⌋ Beeeep ⌋	Comfort
Press * to change status	⌋ Beep • Beep ⌋	Vacation

3 MODIFY THE ACCESS CODE

Press # 8	⌋ Beep • Beep ⌋	
Enter your new 4-digit access code	⌋ Beep • Beep ⌋	
Enter the access code again	⌋ Beep • Beep ⌋	Accepted
	⌋ Beeeep ⌋	Error

3 MODIFY THE NUMBER OF RINGS (phone only)

Press # 9	⌋ Beep • Beep ⌋	
Enter the number of rings after which the CT240 will answer (between 1 and 9)	⌋ Beeeep ⌋ x the number of selected rings	

4 END SESSION

Press # 0 to end the session	
------------------------------	--

3.2 Manual Output Activation Button

The button, located on the upper-left corner of the CT240, can be used to manually switch the relay status. This option is not available while the CT240 is answering a telephone call.

The light is ON when the auxiliary output is in Vacation mode (terminals 1 and 2 closed)

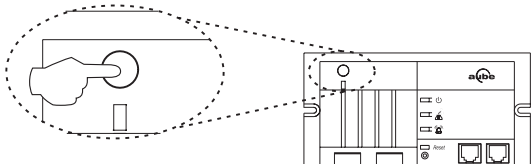

3.3 Reset to default values

Insert a pointed object (e.g. paper clip) in the hole located under the Reset light. The light will flash 3 times to indicate that the CT240 has been reset:

- number of rings: 4
- access code: 1234
- Output status:
ABC: Terminals A and C: Comfort
123: Terminals 1 and 2: opened, Terminals 2 and 3: closed

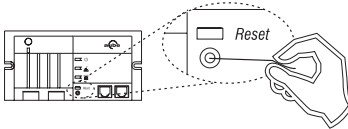

4. Technical Specifications

Power supply: 9 VAC / 60 Hz (50 Hz Europe)

Output (ABC): 0 VDC = Comfort mode / 12 VDC = Vacation mode

Maximum load for parallel connection of Aube thermostats: 50 mA

Auxiliary output (123): SPDT with following capacity:

- 5 A / 30 VAC inductive / Power Factor: 0.4
- 10 A / 30 VAC resistive (if installed in a certified electrical box)
- 10 A / 240 VAC resistive (if installed in a certified electrical box)
- 1/2 HP / 120 VAC motor (if installed in a certified electrical box)
- 1 HP / 240 VAC motor (if installed in a certified electrical box)

Protection: Class II

Access code (default): 1234

Number of rings (default): 4 rings

Memory protection: In case of power failure, access code and output status are protected.

Phone certification standard:

- FDTBR21: European telephone network
- FCC68: North American telephone network

Approvals:

- c UL us (North America)
- CE (Europe)

Dimensions (H W D): 2.7 x 5.4 x 1.2 in. (69 x 137 x 31 mm)

5. Warranty

Resideo warrants this product, excluding battery, to be free from defects in workmanship or materials, under normal use and service, for a period of three (3) years from the date of first purchase by the original purchaser. If at any time during the warranty period the product is determined to be defective due to workmanship or materials, Resideo shall repair or replace it (at Resideo's option).

If the product is defective,
(i) return it, with a bill of sale or other dated proof of purchase, to the place from which you purchased it; or

(ii) Customer Care will make the determination whether the product should be returned to the following address: Resideo Return Goods, 1985 Douglas Dr. N., Golden Valley, MN 55422, or whether a replacement product can be sent to you. This warranty does not cover removal or reinstallation costs. This warranty shall not apply if it is shown by Resideo that the defect was caused by damage which occurred while the product was in the possession of a consumer.

Resideo's sole responsibility shall be to repair or replace the product within the terms stated above. RESIDEO SHALL NOT BE LIABLE FOR ANY LOSS OR DAMAGE OF ANY KIND, INCLUDING ANY INCIDENTAL OR CONSEQUENTIAL DAMAGES RESULTING, DIRECTLY OR INDIRECTLY, FROM ANY BREACH OF ANY WARRANTY, EXPRESS OR IMPLIED, OR ANY OTHER FAILURE OF THIS PRODUCT.

Some states do not allow the exclusion or limitation of incidental or consequential damages, so this limitation may not apply to you.

THIS WARRANTY IS THE ONLY EXPRESS WARRANTY RESIDEO MAKES ON THIS PRODUCT. THE DURATION OF ANY IMPLIED WARRANTIES, INCLUDING THE WARRANTIES OF MERCHANTABILITY AND FITNESS FOR A PARTICULAR PURPOSE, IS HEREBY LIMITED TO THE THREE YEAR DURATION OF THIS WARRANTY. Some states do not allow limitations on how long an implied warranty lasts, so the above limitation may not apply to you.

This warranty gives you specific legal rights, and you may have other rights which vary from state to state. If you have any questions concerning this warranty, please write Resideo Customer Care, 1985 Douglas Dr, Golden Valley, MN 55422.



resideo Resideo Technologies, Inc.
1985 Douglas Drive North, Golden Valley, MN 55422
www.resideo.com 400-240-001-B M.S. Rev. 05-20 | Printed in United States

© 2020 Resideo Technologies, Inc. All rights reserved.
This product is manufactured by Resideo Technologies, Inc. and its affiliates.