

User Manual
JR-CB1 Wireless Receiver

Product diagram

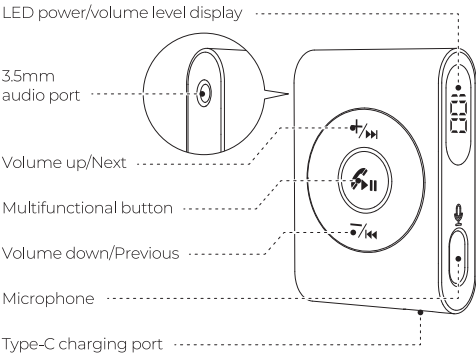

Basic parameters

Name: Wireless Receiver
Model: JR-CB1
BT version: V5.3
Supported protocols: HSP/HFP/A2DP/AVRCP
Audio decoding: SBC
Transmission distance: 12m
Frequency response range: 20Hz-20kHz
Microphone sensitivity: -38±2dB
Working voltage: 3.0~4.2V
Battery capacity: 300mAh
Music time: 22h (70% volume)
Talk time: 16h (70% volume)
Charging time: 2h
Standby time (connected): 27h
Charging input: 5V=1A
Product size: 51.4mm*35mm*13.4mm
Net weight: 30g

Packing list

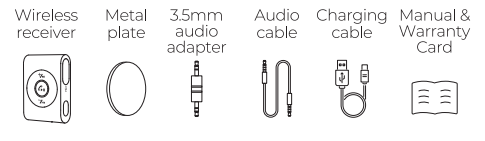

Pairing operation

1. Press and hold the multifunctional button for 2s, the red, green, orange and blue lights, which form a light ring, will keep on for 1s simultaneously, which means the receiver is turned on. When the red, green, orange and blue lights of the light ring start to flash alternately in turns, it means the receiver is ready for pairing.

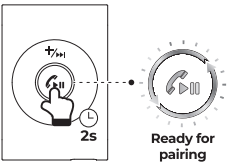

2. Turn the phone's BT function on, search for the BT device "JR-CB1".

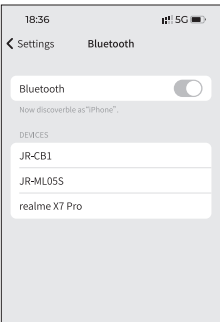

3. Connect the phone with the device "JR-CB1".

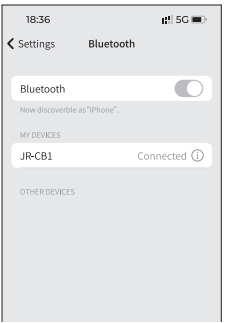

Ready for pairing



4. Plug one end of the audio adapter into the wireless receiver.

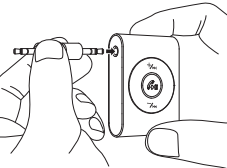

Connected



5. Plug the other end into the 3.5mm port of car audio system.

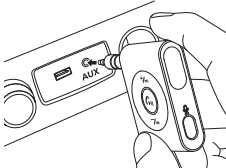

6. Switch the car audio system to AUX mode, you can start to use the wireless receiver to enjoy music or answer calls.

Metal plate using method:

1. Remove the protective film.



2. Stick the metal plate onto dashboard.

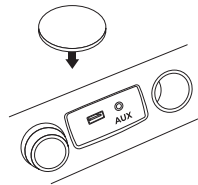

3. Put the wireless receiver onto the metal plate.

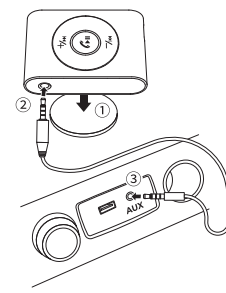

Common operations

1. Turn on/off

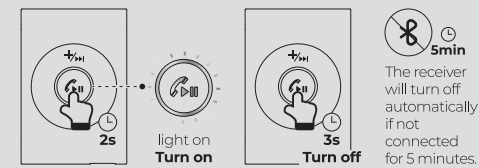

2. Music function

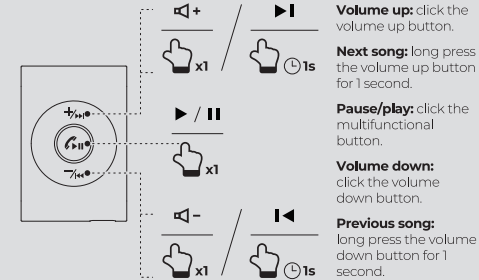

3. Activate Siri

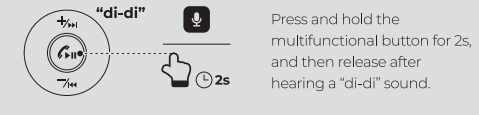

4. Call function

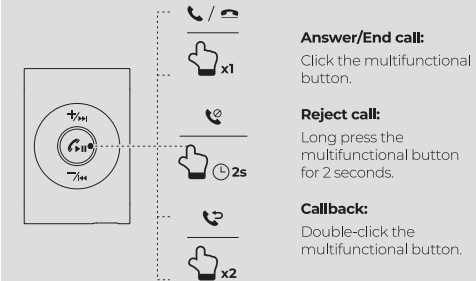

5. Restore factory settings



Prompt tone instructions

Turn on	"doo-doo-doo" sound in rising tone
Turn off	"doo-doo-doo-doo" sound in falling tone
Connected	"doo-der" sound.
Disconnected	"doo-doo-doo" sound in falling tone
Low battery warning	"di-di-di" sound every 60s
Call reminder	Synchronize with the ringtone for iOS system; or "doo-" "doo-" "doo-" sound for Android system that cannot synchronize the ringtone.
Siri activated	"di-di" sound

Receiver indicator lights

Turn on	The red, green, orange and blue lights of the light ring keep on for 1s simultaneously, and the nixie tube power display keeps on for 3s
Turn off	The red, green, orange and blue lights of the light ring keep on for 1s simultaneously, and the nixie tube power display flashes 3 times
Ready for pairing	The red, green, orange and blue lights of the light ring flash alternately in turns
Connected	The red, green, orange and blue lights of the light ring flash slowly in breathing light mode
Low battery	When residual power is lower than 3.1V, the ones digit of the nixie tube power display will flash
Charging	The ones digit of the nixie tube power display flashes
Fully charged	The nixie tube power display shows "100" and keeps on

FAQ

Q: Why can't the receiver be connected?
A: ① Please delete the connected device name "JR-CB1" from your mobile phone's BT list.
② Turn off the phone's BT function.
③ Turn off the receiver, and then turn it on again. Observe the light ring to see whether the receiver is ready for pairing.
④ If so, please restart the phone's BT function, and then search and pair with it again.
⑤ If the light ring flashes slowly in breathing light mode, it means the receiver is already connected to another device. You can disconnect it or 5-click the multifunctional button to restore factory settings, and then restart the receiver for reconnection.

Q: Why is the sound of the receiver too low?

A: ① The playback channel of the mobile phone may not be turned on. Please turn your phone's BT function on, click the icon on the right side of the connected earphones to turn on the "media channel and call channel".
② Please open your phone's "Settings" interface, and check if there is a maximum volume limit on the phone.
③ The volume up/down control of the receiver and the mobile phone are operated separately due to different settings of mobile phones (such as Android). Please adjust the volume of both the mobile phone and the receiver according to the settings of the mobile phone.

Q: Why does jamming, discontinuity, noise or current sound occur when listening to songs or talking via the receiver?
A: ① Please check whether the receiver is in low battery condition, if so, the current sound or noise may be caused by it.
② The receiver's signal may be disconnected because of the long distance between the receiver and connected device. Please keep them within 12m distance.
③ The receiver's signal may be interfered when being used in an environment with strong interference. Please make sure there's no large shield, metal partition or large interference source around you.
④ Please make sure the mobile phone's signal and network are in good condition, in case of poor signal or network cache problems, jamming or discontinuity will occur when listening to songs or talking.
⑤ Please check whether the audio cable or port is damaged; insert the audio cable to its place or replace a new one.

Q: Why can't the receiver be recharged?

A: ① The charging port and cable may not be connected properly, please pull the cable out and plug it in again repeatedly to make sure it is well connected.
② Please use adapters that conform to national/regional safety standards together with the included charging cable to charge the receiver. Chargers with excessive power may be incompatible or damage the receiver's battery.

Q: Why the receiver's digital display has error?

A: ① All electronic products have self-power consumption problem. After being fully charged, it is normal for the product to show a less than 100% power in its first startup.
② Due to current loss and voltage drop phenomenon during the use of electronic products, if the power of the product is used up, when you restart or recharge it after a period of time, it is normal for the product to show that part of the power is restored.

Safety Criterion

- Please follow the instructions, do not disassemble the product or refit it for any reason, otherwise it may break down or burn down.
- Do not immerse it in any liquid or wash it with water.
- Please use adapters that conform to national/regional safety standards together with the included charging cable to charge the receiver, otherwise the receiver's battery may be damaged or cause safety problems.
- Please use and store it in normal temperatures; too low or too high temperature (below 0°C or above 45°C) is not permitted.
- Do not block the openings of the receiver, such as charging port, audio port and microphone, etc.
- Do not use it under thunderstorm which may lead to abnormal performance and signal interruption.