

Southwark mast light

INSTRUCTIONS

INCLUDED

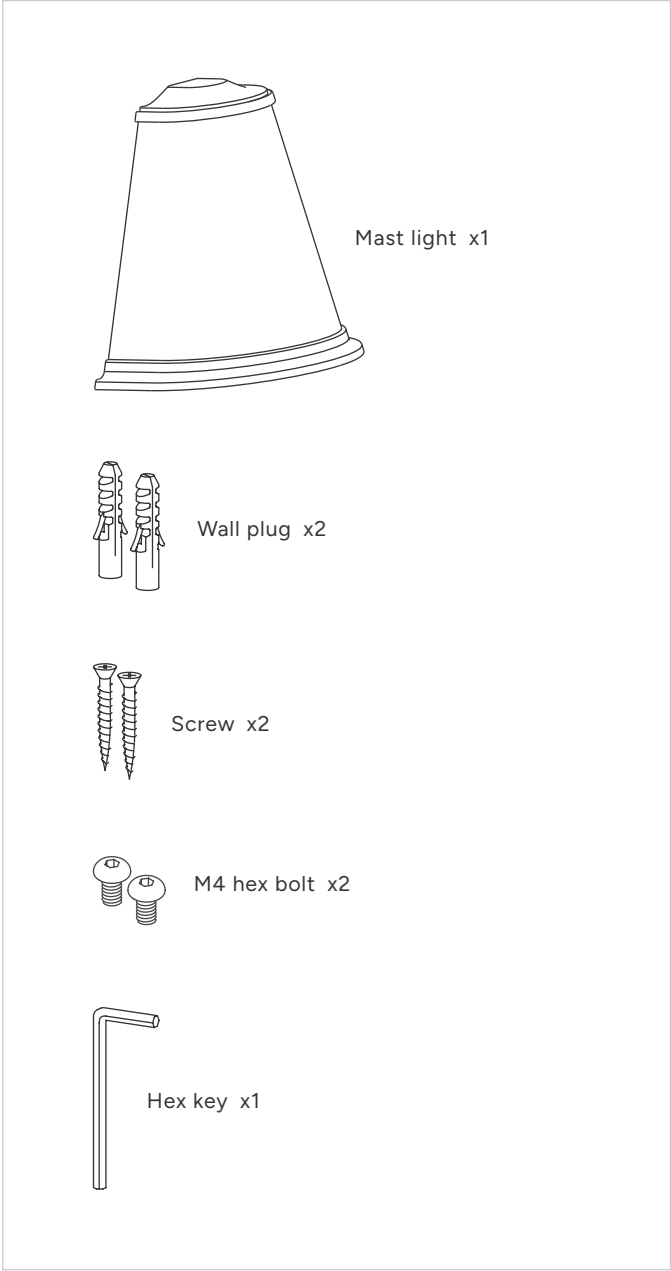

Location	Exterior
Class	Class I
IP rating	IP56
Driver required	No
Fire rating	No
Cable length	N/A
Bulb type	GU10
Max wattage	8W
Bulb included	No
Switched	No
Dimmable	Bulb dependent
Rated voltage	230V-250V~
Rated frequency	50-60Hz

This product must be installed in dry conditions by a qualified electrician. Turn off electrical supply to circuit before installation.

Southwark mast light instructions

TOOLS YOU'LL NEED

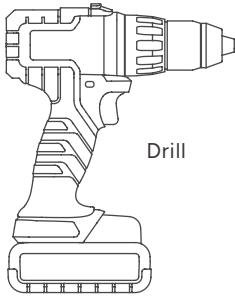

Drill



6mm drill bit

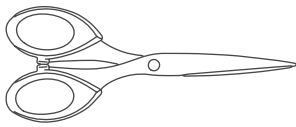

Clippers or scissors

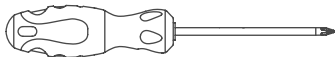

Crosshead screwdriver

Southwark mast light instructions

1

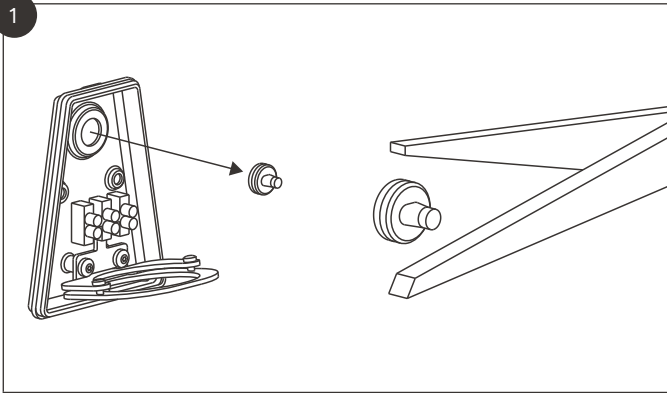

Remove the grommet to cut off the tip.

2

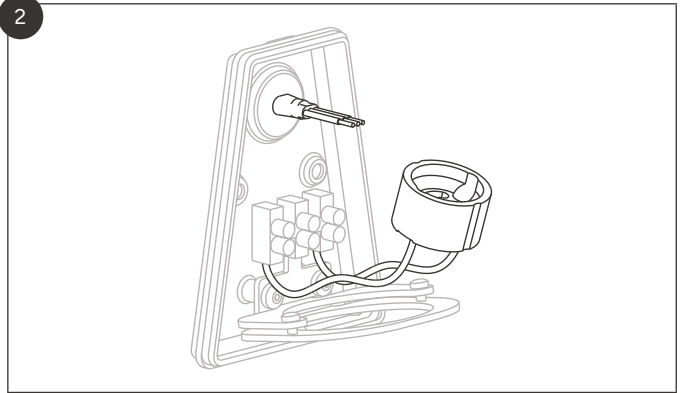

Replace the grommet in the base and push the wires through it. **Important:** use insulated cable and make sure the outside layer goes through the grommet.

3

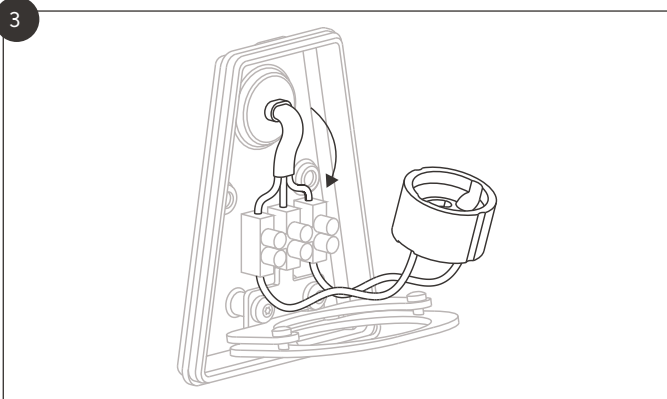

Consult a qualified electrician to wire in the light.

4

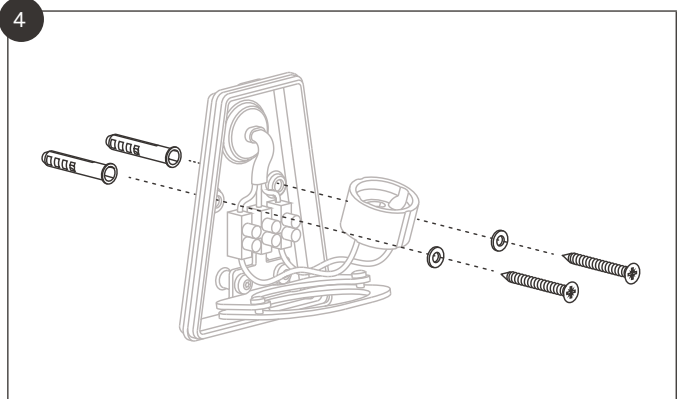

Drill two 6mm holes and set the anchors. Use these to screw the base to the wall.

Southwark mast light instructions

5

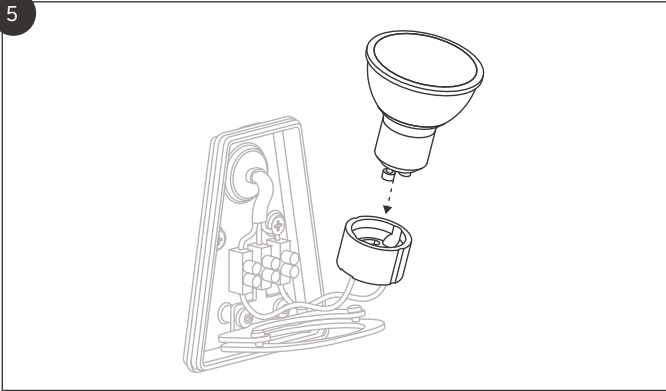

Insert the bulb into the bulb holder.

6

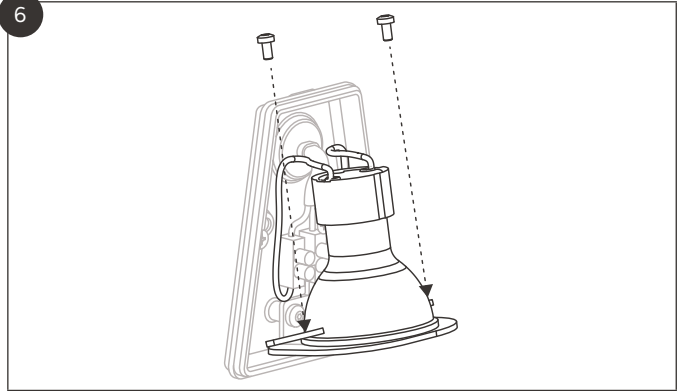

Place the bulb under the plate and tighten the two screws as shown.

7

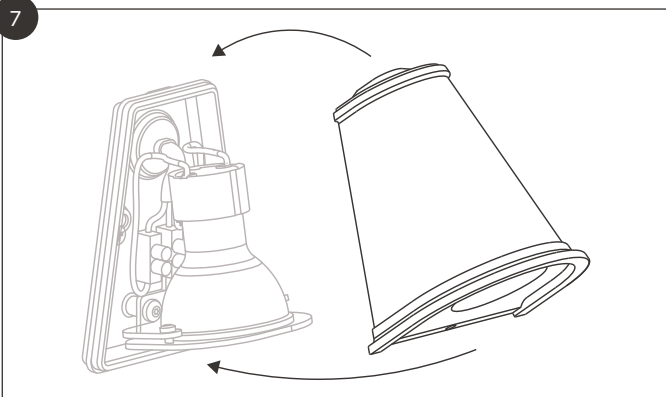

Hook the brass shade over the base and make sure it sits flat.

8

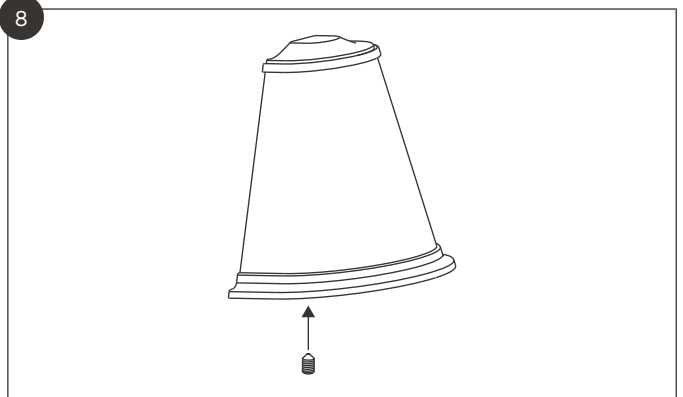

Secure the cover in place with the grub screw provided.