

Instruction Manual

Smart Dehumidifier

Model No.: CL-D22S



Read this manual thoroughly before using and save it for future reference

IMPORTANT SAFEGUARDS

IMPORTANT SAFEGUARDS.....	01
GETTING TO KNOW YOUR SMART DEHUMIDIFIER	05
OPERATING INSTRUCTIONS.....	07
CLEVAST APP SET UP.....	12
CARE & MAINTENANCE.....	17
TROUBLESHOOTING	19
FCC STATEMENT.....	20
WARRANTY INFORMATION.....	21
CUSTOMER SERVICE.....	21

IMPORTANT SAFEGUARDS

IMPORTANT SAFETY PRECAUTIONS

Read Safety Precautions Before Operation and Installation

To prevent death or injury to the user or other people and property damage, the following instructions must be followed. Incorrect operation due to ignoring of instructions may cause death, harm or damage.



WARNING

This symbol indicates the possibility of personnel injury or loss of life.



CAUTION

This symbol indicates the possibility of property damage or serious consequences.

WARNING:

- Do not exceed the rating of the power outlet or connection device.
- Do not operate or stop the unit by switching on or off the power.
- Do not damage or use an unspecified power cord.
- Do not modify power cord length or share the outlet with other appliances.
- Do not insert or pull out plug with wet hands.
- Do not install the appliance in a location that may be exposed to combustible gas.
- Do not place the unit near a heat source.
- Disconnect the power if strange sounds, smell, or smoke comes from it.
- You should never try to take apart or repair the unit by yourself.
- Before cleaning, turn off the power and unplug the unit.
- Do not use the machine near flammable gas or combustibles, such as gasoline, benzene, thinner, etc.
- Do not drink or use the water drained from the unit.
- Do not take the water bucket out during operation.
- Do not use the unit in small spaces.
- Do not put in places where water may splash onto the unit.
- Place the unit on a level, sturdy section of the floor.
- Do not cover the intake or exhaust openings with cloths or towels.
- Care should be taken when using the unit in a room with the following people: infants, children, elderly people, and people not sensitive to humidity.
- Do not use in areas where chemicals are handled.

- Never insert your finger or other foreign objects into grills or openings. Take special care to warn children of these dangers.
- Do not place heavy object on the power cord and take care so that the cord is not compressed.
- Do not climb up on or sit on the unit.
- Always insert the filters securely. Clean filter once every two weeks.
- If water enters the unit, turn the unit off and disconnects the power, contact a qualified service technician.
- Do not place flower vases or other water container on top of the unit.
- Do not use extension cords.

CAUTION:

- This appliance can be used by children aged from 8 years and above and persons with reduced physical, sensory, or mental capabilities or lack of experience and knowledge, if they have been given supervision or instruction concerning the use of the appliance in a safe way and understand the hazards involved. Children shall not play with the appliance. Cleaning and user maintenance shall not be done by children without supervision. (This is applicable to the European Countries.)
- This appliance is not intended for use by persons (including children) with reduced physical, sensory, or mental capabilities or lack of experience and knowledge, unless they have been given supervision or instruction concerning the use of the appliance by a person responsible for their safety. Children should be supervised to ensure that they do not play with the appliance. (This is applicable for other countries except the European Countries.)
- If the supply cord is damaged, it must be replaced by the manufacturer, its service agent, or similarly qualified persons in order to avoid a hazard.
- Prior to cleaning or other maintenance, the appliance must be disconnected from the supply mains.
- Do not install the appliance in a location that may be exposed to combustible gas. If combustible gas accumulates around the unit, it may cause fire.
- If the appliance is knocked over during use, turn off the unit and unplug it from the main power supply immediately. Visually inspect the unit to ensure there is no damage. If you suspect the unit has been damaged, contact a technician or customer service for assistance.
- In a thunderstorm, power must be cut off to avoid damage to the machine due to lightning.
- Do not run cord under carpeting. Do not cover cord with throw rugs, runners, or similar coverings. Do not route cord under furniture or appliances. Arrange cord away from traffic areas and where it will not be tripped over.
- The appliance shall be installed in accordance with national wiring regulations.

- To reduce the risk of fire or electric shock, do not use this fan with any solid-state speed control device.
- Contact the authorized service technician for repair or maintenance of this unit.
- Turn off the product when not in use.
- The manufacturer's nameplate is located on the rear panel of the unit and contains electrical and other technical data specific to this unit.
- Be sure the unit is properly grounded. To minimize shock and fire hazards, proper grounding is important. The power cord is equipped with a three-prong grounding plug for protection against shock hazards.
- Your unit must be used in a properly grounded wall receptacle. If the wall receptacle you intend to use is not adequately grounded or protected by a time delay fuse or circuit breaker (please refer to the nameplate for electrical data), have a qualified electrician install the proper receptacle.
- Please do not operate the dehumidifier in excessively damp rooms as this may cause danger or machine malfunction.
- The unit's circuit board (PCB) is designed with a fuse to provide overcurrent protection. The specifications of the fuse are printed on the circuit board, such as: T3.15A/250V (or 350V), etc.
- Do not operate the unit with a damaged cord or plug. Discard the unit or return it to an authorized service facility for examination and/or repair.

NOTE ABOUT FLUORINATED GASSES(NOT APPLICABLE TO THE UNIT USING R290 REFRIGERANT):

1. Fluorinated greenhouse gases are contained in hermetically sealed equipment. For specific information on the type, the amount and the CO₂ equivalent in tonnes of the fluorinated greenhouse gas(on some models), please refer to the relevant label on the unit itself.
2. Installation, service, maintenance and repair of this unit must be performed by a certified technician.
3. Product uninstallation and recycling must be performed by a certified technician.

SOCIABLE REMARK:

When using this dehumidifier in European countries, the following information must be followed:

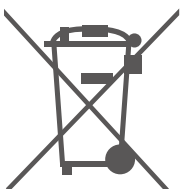

DISPOSAL: Do not dispose of this product as unsorted municipal waste. Collection of such waste separately for special treatment is necessary.



It is prohibited to dispose of this appliance in domestic household waste. For disposal, there are several possibilities:

- The municipality has established collection systems, where electronic waste can be disposed of at least free of charge to the user.
- When buying a new product, the retailer will take back the old product at least free of charge.
- The manufacturer will take back the old appliance for disposal at least free of charge to the user.
- As old products contain valuable resources, they can be sold to scrap metal dealers. Wild disposal of waste in forests and landscapes endangers your health when hazardous substances leak into the ground-water and find their way into the food chain.

**SAVE THESE INSTRUCTIONS
HOUSEHOLD USE ONLY**

GETTING TO KNOW YOUR SMART DEHUMIDIFIER

1. IDENTIFICATION OF PARTS

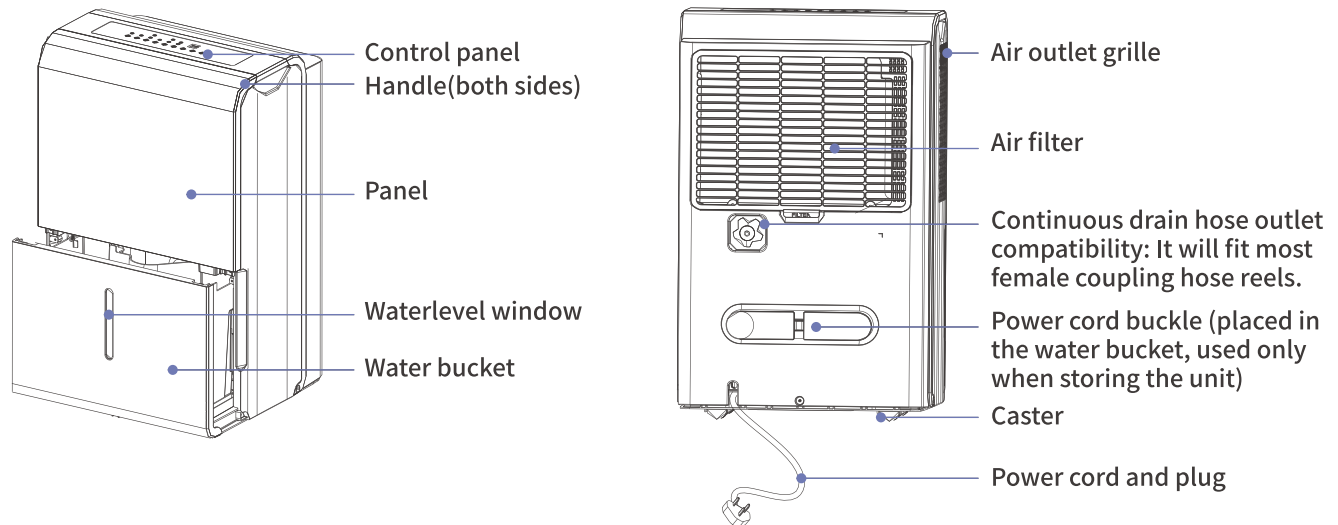

2. DESIGN NOTICE

- In order to ensure the optimal performance of our products, the design specifications of the unit are subject to change without prior notice.

3. PRECAUTION BEFORE FIRST USE

- After receiving the dehumidifier, let it sit in an upright position for 1 to 2 hours before using it to ensure refrigerant flows back to the compressor.
- Dehumidifier is an electrical appliance with a "compressor" structure inside. During transportation, the refrigerant oil in the system may flow to the desiccant capillary tube. If it is used immediately after transportation, it may cause problems such as tube blockage. It is recommended to let the unit sit in an upright position after it has been transported from one location to another.

4. POSITIONING THE UNIT

Casters(At four points on the bottom of unit)

- Casters can move freely.
- Do not force casters to move over carpet, nor move the unit with water in the bucket. (The unit may tip over and spill water.)

A dehumidifier operating in a basement will have little or no effect on drying an adjacent enclosed storage area, such as a closet, unless there is adequate circulation of air in and out of the area.

- Do not use outdoors.
- This dehumidifier is intended for indoor residential applications only. This dehumidifier should not be used for commercial or industrial applications.
- Place the dehumidifier on a smooth, level floor strong enough to support the unit with a full bucket of water.
- Allow at least 20cm of air space on all sides of the unit for good air circulation (at least 40cm of air space on air outlet).
- Place the unit in an area where the temperature will not fall below 5°C(41°F). The coils can become covered with frost at temperatures below 5°C(41°F), which may reduce performance.
- Place the unit away from the clothes dryer, heater or radiator.
- Use the unit to prevent moisture damage anywhere books or valuables are stored.
- Use the dehumidifier in a basement to help prevent moisture damage.
- The dehumidifier must be operated in an enclosed area to be most effective.
- Close all doors, windows and other outside openings to the room.

5. WHEN USING THE UNIT

- When first using the dehumidifier, operate the unit continuously for 24 hours. Make sure the plastic cover on the drain hose outlet is installed tightly so there will be no leak.
- This unit is designed to operate in a working environment between 5°C/41°F and 32°C/90°F, and between 30%(RH) and 80%(RH).
- If the unit has been switched off and needs to be switched on again quickly, allow approximately three minutes for the correct operation to resume.
- Do not connect the dehumidifier to a multiple socket outlet that is shared to other electrical appliances.
- Select a suitable location, making sure you have easy access to an electrical outlet .
- Plug the unit into an electrical socket-outlet with earth connection.
- Make sure the water bucket is correctly fitted otherwise the unit will not operate properly .
- Note: When the water in the bucket reaches to a certain level, please be careful to move the machine to avoid spilling.

6. ACCESSORIES

Package Inclusion: 1x Power cord bucket (to be placed at the back of the unit)

1x Drain cap Drain hose is not included

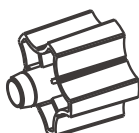
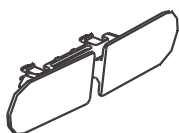

installation of the power cord bucket:

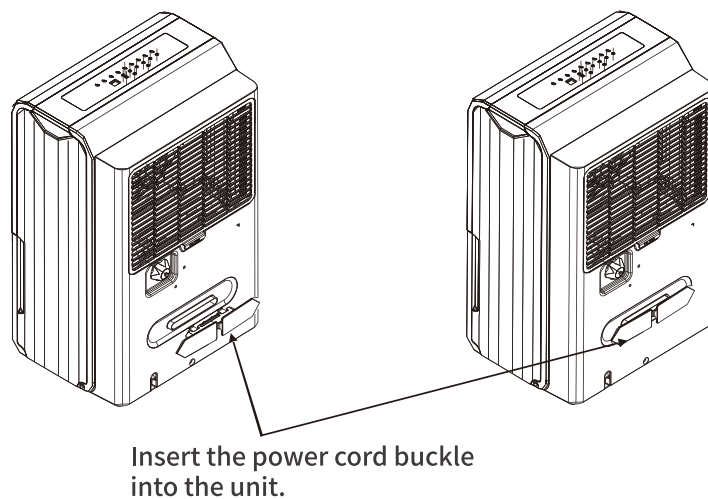

OPERATING INSTRUCTIONS

1. CONTROL PANEL FEATURES

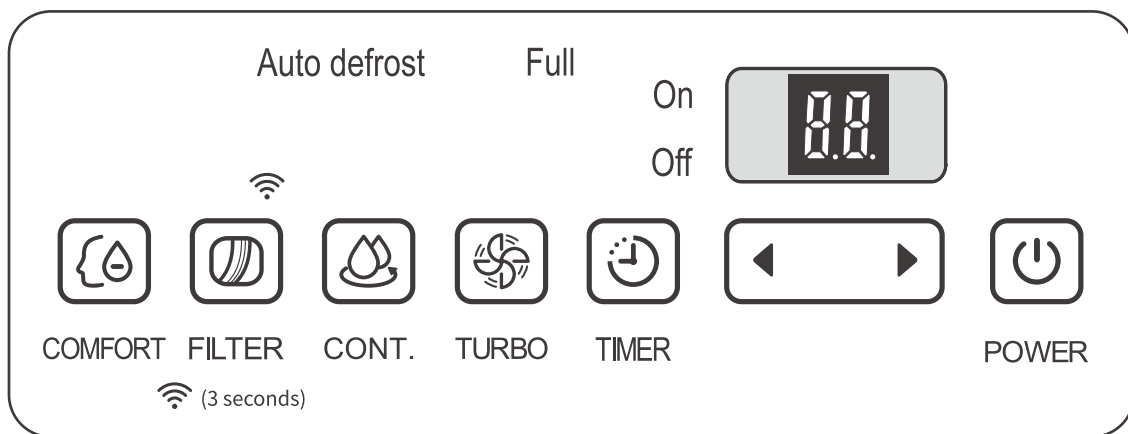

FILTER button

The check filter feature is a reminder to clean the Air Filter for more efficient operation. The filter light (Clean filter light) will illuminate after 250 hours of operation. To reset after cleaning the filter, press the filter button and the light will go off.



TURBO Pad

Control the fan speed. Press to select either High or Normal fan speed. Set the fan control to High for maximum moisture removal. When the humidity has been reduced and quiet operation is preferred, set the fan control to Normal.



CONTINUE button

Press to activate the continuous dehumidifying operation.

Note: On this operation, the unit can not be set humidity level.



Timer button

Press to initiate the Auto start and Auto stop feature, in conjunction with the ◀ and ▶ buttons.



Left/Right buttons

Humidity Set Control buttons

The humidity level can be set within a range of 35% RH(Relative Humidity) to 85%RH(Relative Humidity) in 5% increments. For drier air, press the ◀ button and set it to a lower percent value(%). For damper air, press the ▶ button and set a higher percent value(%).

TIMER Set Control buttons

Use the Left/Right buttons to set the Auto start and Auto stop time from 0.0 to 24.



POWER button

Press to turn the dehumidifier on and off.



COMFORT button

Press to activate the comfort dehumidifying operation. In Comfort dehumidifying mode, the unit will automatically control room humidity to a comfortable range of 45%~55% according to the room temperature. The humidity setting function will be invalid.

Note: On this operation, the unit can not be set humidity level.



Display

Shows the set % humidity level from 35% to 85% or auto start/stop time (0~24) while setting, then shows the actual($\pm 5\%$ accuracy) room % humidity level in a range of 30% RH(Relative Humidity) to 90%RH(Relative Humidity).

Error Codes and Protection Code:

- AS-Humidity sensor error-Unplug the unit and plug it back in. If error repeats, call for service.
- ES-Tube Temperature sensor of the evaporator error- Unplug the unit and plug it back in. If error repeats, call for service.

- P2-Bucket is full or bucket is not in right position- Empty the bucket and replace it in the right position.

Note: When one of the above malfunctions occurs, turn off the unit, and check for any obstructions. Restart the unit, if the malfunction is still present, turn off the unit and unplug the power cord. Contact the manufacturer or its service agents or a similar qualified person for service.

2. CLEVAST DEHUMIDIFIER FEATURES

Clevast App Control

The Clevast dehumidifier can be controlled via a mobile app, providing convenient access to the device's settings and allowing you to monitor and adjust the humidity level from anywhere.

Setting the Timer

When the unit is on, first press the Timer button, the Timer Off indicator light illuminates. It indicates the Auto Stop program is initiated. Press it again the Timer On indicator light illuminates. It indicates the Auto Start is initiated.

When the unit is off, first press the Timer button, the Timer On indicator light illuminates. It indicates the Auto Start program is initiated. Press it again the Timer Off indicator light illuminates. It indicates the Auto Stop is initiated.

Press or hold the LEFT OR RIGHT button to change the Auto time by 0.5hour increments, up to 10 hours, then at 1 hour increments up to 24 hours. The control will count down the time remaining until the start.

The selected time will register after 5 seconds and the system will automatically revert back to display the previous humidity setting.

When the Auto Start & Auto Stop times are set, within the same program sequence, Timer On Off indicator lights illuminate identifying both On and Off times are now programmed.

Turning the unit On or Off at any time or adjusting the timer setting to 0.0 will cancel the Auto Start/ Stop function.

When the LED display window displays the code of P2, the Auto Start/Stop function will also be cancelled.

Auto Shut Off

The dehumidifier shuts off when the bucket is full, or when the bucket is removed or not replaced in the proper position.

Wait 3 minutes before resuming the operation after the unit has stopped. This is to protect the unit. Operation will automatically start after 3 minutes.

Bucket Full Light

Glows when the bucket is ready to be emptied.

Auto Defrost

When frost builds up on the evaporator coils, the compressor will cycle off and the fan will continue to run until the frost disappears.

Check filter feature

The system starts to count the time once the fan motor operates. The check filter feature can be only activated when the accumulated operation achieves 250 hours or more. The Reset light (clean filter indicator) flashes every second. After cleaning the air filter, press the Filter button and the Reset light goes off.

Auto-Restart

If the unit breaks off unexpectedly due to the power cut, it will restart with the previous function setting automatically when the power resumes.

3. REMOVING THE COLLECTED WATER (There are two ways to remove collected water.I.)

1. Use the bucket

- When the unit is off, if the bucket is full, the Full indicator light will light.
- When the unit is on, if the bucket is full, the compressor and the fan turn off, and the Full indicator light will light, the digital display shows P2.
- Slowly pull out the bucket. Grip the left and right handles securely, and carefully pull out straight so water does not spill. Do not put the bucket on the floor because the bottom of the bucket is uneven. Otherwise the bucket will fall and cause the water to spill.
- Throw away the water and replace the bucket. The bucket must be in right place and securely seated for the dehumidifier to operate.
- The machine will re-start when the bucket is restored in its correct position.

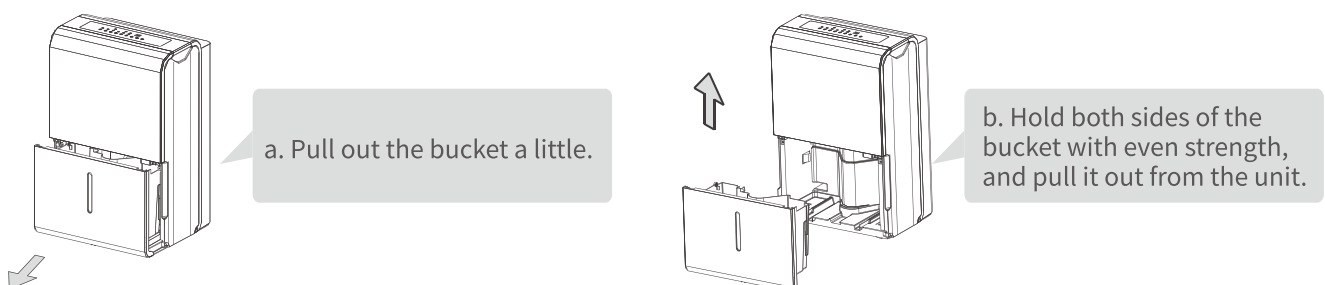

NOTE:

- When you remove the bucket, do not touch any parts inside of the unit. Doing so may damage the product.
- Be sure to push the bucket gently all the way into the unit. Banging the bucket against anything or failing to push it in securely may cause the unit not to operate.

2. Continuous draining

- Water can be automatically emptied into a floor drain by attaching the unit with a water hose (ID: 5/16", not included) with a female threaded end (ID: M= 1/2" or 3/4", not included)
- Remove the plastic cover from the back drain outlet of the unit and set aside, then insert the drain hose through the drain outlet of the unit and lead the drain hose to the floor drain or a suitable drainage.

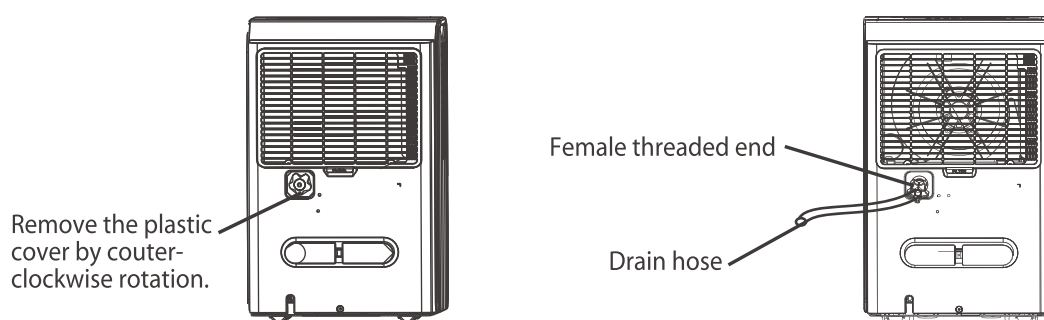

- When you remove the plastic cover and there's some water in the back drain outlet of the unit, you must dry it. Make sure the hose is securely connected so there are no leaks and the end of the hose should be placed down the floor to let the water flow. This unit uses gravity drain.
- Direct the hose toward the drain, making sure that there are no kinks that will stop the water flowing. Make sure the water hose is lower than the drain hose outlet of the unit.
- Select the desired humidity setting and fan speed on the unit for continuous draining to start.

Note: When the continuous draining feature is not being used, remove the drain hose from the outlet, and dry the water in the continuous drain hose outlet.

4. SPECIFICATIONS

Model No.:	CL-D22S
Rated voltage:	115V 1Ph
Rated frequency:	FREQUENCY 60HZ
Rated power:	250W
Complete-built unit size:	16.54 x 11.69 x 19.69 inches
Complete-built unit Net weight:	32.41lbs

Applicable Ambient (RH Range Manual) :	35-85%
Applicable Ambient (Ambient temp) :	41-96°F
Refrigerant type:	R32/3.88ozs
Air flow (Hi/Mi/Lo):	135.29/-/117.65 CFM(ft3/min)
Water tank volume:	3L
Noise level(Hi):	51dB(A)
Plug type:	18#x3/SP007

CLEVAST APP SET UP

1. DOWNLOAD THE CLEVAST APP

To download the Clevast App, please scan the QR code or search for "Clevast" in Apple App store® (iOS) or Google Play Store (Android).



NOTE:

- For Android™ users, choose "**Allow**" to use Clevast. It won't be used to record personal, private information.
- The Clevast App is continually being improved and may change over time. If there are any differences, follow the in-app instructions.
- Follow the instructions to finish setting up your Dehumidifier.



2. CREATE / LOGIN YOUR OWN CLEVAST ACCOUNT

Open the Clevast App, if you already have an account, tap Log In. If you want to create a new account, tap Sign Up.

NOTE: You must create your own Clevast account to use third-party services and products. These will not work with a guest account. With a Clevast account, you can also allow your family and friends to control your dehumidifier unit.

3. SETTING UP CLEVAST APP

User must finish all the steps in 8 minutes after powering on the Dehumidifier, otherwise you need to power it on again.

1. Turn on Bluetooth®  and Wi-Fi®  on your phone.
2. Make sure your mobile device has already been connected to the Wireless network which you want to use. Also, you need to forget other irrelevant Wireless networks in case it influences your configuration process.
3. Disconnect the power supply of dehumidifier.
4. Connect the power supply of dehumidifier, press and hold the " FILTER " button for more than 3 seconds.

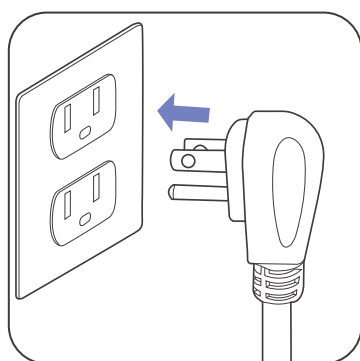

Step 1

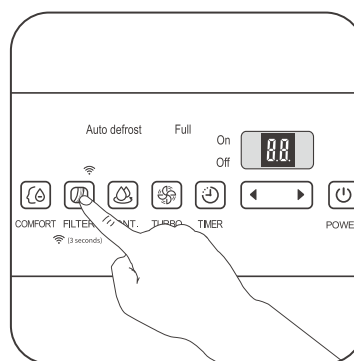

Step 2

5. When the unit displays "**AP**", it means that the dehumidifier wireless has already entered into "**AP**" Mode.
6. Press "**+ Add Device**"

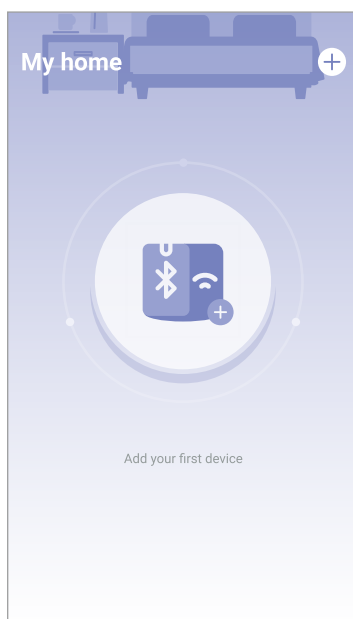

7. Enter the Add Device interface, select the Dehumidifier to enter the network configuration interface.

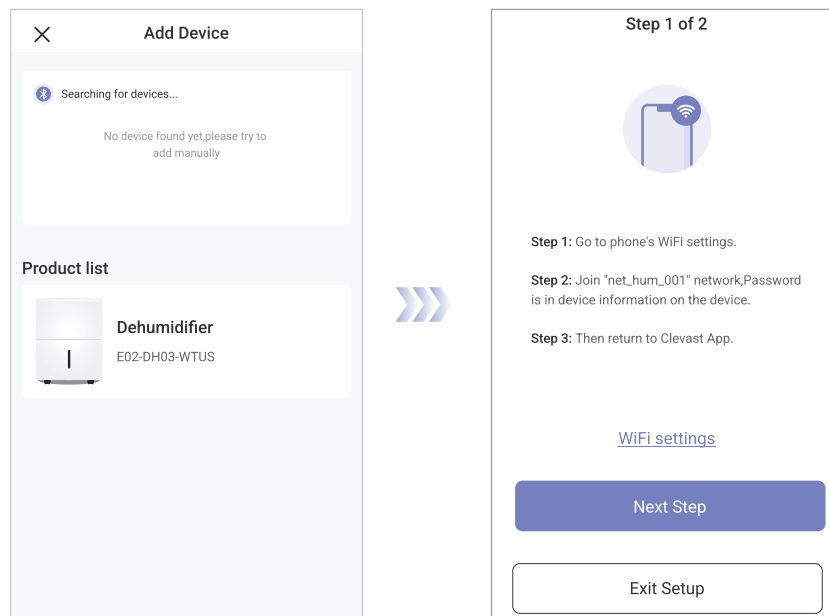

8. Go to the phone's "**WLAN**" settings, use the password "12345678" to connect to the network "net_a1_XXXX".

If "net_a1_XXXX" network is not found on the WLAN. Check whether the device is in AP mode.
If not, try again.

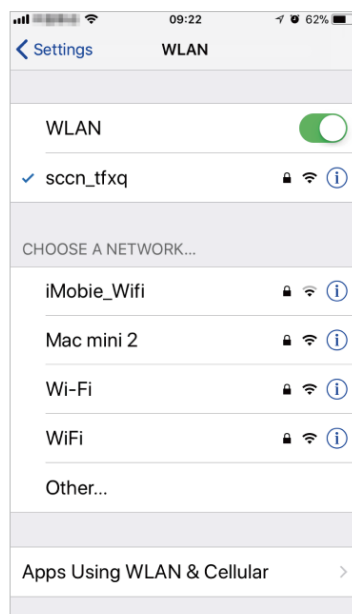

9. Please select family WLAN and enter the password. Please ensure that the current connection is the 2.4G wireless network!

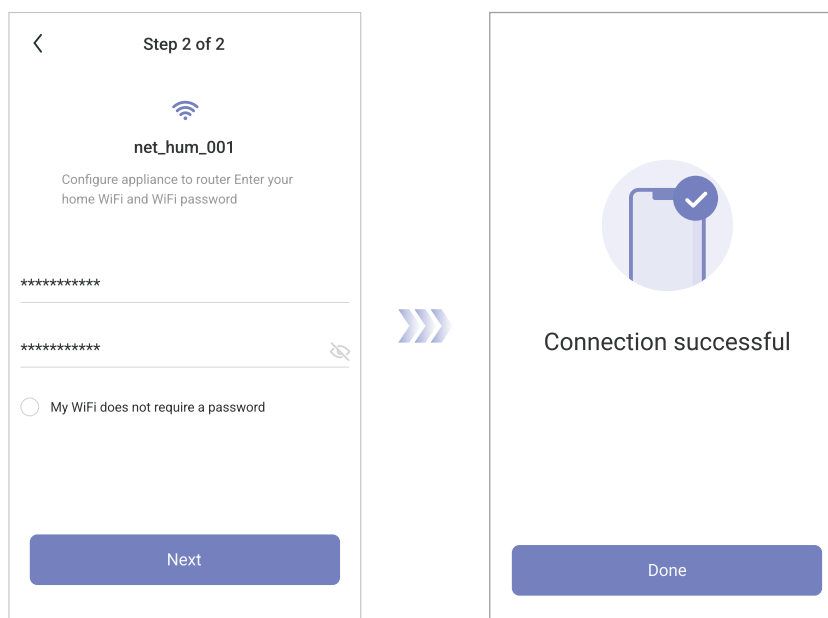

NOTE:

- When finishing network configuration, APP will display success cue words on the screen.
- Due to different internet environment, it is possible that the device status still display "offline". If this situation occurs, it is necessary to pull and refresh the device list on the APP and make sure the device status become "online". Alternatively, user can turn off the power and turn on it again, the device status will become "online" after few minutes.

4. APP FUNCTIONS

Please ensure both your mobile device and dehumidifier are connected to the Internet before using app to control the dehumidifier via the internet. Please follow the next steps:

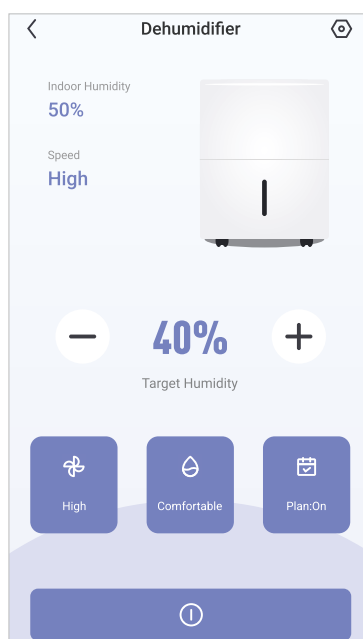

Thus, users can control dehumidifier on/off status, operation mode, target humidity, fan speed and so on.

NOTE: Not all the functions of the APP are available on the dehumidifier. For example: ION, Pump, Pure function, please check the user manual to find more information.

CYCLE PLAN

Weekly, users can make an appointment to turn on or off the dehumidifer at a specific time. Users can also choose circulation to keep the dehumidifer under schedule control every week.

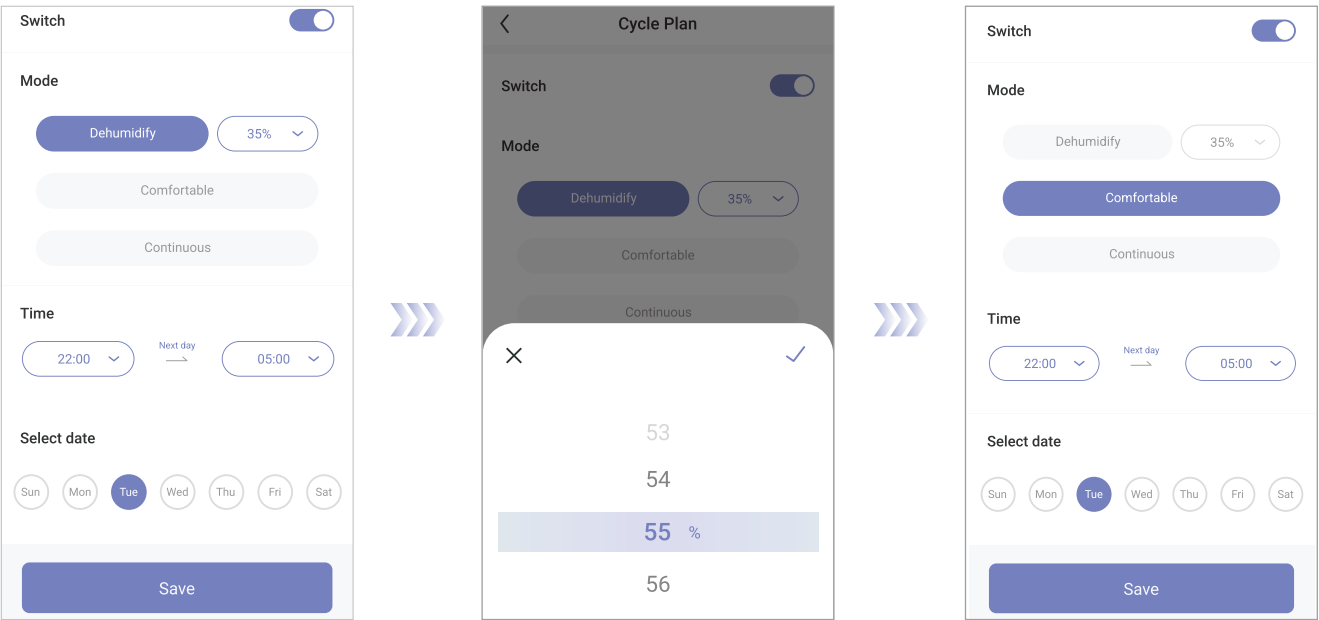

CARE & MAINTENANCE

Care and cleaning of the dehumidifier.

Turn off the dehumidifier and remove the plug from the wall outlet before cleaning.

1. CLEAN THE GRILLE AND CASE

- Use water and a mild detergent. Do not use bleach or abrasives.
- Do not splash water directly onto the main unit. Doing so may cause an electrical shock, cause the insulation to deteriorate, or cause the unit to rust.
- The air intake and outlet grilles get soiled easily, so use a vacuum attachment or brush to clean.

2. CLEAN THE BUCKET

- Every few weeks, clean the bucket to prevent growth of mold, mildew and bacteria. Partially fill the bucket with clean water and add a little mild detergent. Swish it around in the bucket, empty and rinse.

Note: Do not use a dishwasher to clean the bucket. After cleaning, the bucket must be in place and securely seated for the dehumidifier to operate.

3. CLEAN THE AIR FILTER

- Remove the filter every two weeks based on normal operating conditions.
- To remove the filter, pull filter outwards.
- Wash the filter with clean water then dry.
- Re-install the filter, replace Bucket.



CAUTION

DO NOT operate the dehumidifier without filter because dirt and lint will clog it and reduce the performance.

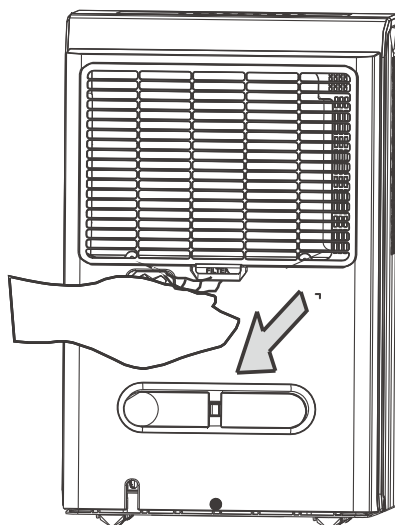

4. WHEN NOT USING THE UNIT FOR LONG TIME PERIODS

- After turning off the unit, wait one day before emptying the bucket. Clean the main unit, water bucket and air filter.
- Wrap the cord with the power cord buckle.
- Cover the unit with a plastic bag.
- Store the unit upright in a dry, well-ventilated place.

TROUBLESHOOTING

Before calling for service, review the chart below first yourself.

No.	Problems	Solution
1	Unit does not start	<ol style="list-style-type: none"> 1. Make sure the dehumidifier's plug is pushed completely into the outlet. 2. Check the house fuse/circuit breaker box. 3. Dehumidifier has reached its preset level or bucket is full. 4. Water bucket is not in the proper position.
2	Dehumidifier does not dry the air as it should	<ol style="list-style-type: none"> 1. Did not allow enough time to remove the moisture. 2. Make sure there are no curtains, blinds or furniture blocking the front or back of the dehumidifier. 3. The humidity control may not be set low enough. 4. Check that all doors, windows and other openings are securely closed. 5. Room temperature is too low, below 5°C(41°F). 6. There is a kerosene heater or something giving off water vapor in the room.
3	The unit makes a loud noise when operating	<ol style="list-style-type: none"> 1. The air filter is clogged. 2. The unit is tilted instead of upright as it should be. 3. The floor surface is not level.
4	Water on floor	<ol style="list-style-type: none"> 1. Hose to connector or hose connection may be loose. 2. Intend to use the bucket to collect water, but the back drain plug is removed.
5	Frost appears on the coil	This is normal. The dehumidifier has Auto defrost feature.
6	ES, AS,P2 appear in the display	These are error codes and protection codes. See the CONTROL PANEL FEATURES section.

FCC STATEMENT

This device complies with Part 15 of the FCC Rules. Operation is subject to the following two conditions:

- (1) This device may not cause harmful interference, and
- (2) This device must accept any interference received, including interference that may cause undesired operation.

Any changes or modifications not expressly approved by the party responsible for compliance could void the user's authority to operate this equipment.

This equipment has been tested and found to comply with the limits for a Class B digital device, pursuant to Part 15 of the FCC Rules. These limits are designed to provide reasonable protection against harmful interference in a residential installation. This equipment generates, uses and can radiate radio frequency energy and, if not installed and used in accordance with the instructions, may cause harmful interference to radio communications. However, there is no guarantee that interference will not occur in a particular installation. If this equipment does cause harmful interference to radio or television reception, which can be determined by turning the equipment off and on, the user is encouraged to try to correct the interference by one of the following measures:

- Reorient or relocate the receiving antenna.
- Connect the equipment into an outlet on a circuit different from that to which the receiver is connected.
- Increase the separation between the equipment and receiver.
- Consult the dealer or an experienced radio/TV technician for help.

FCC RADIATION EXPOSURE STATEMENT

This equipment complies with FCC radiation exposure limits set forth for an uncontrolled environment. End users must follow the specific operating instructions for satisfying RF exposure compliance.

To maintain compliance with FCC RF exposure compliance requirements, please follow operation instructions as documented in this manual. This transmitter must not be co-located or operating in conjunction with any other antenna or transmitter.

This equipment should be installed and operated with a minimum distance of 20cm between the radiator and your body.

The availability of some specific channels and/or operational frequency bands are country dependent and are firmware programmed at the factory to match the intended destination. The firmware setting is not accessible by the end user.

WARRANTY INFORMATION

We grant a 1-year warranty on the product commencing on the date of purchase. Within the guarantee period, we will eliminate any defects in the appliance resulting from faults in materials or workmanship. Please contact us at: support@clevast.com to launch a warranty claim.

This guarantee does not cover: damage due to improper use, normal wear or use as well as defects that have a negligible effect on the value or operation of the appliance. The guarantee becomes void if repairs are undertaken by unauthorized persons and if original product parts are not used.

CUSTOMER SERVICE

1. If you have any product questions or concerns, please don't hesitate to contact us directly at support@clevast.com or visit our website at: www.clevast.com.
2. We have a hassle-free warranty and customer service team for satisfactory solutions to any issue you might have.

CLEVAST

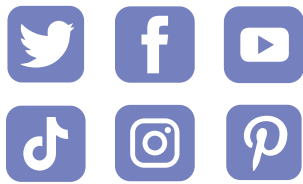

@CLEVAST
WWW.CLEVAST.COM



Scan to Follow Us