



Item #

Model # FC182832T01WT

USE AND CARE GUIDE

18.3IN X 28IN X 32.8IN HUSKY BASE FOLDING CABINET

Questions, problems, missing parts?
Before returning to the store, call
Husky Customer Service
8 a.m. - 7 p.m., EST, Monday - Friday
9 a.m. - 6 p.m., EST, Saturday

1-888-43-HUSKY

WWW.HUSKYTOOLS.COM

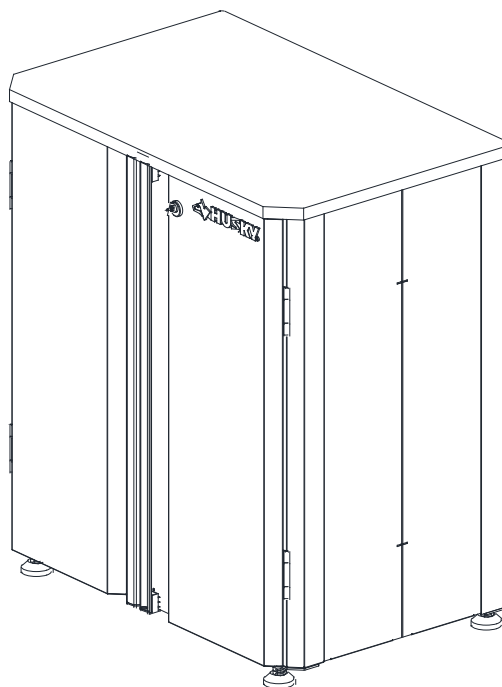

Due to continuing improvements,
the actual product may differ slightly
from product described herein.

THANK YOU

We appreciate the trust and confidence you have placed in Husky through the purchase of this cabinet. We strive to continually create quality products designed to enhance your home. Visit us online to view our full line of products available for your home improvement needs. Thank you for choosing Husky.

Table of Contents

Table of Contents	2
Safety Information	2
Warranty	2
Specifications	3
Pre-Installation	3

Assembly	5
Maintenance	8
Care and Cleaning	8

Safety Information

To reduce the risk of serious injury, read and follow the safety instructions below before assembling and using this product.

- This product is intended for indoor use only.
- This product is not designed for commercial nor industrial usage.



CAUTION: Use at least two people to move, assemble or install this product. Failure to do so can result in personal injury or product damage. Any assembly or maintenance of the product must be carried out by adults only.



CAUTION: DO NOT alter this product in any manner. For example, do not weld external bar locks or attach electrical and lock equipment. This may cause product damage or personal injury.



CAUTION: Check all nuts and bolts periodically for tightness. When required, tighten them again.



CAUTION: DO NOT leave children unattended near this product. Cabinet may tip over if improperly opened.



WARNING: Keep the product on level surfaces. The product could become unstable and it may tip over if stored or moved on an uneven surface, which may cause personal injury, death or product damage.



WARNING

- Unit must be placed on a level surface or leveled with included hardware (when applicable).
- Do not sit or stand on or allow children to climb, sit or stand on the assembled product.
- For safety reasons, it is imperative that this unit be mounted on the wall or floor.
- Do not use without installing the tip restraint.
- Unit can tip over causing severe injury or death.
- Never open more than one drawer at a time.
- Do not exceed the recommended weight limits.
- Evenly distribute the weight on each level and always keep the heavier loads on the bottom.
- Before cutting, drilling or hammering into any wall or floor surface, verify the location of electrical, plumbing and gas lines. Cutting may cause serious injury.

Warranty

This warranty excludes incidental/inconsequential damages and failures due to misuse, abuse or normal wear and tear.

This full warranty gives you specific rights, and you may also have other rights, which vary state to state.

Contact the customer service team at 1-888-43-HUSKY or visit www.huskytools.com.

Specifications

Maximum load for each door	15 lbs. / 6.8 kg
Maximum load for each shelf	100 lbs. / 45.4 kg
Maximum load for bottom panel	100 lbs. / 45.4 kg
Maximum load for wood top	100 lbs. / 45.4 kg
Maximum total load	330 lbs. / 150 kg

Pre-Installation

TOOLS REQUIRED



Safety Goggles
(not included)



Gloves
(not included)

HARDWARE INCLUDED



NOTE: Hardware not shown to actual size.

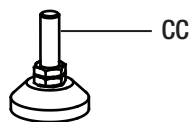
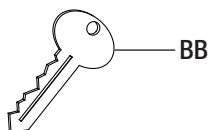
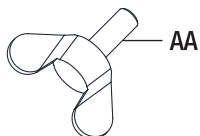

Part	Description	Quantity
AA	Wing Screw	04
BB	Keys	02
CC	Adjustable Foot	04

Pre-Installation (continued)

PACKAGE CONTENTS

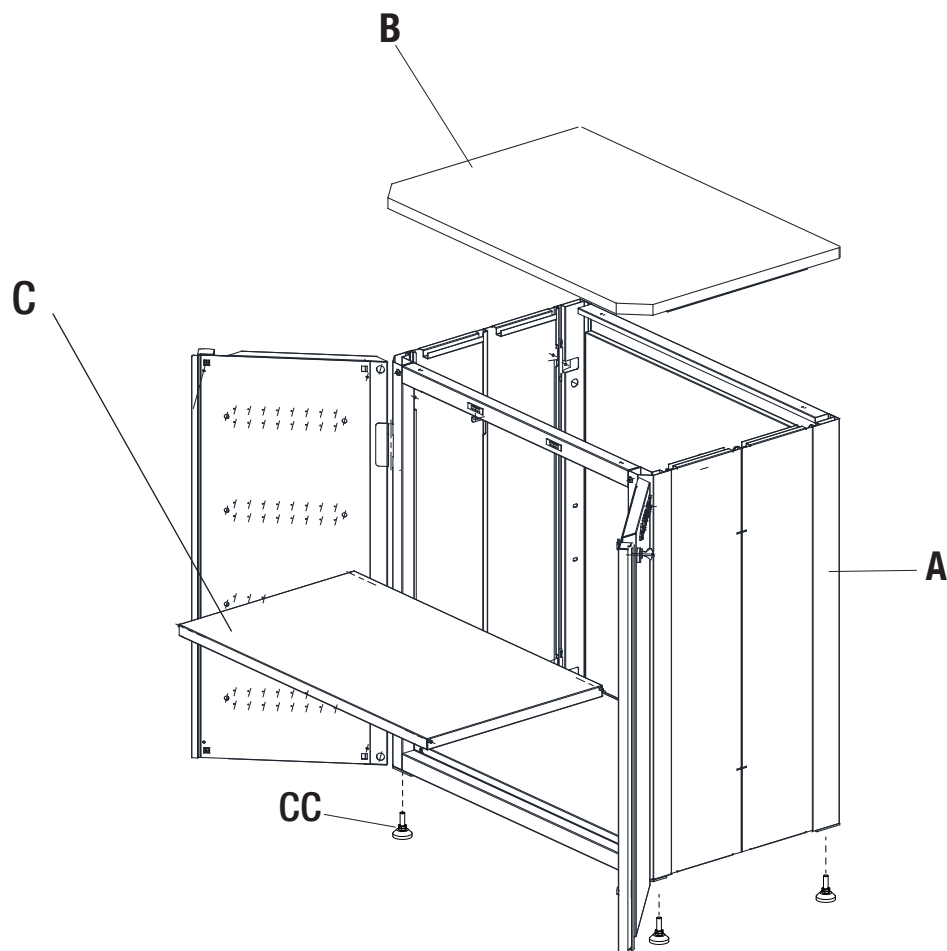

Part	Description	Quantity	Remarks
A	Cabinet Case	01	Pre-assembled
B	Cabinet Top	01	Assembly required
C	Cabinet Shelf	01	Assembly required
CC	Adjustable Foot	04	Assembly required

Assembly



CAUTION: Assemble on a flat surface. Make sure the surface is free of debris or the cabinet is protected. A piece of cardboard is recommended to keep the product from being scratched during assembly.



CAUTION: Please wear gloves during the whole assembling process to avoid accidental personal injury.



CAUTION: For component with protective film, please peel off the protective film before assembling it.

1 TAKE OUT ALL THE HARDWARE

- Lay the back of the cabinet down on even floor.
- Take the keys put in the bag together with the Instruction Manual to unlock and open the Cabinet doors.
- Take out the Hardware package from the inside of the folded cabinet.
- Close the doors and make sure it is locked securely.

Lay the cabinet down on even floor

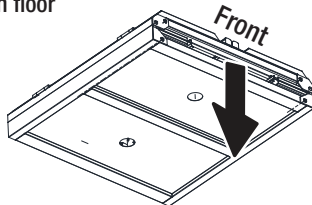

Take out Hardware boxes

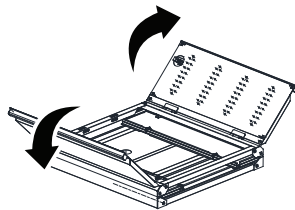

Close and lock the door

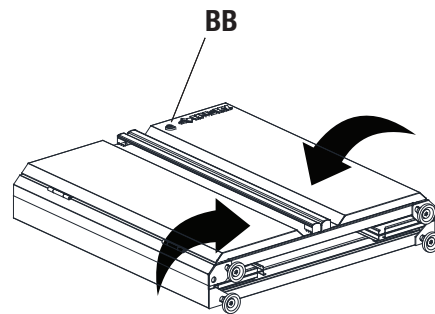

2 INSTALL THE ADJUSTABLE FEET

Install the Adjustable feet to the bottom of the cabinet.

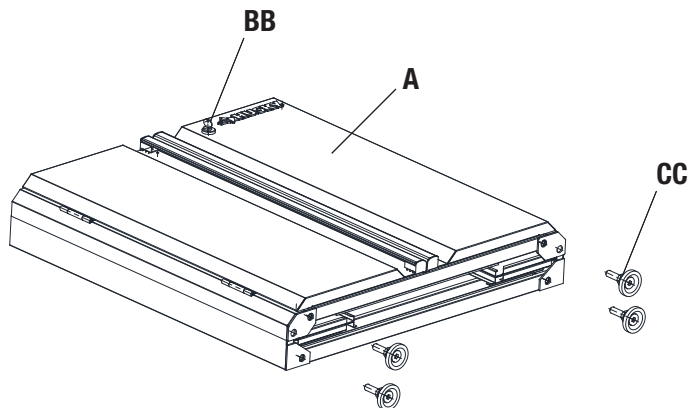

Assembly (continued)

3 TAKE OUT ALL THE HARDWARE



CAUTION: Use at least two adult to move, assemble or install this product. Failure to do so can result in personal injury or product damaged.



CAUTION: Do not put your hands on the folding point to avoid personal injury.

- Lift the cabinet upwards. Be careful as the cabinet can be slipped or fallen down which may cause serious injury or product damaged.
- Unfold the cabinet case. Do not touch on the conjunction parts while folding to avoid getting injured.

Lift the Cabinet Upwards

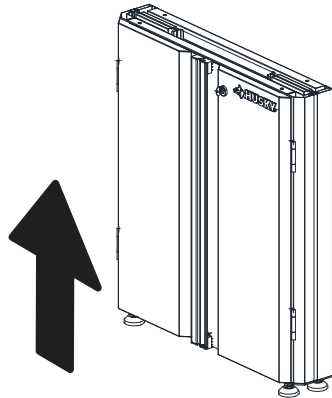

Unfold the Cabinet case totally

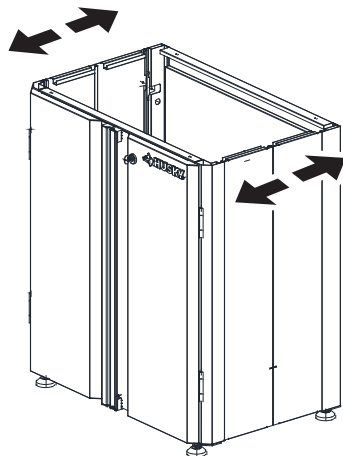

4 SETTLE THE BOTTOM PANEL

- Push the side panels till they get flattern. Make sure you adjust the Levelers evenly with the floor.
- Unlock the security pin of the Bottom panel.
- Flip down and fix the bottom panel firmly on the base frame of the cabinet.

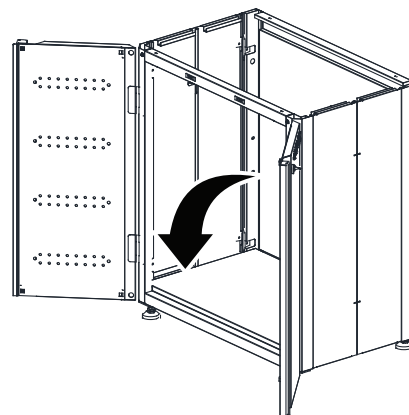
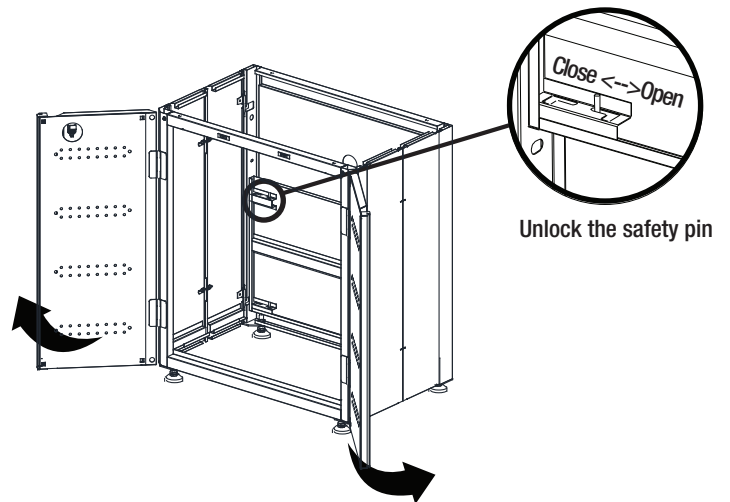

Flip down the bottom panel
Fix the bottom panel firmly

Assembly (continued)

5 INSTALL THE DECK

- Insert the two lower pins on the inner back side of side panels at desired height. Make sure the 2 pins are secured firmly.
- Flip the deck forward and make sure the 4 pins of the deck are at the same height.
- Lock the 2 front pins under the deck and make sure that the pins are secured firmly.

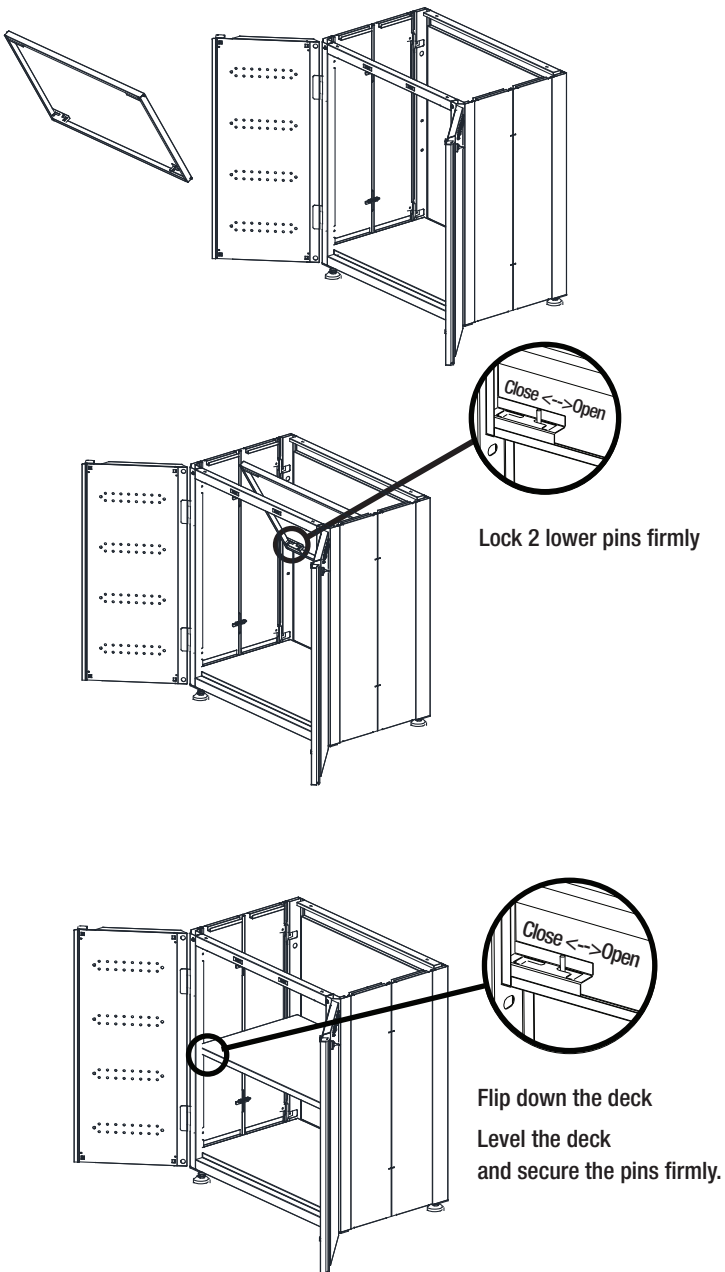

6 INSTALL THE CABINET TOP

- Place the wooden surface on top of the cabinet.
- Make sure to match the position.
- Tighten the 4 screws on the inside of the cabinet, just below the top of the cabinet.

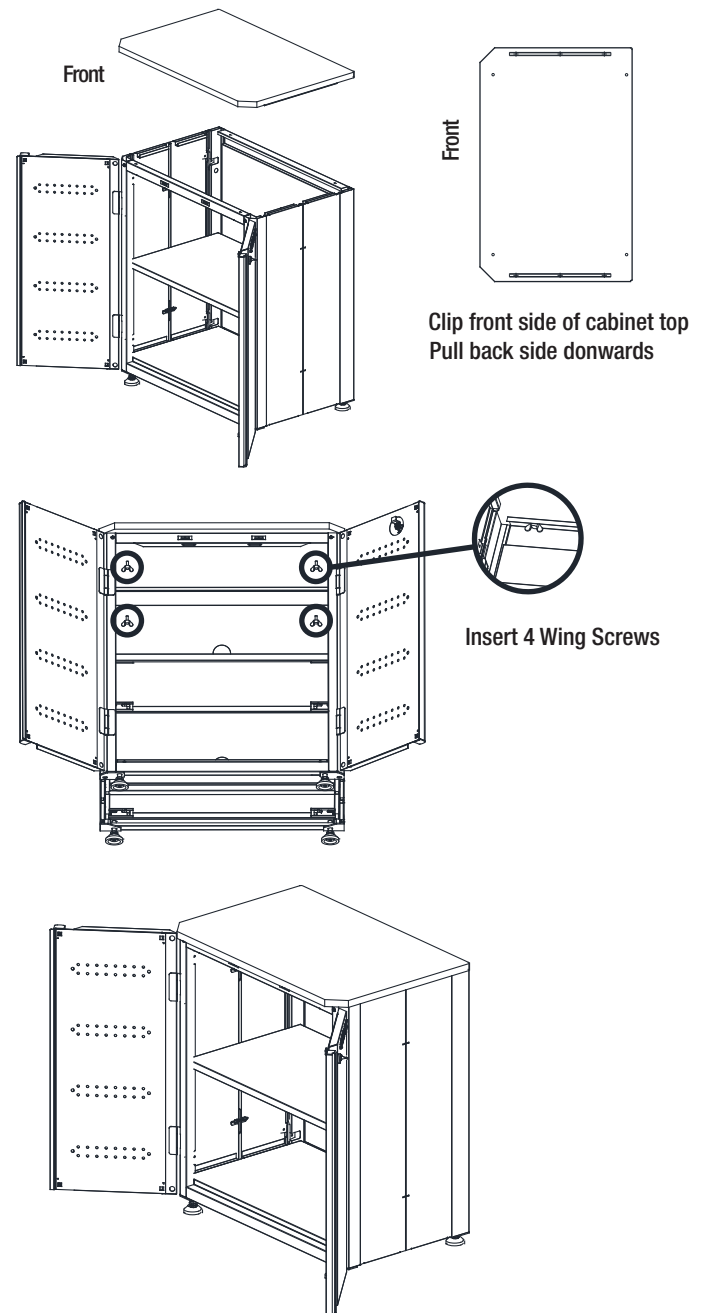

Maintenance

- Check all the screws and nuts periodically for tightness. Tighten them when necessary.
- Check the safety strap periodically for tightness. Tighten it when necessary.

Care and Cleaning

- Periodically clean the surfaces with soft rag and water.
- Grease and oil can be removed with most standard cleaning fluids. For safety, use a nonflammable cleaning fluid.



Questions, problems, missing parts? Before returning to the store,
call Husky Customer Service
8 a.m. - 7 p.m., EST, Monday - Friday
9 a.m. - 6 p.m., EST, Saturday

1-888-43-HUSKY

WWW.HUSKYTOOLS.COM

Retain this manual for future use.