

2515367



Please read all instructions carefully before use and retain for future reference.



CAUTION Do not immerse in water.



Wear a dust mask.



Protect your eyes.



Protect your ears.



Protect your hands.

Please read all instructions carefully before use and retain for future reference.

INTENDED USE Only operate the power tool/machine for its intended purpose and within the parameters specified in this manual.

This power tool/machine is for domestic use only. This power tool/machine is not intended for use by persons with reduced physical, sensory or mental capabilities, or lack of experience and knowledge, unless supervised or given appropriate instruction concerning the product's use by a person responsible for their safety.

GENERAL PRECAUTION Do not allow to be used as a toy. Children should be supervised to ensure they do not play with the power tool/machine.

If the power tool/machine is not functioning properly, has been dropped, damaged, left outdoors, or immersed in liquid, do not use, contact DOMU Brands Customer Services.

Do not use the power tool/machine if any parts appear to be faulty, missing or damaged.

Ensure all parts are securely attached before use.

RISK OF PERSONAL INJURY Avoid body contact with earthed or grounded surfaces such as pipes, radiators, ranges and refrigerators. There is an increased risk of electric shock if your body is earthed or grounded.

Prevent unintentional starting. Ensure the switch is in the off position before connecting to the power source and/or battery pack, picking up or carrying the tool. Carrying power tools with your finger on the switch, or energising power tools that are switched on, invites accidents.

Do not operate power tools in explosive atmospheres such as in the presence of flammable liquids, gases or dust. Power tools create sparks which may ignite the dust or fumes.

Always wear eye protection. Any power tool can throw foreign objects into your eyes and cause permanent eye damage. Always wear safety goggles (not glasses) that comply with ANSI safety standard Z87.1. Every day glasses have only impact resistant lenses.

Do not expose power tools to rain or wet conditions. Water entering the power tools will increase the risk of electric shock.

Stay alert, watch what you are doing and use common sense when operating a power tool/machine. Do not use a power tool/machine while you are tired or under the influence of drugs, alcohol or medication. A moment of inattention while operating power tool/machine may result in serious personal injury.

Use personal protective equipment. Always wear eye protection. Protective equipment such as dust mask, non-skid safety shoes, hard hat, or hearing protection used for appropriate conditions will reduce personal injuries.

Prevent unintentional starting. Ensure the switch is in the off-position before connecting to power source and/or battery pack, picking up or carrying the tool.

Carrying power tool/machine with your finger on the switch or energizing power tool/machine that have the switch on invites accidents.

Remove any adjusting key or spanner before turning the power tool/machine on. A spanner or a key left attached to a rotating part of the power tool/machine may result in personal injury.

Do not overreach. Keep proper footing and balance at

all times. This enables better control of the power tool/machine in unexpected situations.

Dress appropriately. Do not wear loose clothing or jewellery.

Keep your hair, clothing and gloves away from moving parts. Loose clothes, jewellery or long hair can be caught in moving parts.

If devices are provided for the connection of dust extraction and collection facilities, ensure these are connected and properly used. Use of dust collection can reduce dust-related hazards.

WORK AREA SAFETY Keep work area clean and well lit. Cluttered or dark areas invite accidents.

Do not operate power tool/machine in explosive atmospheres, such as in the presence of flammable liquids, gases or dust.

Power tool/machine create sparks which may ignite the dust or fumes.

Keep children and bystanders away while operating a power tool/machine. Distractions can cause you to lose control.

GENERAL POWER TOOL USE AND CARE Do not force the power tool/machine. Use the correct power tool/machine for your application. The correct power tool/machine will do the job better and safer at the rate for which it was designed.

Do not use the power tool/machine if the switch does not turn it on and off. Any power tool/machine that cannot be controlled with the switch is dangerous and must be repaired.

Disconnect the plug from the power source and/or the battery pack from the power tool/machine before making any adjustments, changing accessories, or storing power tool/machine tools. Such preventive safety measures reduce the risk of starting the power tool/machine accidentally.

Store idle power tool/machine out of the reach of children and do not allow persons unfamiliar with the power tool/machine or these instructions to operate the power tool/machine.

Power tool/machines are dangerous in the hands of untrained users.

Maintain power tool/machines. Check for misalignment or binding of moving parts, breakage of parts and any other condition that may affect the power tool/machines operation. If damaged, have the power tool/machines repaired before use. Many accidents are caused by poorly maintained power tool/machines.

Keep cutting tools sharp and clean.

Properly maintained cutting tools with sharp cutting edges are less likely to bind and are easier to control.

Use the power tool/machine accessories and tool bits in accordance with these instructions, take into account the working conditions and the work to be performed.

Use of the power tool/machine for operations different from those intended could result in a hazardous situation.

CLEANING & MAINTENANCE Never soak or immerse electrical components and or a component that has a plug attached.

Disconnect the plug from the power source before making any adjustments, changing accessories, or storing. Such preventive safety measures reduce the risk of starting the power tool accidentally.

Ensure the motor has fully stopped before cleaning, clearing a blockage, checking, or carrying out any maintenance on the tool.

Maintain your power tool. Check for misalignment or binding of moving parts, breakage of parts and any other condition that may affect the power tool's operation. If damaged, have the power tool repaired by a qualified repair person before use. Many accidents are caused by poorly maintained power tools.

Keep cutting tools sharp and clean. Properly maintained cutting tools with sharp cutting edges are less likely to

bind and are easier to control.

Regularly check external nuts and fixings to ensure vibration caused by normal use has not begun to loosen them.

Store idle power tools out of reach of children and do not allow persons unfamiliar with the power tool or these instructions to operate the Breaker.

Locate the power tool out of reach of children, in a dry, locked unit.

Make sure that the cord is located so that it will not be stepped on, tripped over, or otherwise subjected to damage or stress.

Remove the plug from the mains socket / battery (where applicable) before carrying out any adjustment or maintenance.

Always store the power tool/machine in a dry place.

If the power cord is damaged, it must be replaced by a qualified service technician.

Keep the ventilation slots and motor housing as free of dirt and dust as possible (where applicable).

Clean the power tool/machine by rubbing it with a clean cloth and blow it clean using low-pressure compressed air is recommended.

Ensure you have all the pieces listed. If you are missing any components, contact our customer services department at support@domu.co.uk DO NOT proceed with assembly if any components are missing.

LAWN TRIMMERS & LAWN EDGE TRIMMERS

Check for misalignment or binding of moving parts, breakage of parts and any other condition that may affect the power tool's operation.

Keep cutting tools sharp and clean. Properly maintained cutting tools with sharp cutting edges are less likely to bind and are easier to control.

Hold power tool by insulated gripping surfaces, when performing an operation where the cutting accessory may contact hidden wiring or its own cord. Cutting accessory contacting a "live" wire may make exposed metal parts of the power tool "live" and could give the operator an electric shock.

Keep hands away from cutting area. Never reach underneath the workpiece for any reason. Do not insert fingers or thumb into the vicinity of the blade and blade release switch.

TECHNICAL SPECIFICATION

Rated Voltage 230V - 240V

Rated Power 1000W

Rated Frequency 50Hz

COMPONENTS

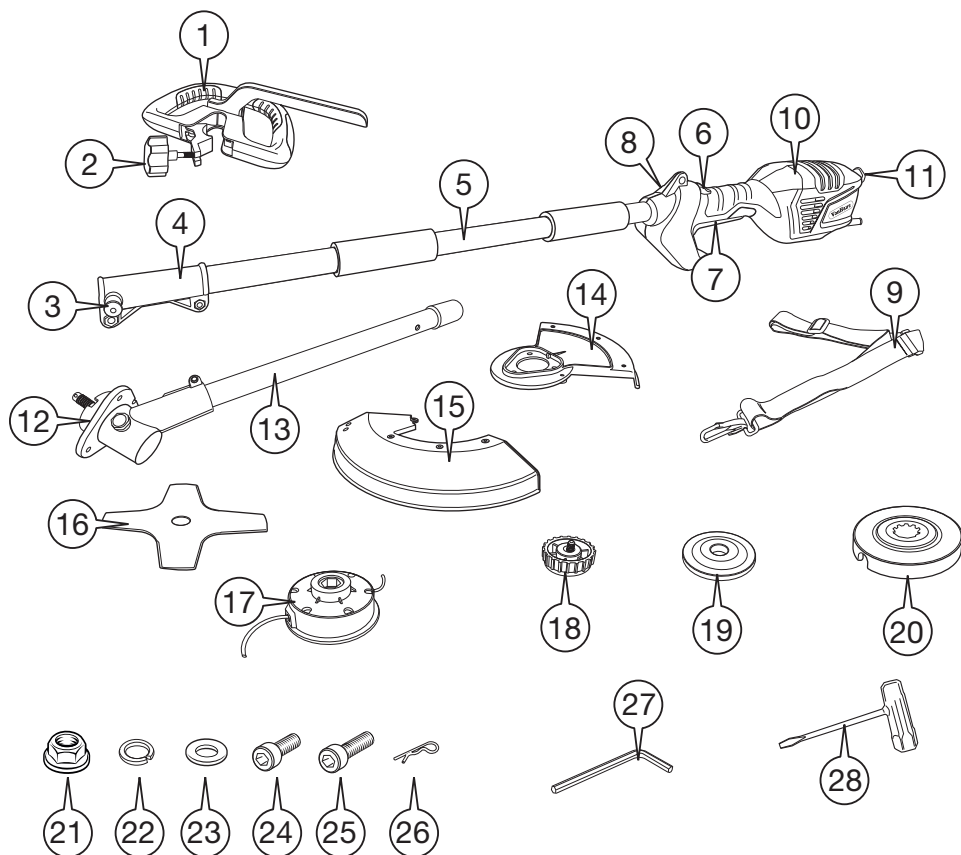

1. Auxiliary Handle/Secondary Handle .

2. Auxiliary Handle Locking Screw.

3. Spring Pin.

4. Locking Grip (not pictured).

5. Main Unit Pole.

6. Safety Switch.

7. ON/OFF Trigger.

8. Shoulder Strap Connection.

9. Shoulder Strap

10. Rear Grip.

11. Cable Hook

12. Gearbox.

13. Lower Pole.

14. Inner Mounting Plate.

15. Plastic Trimmer Guard.

16. Brush Cutter Disc.

17. Spool Assembly.

18. Spool Locking Nut (pre-assembled into 17).

19. Brush Cutter Locking Plate.

20. Coupling Plate.

21. Hex Nut x 1.

22. Spring Washer x 7

23. Washer x 7

24. Small Hex Bolt x 3.

25. Large Hex Bolt x 4.

26. Split Pin x 1.

27. Hex Key (stored on Auxiliary Handle)

28. Maintenance Tool.

HANDLE / STRAP ASSEMBLY

Adjust the Secondary Handle (1) to the left or right position using the Hex Key (27) supplied.

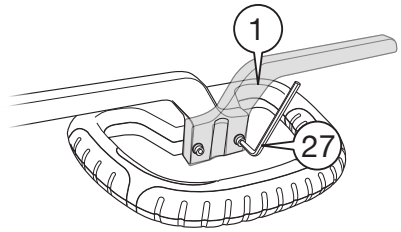

Position the Auxiliary Handle (1) to the Main Unit Pole (5) between the 2 foam grips or where the appropriate position is to obtain the best balance. Using the hinged opening, close and secure the Auxiliary Handle (1) using the Auxiliary Handle Locking Screw (2) as shown. Turn clockwise to tighten.

IMPORTANT! Ensure the Auxiliary Handle (1) is completely secure before initial use.

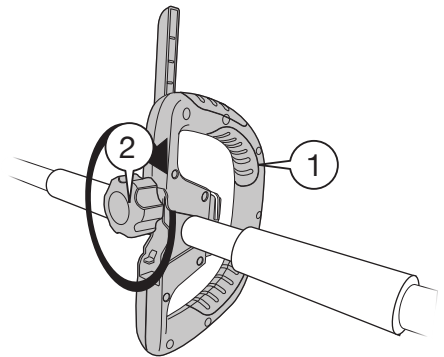

For added stability and manoeuvrability, we recommend you always attach the Shoulder Strap (9) to the Shoulder

Strap Connector (8) located on the top of the Main Unit. Adjust the length of the shoulder strap to obtain a comfortable working position. A few practice swings without starting the motor should be made to determine correct balance.

Put the shoulder strap over your right shoulder. Carry the tool motor unit at the right side of your body.

IMPORTANT: Never attach the strap diagonally across your shoulder and your breast, but rather place it on one of your shoulders. In this way you can remove the tool quickly from your body in case of danger.

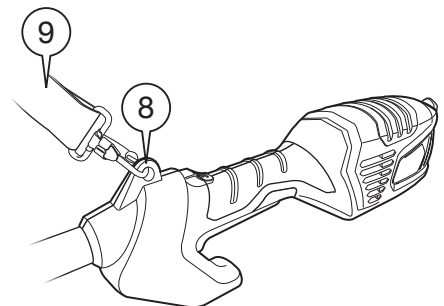

TRIMMER ASSEMBLY

Align the Gear Box (12) and Lower Pole (13) with the 3 holes on the Inner Mounting Plate (14). Secure in place from the inside using 3 Small Hex Bolts (24), 3 Washers (23) and 3 Spring Washers (22) in the order shown on the right. Tighten using the Hex Key (27) supplied.

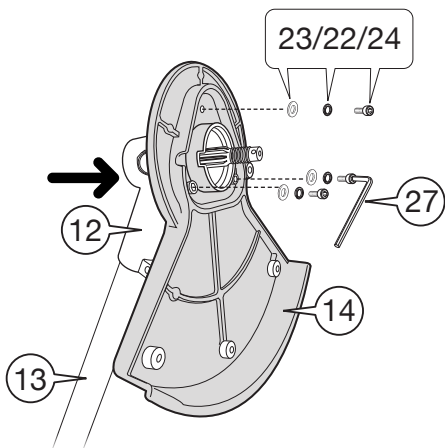

To attach the Plastic Trimmer Guard (15) to the Inner Mounting Plate (14), place the Guard on top and align the 4 holes. Insert 4 x Large Hex Bolts (25) along with the remaining Washers (23) and Spring Washers (22). Securely tighten using the Hex Key (27) supplied.

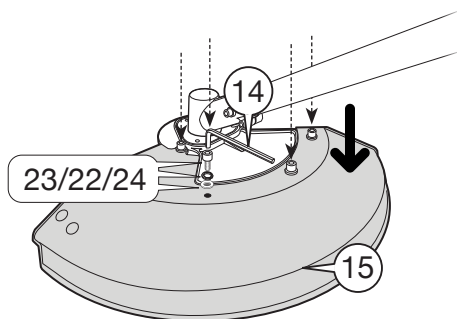

When using the Trimmer attachments, the Coupling Plate (20) must first be added. Simply slide this over the Gear Box (12) drive shaft as shown ensuring it locks onto the splines of the Gearbox shaft.

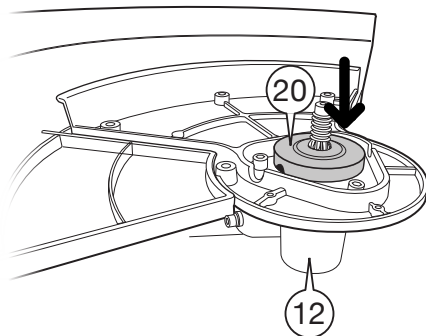

TRIMMER ASSEMBLY

With the Coupling Plate (20) in position, place the Spool Assembly (17) over the drive shaft and turn counter-clockwise to secure.

IMPORTANT! Ensure the Spool Assembly is completely secure before initial use.

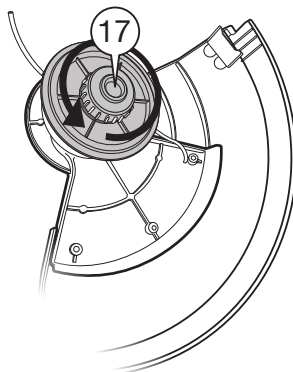

NOTE: The Gearbox shaft is a reverse thread. Counter-clockwise to tighten, clockwise to loosen.

To insert the Lower Pole (13) into the Main Unit Pole (5), simply pull back the Spring Pin (3), insert the Lower Pole (13) and secure using the Locking Grip (4). Turn clockwise to tighten.

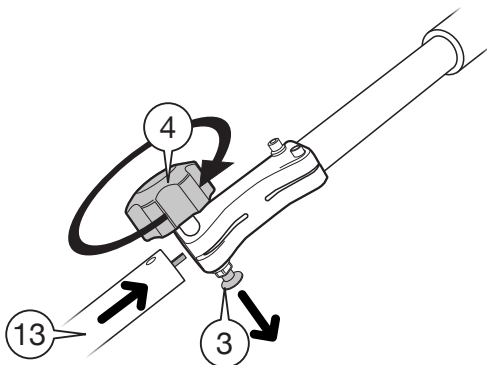

NOTE: To remove the Spool Assembly from the Gear box for cleaning & maintenance, first, turn the assembly and align the hole with the groove on the Coupling Plate. The Hex Key (27) supplied should then be inserted before turning the Assembly clockwise to unscrew.

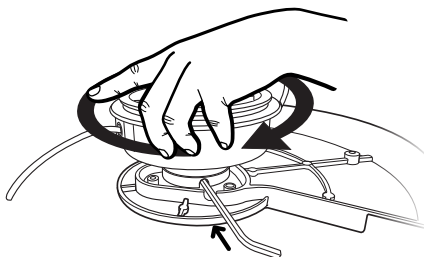

USEAGE

POWER ON/OFF

To operate, press the Safety Switch (6) forwards whilst at the same time pressing the ON/OFF Trigger (7).

Release the Safety Switch (6) once powered on.

NOTE: When the Trimmer starts up there may be some kickback, always ensure you are stood firmly and have a firm grip.

NOTE: Always ensure that the power cord is correctly wrapped around the Cable Hook (11) before use as illustrated.

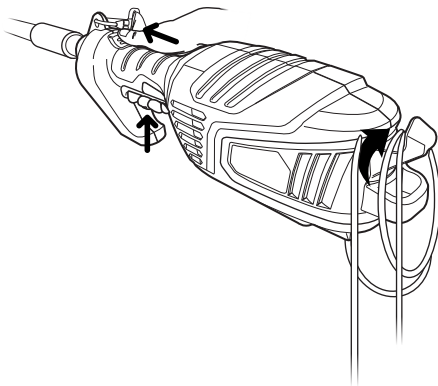

WORKING POSITION

NOTE! If you require more line, simply knock the head of the Trimmer on the floor. The Spool Locking Nut (18) doubles as a manual feed mechanism.

WARNING! Ensure the area you are cutting is completely free any stones or debris. These can cause serious damage to the Garden Tool, the user and any passers-by.

When operating the Trimmer, ensure you are holding the equipment firmly in both hands, with one hand on the rear handle and the other holding the Auxiliary Handle.

CAUTION: Never hold the Trimmer with one hand.

Holding the Auxiliary Handle/Secondary Handle (1), slightly raise the Trimmer out in front of the body at an inclined angle.

If cutting longer areas of grass, ensure you cut down in stages to prevent any grass entangling around the Spool Assembly (17).

CAUTION: Avoid lowering the Trimmer head too much as coming into contact with the ground may loosen the Spool Assembly (17).

Maintain proper footing and balance and be careful not to overreach.

Always wear safety goggles, non-slip footwear and gloves when using the Trimmer.

IMPORTANT: If poor cutting performance is experienced or the Trimmer appears to be vibrating, switch off and disconnect from the mains. This may be an indication the Spool Assembly (17) needs to be clean, adjusted or replaced.

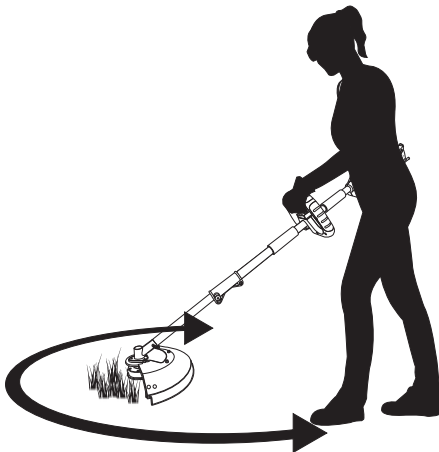

REPLACING THE SPOOL



Protect your hands.

Detach the Spool Locking Nut (18) by twisting clockwise to release. Once removed, lift the Spool Assembly (17) off the Gear Box drive shaft.

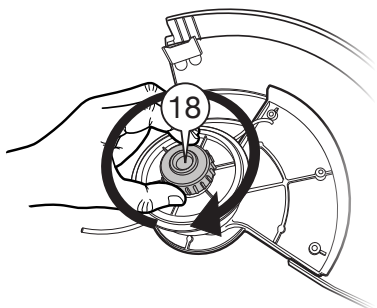

To access the Spool thread, gently push the cover down and twist clockwise to unlock. Carefully lift out the Spool carrier from the case and withdraw the Spool from the eyelets either side. Wipe clean if necessary using a damp cloth. Upon removal, you will notice a spring beneath the carrier

IMPORTANT: Ensure the spring is kept in a safe place during any maintenance.

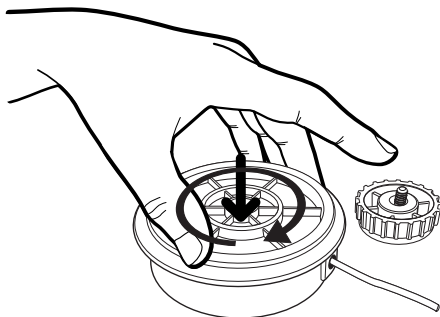

To rectify an incorrectly wound line, fold the line in half, making sure one end is slightly longer than the other. At the fold, hook this onto the inner eyelet. Ensure that both lines are now separated into each section as you tightly wind it round following the indication marker on the top, which is marked 'wind cord'.

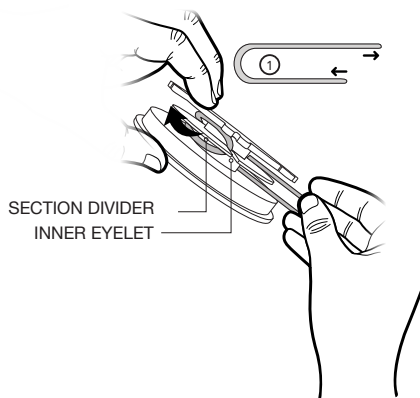

REPLACING THE SPOOL

NOTE: If the Spool Line is too long, it will automatically be cut down by the Small Blade attached to the plastic trimmer guard once the tool is switched on.

Once wound, hook one end into the outer eyelet (*fig 2*) and insert the other end through one of the eyelets on the Spool Assembly (17).

(*fig 3*). Unhook the end secured in (*fig 2*) and insert through the other eyelet on the Assembly.

NOTE: Ensure the spring from step 3 is replaced back underneath the carrier before placing the carrier back into the housing.

Replace the spool cover, firmly pushing down to click back into place.

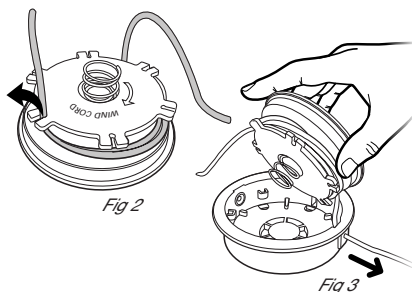

BRUSH CUTTER ASSEMBLY

Ensure the Plastic Trimmer Guard (15) has been detached from the Inner Mounting Plate (14) before using the Brush Cutter attachment.

When using the Brush Cutter attachment, the Coupling Plate (20) must first be added. Simply slide this over the Gear Box (12) drive shaft as shown.

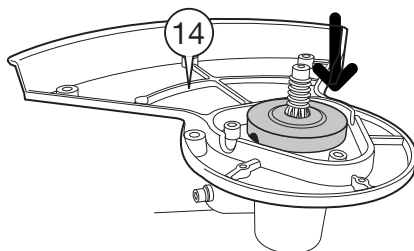

Place the Brush Cutter Disc (16) over the drive shaft so it sits flush on top of the Coupling Plate (20).

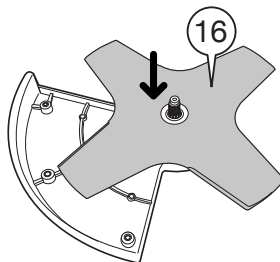

BRUSH CUTTER ASSEMBLY

Next, place the Brush Cutter Locking Plate (19) over the drive shaft.

NOTE: Ensure the flat side of this plate sits against the Brush Cutter Disc (16).

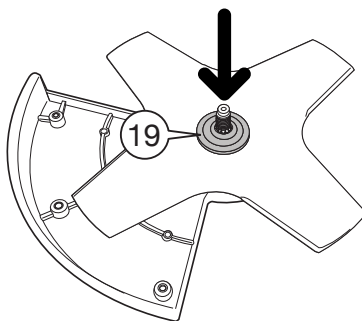

Secure all plates together using the Hex Nut (21) supplied. Tighten using the Maintenance Tool (28). Finally, insert the Split Pin (26) into the small hole of the drive shaft and bend around the Nut.

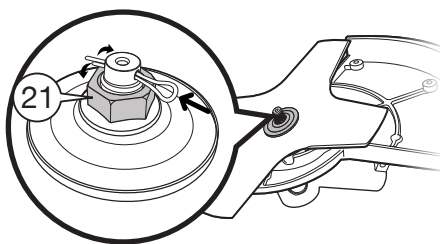

BRUSH CUTTER USEAGE

POWER ON/OFF

To operate, press the Safety Switch (6) forwards whilst at the same time pressing the ON/OFF Trigger (7).

Release the Safety Switch (6) once powered on.

NOTE: When the Brush Cutter starts up there may be some kickback, always ensure you are stood firmly and have a firm grip.

NOTE: Always ensure that the power cord is correctly wrapped around the Cable Hook (11) before use as illustrated.

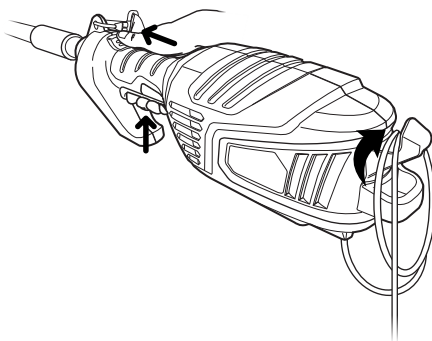

BRUSH CUTTER ASSEMBLY

WARNING! Ensure the area you are cutting is completely free any stones or debris. These can cause serious damage to the Garden Tool, the user and any passers-by.

Just like operating the Trimmer, ensure you are holding the equipment firmly in both hands when using the Brush Cutter attachment, with one hand on the rear handle and the other holding the Auxiliary Handle.

CAUTION: Never hold the Trimmer with one hand. Holding the Auxiliary Handle/Secondary Handle (1), slightly raise the Brush Cutter Disc out in front of the body at an inclined angle. Cut tall section of grass in a broad sweeping motion (right to left).

CAUTION: Do not use the Brush Cutter near fencing, posts, buildings or other immovable objects.

CAUTION: Avoid lowering the Trimmer head too much as coming into contact with the ground may damage the Brush Cutter Disc (16).

Maintain proper footing and balance and be careful not to overreach.

Always wear safety goggles, non-slip footwear and rubber gloves when using the Trimmer.

IMPORTANT: If poor cutting performance is experienced or the Brush Cutter appears to be vibrating, switch off and disconnect from the mains. This may be an indication that some grass has tangled around the Disc or the Disc is not correctly balanced.



PART MAINTENANCE



Protect your hands.

FILLING WITH GREASE

The Gearbox (12) is filled with a multi-purpose grease. It is recommended that you regularly check the quantity and fill where necessary. Remove the bolt from the side of the Gearbox (using the Maintenance Tool (28) supplied) and fill appropriately.

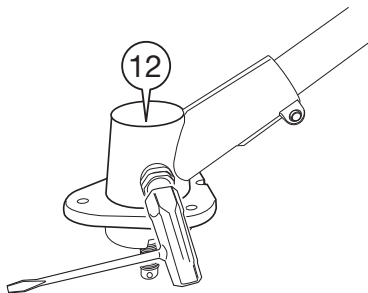

BRUSH CUTTER ASSEMBLY

SHARPENING THE BRUSH CUTTER DISC

Never attempt to sharpen the Disc (16). The Brush Cutter Disc is reversible, so should be turned over when one side is blunt (see page 11 for fitting).

The Disc must remain balanced when fitted. An unbalanced Disc will cause excessive vibration through the tool.

IMPORTANT: Always check the Brush Cutter Disc (16) before every use for any signs of damage. Never use if damaged and replace immediately with an approved replacement part.

NOTE: Disc bore size - 25.5mm.

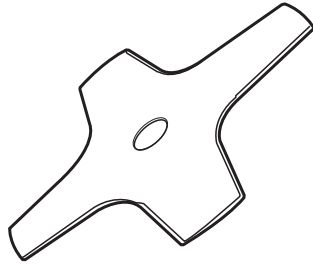

CLEANING & MAINTENANCE

Ensure all components are well lubricated before usage.

Always keep the ventilation slots in the motor housing clean and free from dust and dirt.

Never clean or spray a machine with water.

Ensure all components are well lubricated before usage.

Always keep the ventilation slots in the motor housing clean and free from dust and dirt.

Never clean or spray a machine with water.

TROUBLESHOOTING

PROBLEM	SOLUTION
Tool does not power on	<p>Ensure the tool is switched on and connected to mains power.</p> <p>Activate the ON/OFF Trigger Switch.</p> <p>Check the fuse and replace if necessary.</p>
Disc does not move	<p>Driver gear may be broken. Contact DOMU Brands Customer Services.</p>
Poor cutting performance	<p>Brush Cutter Disc may be damaged or blunt and will need changing as outlined in the 'Part Maintenance' section.</p> <p>Add more Spool line by gently knocking the head of the Spool Assembly on the ground.</p> <p>Remove and replace the Spool line.</p>
Motor becomes hot	<p>The tool has been heavily used.</p> <p>Reduce the force applied to the tool. Do not exert extra pressure, let the tool do the work.</p> <p>Air vents have become blocked. Clean the air vents using compressed air or a clean dry cloth.</p>
Vibrating abnormally	<p>Brush Cutter Disc may be loose. Tighten the Hex Nut as described on page 11.</p> <p>Disc is not mounted correctly. Check the Disc and replace if necessary.</p> <p>Machine bearings may be worn. Contact DOMU Brands Customer Services.</p>
Spool assembly is difficult to rotate	<p>A build up of grass may have tangled around the Spool Assembly. Disconnect from the mains and remove any blockages.</p>
Spool line not releasing evenly	<p>Rewind the Spool line.</p>



DISPOSAL INFORMATION Please recycle where facilities exist. Check with your local authority for recycling advice.

CUSTOMER SERVICE If you are having difficulty using this product and require support, please contact **support@domu.co.uk**

WARRANTY To register your product and find out if you qualify for a free extended warranty please go to **www.vonhaus.com/warranty**. Please retain a proof of purchase receipt or statement as proof of the purchase date. The warranty only applies if the product is used solely in the manner indicated in the warnings page of this manual, and all other instructions have been followed accurately. Any abuse of the product or the manner in which it is used will invalidate the warranty. Returned goods will not be accepted unless re-packaged in its original packaging and accompanied by a relevant and completed returns form. This does not affect your statutory rights. No rights are given under this warranty to a person acquiring the appliance second-hand or for commercial or communal use.

COPYRIGHT All material in this instruction manual are copyrighted by DOMU Brands. Any unauthorised use may violate worldwide copyright, trademark, and other laws.

THANK YOU

Thank you for purchasing your product/appliance. Should you require further assistance with your purchase, you can contact us at

support@domu.co.uk

VonHaus is a registered trademark of DOMU Brands Ltd.

Made in China for DOMU Brands. Unit 30, Stakehill Industrial Estate, Middleton, Manchester M24 2RW.

Authorised Representative: Authorised Representative Service, 77 Camden Street Lower, Dublin, D02 XE80, Ireland.

MERCI

Merci d'avoir acheté notre produit/appareil.

Si vous aviez besoin d'aide suite à votre achat, vous pouvez nous contacter à

support@domu.co.uk

VonHaus est une marque déposée de DOMU Brands Ltd.

Fabriquée en Chine pour DOMU Brands. Unit 30, Stakehill Industrial Estate, Middleton, Manchester M24 2RW.

Authorised Representative: Authorised Representative Service, 77 Camden Street Lower, Dublin, D02 XE80, Ireland.

VIELEN DANK

Vielen Dank, dass Sie das Produkt/Gerät gekauft haben. Sollten Sie weitere Unterstützung benötigen, können Sie uns gerne unter (email) kontaktieren.

support@domu.co.uk

VonHaus ist eine registrierte Handelsmarke von DOMU Brands Ltd. Hergestellt in China für DOMU Brands. Unit 30, Stakehill Industrial Estate, Middleton, Manchester M24 2RW.

Authorised Representative: Authorised Representative Service, 77 Camden Street Lower, Dublin, D02 XE80, Ireland.

GRACIAS

Gracias por comprar nuestro producto/aparato

Si requiere asistencia con vuestra compra, podeis contactarnos a

support@domu.co.uk

VonHaus es una marca registrada de DOMU Brands Ltd.

Hecha en China para DOMU Brands. Unit 30, Stakehill Industrial Estate, Middleton, Manchester M24 2RW.

Authorised Representative: Authorised Representative Service, 77 Camden Street Lower, Dublin, D02 XE80, Ireland.

GRAZIE

Grazie per aver acquistato il prodotto.

Per ulteriore assistenza sul tuo acquisto, puoi contattarci all'indirizzo email

support@domu.co.uk

VonHaus è un marchio registrato di DOMU Brands Ltd.

Made in Cina per DOMU Brands. Unit 30, Stakehill Industrial Estate, Middleton, Manchester M24 2RW.

Authorised Representative: Authorised Representative Service, 77 Camden Street Lower, Dublin, D02 XE80, Ireland.