

SRL2

Motorcycle Bluetooth®
Communication System
for Shoei Helmets

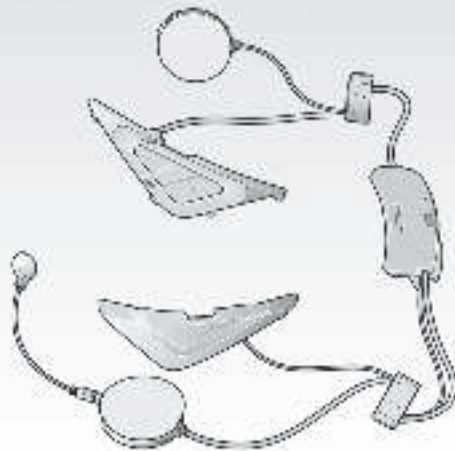

© 1998–2025 Sena Technologies, Inc. All rights reserved.

Sena Technologies, Inc. reserves the right to make any changes and improvements to its product without providing prior notice.

Sena™ is a trademark of Sena Technologies, Inc. or its subsidiaries in the USA and other countries.

The Bluetooth® word mark and logos are owned by the Bluetooth SIG, Inc. and any use of such marks by Sena is under license.

Sena Technologies, Inc.

152 Technology Drive, Irvine, CA 92618

CONTENTS

Safety Precautions	5	7 STEREO MUSIC	25
1 PACKAGE CONTENTS	8	7.1 By Bluetooth Wireless Stereo	25
2 INSTALLING THE SRL2 ON YOUR HELMET	9	7.2 Music Sharing	26
2.1 Flip Up Helmet Installation	9	7.3 Smart Volume Control (Default: Disable)	26
2.2 Full Face Helmet Installation	12	8 GPS NAVIGATION	27
3 GETTING STARTED	15	9 SENA SR10, TWO-WAY RADIO ADAPTER	27
3.1 Powering On and Off	15	10 FM RADIO	28
3.2 Charging	15	10.1 FM Radio On / Off	28
3.3 Low Battery Warning	15	10.2 Preset Stations	28
3.4 Checking the Battery Level	16	10.3 Seek and Save	28
3.5 Volume Adjustment	16	10.4 Scan and Save	29
3.6 Software	17	10.5 Temporary Preset	30
4 PAIRING THE SRL2 WITH BLUETOOTH DEVICES	17	10.6 Region Selection	30
4.1 Mobile Phone Pairing	18	10.7 RDS AF Setting (Default: Disable)	30
4.2 Second Mobile Phone Pairing	18	10.8 FM Station Guide (Default: Enable)	30
4.3 Bluetooth Stereo Device Pairing	19	11 VOICE COMMAND	31
4.4 Bluetooth GPS Navigation Pairing	19	11.1 Voice Command Setting (Default: Enable)	32
4.5 Pairing with the Sena SR10, Bluetooth Two-way Radio Adapter	21	12 INTERCOM PAIRING	32
5 PAIRING WITH SELECTIVE PROFILE: A2DP STEREO OR HANDSFREE	22	12.1 Pairing with Other SRL2 Headsets for Intercom Conversation	32
5.1 A2DP Stereo Music Only	23	12.2 Pairing with Other Sena Headset Models for Intercom Conversation	33
5.2 HFP for Phone Call Only	23	13 TWO-WAY & MULTI-WAY INTERCOM	34
6 MOBILE PHONE CALL MAKING AND ANSWERING	23	13.1 Two-way Intercom	34
6.1 Mobile Phone Call Making and Answering	23	13.2 Multi-way Intercom	34
6.2 Speed Dialing	24	14 THREE-WAY CONFERENCE PHONE CALL WITH INTERCOM PARTICIPANT	38
6.3 VOX Phone (Default: Enable)	25	15 GROUP INTERCOM	39

16 UNIVERSAL INTERCOM.....	39	23 RESET TO FACTORY DEFAULT SETTINGS.....	50
16.1 Universal Intercom Pairing.....	39	24 FAULT RESET	51
16.2 Two-way Universal Intercom.....	40	25 FIRMWARE UPGRADE.....	52
16.3 Three-way Universal Intercom.....	40	26 OPERATION QUICK REFERENCE	52
16.4 Four-way Universal Intercom.....	41		
17 ADDITIONAL INTERCOM SETTINGS	43		
17.1 Audio Multitasking™ (Default: Enable).....	43		
17.2 Intercom-Audio Overlay Sensitivity (Default: 6).....	43		
17.3 Audio Overlay Volume Management (Default: Disable).....	43		
17.4 HD Intercom (Default: Enable).....	43		
17.5 Eight-Way Intercom (Default: Disable).....	44		
17.6 Advanced Noise Control™ (Default: Enable).....	44		
18 REMOTE CONTROL	44		
19 FUNCTION PRIORITY.....	45		
20 VOICE PROMPT.....	45		
21 SIDETONE	46		
22 CONFIGURATION SETTING	46		
22.1 Phone Pairing.....	47		
22.2 Second Mobile Phone Pairing.....	47		
22.3 GPS Pairing.....	48		
22.4 Phone Selective Pairing.....	48		
22.5 Media Selective Pairing.....	48		
22.6 Delete All Bluetooth Pairing Information.....	48		
22.7 Remote Control Pairing.....	49		
22.8 Universal Intercom Pairing.....	49		
22.9 Factory Reset.....	49		
22.10 Exit Voice Configuration Menu.....	49		

Safety Precautions

Please ensure that the product is properly used by observing the safety precautions below to prevent any risk of serious injury, death and/or damage to property.

Hazard alert signal words

The following safety symbols and signal words are used in this manual.

! WARNING Indicates a potential hazardous situations that, if not avoided, could result in death or serious injury.

! CAUTION Indicates a potential hazardous situation that, if not avoided, could result in minor or moderate injury.

NOTICE Indicates information considered important, but not hazard-related. If not avoided, it could cause damage to your product.

Note Notes, usage tips, or additional information

Product Use

Observe the following precautions to avoid injury or damage to your product while using the product.

! WARNING

- Use of the product at a high volume for a long period of time may damage your eardrums or hearing ability.

- When relevant, follow all regulations regarding the use of the camera.
 - (1) Do not use your camera in an aircraft, unless permitted.
 - (2) Turn off the camera when you are near medical equipment. Your camera can cause interference with medical devices in hospital or healthcare facilities.
- The camera generates a low level magnetic field. Keep a safe distance between the camera and cardiac pacemakers to avoid potential interference. Turn off the camera immediately if your camera indicates interference with a pacemaker and contact the pacemaker manufacturer or a physician.
- Avoid interference with other electronic devices. Your camera generates a low level magnetic field that may interfere with unsealed or improperly shielded electronic equipment in homes or vehicles. Consult the manufacturers of your electronic devices to resolve any interference problems you experience.
- Never use a damaged memory card. This may result in electric shock, camera malfunction, or fire.
- Careless use of the product on the road is risky and may result in serious injury, death or damage. You must heed all safety precautions in all documents that come with this product. This will help minimize the chance these risks may occur while riding.
- In any place where wireless communication is prohibited, such as hospitals or airplanes, turn off the power. In a place where wireless communication is prohibited, electromagnetic waves may cause hazards or accidents.
- Before riding, fasten the product from the helmet, and double-check that it is properly fastened. Separation of the product while riding will cause damage to the product and may result in an accident.
- When you use the product while you operating any vehicle or equipment such as motorcycles, scooters, mopeds, ATVs, or quadbikes (hereinafter called "transportation means"), you need to follow the safety precautions provided by the manufacturer of the vehicle.
- When you use the product, use good judgment; never use it under the influence of alcohol or drugs or when you are extremely tired.

⚠ CAUTION

- If the product emits an unusual smell, feels hot, or appears abnormal in any other way while using or charging, stop using it immediately. It may cause damage, explosion, or fire. Contact your sales location if any of these problems are observed.
- Do not use the product in an explosive atmosphere. If you are in such a location, turn off the power and heed any regulations, instructions, and signs in the area.

NOTICE

- Attaching the product to the helmet is considered a modification to the helmet and may void your helmet's warranty or compromise your helmet's functionality. This may entail risks during an accident, so be fully aware of this fact before using the product. Should you not accept this fact, you may return the product for a full refund.
- In some regions, it is prohibited by law to ride motorcycles while wearing headsets or earbuds. Therefore be certain you are aware of all relevant laws in the region where you are using the product and are sure that you comply with them.
- The headset is for motorcycle helmets only. To install the headset, you must follow the installation instructions shown in the User's Guide.
- Do not impact the product with sharp tools as this may damage the product.
- Keep product away from pets or small children. They may damage the product.
- Any changes or modifications to the equipment not expressly approved by the party responsible for compliance could void the limited warranty to operate the equipment.
- High internal temperature may result in noisy photos. This is not a malfunction and does not affect your camera's overall performance.
- Check that the camera is operating properly in advance. Any file loss or camera damage caused by camera malfunction or improper use is not covered under warranty.

Battery

Your product has a built-in battery. Be careful to heed all safety information in this guide. Failure to carefully observe the safety precautions can cause battery heat generation, bursting, fire and serious personal injury.

⚠ WARNING

- Do not use the product in direct sunlight for a long period of time. Doing so can damage the product and generate heat that can cause burns.
- Do not use or store the product inside cars in hot weather. It may cause the battery to generate heat, rupture, or ignite.
- Do not continue charging the battery if it does not recharge within the specified charging time. Doing so may cause the battery to become hot, explode, or ignite.
- Do not leave the product near open flames. Do not dispose of the product in a fire. It may cause the battery to become hot, explode, or ignite and cause serious injury.
- Never attempt to charge a battery with the charger which has been physically damaged. It may cause explosion and/or accidents.

NOTICE

- Battery life may vary depending on conditions, environmental factors, functions of the product in use, and devices used with it.

Product Storage and Management

Take the following precautions to avoid personal injury or damage to your product while storing and maintaining the product.

CAUTION

- Do not dispose of the product with household waste. The built-in battery is not to be disposed of in municipal waste stream and requires separate collection. Disposal of the product should be done in accordance with the local regulations.

NOTICE

- Keep the product free of dust. Dust may damage mechanical and electronic parts of the product.
- The product should be stored at room temperature. Do not expose the product to extremely high or low temperature as this may reduce the life span of electronic devices, damage the battery, and/or melt plastic parts of the product.
- Do not clean the product with cleaning solvents, toxic chemicals, or strong detergents as this may damage the product.
- Do not paint the product. Paint may obstruct moving parts or interfere with the normal operation of the product.
- Do not drop or otherwise shock the product. It may damage the product or its internal electronic circuits.
- Do not disassemble, repair or modify the product as this may damage the product and invalidate the product warranty.
- Do not store the product in humid environments, especially for long periods of time. It may damage the internal electronic circuits.
- Battery performance will deteriorate over time if stored for a long period of time without being used.

- Do not store the camera in proximity to magnetic fields. Doing so may result in camera malfunction.
- Be careful to protect the lens by avoiding rough handling or physical shock.
- Wipe the surface of the lens with a soft cloth in the following situations:
 - (1) When there are fingerprints on the lens surface.
 - (2) When the lens is used in hot or humid environments, such as near oceans or rivers.
- Store the product in a well-ventilated room to protect the lens from dirt and dust.

1 PACKAGE CONTENTS

- **Headset Main Unit**

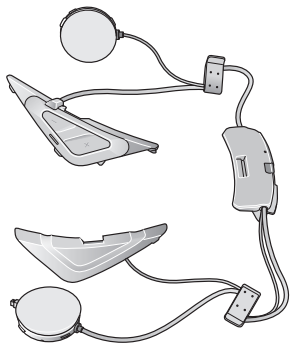

Wired Boom Microphone for Flip Up Helmets

- **Wired Boom Microphone**



- **Microphone Sponges (2)**



Wired Microphone for Full Face Helmets

- **Wired Microphone**



- **Hook and Loop Fastener for Wired Microphone for Full Face Helmet**



Others

- **USB Power & Data Cable (Micro USB Type)**



2 INSTALLING THE SRL2 ON YOUR HELMET

SRL2 compatible SHOEI helmets can be found by scanning the QR code of the product box.

2.1 Flip Up Helmet Installation

To securely install the SRL2 on the flip up helmet, please follow this procedure.

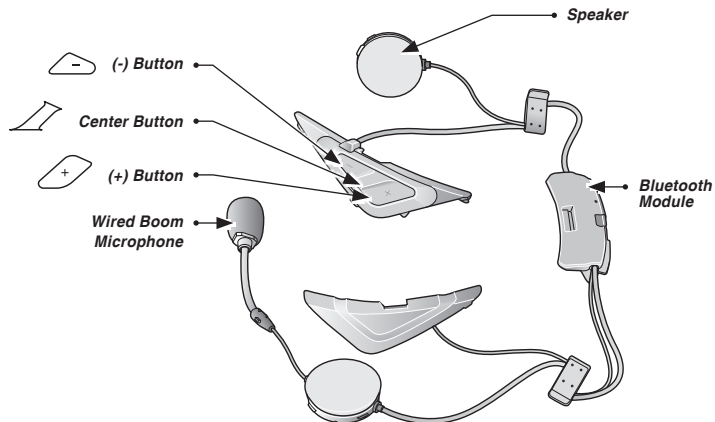

2.1.1 Preparing the helmet for installation

1. Press the open cover button. While pressing the button, lift the face cover completely.

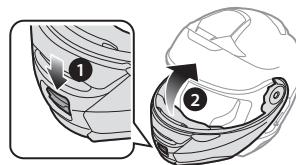

2. Push the tab on the right cover with your thumb.

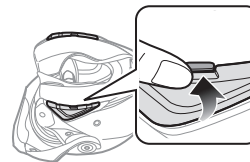

3. While pushing the tab, insert the service tool into the groove and push to remove the cover.

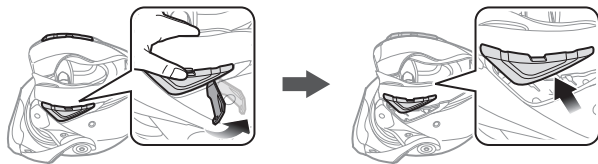

4. Repeat the process on the other side to remove the left cover.
5. Push the tab on the rear cover and remove the rear cover with your thumbs.

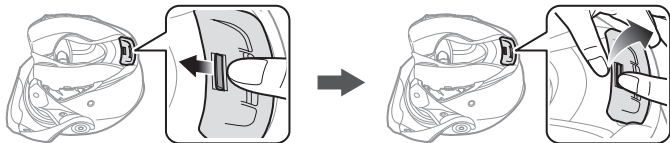

6. Detach the snap fasteners of the internal paddings and remove the paddings from the helmet.



2.1.2 Installing the headset

1. Align the arrows on the right side speaker unit with the microphone cable and insert the microphone cable into the microphone connector.

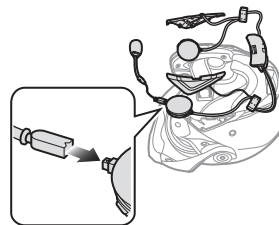

2. Facing the USB port on the Bluetooth module toward the rear of the helmet, push the module into the corresponding slot until you hear a click.

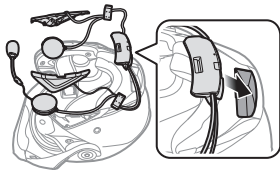

3. Insert the helmet speakers and the microphone into the grooves in the inner shell of the helmet.
4. Slide the antenna into the corresponding place. Make sure that the grooves under the antenna fit the corresponding grooves.

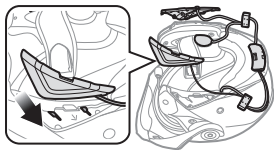

5. Repeat the process on the other side to install the button module.

6. Slide the left and right clips into their corresponding sides between the external shell and the inner shell.

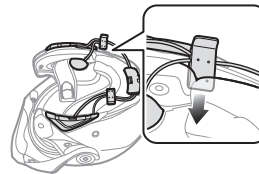

7. Reattach the internal paddings beginning with the rear and click the snap fasteners.



8. Lower the face cover completely.

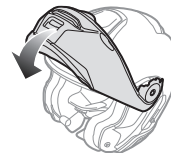

2.2 Full Face Helmet Installation

To securely install the SRL2 on the full face helmet, please follow this procedure.

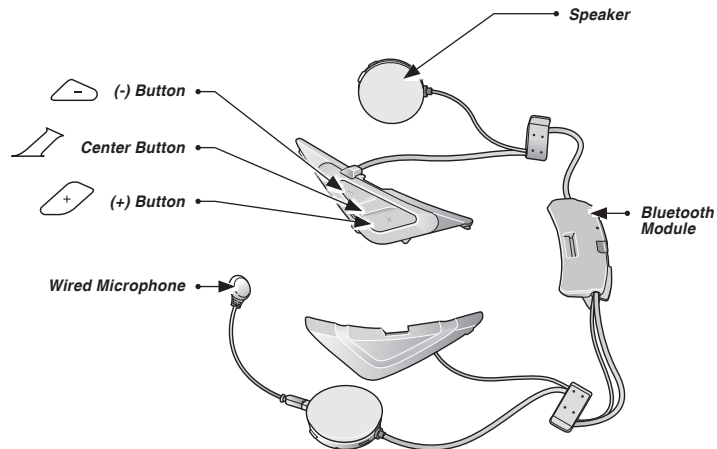

2.2.1 Preparing the helmet for installation

1. Push the tab on the right cover with your thumb.



2. While pushing the tab, insert the service tool into the groove and push to remove the cover.

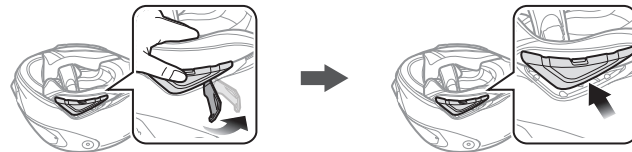

3. Repeat the process on the other side to remove the left cover.

4. Push the tab on the rear cover and remove the rear cover with your thumbs.

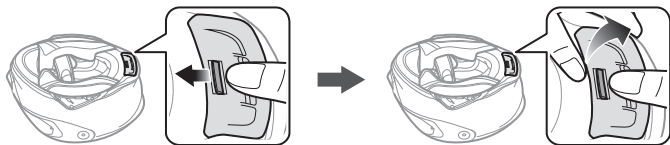

5. Detach the snap fasteners of the internal paddings and remove the paddings from the helmet.

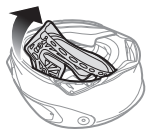

2.2.2 Installing the headset

1. Align the arrows on the right side speaker unit with the microphone cable and insert the microphone cable into the microphone connector.

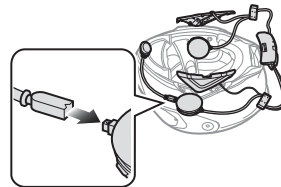

2. Facing the USB port on the Bluetooth module toward the rear of the helmet, push the module into the corresponding slot until you hear a click.

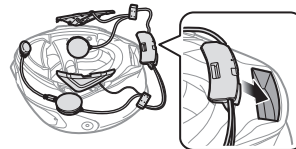

3. Insert the helmet speakers into the grooves in the inner shell of the helmet.

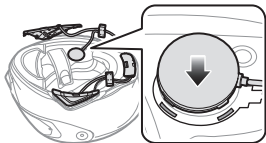

4. Peel off the cover of the adhesive tape of the hook and loop fastener for microphone and attach it to the inside of the helmet's chin guard. Then, attach the wired microphone to the hook and loop fastener.

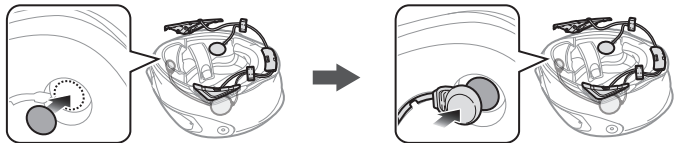

5. Slide the antenna into the corresponding place. Make sure that the grooves under the antenna fit the corresponding grooves.

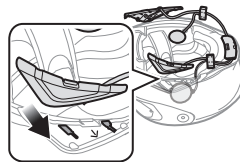

6. Repeat the process on the other side to install the button module.
7. Slide the left and right clips into their corresponding sides between the external shell and the inner shell.

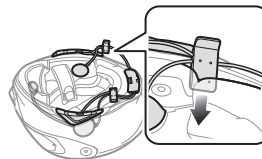

8. Reattach the internal paddings beginning with the rear and click the snap fasteners.



3 GETTING STARTED

3.1 Powering On and Off

When powering on the headset, press the Center Button and the (+) Button at the same time for 1 second. When powering off the headset, tap the Center Button and the (+) Button at the same time until the red LED appears briefly and the headset turns off completely while hearing descending beeps.

3.2 Charging



WARNING

When charging the battery, use only the approved charger provided by the manufacturer. Use of a non-approved charger may cause fire, explosion, leakage, and other hazards which may also reduce the life time or performance of the battery.

You can charge the SRL2 by connecting the supplied USB power & data cable into a computer's USB port or USB wall charger. You can use any standard micro-USB cable to charge the SRL2. The LED turns red while the headset is charging and turns blue when it is fully charged. It takes about 2.5 hours to be completely charged.

Note:

Any 3rd party USB charger can be used with Sena products if the charger is approved by either the FCC, CE, IC or other locally approved agencies that Sena accepts.



CAUTION

Please make sure to take off your SRL2-installed helmet while charging. The headset automatically turns off during charging.

3.3 Low Battery Warning

When the battery is low, the blinking blue LED in stand-by mode turns to red and you will hear a voice prompt saying **“Low Battery”**.

3.4 Checking the Battery Level

You can check the battery level in two different ways when the headset is powering on.

3.4.1 LED Indicator

When the headset is powering on, the red LED flashes rapidly indicating the battery level.

4 flashes = High, 70~100%

3 flashes = Medium, 30~70%

2 flashes = Low, 0~30%

Note:

- 1. The battery performance may be reduced over time with usage.*
- 2. Battery life may vary depending on conditions, environmental factors, functions of the product in use, and devices used with it.*

3.4.2 Voice Prompt Indicator

When you power on the headset, press and hold the Center Button and the (+) Button for more than 6 seconds until you hear three, high-toned beeps. Then you will hear voice prompt indicating the battery level. However, if you release the buttons as soon as the headset turns on, you will not hear the voice prompt of battery level indication.

Note:

If the Voice Command setting is disabled, press and hold the Center Button and the (+) Button for more than 3 seconds as the Bluetooth system powers on.

3.5 Volume Adjustment

You can raise or lower the volume by tapping the (+) Button or the (-) Button. The volume is set and maintained independently at different levels for each audio source even when you turn off and on the headset. For example, once you set the volume for mobile phone handsfree, it will not change even if you adjust the volume for your Bluetooth MP3 music. So you can always maintain the preferred optimum volume level for each audio source.

**WARNING**

Use of the product at a high volume for a long period of time may damage your eardrums or hearing ability. Keep the volume at a modest level to prevent damage.

3.6 Software

3.6.1 SRL Series Updater Software

The SRL Series Updater Software allows you to upgrade the firmware. It is available to download for both Windows and Mac. For more information on downloading the SRL Series Updater Software, please visit www.sena.com.

3.6.2 Sena Motorcycles App

The Sena Motorcycles App allows you to configure the device settings, create groups of intercom friends, and view the quick start guide. Simply pair your phone with your SRL2 headset, run the Sena Motorcycles App and you can configure its settings directly from your smartphone. You can download the Sena Motorcycles App for Android or iPhone from www.sena.com.

4 PAIRING THE SRL2 WITH BLUETOOTH DEVICES

Before using the SRL2 Bluetooth headset with any other Bluetooth devices for the first time, you will need to pair them together. It can be paired with Bluetooth mobile phones, Bluetooth stereo devices such as MP3 players, or motorcycle specific Bluetooth GPS navigation, and with other Sena Bluetooth headsets. This pairing operation is only required once for each Bluetooth device. The headset remains paired with the devices and automatically reconnects to them when they are within range. You will hear high-toned double beeps and a voice prompt when the headset connects to the paired device automatically: **“Phone connected”** to a mobile phone, **“Media connected”** to a Bluetooth stereo device.

4.1 Mobile Phone Pairing

1. Turn on the SRL2 and press the Center Button for 12 seconds until you hear high-toned double beeps. You will hear a voice prompt saying **“Configuration menu”**.
2. Within 2 seconds, tap the (+) Button until the LED flashes red and blue alternately and you hear multiple beeps. You will hear a voice prompt saying **“Phone pairing”**.
3. Search for Bluetooth devices on your mobile phone. Select the Sena SRL2 in the list of the devices detected on the mobile phone.
4. Enter 0000 for the PIN. Some mobile phones may not ask for the PIN.
5. The mobile phone confirms that pairing has been completed and the SRL2 is ready to use. You will hear a voice prompt from the SRL2 saying **“Your headset is paired”**.
6. If the pairing process is not completed within three minutes, the SRL2 will return to stand-by mode.

4.2 Second Mobile Phone Pairing

Typical Bluetooth headsets can connect with only one Bluetooth device, but a second mobile phone pairing allows the headset to connect with another Bluetooth device such as a second mobile phone, an MP3 Player, or the Sena SR10, the Bluetooth adapter.

1. To pair the second mobile phone, press the Center Button for 12 seconds until you hear high-toned double beeps. You will hear a voice prompt saying **“Configuration menu”**.
2. Within 2 seconds, double tap the (+) Button, then the LED turns to blue flashing and the beeps turn to high-toned double beeps. You will hear a voice prompt saying **“Second mobile phone pairing”**.
3. Search for Bluetooth devices on your mobile phone. Select the Sena SRL2 in the list of the devices detected on the mobile phone.
4. Enter 0000 for the PIN. Some mobile phones may not ask for the PIN.
5. The mobile phone confirms that pairing has completed and the SRL2 is ready to use. You will hear a voice prompt from the SRL2 saying **“Your headset is paired”**.
6. If you want to pair the Sena SR10, Bluetooth adapter, please refer to the section 4.5, *“Pairing with the Sena SR10, Bluetooth Two-way Radio Adapter”*.

Note:

If you have two audio (A2DP) devices connected to your headset then the audio from one device will interrupt the audio from the other device. For example, if you are playing music from the primary mobile phone, then it can be interrupted by playing music from the secondary mobile phone and vice versa.

4.3 Bluetooth Stereo Device Pairing

1. If a Bluetooth stereo device is integrated with the mobile phone such as smartphones, you don't need to pair the SRL2 with it separately. When the SRL2 is paired with the mobile phone, it is also paired as a stereo music device.
2. If you have a stand alone Bluetooth stereo device, follow the pairing procedure separately. The procedure is the same as the procedure in *section 4.1, "Mobile Phone Pairing"*.

Note:

1. If Bluetooth connection between the headset and a mobile phone is disconnected, press the Center Button for 3 seconds to recover the Bluetooth connection immediately.
2. If Bluetooth connection between the headset and a media player is disconnected, press the Center Button for 1 second to recover the Bluetooth connection and play.

4.4 Bluetooth GPS Navigation Pairing

4.4.1 GPS Pairing

1. Turn on the headset and press the Center Button for 12 seconds until you hear high-toned double beeps. You will hear a voice prompt saying **"Configuration menu"**.
2. Within 2 seconds, tap the (+) Button 3 times, then the LED turns to green flashing and the beeps turn to multiple mid-toned beeps. You will hear the voice prompt, **"GPS pairing"**.
3. Search for Bluetooth devices on the GPS navigation screen. Select the Sena SRL2 in the list of the devices detected on the GPS.
4. Enter 0000 for the PIN.
5. The GPS confirms that pairing has completed and the SRL2 is ready to use. You will hear a voice prompt from the SRL2 saying **"Your headset is paired"**.
6. If the pairing process is not completed within three minutes, the SRL2 will return to stand-by mode.

Note:

If you pair your GPS device via GPS Pairing, its instructions will not interrupt your intercom conversations, but overlay with them.

The pairing diagram for GPS pairing is shown in the figure below.

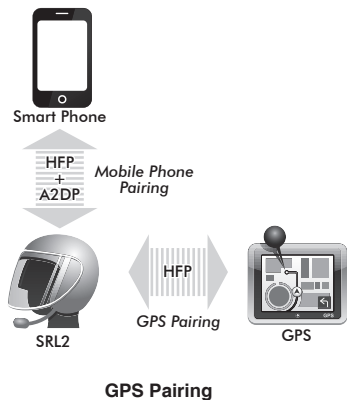

4.4.2 GPS Pairing as Mobile Phone

If a GPS is not only used for turn-by-turn voice instructions but also is your preferred Bluetooth stereo music source, you can pair the GPS to the SRL2 by following the simple procedures in *section 4.1, "Mobile Phone Pairing"*. However, since some GPS systems support mobile phone bridging over Bluetooth, you can pair the mobile phone to the GPS to use your mobile phone. When you do this, the SRL2 thinks the GPS is a mobile phone so you can no longer pair your mobile phone to the SRL2 directly. Please refer to the user's guide of your GPS for details.



Note:

You have to use a motorcycle specific GPS which transmits turn-by-turn voice instruction to the headset by Bluetooth. Most automotive GPS systems don't have this feature.

4.5 Pairing with the Sena SR10, Bluetooth Two-way Radio Adapter

The Sena SR10 is a Bluetooth two-way radio adapter for group communication, and uses HFP as do most motorcycle specific GPS navigation systems. If you pair the SRL2 with an SR10 by second mobile phone pairing, the SRL2 is able to have two HFP devices at the same time: a mobile phone and the Sena SR10.

1. Turn on the headset and press the Center Button for 12 seconds until you hear high-toned double beeps. You will hear a voice prompt saying **“Configuration menu”**.
2. Within 2 seconds, double tap the (+) Button, then the LED turns to blue flashing and the beeps turn to high-toned double beeps. You will hear a voice prompt saying **“Second mobile phone pairing”**.
3. Turn on the SR10 and follow the SR10's “Bluetooth Headset Pairing” procedure to complete the process. Please refer to the SR10 User's Guide for details.

4. When the pairing is completed, you will hear a voice prompt saying **“Your headset is paired”**.
5. If the pairing process is not completed within three minutes, the SRL2 will return to stand-by mode.

The incoming audio from the two-way radio via SR10 is heard in the background while having an intercom conversation or a mobile phone call. You can listen to music, answer a mobile call, have an intercom conversation and use a two-way radio via the SR10 for group communication as shown in the figure below. A GPS navigation or a radar detector which has a headphone jack or audio line-out could be connected to the SR10 by a wire. The GPS voice instruction or the radar detector alarm is also heard in the background via the SR10 while having an intercom conversation or a phone call. Please refer to the SR10 User's Guide for details.

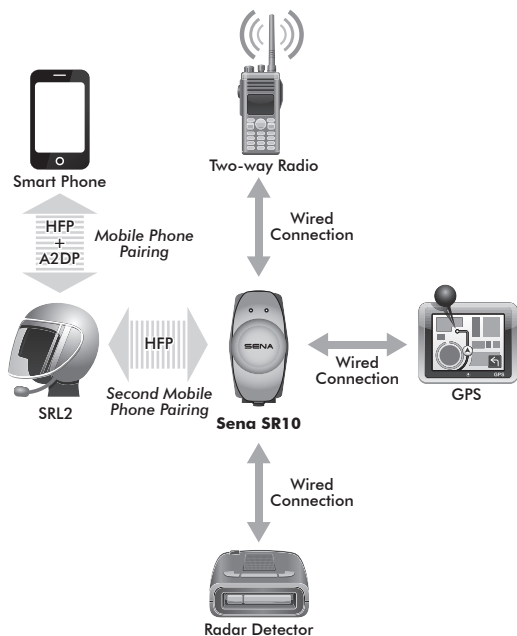

**Parallel Connection of SR10 and Mobile Phone by
Bluetooth Second Mobile Phone Pairing**

5 PAIRING WITH SELECTIVE PROFILE: A2DP STEREO OR HANDSFREE

If you have an MP3 stereo music phone such as a smartphone, sometimes you may need to selectively use the SRL2 for A2DP stereo music only or for mobile phone handsfree only. These instructions are for advanced users who want to pair the SRL2 to their smartphones only with one selective profile: A2DP for stereo music or HFP for phone calls.

If you have previously paired a mobile phone to the SRL2, you must clear the previous pairing list on both devices; the mobile phone and SRL2. To clear the pairing list on SRL2, please do a factory reset or follow the pairing list clearing procedure described in this manual. To clear the pairing list on the mobile phone, please refer to the mobile phone manual. For most smartphones, delete the Sena SRL2 from the list of Bluetooth devices in the settings menu.

5.1 A2DP Stereo Music Only

1. Turn on the headset and press the Center Button for 12 seconds until you hear high-toned double beeps. You will hear a voice prompt saying **“Configuration menu”**.
2. Within 2 seconds, tap the (+) Button 5 times, then the LED turns to red flashing and the beeps turn to double mid-toned beeps. You will hear a voice prompt saying **“Media selective pairing”**.
3. Search for Bluetooth devices on your smartphone. Select the Sena SRL2 in the list of devices detected on your phone.
4. Enter 0000 for the PIN. Some smartphones may not ask for PIN.

5.2 HFP for Phone Call Only

1. Turn on the headset and press the Center Button for 12 seconds until you hear high-toned double beeps. You will hear a voice prompt saying **“Configuration menu”**.
2. Within 2 seconds, tap the (+) Button 4 times, then the LED turns to blue flashing and the beeps turn to multiple mid-toned beeps. You will hear a voice prompt saying **“Phone selective pairing”**.
3. Search for Bluetooth devices on your smartphone. Select the Sena SRL2 in the list of devices detected on your phone.
4. Enter 0000 for the PIN. Some smartphones may not ask for PIN.

6 MOBILE PHONE CALL MAKING AND ANSWERING

6.1 Mobile Phone Call Making and Answering

1. When you have an incoming call, simply tap the Center Button to answer the call.
2. You can also answer the incoming call by loudly speaking any word of your choice if Voice Activated Phone Answering (VOX Phone) is enabled, unless you are connected to intercom.
3. To end a call, press the Center Button for 2 seconds, or wait for the called person to end the call.
4. To reject a call, press the Center Button for 2 seconds until you hear a voice prompt saying **“Call Rejected”**.
5. There are several ways to make a phone call:
 - Enter numbers on your mobile phone's keypad and make a call. Then the call is automatically transferred to the headset.
 - In stand-by mode, press the Center Button for 3 seconds, to activate the voice dialer of your mobile phone. For this, the voice dialing function must be available on the mobile phone. Refer to your mobile phone manual for further instruction.

Note:

1. If you are using second mobile phone connection and you have an incoming call from the second phone during the call of the first phone, then you may still receive the call from second phone. In this case, the call from the first phone is on waiting mode. If you end a call, then it will automatically guide you to the first phone call.
2. If you are using second mobile phone connection of mobile phone and GPS, you may not be able to listen to the GPS voice instruction during the phone call.

6.2 Speed Dialing

6.2.1 Assigning Speed Dial Presets

You can assign phone numbers for speed dialing through the Sena Motorcycles App. Please visit the Sena Bluetooth website at www.sena.com for more information.

6.2.2 Using Speed Dial Presets

You can quickly make a phone call by using the voice speed dial menu.

1. To enter into the voice speed dial menu, press the (+) Button for 3 seconds and you will hear a mid-toned single beep and a voice prompt saying **“Speed dial”**.

2. Tap the (+) Button or the (-) Button to navigate between the menus. You will hear voice prompts for each menu item.
3. Tap the Center Button to select a voice menu among the followings:

(1) Last number redial

(4) Speed dial 3

(2) Speed dial 1

(5) Cancel

(3) Speed dial 2

4. To redial the last number called, tap the Center Button when you hear a voice prompt saying **“Last number redial”**.
5. To call one of the speed dials, tap the Center Button when you hear the voice prompt, **“Speed Dial (#)”**.
6. If you want to exit the speed dial immediately, tap the (+) Button or the (-) Button until you hear a voice prompt saying **“Cancel”**, and tap the Center Button. If any button is not pressed within 15 seconds, the SRL2 will exit the voice speed dial menu and go back to stand-by mode.

Note:

1. Make sure that you connect the mobile phone and the headset in order to use the speed dial function.
2. Speed dial needs to be setup through the Sena Motorcycles App first.

Answer	Tap the Center Button or Say “Hello”
End	Press the Center Button for 2 seconds
Reject	Press the Center Button for 2 seconds
Call	Use phone keypad
Speed Dial	Press the (+) Button for 3 seconds
Voice Dial	Press the Center Button for 3 seconds

Mobile Phone Call Button Operations

6.3 VOX Phone (Default: Enable)

You can enable or disable VOX Phone through the Sena Motorcycles App. If this feature is enabled, you can answer incoming calls by simply saying a word loudly enough, unless you are connected to intercom. For example, when you hear a series of beeps for an incoming call, you can answer the phone by saying **“Hello”** or any other word loudly. However, the VOX Phone feature does not work if you are connected to intercom. If this mode is disabled, you have to tap the Center Button to answer an incoming call.

7 STEREO MUSIC

You can listen to stereo music by Bluetooth wireless stereo.

7.1 By Bluetooth Wireless Stereo

The Bluetooth audio device must be paired with the SRL2 by following the “Bluetooth Stereo Device Pairing” procedures described in the *section 4.3*. The SRL2 supports the Audio/Video Remote Control Profile (AVRCP), so if your Bluetooth audio device also supports the AVRCP, you can use the SRL2 to remotely control music playback. Not only can you adjust the volume but you can also use functions such as play, pause, next track and previous track. If the Audio Multitasking feature is enabled, you can listen to music while having an intercom conversation.

1. To adjust the volume, tap the (+) Button or the (-) Button.
2. To play or pause music, press and hold the Center Button for 1 second until you hear double beeps.
3. To track forward or track back, press and hold the (+) Button or the (-) Button for 1 second.

7.2 Music Sharing

You can start sharing music with an intercom friend using Bluetooth stereo music during a two-way intercom conversation.

1. Enter into a two-way intercom and press the (-) Button for 3 seconds to start sharing music until you hear a voice prompt saying **“Music sharing on”**.
2. To track forward or track back, press and hold the (+) Button or the (-) Button for 1 second.
3. To terminate music sharing, press the (-) Button for 3 seconds until you hear a voice prompt saying **“Music sharing off”**.

Please refer to *section 13* for more information on intercom connections.

Note:

1. Audio Multitasking must be enabled to use music sharing. Please refer to *section 17.1* or more details on the Audio Multitasking feature.
2. Both you and your intercom friend can remotely control music playback during music sharing such as track forward and track back.
3. When you have an incoming call, make a phone call, or hear the turn-by-turn voice instruction of GPS during music sharing, the function will be paused.

7.3 Smart Volume Control (Default: Disable)

You can enable or disable Smart Volume Control through the Sena Motorcycles App. Enabling Smart Volume Control automatically changes the level of the speaker volume based on the level of the environment noise. You can enable it by setting the sensitivity to low, medium or high.

8 GPS NAVIGATION

If you pair a Bluetooth GPS to the SRL2 as described in *section 4.4, "Bluetooth GPS Navigation Pairing"*, you can hear the voice instruction of the GPS while having an intercom conversation. The GPS voice instruction does not interrupt intercom conversations.

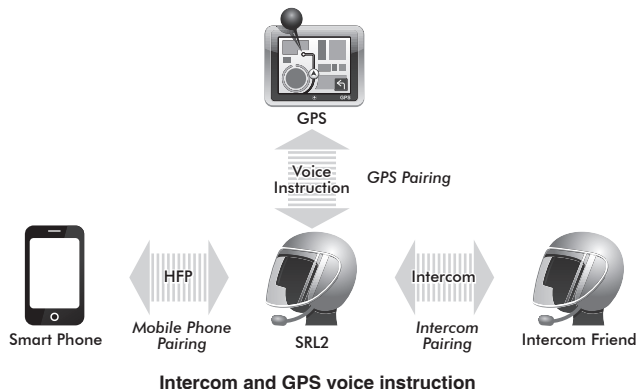

9 SENA SR10, TWO-WAY RADIO ADAPTER

As described in *section 4.5*, you can use a two-way radio and the SRL2 Bluetooth intercom simultaneously by using the Sena SR10, a Bluetooth Two-way Radio Adapter, along with the SRL2. Incoming audio from the two-way radio will not interrupt an intercom conversation but is heard in background. This is useful when you have an intercom conversation with a passenger on the back seat and use a two-way radio for group communication with other motorcycle riders.

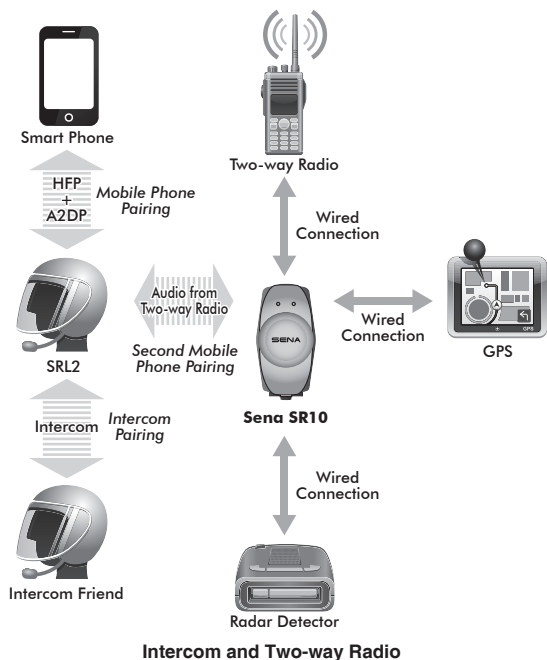

10 FM RADIO

10.1 FM Radio On / Off

To turn on the FM radio, press and hold the (-) Button for 1 second until you hear mid-toned double beeps. You will then hear a voice prompt saying “**FM on**”. In order to turn off the FM radio, press and hold the (-) Button for 1 second until you hear a voice prompt saying “**FM off**”. When you power it off, the SRL2 will remember the last station frequency. When you power it on and turn on the FM radio, the last station frequency will be playing.

10.2 Preset Stations

You can listen to preset stations while listening to the FM radio. Press the Center Button for 1 second to go upward to your next saved preset station.

10.3 Seek and Save

“Seek” is the function that searches for station to station frequencies. To use the “Seek” function, please follow the procedure below:

1. Double tap the (+) Button to search up the radio stations or the (-) Button to search down radio stations.

2. If the tuner finds a station while searching frequencies, it stops the seek function.
3. To save the current station, press the Center Button for 3 seconds until you hear a voice prompt saying **“Preset (#)”**.
4. Tap the (+) Button or the (-) Button, in order to select which preset number you want for that specific station. You can save up to 10 preset stations. (You may cancel the preset operation by waiting approximately 10 seconds. You will then hear **“Save preset cancelled”**. You can also tap the (+) Button or the (-) Button until you hear **“Cancel”**. Press the (+) Button for 1 second to confirm cancellation. You will then hear **“Save preset cancelled”**.)
5. To save the current station, press the (+) Button for 1 second. You will then hear a voice prompt saying **“Save preset (#)”**.
6. To delete the saved station in the preset number, press the (-) Button for 1 second. You will then hear a voice prompt saying **“Delete preset (#)”**.

Note:

1. You can save FM stations to presets using the Sena Motorcycles App. It allows you to save up to 10 FM station frequency presets on the SRL2 settings menu.
2. You can still answer an incoming phone call and intercom while listening to the FM radio.

10.4 Scan and Save

"Scan" is the function that automatically searches station frequencies, starting from the current frequency and up. To use the scan function, please follow the procedures below:

1. Press and hold the (+) Button for 1 second. Then the current station frequency moves upward to find other station frequencies.
2. If the tuner finds a station, it stays at the station frequency for 8 seconds, then searches the next station frequency.
3. Scan function stops when you press and hold the (+) Button for 1 second.
4. To save a station while scanning frequencies, tap the Center Button when at that station. You will hear a voice prompt saying **“Save preset (#)”**. The station will be saved as the next preset number.
5. All stations preset during "Scan" will overwrite previously set stations.

10.5 Temporary Preset

With the temporary preset function, you may temporarily preset stations automatically without changing the existing preset stations. Tap the (+) Button three times to automatically scan for 10 temporary preset stations. The temporary preset stations will be cleared when the system is powered off.

10.6 Region Selection

You can select the proper FM frequency region through the Sena Motorcycles App. With the region setting, you may optimize the seek function to avoid unnecessary frequency ranges.

Region	Frequency range	Step
Worldwide	76.0 ~ 108.0 MHz	± 100 kHz
Americas	87.5 ~ 107.9 MHz	± 200 kHz
Asia	87.5 ~ 108.0 MHz	± 100 kHz
Australia	87.5 ~ 107.9 MHz	± 200 kHz
Europe	87.5 ~ 108.0 MHz	± 100 kHz
Japan	76.0 ~ 95.0 MHz	± 100 kHz

10.7 RDS AF Setting (Default: Disable)

You can enable or disable RDS AF setting through the Sena Motorcycles App. RDS AF allows a receiver to re-tune to the second frequency location when the first signal becomes too weak. With RDS AF enabled on the receiver, a radio station with more than one frequency can be used.

10.8 FM Station Guide (Default: Enable)

You can enable or disable FM Station Guide through the Sena Motorcycles App. When FM Station Guide is enabled, FM station frequencies are given by voice prompts as you select preset stations. When FM Station Guide is disabled, the voice prompts on FM station frequencies will not be given as you select preset stations.

11 VOICE COMMAND

The voice command of the SRL2 allows you to operate certain operations by simply using your voice. You can control the SRL2 completely handsfree using the voice recognition. The voice command function works only with English commands.

Voice Command Procedure:

1. There are two ways to enter the voice command mode. The simplest way is to tap the Center Button and the (-) Button simultaneously. Another way is to say, **“Hello Sena”** during standby mode.
2. Speak a voice command from the table below:

Mode Status	Function	Voice Command
Standby/Intercom	Start/End each intercom	“Intercom [one, two, ... , nine]”
	End all intercoms	“End intercom”
	Call last intercom	“Last intercom”
	Group intercom	“Group intercom”
	Intercom pairing	“Pairing intercom”
	Cancelling operations	“Cancel”
Standby/Music/ FM Radio	Play/Pause music	“Music” or “Stereo”
	Turn on/off FM radio	“FM radio”
	Check battery	“Check battery”
	Speed dialing	“Speed dial [one, two, three]”
	Redial the last call	“Redial”
	Voice command help	“What can I say?”
	Check connected devices	“Connected devices”
	Configuration menus	“Configuration”

Mode Status	Function	Voice Command
Music / FM Radio	Next track (music) / next preset (FM radio)	“Next”
	Previous track (music) / previous preset (FM radio)	“Previous”
	Stop music / FM Radio	“Stop”

Note:

1. Voice command performance may vary based on the environmental conditions including riding speed, helmet type and ambient noise. To improve the performance, minimize the wind noise on the microphone by using the large microphone sponge and closing the visor.
2. To activate the voice command during non-stand-by functions, tap the Center Button and the (-) Button simultaneously.

11.1 Voice Command Setting (Default: Enable)

You can enable or disable Voice Command through the Sena Motorcycles App. When Voice Command is enabled, you can use your voice to give a command so that the Bluetooth system operates certain operations completely handsfree. If Voice Command is disabled, you will need to operate all of the functions using the buttons on the Bluetooth system.

12 INTERCOM PAIRING

12.1 Pairing with Other SRL2 Headsets for Intercom Conversation

The SRL2 can be paired with up to nine other headsets for Bluetooth intercom conversation.

1. Turn on the two SRL2 headsets (A and B) that you would like to pair with each other.
2. Press and hold the Center Button of two Bluetooth systems for 8 seconds until red LEDs of the both units start to flash rapidly. You will hear a voice prompt saying “**Intercom pairing**”.
3. Simply tap the Center Button of any one of the two headsets A or B (It doesn't matter that you choose A or B.) and wait until the LEDs of both headsets turn to blue and intercom connection is automatically established. The two SRL2 headsets A and B are paired with each other for intercom conversation. If the pairing process is not completed within one minute, the SRL2 will return to stand-by mode.

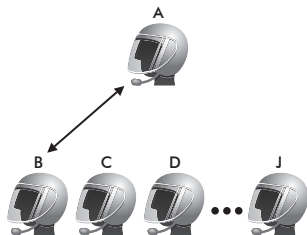

Pairing A & B

4. You can pair with up to nine other headsets. To pair with more headsets such as A and C, A and D, and more, simply follow the same procedure as above.

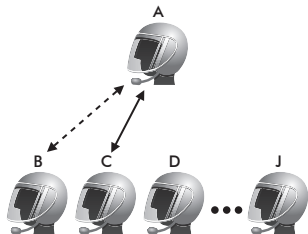

Pairing A & C

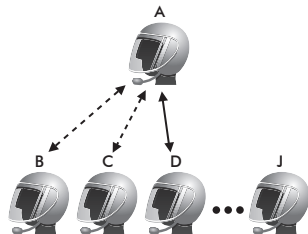

Pairing A & D

5. The intercom pairing queue is '**Last-Come, First-Served**'. If a headset has multiple paired headsets for intercom conversations, the last paired headset is set as **first intercom friend**. The previous intercom friend becomes **second intercom friend**, and **third intercom friend**.

Note:

1. For example, after the pairing procedures listed above, headset D is the **first intercom friend** of headset A. Headset C is the **second intercom friend** of headset A, and headset B is the **third intercom friend** of headset A.
2. If you want to cancel pairing, double tap the Center Button during pairing mode.

12.2 Pairing with Other Sena Headset Models for Intercom Conversation

The SRL2 can be paired with all other Sena headset models such as the SMH10 and the SMH5 for an intercom conversation. Please follow the same procedure as above to pair with these headset models.

Note:

The SMH5 cannot participate in multi-way intercom with the SRL2 or the SMH10. The SMH5 has limited capability of having two-way intercom with other SMH5s or with other Sena headsets, such as the SMH10.

13 TWO-WAY & MULTI-WAY INTERCOM

13.1 Two-way Intercom

1. You can start an intercom conversation with one of any intercom friends by using either the Center Button or the voice command. Single tap to start intercom with the **first intercom friend** and double tap to start intercom with the **second intercom friend**. To start intercom with the **third intercom friend** and above, triple tap to enter into friend selection mode. Tap the (+) Button or the (-) Button to select a friend and tap the Center Button once more to initiate the intercom with that friend.
2. You can end an intercom conversation by using either the Center Button or the voice commands. Press the Center Button for 1 second to end any intercom, or use the voice command, “**End intercom**”. Or, you can single tap to end intercom with the **first intercom friend** and double tap to end intercom with the **second intercom friend**. To end intercom with the **third intercom friend** and above, triple tap to enter into friend selection mode. Tap the (+) Button or the (-) Button to select a friend and tap once more to end intercom with that friend. Also, use the voice command, “**Intercom [four ~ nine]**” to end each intercom.

	1st intercom friend	2nd intercom friend	3rd ~ 9th intercom friend
Start intercom	Single tap the Center Button	Double tap the Center Button	Triple tap the Center Button → Tap the (+) Button or the (-) Button to select friend → Single tap the Center Button
End intercom	Single tap the Center Button	Double tap the Center Button	Triple tap the Center Button → Tap the (+) Button or the (-) Button to select friend → Single tap the Center Button
End any intercom	Press the Center Button for 1 second		

Start & End Two-way Intercom

13.2 Multi-way Intercom

13.2.1 Start Three-way Intercom

You (A) can have a three-way intercom with two other SRL2 friends (B & C) by establishing two intercom connections at the same time.

1. You (A) need to be paired with two other friends (B & C) for three-way intercom.

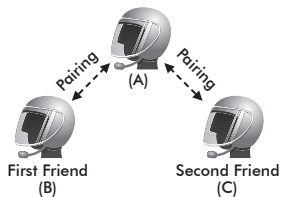

2. Start an intercom conversation with one of the two friends in your intercom group. For example, you (A) may start an intercom conversation with the intercom friend (B). Or intercom friend (B) may start an intercom call with you (A).

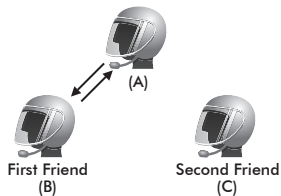

3. The second intercom friend (C) may join the intercom by making an intercom call to you (A). You (A) may also connect the second intercom friend (C).

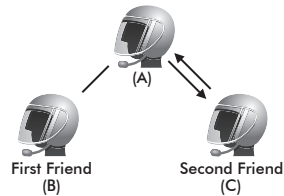

4. Now you (A) and two SRL2 intercom friends (B & C) are having a three-way intercom.

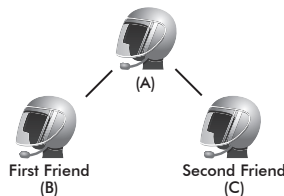

13.2.2 End Three-way Intercom

When you are a member of an active three-way intercom, you can completely terminate the intercom or just disconnect an intercom connection with one of your active intercom friends.

1. Press the Center Button for 5 seconds until you hear double beeps to terminate three-way intercom completely. It terminates both intercom connections with (B) and (C).
2. Tap or double tap the Center Button to disconnect intercom connection with one of the two intercom friends accordingly. For example, by single tapping the Center Button, you can just terminate the intercom connection with the first intercom friend (B). However, you still have the intercom connection with your second intercom friend (C).

The Center Button Operation	Result
Press for 5 seconds	Disconnect (B) & (C)
Single tap	Disconnect (B)
Double tap	Disconnect (C)

13.2.3 Start Multi-way Intercom

You can have multi-way intercom with up to seven other SRL2 users by creating an intercom chain. Both the head and the tail of the chain can add new participants.

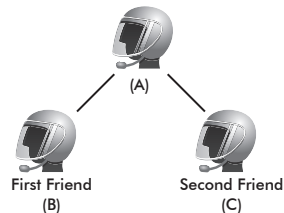

For example, if you have a three-way intercom set up, the new participant (D) can be added to either (B)-the head, or (C)-the tail. If (D) were added to (C), then (D) becomes the new tail of the chain. If (D) were added to (B), then (D) becomes the new head. In this way, an intercom chain can hold up to a total of eight people.

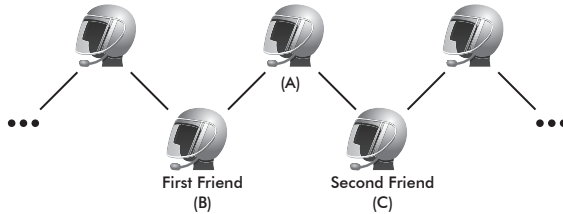

Please note that each participant's intercom friends are the ones adjacent to each other.

Note:

To have multi-way intercom with more than four participants, you must enable Eight-way Intercom. Please refer to section 17.5, "Eight-Way Intercom (Default: Disable)" for more details.

13.2.4 End Multi-way Intercom

You can completely get out of the multi-way intercom or just disconnect a part of the chain.

1. Press the Center Button for 5 seconds until you hear double beeps to terminate multi-way intercom. It terminates the intercom connections between you (A), and all participants in the chain.
2. Single tap or double tap the Center Button to disconnect intercom connection between one of the two intercom friends. A single tap will disconnect the intercom connection between you (A) and (B). Rest of the connection of the chain will be preserved. Likewise, double tap will disconnect the intercom connection between you (A) and (C), while preserving rest of the connections.

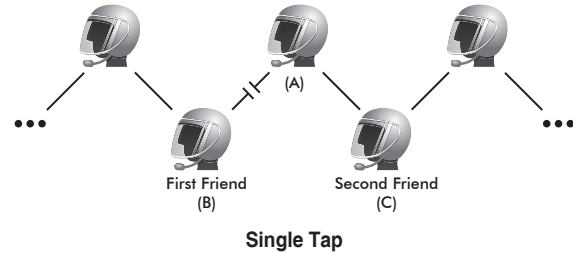

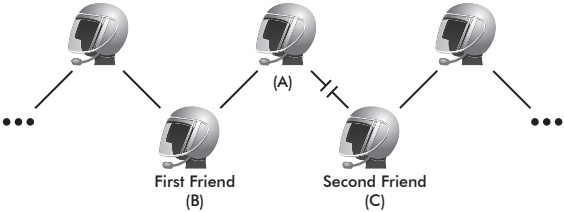

Double Tap

The Center Button Operation	Result
Press for 5 seconds	Disconnect all participants
Single tap	Disconnect participants chained to (B)
Double tap	Disconnect participants chained to (C)

14 THREE-WAY CONFERENCE PHONE CALL WITH INTERCOM PARTICIPANT

You can have a three-way conference phone call by adding an intercom friend to the mobile phone conversation. While having a mobile phone call, make an intercom call to one of the intercom friends by tapping the Center Button to form a three-way conference call with the person on the mobile phone line. To disconnect the intercom first and go back to your private mobile phone call, terminate the intercom by tapping the Center Button. To end the mobile phone call first and maintain the intercom conversation, press the Center Button for 2 seconds, or wait for the person on the mobile phone line to end the call.

Start	Tap the Center Button while having a mobile phone call
End intercom first	Tap the Center Button
End phone call first	Press the Center Button for 2 seconds or Wait for the called person to end the call

Start & End Three-way Conference Phone Call

15 GROUP INTERCOM

Group Intercom allows you to instantly create a multi-way intercom of up to eight participants. You can create and start Group Intercom through your Smartphone App.

1. Start your Smartphone App and go to 'Group Setting' under 'Group Intercom'.
2. Browse your friends, and select up to seven other people you want to group with.
3. Check your friends and press 'Save to My SRL2' on the screen.
4. Press 'Connect' on the screen or tap the (+) Button and the (-) Button simultaneously to begin Group Intercom.
5. When all of the Bluetooth system are connected together, everyone will hear the voice prompt, **"Group Intercom connected"**.
6. To terminate Group Intercom, tap the (+) Button and the (-) Button simultaneously during Group Intercom. You will hear a voice prompt, **"Group intercom terminated"**.

Note:

To use Group Intercom with more than four participants, you must enable Eight-way Intercom. Please refer to section 17.5, "Eight-Way Intercom (Default: Disable)" for more details.

16 UNIVERSAL INTERCOM

You can have an intercom conversation with non-Sena Bluetooth headsets using the Universal Intercom function. Non-Sena Bluetooth headsets can be connected to the Sena Bluetooth headset if they support the Bluetooth Hands-Free Profile (HFP). The working distance may differ depending on the performance of Bluetooth headset that it is connected to. In general, it is shorter than normal intercom distance since it uses the Bluetooth handsfree profile.

16.1 Universal Intercom Pairing

The SRL2 can be paired with non-Sena Bluetooth headsets for Bluetooth intercom conversation. You can pair the SRL2 with only one non-Sena Bluetooth headset so if you pair with a different non-Sena Bluetooth headset, the previous pairing list will be removed.

1. Turn on the SRL2 and a non-Sena Bluetooth headset that you want to pair with.

2. Press the Center Button for 12 seconds to enter the configuration menu. Tap the (-) Button three times and you will hear a voice prompt saying **“Universal intercom pairing”**. Press the Center Button to enter into Universal Intercom Pairing mode and the blue LED will flash rapidly and you will hear multiple beeps. Please refer to *section 22.8, “Universal Intercom Pairing”* for more details.
3. Perform the operation required for handsfree pairing on the non-Sena Bluetooth headset (refer to the user’s manual of the headsets you want to use). The SRL2 will automatically perform pairing with non-Sena Bluetooth headsets in pairing mode.

16.2 Two-way Universal Intercom

You can initiate the Universal Intercom connection with non-Sena Bluetooth headsets using the same intercom connection method as you would between other Sena headsets. Make sure that you may single tap the Center Button to begin an intercom conversation with the first intercom friend, double tap with the second intercom friend, and triple tap with the third intercom friend.

Non-Sena Bluetooth headsets may initiate the Universal Intercom connection by activating the voice dialing or using the redialing operation. You may also disconnect the existing connection by ending a call operation function (refer to the user’s manual of the headsets for voice dialing, redialing, and ending a call).

16.3 Three-way Universal Intercom

You may make a three-way Universal Intercom connection with two SRL2s and one non-Sena Bluetooth headset.

1. You (A) need to be paired with a non-Sena Bluetooth headset (B) and another SRL2 headset (C) for the three-way intercom.

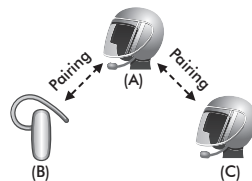

2. Start an intercom conversation with non-Sena Bluetooth headset (B) in your intercom group. For example, you (A) may start an intercom conversation with non-Sena Bluetooth headset (B). The non-Sena Bluetooth headset (B) may also start an intercom call with you (A).

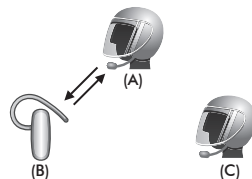

- The other SRL2 (C) may join the intercom by making an intercom call to you (A).

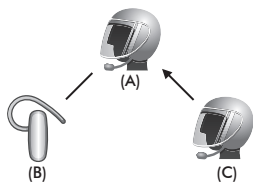

- Now you (A), non-Sena Bluetooth headset (B), and the other SRL2 (C) are having a three-way intercom.

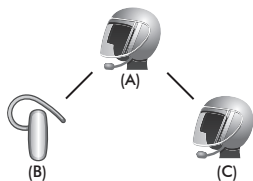

- You may disconnect three-way Universal Intercom using the same way as you do in normal three-way intercom. Please refer to *section 13.2.2, "End Three-way Intercom"*.

16.4 Four-way Universal Intercom

You may make a four-way Universal Intercom connection with a couple of different configurations, 1) three SRL2s and one non-Sena Bluetooth headset or 2) two SRL2s and two non-Sena Bluetooth headsets.

You may have a couple of other four-way Universal Intercom configurations, 1) your headset (A), a non-Sena Bluetooth headset (B), another SRL2 (C), and a non-Sena Bluetooth headset (D), 2) your headset (A), a non-Sena Bluetooth headset (B), and two other SRL2 headsets (C and D). You may make the four-way Universal Intercom call the same way as a normal four-way intercom call.

16.4.1 Four-way Universal Intercom Case 1

Two SRL2 headsets (A and C) and two non-Sena Bluetooth headsets (B and D)

- You (A) may start an intercom conversation with the non-Sena Bluetooth headset (B).

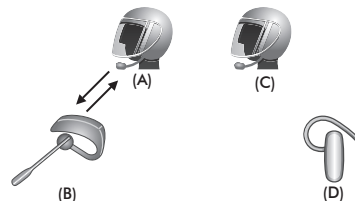

- The other SRL2 (C) may join the intercom by making an intercom call to you (A).

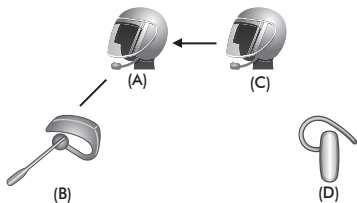

- The non-Sena Bluetooth headset (D) may join the three-way intercom by making an intercom call to the SRL2 (C).

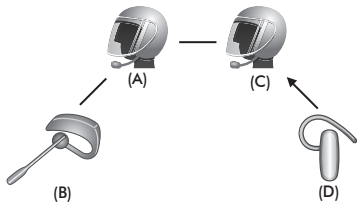

- Now two SRL2 headsets (A & C) and two non-Sena Bluetooth headsets (B & D) are connected with the four-way Universal Intercom.

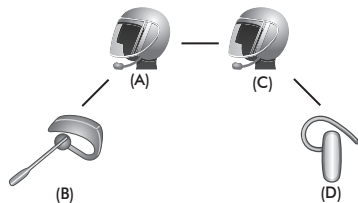

You may disconnect a four-way Universal Intercom using the same way as you do in a normal four-way intercom. Please refer to *section 13.2.4, "End Multi-way Intercom"*.

16.4.2 Four-way Universal Intercom Case 2

Three SRL2 headsets (A, C and D) and one non-Sena Bluetooth headset (B). The procedure is the same as case 1 described in *section 16.4.1*.

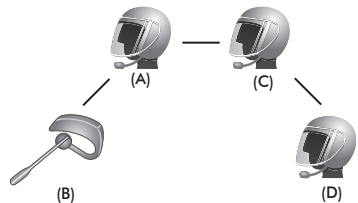

17 ADDITIONAL INTERCOM SETTINGS

17.1 Audio Multitasking™ (Default: Enable)

You can enable or disable Audio Multitasking through the Sena Motorcycles App. Audio Multitasking allows you to have an intercom conversation while simultaneously listening to music, FM radio, or GPS instructions. The overlaid audio is played in the background with reduced volume whenever there is an intercom conversation and will return to normal volume once the conversation is finished. If this feature is disabled, any incoming or outgoing intercom will interrupt your audio channel.

17.2 Intercom-Audio Overlay Sensitivity (Default: 6)

You can adjust Intercom-audio overlay sensitivity through the Sena Motorcycles App. The music, FM radio and GPS volume will be lowered to play in the background if you talk over the intercom while the overlaid audio is playing. You can adjust the intercom sensitivity to activate this background audio mode. Level 1 has the lowest sensitivity and level 10 has the highest sensitivity.

Note:

If your voice is not louder than the sensitivity of the selected level, the overlaid audio will not be lowered.

17.3 Audio Overlay Volume Management (Default: Disable)

You can enable or disable Audio Overlay Volume Management through the Sena Motorcycles App. The music, FM radio and GPS overlaid audio reduces in volume whenever there is an ongoing intercom conversation. If Audio Overlay Volume Management is enabled, the volume level of the overlaid audio will not be reduced during an intercom conversation.

17.4 HD Intercom (Default: Enable)

You can enable or disable HD Intercom through the Sena Motorcycles App. HD Intercom enhances the two-way intercom audio from normal quality to HD quality. HD Intercom will become temporarily disabled when you enter into a multi-way intercom. If this feature is disabled, the two-way intercom audio will change to normal quality.

17.5 Eight-Way Intercom (Default: Disable)

You can enable or disable Eight-way Intercom through the Sena Motorcycles App. Disabling the Eight-way Intercom optimizes the intercom performance for a small group up to four participants. Enabling the Eight-way Intercom optimizes the intercom performance for a larger group up to eight participants.

17.6 Advanced Noise Control™ (Default: Enable)

You can enable or disable Advanced Noise Control through the Sena Motorcycles App. When Advanced Noise Control is enabled, the background noise is reduced during an intercom conversation. When it is disabled, the background noise is mixed with your voice during intercom.

Note:

If you use your SRL2 with the Bluetooth Audio Pack for GoPro, you can enable or disable this feature only during Normal Voice Recording. This feature is automatically disabled while in Ultra HD (UHD) Voice Recording mode.

18 REMOTE CONTROL

You can remotely control the SRL2 via Bluetooth using the Remote Control (sold separately). This eliminates the need to take off your hand for button operations. Your SRL2 and the Remote Control must be paired together before use.

1. Turn on the SRL2 and the Remote Control.
2. Press the Center Button for 12 seconds to enter the configuration menu. Tap the (-) Button four times and you will hear a voice prompt saying, **“Remote control pairing”**. Tap the Center Button to enter into Remote Control Pairing mode and the red LED will flash rapidly and you will hear multiple beeps. Please refer to section 22.7, “Remote Control Pairing”.
3. Enter pairing mode in the Remote Control device. The Bluetooth system will automatically connect with the Remote Control device in pairing mode. You will hear a voice prompt, **“Remote control connected”** when they are successfully paired.

19 FUNCTION PRIORITY

The SRL2 operates in the following order of priority:

(highest)

Mobile phone

Voice command mode

Intercom

Music sharing by Bluetooth stereo music

FM Radio

(lowest)

Bluetooth stereo music

A lower priority function is always interrupted by a higher priority function. For example, stereo music is interrupted by intercom call, and an intercom conversation is interrupted by an incoming mobile phone call.

20 VOICE PROMPT

Voice Prompt is enabled by default. You can disable voice prompts through the Sena Motorcycles App, but the following voice prompts are always on.

- Voice prompts for configuration setting menu
- Voice prompts for battery level Indicator
- Voice prompts for factory reset
- Voice prompts for speed dial
- Voice prompts for FM radio functions

21 SIDETONE

Sidetone is disabled by default. You can enable or disable Sidetone through the Sena Motorcycles App. Sidetone is the sound of your own voice as picked up by your Bluetooth system's microphone and reproduced in your own ear, by your own speaker. It helps you to naturally speak at the correct level according to varying helmet noise conditions. If this feature is enabled, you can hear what you are speaking during an intercom conversation or a phone call.

22 CONFIGURATION SETTING

You can set the configuration of the SRL2 by the voice menu instruction as below.

1. To enter into voice configuration menu, press the Center Button for 12 seconds until you hear high-toned double beeps. You will also hear a voice prompt saying **"Configuration menu"**.
2. Tap the (+) Button or the (-) Button to navigate between the menus. You will hear voice prompts for each menu item as below.
3. You can enable the feature or execute the command by tapping the Center Button, or disable the feature by tapping the Center Button.
4. If any button is not pressed within 10 seconds, the SRL2 will exit the configuration and go back to stand-by.
5. If you want to exit the configuration immediately, tap the (-) Button and you will hear a voice prompt, **"Exit configuration"**, and tap the Center Button.

The voice prompt for each menu item is as below:

- | | |
|--|---------------------------------------|
| (1) <i>Phone pairing</i> | (6) <i>Delete all pairings</i> |
| (2) <i>Second mobile phone pairing</i> | (7) <i>Remote control pairing</i> |
| (3) <i>GPS pairing</i> | (8) <i>Universal intercom pairing</i> |
| (4) <i>Phone selective pairing</i> | (9) <i>Factory reset</i> |
| (5) <i>Media selective pairing</i> | (10) <i>Exit configuration</i> |

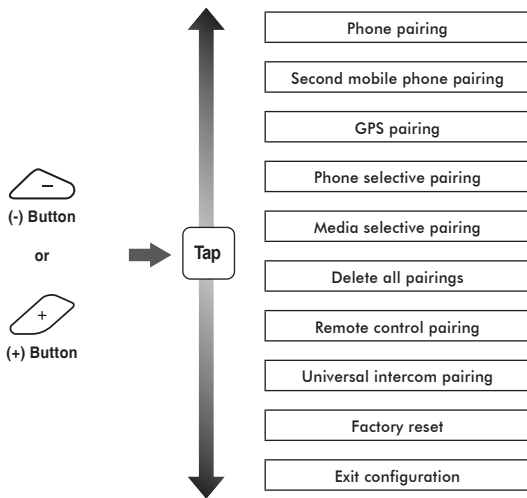

22.1 Phone Pairing

Voice Prompt	"Phone pairing"
Factory Default	N/A

To go into mobile phone pairing mode, tap the (+) Button or the (-) Button until you hear the voice prompt, **"Phone pairing"**. Please refer to *section 4.1, "Mobile Phone Pairing"* for details on mobile phone pairing. If you tap the (+) Button or the (-) Button, you can exit from the phone pairing mode.

22.2 Second Mobile Phone Pairing

Voice Prompt	"Second mobile phone pairing"
Factory Default	N/A

To go into second mobile phone pairing mode, tap the (+) Button or the (-) Button until you hear the voice prompt, **"Second mobile phone pairing"**. Please refer to *section 4.2, "Second Mobile Phone Pairing"* for details on second mobile phone pairing. If you tap the (+) Button or the (-) Button, you can exit from the second mobile phone pairing mode.

22.3 GPS Pairing

Voice Prompt	“GPS pairing”
Factory Default	N/A

To go into GPS pairing mode, tap the (+) Button or the (-) Button until you hear the voice prompt, **“GPS pairing”**. Please refer to *section 4.4.1, “GPS Pairing”* for details on GPS pairing. If you tap the (+) Button or the (-) Button, you can exit from the GPS pairing mode.

22.4 Phone Selective Pairing

Voice Prompt	“Phone selective pairing”
Factory Default	N/A

To go into phone selective pairing mode, tap the (+) Button or the (-) Button until you hear the voice prompt, **“Phone selective pairing”**. Please refer to *section 5.2, “HFP for Phone Call Only”* for details on phone selective pairing. If you tap the (+) Button or the (-) Button, you can exit from the phone selective pairing mode.

22.5 Media Selective Pairing

Voice Prompt	“Media selective pairing”
Factory Default	N/A

To go into media selective pairing mode, tap the (+) Button or the (-) Button until you hear the voice prompt, **“Media selective pairing”**. Please refer *section 5.1, “A2DP Stereo Music Only”* for details on media selective pairing. If you tap the (+) Button or the (-) Button, you can exit from the media selective pairing mode.

22.6 Delete All Bluetooth Pairing Information

Voice Prompt	“Delete all pairings”
Factory Default	N/A
Execute	Tap the Center Button

To delete all Bluetooth pairing information of the SRL2, tap the (+) Button or the (-) Button until you hear a voice prompt, **“Delete all pairings”**, and tap the Center Button to confirm.

22.7 Remote Control Pairing

Voice Prompt	“Remote control pairing”
Factory Default	N/A
Execute	Tap the Center Button

To enter into Remote Control Pairing mode, tap the (+) Button or the (-) Button until you hear a voice prompt, **“Remote control pairing”**. Then tap the Center Button to enter into Remote Control Pairing mode. The headset will automatically exit from the configuration menu. Please refer to *section 18* for details on remote control pairing.

22.8 Universal Intercom Pairing

Voice Prompt	“Universal intercom pairing”
Factory Default	N/A
Execute	Tap the Center Button

To enter into Universal Intercom Pairing mode, tap the (+) Button or the (-) Button until you hear a voice prompt, **“Universal intercom pairing”**. Then tap the Center Button to enter into Universal Intercom Pairing mode. The headset will automatically exit from the configuration menu. Please refer to *section 16* for details on Universal Intercom.

22.9 Factory Reset

Voice Prompt	“Factory reset”
Factory Default	N/A
Execute	Tap the Center Button

To restore factory default settings on the SRL2, tap the (+) Button or the (-) Button until you hear a voice prompt, **“Factory reset”**, and tap the Center Button to confirm. The SRL2 powers off with a voice prompt, **“Headset reset, good-bye”**.

22.10 Exit Voice Configuration Menu

Voice Prompt	“Exit configuration”
Factory Default	N/A
Execute	Tap the Center Button

To exit voice configuration menu and get back to stand-by mode, tap the (+) Button or the (-) Button until you hear a voice prompt, **“Exit configuration”**, and tap the Center Button to confirm.

Tap the (+) Button or the (-) Button	Tap the Center Button
Phone Pairing	None
Second Mobile Phone Pairing	None
GPS Pairing	None
Phone Selective Pairing	None
Media Selective Pairing	None
Delete All Pairings	Execute
Remote Control Pairing	Execute
Universal Intercom Pairing	Execute
Factory Reset	Execute
Exit Configuration	Execute

23 RESET TO FACTORY DEFAULT SETTINGS

1. To restore the SRL2 to factory default settings, press the Center Button for 12 seconds until you hear high-toned double beeps. You will hear a voice prompt saying **“Configuration menu”**.
2. Tap the (-) Button twice and you will hear a voice prompt saying **“Factory reset”**.
3. Within 5 seconds, tap the Center Button to confirm reset. The headset will be restored to factory setting and switched off automatically. You will hear a voice prompt saying **“Headset reset, good-bye”**.

24 FAULT RESET

When the SRL2 is not working properly or is in faulty status for any reason, you may reset by pushing the pin-hole reset button located next to the DC Power Charging & Firmware Upgrade Port. Insert a paper clip into the reset pin-hole and press the reset button for a second with light pressure. The SRL2 will be switched off, and you have to turn on the system back on and try again. However, this will not restore the headset to factory default settings.

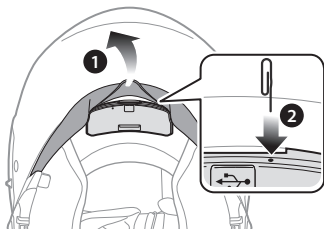

Note:

The charging LED is not a pin-hole reset button. Do not press it.

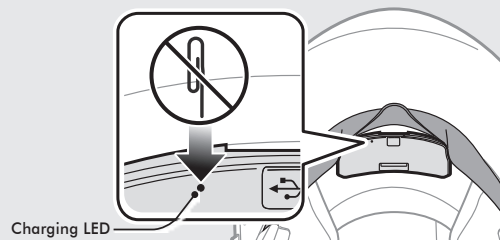

25 FIRMWARE UPGRADE

The SRL2 supports firmware upgrade function. Please visit Sena Bluetooth web site at www.sena.com to check the latest software downloads.

26 OPERATION QUICK REFERENCE

Type	Operation	Button Command	LED	Beep
Basic Operations	Power on	Press the (+) Button and the Center Button for 1 second	Solid blue	Ascending beeps
	Power off	Tap the (+) Button and the Center Button	Solid red	Descending beeps
	Volume adjustment	Tap the (+) Button or the (-) Button	-	-
	Voice Command	Say "Hello, Sena"	Green flashing	-
		Tap the Center Button and the (-) Button		
Mobile Phone	Answer phone call	Tap the Center Button	-	-
	End/Reject phone call	Press the Center Button for 2 seconds	-	-
	Voice dial	Press the Center Button for 3 seconds	-	-
	Speed dial	Press the (+) Button for 3 seconds	-	Mid-toned single beep

Type	Operation	Button Command	LED	Beep
Music	Play/Pause music	Press the Center Button for 1 second	-	-
	Track forward	Press the (+) Button for 1 second	-	-
	Track backward	Press the (-) Button for 1 second	-	-
FM Radio	FM radio on/off	Press the (-) Button for 1 second	-	Mid-toned double beeps
	Seek forward	Double tap the (+) Button	-	High-toned triple beeps
	Seek backward	Double tap the (-) Button	-	High-toned triple beeps
Intercom	Intercom pairing	Center Button for 8 seconds	Red flashing	-
		Tap the Center Button		-
	Start/End intercom	Tap the Center Button	-	-
	End all intercoms	Press the Center Button for 5 seconds	Blue flashing	-
	Start group intercom	Tap the (+) Button and the (-) Button	Green flashing	-
	End group intercom	Tap the (+) Button and the (-) Button	-	-

