

尺寸: 105x148.5mm 折页方式: 骑马钉 100g铜版纸

专色 #A7E800
R167 G232 B0
C39 M0 Y90 K0
PANTONE 2290C

SEENDA

User Manual

2.4G Wireless Keyboard and Mouse Combo

2.4G Stable
Connection

Scissor-switch
Quiet Typing

Ultra-thin Sleek
Design

SK38

EN

Product Warranty

All Seenda products come with a 24-month warranty policy, please do not hesitate to contact us if you have any questions. Our support team will try our best to provide you with a pleasant shopping experience.

Our email: support@seenda.com
Our website: www.seenda.com

Phone: +1 844-968-2543
Mon-Fri: 10AM - 2PM; 3PM - 7PM ET
*Closed during Holidays

Product Features

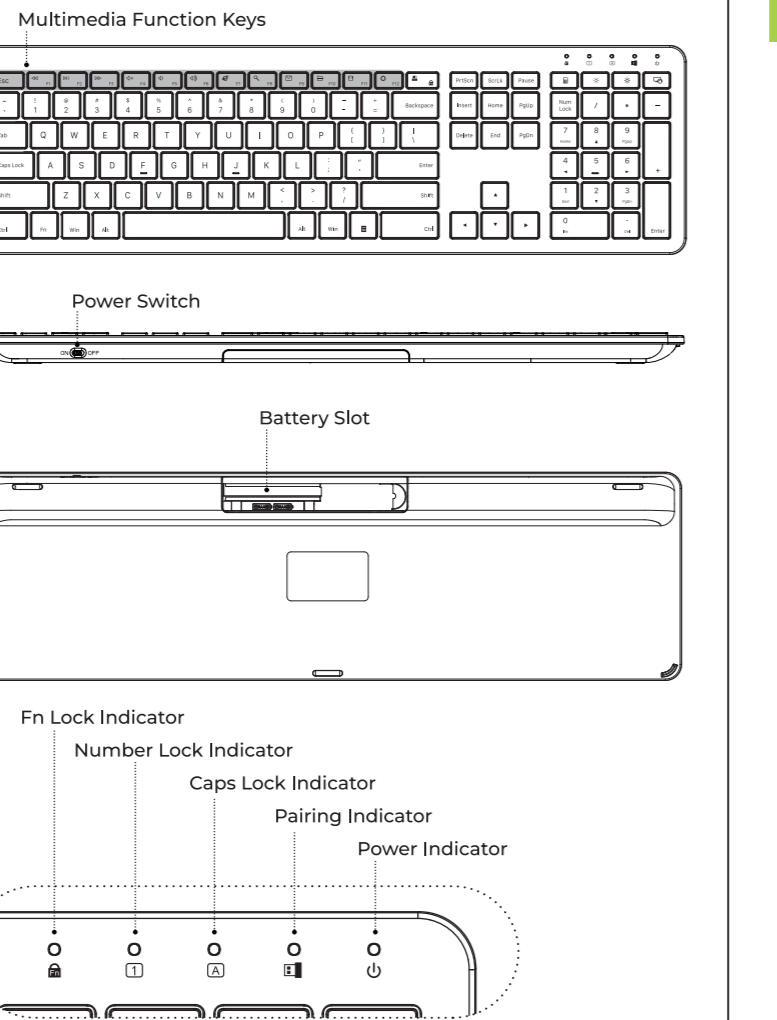
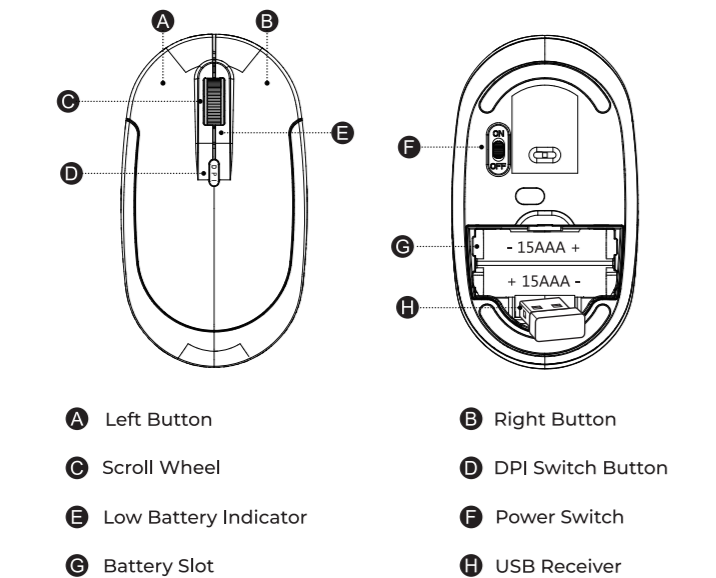

2.4G USB Connection

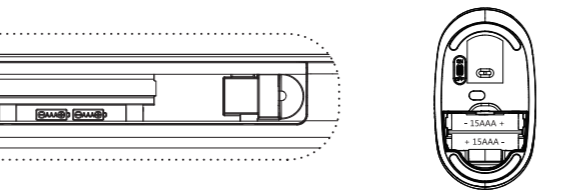

1. Insert 2 AAA batteries into the keyboard and 2 AAA batteries into the mouse.

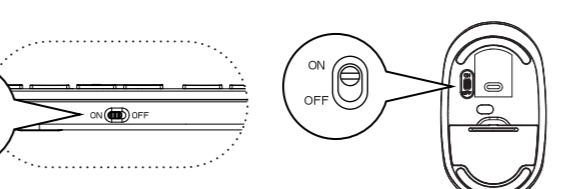

2. Turn the power switch to ON.

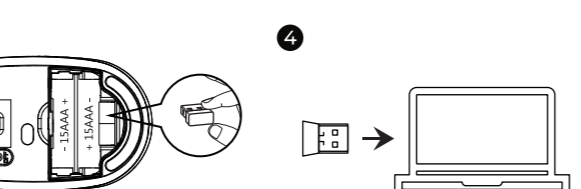

3. Take out the USB receiver from the mouse's battery compartment (Note: The keyboard and mouse share one USB receiver.)

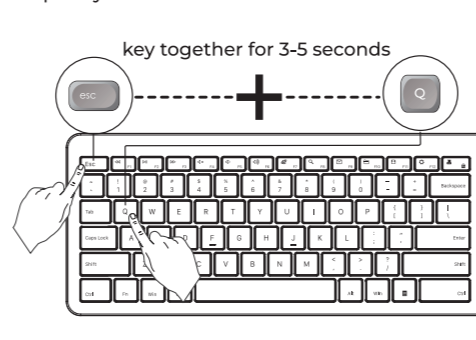

4. Plug the USB receiver into the USB port of the computer, then the keyboard and mouse will be connected automatically.

How to re-pair the USB receiver with keyboard and mouse if connection lost

How to Re-pair Keyboard with Receiver :

1) Unplug the receiver, restart the keyboard switch to "ON"

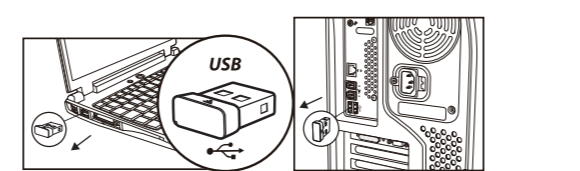

2) Press and hold the "Esc" + "Q" at the same time for about 3-5 seconds, release your hand when the power indicator lights flashing quickly

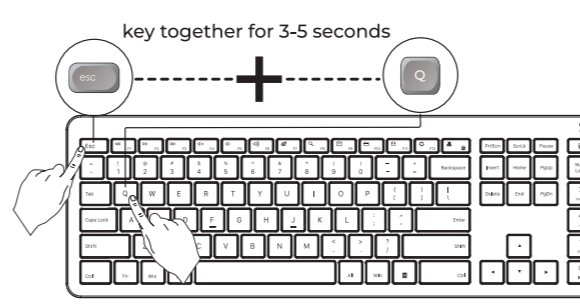

How to Repair the Mouse with the Receiver :

1) Unplug the receiver, restart the mouse switch to "ON"

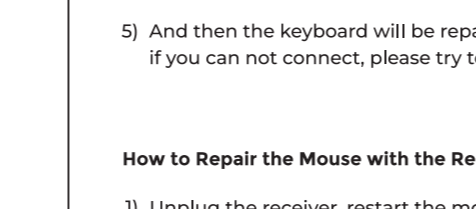

2) Press and hold the scroll wheel + right button at the same time for about 3-5 seconds to enter into pairing mode

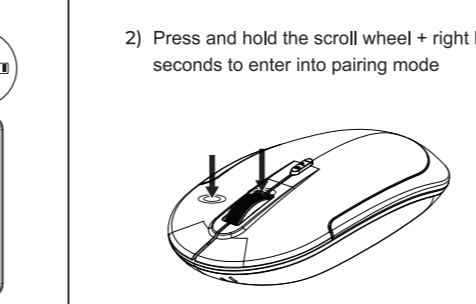

How to Repair the Keyboard with the Receiver :

1) Unplug the receiver, restart the keyboard switch to "ON"

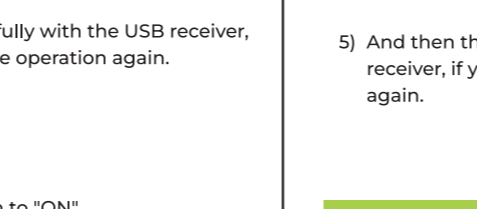

2) Press and hold the scroll wheel + right button at the same time for about 3-5 seconds to enter into pairing mode

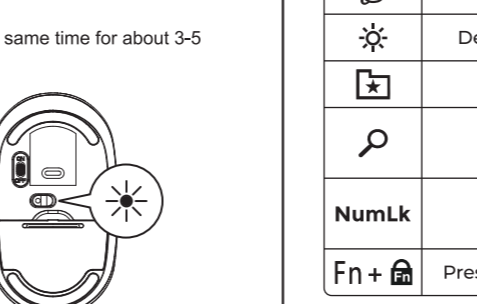

Keyboard Multimedia Function

Buttons	Function	Buttons	Function
	Mute		Volume down
	Volume up		Previous
	Play&Stop		Next
	Browser		Open setting
	Decrease brightness		Increase brightness
	Favorites		Screen switching
	Search		Activates the voice service function
	Number Lock		Open the "Connect" device interface
	Press Fn + Lock to turn on/off the Fn function		

Mouse Specifications

Working current	≤8mA
Working range	Within 10m (33ft)
DPI of the mouse	800-1200-1600 dpi
Key lifespan	3 million strokes
Batteries	2 AAA batteries for the mouse (Battery not included)
Sleep mode	Mouse will turn to sleep mode after 10 minutes of inactivity

Keyboard Specifications

Working current	≤8mA
Working range	Within 10m (33ft)
Key lifespan	3 million strokes
Batteries	2 AAA batteries required for the keyboard (Battery not included)
Sleep mode	Keyboard will turn to sleep mode after 5 seconds of inactivity

Package Contents

- ▶ 1 * Wireless Keyboard
- ▶ 1 * Wireless Mouse
- ▶ 1 * USB Receiver(Stored in the mouse's battery compartment)
- ▶ 1 * User Manual

FAQ

Keyboard & Mouse won't work properly

The keyboard and mouse are not working properly.
- Ensure that the batteries in the keyboard and mouse are not low. If they are, replace them with new ones.
- Make sure that both the keyboard and mouse are turned on.
- Confirm that the USB receiver is properly inserted into the computer. Check if the computer recognizes the receiver. If not, try plugging the USB receiver into another USB port on the computer. If it still doesn't work, you can also test the receiver on a different device to check its functionality.

How to wake up the keyboard and mouse from sleep mode

To conserve battery life, the keyboard will enter sleep mode after 5 seconds of inactivity, and the mouse will enter sleep mode after 10 minutes of inactivity. To wake them up, simply press any key on the keyboard and click the left or right button on the mouse, and they will be ready for use within 3 seconds.

For any other issues while using, please do not hesitate to contact our customer service for assistance.

Sleep Mode

To conserve battery life, the keyboard will enter sleep mode after 5 seconds of inactivity, and the mouse will enter sleep mode after 10 minutes of inactivity. To wake them up, simply press any key on the keyboard and click the left or right button on the mouse, and they will be ready for use within 3 seconds.

Safety Warning

IMPORTANT: To reduce risk of fire, electric shock, or injury, follow the safety instructions.

- ⚠ Heat Exposure: Avoid leaving the item in high-temperature environments or in direct sunlight, which could result in a fire hazard.
- ⚠ Liquid Exposure: Keep the item away from water and liquids. Do not use it until thoroughly dried.
- ⚠ Damage and Leakage: Cease usage and consult customer service if the item is damaged or the battery leaks.
- ⚠ Correct Disposal: Follow local regulations for disposing of electronic devices and batteries. Do not dispose of with household waste.
- ⚠ Radio Frequency Interference: This device may cause interference with other electronics. Keep a safe distance from sensitive devices.
- ⚠ Child Safety: Keep the item and its components out of reach of children to avoid choking or battery ingestion hazards. Never allow children to handle the item unsupervised.

CAUTION: Non-compliance with the above warnings can lead to serious injury or property damage.

EU Declaration of Conformity

Declared Object: 2.4G Wireless Keyboard and Mouse Combo
Model: SK38
Rating: 3V=10mA
Place of Production: Made in China
Manufacturer: Shenzhen Hangshi Electronic Technology Co., LTD
E-mail: chen.zhao@bow.cn
Address: Floor 2, Building A1, Zone G, Democratic West Industrial Zone, Democratic Community, Shajing Street, Bao'an District, Shenzhen City, Guangdong Province, China, 518104

European Representative: EC REP
Business name: g.L.L. GmbH
Business address: Bauernvogelkoppel, 55c, 22393, Hamburg, Germany
Email: g.L.L.DE@outlook.com
UK REP
Business name: AMANTO INTERNATIONAL TRADE LIMITED
Business address: The Imperial, 35-36 St Stephens Gardens, Notting Hill, London, United Kingdom, W2 5NA
Email: AmantoUK@outlook.com

It is our sole responsibility to declare that the above products are in full compliance with Directive 2014/53/EU, 2011/65/EU (as amended)

Position: Managing Director
Signature: ZHAO CHEN
Date of Sign: 2022.1.5
EU agent name: Tony Jia
Date of Sign: 2022.1.5

