

BROSA

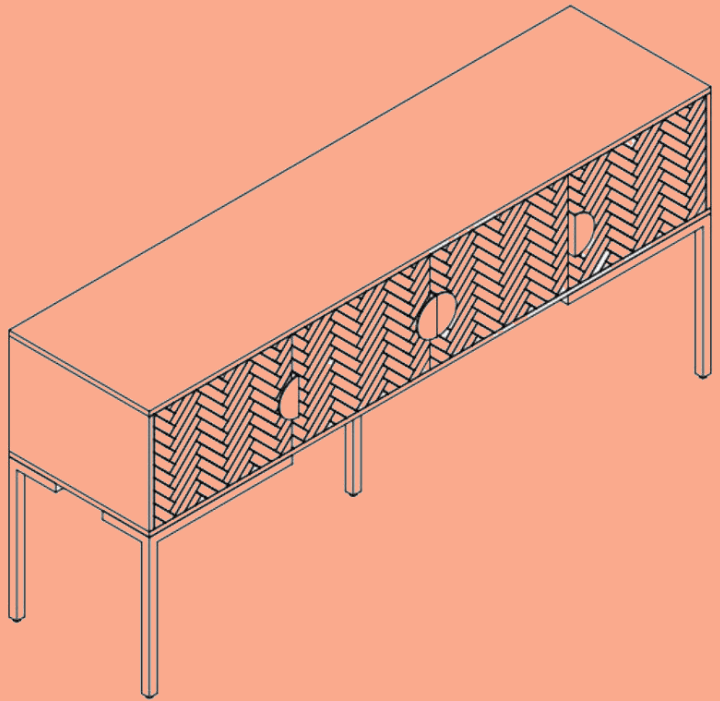

ASSEMBLY GUIDE

Hertz
4 DOOR SIDBOARD

BRHTZSIDBDA

Safety & Warnings	3
Components	4
Assembly	5
Cleaning & Care	16
Troubleshooting	17
Notes	18

SAFETY & WARNINGS

- Lift don't drag. This protects your floor and product.
- Check the assembly guide for required components.
- Assembly requires 2 people. It's always easier with a friend.
- Assembling this product on a soft surface protects its finish.
- Avoid loose screws. Tighten fixtures every few months.

**WARNING**

	
<p>Children have died from furniture toppling over.</p> <ul style="list-style-type: none">• ALWAYS secure this furniture with an anchor device.• NEVER allow children to stand, climb or hang on drawers, doors or shelves.	

COMPONENTS

Before you get started, check you have all the pieces below.

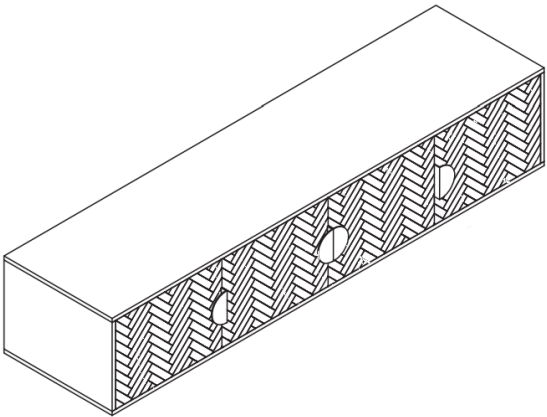

1 Body

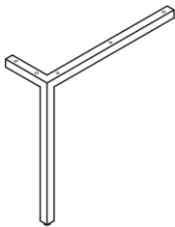

2 Leg Frame (x2)

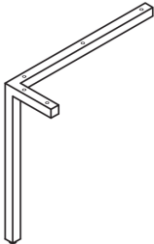

3 Leg Frame (x2)

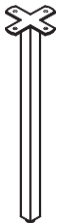

4 Middle Leg

Hardware

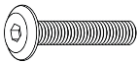

A 6x35mm Bolt
(x20)



B 8x16mm Washer
(x24)

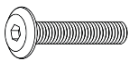

C 6x16mm Bolt (x4)

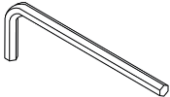

D 4mm Allen Key

ASSEMBLY

- Assemble furniture using the provided instructions.
- Do not dispose of any packaging or contents of the shipping carton until assembly is completed to avoid accidentally discarding small parts or hardware.

Placement

- Keep furniture on flat, level ground. Placing it unevenly may cause deformation
- Do not place heavy objects on furniture.
- When repositioning furniture always lift, don't drag.
- Keep sharp objects away. They cause scratches and splinters to the surface.
- Do not stack furniture.

Step 1:

Align a leg frame (2) with the holes on the bottom of the body (1). Insert a bolt (A) and bolt (C) with Washer (B) into a hole. Tighten the bolt with your hand until it is finger tight. Repeat this for the remaining holes and then repeat the process for the remaining leg frames (2, 3 & 4).

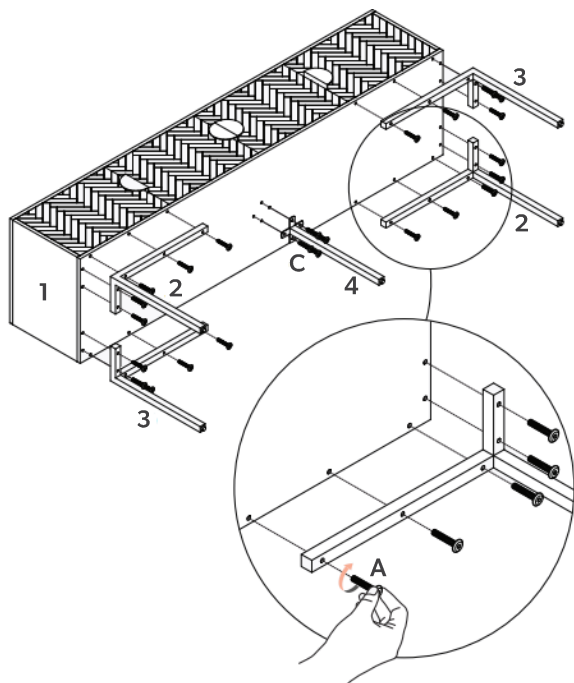
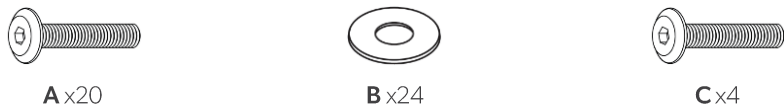

Step 2:

Tighten all bolts with the Allen key **(D)**.



D

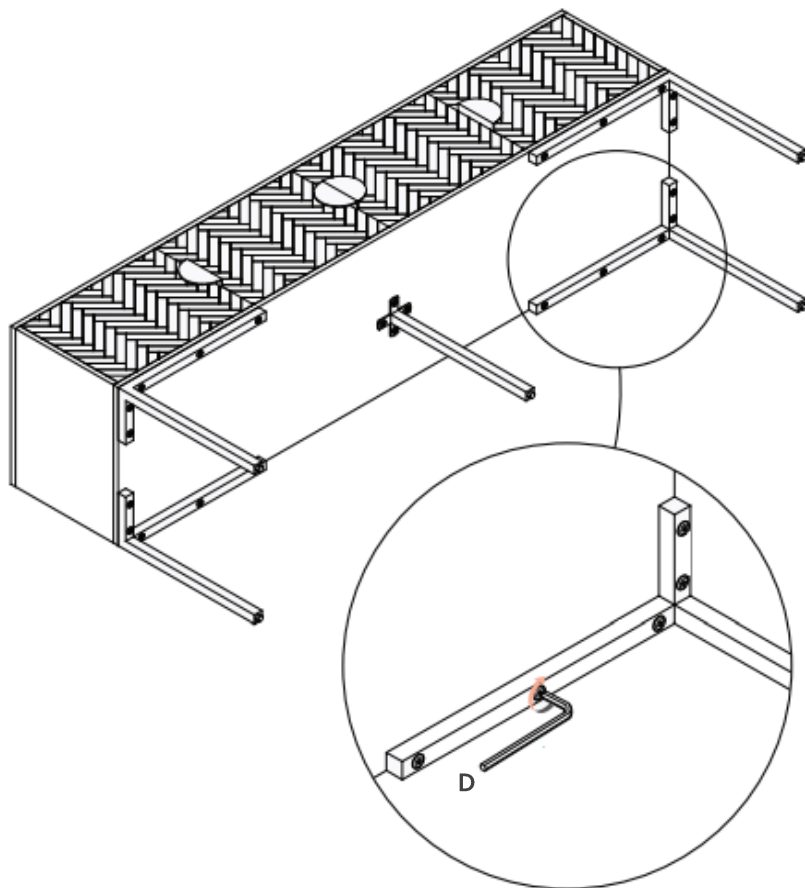

Step 3:

Lift the piece of furniture off the ground and place it upright on a level surface.

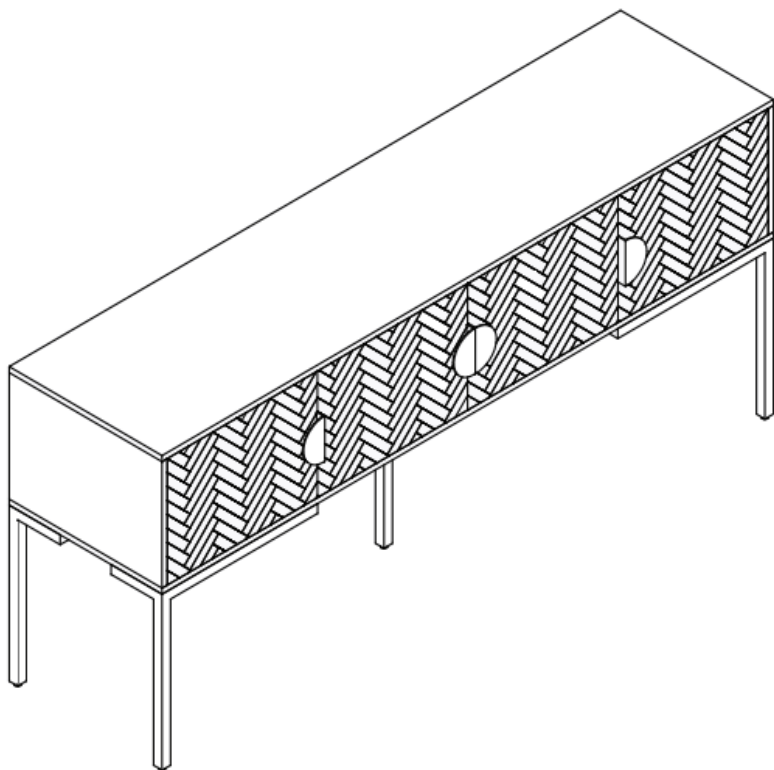

Disassembling the Door

Follow the steps below to disassemble your doors when needed.

Step 1:

Loosen the screw at the end of the hinge arm.

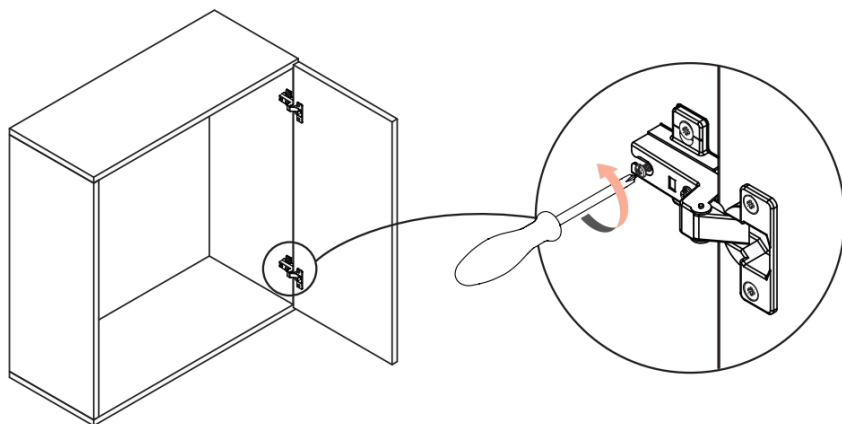

Step 2:

Gently pull the door so that it is separated from the body.

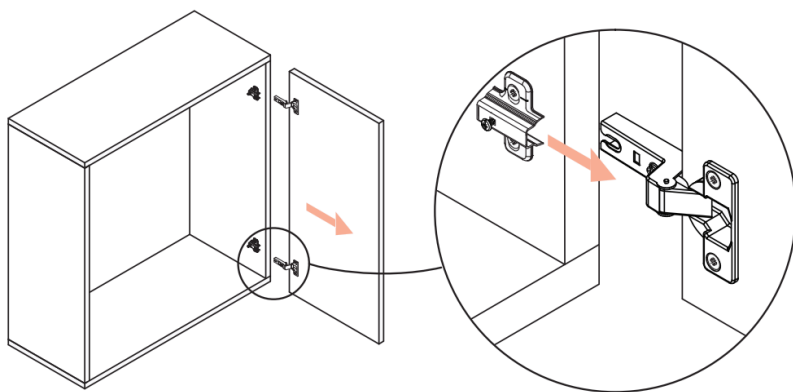

Reverse the steps above to get the doors attached again.

Anti-Tip Kit Installation

It is strongly recommended to install anti-tip kit for safety.

Hardware

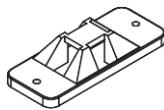

a x4



b x2



c x4



d x4



e x4

Wall Fixings

Identify your wall composition and contact your local hardware store to get the appropriate fixings.

Wood

If fixing to wood, make sure that it isn't chipboard as screws can easily pull away from the core structure.

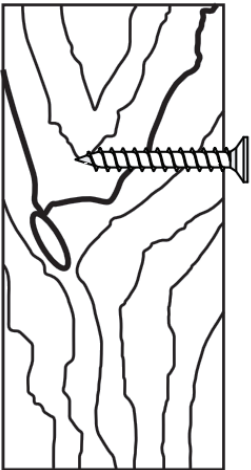

Brick or Masonry

Use an appropriate wall plug provided you are sure your wall is sound.

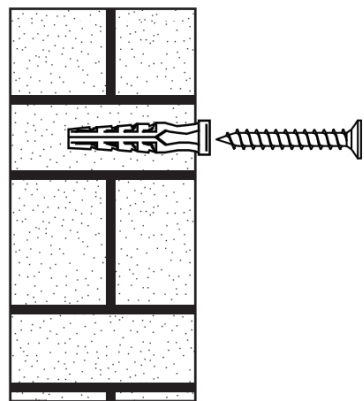

Cavity Wall

Special toggle wall plugs are needed. Seek expert advice.

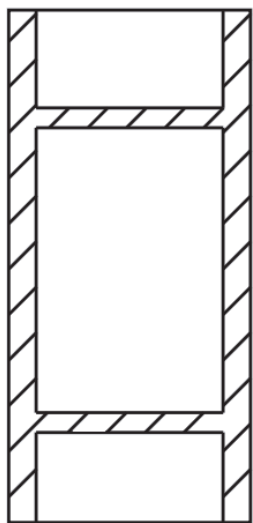

What You Need

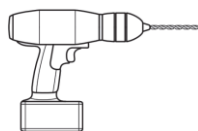

Step 1:

Attach the brackets **a** securely to the rear top of the product using the short screws **(c)** provided.

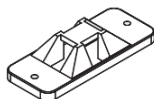

a x2



c x4

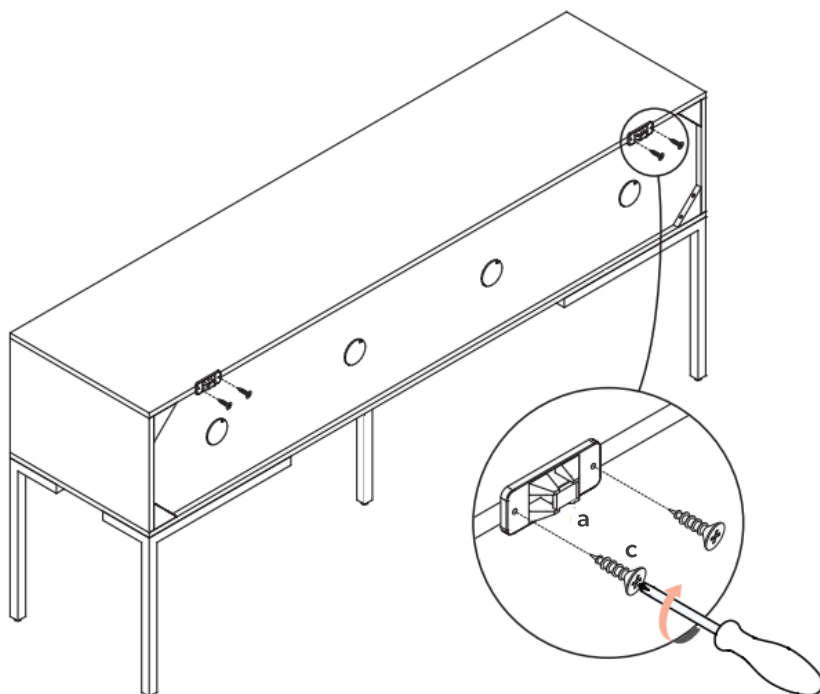

The instructions below demonstrate how to attach the kit to the wall using the wall anchors provided. However, you must identify the type of your wall and choose the appropriate wall fixings.

Step 2:

Determine where the piece is to be placed and mark locations on the wall for the mounting brackets a using a pencil. Move the furniture out of the way so that the brackets can then be mounted to the wall.

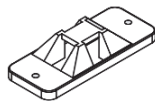

a x2

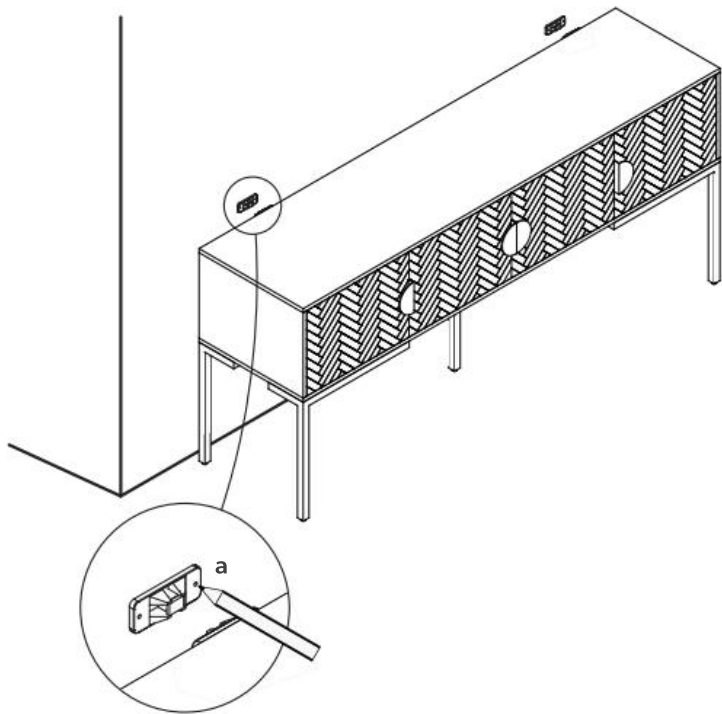

Step 3:

Drill holes for the wall plugs using a drill. Knock the plugs e into the holes using a hammer. Place the brackets against the plugs again and fix the brackets with the long screws d.



d x4



e x4

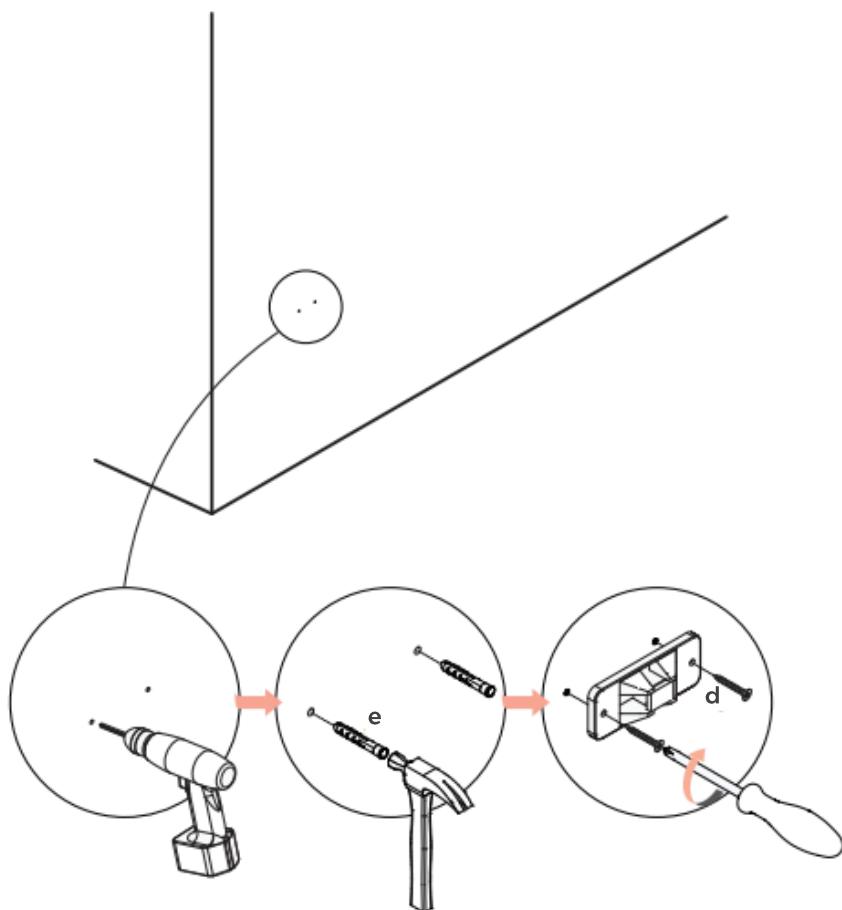

Step 4:

Lace the nylon strap (**b**) down through the brackets. Slide the thin end of the strap through the receiving end on the nylon strap. Pull to tighten the piece of furniture snug against wall.



b x2

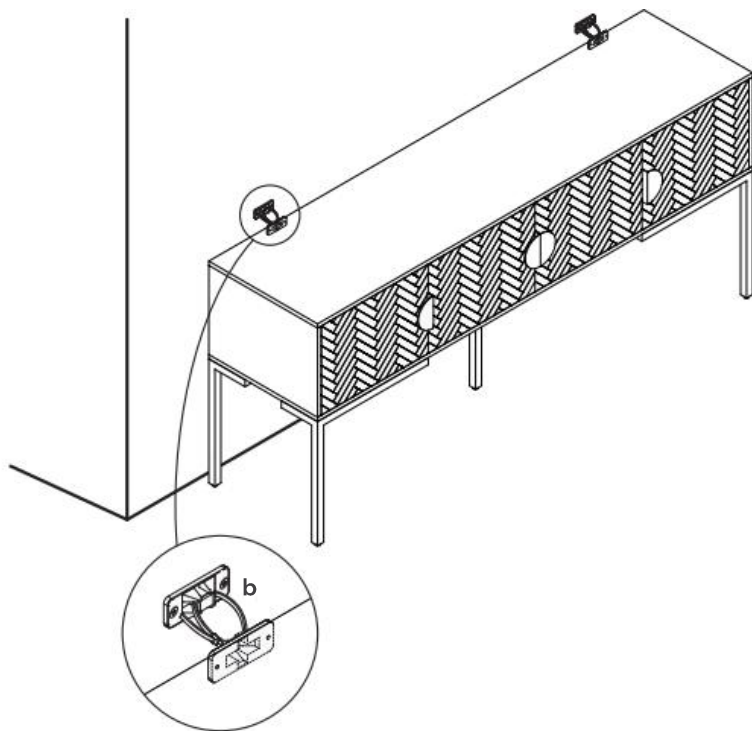

CLEANING & CARE

Cleaning and Maintenance

- Clean furniture regularly with a white soft cloth. Slightly damp fabrics help absorb dust but remember to dry it once you're done.
- Clean spills and stains immediately with a clean cloth. If you're on hand to wipe up any spills straight away, you shouldn't encounter any problems.
- Keep liquids away as they may damage the finishing.
- Avoid harsh cleaning chemicals such as alcohol or gasoline solvents. Avoid using sponges or dirty cloths.
- Cover furniture that isn't being used to protect from dust and ageing.
- Re-tighten screws and attachments if they loosen.

Material

Brass is a natural material and as such may tarnish over time. This can be brought on through regular use or temperature and environment change. To reduce the look of tarnishing and return your brass to its original colour, please use the soft scotch pad to gently rub the affected area and surrounding areas. You can then apply a clear wax or PU lacquer to protect the surface again. All products are previously treated with PU lacquer to help reduce the risk of tarnishing.

Exposure

- Use protective coasters and mats for items on the furniture.
- Keep furniture away from intense direct sunlight. Exposure can cause cracks or discolouration.
- Severe changes in temperature and humidity can accelerate ageing. Keep furniture at least 60cm from heating or air conditioning.
- Do not place furniture near open flames.

TROUBLESHOOTING

Upon receiving your product, you might find that the door doesn't align well. This not a product flaw and can be adjusted following the instructions below.

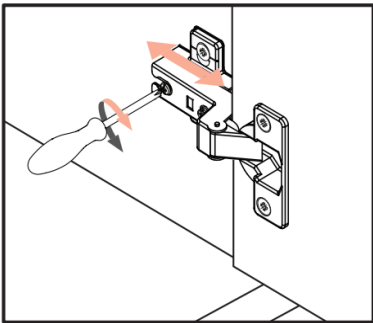
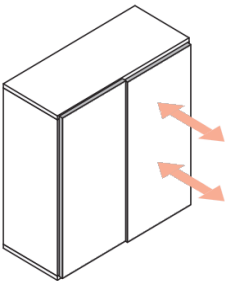
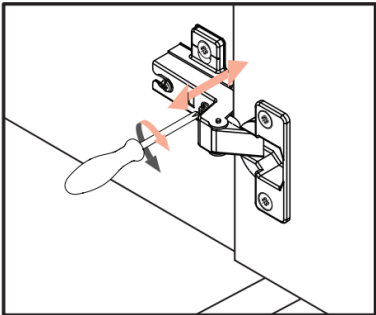
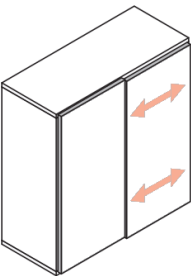
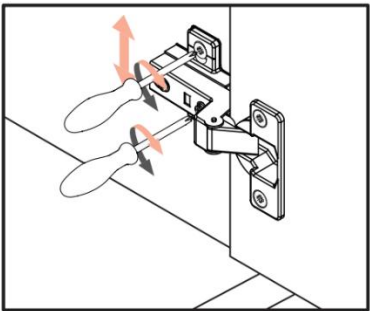
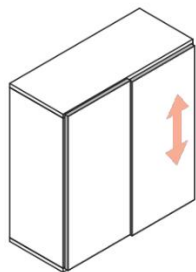

NOTES

[illegible]

[illegible]

NEED MORE INFORMATION?

We hope that this user guide has given you the assistance needed for a simple set-up.

For the most up-to-date guide for your product, as well as any additional assistance you may require, head online to **help.brosa.com.au**

BROSA