

1. Safety Instructions

This user manual includes important safety information. Please read below instructions carefully. It may be dangerous or illegal if you do not follow these instructions.

Pay attention to Traffic Safety

Obey local traffic laws and do not use the phone while driving. Using a cell phone while driving is dangerous and it is illegal in some areas. Radio frequency (RF) signals may affect improperly installed or inadequately shielded electronic systems in motor vehicles such as electronic fuel injection systems, electronic antiskid (antilock) braking systems, electronic speed control systems, and air bag systems. For more information, check with the manufacturer of your vehicle for any equipment that has been added. Do not place objects, including installed or portable wireless equipment in the area over the air bag or in the air bag deployment area.

Pacemaker Interference

Pacemaker manufacturers recommend that a minimum separation of 15.3 centimeters (6 inches) be maintained between a wireless phone and a pacemaker in order to avoid potential interference with the pacemaker.

Turn Off Your Cell Phone in Medical and Health Care Facilities.

Switch off your device in health care facilities when any regulations posted in these areas instruct you to do so. Hospitals or health care facilities may be using equipment that could be sensitive to external RF energy.

Switch Off on Airplanes

Using your device while flying in aircraft is prohibited. Switch off your device before

boarding an aircraft. The use of wireless devices in an aircraft may be dangerous to the operation of the aircraft, disrupt the wireless telephone network, and may be illegal.

Accessories and Batteries

Use only the approved accessories and batteries. Please do not try to use with any product that was not manufactured for use with this phone. Please be sure the phone has been switched off before taking out the battery. Please dispose of scrap batteries properly according to the local regulations.

Cell Phone Should Be Turned Off Near Sites of Explosion.

Potentially explosive atmospheres include areas where you would normally be advised to turn off your vehicle engine. Sparks in such areas could cause an explosion or fire resulting in bodily injury or even death. Switch off the device at refueling points such as near gas pumps at service stations and in any area with a potentially explosive atmosphere and obey all signs and instructions. Observe restrictions on the use of radio equipment in fuel depots, storage, chemical plants or where blasting operations are in progress.

Using the Phone Correctly

Please use this phone in its normal intended position. Do not let children use the phone without supervision. Your phone contains small parts such as SIM card, which can be accidentally swallowed by a child.

Your Phone is Not Waterproof

This phone is not waterproof. Please do not expose your phone to wet weather or environment (such as rain, snow, seawater, etc.).

3. Getting started

Remove the Back Cover

Open the battery cover carefully by prising open from the bottom right corner where you will find a small notch.

Install the SIM card and battery

For availability and information about using SIM card services, contact your SIM card vendor. This may be the service provider, network operator, or other vendor.

Note: The SIM card and its contacts are easily damaged by scratches or bending, so please be careful when handling, inserting, or removing the card.

Note: Keep all SIM cards out of the reach of small children.

1. Ensure the phone is switched off and the charger is disconnected before removing the battery.
2. With the back cover removed, install the SIM card by sliding it into the nest under the metal holding plate. Ensure the angled corner is on the lower right hand side. (To remove the SIM card, gently press on it and slide it out of its nest.) Please note you can only use a Nano SIM card and not a Micro or Standard SIM. You can also install a micro SD memory card into the slot beside the SIM slot.
3. Install the battery into the battery slot, ensuring that the three metallic stripes on the battery align with the three metallic prongs in the battery slot.
4. Put on the battery cover. Ensure the cover is completely closed and the matching sound (click) could be heard.
5. Plug the phone in to charge.

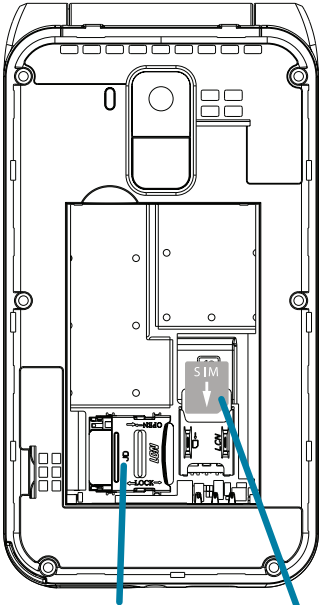

Micro SD      SIM

the left soft key.

4. Press the Middle of the Navigation key to choose the recipients of the text from your contact list or type the number manually then press the down Navigation key to start writing your text.
5. For MMS, press the middle navigation key to attach an image or an audio/ringtone on your message.
6. Press the left soft key twice to send your message.

Other options include Send, Insert template, Add contact, Add emoji and Save as draft. You can also access a stored message in inbox and reply to it. By selecting the Inbox instead of Write Message and following the same commands.

Receiving/Reply to a Message

When you receive a new text message, your phone will display an envelope icon and “New Message”.

1. Press the Left soft key to read the message.
2. Press the Left Soft key again to see a list of available commands such as “Delete”, Reply” etc..

Delete	To delete the message.
Reply	To reply the message
Forward	To forward the message
Call	To call the sender
Move	To move to phone/sim storage
Add to contacts	To add the sender to your Phonebook
Details	To see the details.

Letters and Numbers Input

Text Message Letters

English letters are set on number keys from “2” to “9”. You can input numbers, upper or lower case letters and punctuation symbols. Pressing the hash key while typing lets you switch between the different types of input modes. Each number key is set for three or four letters. Press the number key one time to display the first letter, two times to display the second letter, etc.

Text Message Punctuation

The punctuation available includes: \ / ~ < > \$ @ % { } ? and more

To enter punctuation:

1. Press the \* star key to display the list of punctuation symbols
2. Use the navigation key to scroll through the list.
3. Press the Left Soft key to select.



Turning the Phone On

To turn the phone on, press and hold the red end key until the screen lights up.

If you switch on the mobile phone before inserting the SIM card, it prompts you to insert the SIM card. The mobile phone checks whether the SIM card is valid automatically after it is inserted. When you first switch on your phone it will ask you to set the language. The following prompts appear on the screen in sequence when the mobile phone is just switching on:

- Input phone password - If the password of the phone has been set.
- Input PIN - If the password of the SIM card has been set.
- Searching - The mobile phone is searching for available network.

Turning the Phone Off

To turn the phone off, press and hold the red key until the screen turns blank.

Charging the Battery

The battery can be charged when the phone is either on or off. Please ensure the battery is inserted into the phone before charging. The charging time is three hours.

To connect the charger:

1. Insert the cord into its port on the bottom panel of the phone
2. Plug the other end of the cable into either a computer USB socket or use any USB mains charger that runs at 240V.

To disconnect the charger:

1. Unplug the wall charger.
2. Remove the cord from the phone.

Battery Level Indication

 EMPTY FULL

Charging Using the Docking Charger

You can also use the docking charger for easy charging.

1. Simply plug the charger into the back of the dock.
2. Place the phone into the dock to start charging.
3. Remove the phone when charging is complete.

Please note: the dock charger is sold separately.

Low Battery Alert

The phone will sound an alert when the battery is low and display a message of low battery on the screen.

PLEASE NOTE: The TTfone TT760 does not come with a charger,

Text Message Numbers

To enter a number instead of a letter:

1. Press the # key to switch input mode from letter to numerical and then use number keys from 1 to 0 to enter numbers.
2. Press # again to switch back to letter input mode.

To enter a space, press the “0” key when in letter mode.

Security Inbox

The default password is 1234. To change the password go to Message/Security inbox/Options/Change password.

6. Contacts

Storing, Searching and Deleting Numbers in the Phone Book

Phone numbers can be stored on the phone or the SIM card. The green icon indicates that the contact is saved in the phone. The yellow SIM card symbol indicates that the contact is saved on the SIM card. You can store up to 500 entries in the phone memory.

To Add a New Contact to the Phone Book

1. Press the Left soft key to access the menu.
2. Select Contacts and press the left soft key.
3. Press the Left soft key to select Options.
4. Select Add new contact and press the left soft key.
5. Choose either to save to Phone memory or to SIM memory using the up an down navigation key. Press the Left soft key.
6. Press the middle navigation key to enter the name of the contact by using the number keypad. Press a key 1 to 4 times to enter the correct letter. press “0” for a space.
7. Once the name is set press the Left soft key to save the name.
8. Press the Down navigation key to select number, press the middle navigation key to edit. Enter the number by using the number keypad, press the Left soft key to save the number.
9. Press the Left soft key to Save.

To Search for an Existing Contact

1. Press the Left soft key to access the menu.
2. Select Contacts and press the left soft key.
3. Press Up or Down navigation key to search for the contact. Press the Left Soft key.
4. Select Call and press the left soft key.

To Delete an Existing Contact

1. Press the Left soft key to access the menu.

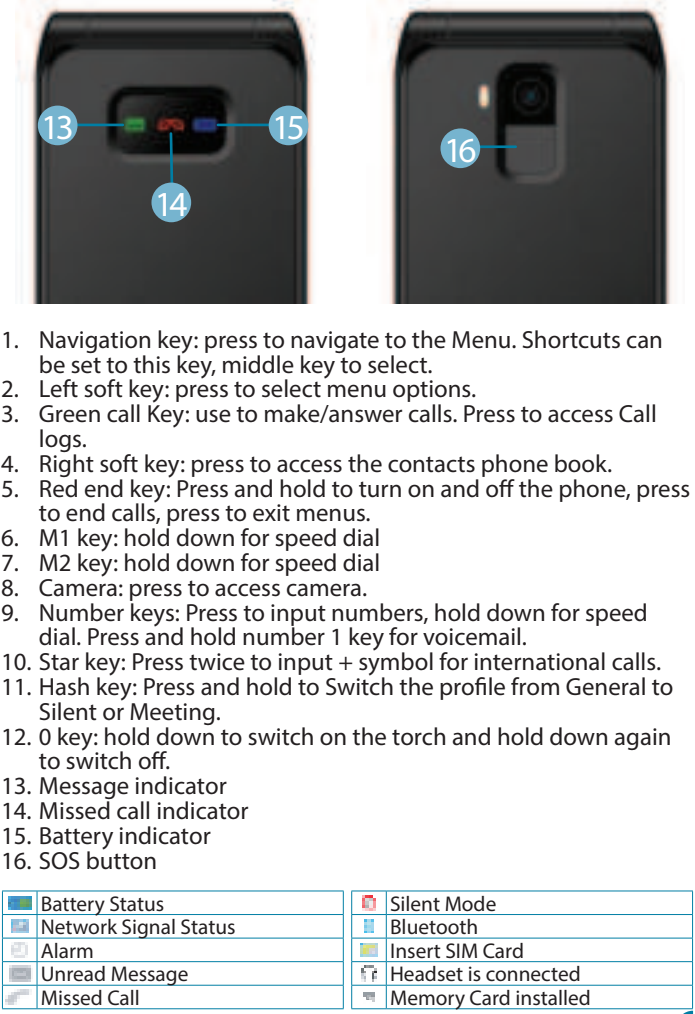

you can use any USB mains plug or plug the cable into your PC or Laptop to charge the phone. If you do not have one of these you can purchase a charger from [www.ttfone.com](http://www.ttfone.com)

4. Making/Receiving Phone Calls

To Make Calls

1. Enter a number and press the green call key to call.

- To delete a digit, press the Right Soft key.
- To clear the screen, press the red end key once.

To Answer Calls

When your phone rings, press the green call key once to answer the call.

To End a Call

To end a call, press the red end key.

To Reject a Call

To reject the call without answering, press the red end key when your phone rings.

To Redial a Number

1. Press the green call key to take you to all your recently dialed call list.
2. Select the number you want to dial then press the green call key to call.

Making International Calls

1. Press the star key twice until a “+” character appears on the screen.
2. Enter the country code, area code and phone number as instructed by your long distance network service carrier.
3. Press the green call key to call.

Changing the Volume during a Call

To change the volume during a call:

- Press the up or down navigation key.

5. Messages (SMS/MMS)

Writing and Sending a Message

1. Press the Left soft key to access the menu.
2. Select Messages and press the left soft key.
3. Press Up or Down navigation key until “Write message” appears. Press the middle navigation key and select New SMS or NEW MMS if you wish to use multimedia messaging service, press

2. Select Contacts and press the left soft key.
3. Press Up or Down navigation key to search for the contact. Press the Left Soft key.
4. Select Delete and press the left soft key.

7. Call logs

This option stores recently dialled calls, received calls and missed calls. Your phone can store up to 20 records for each function.

1. Press the Left Soft key to access the menu.
2. Choose Call logs and press the left soft key.
3. Scroll through available functions (missed calls, dialled calls, received calls, rejected calls, delete all and call timers).

Press the Left Soft key to select the desired function.

8. Multimedia

Camera

Navigate to Menu/Camera to open up the Camera App. Use the Middle Navigation key to take pictures and the Left Soft key to enter the options menu.

More options - to switch to Video recorder, to use flash, adjust image size, activate night mode, adjust brightness, contrast and exposure, set the white balance, the timer and the effects.

Image viewer - to see the pictures you have taken.

Settings - to set the quality of the photo, adjust the shutter sound and choose storage options.

Please Note: you will need to insert a MicroSD memory card in order to store the photos this is sold separately and available on our website [www.ttfone.com](http://www.ttfone.com).

Video Recorder

1. Press the Left Soft key to access the menu.
2. Select Multimedia and press the left soft key.
3. Press Up or Down navigation key until “Video Recorder” appears. Press the Left Soft key.

Press the Middle Navigation key to start/pause recording and press the left soft key to stop the recording (please note you may need a memory card inserted this is not included and can be purchased separately from [www.ttfone.com](http://www.ttfone.com)). Press the Left Soft key to enter the option menu.

Image Viewer

1. Press the Left soft key to access the menu.



2. Select Multimedia and press the left soft key.

3. Press Up or Down navigation key until “Image Viewer” appears.

4. Use the Up and Down navigation key to select the image and press the middle navigation key to view the image.
- Press the left Soft key to select the options these include: Set as wallpaper, Set as contact icon, Delete, Share, Edit image, Rename, Slide play, Details.

Audio Player

1. Press the Left soft key to access the menu.

2. Select Multimedia and press the left soft key.

3. Press Up or Down navigation key until “Audio Player” appears. Press the middle navigation key.

4. Use the Middle Navigation key to play and pause the track.

5. Use the left and right navigation keys to change tracks

6. Use the Up and Down navigation key to increase/decrease the volume.

Video Player

To watch the videos recorded:

1. Press the Left Soft key to access the menu.

2. Select Multimedia and press the left soft key.

3. Press Up or Down Navigation key until “Video Player” appears. Press the Left Soft key.

4. Press the middle navigation key to play the video playback. Press left and right navigation key to change to next or previous video. Press the up and down key to increase/ decrease the volume.

Sound Recorder

Record voice notes:

1. Press the Left soft key to access the menu.

2. Select Multimedia and press the left soft key.

3. Press Up or Down navigation key until “Sound Recorder” appears. Press the Left soft key.

4. Press the middle navigation key to start/pause the recording. Press the Right soft key to stop the recording.

5. Press the left soft key for Options menu where you can view Record file list and Storage.

FM radio

1. Press the Left Soft key to access the menu.

2. Select Multimedia and press the left soft key.

10. Apps

Calculator

Phone can provide basic calculator functions: addition, subtraction, multiplication and division.

1. Press the Left soft key to access the menu.

2. Select Apps and press the left soft key.

3. Press Up or Down navigation key until “Calculator” appears. Press the Left soft key. Enter number keys to enter values. Use the \* key for decimal. Use the navigation key to select the math operation: +,-,x and ÷.

4. Press the right soft key to clear the last digit or to exit the operation. Press the middle navigation key to complete the operation.

Calendar

To view the calendar please go to Menu/Apps/Calendar. Press the left soft key for Options to add new schedule or view schedule.

Alarm

You can set up up to three alarms in Menu/Apps/Alarm. Press the middle navigation key to enter to editing mode. In edit mode, you can choose a different alarm tone, change the time and set repeat options.

Turning off the Alarm

When the alarm sounds:

- Press the Left Soft key to shut off the alarm

• Press the Right Soft key to snooze.

Torch

To activate the flashlight function go to Menu/Apps/Torch. Here you can switch on and off the flashlight. You can also hold down the 0 key for 3 seconds when in standby mode, press and hold it again to switch off the torch.

World Clock

To view the time in other countries go to Menu/Apps/World Clock. Press the left soft key to add a new city.

Search Browser

The TT760 comes with a simplified Internet browser you can use to access your favourite websites. Go to Menu/Apps/Search browser select navigation and enter the web address and press the left soft key. You can also use the bookmark section for quick access to saved websites or urls.

This app needs an internet connection to use their services.

Contact your service provider for detailed subscription costs for

2. Language Settings - to set desired language.

3. Shortcut Settings - to set the shortcut menu for the navigation keys.

4. Auto Power On/Off - to set desired time schedule for power On and Off.

5. Power saving mode - a tool that helps you extend the battery life of your device.

6. Restore Factory Settings - to restore the default settings settings, use password 0000.

Display

1. Wallpaper - to set desired wallpaper background for the screen.

2. Idle display settings - to set your display settings when keypad is locked.

3. Brightness - to set the screen brightness of the display. Use the left and right navigation keys to decrease and increase the contrast.

4. Backlight - - to set the screen backlight time

5. Keypad backlight time - to set the keypad backlight time.

Security Settings

This is to prevent your mobile phone from illegal use. You can set SIM or PIN security as ON/OFF in Settings/Security Settings/Sim lock. PIN can be obtained from your network provider. You can also set Phone Lock as ON/OFF in Settings/SecuritySettings/Phone Lock.

NOTE: The default phone lock password is 0000. Please change into your own private password as soon as possible.

Screen Auto Lock - to set time for automatic screen timeout and keypad lock.

Key vibrate switch

Key vibrate determines when a press is registered without looking at the actual display. It also improves the accuracy of keypad typing. To switch on/off the vibration of the keys please go to Settings/Key vibrate switch.

Voice dial

When you press a number to dial, the phone speaks the number you pressed. To switch on/off the voice dial function please go to Settings/Voice dial. You can also adjust the volume to your liking.

Speed Dial

1. Press the Left soft key to access the menu. Press Up or Down navigation key until Settings appears. Press the Left soft key.

3. Press Up or Down navigation key until “FM radio” appears. Press the Left Soft key.

4. Press the middle navigation key to play or pause the FM radio. Press left and right navigation key to change station.

5. Use the up and down navigation key to increase/decrease volume.

Press the Left Soft key to select the options these include: Auto search and save, Channel list, Save, Manual search, Open speaker, Background play, Record, Timing record, Record file list, Storage. \*The quality of radio sound depends on signal quality at your location. Headphones act as an aerial so you will get better reception when they are plugged in.

9. SOS Menu

SOS Emergency Button

Important Notice: Wireless phones, including this device, operate using radio signals, wireless networks, landline networks, and user-programmed functions. Because of this, connections in all conditions and/or locations cannot be guaranteed. You should never rely solely on any wireless device for medical emergency communication. You can set the emergency numbers in the phone book according to your requirements; you can set a total of up to five emergency numbers. In case of an emergency, when the SOS button is pushed down the phone will automatically send a text message to the first emergency number set up on the phone. The mobile phone will then make the emergency call. If the first call fails, the phone will proceed to dialling the second emergency number. In this manner the phone will circulate the emergency contact numbers in order to receive an answer. The phone will also sound an alarm when an emergency call or message is sent.

Please note: If one of the emergency numbers has a voicemail system, the phone will assume that the call has been answered and will no longer call any more of the emergency numbers.

To activate the SOS function, first add at least one SOS number then switch SOS status to “ON”.

Attention! The Emergency SOS button will only make calls if:

1. A SIM card is in the mobile.

2. There is at least one SOS number programmed.

3. There is a SOS text message saved.

your data allowance. Please note that this is a basic text-based search engine browser, some websites will not load due to the basic nature of this browser.

My files

You can manage and organise any file stored on your device. Please go to Menu/Apps/My Files and choose either the Phone memory or the Memory card (Micro SD card). Press the left soft key to access the submenus to view or play multimedia files.

Bluetooth

The mobile phone supports Bluetooth function. You can use Bluetooth wireless technology to set wireless connection with other compatible devices, including mobile phones, computers, headsets, in-car accessories etc. With Bluetooth function, you can send photos, video segments, audio segments, personal business card and memos. You can also establish wireless connection with a compatible PC to transmit files.

Try to keep the two devices you are connecting through Bluetooth close together while they are in use. Most Bluetooth headsets have a range of 10 meters. If possible, try to keep your phone on a chair beside you or nearby while talking on your headset to ensure the best connection. When using your computer, try putting your phone on the desk beside your monitor to ensure the best connection possible.

Pair Bluetooth Devices

Have one of the devices “search for new devices” to find the other. Typically you want a phone to search for your headset or audio speaker rather than the other way around. The Search function is located within the Bluetooth menu in your phone.

1. Press the Left Soft key to access the menu.

2. Press Up or Down navigation key until Apps appears. Press the left soft key.

3. Press Up or Down navigation key until “Bluetooth” appears. Press the Left Soft key.

4. Press the Left soft key to activate Bluetooth then use this menu to pair devices, make your phone discoverable and edit your device name.

Once your phone finds the other device enter the “pairing code” for the device to link the two together. The pairing code is typically located on a sticker on the back of a headset or in the instruction book for a device.

2. Select Speed dial and press the left soft key.

3. Scroll up and down and select Number list. You can set the phone numbers to the desired number keys. Press left soft key for Options and select Edit and type the number manually or press the Left soft key to select contacts from Phonebook.

Status - to view if the Speed dial is activated or not.

To call these set speed dial numbers simply hold down the desired key for 3 seconds in home screen.

Indication LED

The indication lights lets you identify if you have an unread message, a missed call and an incoming call. You can disable the indication lights in Settings/Indication LED.

Flight mode

When activated, this mode suspends the device’s radio-frequency signal transmission technologies, effectively disabling the device from sending or receiving calls, text messages and data services. You can activate/deactivate Flight mode in Settings/Flight mode.

13. Troubleshooting

Phone does not turn on

1. Ensure you have held the power button down for more than 5 seconds.

2. Re-insert the battery and retry turning on the phone.

3. Plug charger into the phone and ensure the battery is charged. Cannot connect to a network

1. Signal strength may be weak, try moving your location and try again.

2. It may be possible that you are using the phone beyond the network service coverage area.

3. Check that your SIM card is correctly installed and is valid. (Contact your network provider)

Phone call quality is poor

1. Increase the call volume using the Up and Down keys during calls.

2. It may be that the network reception is poor in your location. Try moving to another area to obtain a better connection.

Shorter standby time

1. Standby time is related to system settings. In areas of poor reception, the phone will use more battery power to try to find a base station.

2. It could also be the case that the battery of the phone has become worn out. You may need to replace the battery.

SIM card Error

1. Reinstall the SIM card in the phone. Ensure the metal contacts are clean - wipe gently with a clean cloth before inserting into the phone.

2. The SIM card may not be correctly installed.

3. If the SIM card is damaged contact your service provider.

Some features do not operate or cannot be set

1. This could be due to an operation error on the phone. Switch the mobile phone off and restart after 30 seconds.

2. The network provider may not support the feature you are trying to use and this may prevent its use. Cannot receive incoming calls

1. Ensure your mobile phone is switched on and connected to a network.

2. Ensure your SIM card is correctly installed.

3. Call restrictions may be prohibiting incoming phone calls, so these settings must be checked.

4. Poor areas of network coverage can

Status

To view the SOS status go to SOS Menu/Status. Press Up or Down navigation key to choose either ON and OFF. Press the Left soft key for OK.

SOS number list

To add the Emergency Contact Numbers from Phonebook:

1. Press the left soft key to access the menu.

2. Select SOS and press the left soft key.

3. Press Up or Down navigation key until “SOS number list” appears. Press the Left soft key.

4. Press the left soft key for Options menu to choose either to “Edit” if you would like to input number manually or “Import contacts” if you would like to add contacts from your contact list. Press the Left soft key to save number.

5. Repeat process to add 4 other emergency contacts.

SOS SMS

When the SOS function is activated the phone can send out an emergency SMS.

To Edit the SOS Message:

1. Press Up or Down navigation key to choose “SOS SMS” appears. Press the Left soft key.

2. Manually type text of the message. Press the middle navigation key to save.

SOS Settings

To activate SOS Ring Alert

When the SOS function is activated the phone can sound a loud Siren alarm to alert people nearby to a problem. To activate or deactivate the Siren, press up or down navigation key and select SOS Ring Alert and press left soft key to activate or deactivate SOS Ring Alert.

To activate SOS LED Alert

When the SOS function is activated the phone’s torch will flash a light to draw attention of the people. To activate or deactivate the LED Alert, press up or down navigation key and select SOS LED Alert and press left soft key to activate or deactivate SOS LED Alert.

11. Sound Profiles

You can use profiles to set and customise the ring tones, message alert tones, and other tones for different events.

1. Press the Left soft key to access the menu.

2. Select Sound Profiles and press the left soft key.

3. Use the Up or Down navigation key to select from the following profiles: Normal, Silent, Meeting.

4. Press the Left Soft key and choose Settings to enter the editing mode. Here you can Activate or customise the Settings for each profile according to the items in the table below.

Settings Menu

Setting	Description
Rename	Change the name of the profile
Ring Settings	Change the ringtone and message tone
Adjust volume	Change the volume for Calls, Messages and Alarms
Ring Type	Change the Vibrate settings
Other alert rings	Change the keypad tone, battery low alert and power ringtone.

12. Settings

Call Settings

These features require the support of your network provider based on the calling package you select when you purchase your phone. To access the Call Setting Menu go to Settings/Call Settings. You can also activate or deactivate the flip answer during calls.

Call divert	Divert calls to another number *your network may charge for this service
Call waiting	Activate call waiting services
Call barring	Restrict numbers you will call or accept calls from.
Hide ID	Hide your phone number *network must support for this feature to work
Others	Auto redial, Call time minute reminder, Vibration when connected, Answer/Reject mode, Flight mode, Auto Call record
Blacklist	Can be used to block phone numbers that you do not want to receive calls and messages from

Phone Settings

1. Time and Date - to set date and time.

- prevent incoming calls so check the network status of your phone. Phone not charging

1. Bad connections can hinder the phone charging; ensure all contacts are correctly connected.

2. Check to see whether the phone battery charging slot or the charger itself is damaged. If so, discontinue use. Replace battery or charger.

3. The phone cannot be charged in temperatures below 10°C or above 55°C.

- Does not dial numbers

1. Confirm that once the number is entered using the keypad that the call button is pressed to dial the phone number.

2. Check the phone number entered is correct.

3. Check reception coverage status of your mobile phone.

4. Ensure the call restriction settings are correct in order for you to dial outgoing calls.

14. Radio Frequency (RF) Exposure and SAR

The highest SAR Value - 1.004 w/kg.

15. Declaration of Conformity

TTfone/TTPlus Limited hereby declares that TT760 conforms to the essential requirements and other relevant regulations contained in the Directives EN 301 511 V.12.5.1 (2017-03). A copy of the Declaration of Conformity is available at : www.ttfone.com/doc

Correct disposal of this product (Waste Electrical & Electronic Equipment) (Applicable in countries with separate collection systems)

The trash can marking on the product, accessories or manual indicates that the product and its electronic accessories (e.g. charger, headset, cable should not be disposed of with other household waste. To prevent possible harm to the environment or human health from uncontrolled waste disposal, please separate these items from other types of waste and recycle them responsibly to promote the sustainable reuse of material resources. Household users should contact either the retailer where they purchased this product, or their local government office, for details of where and how they can take these items for environmentally safe recycling. Business users should contact their supplier and check the terms and conditions of the purchase contract. This product and its electronic accessories should not be mixed with other commercial wastes for disposal. This product is RoHS compliant.

Correct disposal of batteries in this product

The trash can marking on the battery, manual or packaging indicates that the battery in this product should not be disposed of with other household waste. Where marked, the chemical symbols Hg, Cd or Pb indicate that the battery contains mercury, cadmium or lead above the reference levels in EC Directive 2006/66. If batteries are not properly disposed of, these substances can cause harm to human health or the environment. To protect natural resources and to promote material reuse, please separate batteries from other types of waste and recycle them through your local, battery return system.



Check out our other fantastic range of products at [www.ttfone.com](http://www.ttfone.com)