

# HEDPS SHALLOW SERIES HORN LOADED DRIVERS

HEDPS1 HEDPS8 HEDPS65 HEDPS69

## TECH SHEET

Expanding on Cerwin Vega's Pro Driver Lineup is the addition of 3 Full Range Horn Loaded Drivers, and 1 Horn Loaded Bullet Tweeter. These drivers are designed to create amazing sound and LOTS of it. Utilizing the horn loaded design increases the driver's efficiency to better utilize available power while producing incredible output. These horns are matched to the treated paper cones for that tonal balance and quick and accurate response to all music demands. High Power Handling also contributes to the output capabilities when you want and NEED to have that concert replicated sound. Available in 8", 6x9" and 6.5" to perfectly fit your application. For times where you might get too overzealous with the volume knob; we also offer replacement diaphragms for tweeter infield serviceability.

## HEDPS8

### FEATURES:

- High Power Handling 200W RMS/600W MAX
- Treated Paper Cone Woofer
- Horn Loaded Tweeter
- Field Servicable Tweeter Diaphragm(HEDPSTD)
- Mesh Steel Grills Included
- Sold Each

### SPECIFICATIONS:

- |                           |                   |
|---------------------------|-------------------|
| • Power Rating:           | 200W RMS/600W MAX |
| • Sensitivity:            | 95dB 1W/1M        |
| • Frequency Response:     | 85Hz-20kHz        |
| • Nominal Impedance:      | 4Ω                |
| • Free-Air Resonance (FO) | 95Hz              |
| • Mounting Depth:         | 80.5mm / 3.16in.  |
| • Cut-out Diameter:       | 179mm / 7.04in.   |
| • Over-All Diameter:      | 210mm / 8.27in.   |
| • Over-All Height:        | 88mm / 3.46in.    |

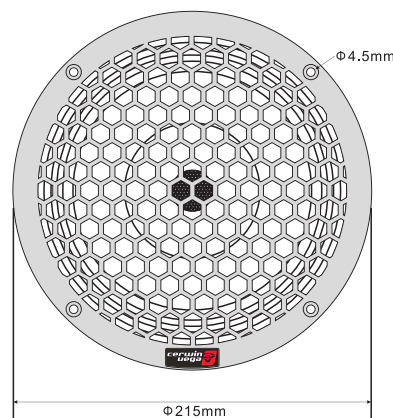
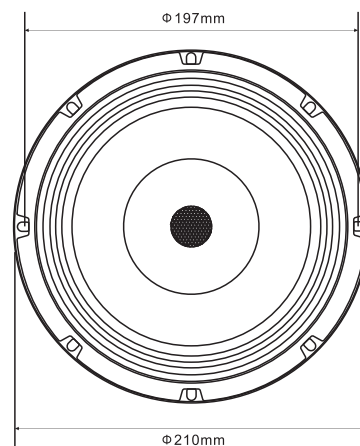
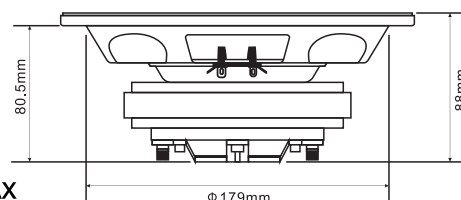

Cerwin-Vega YouTube: @cerwinvega\_usa

**CERWINVEGA.COM**

Email: [helpdesk@dat-cvm.com](mailto:helpdesk@dat-cvm.com)

Direct line: 213-261-4161

©2025 Cerwin Vega. All Rights Reserved.

# HEDPS SHALLOW SERIES HORN LOADED DRIVERS

HEDPS1 HEDPS8 HEDPS65 HEDPS69

## TECH SHEET

Expanding on Cerwin Vega's Pro Driver Lineup is the addition of 3 Full Range Horn Loaded Drivers, and 1 Horn Loaded Bullet Tweeter. These drivers are designed to create amazing sound and LOTS of it. Utilizing the horn loaded design increases the driver's efficiency to better utilize available power while producing incredible output. These horns are matched to the treated paper cones for that tonal balance and quick and accurate response to all music demands. High Power Handling also contributes to the output capabilities when you want and NEED to have that concert replicated sound. Available in 8", 6x9" and 6.5" to perfectly fit your application. For times where you might get too overzealous with the volume knob; we also offer replacement diaphragms for tweeter infield serviceability.

## HEDPS65

### FEATURES:

- High Power Handling 120W RMS/360W MAX
- Treated Paper Cone Woofer
- Horn Loaded Tweeter
- Field Servicable Tweeter Diaphragm(HEDPSTD)
- Mesh Steel Grills Included
- Sold Each

### SPECIFICATIONS:

- |                           |                   |
|---------------------------|-------------------|
| • Power Rating:           | 120W RMS/360W MAX |
| • Sensitivity:            | 94dB 1W/1M        |
| • Frequency Response:     | 130Hz-20kHz       |
| • Nominal Impedance:      | 4Ω                |
| • Free-Air Resonance (FO) | 150Hz             |
| • Mounting Depth:         | 78mm / 3.07in.    |
| • Cut-out Diameter:       | 144mm / 5.66in.   |
| • Over-All Diameter:      | 165mm / 6.49in.   |
| • Over-All Height:        | 85.5mm / 3.36in.  |

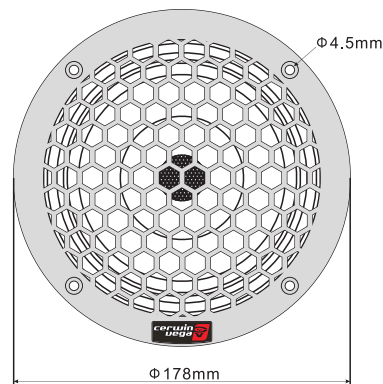
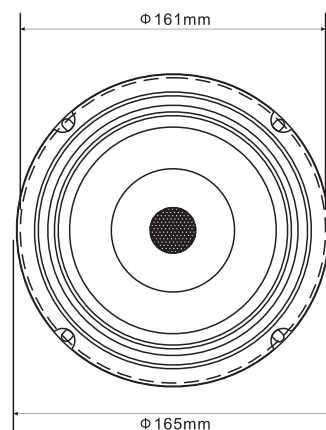
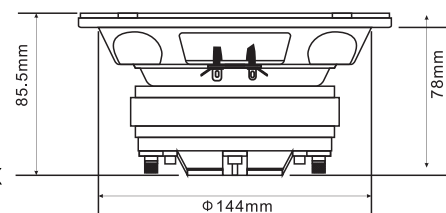

Cerwin-Vega YouTube: @cerwinvega\_usa

**CERWINVEGA.COM**

Email: [helpdesk@dat-cvm.com](mailto:helpdesk@dat-cvm.com)

Direct line: 213-261-4161

©2025 Cerwin Vega. All Rights Reserved.

# HEDPS SHALLOW SERIES HORN LOADED DRIVERS

HEDPS1 HEDPS8 HEDPS65 HEDPS69

## TECH SHEET

Expanding on Cerwin Vega's Pro Driver Lineup is the addition of 3 Full Range Horn Loaded Drivers, and 1 Horn Loaded Bullet Tweeter. These drivers are designed to create amazing sound and LOTS of it. Utilizing the horn loaded design increases the driver's efficiency to better utilize available power while producing incredible output. These horns are matched to the treated paper cones for that tonal balance and quick and accurate response to all music demands. High Power Handling also contributes to the output capabilities when you want and NEED to have that concert replicated sound. Available in 8", 6x9" and 6.5" to perfectly fit your application. For times where you might get too overzealous with the volume knob; we also offer replacement diaphragms for tweeter infield serviceability.

## HEDPS69

### FEATURES:

- High Power Handling 160W RMS/480W MAX
- Treated Paper Cone Woofer
- Horn Loaded Tweeter
- Field Servicable Tweeter Diaphragm(HEDPSTD)
- Mesh Steel Grills Included
- Sold Each

### SPECIFICATIONS:

- Power Rating: 160W RMS/480W MAX
- Sensitivity: 94dB 1W/1M
- Frequency Response: 90Hz-20kHz
- Nominal Impedance: 4Ω
- Free-Air Resonance (FO) 102Hz
- Mounting Depth: 90mm / 3.16in.
- Cut-out Diameter: 213x148mm / 8.38x5.82in.
- Over-All Diameter: 235x167mm / 9.25x6.57in.
- Over-All Height: 97mm / 3.81in.

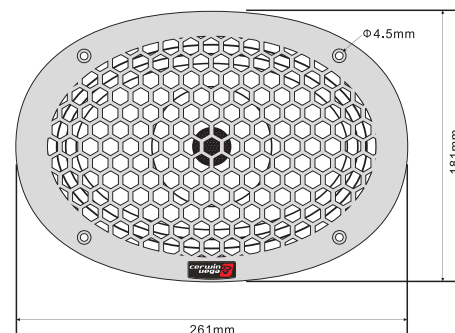
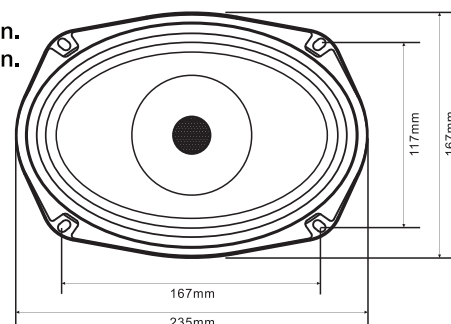
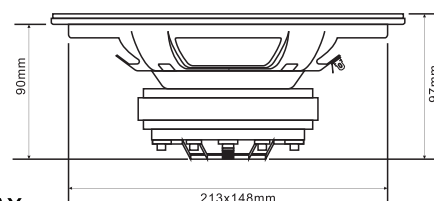

Cerwin-Vega YouTube: @cerwinvega\_usa

**CERWINVEGA.COM**

Email: [helpdesk@dat-cvm.com](mailto:helpdesk@dat-cvm.com)

Direct line: 213-261-4161

©2025 Cerwin Vega. All Rights Reserved.

# HEDPS SHALLOW SERIES HORN LOADED DRIVERS

HEDPS1 HEDPS8 HEDPS65 HEDPS69

## TECH SHEET

Expanding on Cerwin Vega's Pro Driver Lineup is the addition of 3 Full Range Horn Loaded Drivers, and 1 Horn Loaded Bullet Tweeter. These drivers are designed to create amazing sound and LOTS of it. Utilizing the horn loaded design increases the driver's efficiency to better utilize available power while producing incredible output. These horns are matched to the treated paper cones for that tonal balance and quick and accurate response to all music demands. High Power Handling also contributes to the output capabilities when you want and NEED to have that concert replicated sound. Available in 8", 6x9" and 6.5" to perfectly fit your application. For times where you might get too overzealous with the volume knob; we also offer replacement diaphragms for tweeter infield serviceability.



## HEDPS1

### FEATURES:

- High Power Handling 60W RMS/180W MAX
- Horn Loaded Tweeter
- Field Servicable Tweeter Diaphragm(HEDPS1D)
- Sold Each

### SPECIFICATIONS:

- Power Rating: 60W RMS/180W MAX
- Sensitivity: 96dB 1W/1M
- Frequency Response: 1kHz-20kHz
- Nominal Impedance: 4Ω
- Free-Air Resonance (FO) 1500Hz
- Mounting Depth: 33mm / 1.29in.
- Cut-out Diameter: 70mm / 2.75in.
- Over-All Diameter: 96.5mm / 3.79in.
- Over-All Height: 38mm / 1.49in.

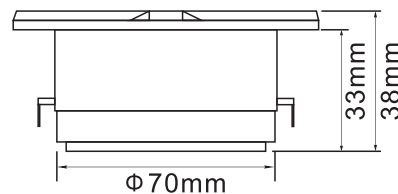

## HEDPS1D

Replacement Diaphragm for HEDPS1

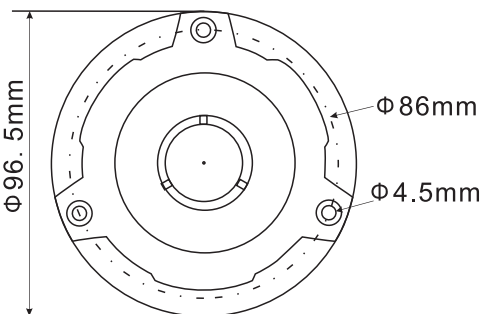

## HEDPSTD

Replacement Diaphragm for HEDPS8, HEDPS65, HEDPS69

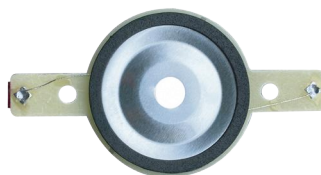

Cerwin-Vega YouTube: @cerwinvega\_usa

**CERWINVEGA.COM**

Email: [helpdesk@dat-cvm.com](mailto:helpdesk@dat-cvm.com)

Direct line: 213-261-4161

©2025 Cerwin Vega. All Rights Reserved.