

Universal Two Channel Garage Door Opener Wireless Keypad JP-LT



Please read all the instructions thoroughly BEFORE beginning.

Start with the garage door closed and determine your garage door opener type - Smart/Learn Button or DIP Code Switch and would be located either on the opener itself or have a separate radio receiver. Refer to the owner manual if necessary. This keypad can control up to two garage door openers and they can be different brands or types as long as they are in the types listed tables.

NOTE: The following brand names are part of the Chamberlain brand: Access Master, Chamberlain, Do-It, Gatheron, LiftMaster, Link Control, Master Mechanic, Merik, Raynor, Sears Craftsman, Steel Craft, True Value.

NOTE: Factory default 4 digit PIN code for channel one is **1111** and for channel two is **2222**, see "Change an Existing PIN Code" to change them.

TYPE 1 Chamberlain, Genie, Linear MegaCode, Moore-O-Matic, Overhead Door, Stanley, Wayne Dalton. Garage door opener with the **Smart/Learn Button**

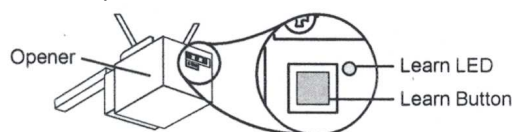

TYPE 2 Digi-Code, Genie, Linear Delta3, Moore-O-Matic, Multi-Code, Stanley. Garage door opener with the **DIP Code Switch**

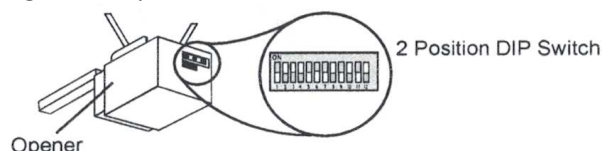

Programming a TYPE 1 Smart/Learn Button opener

1. Press and hold * and # buttons at the same time to enter program mode.
2. Enter **1#** (for channel 1) or **2#** (for channel 2).
3. Enter the 2-digit opener ID (from chart 1) __ then #.
4. Press and release the learn button on the garage door opener so its LED comes on.
5. Enter the existing 4-digit PIN Code ____# (Factory default is **1111** for channel one and **2222** for channel two)

NOTE: For Genie and Overhead Door openers the PIN code will need to be entered twice before the receiver will learn the code.

Example: For Chamberlain opener with purple learn button on channel one once in program mode you would enter: **1# 03# 1111#** (assuming PIN code has not been changed)

6. Test the keypad by entering the 4-digit PIN code then #.
7. Repeat for second channel if needed.

Opener ID	Brand	Type/Learn Button
01	Linear	MegaCode 318MHz 1997 - Current
02	Chamberlain Brands	Red/Orange Button 390MHz 1997 - 2005
03	Chamberlain Brands	Purple Button 315MHz 2005 - Current
04	Chamberlain Brands	Green Button 390MHz 1993 - 1996
05	Genie Overhead Door	Intellicode Code Dodger 315MHz 2005 - Current
06	Genie Overhead Door	Intellicode Code Dodger 390MHz 1995 - 2005
07	Stanley	Secure Code 310MHz 1998 - Current
08	Chamberlain Brands	Yellow Button 310/315/390MHz 2011 - Current
09	Wayne Dalton	Rolling Code 372.5MHz 1999 - Current

Chart 1

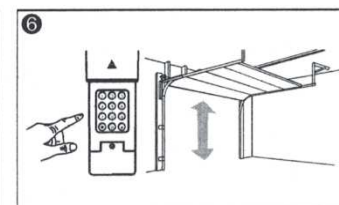
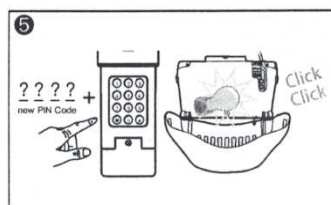
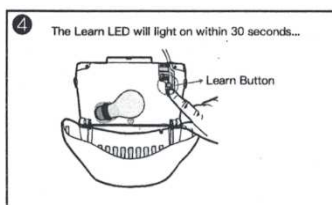
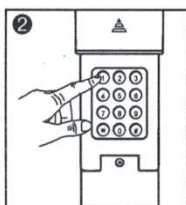
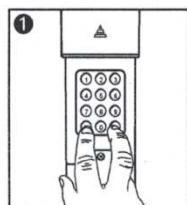

Many older garage door openers used an external radio receiver so the code switch settings will have to be found on the receiver itself or from the remote. You can locate the receiver by looking for where the wire antenna is

1. Press and hold * and # buttons at the same time to enter program mode.

- Example: For the code switch settings shown below you would enter **2-8-8-8-2-2-2-8-8-8-8-8-#** as the code switch sequence.

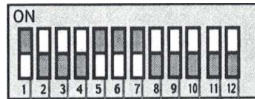

- As a security precaution the keypad will lock up for 2 minutes if three consecutive incorrect PIN codes have been attempted

1. Press and hold * and # buttons at the same time to enter program mode.
2. Enter current 4-digit PIN Code ____ then # (factory default is **1111** for channel one and **2222** for channel two)
3. Enter new 4-digit PIN Code ____ then #

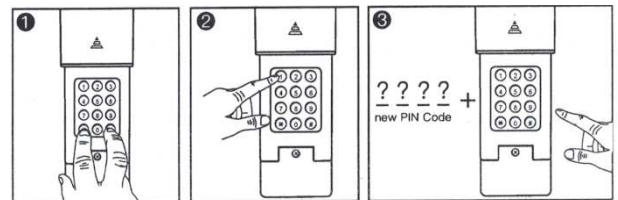

If needed the keypad can be reset back to the factory default PIN codes by removing the battery cover, press and hold down the Reset Button for 5 seconds until the keypad beeps to confirm that it has been reset. Factory PIN is **1111** for channel one and **2222** for channel two.

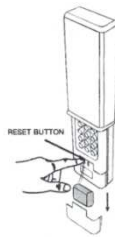

Install keypad out of reach of children at a minimum height of 5' within and within sight of the door. Note a 4" clearance is needed for the cover. Slide off the keypad cover and remote battery cover and battery. Mark the two screw holes and drill 1/8" pilot hole for the screws for a wood surface. If installing on other surface use appropriate mounting method. Secure keypad and re-assemble.

Replace the 9-Volt battery when keypad lights become dim or do not light up at all. To replace battery, slide keypad cover up then remove screw holding battery cover. Slide off battery cover and remove battery. Replace with a heavy-duty alkaline type battery. Re-programming may be needed when replacing the battery.

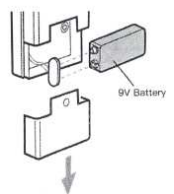

Email: support@remotes4less.com Tel: 855-373-6683