



User Guide

Kasa Smart Wi-Fi Light Switch, Motion-Activated
KS200M

Contents

About This Guide	1
Introduction	2
Set Up Your Smart Light Switch	4
Main Device Controls	5
Set Schedules	6
Set Timer	8
Set Away Mode	9
Check Runtime	10
Manage Device Settings	11
Reset Your Smart Light Switch	12
Create Scenes	15
Smart Actions	17
Discover Kasa	28

About This Guide

This guide provides a brief introduction to Kasa Smart Wi-Fi Light Switch and the Kasa app, as well as regulatory information.

Please note that features of Kasa Smart Wi-Fi Light Switch may vary slightly depending on the model and software version you have, and on your location, language and internet service provider. All images, steps, and descriptions in this guide are only examples and may not reflect your actual experience.

Conventions

In this guide, the following convention is used:

Convention	Description
Teal	Key information appears in teal, including management page text such as menus, items, buttons and so on.
<u>Underline</u>	Hyperlinks are in teal and underlined. You can click to redirect to a website.

More Info

- Specifications can be found on the product page at <https://www.tp-link.com>.
- Our Technical Support and troubleshooting information can be found at <https://www.tp-link.com/support>.

Introduction

TP-Link Smart Wi-Fi Light Switch is a standard wall light switch that can be controlled via your iOS or Android devices. Built-in motion and ambient light sensors work together to realize hands-free control. Kasa smart switch automatically turns your lights on and off, saving you effort and electricity bills. Create smart modes to customize your light settings to follow your routine with the easy-to-use app. Just set it then forget it. The Kasa Smart app also provides easy step-by-step installation instructions and convenient remote control from anywhere, anytime.



- **Advanced Sensing** - The equipped sensors detect motion and ambient lighting so your lights only trigger on at night.
- **Smart Modes** - Set different light triggers based on your routine for effortless control.
- **Easy Installation** - The detailed in-app guide and unique circuit design make installation simple.
- **Energy Saving** - Turn off the light automatically after you leave the room for a set time.
- **Remote Control** - Control anything connected to your smart light switch, like lights, ceiling fans or other fixtures, from anywhere using the Kasa Smart app.
- **No Hub Required** - Connect to your existing Wi-Fi router.
- **Away Mode** - Set your smart light switch to turn connected fixtures on and off at random intervals to give the appearance you're home even while you're away.
- **Scheduling** - Set lights to automatically turn on and off throughout the day or night whether you're home or away.
- **Voice Control** - Use Alexa, Google Assistant, or Microsoft Cortana to control your devices with voice commands.

Appearance

The Smart Switch is compatible with incandescent, LED, Halogen, and compact fluorescent light bulbs. The switch also includes a white backlight LED indicator to easily locate the switch at night. See the explanation below:



Flashing amber & green: Ready for setup.

Solid amber: Your phone is connected to the switch.

Flashing green: Connecting to Wi-Fi.

Stay green for 30s: Connected to Wi-Fi.

Solid red: Disconnected from Wi-Fi.

Flashing amber: The switch is being reset to factory default settings.

White: Light fixture is off.

RESTART

Press to reboot the Smart Switch.

RESET

Press and hold for about **5** seconds to initiate the setup mode with configuration settings saved.

Press and hold for about **10** seconds to factory reset the Switch.

Set Up Your Smart Light Switch

Follow the steps below to set up your Smart Power Strip via [Kasa Smart](#) app.

1. Download and install Kasa app

Go to Google Play or the Apple App Store or scan the QR code below to download the Kasa app on your Android or iOS smartphone or tablet.



OR



2. Log in or sign up with TP-Link ID

Open the app. Use your TP-Link ID to log in.

If you don't have a TP-Link ID, tap [Create Account](#) and the Kasa app will guide you through the rest.



3. Add Device

Tap the + button in the Kasa app, select [Smart Switches](#) and then follow step-by-step app instructions to complete the installation and setup.



Main Device Controls

After you successfully set up your Smart Light Switch, you will see the home page of the Kasa Smart app. Here you can view and manage all devices that you've added to Kasa. Tap your smart switch to control and manage it.

Home Page

You can see all your Kasa devices listed in the Home page.

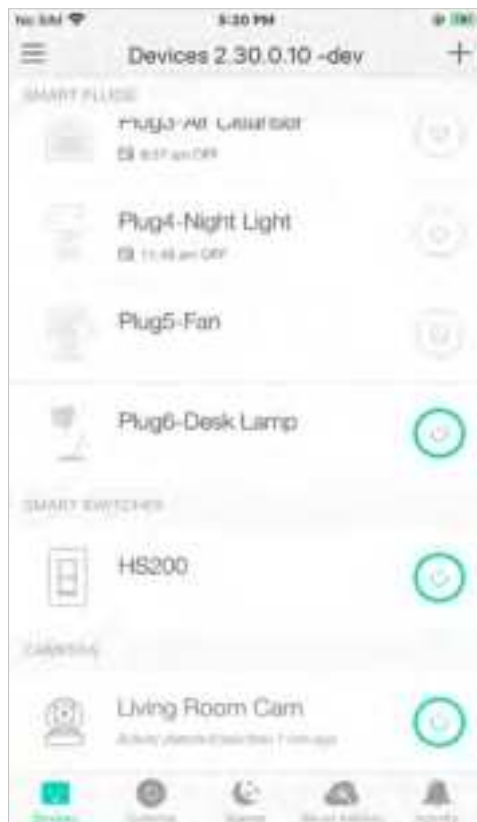

Turn on/off the smart outlet

Turn on/off any outlet of your Smart Light Switch quickly by tapping the switch on the home page. Tapping in the device, you can also check or change its status.

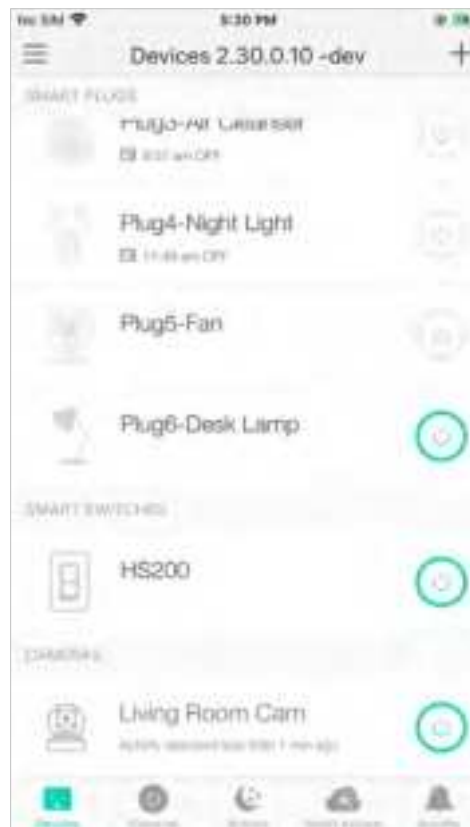

Set Schedules

Schedule: Set schedules to automatically turn on/off the light at set times according to your daily routine.

1. Tap your Smart Light Switch in the Home page, and then tap .



2. Tap + on the top right corner.



2. Set a schedule to turn the light on or off. For example, I want to turn off the light at 11:00 PM every day.



4. You can also choose to turn on/off the light at Sunrise or Sunset. Please note that the Sunrise and Sunset times are based your location.



5. Tap [Save](#) and you'll see your schedule listed in the [Schedule](#) Page. You can add more schedules following the same steps.

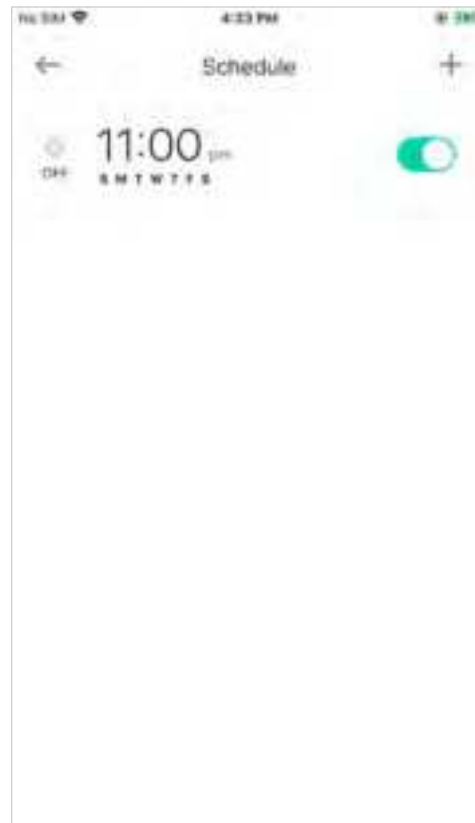

6. You can turn off your schedule any time at the [Schedule](#) page.



Set Timer

Timer: Set the timer for your Smart Light Switch to automatically turn on/off after the time ends.

1. Tap your Smart Light Switch in the Home page, and then tap .



2. Set the time after which the light will be automatically turned on/off.

For example, when I turn on the light, I want it to be off after 30 minutes.

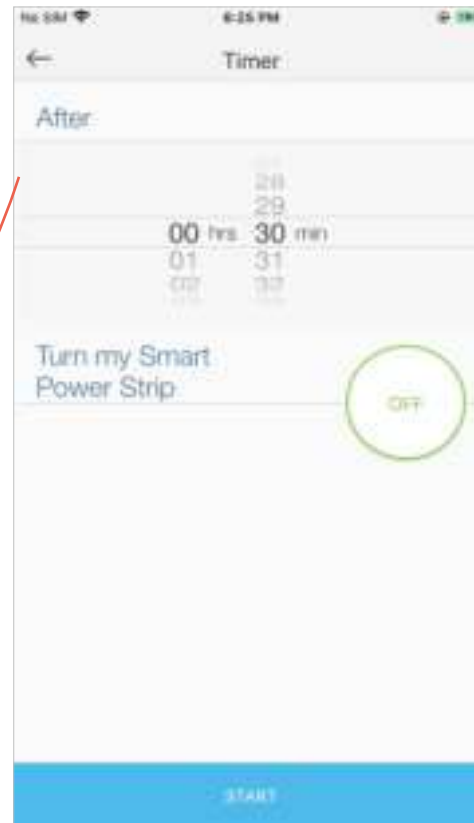

2. Tap **START** and you'll see the timer is counting down. Tap **Stop** to stop the Timer at any time.



Set Away Mode

Away Mode: Set Away Mode for your Smart Light Switch to turn on/off the light automatically at random intervals while you are away to make the appearance that someone is at home.

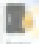
1. Tap your Smart Light Switch in the Home page, and then tap .



2. Set the start and end time during which the switch will be automatically turned on and off at random intervals, and the repeating frequency. For example, I want the light to turn on and off between 7:00 PM to 11:50 PM every Friday and Saturday.

Note: The start and end time must be on the same day.



Check Runtime

Runtime: Check runtime to keep track of how long your Smart Light Switch has been working.

1. Tap your Smart Light Switch in the Home page, and then tap  .

2. Check the runtime for today, the past 7 days, or the past 30 days.

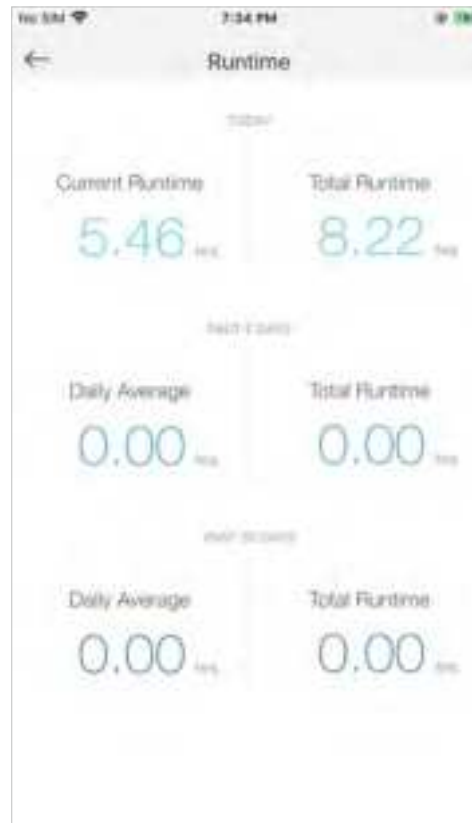

Manage Device Settings

1. Tap your Smart Light Switch in the Home page and then tap ⚙️ .

2. Change the name and icon of each outlet.



Reset Your Smart Light Switch

TP-Link provides three methods to reset your Smart Power Strip.

Method 1

Swipe left any of your Smart Light Switch and tap [Delete](#). Then tap [Remove Device](#). Your Smart Light Switch will be removed from your Kasa account and restored to factory settings.

Method 2

Tap your Smart Light Switch and go to the [Devices Settings](#) page. Then tap [Remove Device](#) in the bottom. Your Smart Light Switch will be removed from your Kasa account and restored to factory settings.

Method 3

Press and hold the [Reset](#) button on the panel of the switch for 10s to restore your it to factory default settings..



Create Scenes

A scene is a preset group of smart devices that can be programmed, customized and activated simultaneously at the touch of a button from your smartphone or tablet, allowing you to easily set your mood, activity or fit any special occasion. To create a scene with your Smart Light Switch, you need other Kasa smart devices, a smart plug for example.

1. Tap  at the bottom, then tap + at the top right corner.



2. Select a scene or create your own scene.

For example: I want to turn on the light and the the speaker simultaneously in the morning with just a tap in the Kasa Smart app .

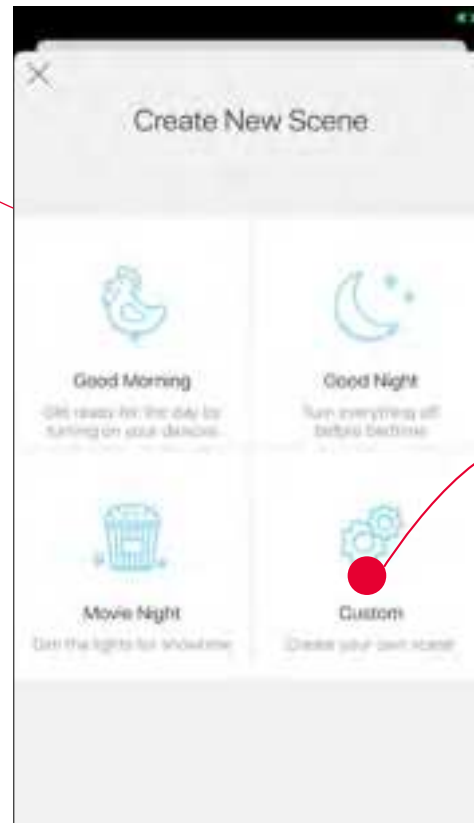

2. Select devices for the scene to work on and set their status respectively.

4. Pick an icon for your scene.



2. Name your scene.

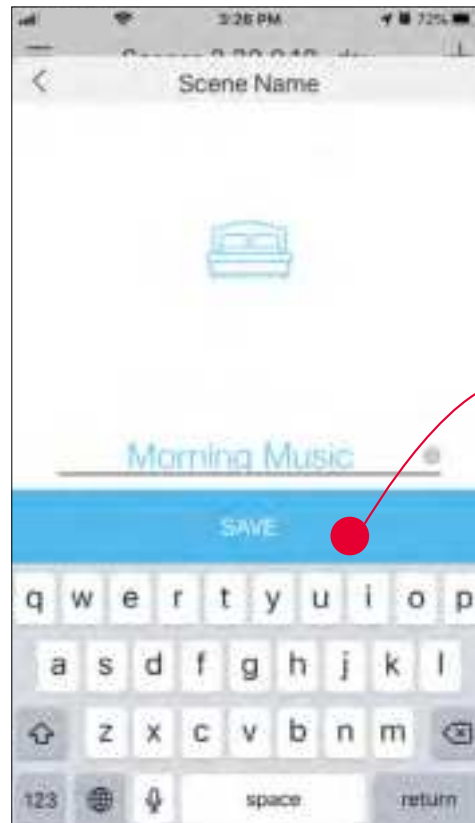

2. Your scene is created and is displayed in the scene list. Just tap the scene to activate it.

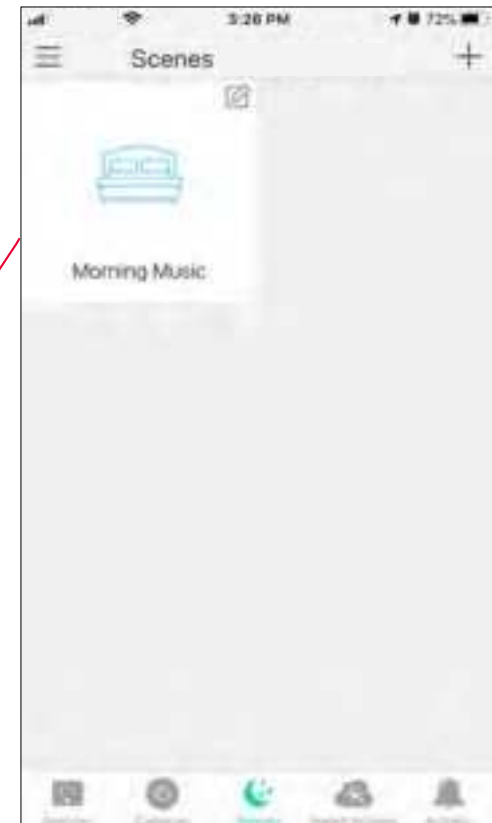

Smart Actions

Smart Actions is a function provided that enables device interconnections and home automations. With Smart Actions, your Kasa devices can work together to create a smarter smart home. From the moment you wake up to the moment you drift asleep, Smart Actions make your home safer and more comfortable.

1. Tap  at the bottom, then tap [Add an Action](#).

2. Select an automation type for your Smart Actions.

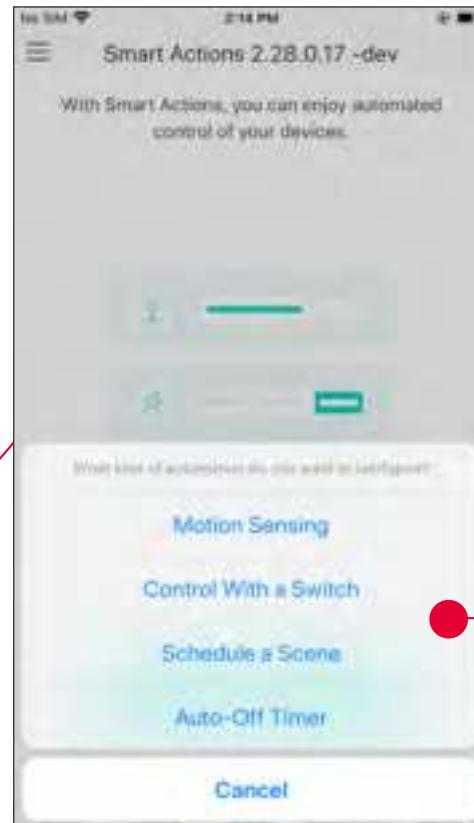
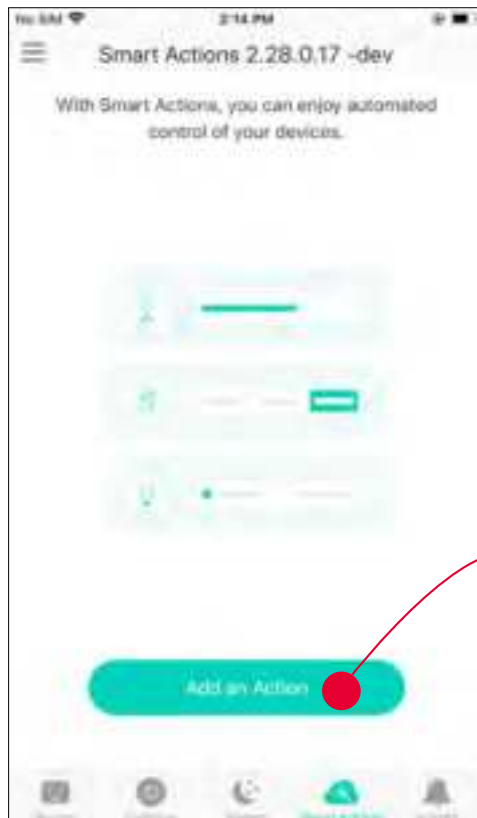

[Motion Sensing](#): Take actions when a Kasa camera senses a motion.

[Control With a Switch](#): Extending the Smart Switch control to other Kasa Smart devices. Turn on/off a group of devices with the Smart Switch all together.

[Schedule a Scene](#): Schedule a "Scene" to be turned on automatically at the time specified.

[Auto-off Timer](#): Whenever a Smart device is turned on, turn it off after the designated amount of time.

1. Configure Motion Sensing If you already have a Kasa Smart Camera

e.g.: I want to turn the light on when my Kasa camera senses a motion.

1. Tap [Motion Sensing](#) then select a camera.

2. Select your Smart Light Switch.

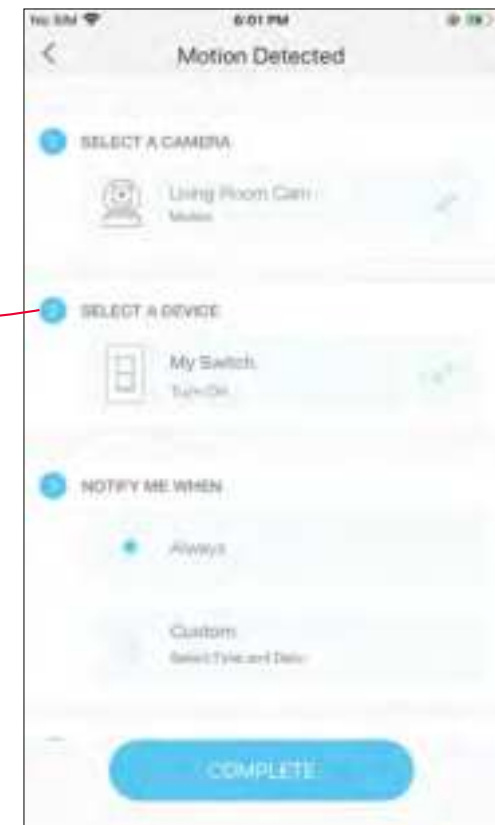
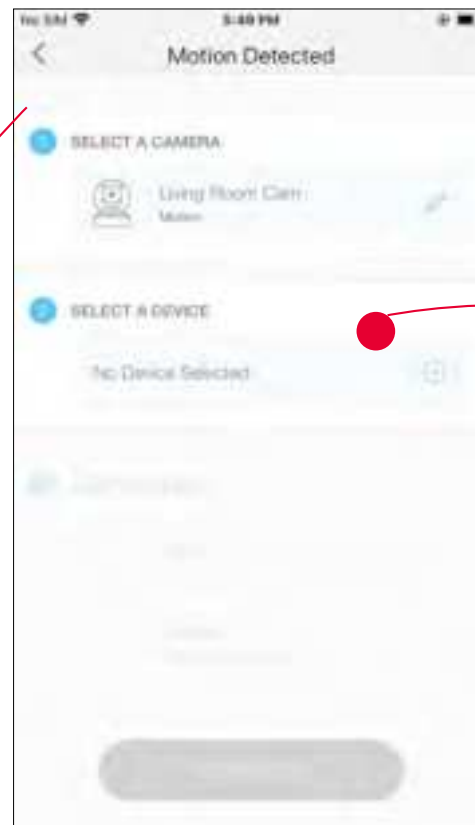
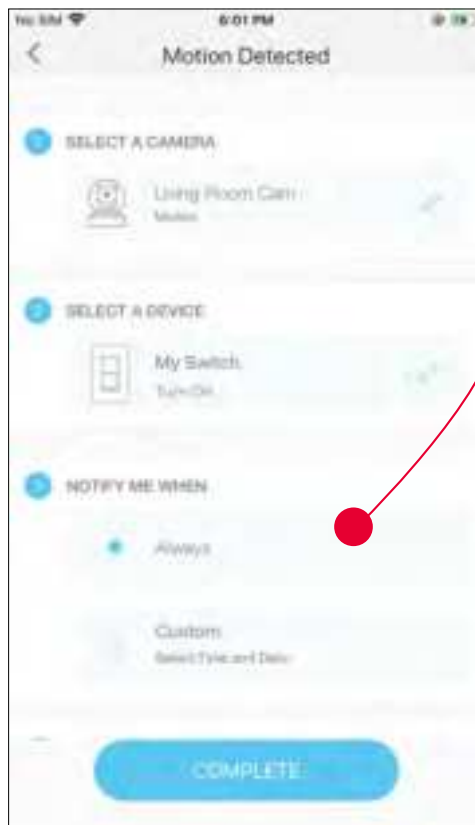

3. Set the time when you want the action to run. You can choose [Always](#) or tap [Custom](#) to choose time according to your needs.

For example: I want the motion to trigger the light on from 11:00 PM to 7:00 AM every day.

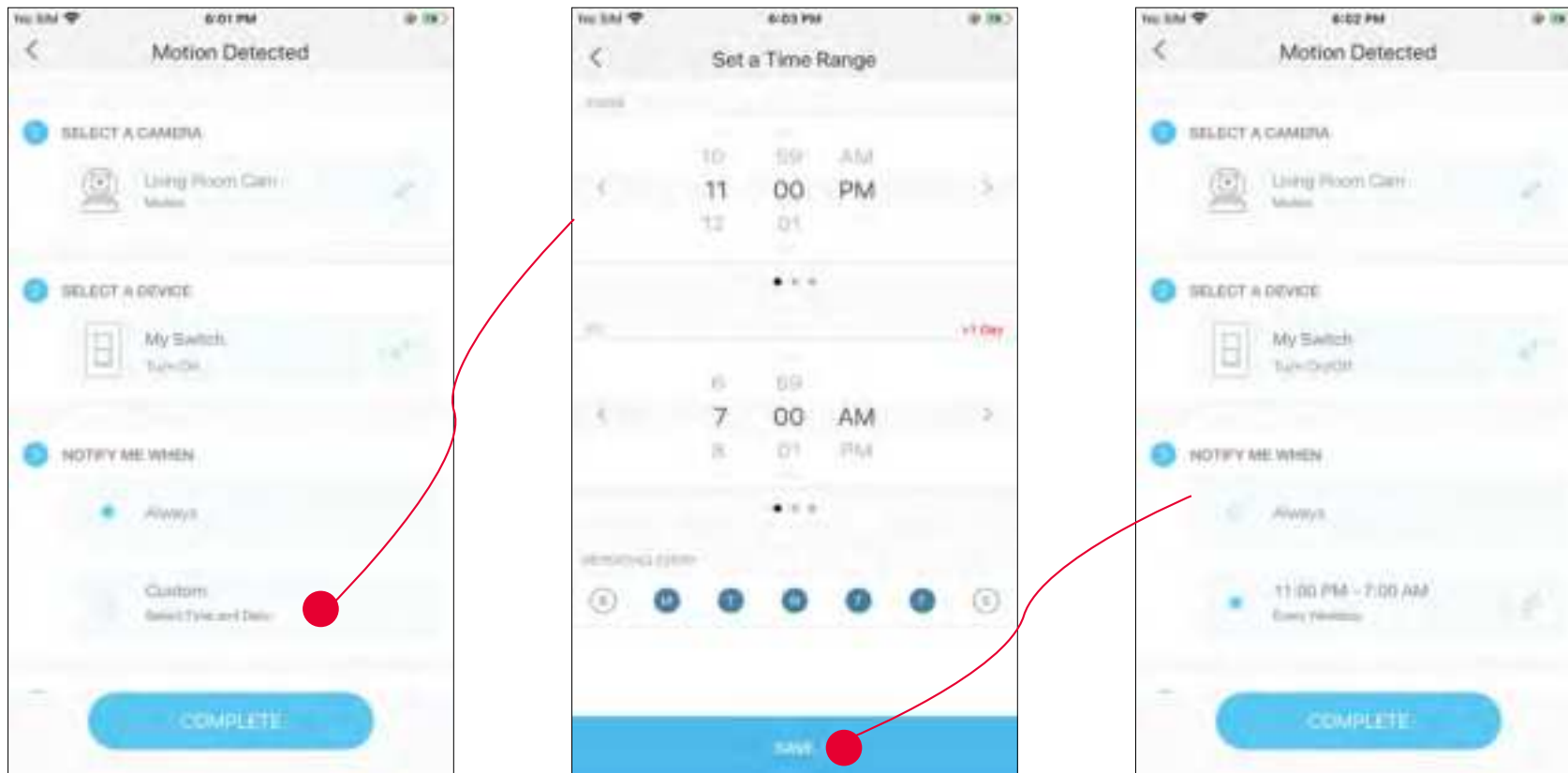

4. (Optional) Set an auto-off timer then tap [Complete](#). Then your living room light will be turned off after the time you set.

5. Name your action for easy identification.

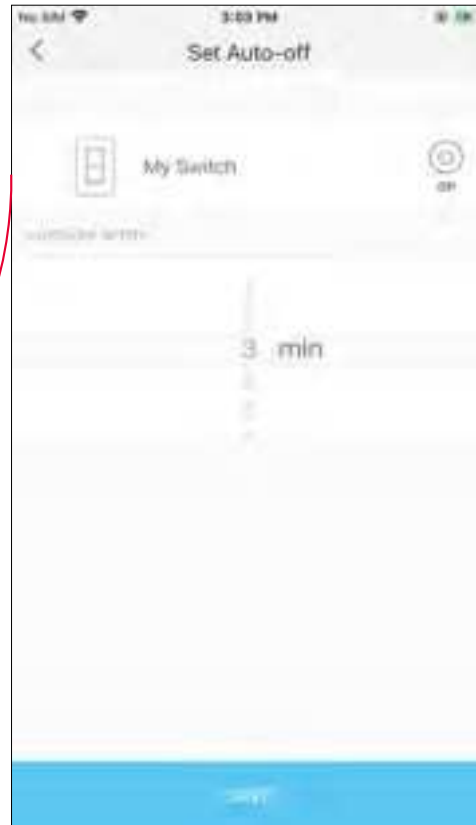
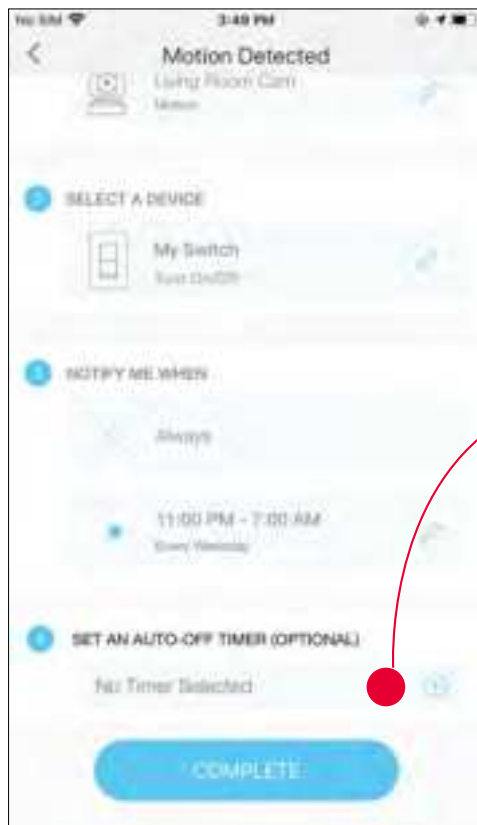

6. The Smart Action is created successfully and displayed in the Smart Actions list.



2. Configure Control With a Switch If you already have other Kasa smart dviceices

e.g.: I want to turn on the living room light, which is plugged in my Kasa smart plug, when I turn on my switch, and turn the light off when I turn off the switch.

1. Tap [Control With a Switch](#).

2. Add a Kasa smart switch. Then select your Kasa smart plug which your living room light is plugged in.

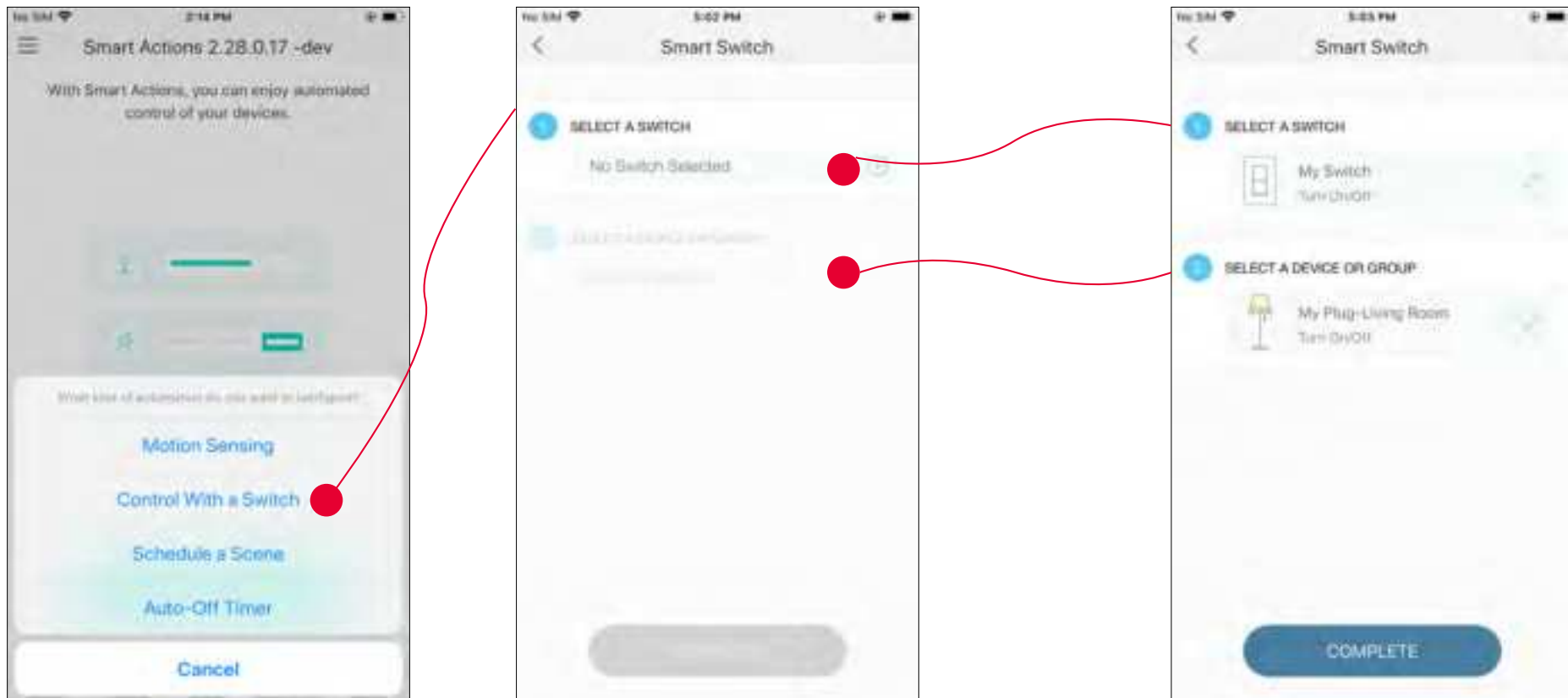

4. Name your action for easy identification.

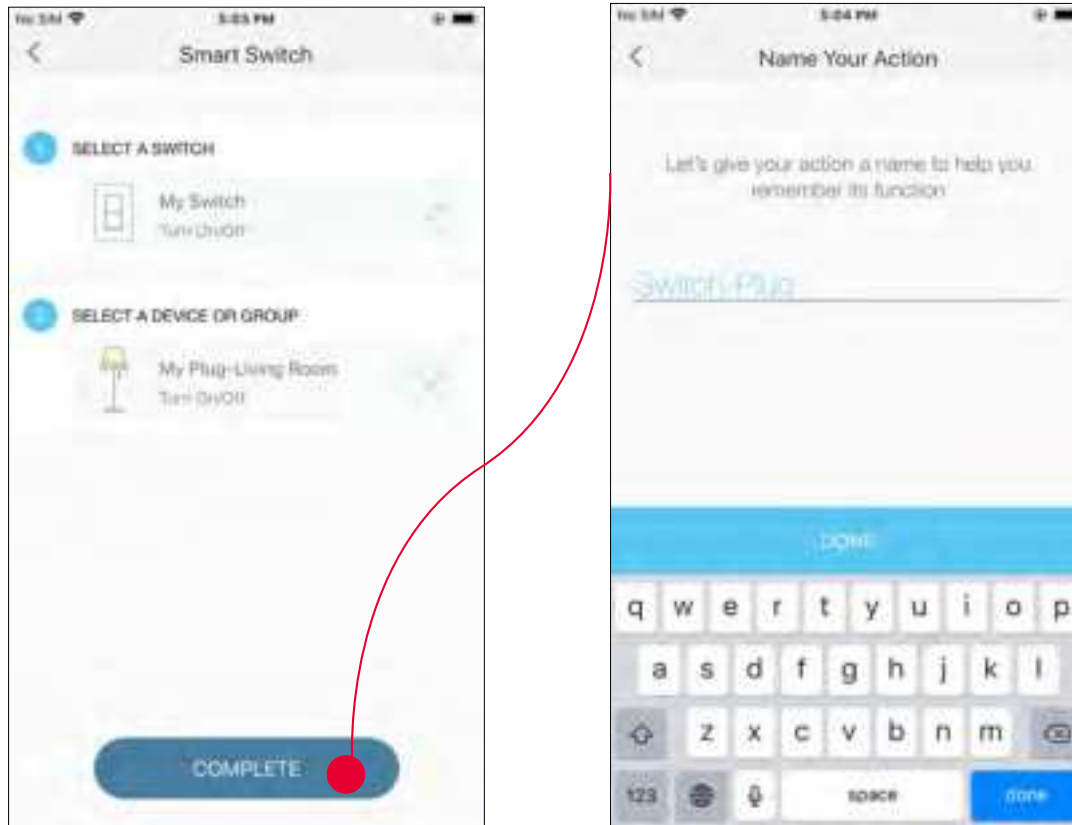

5. Now Your Smart Action is created successfully and is displayed in the smart actions list.



3. Configure Schedule a Scene

e.g.: I want to turn on the scene I have created automatically at scheduled time.

1. Tap [Schedule a Scene](#) then select a scene you have created.

For example: I want to turn on my [Morning Music](#) scene, which turns on my switch and my music speaker (plugged in to a Kasa smart plug) with just a tap, at 7: 20 AM every weekday.

2. Set the time and frequency at which you want your scene to be turned on .

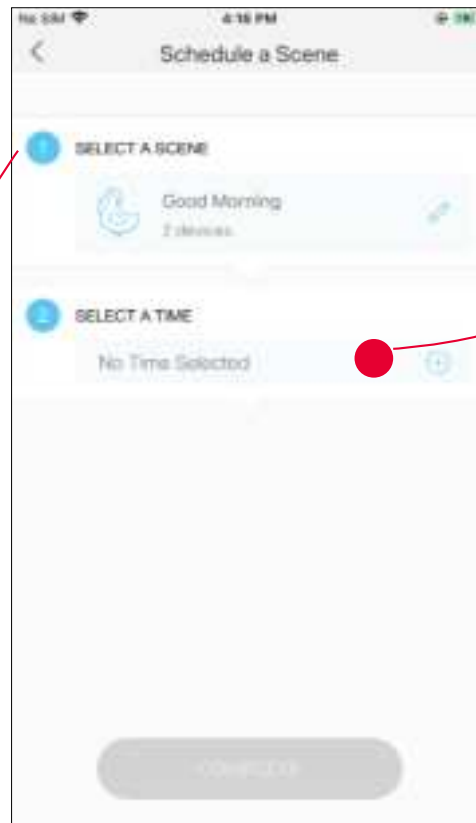
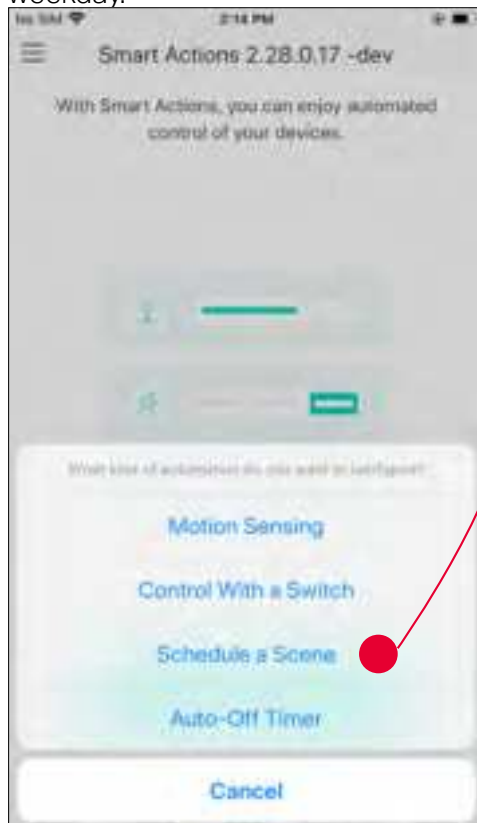

3. Name your action for easy identification.



2. The Smart Action is created successfully and displayed in the Smart Actions list.



4. Configure Auto-Off Timer

e.g.: I want to turn off my Kasa Smart Light Switch after 30 minutes whenever it turns on.

1. Tap [Auto-Off Timer](#) then select a device.

2. Set the time.

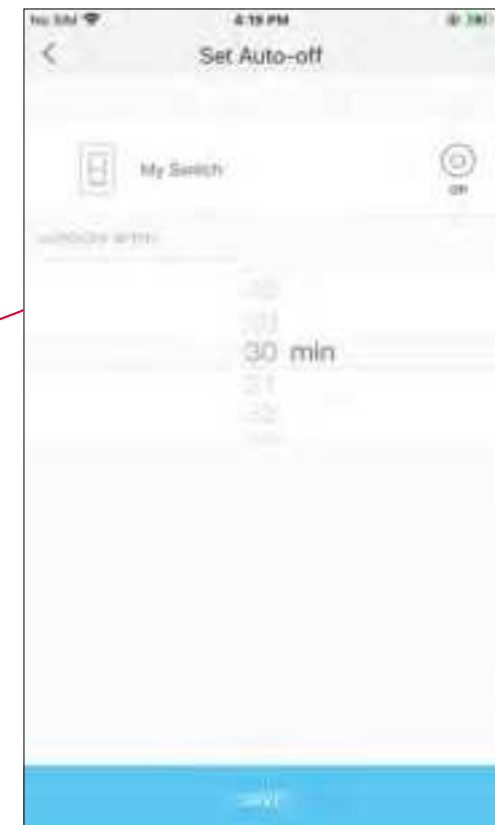
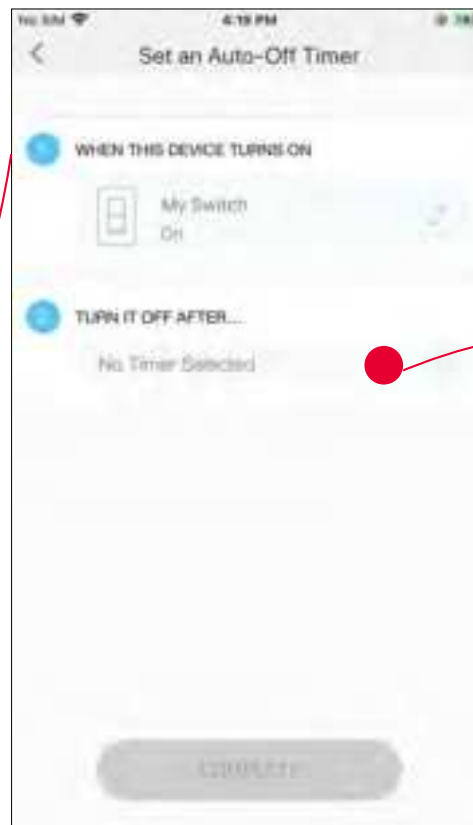
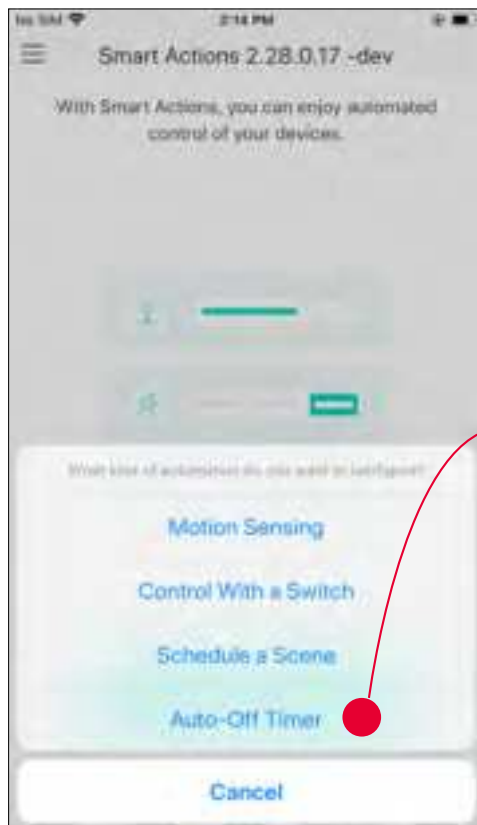

3. Name your action for easy identification.



Discover Kasa

Use the Kasa Smart app to pair your Smart Wi-Fi Power Strip with Amazon Alexa or Google Home Assistant, and enjoy a full hands-free experience. Kasa helps manage the rest of your smart home too, working with Samsung SmartThings to trigger changes when you arrive home or leave for the day.

Launch the **Kasa Smart** app. Go to the sidebar and tap Work with Kasa. You can choose **Amazon Alexa / Google Assistant/ IFTTT / Samsung SmartThings** for detailed instructions.

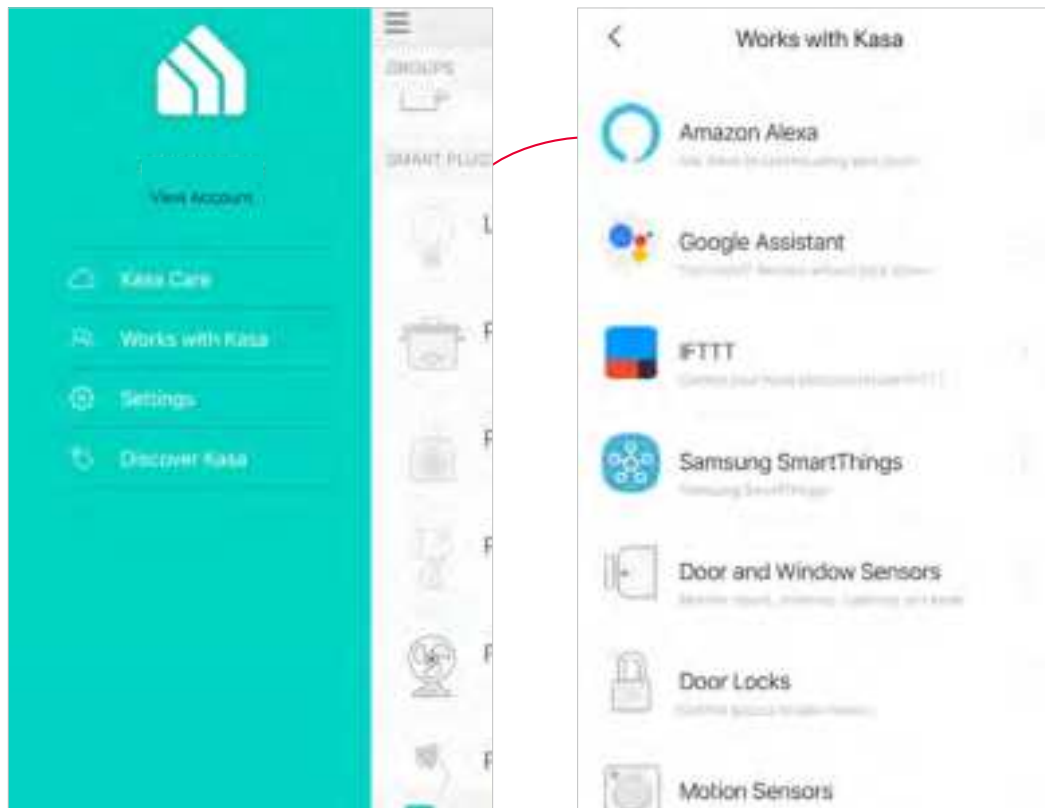

FCC compliance information statement



Product Name: Kasa Smart Wi-Fi Light Switch, Motion Activated

Model Number: KS200M

Responsible party:

TP-Link USA Corporation, d/b/a TP-Link North America, Inc.

Address: 145 South State College Blvd. Suite 400, Brea, CA 92821

Website: <http://www.tp-link.com/us/>

Tel: +1 626 333 0234

Fax: +1 909 527 6803

E-mail: sales.usa@tp-link.com

This equipment has been tested and found to comply with the limits for a Class B digital device, pursuant to part 15 of the FCC Rules. These limits are designed to provide reasonable protection against harmful interference in a residential installation. This equipment generates, uses and can radiate radio frequency energy and, if not installed and used in accordance with the instructions, may cause harmful interference to radio communications. However, there is no guarantee that interference will not occur in a particular installation. If this equipment does cause harmful interference to radio or television reception, which can be determined by turning the equipment off and on, the user is encouraged to try to correct the interference by one or more of the following measures:

- Increase the separation between the equipment and receiver.
- Connect the equipment into an outlet on a circuit different from that to which the receiver is connected.
- Consult the dealer or an experienced radio/ TV technician for help.

This device complies with part 15 of the FCC Rules. Operation is subject to the following two conditions:

1. This device may not cause harmful interference.
2. This device must accept any interference received, including interference that may cause undesired operation.

Any changes or modifications not expressly approved by the party responsible for compliance could void the user's authority to operate the equipment.

Note: The manufacturer is not responsible for any radio or TV interference caused by unauthorized modifications to this equipment. Such modifications could void the user's authority to operate the equipment.

FCC RF Radiation Exposure Statement

This equipment complies with FCC RF radiation exposure limits set forth for an uncontrolled environment. This device and its antenna must not be co-located or operating in conjunction with any other antenna or transmitter.

"To comply with FCC RF exposure compliance requirements, this grant is applicable to only Mobile Configurations. The antennas used for this transmitter must be installed to provide a separation distance of at least 20 cm from all persons and must not be co-located or operating in conjunction with any other antenna or transmitter."

We, **TP-Link USA Corporation**, has determined that the equipment shown as above has been shown to comply with the applicable technical standards, FCC part 15. There is no unauthorized change is made in the equipment and the equipment is properly maintained and operated.

Issue Date: 2021.03.25

Canadian Compliance Statement

This device contains licence-exempt transmitter(s)/receiver(s) that comply with Innovation, Science and Economic Development Canada's licence-exempt RSS(s). Operation is subject to the following two conditions:

- (1) This device may not cause interference.
- (2) This device must accept any interference, including interference that may cause undesired operation of the device.

L'émetteur/récepteur exempt de licence contenu dans le présent appareil est conforme aux CNR d'Innovation, Sciences et Développement économique Canada applicables aux appareils radio exempts de licence. L'exploitation est autorisée aux deux conditions suivantes :

- 1) L'appareil ne doit pas produire de brouillage;
- 2) L'appareil doit accepter tout brouillage radioélectrique subi, même si le brouillage est susceptible d'en compromettre le fonctionnement.

Industry Canada Statement

CAN ICES-3 (B)/NMB-3(B)

NCC Notice

注意！

依據 低功率電波輻射性電機管理辦法

LP0002低功率射頻器材技術規範_章節3.8.2

取得審驗證明之低功率射頻器材，非經核准，公司、商號或使用者均不得擅自變更頻率、加大功率或變更原設計之特性及功能。

低功率射頻器材之使用不得影響飛航安全及干擾合法通信；經發現有干擾現象時，應立即停用，並改善至無干擾時方得繼續使用。

前述合法通信，指依電信管理法規定作業之無線電通信。

低功率射頻器材須忍受合法通信或工業、科學及醫療用電波輻射性電機設備之干擾。

BSMI Notice

安全諮詢及注意事項

- 請使用原裝電源供應器或只能按照本產品注明的電源類型使用本產品。
- 清潔本產品之前請先拔掉電源線。請勿使用液體、噴霧清潔劑或濕布進行清潔。
- 注意防潮，請勿將水或其他液體潑灑到本產品上。

- 插槽與開口供通風使用，以確保本產品的操作可靠並防止過熱，請勿堵塞或覆蓋開口。
- 請勿將本產品置放於靠近熱源的地方。除非有正常的通風，否則不可放在密閉位置中。
- 不要私自拆開機殼或自行維修，如產品有故障請與原廠或代理商聯繫。

限用物質含有情況標示聲明書

設備名稱： Equipment name Kasa Smart Wi-Fi Light Switch, Motion Activated				型號（型式）： Type designation (Type) KS200M		
單元 Unit	限用物質及其化學符號 Restricted substances and its chemical symbols					
	鉛 Lead (Pb)	汞 Mercury (Hg)	鎘 Cadmium (Cd)	六價鉻 Hexavalent chromium (Cr+6)	多溴聯苯 Polybrominated biphenyls (PBB)	多溴二苯醚 Polybrominated diphenyl ethers (PBDE)
PCB	○	○	○	○	○	○
外殼	○	○	○	○	○	○
電源供應板	—	○	○	○	○	○
其他及其配件	—	○	○	○	○	○
備考 1. “超出 0.1 wt %” 及 “超出 0.01 wt %” 係指限用物質之百分比含量超出百分比含量基準值 Note 1: “Exceeding 0.1 wt %” and “exceeding 0.01 wt %” indicate that the percentage content of the restricted substance exceeds the reference percentage value of presence condition. 備考 2. “○” 係指該項限用物質之百分比含量未超出百分比含量基準值。 Note 2: “○” indicates that the percentage content of the restricted substance does not exceed the percentage of reference value of presence. 備考 3. “—” 係指該項限用物質為排除項目。 Note 3: The “—” indicates that the restricted substance corresponds to the exemption.						

Safety Information

- Keep the device away from water, fire, humidity or hot environments.
- Do not attempt to disassemble, repair, or modify the device.

- Do not use the device where wireless devices are not allowed.
- The socket-outlet shall be installed near the equipment and shall be easily accessible.
- Operating temperature: 0°C ~40°C (32 °F ~104 °F); Storage Temperature: -40°C~60°C (-40 °F ~140 °F)

Follow all national and local safety regulations and practices. If you are uncertain or uncomfortable when performing the installation, consult a qualified electrician.

- Install only in a suitable UL or equivalent Listed outlet box.(suitable dimensions: W > 2.83in./72mm, H > 1.81in./46mm, D > 3.15in./80mm).
- CAUTION – Risk of electric Shock – More than one disconnect switch may be required to de-energize the equipment before servicing. A circuit breaker which disconnects the Live and Neutral conductor simultaneously is suitable. Ensure power is off at the circuit breaker before removing or installing any wall switch.
- Do not install the Smart Switch with wet hands or when standing on wet or damp surfaces.
- The Smart Switch must be installed and used in accordance with the National Electric Code (NEC) or your local electrical code. If you are unfamiliar with these codes and requirements, or are uncomfortable performing the installation, consult a qualified electrician.
- Timer could turn-on unexpectedly without the user being present. To Reduce the Hazardous Condition – Unplug the appliance from the receptacle before servicing.

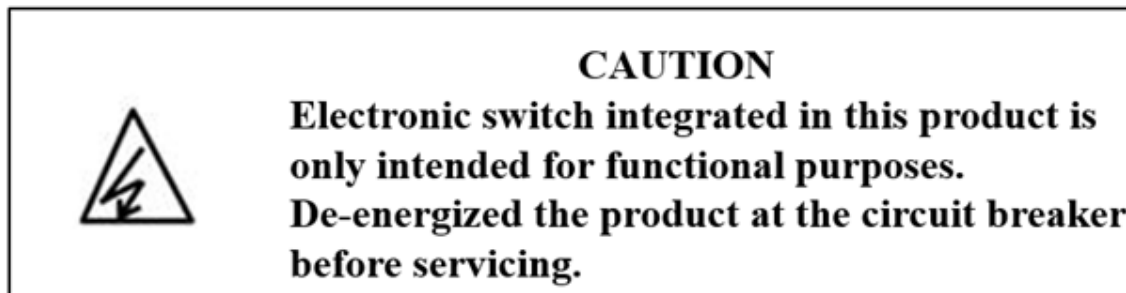





CAUTION:

To Reduce the Risk of Electric Shock – Use Only Indoors.

USE ONLY IN DRY LOCATIONS.

Please read and follow the above safety information when operating the device. We cannot guarantee that no accidents or damage will occur due to improper use of the device. Please use this product with care and operate at your own risk.

Explanation of the symbols on the product label

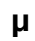
Symbol	Explanation
	Indoor use only
	AC voltage
	DC voltage
	<p>RECYCLING</p> <p>This product bears the selective sorting symbol for Waste electrical and electronic equipment (WEEE). This means that this product must be handled pursuant to European directive 2012/19/EU in order to be recycled or dismantled to minimize its impact on the environment.</p> <p>User has the choice to give his product to a competent recycling organization or to the retailer when he buys a new electrical or electronic equipment.</p>
	<p>Switch of micro-gap construction (for US version)</p> <p>Switch of micro-gap / micro-disconnection construction (for other versions except US)</p>