

Register and Save!

Offer includes
50% off
your next order
of assorted
tips + tip
storage case.

Save over \$50!

Visit **Waterpik.com/WelcomeWF**
to watch How To video.

Register your product and receive over
\$50 in savings.

Waterpik.com/registration



We'd Love to Hear from You!



Connect with Us
@Waterpik



Call: 1-800-525-2774
www.waterpik.com

Waterpik® 14 Day Challenge App



Make water flossing a habit! Try our new mobile App for
the best water flossing experience.



waterpik®
waterflosser®

Congratulations!

You are now on your way
to better oral health!



Register and Save

Register your product at waterpik.com/registration to receive
over **\$50** in savings (includes **50%** off your next order of assorted
tips + tip storage case).



Write a Review

Creating innovative Waterpik® products that inspire better oral
health is our passion. We invite you to leave a review by sharing your
thoughts on the Waterpik® Ultra Water Flosser on waterpik.com or
the retailer's website.



We're Here to Help

We hope you are loving your new Waterpik® Ultra Water Flosser.
If for any reason you are not satisfied or have any product questions,
please contact our fast and friendly Customer Service Team based in
Fort Collins, Colorado. Waterpik® Ultra Water Flosser is backed by a
3-year manufacturer's warranty.

Call: 1-800-525-2774
Monday-Friday
7 am - 5 pm MST



Chat or E-mail
service@waterpik.com



**Quick Start
Guide Inside!**



Quick Start Guide

PRIMING UNIT (FIRST TIME USE ONLY)

- 1 Fill reservoir with warm water and replace it firmly on the base.
Insert tip firmly until it clicks into place.

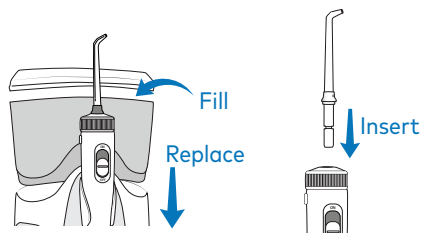

- 2 Turn pressure to high, point tip into sink, turn power ON and water switch to ON until water flows. Turn power and water OFF.

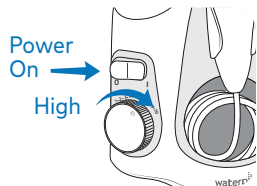

NEED HELP?

Visit [Waterpik.com/WelcomeWF](https://www.waterpik.com/WelcomeWF)
To watch a How To Video and find additional
product support.

Call Us! 1-800-525-2774

WATER FLOSS

- 3 Place tip in mouth. Start on low pressure. Turn power ON. Turn water ON and increase pressure to your liking.

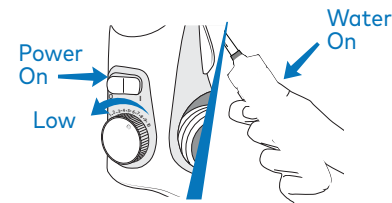

- 4 Lean over sink Close lips enough to prevent splashing, while still allowing water to flow from mouth into sink.

TO AVOID MESS: KEEP TIP IN MOUTH WHILE UNIT IS ON.

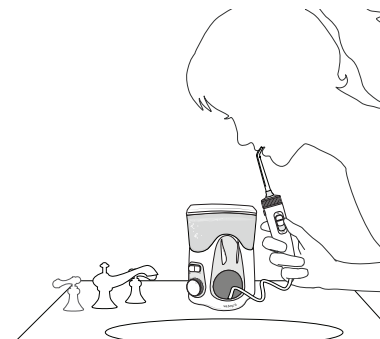

- 5 Aim water at the gumline at a 90 degree angle. Follow the gumline and pause briefly between teeth.

