

Quick Start Guide

Awesome Plant 14 Pro



Scan or Visit
Awesoplant.com
For more product information
Buy Replacements & Seeds

What's Inside

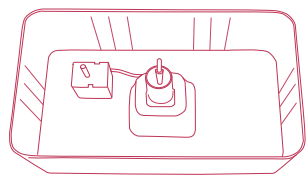

Water Tank ×1

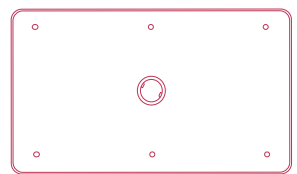

LED Grow Light Panel ×1

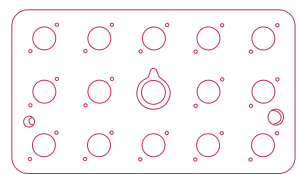

Plant Deck ×1

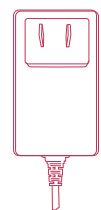

AC Adapter ×1



Water Hole Plug ×1



Adjustable Rod ×1



Water Level Gauge ×1

Replacements

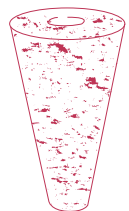

Grow Sponge ×14

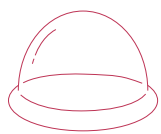

Grow Dome ×14

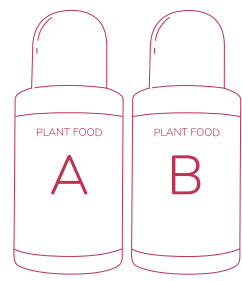

Plant Food A ×1
Plant Food B ×1

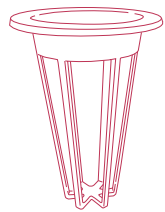

Grow Basket ×14

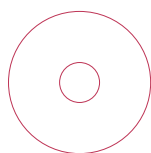

Pod Sticker ×14



Unused pod cover lid ×4



Scan or Visit
Awesoplant.com
Get more Replacements & Seeds

Assembly

- 1** Plug the adapter to water tank
(DO NOT plug in the power)

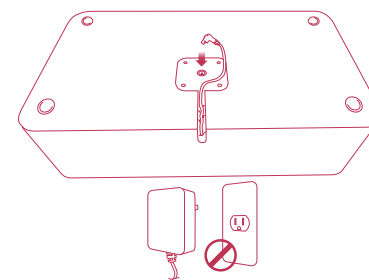

- 2** Insert the rod and rotate counterclockwise to lock

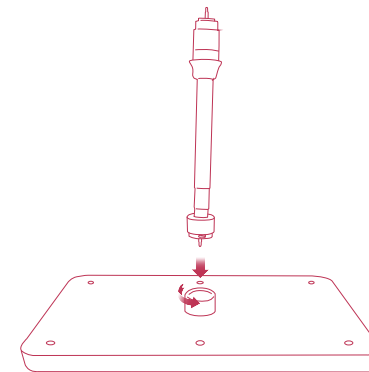

Assembly

- 3** Put the plant deck on water tank, insert the rod and rotate counterclockwise to lock

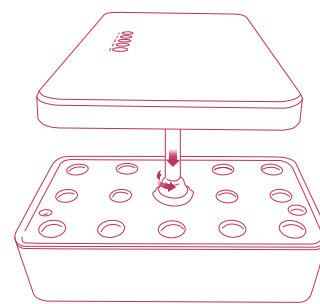

- 4** Insert the water level gauge, add 5L water (check water level and keep below MAX line) , and plug the water hole plug

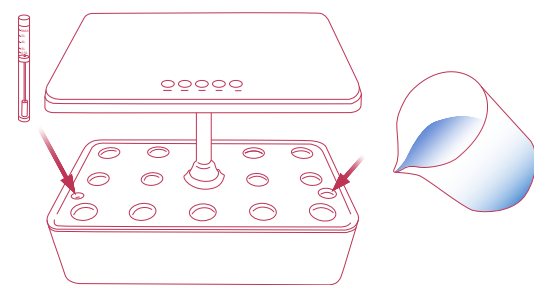

Your 14 Pro

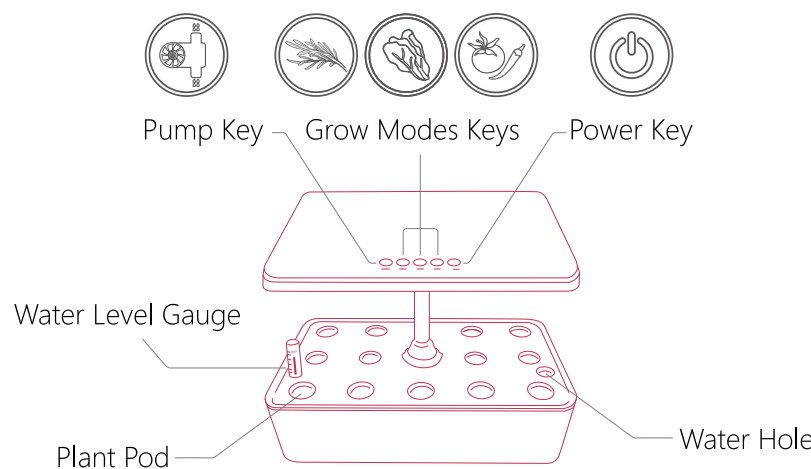

Awesome Plant 14 Pro
Model: A1010
Indoor Hydroponics Growing System for Home, Kitchen & Garden
14 Plant Pods, 3 Growing Modes, LED Grow Light, Quiet Pump
Adjustable Height for Vegetables & Herbs Up to 18.7"
Input: 100V-240V/50-60Hz
Output: 24V 1000mA
Size: 40cm × 23cm × 31cm(lowest)/60(highest)

awesome plant

Start Planting

- 1** Put 1-2 seeds into sponge, and put the sponge into the basket

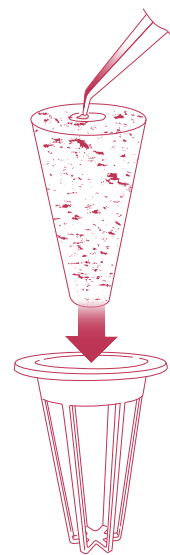

Tips soak seeds in warm water (~30°C/~86°F) for 2-8hr before germination increases sprout chance

Start Planting

- 2** Stick the pod sticker to avoid alga growth if necessary
Put the basket into plant pod
Cover the dome to keep warm if necessary

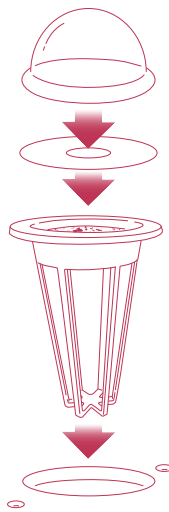

Tips Keeps the water level above 4.5L

Start Planting

- 3** Plug in and always keep the power connected

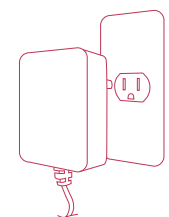

- 4** Press the flashing Power Key



- 5** Choose a grow mode



Optimized spectrum, 16 hr on (from mode switching time), 8 hr off



Optimized spectrum, 16 hr on (from mode switching time), 8 hr off



Optimized spectrum, 17 hr on (from mode switching time), 7 hr off

- 6** Add plant food A+B after germination, wait for the harvest come

Q & A

How much plant food should I add?

After germination, we recommend to add 12.5ml/5L plant food A and 12.5ml/5L plant food B. After real leaf comes out(about 5 days after germination), we recommend to add another 12.5ml/5L plant food A and 12.5ml/5L plant food B. No need to add more before harvest. After harvest, change water and starts again.

How does the pump work?

The pump starts working 5s after power on, with the blue indicator on, and keeps a 20min on, 20min off cycle. To manually stop, press Pump Key and the blue indicator will flash. To start the pump again, press Pump Key again .

Where can I use Awesome Plant 14 Pro?

Anywhere in room temperature, such as kitchen, living room, office and window still, no need for sun light and soil.

What can I grow with Awesome Plant 14 Pro?

Vegetables, fruits, flowers & herbs with height below 18.7".