

# User's Manual

Portable Car Air Pump  
Y-QB01



### Warm Tips

Please read the instruction manual carefully and follow the instructions in the operation manual. Using the product correctly will make you more convenient and quick to familiarize yourself with the product.

### Power button

Long press to power on/off, short press to start/stop inflation after power on, 3 minutes After not using automatic shutdown

### Mode switch

This product provides four inflatable modes for you to choose. It is convenient for you to switch between different situations.

The four modes are: "Car", "Motorcycle", "Bicycle", and "Ball". You can use the mode key to select and choose, and the default value of the air pressure will automatically change after the selection.

### Unit switching

This product provides four pressure units for you to choose. It is convenient for your local usage habits and you can switch between them.

The four units are: "PSI", "BAR", "KPA", "kg / cm²". You can switch with the unit key.

### Set value adjustment

This product is set with a default air pressure value, but if it does not meet your needs, you can also manually adjust the air pressure value from the main, press to increase or decrease the number (short press is to increase or decrease 0.01 value each time, long press It is a quick adjustment, and it is also a quick adjustment in units of 0.01.) After adjusting to the value you want, wait for 3 seconds to complete the automatic setting . At this time, the air pump air pressure setting value has changed to the number you set. At this time, directly press the key to start the air pump.

## Product description

### Button Definition

- Light/SOS
- Tire pressure Decreasemen
- Boot up / Shutdown
- Tire pressure Decreasemen
- Mode selecting

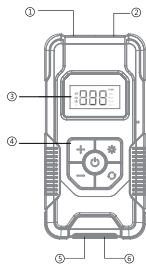

- Inflating Tube Socket
- Flash Li light
- LED Display
- Button Plat
- Type-C
- USB

## Product parameters

Storage Temperature: -20 ~ 60°C

Product Size: 85\*55\*170mm

Input: 5V/2A 9V/2A; Output: 5V/2A

LED Lighting: 1 LED lighting

Working Temperature: -10 ~ 45 °C

Inflating Tube Size: 200mm trachea extraction length (including air nozzle)

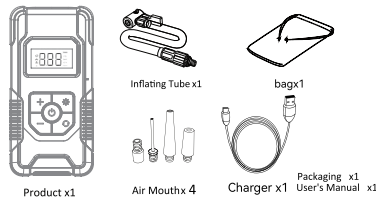

Product x1

Air Mouthx 4

Charger x1

Packaging x1

## LED Flash Light

This product is equipped with LED lighting function, which can help you use it when working in dark places. Long press the button to turn on the LED light, short press to switch the SOS function, long press again to turn off the LED light.

## Product charging, mobile charging

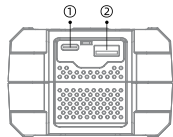

- Product charging for Type-C interface; input: 5V/2A; 9V/2A; Support QC fast charging protocol
- USB-A interface for the charger. Output: 5V/2A

## Notice

\*This product is forbidden to be used alone by children. Children must be accompanied by an adult.

\*Never insert the trachea into the mouth, ears, nose or eyes of a human or animal to inflate!

\*Do not use this product as a toy product.

\*Do not use this product near flammable and explosive liquids and gases (such as gas stations, gas stations)

\*Inflating will cause physical heating phenomenon of high-pressure operation. Be careful when you remove the air pipe.

\*After 15 minutes of continuous use, it is recommended to continue using after an interval of 5-10 minutes.

## How to use the air pump

-This product is suitable for:

Various types of automobiles (excluding trucks and engineering vehicles), motorcycles, electric vehicles, various types of bicycles, balls, balloons, life buoys, swimming rings, inflatable cushions, kayaks and other inflatable products.

-This product has an automatic inflation function for the parts that need to be inflated, and can automatically stop when the air pressure reaches a standard value, with intelligent settings and simple operation.

-This product is also a precision digital air pressure measurement tool. Any part that requires air pressure can be measured with this product.

This product is equipped with LED lighting function, which allows you to operate clearly in a dark environment.

-This product is equipped with four pumping modes, "Car", "Motorcycle", "Bicycle", and "Ball". You can choose the appropriate mode according to your needs. Each mode has different air pressure default values. Do not need to set it by yourself unless these default values do not meet your needs. When the air pressure reaches your set value, the air pump will automatically stop.

## Instructions

### Automobile \ Motorcycle \ Electric Vehicle \ Bicycle

Connect the air nozzle tube in the accessory to the air outlet of the air pump and screw it tightly. After attaching the air nozzle to the tire core, press down the handle. At this time, Long press to boot, it will flash a few times and then display the tire pressure value of the tire. After confirming whether the air pump mode is correct, press the key to start the air pump to start air pumping, and stop automatically when the set value is reached.

### Ball \ Swimming Ring \ Air Cushion

Connect the air nozzle tube in the accessory to the air

outlet of the air pump and screw it tightly. After attaching the air nozzle to the ball needle (or two other conversion nozzles), press down the handle. After confirming whether the air pump mode is correct, press the key to start air pump. Stop when it reaches the set value.

There are four pressure units for you to choose:

PSI / Bar / Kpa / Kg/cm²

## Default values of tire pressure in various modes



Ball Bicycle Motorcycle Car

0.6	2.1	2.2	2.5	Kg/cm²
-----	-----	-----	-----	--------

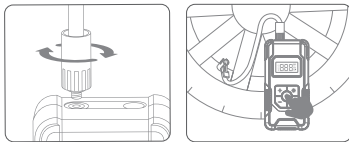

Step 1

Connect the air hose to the product.

Step 2

Connect the air nozzle to the tire and turn the product on.

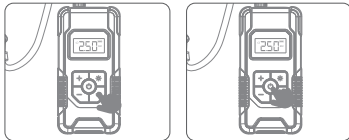

Step 3

Select the car inflation mode.

Step 4

Just press the start button for inflation.

## Frequently Asked Questions

Status	Cause / Solution
Machine is not working	<ol style="list-style-type: none"><li>Check whether the battery is in a low-power state;</li><li>If the above situation occurs, please charge the battery before use.</li></ol>
Inaccurate tire pressure display	<ol style="list-style-type: none"><li>Check whether the connection between the inflation tube connector and the tire valve is too tight (some vehicles cannot be connected too tightly), and you can gradually loosen the interface for testing;</li><li>Check whether the air pressure unit is correct (can let the inflation tube disconnect the tire inflation nozzle, and after the air pump is disconnected from the power supply for 5 seconds, reconnect the power supply for operation)</li></ol>
Power plug or power cord is over hot	<ol style="list-style-type: none"><li>If the power cord is crimped, unfold it completely;</li><li>If the car power socket is wet and dirty, wipe it clean and dry;</li><li>The working time is too long, please cool down before using.</li></ol>
Preset tire pressure display is abnormal	An external tire pressure monitor is installed on the tire valve, and the limit nut of the tire pressure monitoring prevents the normal connection of the gas pump nozzle with the tire valve, which causes the gas pump to fail to charge.
Stops in seconds after the preset tire pressure is activated	<ol style="list-style-type: none"><li>An external tire pressure monitor is installed on the tire valve. The limit nut of the tire pressure monitor prevents the normal connection of the air pump nozzle to the wheel valve, causing the inflated pump to fail to charge.</li><li>If the current ambient temperature is below zero, use a lighter to warm his tire's valve slightly before inflating.</li></ol>
Conversion of inflatable standard units	100kpa = 14.5psi = 1kg = 1.01bar The tire pressure of common cars is 2.3-2.5bar

If you have other questions, please contact customer service for help.

## Cases not covered by warranty service

- Apply After the warranty period
- Without Warranty card, valid invoice or other valid sales certificate;
- Warranty card voucher model does not match or is altered;
- Damage caused by failure to use, maintain, maintain or use non-original accessories in accordance with the instruction manual;
- Unauthorized repairs, alterations, and misuse, collisions, drops, crushing, fluid penetration, corrosion;
- Torn, altered, or illegible product labels, seals, and serial numbers (SN)
- Damage caused by irresistible floods, fires, lightning strikes, etc. ;
- Defects caused by normal wear and tear of the product;
- Products not sold in mainland China.

## Paid service guarantee

If the product does not meet the warranty service conditions but requires maintenance, the appropriate maintenance cost will be calculated according to the parts and labor costs, and a quote will be provided to you. After obtaining your consent, we will provide you with product maintenance services.

## Contacts

Email: HMF20200@hotmail.com

