

# WEEFINE

## Universal Phones Smart Housing (WFH07)

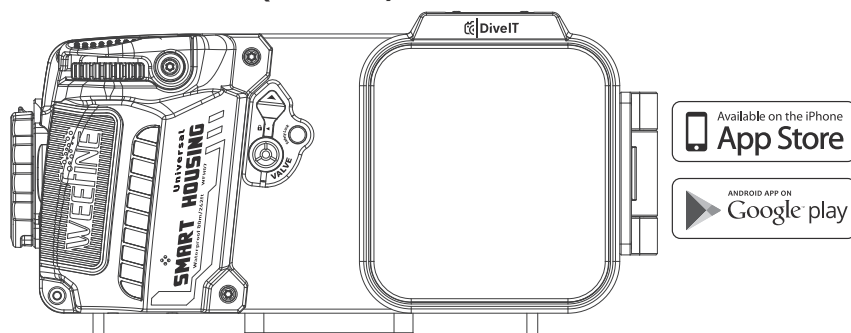

Please read the manually carefully before using

### Product Introduction

Thank you for purchasing WEEFINE products! WEEFINE is committed to improving convenience and reliability through innovative design and ease of use that cater to the usage habits of both professional and amateur photographers; Mobile phones are becoming the most commonly used photography devices. The WEEFINE WFH07 Smart Housing, with its rich functions and professional software and hardware design, creates an excellent underwater photography experience for you. All important function operations of each WFH07 is strictly inspected and hydraulically tested to ensure stable and reliable quality. Please read this manual carefully before using the product, as it will maximize its performance and lifespan.

### Technical Parameters & Housing opening&locking & Place the phone

Compatible phones size	Within 163.5(L) x 82(W) x 10.6(H) mm + 7mm(Lens)
Depth Rating	80m / 262Ft
Battery	Built-in Lithium Battery
Charger	TYPE-C input
Running time	Work running time > 24 Hours, Standby time > 100 days;
Times of vacuumizing	> 100 number of times
Material	Aluminum with Type II Anodizing and Optical Grade Polycarbonate Resin
Dimension	238.5(L) x 119(W) x 76(H) mm
Weight	1150g (Air) / 100g (Underwater)

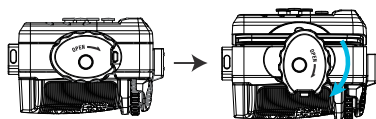

#### Open

Pull the lock plate safety buckle outward and twist the lock plate towards the Open direction until the back cover is fully opened;

#### Locking

Align the lock plate latch with the lock column on the transparent back cover of the housing, twist the lock plate towards the Lock direction until the safety buckle of the lock plate clicks and the housing locks;

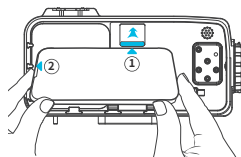

#### Place the phone

Place the back of the phone facing down and push the phone's clip until the phone is flat and inserted;

Note: The top of the phone should not overlap with the rubber protective buckle on the left side of the Smart Housing to avoid damaging the phone when closing it;

### Product information

(Figure 1)

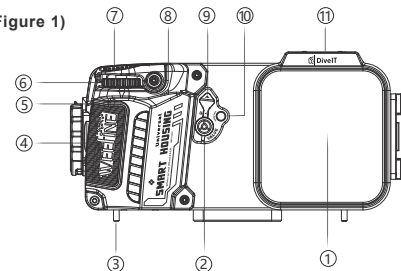

(Figure 2)

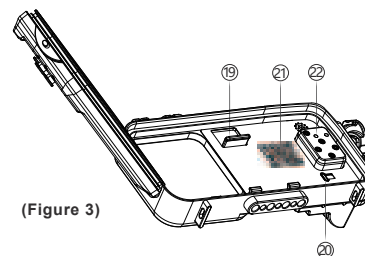
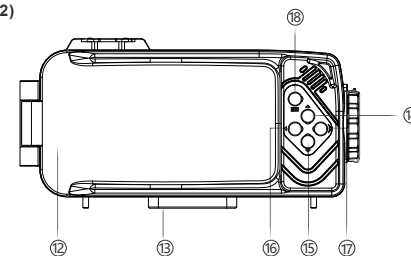

(Figure 3)

(Figure 1)

① Lens window ② Exhaust valve ③ Hand rope hole ④ Lock plate ⑤ Lock plate safety buckle ⑥ Wheel ⑦ Shutter ⑧ Fiber optic port ⑨ Exhaust valve latch ⑩ Exhaust valve safety lock ⑪ Hot shoe / Traybase

(Figure 2)

⑫ back window ⑬ Fixed seat ⑭ Up key ⑮ Down key ⑯ Left key ⑰ Right key ⑱ Menu

(Figure 3)

⑲ Phone's clip ⑳ Charging port ㉑ DiveIT APP QR ㉒ Indicator light

### Packing List

WFH07 *1	User Manual *1	Silicon grease *1	Lanyard *1
Spare O-ring *1	Allen Key *1	Removal tool *1	Clean cloth *1
USB-C cable *1	Shutter extension lever *1		

### Housing on/off & Connecting the phone to the Smart Housing & Button vibration effect

#### Turn on

Push and hold the Shutter for 3 seconds;

#### Turn off

Push and hold the Menu key for 3 seconds;

#### Connecting the phone to the Smart Housing

Scan the QR code inside the Smart Housing to download the DiveIT App and install it for registration; After opening the App and turning on the Smart Housing, the phone and the Smart Housing will be automatically connected;

#### Button vibration effect

Push and hold the Right key for 3 seconds to enable or disable it;

Working indicator light status	Battery level > 20%	Battery level < 20%
Bluetooth connected	Green light goes on	Red light goes on
Bluetooth not connected	Green light flashing	Red light flashing



Note: Valve Pump function will disable when battery level < 20%;

App manually

### Open and close the exhaust valve

#### Open the valve

While pressing the safety lock of the red exhaust valve, pull the exhaust valve latch in the direction of the arrow until the exhaust valve is completely ejected and the valve opens;

#### Close the valve

Press the exhaust valve firmly until the latch is marked with a pointing arrow, and the valve is closed with a "click" sound;

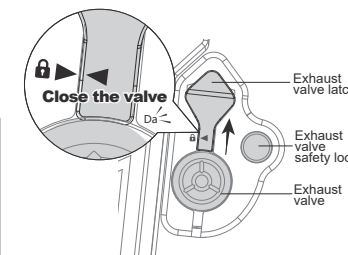

#### Note:

- Before closing the back cover of the housing, please open the exhaust valve, so as to smoothly close the housing;
- Please open the exhaust valve during transportation to maintain the balance of air pressure inside and outside the housing and avoid damaging components;
- Before diving, the exhaust valve must be closed to avoid water;
- After diving, it is necessary to blow/dry/wipe off the water around the valve before opening it to prevent water droplets from being sucked into the hose;

### General Maintenance & Charging and indicator light status

1. Soak the housing in freshwater for minimum 30 minutes after diving;
2. If the housing is not going to be used for a long time, please store the housing with 70% battery capacity;
3. The battery needs to be recharged fully every 6 months to prolong the battery life;
4. There is an O-ring on the case, silicon grease should be used to keep the O-ring well lubricated. If the O-ring is cracked, hardened, damaged, deformed, and so on, it should be replaced in time;
5. Do not use sharp tools to remove the O-ring.

Inserting a Type-C cable into the charging port, and it takes less than 3 hours to fully charge;

Red light: charging in progress;  
Green light: battery fully charged;

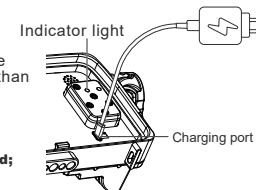

**FCC Warning:**

This equipment has been tested and found to comply with the limits for a Class B digital device, pursuant to part 15 of the FCC Rules. These limits are designed to provide reasonable protection against harmful interference in a residential installation. This equipment generates, uses and can radiate radio frequency energy and, if not installed and used in accordance with the instructions, may cause harmful interference to radio communications. However, there is no guarantee that interference will not occur in a particular installation. If this equipment does cause harmful interference to radio or television reception, which can be determined by turning the equipment off and on, the user is encouraged to try to correct the interference by one or more of the following measures:

- Reorient or relocate the receiving antenna.
- Increase the separation between the equipment and receiver.
- Connect the equipment into an outlet on a circuit different from that to which the receiver is connected.
- Consult the dealer or an experienced radio/TV technician for help.

**Caution:** Any changes or modifications to this device not explicitly approved by manufacturer could void your authority to operate this equipment.

This device complies with part 15 of the FCC Rules. Operation is subject to the following two conditions:

(1) This device may not cause harmful interference, and (2) this device must accept any interference received, including interference that may cause undesired operation.

This equipment complies with FCC radiation exposure limits set forth for an uncontrolled environment. This equipment should be installed and operated with minimum distance 0cm between the radiator and your body.